

Fort Street Public School

Information pack

April 2020



Artist impression of the Fort Street Public School upgrade

The NSW Government is investing \$6.7 billion over four years to deliver more than 190 new and upgraded schools to support communities across NSW. In addition, a record \$1.3 billion is being spent on school maintenance over five years. This is the largest investment in public education infrastructure in the history of NSW.

The NSW Department of Education is committed to delivering new and upgraded schools for communities across New South Wales. The delivery of these important projects is essential to the future learning needs of our students and supports growth in the local economy.

About this information pack

This document provides an overview of the State Significant Development Application (SSDA) for the Fort Street Public School upgrade, which was recently lodged with the Department on Planning, Industry and Environment (DPIE).

In this document, you will find an overview of:

- the proposed school upgrade
- how we will manage construction impacts
- how you can provide feedback
- how to contact us for more information.

Change to information sessions

School Infrastructure NSW is committed to keeping the school and local community updated at important project milestones, such as the lodgement of an SSDA. We are temporarily changing some of the ways we keep you informed about our project in your community to account for social distancing measures. Until further notice we will be sharing information with our communities online instead of in person.

Project overview

The Fort Street Public School upgrade will cater to growing enrolments and provide exciting new spaces for learning and teaching.

Under the SSDA, we are proposing to increase the school's capacity up to 550 students through a range of new and refurbished buildings, which will be sensitive to the area's character and heritage.



Up to 24 home base classrooms



School hall



A library



Out of school hours care (OSHC)



New play spaces

Indicative project timeline

Proposed relocation to temporary school



Early works

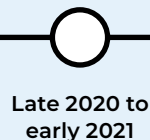

Construction start (pending SSDA approval)

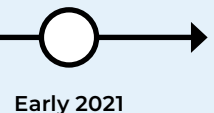

What is a State Significant Development Application?

State Significant Development Applications (SSDAs) are used for projects that have special significance to the people and State of NSW. The Department of Planning, Industry and Environment (DPIE) is responsible for the planning approval process for SSDAs, rather than a local council.

DPIE is placing the Fort Street Public School upgrade SSDA on public exhibition from 2 April to 29 April 2020. During this time, you can get more information and provide feedback on the SSDA by going to: planningportal.nsw.gov.au/major-projects/project/13596

Site plans

Existing site plan

The site plan below shows the layout of the existing Fort Street Public School buildings and grounds.

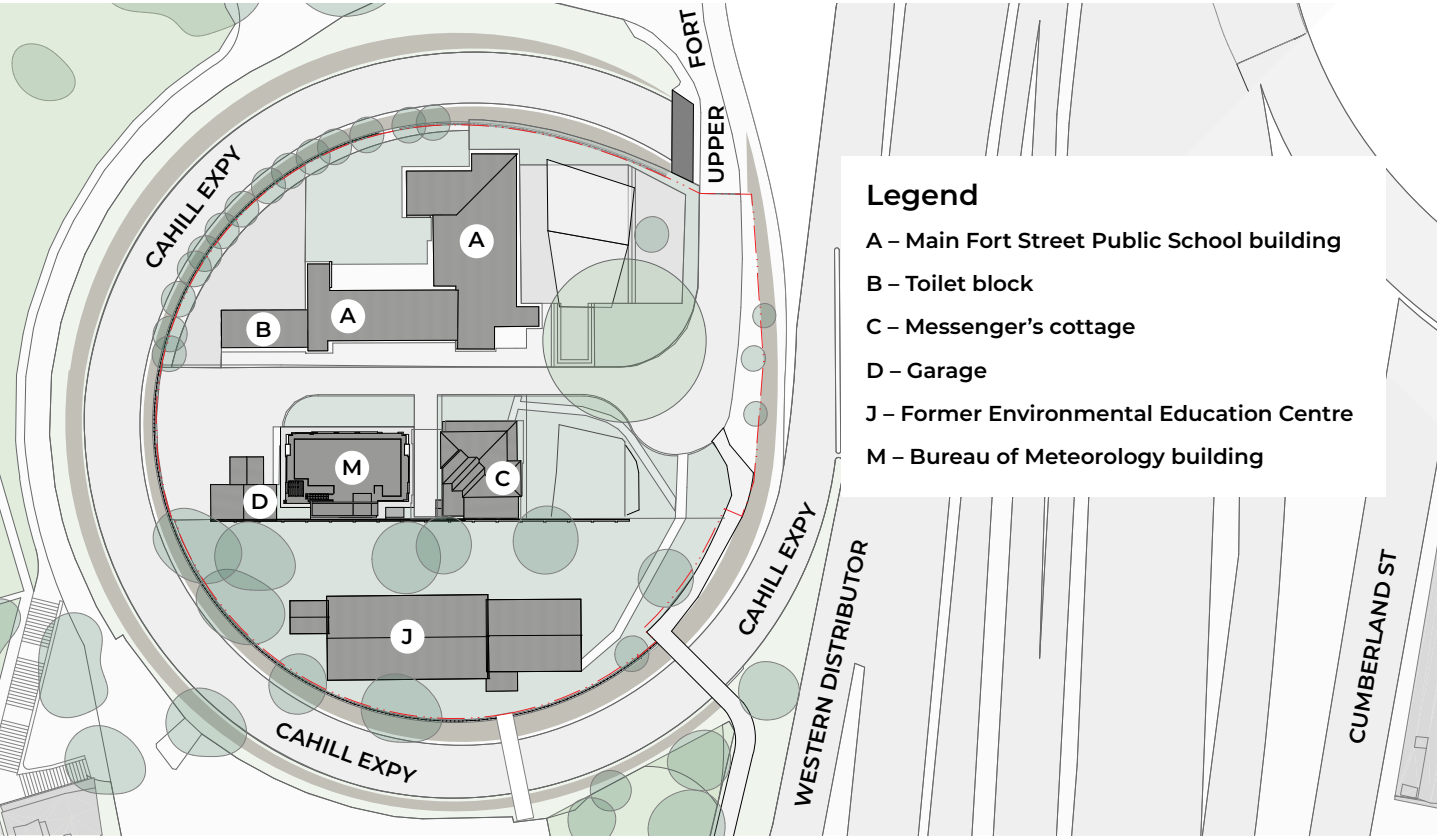

Future site plan

The site plan below shows the proposed layout of the upgraded Fort Street Public School buildings and grounds. This plan shows the location of a range of proposed new and refurbished buildings, together with longer term plans for the school site.



Proposed changes to the site

The Fort Street Public School upgrade includes a range of proposed new buildings and refurbishments to existing buildings, as outlined below and indicated on the future site plan (page 3):

- A new building on the western part of the site for a staff room (Building F)
- Two new, interconnected school buildings (Buildings H & J)
- New school hall and canteen building (Building G)
- Refurbishment and extension of the existing Fort Street Public School building, including the construction of a rooftop play area (Building A)

- Refurbishment of the Bureau of Meteorology Building, including internal alterations and rooftop terrace (Building M)
- Minor alterations to the Messenger's Cottage (Building C).

Longer term plans

Our longer-term plans for the school include a proposed pedestrian bridge over the Cahill Expressway and a new school building on the north-west of the site (indicated by the blue shade on the future site map). However, neither of these proposals are part of this SSDA and may be delivered at a later date through separate development applications.

Functional relationships

This diagram shows each level of the proposed school and how they connect with each other.

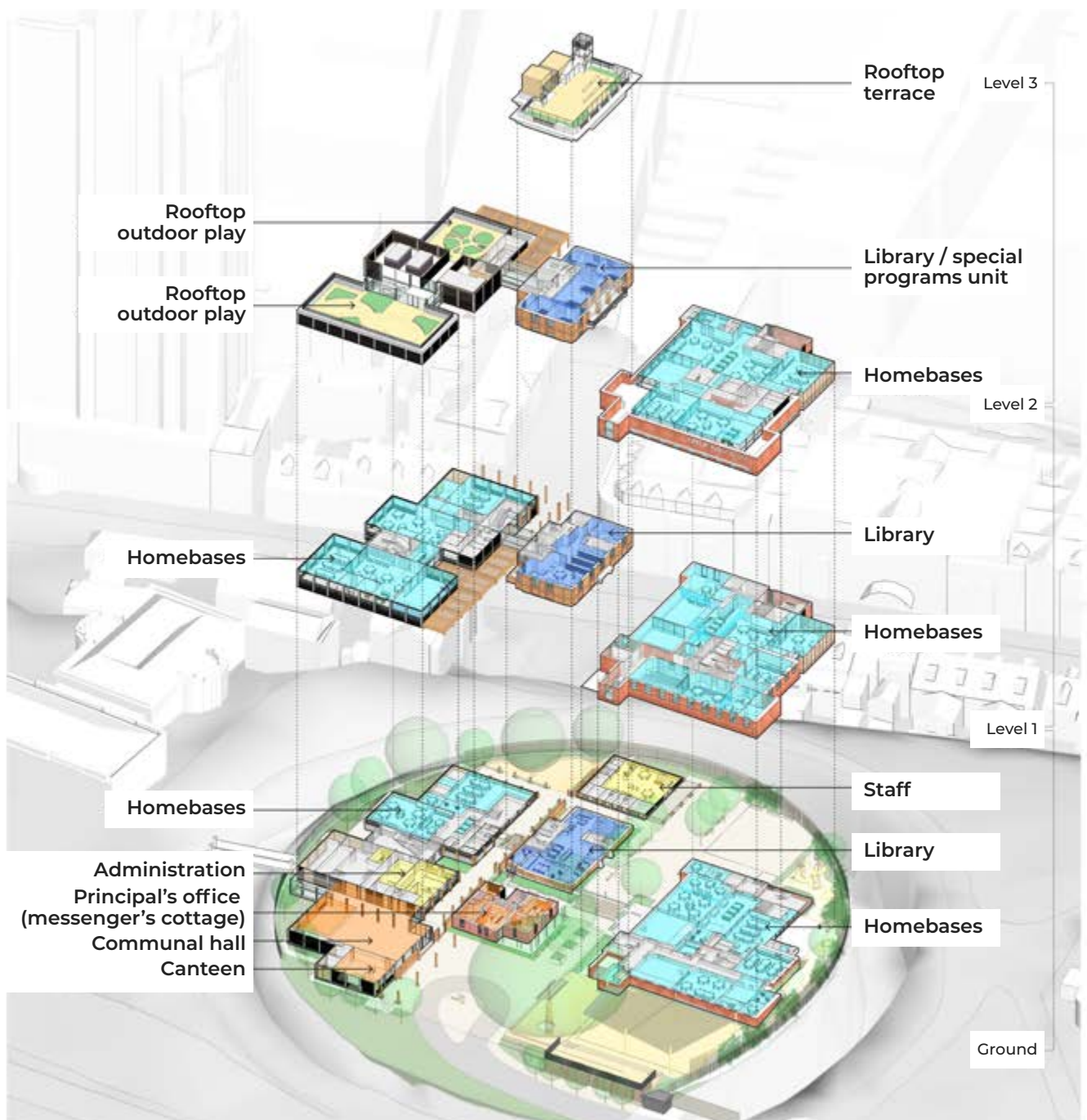

Artist impressions

The images below show different views of the existing and future school from three different viewpoints. We have provided a site map to show the viewpoint provided in each of these images.

View from the National Trust (north view)

Current view of school from the National Trust



View of upgraded school from the National Trust



Map viewpoint



North view

View from Observatory Hill (south view)

View of existing school from Observatory Hill



View of upgraded school from Observatory Hill



Map viewpoint

South view



View from the Cahill Expressway, Harbour Bridge (west view)

View of existing school from Cahill Expressway, Harbour Bridge



View of upgraded school from Cahill Expressway, Harbour Bridge



Map viewpoint



Transport and access

To support a larger student population, we are proposing to make the following changes to vehicle and pedestrian connections to the school:

Widening Upper Fort Street to remove pinch point

The section of Upper Fort Street near the entrance of the school currently only allows for one-way traffic. This can result in traffic congestion at busy times of the day. We are proposing to widen this section of the street to six metres, which will allow for two-way traffic and improve traffic flow.

Drop-off/pick-up zone

We are proposing to modify the drop-off/pick-up zone on Upper Fort Street to allow for:

- up to 30 queued vehicles
- additional queueing area for 18 vehicles along Watson Road
- 15-minute free parking for parents and carers to park and access after school care (or at times when the pick-up line is not in operation).

At other times, the existing 2P and 4P parking controls will apply.

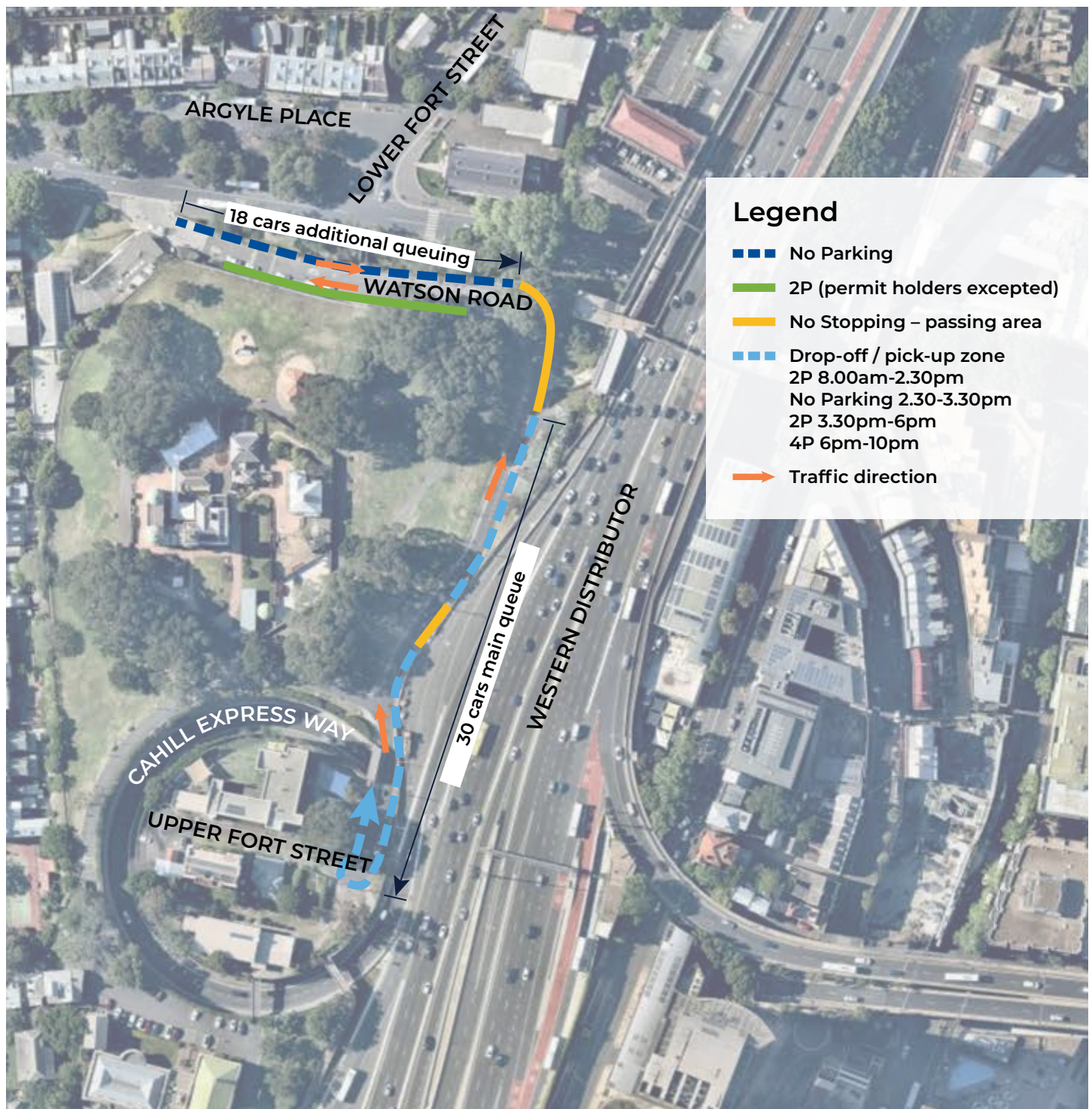

Managing construction impacts

Hours of work

The hours of work for the project are expected to be consistent with standard Sydney CBD construction working hours:

- Monday to Friday: 7:00am – 7:00pm
- Saturday: 7:00am – 5:00pm
- Sundays and public holidays: no works.

Out of hours work will be considered on a case-by-case basis and will need to be approved by the Department of Planning, Industry and Environment.

Truck movements

We anticipate there will be up to 25 to 50 vehicles moving in and out of the site each day. We expect that truck movements will be focused on the western side of the site via Sussex Street and Kent Street.

Temporary diversion of the cycleway

As the Sydney Harbour Bridge southern cycleway currently passes over the school site, we will need to reroute the cycleway during construction from Kent Street to the Sydney Harbour Bridge. The proposed cycleway detour is an on-road route along Kent Street, Argyle Street and Watson Road.

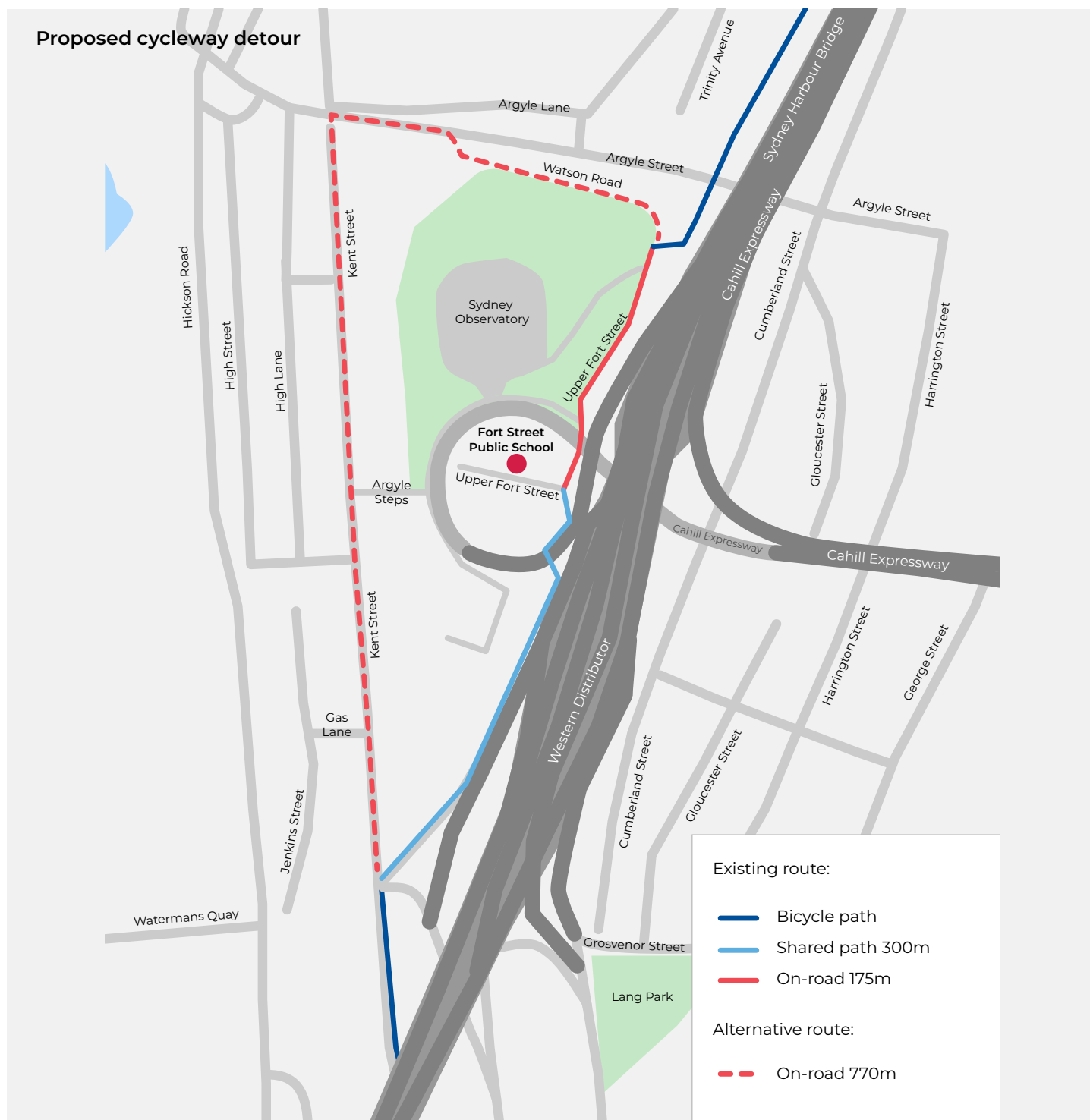

Frequently asked questions

General

What is a State Significant Development Application?

State Significant Development Applications (SSDAs) are used for projects that have special significance to the people and State of NSW. The Department of Planning, Industry and Environment (DPIE) is responsible for the planning approval process for SSDAs, rather than a local council.

How many students currently attend Fort Street Public School?

About 220

What is the student capacity of the proposed new Fort Street Public School?

550

When will the school reach capacity?

Enrolments are anticipated to increase year by year. We expect that it will take several years for the school to reach its full capacity.

Construction

When will construction start?

We expect early works will begin in the second half of 2020. Pending SSDA approval, we expect construction will start in the first quarter of 2021. We will keep you updated on these timeframes as approval is given and the project progresses.

When will you build the proposed pedestrian bridge on the western side of the school?

The pedestrian bridge is part of a long-term masterplan for the school site, which may be built at a later date after the completion of the Fort Street Public School upgrade. This will require separate approvals.

Sydney Harbour Bridge Cycleway

Where will the cycleway be diverted during construction?

The proposed cycleway detour is an on-road route along Kent Street, Argyle Street and Watson Road.

How can I find out more about the proposed Sydney Harbour Bridge Cycleway upgrade?

The proposed Sydney Harbour Bridge Cycleway upgrade is being managed by Transport for NSW and is not part of the Fort Street Public School upgrade.

You can find out more about the proposed cycleway upgrade at Transport for NSW: rms.nsw.gov.au/projects/.

More information and feedback

How can I find out more about the SSDA for the Fort Street Public School upgrade?

You can find detailed information about the SSDA for the Fort Street Public School upgrade by going to the Department of Planning, Industry and Environment's website at: planningportal.nsw.gov.au/major-projects/project/13596

How can I provide feedback on the SSDA for the Fort Street Public School upgrade?

All feedback on the SSDA should be given to the Department of Planning, Industry and Environment. To find out how to submit your feedback, please go to planningportal.nsw.gov.au/major-projects/project/13596

Stay informed



Website

Stay up to date by visiting the School Infrastructure NSW website schoolinfrastructure.nsw.gov.au



Email

Contact the Community Engagement team by emailing schoolinfrastructure@det.nsw.edu.au



Phone

Contact us between 9am and 5pm, Monday to Friday on **1300 482 651**