

# Investing in our schools

The Fort Street Public School upgrade will cater to growing enrolments and provide exciting new spaces for learning and teaching.

Under the SSDA, we are proposing to increase the school's capacity up to 550 students through a range of new and refurbished buildings, which will be sensitive to the area's character and heritage.

## Benefits

 Up to 24 home base classrooms

 School hall

 A library

 Out of school hours care (OSHC)

 New play spaces



Artist impression of the Fort Street Public School upgrade

## Indicative project timeline

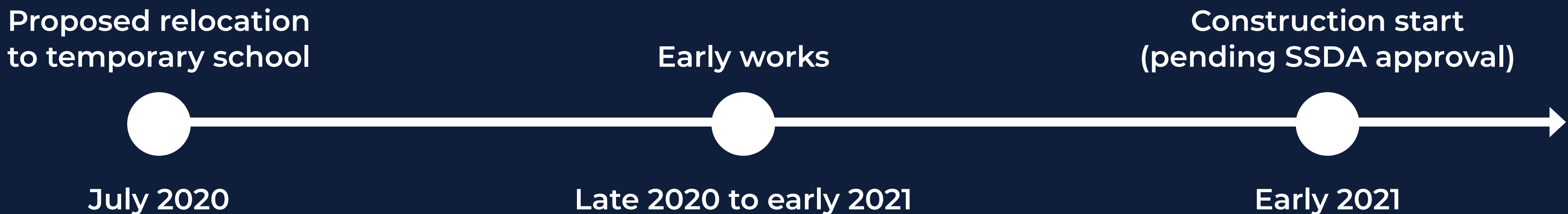

## Fort Street Public School upgrade

For more information phone: 1300 482 651  
Email: [schoolinfrastructure@det.nsw.edu.au](mailto:schoolinfrastructure@det.nsw.edu.au)



# Existing site plan

The site plan below shows the layout of the existing Fort Street Public School buildings and grounds.

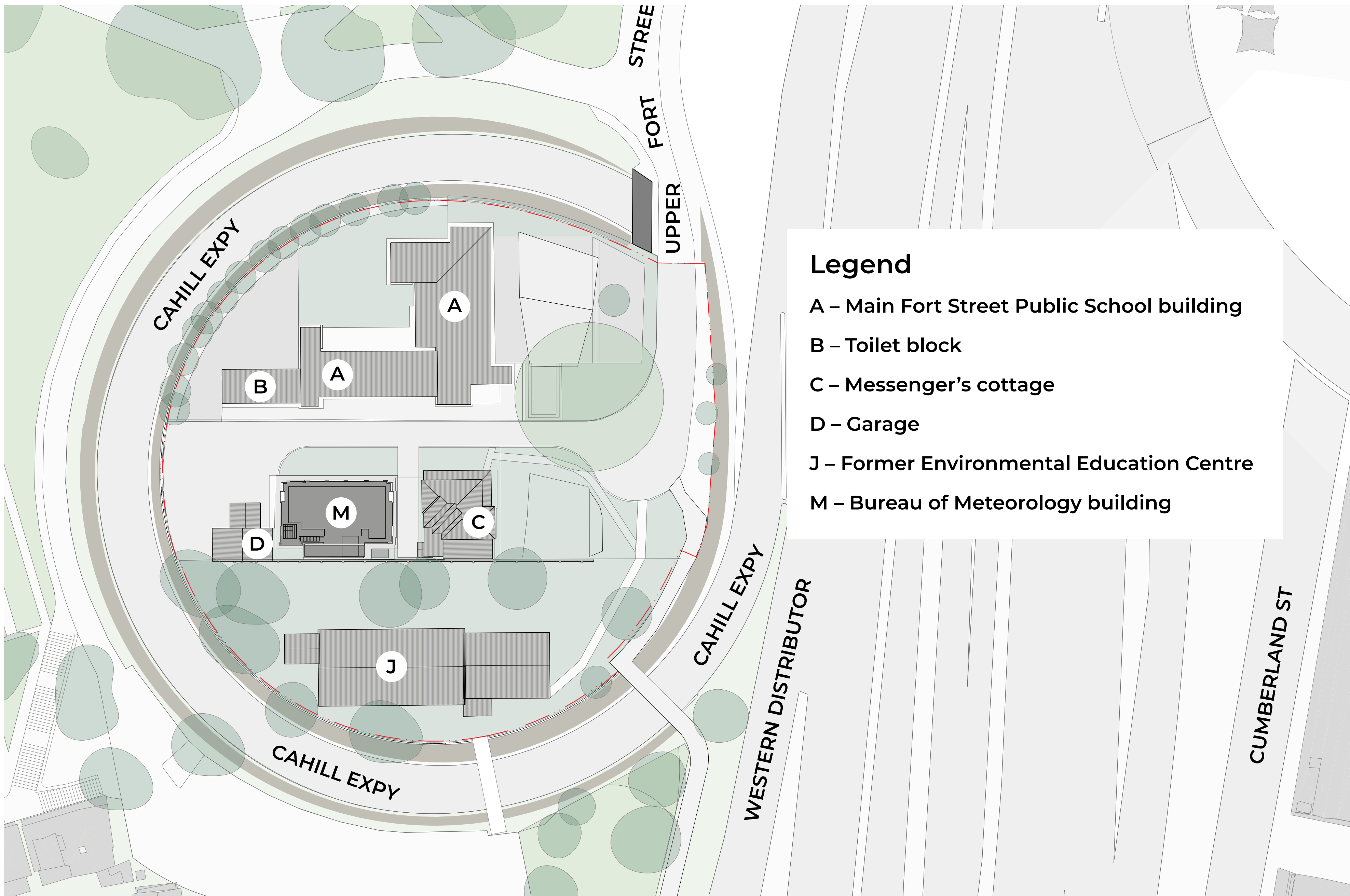

## Fort Street Public School upgrade

For more information phone: 1300 482 651  
Email: schoolinfrastructure@det.nsw.edu.au

# Future site plan

The site plan below shows the proposed layout of the upgraded Fort Street Public School buildings and grounds. This plan shows the location of a range of proposed new and refurbished buildings, together with longer term plans for the school site.

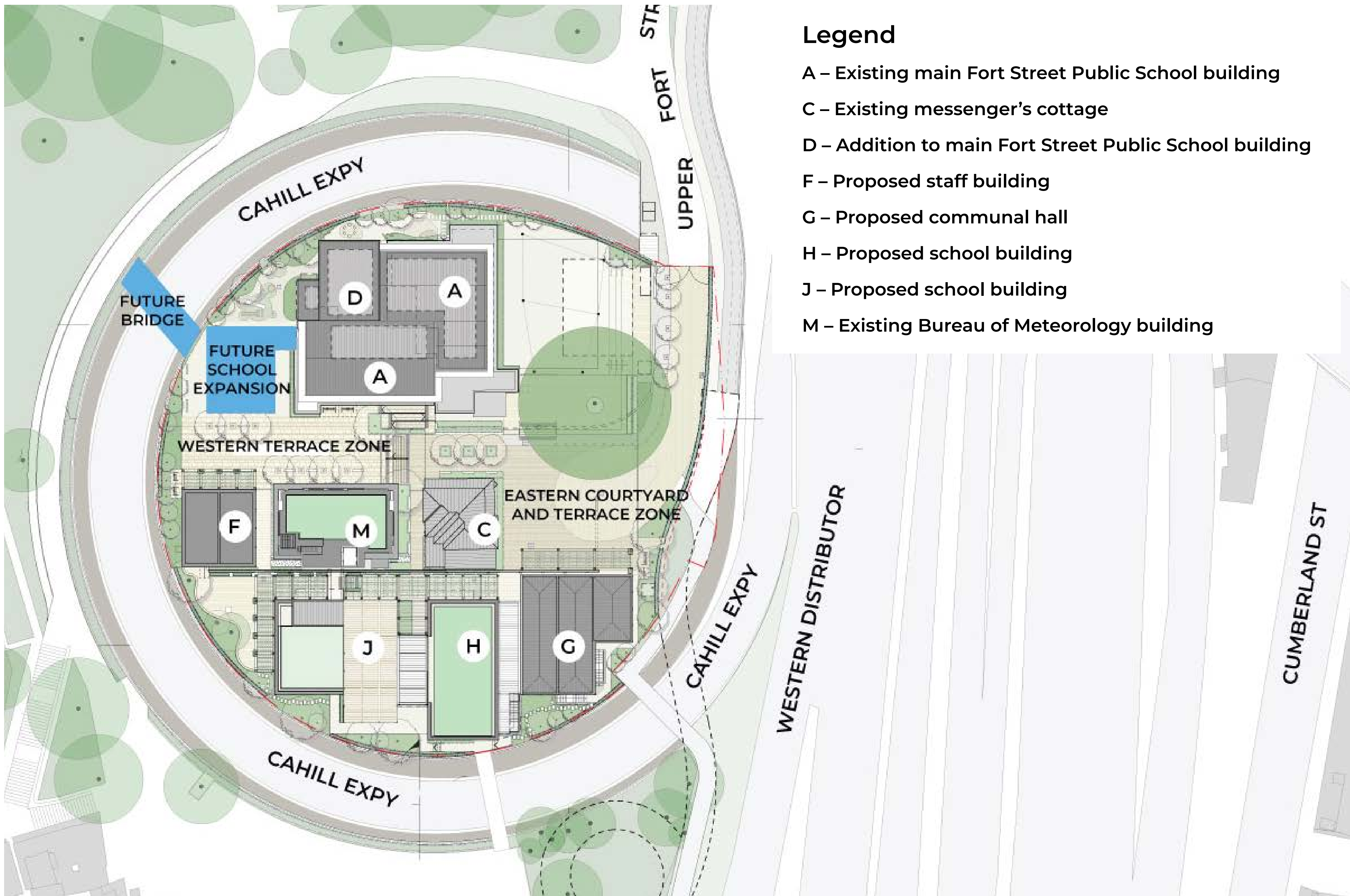

## Fort Street Public School upgrade

For more information phone: 1300 482 651  
Email: [schoolinfrastructure@det.nsw.edu.au](mailto:schoolinfrastructure@det.nsw.edu.au)



# Functional relationships

This diagram shows each level of the proposed school and how they connect with each other.

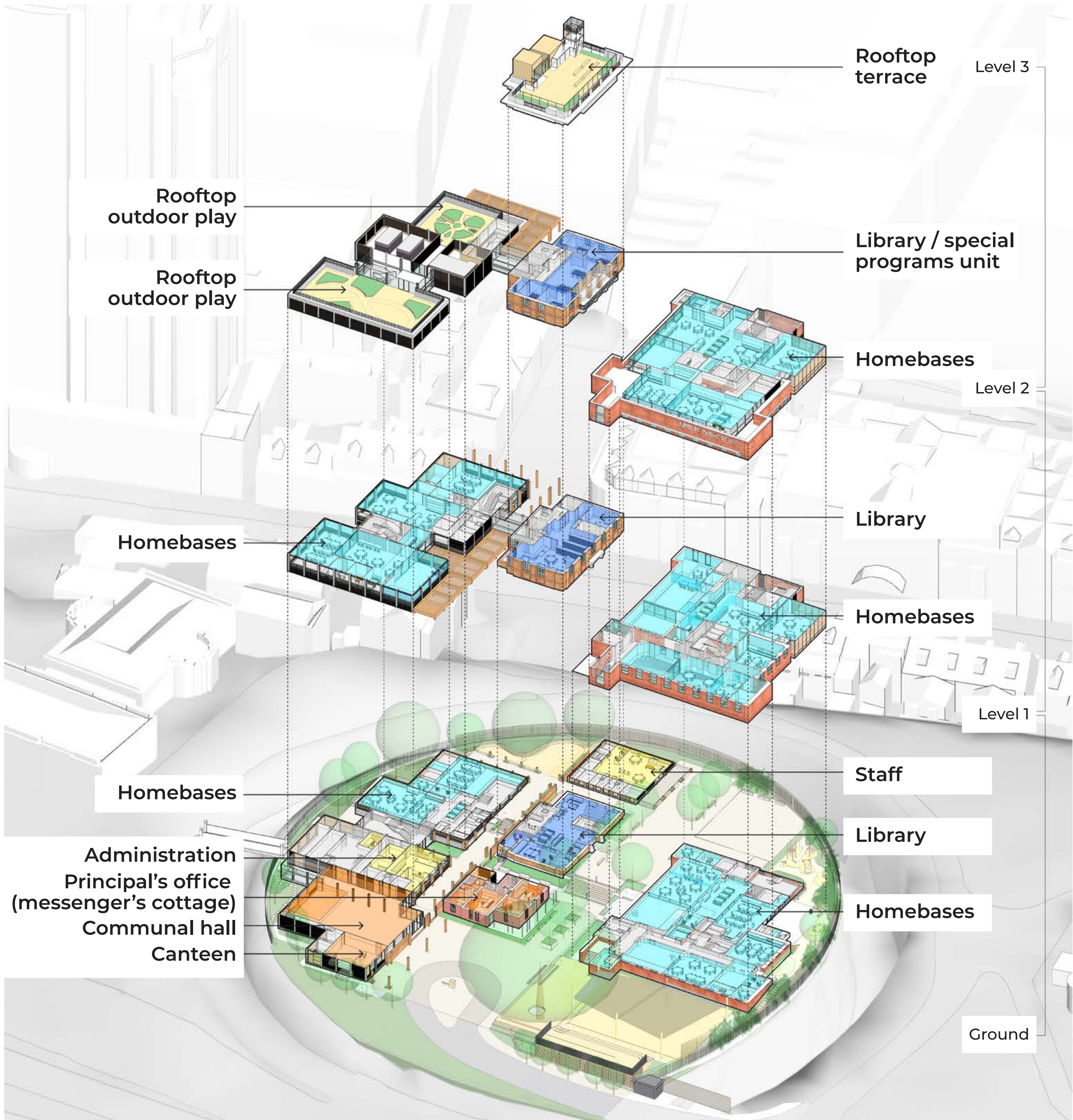

## Fort Street Public School upgrade

For more information phone: 1300 482 651  
Email: [schoolinfrastructure@det.nsw.edu.au](mailto:schoolinfrastructure@det.nsw.edu.au)



# Artist impressions

The images show different views of the existing and future school from three different viewpoints. We have provided a site map to show the viewpoint provided in each of these images.

## View from the National Trust (north view)

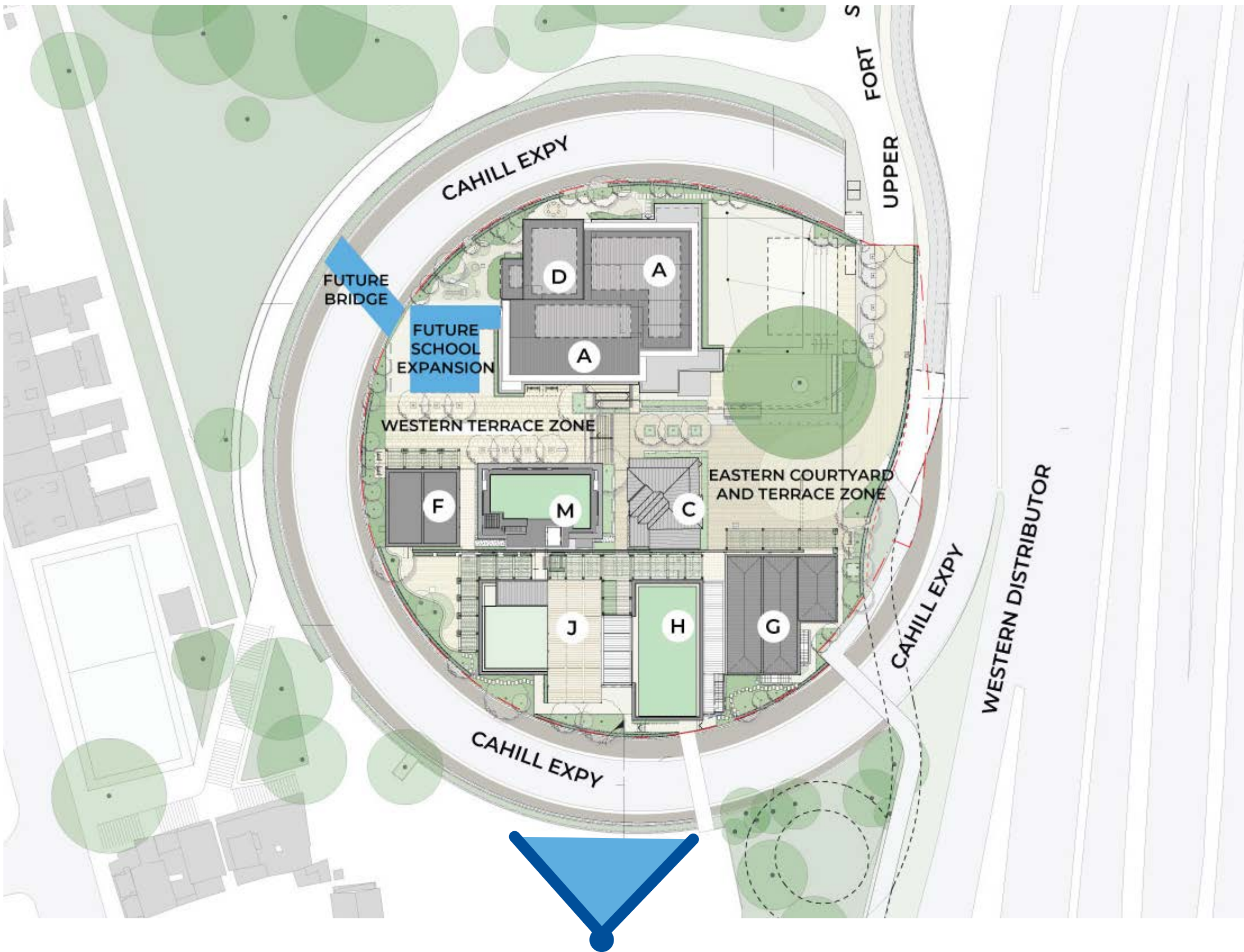

Map viewpoint

North view



Current view of school from the National Trust



View of upgraded school from the National Trust



# Artist impressions

View from Observatory Hill (south view)

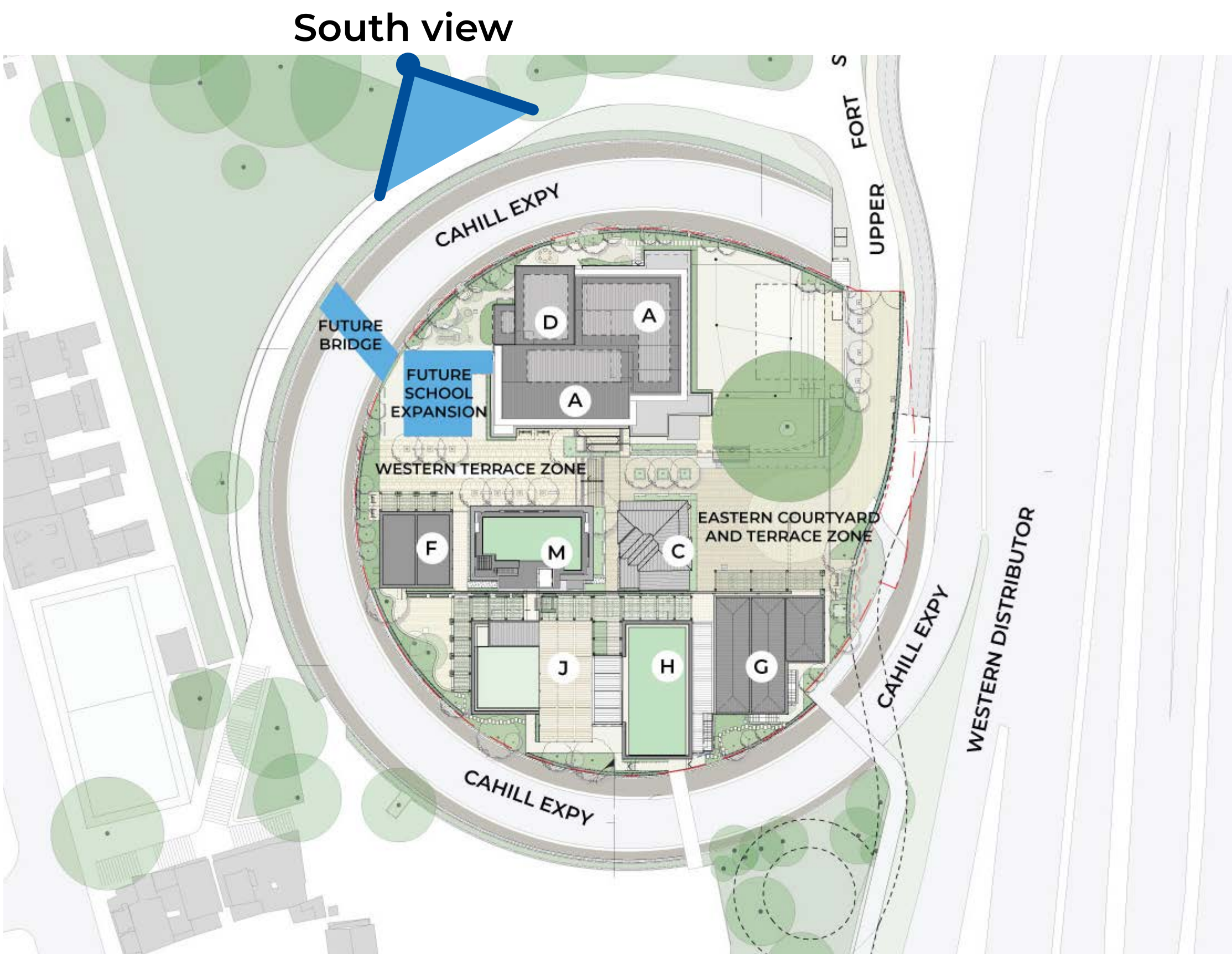

Map viewpoint



View of existing school from Observatory Hill



View of upgraded school from Observatory Hill



# Artist impressions

View from the Cahill Expressway,  
Harbour Bridge (west view)

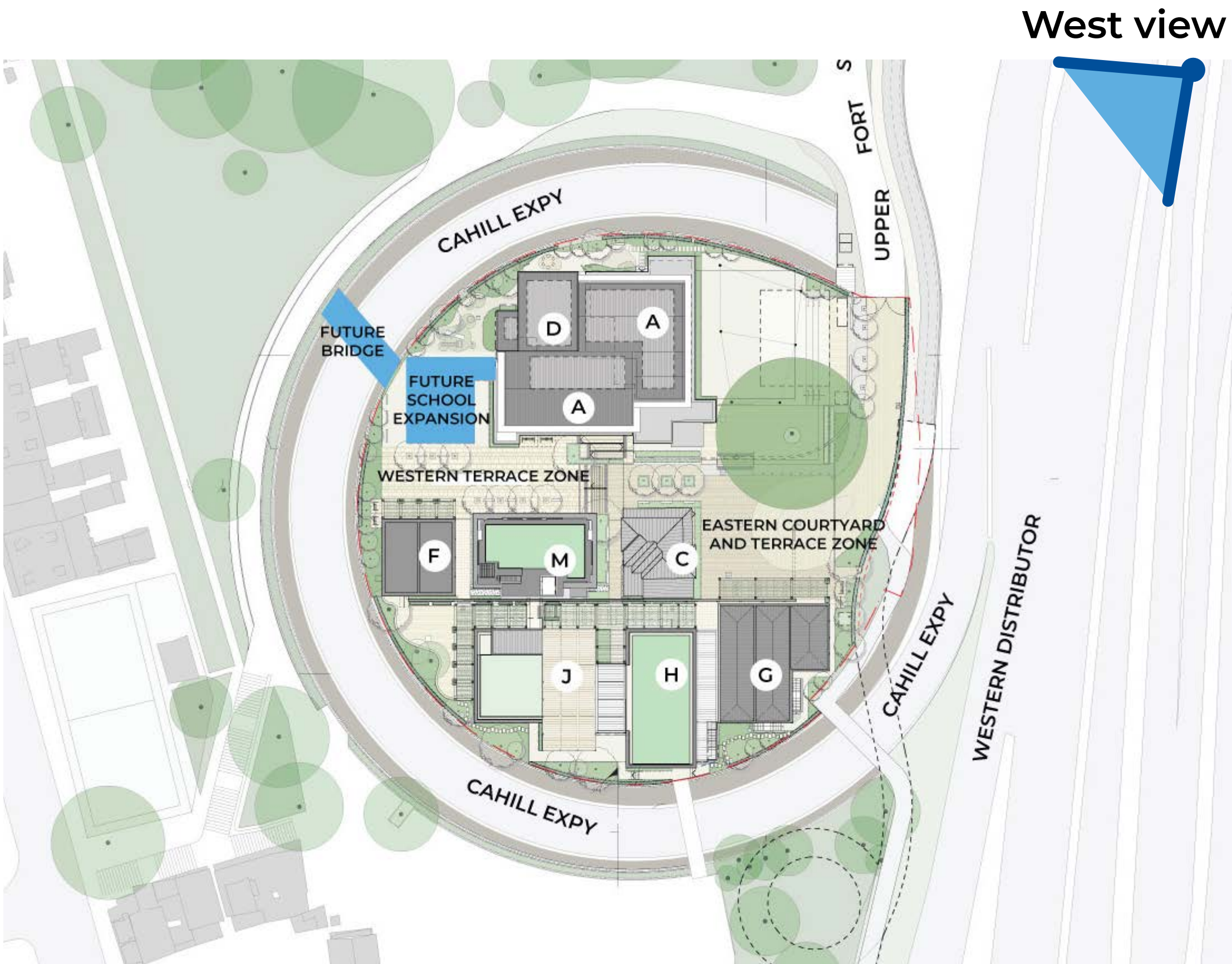

Map viewpoint



View of existing school from Cahill Expressway, Harbour Bridge



View of upgraded school from Cahill Expressway, Harbour Bridge



# Transport and access

To support a larger student population, we are proposing to make the following changes to vehicle and pedestrian connections to the school:

## Widening Upper Fort Street to remove pinch point

The section of Upper Fort Street near the entrance of the school currently only allows for one-way traffic. This can result in traffic congestion at busy times of the day. We are proposing to widen this section of the street to six metres, which will allow for two-way traffic and improve traffic flow.

## Drop-off/pick-up zone

We are proposing to modify the drop-off/pick-up zone on Upper Fort Street to allow for:

- up to 30 queued vehicles
- additional queueing area for 18 vehicles along Watson Road
- 15-minute free parking for parents and carers to park and access after school care (or at times when the pick-up line is not in operation).

At other times, the existing 2P and 4P parking controls will apply.

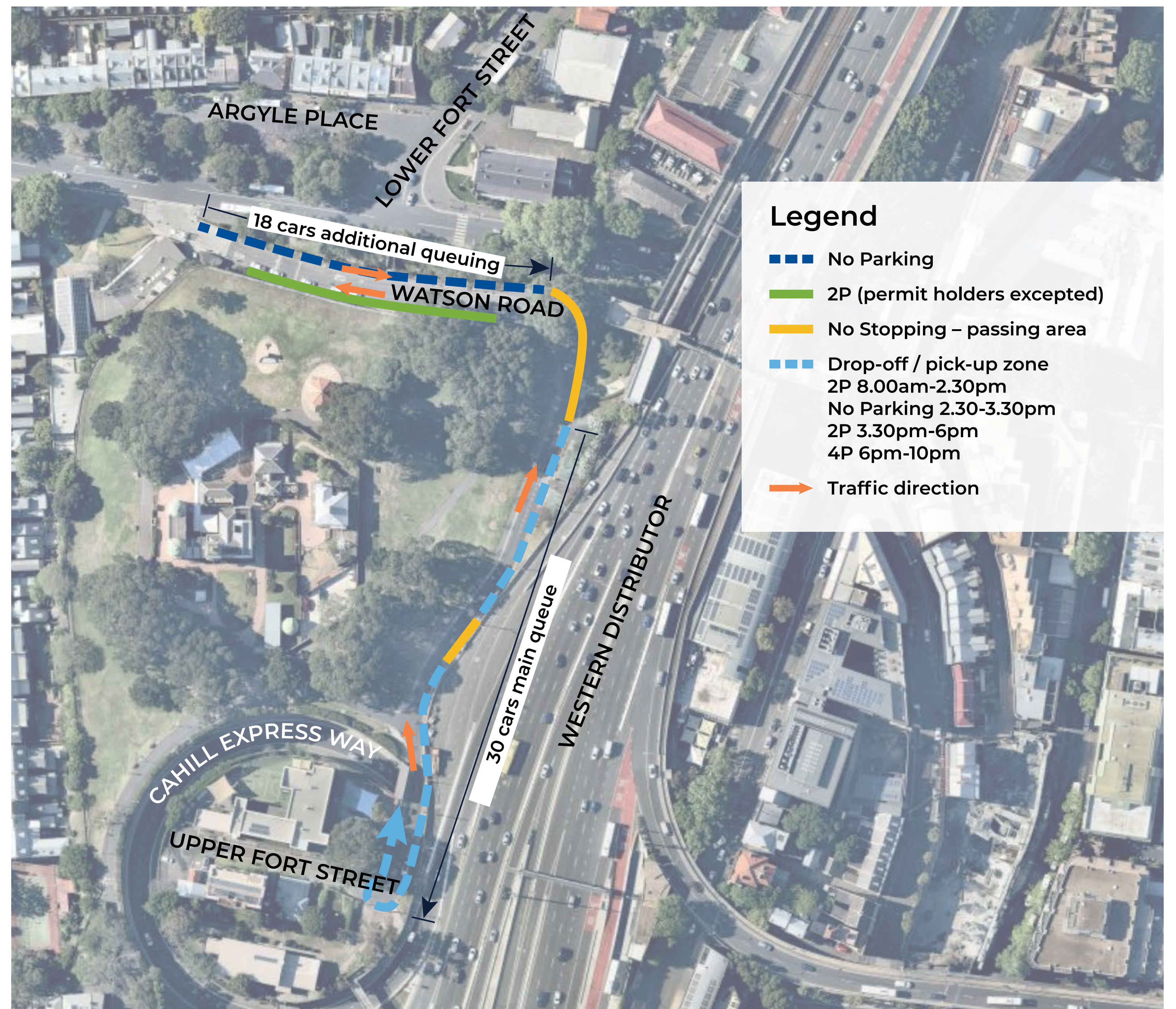

## Fort Street Public School upgrade

For more information phone: 1300 482 651  
Email: [schoolinfrastructure@det.nsw.edu.au](mailto:schoolinfrastructure@det.nsw.edu.au)



# Managing construction impacts

## Hours of work

The hours of work for the project are expected to be consistent with standard Sydney CBD construction working hours:

- Monday to Friday: 7:00am – 7:00pm
- Saturday: 7:00am – 5:00pm
- Sundays and public holidays: no works.

Out of hours work will be considered on a case-by-case basis and will need to be approved by the Department of Planning, Industry and Environment.

## Truck movements

We anticipate there will be up to 25 to 50 vehicles moving in and out of the site each day. We expect that truck movements will be focused on the western side of the site via Sussex Street and Kent Street.

## Temporary diversion of the cycleway

As the Sydney Harbour Bridge southern cycleway currently passes over the school site, we will need to reroute the cycleway during construction from Kent Street to the Sydney Harbour Bridge. The proposed cycleway detour is an on-road route



## Fort Street Public School upgrade

For more information phone: 1300 482 651  
Email: schoolinfrastructure@det.nsw.edu.au



# Feedback and contact information

## Find out more

You can find detailed information about the Fort Street Public School upgrade SSDA by going to the Department of Planning, Industry and Environment's website at: [planningportal.nsw.gov.au/major-projects/project/13596](https://planningportal.nsw.gov.au/major-projects/project/13596)

## Providing feedback on the SSDA

The SSDA is on public exhibition until 30 April 2020. To provide feedback on the SSDA for the Fort Street Public School upgrade, please go to: [planningportal.nsw.gov.au/major-projects/project/13596](https://planningportal.nsw.gov.au/major-projects/project/13596)

## Talk to the project team

You can speak with someone from the School Infrastructure NSW project team about the proposed Fort Street Public School upgrade at:  
Phone: 1300 482 651  
Email: [schoolinfrastructure@det.nsw.edu.au](mailto:schoolinfrastructure@det.nsw.edu.au)



Example of an innovative learning space we are delivering for students in NSW