

Epping West Public School upgrade

Works notification

12 October 2021

A project is underway to upgrade Epping West Public School. The project will deliver new classrooms and an administration facility, refurbishment and renovation work to existing buildings and removal of temporary classroom facilities.

Early works, including site establishment and demolition of Building G, began in September 2021 and are progressing well.

Epping West Public School upgrade – main works starting

Main works construction is starting for the Epping West Public School upgrade from Wednesday 20 October 2021.

The first milestone for main works will be the construction of Building S. Building S is located to the south-west of the school site near Ward Street.

The map overleaf shows the location of Building S and the school access gates.

- Gate 1 - Carlingford Road is the main access for students, the pedestrian overbridge from Ryde Street remains in use.
- Gate 2 – Currently non-operational.
- Gate 3 – The Kiss and Drop from Ward Street remains functional.
- Gate 4 - The left hand gate is for access for OOSH.

There will be no construction traffic during drop-off and pick-up times for Epping West Public School.

Working hours

Work will take place between the following times:

- Monday to Friday, 7am to 6pm and Saturdays, 8am to 1pm.

Frequently asked questions

How will dust and noise be managed during construction?

Any activity that could exceed approved construction noise management levels will be managed in accordance with the Protection of the Environment Operations Act 1997. Noise will be kept to a minimum as best as possible during the construction, and dust as a result of demolition and excavation, will be hosed as required. Trucks making deliveries to the site will have their loads covered. The site will undergo air monitoring during inground works and noise and dust will be appropriately managed throughout construction in accordance with the State Significant Development application consent conditions.

How will site remediation be managed during construction?

For more information contact:

School Infrastructure NSW
Email: schoolinfrastructure@det.nsw.edu.au
Phone: 1300 482 651
www.schoolinfrastructure.nsw.gov.au

The site will be safely remediated in accordance with the Department of Education's Management Plans and Safe Work NSW regulations. This work may involve removal of materials, or the safe covering of the ground with specialist methods in accordance with the Remediation Action Plan.

The work will be completed by licenced remediation experts and would be monitored in strict accordance with all applicable legislation, regulations, policies and guidelines.

The contractor is responsible for monitoring and ensuring all guidelines are being adhered to, working closely with School Infrastructure NSW.

Health and safety during construction

All work will be undertaken in accordance with SafeWork NSW regulations. All construction impacts will be controlled in accordance with the relevant management plans. The health and safety of the school and community are our highest priority.

If you have any concerns about this project, you can contact School Infrastructure NSW during business hours on 1300 482 651. In an emergency, call triple zero (000). We are here to make sure that work is completed safely and efficiently and we will minimise impacts on the community at every opportunity.

Thank you for your patience while we deliver this important school infrastructure.

如果需要这则信息的译本，请打电话 131 450 给笔译与口译服务处（TIS），请他们打电话 1300 482 651 给 Department of Education - School Infrastructure NSW（新州教育部中小学基础设施处）。

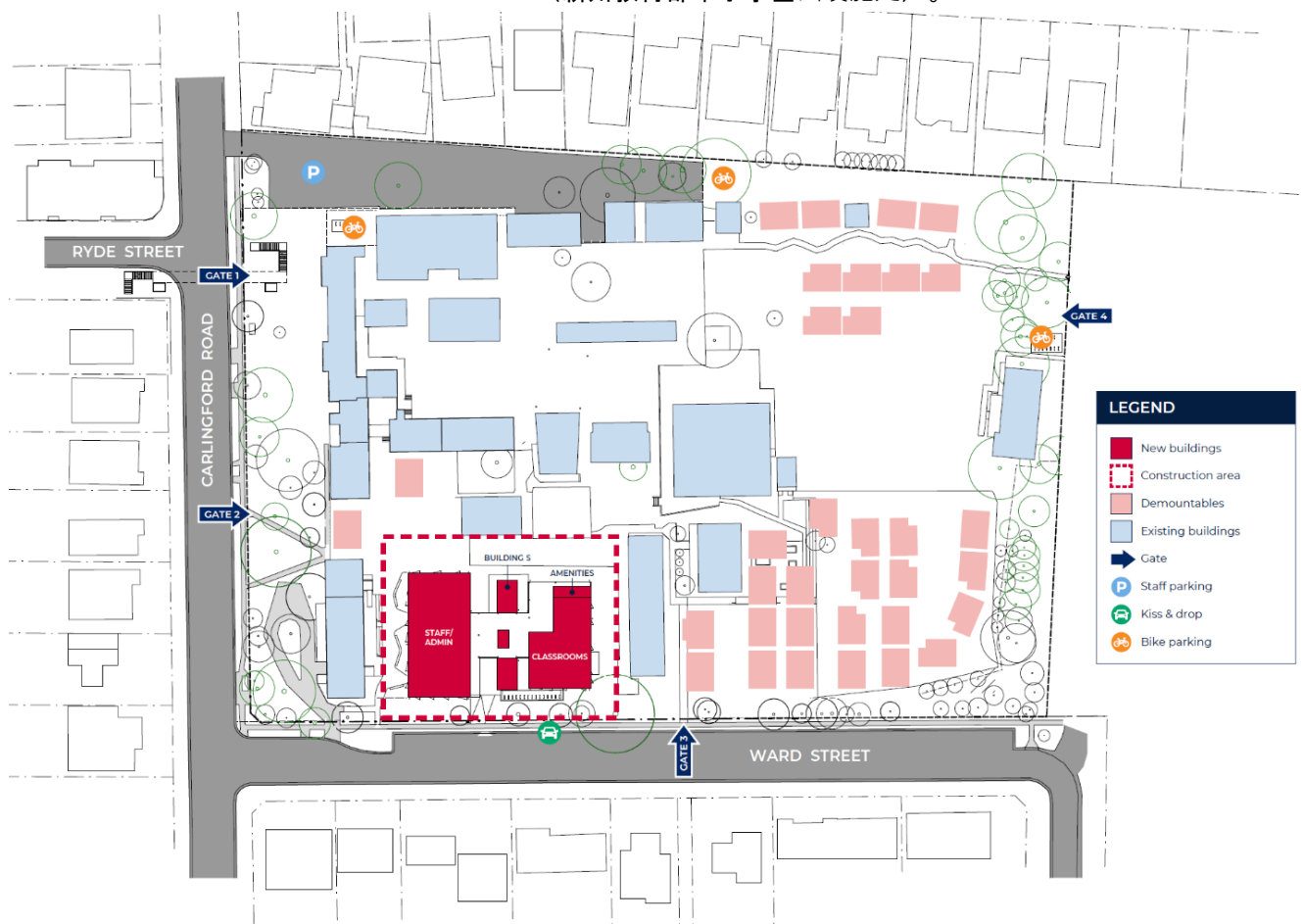

For more information contact:

School Infrastructure NSW
Email: schoolinfrastructure@det.nsw.edu.au
Phone: 1300 482 651
www.schoolinfrastructure.nsw.gov.au