

# Epping West Public School

Information pack | May 2021



Artist impression of Epping West Public School

The NSW Government is investing \$7 billion over the next four years, continuing its program to deliver more than 200 new and upgraded schools to support communities across NSW. This is the largest investment in public education infrastructure in the history of NSW.

The NSW Department of Education is committed to delivering new and upgraded schools for communities across NSW. The delivery of these important projects is essential to the future learning needs of our students and supports growth in the local economy.

We are in the process of designing an upgrade to Epping West Public School to provide upgraded facilities for the school community. The project will deliver



Construction of new buildings which will include new classrooms and administration facility



Refurbishment and renovation work to existing buildings



Removal of temporary classroom facilities

# Progress summary

We are in the process of designing an upgrade to Epping West Public School to provide upgraded facilities for the school community.

The project has received approval to proceed and the master planning and concept design phases are now complete. A contract has been awarded to Hansen Yuncken to develop the design for the State Significant Development (SSD) application. Throughout the project design phases, feedback has been sought from representatives from the school and incorporated, where appropriate, into the design.

Site investigations have been completed to inform the development of the schematic design. The project team are working closely with the school, community members and the City of Parramatta Council to discuss development impacts and proposed mitigation measures, especially with regards to traffic.

The Secretary’s Environmental Assessment Requirement (SEARs) has been received.

# Next steps

The Environmental Impact Assessment (EIS) has been prepared and the State Significant Development Application (SSDA) has been lodged and is waiting for approval.

You can find detailed information about the SSD application by going to the DPIE's website: [www.planningportal.nsw.gov.au/major-projects/project/40061](http://www.planningportal.nsw.gov.au/major-projects/project/40061). Make a formal submission by following the 'Make a Submission' link at: [www.planningportal.nsw.gov.au/major-projects/project/40061](http://www.planningportal.nsw.gov.au/major-projects/project/40061). All feedback on the SSD should be directed to DPIE via this link.

# Frequently asked questions

## What does the project involve?

As part of the project, we are upgrading Epping West Public School. It is proposed to deliver new flexible learning spaces and expanded staff and administration areas. The upgrade will include:

- Replacing 26 existing temporary classrooms with permanent learning spaces
- Construction of two new school buildings to accommodate classrooms and new administration facilities to Ward Street.

- Refurbishment of parts of Building A to accommodate two classrooms and two Special Programs rooms
- Adding an additional classroom to Building H

## What is a State Significant Development Application?

State Significant Development (SSD) applications are used for projects that have special significance to the people and State of NSW. The Department of Planning, Industry and Environment (DPIE) is responsible for the planning approval process for SSD applications, rather than a local council. The SSD application for alterations and additions to Epping West Public School has now been lodged and is available for comment. Follow the 'Make a Submission' link at: [www.planningportal.nsw.gov.au/major-projects/project/40061](http://www.planningportal.nsw.gov.au/major-projects/project/40061)

## How have the school community been involved in the project so far?

A Project Reference Group (PRG) has been operating since the project’s early planning phase; a project governance group made up of the project team, school representatives including the Principal, and a parent member representing the community. The PRG provides key information from an operational, educational, change and logistics perspective into the planning through the design phase of the project.

The school community will be supporting the project with the removal of an old toilet block. This will enhance the new courtyard being created as part of the construction and refurbishment of the new buildings.

## What is the approach being used to build the school?

For this project, we will be combining the manufacture of building components, such as wall systems and facades, in a safe, clean and efficient factory environment off-site with onsite assembly. The parts will be transported to the school site on trucks and then assembled into place. This approach has the potential to deliver significant safety and sustainability outcomes and drive productivity and quality efficiencies that can benefit Government, industry and communities.

## What are the benefits of using this approach?

### 1. Minimises impact on schools

When compared to traditional construction methods, this approach creates less noise, less traffic, less pollution and less dust which results in less impact to the operation of schools.

### 2. Improved health, safety and productivity

This approach uses off-site manufacturing to deliver building components and modules to site. This means safer workplaces for manufacturing and onsite construction teams.

### 3. Time savings

This approach can reduce on-site construction assembly time by up to 30 per cent which benefits everyone; industry, community and existing school operations.

### 4. Upskill the workforce

Demand for new jobs in manufacturing including production line management, technical skills training, logistics management, digital systems and quality assurance are created.

### 5. Improved sustainability

As a consequence of manufacturing precision being applied to construction, this approach can reduce carbon emissions, water and material waste by more than 30%.

### 6. Opportunity to reduce cost

Over time, as the industry becomes more familiar with using modern methods of construction, school designs will reduce project costs and improve quality.

## How will the project be sustainable?

We acknowledge the important part that sustainability has in the construction and lifecycle of new schools and facilities. We will be targeting 4 Star Green Star accreditation for this project which is a Green Building Council of Australia certification that rates how sustainable a facility is.

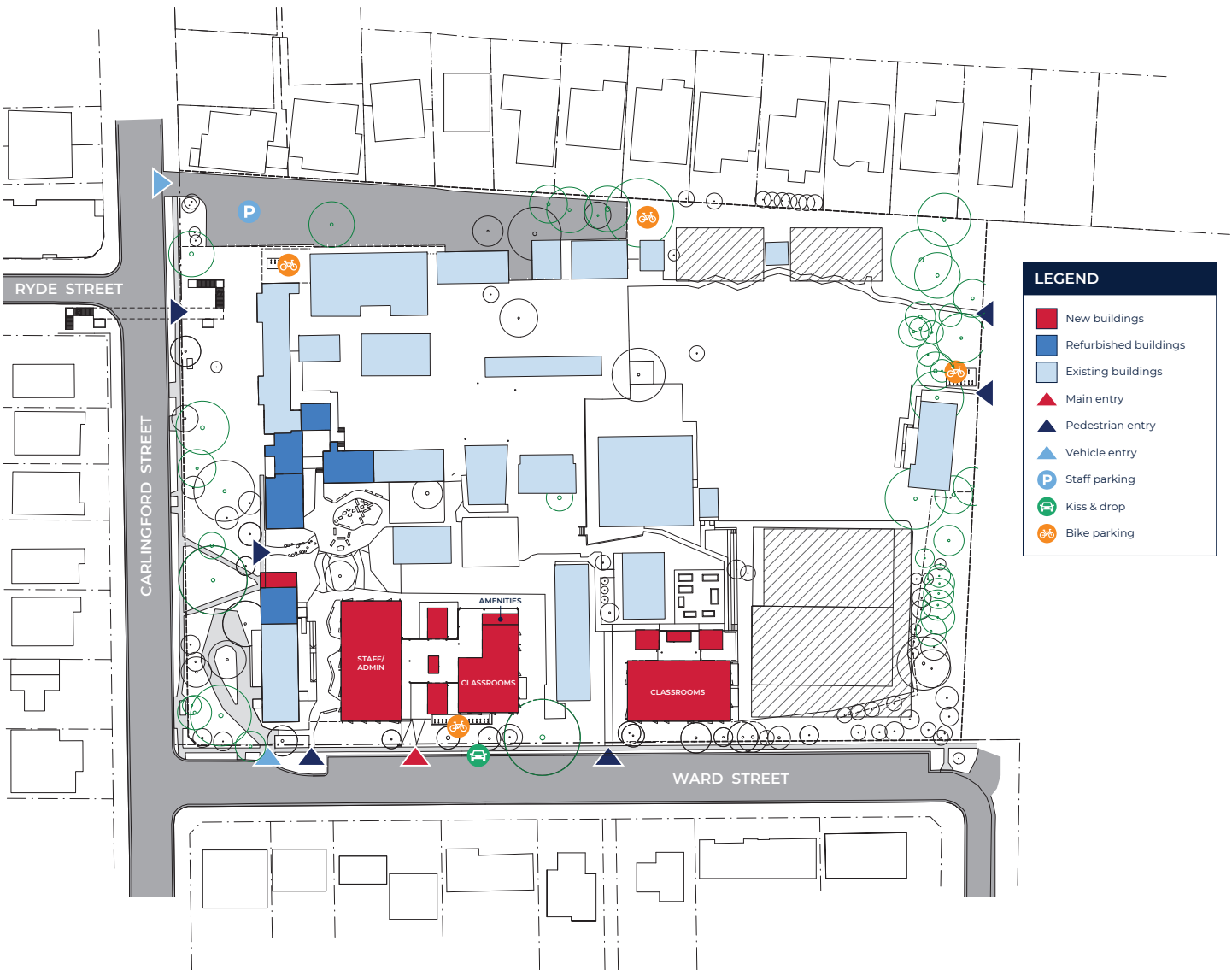

Proposed site plan for Epping West Public School upgrade





Artist impression of Epping West Public School upgrade

## Frequently asked questions (continued)

### Will there be a new catchment boundary for community members in Epping?

The catchment boundary will be defined in close consultation with the educational leadership team and will be communicated once this has been finalised.

### When will construction start?

Pending approval of the SSD application, construction is anticipated to start in late 2021. Construction will be undertaken in stages.

### How will the community be kept safe during construction?

The safety of the school and the local community is our highest priority. Construction planning will be designed so there is minimal impact on school operations. Safety measures will be in place to separate the construction site from areas occupied by the school and ensure students are unable to enter construction areas. Throughout the entire construction period rigorous safety and security measures will be put in place. There will be regular consultation with the school to discuss construction progress.

## How do I get involved?

We are committed to working together with our school communities and other stakeholders to deliver the best possible learning facilities for students.

Your feedback on this project is important to us. For more information, questions or to make a comment please email us at [schoolinfrastructure@det.nsw.edu.au](mailto:schoolinfrastructure@det.nsw.edu.au) or phone 1300 482 651.

## Stay informed



### Website

Stay up to date by visiting the School Infrastructure NSW website [schoolinfrastructure.nsw.gov.au](https://schoolinfrastructure.nsw.gov.au)



### Email

Contact the Community Engagement team by emailing [schoolinfrastructure@det.nsw.edu.au](mailto:schoolinfrastructure@det.nsw.edu.au)



### Phone

Contact us between 9:00am and 5:00pm, Monday to Friday on **1300 482 651**