



Artist impression of the Eastwood Public School upgrade

# Eastwood Public School

Project update | August 2021

## Investing in our schools

The NSW Government is investing \$7.9 billion over the next four years, continuing its program to deliver 215 new and upgraded schools to support communities across NSW. This is the largest investment in public education infrastructure in the history of NSW. The NSW Department of Education is committed to delivering new and upgraded schools for communities across NSW. The delivery of these important projects is essential to the future learning needs of our students and supports growth in the local economy.

## Project overview

A project is underway to upgrade Eastwood Public School. The project will deliver;

- a new building with nine new permanent flexible learning spaces
- a new toilet block to replace an existing amenity block, and
- remove nine temporary classrooms.

## Progress summary

A project reference group (PRG) has been established which includes members of the school leadership, project team and a P&C representative. The PRG will meet regularly to provide guidance throughout the delivery of the project.

Four temporary classrooms have been removed to make way for the construction of the new building. Two of these have been relocated to another area of the school and will be removed once construction is complete.

The construction contract has been awarded to Lloyd Group, who will now work closely with the project team to complete the design and deliver the project.

## Next steps

Site establishment works will start from mid-September, subject to NSW government COVID-19 restrictions and in line with NSW Government guidelines. These will include;

- installing temporary fencing and hoarding (shade cloth) around the perimeter of construction site
- installing work sheds, toilets and meeting rooms
- establishing erosion and sediment controls.

## For more information contact:

School Infrastructure NSW

Email: [schoolinfrastructure@det.nsw.edu.au](mailto:schoolinfrastructure@det.nsw.edu.au)

Phone: 1300 482 651

[www.schoolinfrastructure.nsw.gov.au](http://www.schoolinfrastructure.nsw.gov.au)

### **What is being built at Eastwood Public School?**

We are upgrading Eastwood Public School to replace nine demountable classrooms and a new toilet block. The new building will house nine flexible learning spaces which will cater for the growing population of the school community and increase overall open spaces.

### **How will the construction site be accessed?**

The construction site will be accessed via a temporary gate on Rutledge Street. Separate access from the school will ensure that all deliveries, machinery and personnel movement have minimal impact to students and teachers.

### **What are the construction hours and what are the impacts from noise and dust?**

Construction hours will be between 7 am to 7 pm Monday to Friday, and on Saturdays from 7 am till 4 pm. There will be no construction on Sundays or Public Holidays. Noise and dust control measures will be implemented in accordance with planning approval requirements. Hoarding, secure fencing and shade cloth will be installed to reduce noise and dust impacts on the school and local residents. Dust from construction works will be hosed down as required.

### **Will trees be removed as part of the works?**

Yes, seven small trees will be removed to provide direct access to the construction site. A qualified arborist has identified these trees to be of low landscape value and endorsed their removal as part of the project's landscaping plan. The trees will be removed by a qualified arborist in accordance with NSW work health and safety regulations.

The project's landscaping plan has been developed, which includes replacing removed trees with seven higher density trees identified by the arborist to be better suited for a school environment. In addition, dense fast-growing screen shrubs will be planted along the fence to maintain privacy for neighbours and students, all other existing trees will be protected with screens and monitored by the project's arborist.

We will continue to work with the project's arborist and Ryde City Council to ensure that the local ecology, wellbeing of students and neighbours is at the centre of building the new facilities.

### **What was the planning approval process?**

A Development Application (DA) was submitted to Ryde City Council in October 2020, the application was thoroughly reviewed and approved in July 2021. The approval considers feedback gathered throughout the DA exhibition stage and plans adapted to ensure the privacy of neighbours is adhered to.

### **When will construction be finished?**

The project is expected to be finished by late 2022, depending on site and weather conditions.

### **How can I keep informed?**

We will share regular updates via the school's newsletter, P & C meetings and Schoolzine App. All information about the project can be found in the School Infrastructure NSW website for Eastwood Public School under the tab titled 'Library' or the webpage below. The webpage will be updated regularly.

[www.schoolinfrastructure.nsw.gov.au/projects/e/eastwood-public-school-upgrade.html](http://www.schoolinfrastructure.nsw.gov.au/projects/e/eastwood-public-school-upgrade.html)

### **For more information contact:**

School Infrastructure NSW  
Email: [schoolinfrastructure@det.nsw.edu.au](mailto:schoolinfrastructure@det.nsw.edu.au)  
Phone: 1300 482 651  
[www.schoolinfrastructure.nsw.gov.au](http://www.schoolinfrastructure.nsw.gov.au)

## Site map

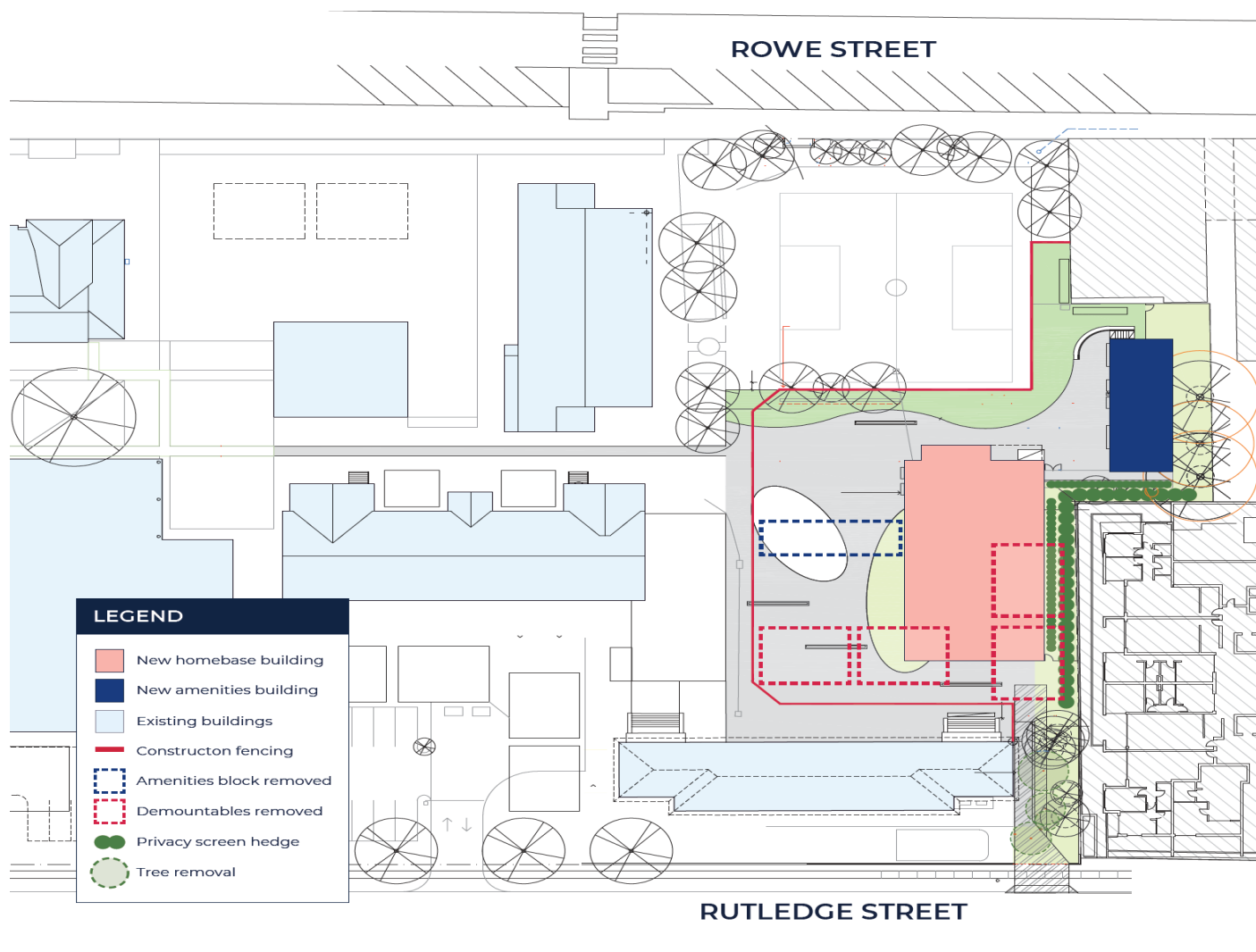

To request this information in your language please call Translating and Interpreting Services (TIS) on 131 450 and ask them to call the Department of Education – School Infrastructure NSW on 1300 482 651.

如果需要这则信息的译本，请打电话131 450给笔译与口译服务处（TIS），请他们打电话1300 482 651给Department of Education - School Infrastructure NSW（新州教育部中小学基础设施处）。

한국어로 이 정보를 요청하시려면 통번역 서비스 (TIS)에 131 450으로 연락하셔서 Department of Education – School Infrastructure NSW (교육부 – NSW 스쿨 기반시설)에 1300 482 651로 전화하도록 요청하십시오.

*At the NSW Department of Education, we recognise the traditional custodians of the lands and waterways where we work and live. We celebrate the First Peoples' unique cultural and spiritual relationship to Country and acknowledge the significance of Aboriginal cultures in Australia.*

### For more information contact:

School Infrastructure NSW  
Email: [schoolinfrastructure@det.nsw.edu.au](mailto:schoolinfrastructure@det.nsw.edu.au)  
Phone: 1300 482 651  
[www.schoolinfrastructure.nsw.gov.au](http://www.schoolinfrastructure.nsw.gov.au)