

Darlington Public School

Project update

October 2019



Artist's impression of the Darlington Public School

The NSW Government is investing \$6.7 billion over the next four years to deliver 190 new and upgraded schools to support communities across NSW. In addition, a record \$1.3 billion is being spent on school maintenance over five years. This is the largest investment in public education infrastructure in the history of NSW.



permanent, innovative and flexible learning spaces and pre-school



student facilities, including canteen and OSHC



hall



administration and staff facilities



library



landscaped outdoor areas, including COLA

Existing site plan



Proposed aerial view of site plan



Proposed site plan



Proposed functional usage

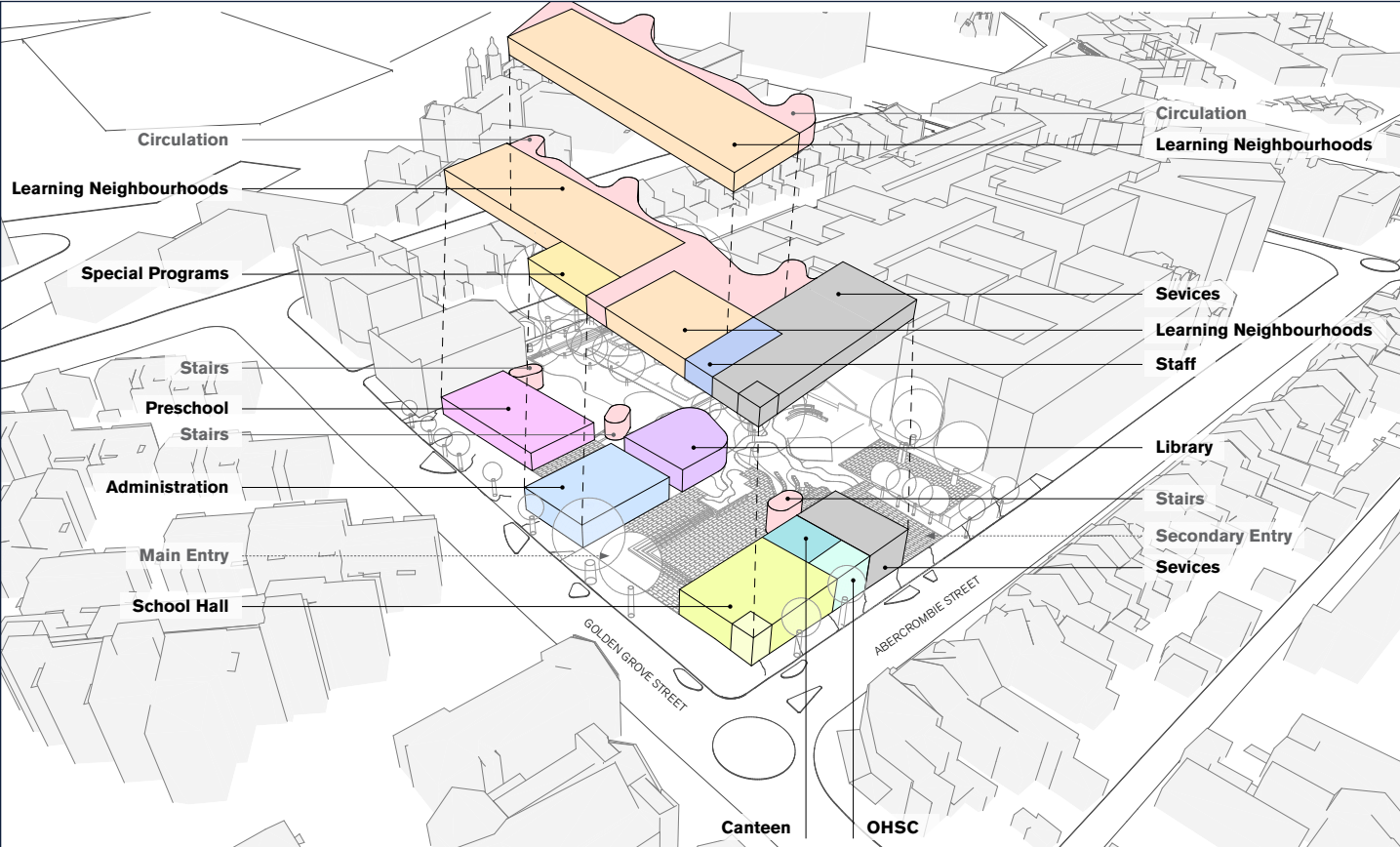

Indicative project timeline

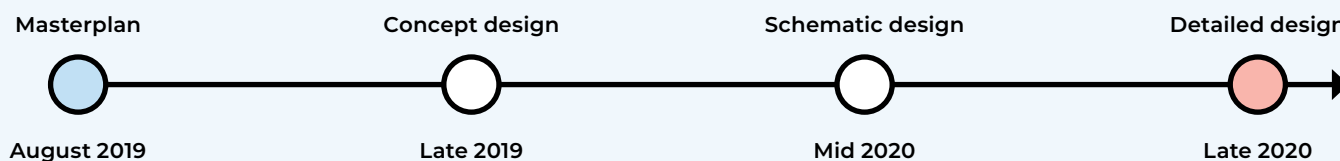

Progress summary

Darlington Public School is being upgraded to deliver new and upgraded facilities, innovative learning spaces, and provide for growing student enrolments in the area.

After a recent design review, the project is currently in the masterplanning phase. In August 2019 concept masterplan options were presented. Feedback received from parents, teachers, P&C members and the community was very positive with the community keen to see the project progress. The characteristics of the site and the broader Darlington area are being respectfully considered in the design process.

Next steps

Concept plans are expected to be completed in late 2019 and will then progress towards detailed designs in 2020. At this stage, it is too early to determine how the school's operations will be maintained during the construction period. A range of on-site and off-site options will be considered in close consultation with the Principal. The health, safety, and well-being of the students, teachers and staff is our highest priority.

How can I get involved?

Your feedback is important to us. We are committed to working together with our school communities and stakeholders to deliver the best possible learning facilities for students.

It is not always possible to implement everyone's suggestions but we will work with school communities to ensure we have considered what is important to you.

We will keep the local school community and residents informed with project update newsletters, information booths and website updates.

Stay informed



Website

Stay up to date by visiting the School Infrastructure NSW website schoolinfrastructure.nsw.gov.au



Email

Contact the Community Engagement team by emailing schoolinfrastructure@det.nsw.edu.au



Phone

Contact us between 9am–5pm, Monday to Friday on **1300 482 651**