



Artist impression of the Darlington Public School upgrade

# Darlington Public School

Project update

September 2022

## Investing in our schools

The NSW Government is investing \$8.6 billion in school infrastructure over the next four years, continuing its program to deliver 160 new and upgraded schools to support communities across NSW. This builds on the more than \$9.1 billion invested in projects delivered since 2017, a program of \$17.7 billion in public education infrastructure.

The NSW Department of Education is committed to delivering new and upgraded schools for communities across NSW. The delivery of these important projects is essential to the future learning needs of our students and supports growth in the local economy.

## Project overview

Darlington Public School is being upgraded to deliver new facilities and provide for growing student enrolments in the area.

## Progress summary

Stage 1 of the Darlington Public School upgrade was finished in May 2022. The school has been using the new facilities including:

- 9 new teaching and learning spaces
- 3 preschool classrooms
- a new library.

Stage 2 of the project started in May 2022, with the demolition of the existing school building. Demolition has recently finished and the site sheds have been relocated. The on-site stormwater tanks and the tower crane have been installed.

## For more information contact:

School Infrastructure NSW  
Email: [schoolinfrastructure@det.nsw.edu.au](mailto:schoolinfrastructure@det.nsw.edu.au)  
Phone: 1300 482 651  
[www.schoolinfrastructure.nsw.gov.au](http://www.schoolinfrastructure.nsw.gov.au)

Stage 2 will deliver:

- more new learning and teaching spaces
- a new hall and canteen
- covered outdoor learning areas (COLAs),
- landscaping and play areas
- new staff facilities.

See next page for a layout map of Stage 2.

### Next steps

This week we started the stormwater connection to the new school building. The local community has been notified and these works will be finished over the school holidays.

Over the next few months, other works will include installing the drainage and sewerage system and the cables that will carry electricity and internet services to and from the new building as well as construction of floor slabs and the walls of the new building.

Thank you for your patience while we deliver this important school infrastructure.

If you have any queries or concerns about this project you can contact School Infrastructure NSW during business hours on 1300 482 651.



Artistic render of the new hall at Darlington Public School

### For more information contact:

School Infrastructure NSW  
Email: [schoolinfrastructure@det.nsw.edu.au](mailto:schoolinfrastructure@det.nsw.edu.au)  
Phone: 1300 482 651  
[www.schoolinfrastructure.nsw.gov.au](http://www.schoolinfrastructure.nsw.gov.au)

# Stage 2

Ground Level

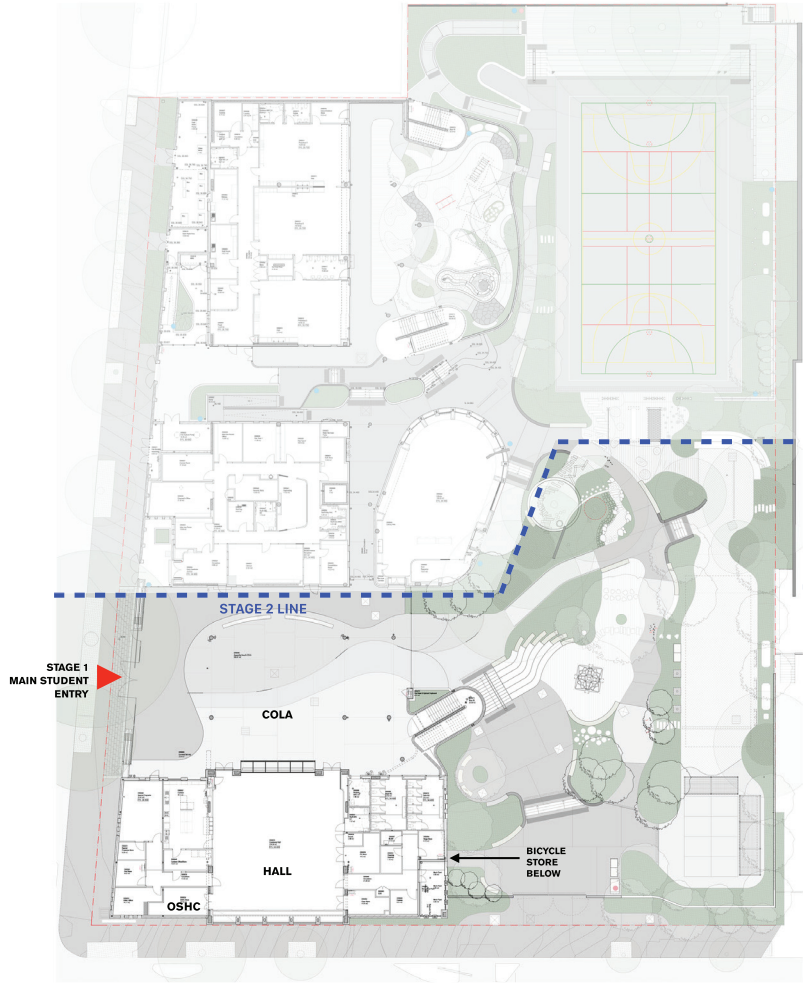

Level 1

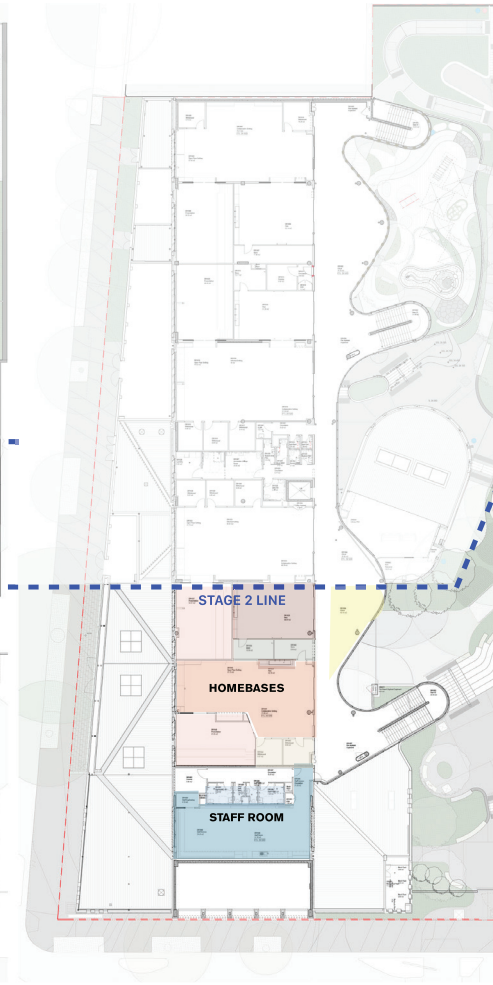

Level 2

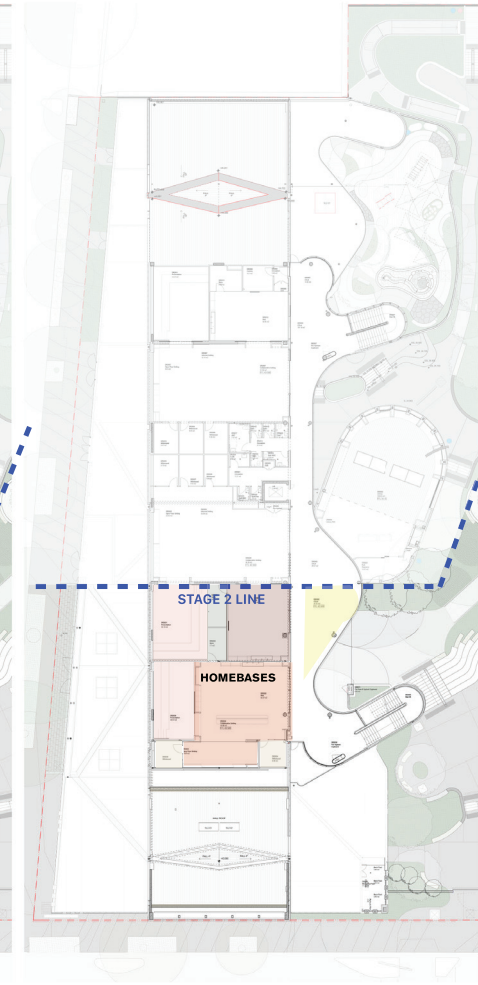

- Learning spaces  
-Collaborative Setting  
-Informal Setting  
-Open Floor Setting
- PAA (Practical Activities Area)
- Presentation
- Withdrawal Room
- Store Room
- COLA
- Student Amenities
- Staff Amenities

For more information contact:

School Infrastructure NSW  
 Email: [schoolinfrastructure@det.nsw.edu.au](mailto:schoolinfrastructure@det.nsw.edu.au)  
 Phone: 1300 482 651  
[www.schoolinfrastructure.nsw.gov.au](http://www.schoolinfrastructure.nsw.gov.au)

