

# Dalmeny Public School

Information Pack – November 2024



## Investing in our schools

As part of the NSW Government's plan to rebuild public education, the 2024-25 Budget is delivering record education funding, including \$3.6 billion for new and upgraded schools in Western Sydney. This targeted investment will ensure growing communities get access to a world class public education.



New two-story building will include  
16 classrooms



New amenities



Lift for accessibility



**1** classroom on the ground floor will be future proofed with amenities to enable it to be converted as support learning unit at a later stage



Removal of demountable classrooms



New covered walkway linking  
classrooms, library and  
administration block

### For more information

Phone: 1300 482 651

Email: [schoolinfrastructure@det.nsw.edu.au](mailto:schoolinfrastructure@det.nsw.edu.au)

Website: [schoolinfrastructure.nsw.gov.au](https://schoolinfrastructure.nsw.gov.au)



## Progress summary

We have developed an initial design for the new school building in consultation with school leadership. We will provide notification prior to this work beginning.

The project scope and design will continue to evolve during future design phases as feedback from specialists, stakeholders and the community is considered.

## Demountable classroom removal, staging plan

To prepare for construction, we will be removing 2 vacant demountable classrooms from the school. Further information will be provided on this in a future notification.

The maps below show the staged plan to remove all demountable buildings from the school. The first map shows the 2 demountable building being removed prior to construction and the second map shows the remainder of the demountable buildings to be removed upon completion of the project. The location of the new classroom building is shown in blue on the second map.

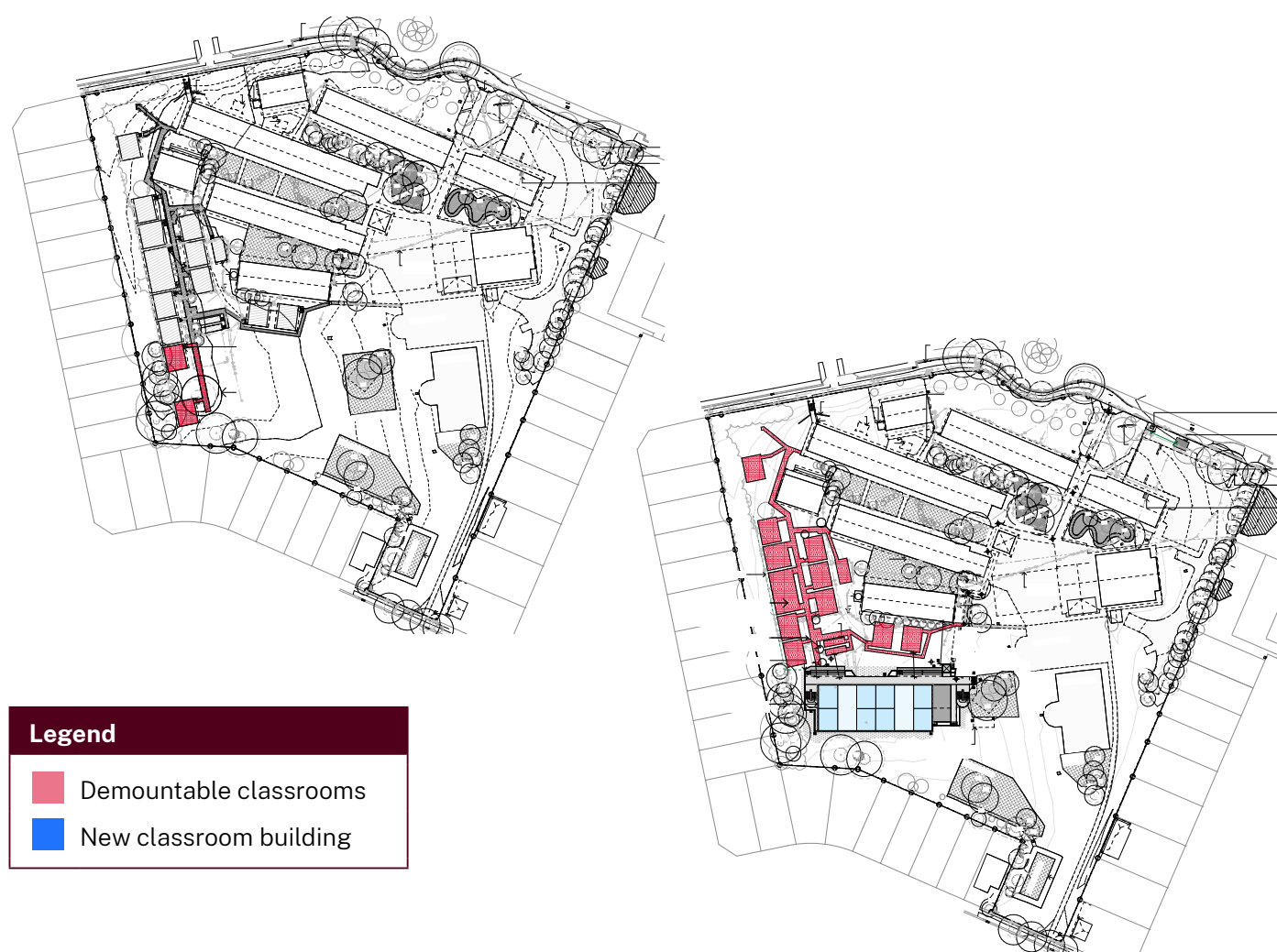



## Next steps

We will continue to work on the design for the new building. This will include consultation with school representatives to ensure classroom layouts support the specific teaching and learning requirements for Dalmeny Public School.



Front view of new building, indicative design only. Subject to change.



Rear view of new building, indicative design only. Subject to change.

## Indicative timeline for the project

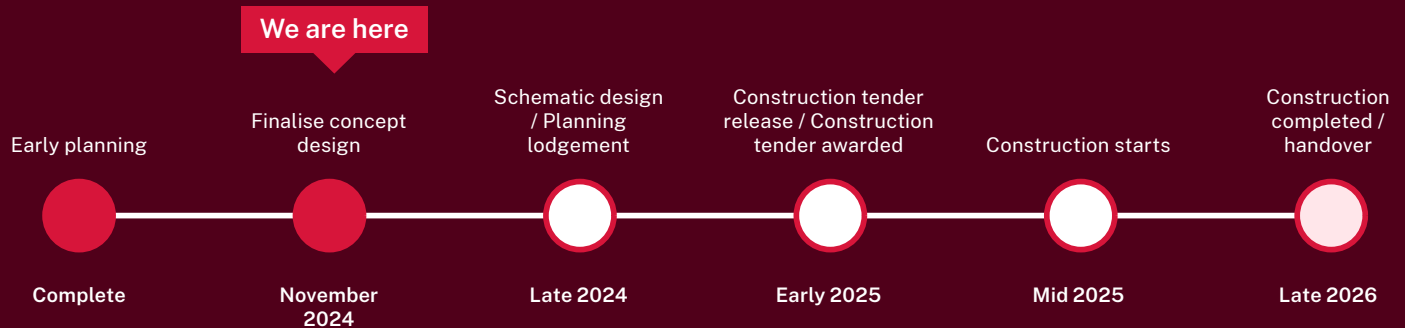

The community will be kept informed as the project progresses.

## Managing construction impacts



We will work with the contractor to manage impacts on the local community, and in close consultation with the Dalmeny Public School leadership to ensure that school operations continue with minimal disruption.

For more information about how we manage construction impacts on our projects, please visit [edu.nsw.link/ConstructionImpacts](https://edu.nsw.link/ConstructionImpacts) or scan the QR code.

## More information



You can find more information about the project at [edu.nsw.link/DalmenyPS](https://edu.nsw.link/DalmenyPS) or by scanning the QR code.

If you have any questions about this project, you can contact us during business hours on the contact details below.

For more information about this project, contact School Infrastructure:

**Website:** [schoolinfrastructure.nsw.gov.au](https://schoolinfrastructure.nsw.gov.au)

**Email:** [schoolinfrastructure@det.nsw.edu.au](mailto:schoolinfrastructure@det.nsw.edu.au)

**Phone:** Contact us between 9 am and 5 pm, Monday to Friday on 1300 482 651