



Artist impression of the Cronulla High School upgrade

Cronulla High School

Project update

November 2022

Investing in our schools

The NSW Government is investing \$8.6 billion in school infrastructure over the next four years, continuing its program to deliver 160 new and upgraded schools to support communities across NSW. This builds on the more than \$9.1 billion invested in projects delivered since 2017, a program of \$17.7 billion in public education infrastructure.

The NSW Department of Education is committed to delivering new and upgraded schools for communities across NSW. The delivery of these important projects is essential to the future learning needs of our students and supports growth in the local economy.

Project overview

A project is underway to upgrade Cronulla High School to meet enrolment growth.

The upgrade will deliver 10 new permanent learning spaces, a new canteen, new administration areas and upgraded student and staff amenities.

Progress summary

The design for the upgrade has been further developed in consultation with architects and a Project Reference Group (PRG). The PRG includes representatives from the Department of Education and Cronulla High School, P&C, architects, planners and design professionals.

In September 2022, the department invited the local Cronulla High School community to provide feedback on the proposed site plan. You can learn more about key findings from the survey below. The feedback was incorporated into the design.

The Cronulla High School upgrade will be delivered under a Review of Environmental Factors (REF), a planning assessment under the State Environmental Planning Policy (SEPP) for Transport and Infrastructure facilities. See below for more details.

A tender has been released to appoint a builder to undertake the construction work. Once the tender period closes, we will select a builder and share the results with the community.

For more information contact:

School Infrastructure NSW
Email: schoolinfrastructure@det.nsw.edu.au
Phone: 1300 482 651
www.schoolinfrastructure.nsw.gov.au

The statutory planning pathway process: Review of Environmental Factors

The Cronulla High School upgrade will be delivered under a Review of Environmental Factors (REF), a planning assessment under the State Environmental Planning Policy (SEPP) for Transport and Infrastructure facilities.

In 2017 the NSW Government introduced a new education-based State Environmental Planning Policy (SEPP) to make it easier to provide new and upgraded education facilities for communities. Under the SEPP minor development works can be carried out without development consent from council.

We are preparing the REF documentation, to determine whether there will be any impacts on the environment, in accordance with the provisions of Part 5 of the Environmental Planning and Assessment Act 1979 (EP&A Act), and the environmental considerations outlined in clause 228 of the Environmental Planning and Assessment Act Regulations 2000.

The works under the REF application include:

- Demolition of the existing Building B canteen and toilet amenities located on the eastern side of the school
- Construction of a new building (Building M) to accommodate a new canteen, toilet amenities and 6 new teaching spaces
- Construction of a new building (Building L) to accommodate administration facilities and 4 new teaching spaces
- Reconfiguration and refurbishment of the existing staff car park.
- Relocation of a shade structure from the existing Building B to now be adjacent to Building D
- Installation of new landscaping in the front forecourt and the main school entrance.

Under the REF, SINSW is required to provide 21 days notification to adjoining properties and relevant agencies with information about our intention to undertake the development works, and to take into consideration any comments they may have on the proposal.

The REF documentation will be published on the SINSW project webpage once it is approved.

Development applications for tree removal and potential remediation works

We are proposing to remove some trees as part of the project and to remediate potential in-ground contamination in the proximity of the new Building L. These works require separate development applications (DA) to be lodged with the Sutherland Shire Council. When lodged, these DAs will be published on the Sutherland Shire Council's planning portal for the community to view and comment during public exhibition period/s.

The landscape design strategy of the project is to retain as many of the existing trees as possible, increase the urban tree canopy cover across the site and integrate harmoniously with the natural topography. A landscape plan is being developed for the project and will include planting approximately 50 trees of species that are local to the Sutherland Shire area.

These 50 trees will replace the 26 trees we are planning to remove as part of the project to accommodate new facilities (buildings L and M and electrical substation) and demountable movements on site to maintain school operations during construction. Of these 26 removed, 21 are native, and 10 are mature.

Community survey

We held a community survey between Monday 5 September and Friday 16 September 2022. It was advertised to the school community and local neighbours through a project update, and was available to access via the project webpage.

We received 25 survey responses and 3 email submissions whilst the survey was open. Thank you to everyone who provided their feedback.

For more information contact:

School Infrastructure NSW
Email: schoolinfrastructure@det.nsw.edu.au
Phone: 1300 482 651
www.schoolinfrastructure.nsw.gov.au

You said



Accessibility and sustainability are two of the most important areas for an upgrade to consider.



There is interest in shared spaces for the school and local community members to congregate in, outside of general learning spaces.



More car parking would be welcomed at the school, traffic and congestion are key issues for the community.

What we're doing

Sustainability

We acknowledge the important part that sustainability has in the construction and lifecycle of upgraded schools and new facilities.

We will be targeting 5-star Green Star accreditation for this project which is a Green Building Council of Australia certification that rates how sustainable a facility is. This certification includes the project meeting measures and minimum standards to drive efficiency in energy, water use, waste and air quality improvement. Specifically;



Both new buildings will run as purely electric.



We will be designing shading to promote heating of the buildings in the winter, and to restrict heat in the summer.



We are proposing to install a new rainwater tank system for each new building, to capture rainwater from the roof areas. This rainwater will then be reused to water the landscaping and flush toilets.



We will be adding additional bicycle storage to encourage cycling to school or work as a method of active transport.

Accessibility

In all our new schools or school upgrades when working on design, we must meet our Educational Facilities Standards and Guidelines (EFSG) for both indoor and outdoor education facilities. The guiding principles of the ESFG provide our vision for learning environments and are enriched by the needs and goals of the school and local community. These guidelines guarantee that all new schools and school upgrades align with the NSW Department of Education's vision and can deliver the Australian curriculum while allowing the school community to contribute ideas towards making the school their own.

The ESFG includes accessibility principles and minimum requirements, which the project will meet.

For more information contact:

School Infrastructure NSW
Email: schoolinfrastructure@det.nsw.edu.au
Phone: 1300 482 651
www.schoolinfrastructure.nsw.gov.au

Share Our Space

Share Our Space is a program that reflects our commitment to ensuring that everyone has access to quality outdoor facilities during school holidays. Our schools are designed to be welcoming and inclusive and Share Our Space helps us go even further in ensuring that everyone can benefit from these facilities.

The community feedback regarding students and community members using school space and school facilities, such as outdoor space, has been passed to the Share our space team.

Car parking

During the project's early planning, a site analysis was undertaken which considers the requirements for the student population in the area.

The Cronulla High School student population is expected to reduce as the school enforces the enrolment policy to reduce their non-local enrolments. This will enable the student population to align more closely with the permanent capacity of the school.

This reduction of students and removal of excess demountables is expected to ease parking demand and traffic congestion on neighbouring streets.

Next steps

Following the REF lodgement there will be a review period of 21 days. Any responses received by community members or stakeholders will be assessed and actioned. If the REF planning pathway is approved, SINSW plans to appoint a builder and we then expect to start construction from late 2022.

Once a builder has been appointed, they will develop a detailed works program. Once this process has been completed, we will have more information to share with the community.

Proposed site plan

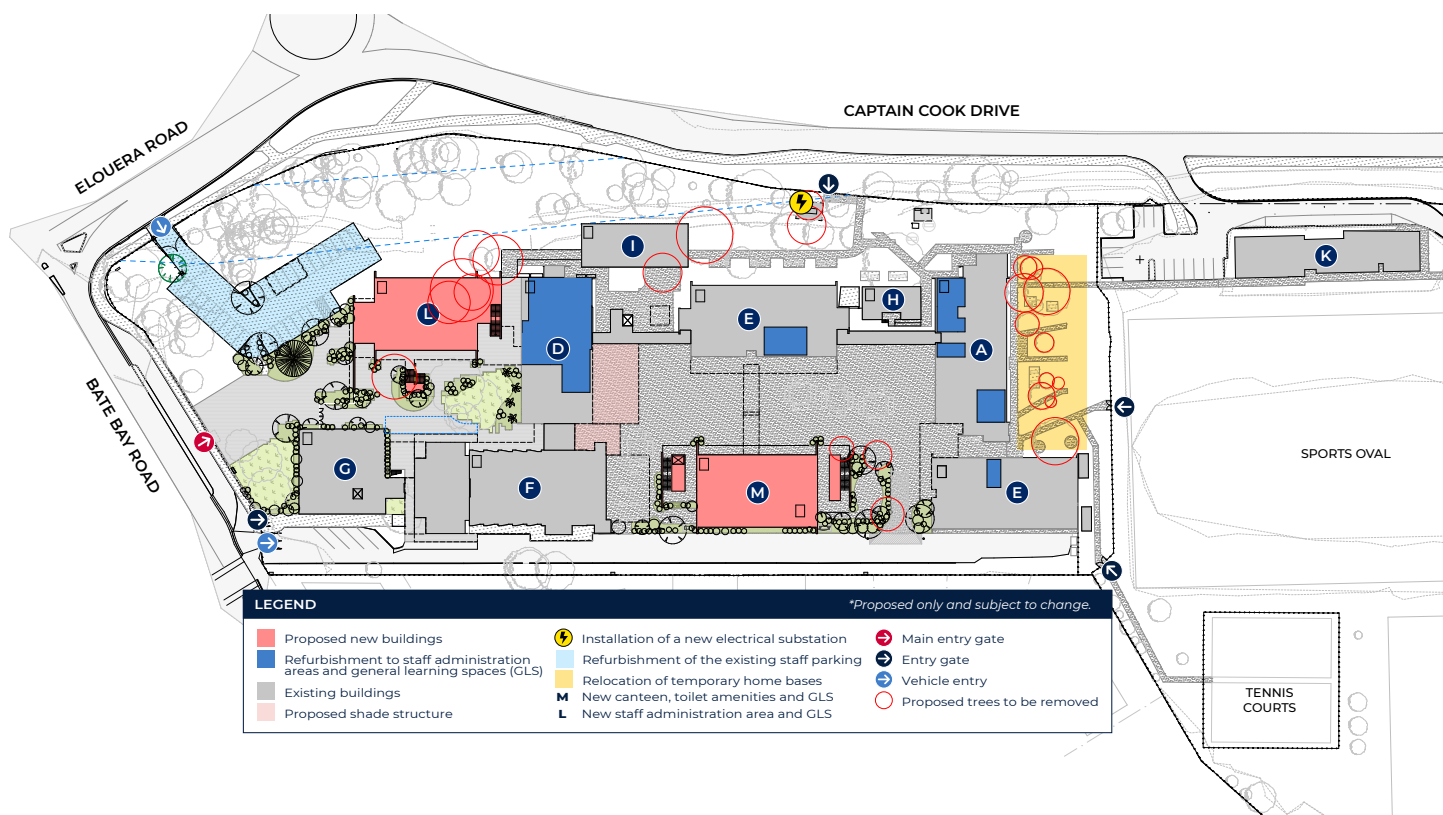

For more information contact:

School Infrastructure NSW
Email: schoolinfrastructure@det.nsw.edu.au
Phone: 1300 482 651
www.schoolinfrastructure.nsw.gov.au