New South Wales Land Registry Services - Document Request

Client Code.....: **FOX**
Search Date.....: **11-Dec-2023 at 12:18 PM**
Client Reference: **22011A - TW**
Doc Reference...: **815804**
Document Type...: **Deposited Plan**
Sub Type.....: **Plan**
Pages.....: **ALL**
NSW LRS Ref.....: **R651114**
Message.....: **OK**

User ID.....: **FOX**
Our Ref#.....: **6400032**

	<u>TOTAL</u>	<u>GST Inc.</u>
On Line Charge..:	3.77	0.34
Authority Fee...:	12.73	1.03
Total Cost.....:	16.50	1.37

SIGNATURE AND SEALS ONLY.

Signed by me **D. CLARKE** as delegate of the Minister for School Education and Youth Affairs pursuant to Section 39 of the Education and Public Instruction Act, 1987 and I hereby certify that I have no notice of the revocation of such delegation.

D. Clarke

Plan Drawing only to appear in this space

DIAGRAM B
NOT TO SCALE
DRIVE
(D) LAND EXCLUDES ROAD VIDE
GOV GAZ 8/19/1967 FOL. 3319 - K823023

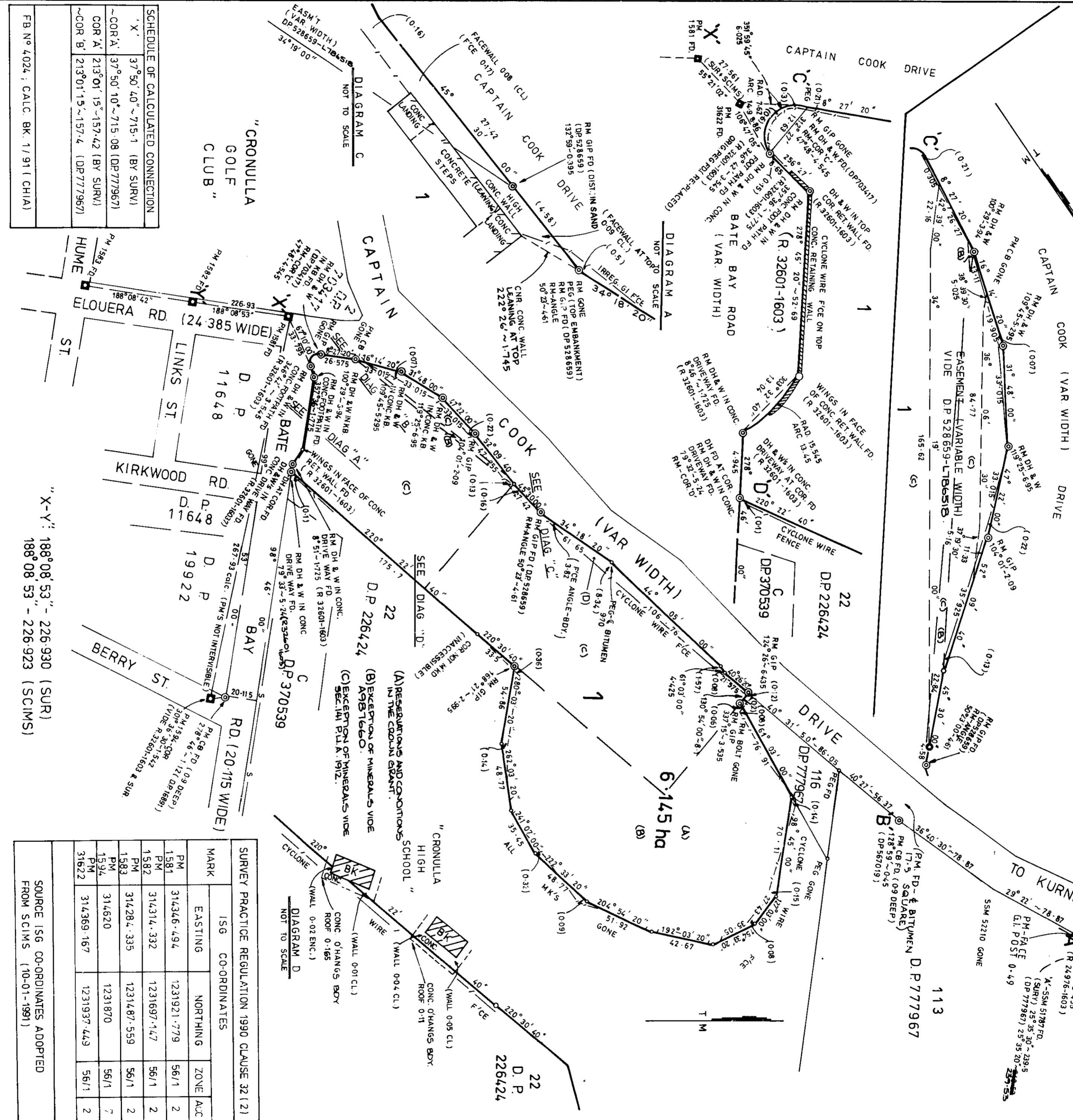

Crown Lands Office Approval

PLAN APPROVED: Authorised Officer
Land District: ...
Paper No: ...
Field Book: ... pages

Council Clerk's Certificate

I hereby certify that ...
the requirements of the Local Government Act, 1919 (other than ...)
the requirements for the registration of plans, and
the requirements of section 34B of the Metropolitan Water, Sewerage and Drainage Act, 1924, as amended + Hunter District Water, Sewerage and Drainage Act, 1928, as amended
have been complied with by the applicant in relation to the proposed ... subdivision or consolidation for ... set out herein

Subdivision No: ...
Date: ...
(Signature): Council Clerk

Consolidated for the opening of a new road or where the land to be surveyed is ...
Water, Sewerage and Drainage Board and the Hunter District Water Board.
Delete if inapplicable

SURVEYOR'S REFERENCE: "CHECK LIST"

SCHEDULE OF CALCULATED CONNECTION

'X'	'Y'	BY SURV
37°30'40" ~ 715.1	188°08'53" ~ 226.930	(SUR)
37°50'10" ~ 715.08	188°08'53" ~ 226.923	(SCIMS)
213°01'15" ~ 157.42	188°08'53" ~ 226.923	(SCIMS)
213°01'15" ~ 157.4	188°08'53" ~ 226.923	(SCIMS)

DIAGRAM A
NOT TO SCALE

DIAGRAM B
NOT TO SCALE

DIAGRAM C
NOT TO SCALE

DIAGRAM D
NOT TO SCALE

SURVEY PRACTICE REGULATION 1990 CLAUSE 32(2)

MARK	ISG CO-ORDINATES	NORTHING	EASTING	ZONE	ACC
PM 1581	314346.494	1231921.779	56/1	2	
PM 1582	314314.332	1231697.447	56/1	2	
PM 1583	314284.335	1231487.559	56/1	2	
PM 1594	314620	1231870	56/1	7	
PM 31622	314369.167	1231937.449	56/1	2	

SOURCE ISG CO-ORDINATES ADOPTED FROM SCIMS (10-01-1991)

OFFICE USE ONLY

DP 815804

Registered: 22/16/1992

Title System: TORRENS

Purpose: CONSOLIDATION

Rel. Map: UO930-82

Last Plan: DP 212509, DP 226424, DP 214814, DP 517501

PLAN OF CONSOLIDATION OF
LOT 1 DP 212509, LOT 1 DP 214814,
LOT 1 DP 517501 & LOT 21 DP 226424

Lengths are in metres. Reduction Ratio: 1:2000

Shire: SUTHERLAND

Locality: CRONULLA

Parish: SUTHERLAND

County: CUMBERLAND

This is sheet 1 of my plan in (delete if inapplicable) Streets

FREDERICK H. SORESENSEN
of PUBLIC WORKS DEPARTMENT, SYDNEY
a surveyor registered under the Survey Act, 1929 as amended, hereby certify that the survey represented in this plan, OF SURVEY
is accurate and has been made in accordance with the Survey Practice Regulations, and any special requirements of the Department of Lands, and was completed on 13-03-1991

Signature: *F. Sorensen*
Surveyor registered under Survey Act, 1929 as amended
Datum: Line of Azimuth X-Y
Insert date of survey.

Plans used in preparation of survey:
DP 212509 DP 777967 Ms 17573 SY
DP 214814 DP 703417 DP 567019
DP 517501 DP 583012 DP 19922
DP 528659 R.32601-1603 DP 16891
DP 226424 Ms 17416 SY

PANEL FOR USE ONLY for statements of intention to dedicate public roads or to create public reserves, drainage reserves, easements or restrictions as to use.

