

Chatswood Public School

Information pack | Day 1 Term 1 2021



Artist impression of Chatswood Public School

The NSW Government is investing \$7 billion over the next four years, continuing its program to deliver more than 200 new and upgraded schools to support communities across NSW. This is the largest investment in public education infrastructure in the history of NSW.

The NSW Department of Education is committed to delivering new and upgraded schools for communities across NSW. The delivery of these important projects is essential to the future learning needs of our students and supports growth in the local economy.

The project will deliver:



More than 150 new and refurbished learning and teaching spaces



Flexible learning spaces



High technology learning environments



Increased quality active play space currently allocated to both schools

Message from your Principal

Dear students, parents and carers,

I am excited to welcome you back to Chatswood Public School for the 2021 school year and would like to extend a warm welcome to our new families. The holiday season was a time to relax with friends and family, reflect on the previous year, and look forward to our year ahead together.

This year marks a year of change for the Chatswood Public School community as construction begins on the upgrade project. We are fortunate to be part of this new chapter in our school's history and have the opportunity to watch our new school develop and take shape. I will continue to advocate for the best outcome for our students and staff throughout the build project and communicate regularly with you.

As we transition from our current school layout to our interim classrooms and locations, our quality teaching and learning that we are so proud of at Chatswood Public School will continue.

Our staff are passionate about instilling a love of learning and have been working hard to prepare material and content for your child before their return to school. As educators, our goal is to provide a rich learning environment and challenge our students to reach their full potential.

The following information will assist you on Day 1 Term 1. You will see that we continue to remain in an environment where NSW health recommendations still apply and as such, parents/carers are not permitted on school grounds. Please read and take note of the information in this pack before Day 1 Term 1 2021.

Alex Montgomery
Principal



An example of the facilities we are building across NSW



An example of the facilities we are building across NSW

Upgrade to Chatswood Public School and Chatswood High School

The Department of Education is upgrading Chatswood Public School and Chatswood High School to meet the needs of students within the local community.

The upgrade to Chatswood Public School is due to be completed at the end of 2023 and will provide:

- Up to 53 classrooms with special programs and special support classrooms
- Flexible learning spaces with moveable furniture and room layouts
- High technology learning environments
- Increased and connected outdoor spaces including a new sports court and rooftop play spaces.

Approved design

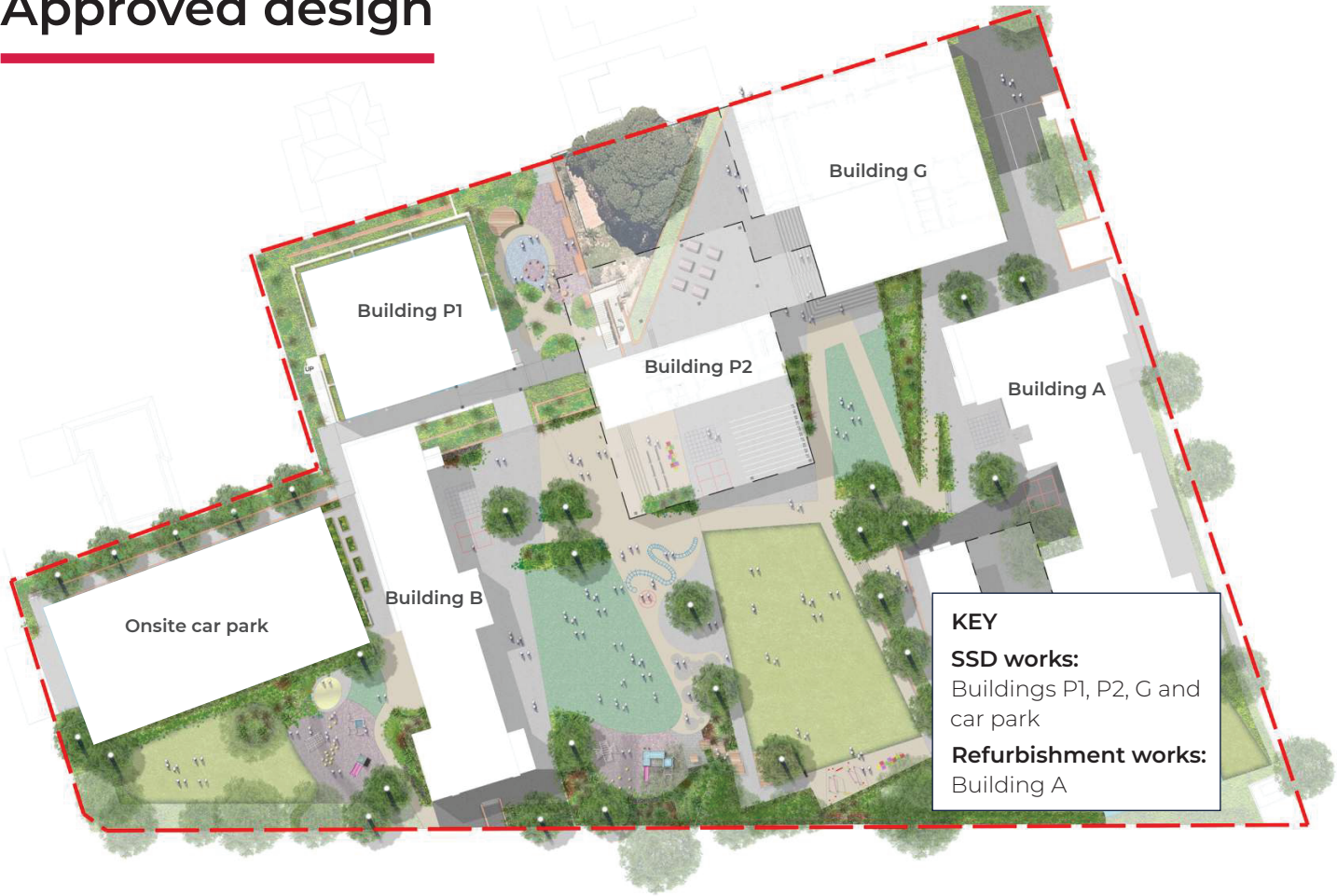

Site map description

Building P1

- 7 storey building
- General Learning Areas
- Support Unit
- 2 levels of COLA

Building P2

- 4 storey building
- General Learning Areas
- Library
- Canteen
- COLA
- Rooftop play space

Building G

- 2 storey height building
- Hall
- Out of School Hours Care

Onsite car park

- Access from Jenkins Street
- Sports court above
- Support Unit parking
- Staff parking

Site landscaping

- Graded play space
- Roof top play space
- COLA
- Site access pathways

Day 1 Term 1

Years 1-6 will return to school on Friday 29 January 2021.

Kindergarten students will start school on Monday 1 February 2021.

Year level locations

Chatswood Public School operates in a campus configuration across the Pacific Highway campus (Main Campus) and Bush Campus. The Bush Campus is located on the grounds of Chatswood High School and was established to address enrolment demand using demountable classrooms.

During construction, Chatswood Public School will continue to operate across the Main Campus and Bush Campus, with the number of students located at the Bush Campus temporarily increasing:

- Kindergarten, Year 2 and the Multi-Categorical Support Class will start at the Bush Campus on Day 1 Term 1 2021.
- Year 1 will start at the Main Campus on Day 1 Term 1 2021 and relocate to the Bush Campus during Term 1.
- Years 3-6 will be located at the Main Campus from Day 1 Term 1 2021 until project completion.

First day of school

A staff member will be in place at each school entrance to assist you in finding your year group.

Main Campus students (Years 1, 3, 4, 5 and 6)

Students are to enter the Main Campus via the Centennial Avenue Gate or the Pacific Highway entrance (see map).

Students will meet at the following locations at 8:55am on Friday 29 January 2021:

- Year 1 – Lower COLA
- Years 3 and 4 – Top COLA
- Years 5 and 6 – Astroturf

Bush Campus students (Kindergarten, Year 2 and the Multi-Categorical Support Unit)

Students are to enter the Bush Campus via the Centennial Avenue stairs entrance, Freeman Road entrance or Eddy Road entrance (see map).

Kindergarten students and their parents will meet on the Bush Campus decking at 9:30am on Monday 1 February 2021. Signage will be in place to help direct you.

Year 2 students will meet on the Bush Campus decking at 8:55am on Friday 29 January 2021.

The Multi-Categorical Support Class will enter via the Eddy Road entrance and meet on the oval at 8:55am on Friday 29 January 2021.



Chatswood Public School Main Campus and Bush Campus map

Start and finish times

All students will start school at 8:55am.

For Term 1 2021, there will be staggered finish times to ensure the safety of our school community:

- Kindergarten will be collected from the Bush Campus on the oval at 2:45pm
- Year 1 will be collected from the Main Campus at the Centennial Avenue Gate at 2:45pm
- Year 2 will be collected from the Bush Campus on the oval at 3:00pm

- Year 3-6 will be collected from the Main Campus at either the Pacific Highway entrance or the Centennial Avenue Gate at 3:00pm
- Multi-Categorical Support Class will be collected from the Bush Campus on the oval at 3:00pm

In keeping with public health guidelines, and with the exception of Kindergarten parents/carers on their child's first day of school, parents/carers are not permitted to enter school grounds to drop off or pick up their child.

Frequently asked questions

Are parents/carers allowed on school grounds?

To ensure social distancing and the safety of our school community, all parents/carers will drop off and pick up their child at the locations outlined above.

With the exception of Kindergarten parents/carers on their child's first day of school, parents/carers are not permitted to enter the Main Campus or Bush Campus.

What will have changed over the summer break?

Returning students may notice some changes to the school grounds.

On the high school grounds near the Bush Campus, construction is underway on the new High School Building R to the north of the oval. Temporary demountable classrooms have been added to the Bush Campus and to the High School sports courts, cricket nets and staff car park. Demountable works will continue during Term 1 2021.

There has been no change to the grounds of the Main Campus.

What happens if I arrive late?

Students that arrive after their year level start time are expected to report to the school administration office at either the Main Campus or Bush Campus.

Where is the office?

The Main Campus administration office can be accessed from the Pacific Highway entrance.

The Bush Campus administration office can be accessed from either the Centennial Avenue stairs entrance or Freeman Road entrance.

Where is the uniform shop?

The uniform shop is on the Main Campus near the Pacific Highway pedestrian entrance.

Where is the canteen?

For the Main Campus, the canteen is located in the existing Hall with existing amenities.

There will also be a canteen on Bush Campus.

Signage will be in place to assist students in finding all of the necessary amenities.

Where is the Out of School Hours Care (OSHC) located?

OSHC for before and after school care will continue operations during construction.

On the Main Campus, OSHC will have an allocated room.

For Bush Campus students, the OSHC provider will collect students and escort them to the Main Campus for after school care from D1 T1 2021.

Alternative after school care providers will be allowed onsite to collect students at both the Bush Campus and Main Campus.

Where is the sick bay?

The Main Campus sick bay is located in A block.

The Bush Campus sick bay is located in the Bush Campus administration building.

Where are the play areas?

The outdoor areas are temporarily changing while construction is underway.

On the Main Campus, students will have access to two covered outdoor learning areas (COLAs) and play equipment. Following the partial demolition of the Public School Hall in early 2021, astroturf will be installed in its place to create additional outdoor play space for students.

On the Bush Campus, students will have access to the oval, the decking and the orchard areas.



Artist impression of the Chatswood Public School central space, looking towards new Buildings P1 and P2

Frequently asked questions (continued)

How will traffic and parking be managed?

The Department of Education is aware of existing traffic congestion on Centennial Avenue and surrounding streets during peak times.

Disruption to the local community will be minimised by a number of mitigation strategies, including:

- Construction workers will be encouraged to use the Chatswood Interchange to access the site
- Movement of materials will take place where possible within the site boundary
- Contractor deliveries will be loaded and unloaded within the site compound to avoid disrupting traffic
- Traffic controllers will be in place where required.

How will noise and dust be managed?

Over the next few years, construction will be underway on school grounds.

Noise levels on site will be managed in accordance with the noise control guidelines that are outlined in the EPA Environmental Noise Control Manual for construction and demolition works.

Noise will be kept to a minimum as best as possible during the construction period. School Infrastructure NSW will provide advance notice of work to the school and local community, particularly when high noise generating works are anticipated.

Dust as a result of demolition and construction works will be hosed down as required.

The Principal meets regularly with the construction team to understand and determine upcoming works to minimise the impact to students and staff.

Stay informed



Website

Stay up to date by visiting the website chatswood-p.schools.nsw.gov.au



Email

Contact the school directly chatswood-p.school@det.nsw.edu.au



Phone

Contact us Monday to Friday on **02 9419 6127**

For more information contact:

School Infrastructure NSW
Email: schoolinfrastructure@det.nsw.edu.au
Phone: 1300 482 651
www.schoolinfrastructure.nsw.gov.au