



Chatswood Public School: New school hall (Building G) next to Building P2

Chatswood Public School and Chatswood High School

Project update | June 2023

Progress summary and next steps

With new Buildings T, Q and G now handed over to the schools, we are at an exciting point in the Chatswood Schools upgrade project's timeline. To coincide with final landscaping works being finished, the public school is planning a welcome event to celebrate the new facilities in Term 3. Similarly, the high school will celebrate in Term 4.

This will be the final regular monthly update as the project team works to finalise the remaining landscaping at both schools and refurbishment works at the high school. The planned activity for the remainder of 2023 is provided for each school overleaf. We will continue to inform the community of any works which may be impactful with work notifications.

Management of construction impacts

During construction, access to buildings and driveways will be maintained at all times. Where temporary footpath changes, car parking removal or lane closures are required for works, traffic control, pedestrian detours, and signage will be in place to assist the community.

Some of this work may be noisy; however, we will take every possible step to minimise noise, such as switching off equipment when not in use and using non-tonal reversing beepers.

Standard construction hours for this project are 7 am to 6 pm Monday to Friday, and 8 am to 4 pm, Saturdays. No works will take place on Sundays or public holidays, unless otherwise notified.

Between Friday 9 June and Monday 17 July 2023, Building H lower ground toilets and change rooms will not be available for use by community members accessing the outdoor sports facilities at the high school. Two female and two male toilets will be available in the temporary demountables as marked on the map on page 2. During this time there will be no standalone changeroom facilities.

Chatswood High School

The below table summarises work activities for the remainder of 2023.

Indicative timing	Detail of upcoming works
<i>June to December 2023</i>	<ul style="list-style-type: none"> • Landscaping works around Buildings Q and T (sports hall) • Finishing the Centennial Avenue entrance • Building R southern landscaping including footpaths and retaining walls • Refurbishment of Buildings M and H • Landscaping works around Buildings M, H and R • Decommissioning and removal of temporary demountables (August) • Reinstatement of staff car park • Removal of hoarding • Packing down site accommodation and services

Indicative map of the Chatswood High School work zone

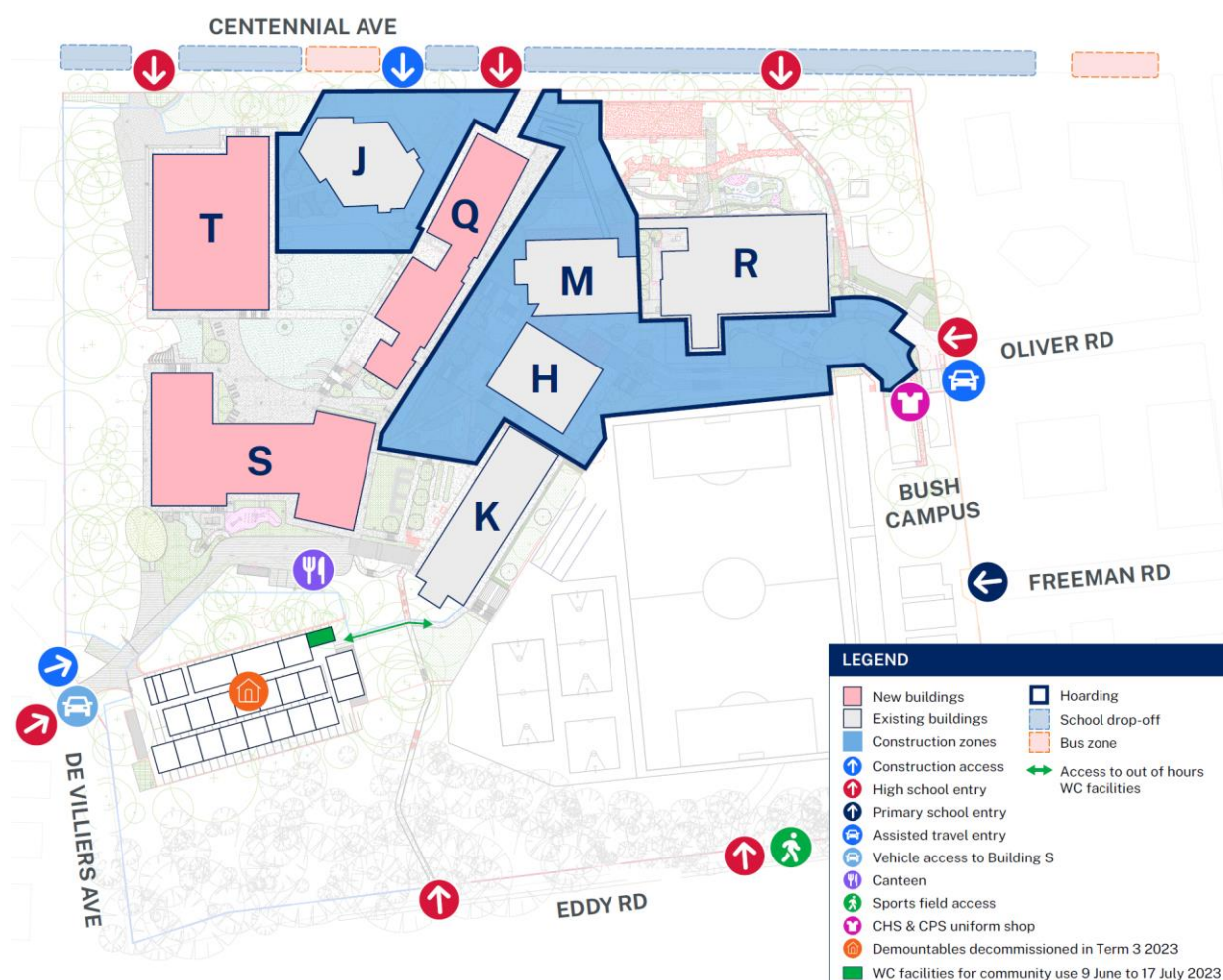

Chatswood Public School

The below table summarises work activities for the remainder of 2023.

Indicative timing	Detail of upcoming works
<i>June to July 2023</i>	<ul style="list-style-type: none"> • Handing over the staff car park in Building V on Jenkins Street. • Handing over the new sports court, yarning circle and newly landscaped central courtyard • Completion of stormwater works on Jenkins Street • Installation of new retaining walls on Jenkins Street, Centennial Avenue and Pacific Highway • Rectification of retaining wall along the northern boundary with neighbours on James Street and Jenkins Street (subject to approval) • Removal of construction loading zone and access on corner of Centennial Avenue and Pacific Highway • Removal of hoarding • Packing down site accommodation and services.

Indicative map of the Chatswood Public School work zone following the handover of Building G

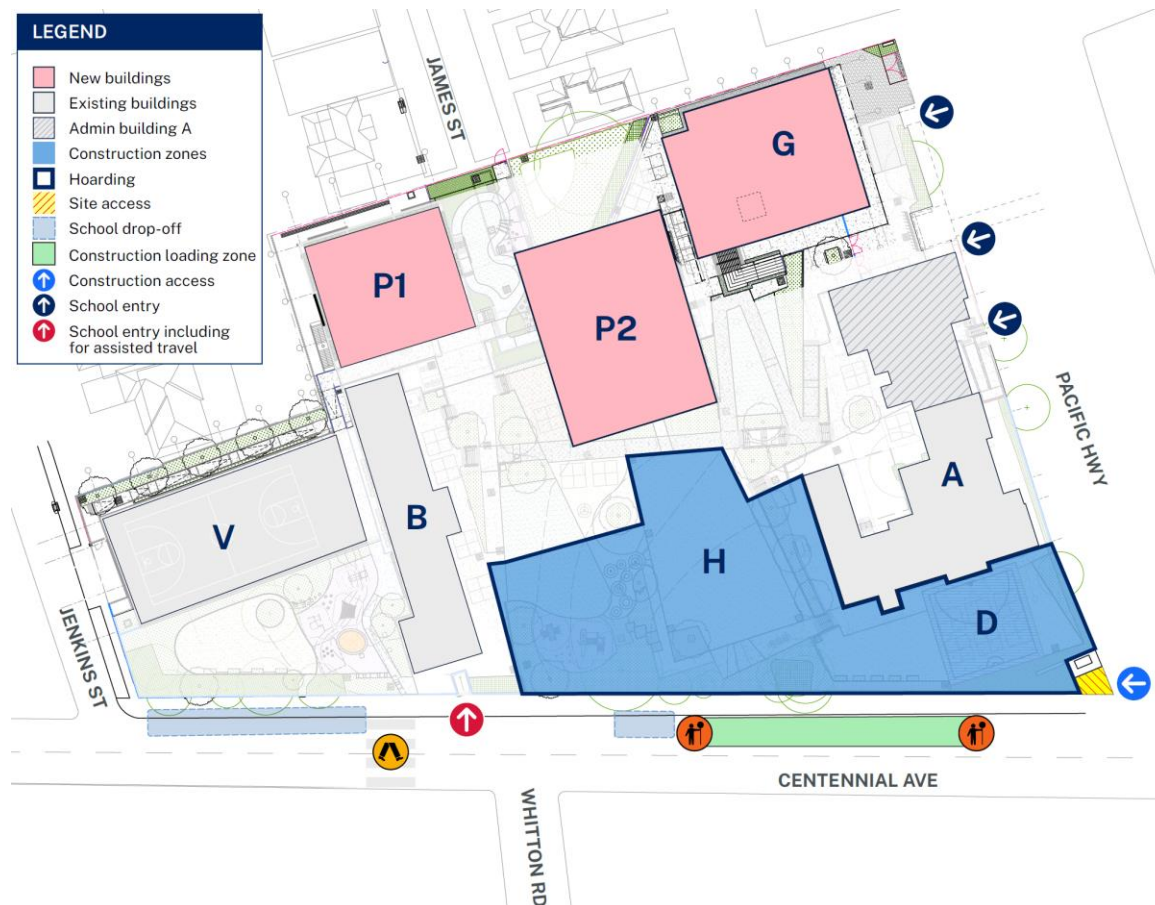



Chatswood Public School – The new school hall (Building G)

The new school hall is a single storey building with a built-in stage with curtains, and a full audio-visual setup including a lighting rig and projector screen. The beautiful hardwood flooring is the star of the space which will be used for sport activities, school assembly's, hosting school plays and music recitals and will be the future home of OOSHC.

Custom built full height doors look out over the public-school central courtyard and can be fully opened to create an undercover gathering and entry to the space. These full height doors lead to a covered outdoor learning area with a bright and fun snakes and ladders for the students (and staff!) to enjoy!

Support rooms include a large kitchenette and storage spaces to house foldaway seating and sports equipment. The front of the building is the new main public school entry point from Pacific Highway and includes bicycle parking and new school gates.



Floor plan of the new school hall (Building G)

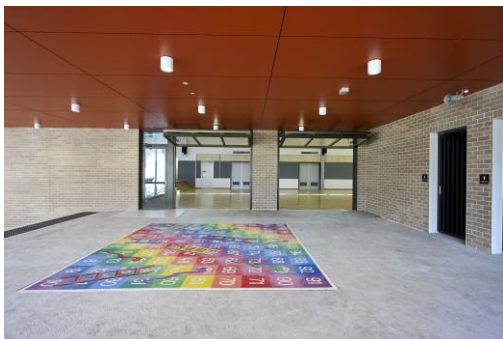

Building G internal entrance with custom built retractable doors, COLA and student facilities



New Chatswood Public School main entrance from Pacific Highway

Chatswood High School – Building Q, new school hall (Building T) and refurbished sports court and cricket nets



Sports hall (Building T) with stage, basketball courts and mezzanine performance workshop

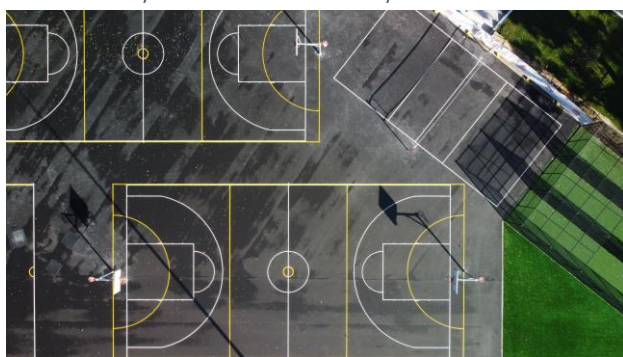

Refurbished sports courts and cricket nets



Building Q senior study/ library



Building Q flexible learning spaces

-  Sports, concerts, music, school assemblies
-  Full audio-visual setup including projector screens
-  Changing rooms with showers
-  Large performance stage with external access
-  Full size basketball court with retractable nets and mezzanine viewing area
-  Mezzanine performance workshop
-  First aid facilities
-  Refurbished outdoor half and two full basketball courts and volleyball court
-  Three refurbished outdoor cricket net lanes
-  New main entrance to school from Centennial Avenue
-  Library
-  Canteen
-  General learning classrooms
-  Flexible learning spaces
-  New administration hub and public entrance
-  Staff study and print rooms
-  School executive offices