



The upgrade at Canterbury South Public School will occur over different stages, with the project due to be complete at the end of 2022.

Keeping you updated

We will continue to keep you updated about project information as the project progresses. This information will be provided through project updates, information sessions, works notifications and our website.

At the NSW Department of Education, we recognise the traditional custodians of the lands and waterways where we work and live. We celebrate the First Peoples' unique cultural and spiritual relationship to Country and acknowledge the significance of Aboriginal cultures in Australia.

Stay informed



Website

Stay up to date by visiting the School Infrastructure NSW website schoolinfrastructure.nsw.gov.au



Email

Contact the Community Engagement team by emailing schoolinfrastructure@det.nsw.edu.au



Phone

Contact us between 9:00am and 5:00pm, Monday to Friday on **1300 482 651**

Canterbury South Public School

Information pack | February 2021



The NSW Government is investing \$7 billion over the next four years, continuing its program to deliver more than 200 new and upgraded schools to support communities across NSW. This is the largest investment in public education infrastructure in the history of NSW.

The NSW Department of Education is committed to delivering new and upgraded schools for communities across NSW. The delivery of these important projects is essential to the future learning needs of our students and supports growth in the local economy.



New building with 30 teaching spaces



New administration building



New library



New hall



New canteen



Covered outdoor learning area (COLA)

Project update

Canterbury South Public School is being developed to deliver new and upgraded facilities, innovative learning spaces, and to provide for growing student enrolments in the area. The project started in mid-2019, with Stage One, when demountable classrooms were installed and additional preliminary work was completed, including some early demolition and replacement of services.

In late 2020, the Development Application for Block C, part of the main works, was approved. A contractor was appointed for the main works, which are due to start early 2021. Site establishment has taken place in preparation for the work.

Next steps

The main works (Stage Two) will be broken into three phases (a,b,c)

Stage Two (a) – due to be complete late 2021:

- Block A; a new administration building, new library, canteen, and special programmes rooms
- Block B; a covered outdoor learning area (COLA) and new hall.

Stage Two (b) – due to be complete late 2022:

- Block C; 30 new teaching and learning spaces
- New internal road.

Stage Two (c) – due to be complete late 2022:

- Demolition of existing buildings and removal of demountable buildings
- Final Landscaping.

Site establishment

During site establishment and construction we will take all steps to ensure the safety of the school and residential community and minimise impacts of construction.

The main site office has been positioned off France Street. Traffic management for work vehicles and site personnel will be coordinated via designated site traffic and pedestrian access gates on France Street and Napier Street.

Construction works will take place from 7.00am to 5.00pm Weekdays and Saturdays. Truck access is not permitted during the critical morning and afternoon school arrival and departure times, particularly 8.30am to 9.15am and 2.45pm to 3.30pm. Construction vehicle movement will also avoid times when students will be using France Street to access Pat O'Connor Reserve.

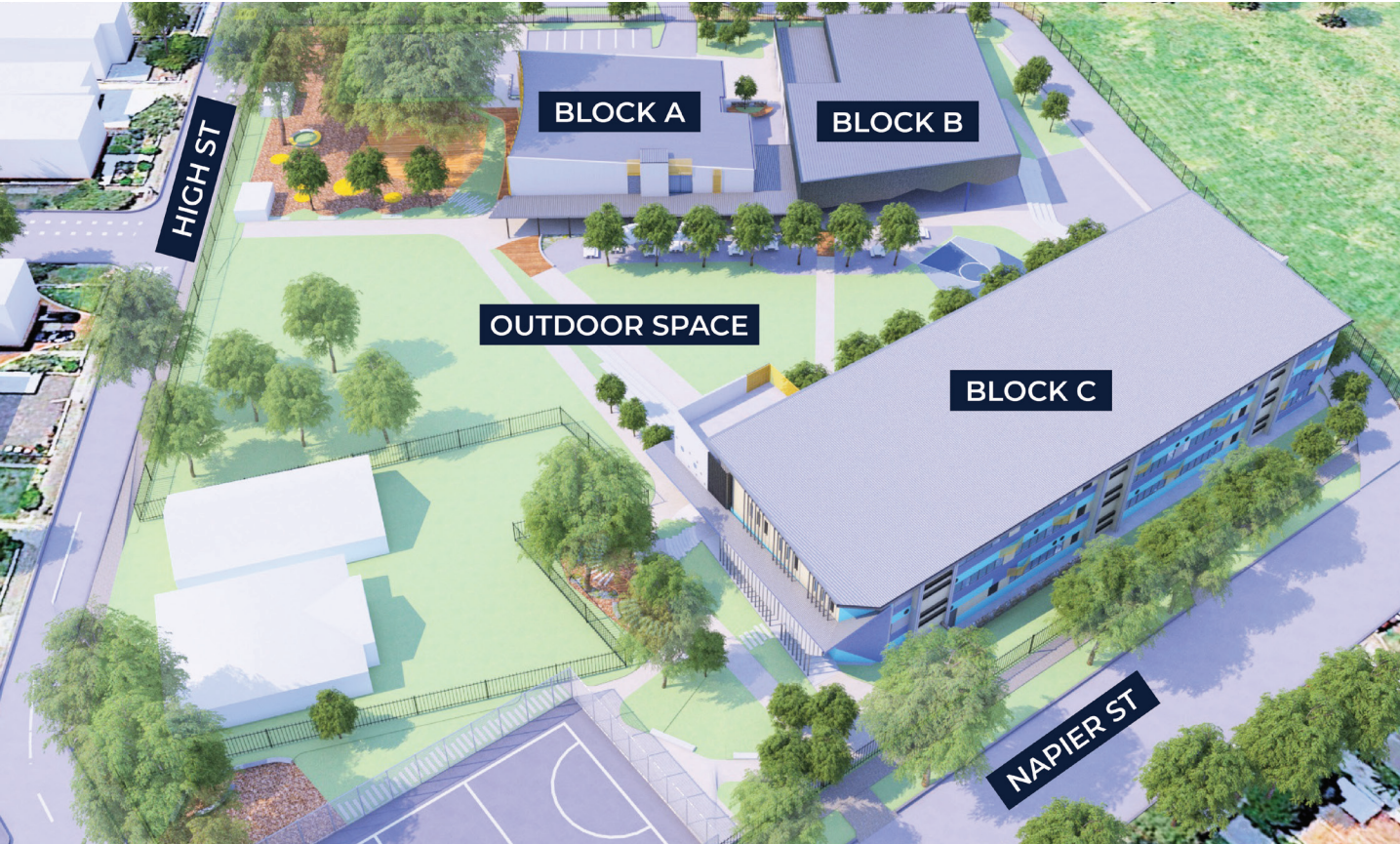

Schematic Design of School Upgrade

Frequently asked questions

Will there be disruption in school operations?

School Infrastructure NSW (SINSW) will work closely with the school leadership to ensure continuity of school operations.

Why is there a new internal road?

The new internal road is to address concerns with traffic management around school drop off and school pick up. It creates a 'kiss and drop' within the school grounds and reduces activity on neighbouring streets.

Will the new road be open to the public outside school hours?

No. The new road is designed to assist with school drop off and pick up. As the road is within the school property, access will be controlled by the school.

Will there still be pedestrian access from High Street?

Yes. While the 'kiss and drop' will be on the new ring road, pedestrian access will remain from High Street, Napier Street, and France Street.

Why was there a delay between Stage One (preliminary works) and Stage Two (major works)?

The project started in mid-2019, when demountable buildings were installed and some buildings were demolished. A Development Application (DA) was then waiting approval for the main works. The decision on the original DA was deferred as there was some feedback to

address, including traffic management. SINSW completed further studies and made amendments to the proposed project.

The updated DA included extra spaces allocated for staff car parking, and an internal road to assist with traffic flow at school drop off and pick times. This was approved in late December 2020.

When is the project expected to be complete?

The project is now expected to be complete by the end of 2022, with sections progressively handed over to the school for use as they are finished.

What is the capacity of the new school?

Once the upgrade is complete, the school will be able to deliver learning spaces for around 690 students.

Based on current population projections for the local area, school enrolments will grow gradually over the next decade. There won't be a sudden increase in student numbers immediately after the upgrade is completed.

What are some of the landscape improvements?

There will be new outdoor areas created, including a large quad space for multi-purpose activity and gathering. The opportunity to use natural material will be used to create a linkage to the nearby Cooks River. Some trees will be removed to complete the project, but new planting will be made to replace these.

While open space is impacted at the School, students will use neighbouring Pat O'Connor Reserve.

