

Brookvale Public School

Project update

April 2019



This image is an example of facilities we are building for students across NSW

THE
LARGEST

INVESTMENT IN
PUBLIC SCHOOL
EDUCATION
INFRASTRUCTURE
IN THE HISTORY OF
NSW

\$6 Billion

FOR MORE THAN
170 NEW AND
UPGRADED SCHOOLS

THE PROJECT
TEAM IS WORKING
CLOSELY WITH
THE SCHOOL AND
KEY STAKEHOLDERS
TO PROGRESS
THE DESIGN

Project overview

The NSW Government is investing \$6 billion over the next four years to deliver more than 170 new and upgraded schools to support communities across NSW. In addition, a record \$1.3 billion is being spent on school maintenance over four years. This is the largest investment in public education infrastructure in the history of NSW.

A project is underway at Brookvale Public School to deliver a new hall and refurbish two learning spaces.

Who is involved

- The project team has been established, including architects, planners, and other design professionals.
- The Project Reference Group has been meeting to define the school requirements and educational principles which are being incorporated into the overall design.

Next steps

- Further progress to the concept design following school community engagement and determine the preferred concept design option.
- The final design is developed and shared with the community during the planning approvals process (DA).



This image is an example of facilities we are building for students across NSW



Front view (early artist impression)



Back view (early artist impression)

New hall concept design

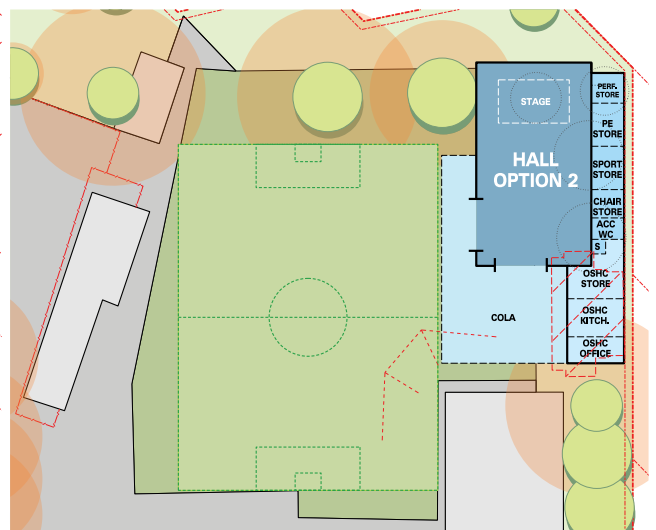

LEGEND

- Pedestrian access
- Hall height up to +8m
- Support rooms & OSCH (After school care) Height - up to +3.5m
- COLA - Undercovered open area
- Existing buildings (D - Demountable)
- Playing field area - Approx. 1890sqm (inclusive of area under the proposed COLA)
- Site boundary
- DA Setback Zone
- Trees to be removed
- Trees protection zone limits
- Photo location
- Footprint of existing dilapidated toilet block to be demolished
- Embankment
- Size guide: Mini Roos soccer field under 8-9s
- Play equipment

LOCATION ASSESSMENT

- ✓ Minimal impact on Green Open Play Space. Continued existing use of oval as a valuable sports playing field.
- ✗ 2 original QLD Brushbox trees removed. 1 standard QLD Brushbox tree removed. 1 dead tree removed.
- ✓ Proposed building location continues along perimeter built form of the site along the eastern boundary.
- ✓ Connected with school activities, physically/socially/visually connected to school. Hall will have connection and flexible relationship with existing open space enhancing the school's delivery of the curriculum and potential for extended community uses.
- ✓ Scope for larger audiences to bleed into green space.
- ✓ This option is preferred by the school's teaching staff and the P&C.
- ✓ Maximise the opportunities of the "Share our Space" initiative promoted by the NSW Department of Education.



Aerial view (early artist impression)

Frequently asked questions

What is an innovative learning environment?

Innovative learning environments allow flexible, technology-rich teaching spaces for one-to-one, small groups and lecture style teaching.

This environment allows all students the opportunity to obtain new information through their preferred learning approach.

Innovative learning prepares students across all curriculum areas and learning stages with skills and capabilities to thrive in a rapidly changing and interconnected world. It connects students and engages their sense of curiosity.

When is construction planned to start?

Some preliminary works may be undertaken in 2019 as part of the normal project development activities, and these works will be carefully planned to avoid disruption to the school's operations. Commencement of main construction work is dependant on planning approvals.

We will be able to communicate more once the development approval has been received.

Will relocation be required in 2019?

No. The school will operate as per normal during 2019. There may be some adjustments to access of play space. We will keep the school community informed with regular updates as the project progresses.

Where will the new hall be located?

The site within the school was selected as it delivers the best educational outcomes, improved outdoor play space and good access for visitors. Other sites were investigated however required substantial vegetation modification and impacts on school operations. The proposed location considers the school site as a whole, future school operations and growth. The only feasible location requires the removal of three trees to deliver the school upgrade.

What impacts will the school upgrade have on OSHC facilities.

The Brookvale Public School upgrade and delivery of the new hall will provide additional provision for before and after school care facilities.

What improvements will be made to the sports field?

As part of the scope of works to deliver the new hall and refurbishment of two classrooms, the sports field will be upgraded.

How will you minimise disruption to normal school operations during construction?

School Infrastructure NSW is working closely with the principal and staff to ensure that disruptions to teaching and amenity are minimised.

For more information

We are committed to working together with our school communities and other stakeholders to deliver the best possible learning facilities for students. We encourage feedback from the school and local community.

Please visit the Brookvale Public School page on the School Infrastructure website to complete our online survey. This survey will close on Friday 12 April 2019.

Stay informed



Website

Stay up to date by visiting the School Infrastructure NSW website schoolinfrastructure.nsw.gov.au



Email

Contact the Community Engagement team by emailing schoolinfrastructure@det.nsw.edu.au



Phone

Contact us between 9am–5pm, Monday to Friday on 1300 482 651