

# Brooke Avenue Public School

Information pack | April 2021



Artist impression of the Brooke Ave Public School upgrade

The NSW Government is investing \$7 billion over the next four years, continuing its program to deliver more than 200 new and upgraded schools to support communities across NSW. This is the largest investment in public education infrastructure in the history of NSW.

The NSW Department of Education is committed to delivering new and upgraded schools for communities across NSW. The delivery of these important projects is essential to the future learning needs of our students and supports growth in the local economy.

## Project overview

We are upgrading Brooke Avenue Public School to deliver new and improved facilities to support the growing student community. The upgrade will deliver:



4 innovative and flexible learning spaces



2 withdrawal rooms



A practical activity area



New sports court

## Progress summary

The schematic designs which outline further detail of the new building have been approved and the detailed design is in development.

The project has received planning approval and construction works have begun.

Perimeter fencing has been installed to restrict access to the construction site, traffic control measures have been established as required to manage pedestrian and vehicular movements near the site access points and works to remove of the old sports court has begun in preparation for excavation work.

## Next steps

Excavation works and groundworks will begin at the end of March at the site of the new building. A concrete slab is scheduled to be poured next month followed by building construction.

All project updates and any works notifications will be shared with the community and uploaded to the SINSW website.

## Project timeline

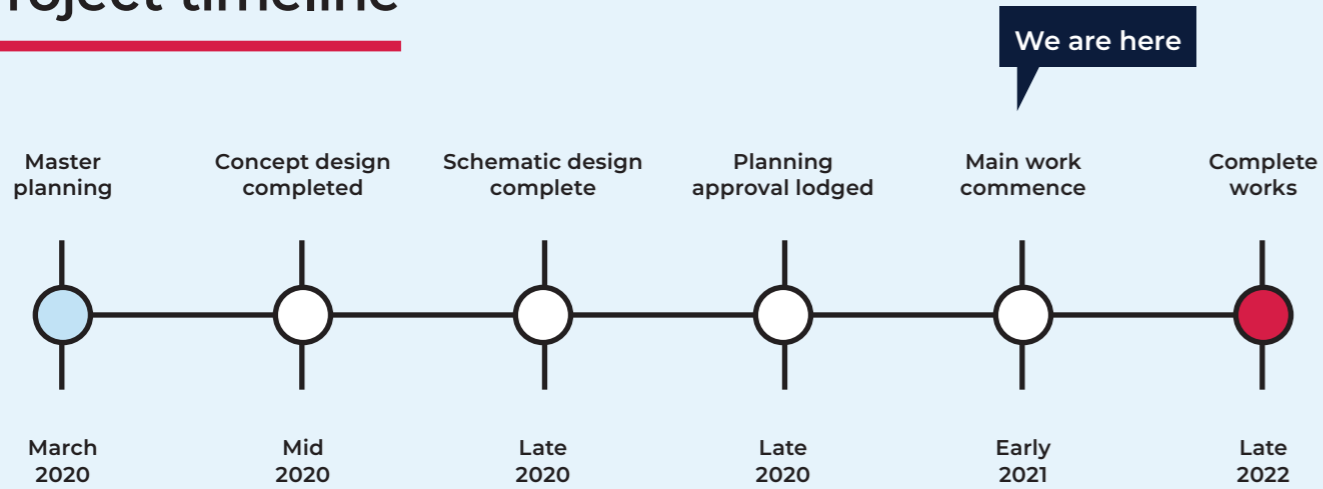

## Regional Renewal Program

Brooke Ave Public School has been successful in acquiring funding through the NSW government's regional renewal program to upgrade bathroom facilities in block A. This is a co-funded program based on the ability of a school to contribute up to 50 per cent of the total project costs.

Upon completion the bathrooms in block A will benefit from upgraded fixtures and increased natural light and air flow.

These works are separate to the school upgrade and will be conducted during the Easter school holidays, ready for use on day 1 term 2.

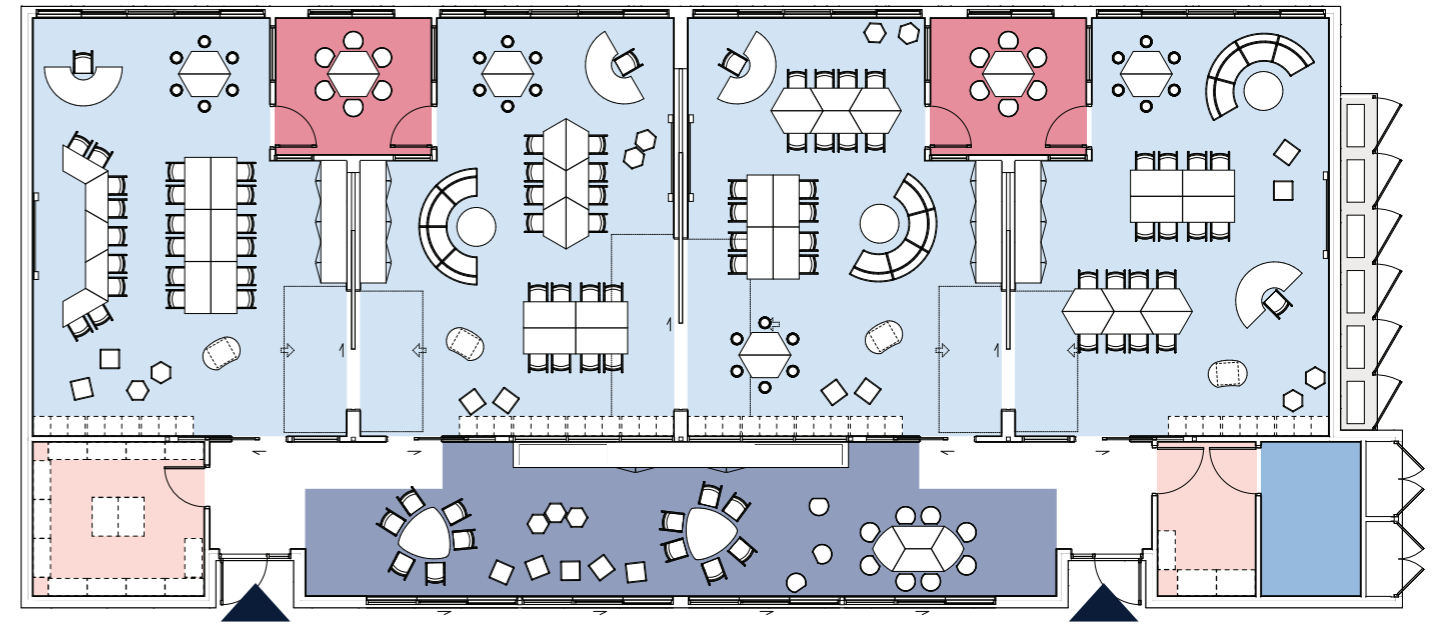

### LEGEND

- Flexible learning spaces
- Withdrawal rooms
- Practical activities area
- Store rooms
- Communications
- Entries

New building site map - furniture layout is indicative and subject to change



### LEGEND

- New homebases
- Proposed new sports court
- Demountables
- Tree removal
- Kiss and drop
- Car park

Site of the new building and sports court at Brooke Avenue Public School

## Frequently asked questions

---

### When will construction works begin?

Site establishment work begun in March and construction works are expected to commence in early April.

The approved project working hours are 7am to 5pm, Monday to Saturday. No work will take place on Sundays or public holidays, unless otherwise notified.

### What safety measure are in place during construction?

Health and safety is our highest priority. We are working collaboratively with the school community and neighbours to ensure that construction works are scheduled and managed to minimise impacts to the community where possible.

### How will traffic be managed?

To ensure the safety of students, staff, the local community and our site workers, traffic management is being implemented when required.

This includes the use of onsite traffic control personnel to manage entry and exit of construction vehicles.

Site vehicles must give way to pedestrians at all times. Wherever possible, truck movements will be scheduled outside school drop off and pick up times.

### Will any trees be removed as part of construction works?

Yes- five trees need to be removed to make space for the sports court and the new building which will house the new learning spaces, withdrawal rooms and practical activity area. The trees will be removed by a qualified arborist in accordance with NSW work health and safety regulations.

### Where will trucks enter the construction site?

Vehicle access to the site will be via the gate on the corner of Brooke Avenue and Tyrrell Place.

### When is construction expected to finish?

Construction is expected to be complete by late 2022.

### Will the upgrade replace demountable classrooms?

The new building will replace four demountable classrooms which will provide four permanent learning spaces to support the long-term student enrolment growth.

### How will the school community be kept up to date?

Works notifications and project updates will be shared with the community to inform on the progress of construction and prior to any disruptive construction works or traffic changes.

All information will be posted in the School infrastructure website.

## Contact us

---



#### Website

Stay up to date by visiting the School Infrastructure NSW website [schoolinfrastructure.nsw.gov.au](https://schoolinfrastructure.nsw.gov.au)



#### Email

Contact the Community Engagement team by emailing [schoolinfrastructure@det.nsw.edu.au](mailto:schoolinfrastructure@det.nsw.edu.au)



#### Phone

Contact us between 9:00am and 5:00pm, Monday to Friday on **1300 482 651**