

Broadwater Public School

Welcome Pack – March 2025



New teaching building

Welcome to your new school

We are excited to welcome students and staff to their rebuilt Broadwater Public School to learn, teach and thrive in. The new facilities include:



3 new flexible teaching spaces



new administration and staff spaces



a new library



a new canteen



outdoor spaces and playground



Aboriginal Cultural Acknowledgement

Thank you for your patience during construction. We are thrilled to deliver this project for the school community.

Did You Know?

Broadwater Public School is designed to be flood resilient, with core school spaces raised 4m on an engineered steel structure. The undercroft beneath the elevated indoor spaces provides an all weather space for learning, play and school activities.

For more information

Phone: 1300 482 651

Email: schoolinfrastructure@det.nsw.edu.au

Website: schoolinfrastructure.nsw.gov.au





Message from your Principal

It is with immense excitement and pride that I announce the official opening of our brand-new school! This milestone is the culmination of three years of hard work, dedication, and vision, and it marks the beginning of a new chapter for our students, staff, families and community. Our new learning spaces, playground, and modern facilities provide the perfect environment for nurturing creativity, curiosity, and academic excellence. These spaces have been designed with our students' growth and well-being at the forefront, and I am thrilled to see how they will inspire and support their learning journey.

Our classrooms are bright and spacious, equipped with the latest technology to enhance teaching and learning. The playground is a vibrant and exciting space where our students can engage in active play, build friendships, and enjoy being outdoors. These new facilities are a testament to the commitment to providing our students with the very best resources to thrive.

I would like to take a moment to express my heartfelt appreciation to our incredible staff and students. Your enthusiasm, dedication, and adaptability have been nothing short of inspiring throughout this transition. A special thank you to our dedicated Parents and Citizens (P&C) group, our families and our entire school community for your unwavering support and patience during this journey. Your involvement, collaboration, and encouragement have played an essential role in bringing this vision to life.

As we embark on this exciting new chapter together, I am confident that our school will continue to be a place where every student feels valued, challenged, and empowered to succeed.

Thank you for your continued support. I look forward to all the wonderful moments ahead as we make lasting memories in our new home.

Bronwyn Cole

Relieving Principal

Connecting with country

The process to design the new Broadwater Public School included consultation with representatives of the local Aboriginal community, through a Connecting with Country process. This has resulted in the inclusion of a stone yarning circle, bush tucker garden, path etchings and the use of local language in signs to identify classrooms and other locations around the school.

New school map

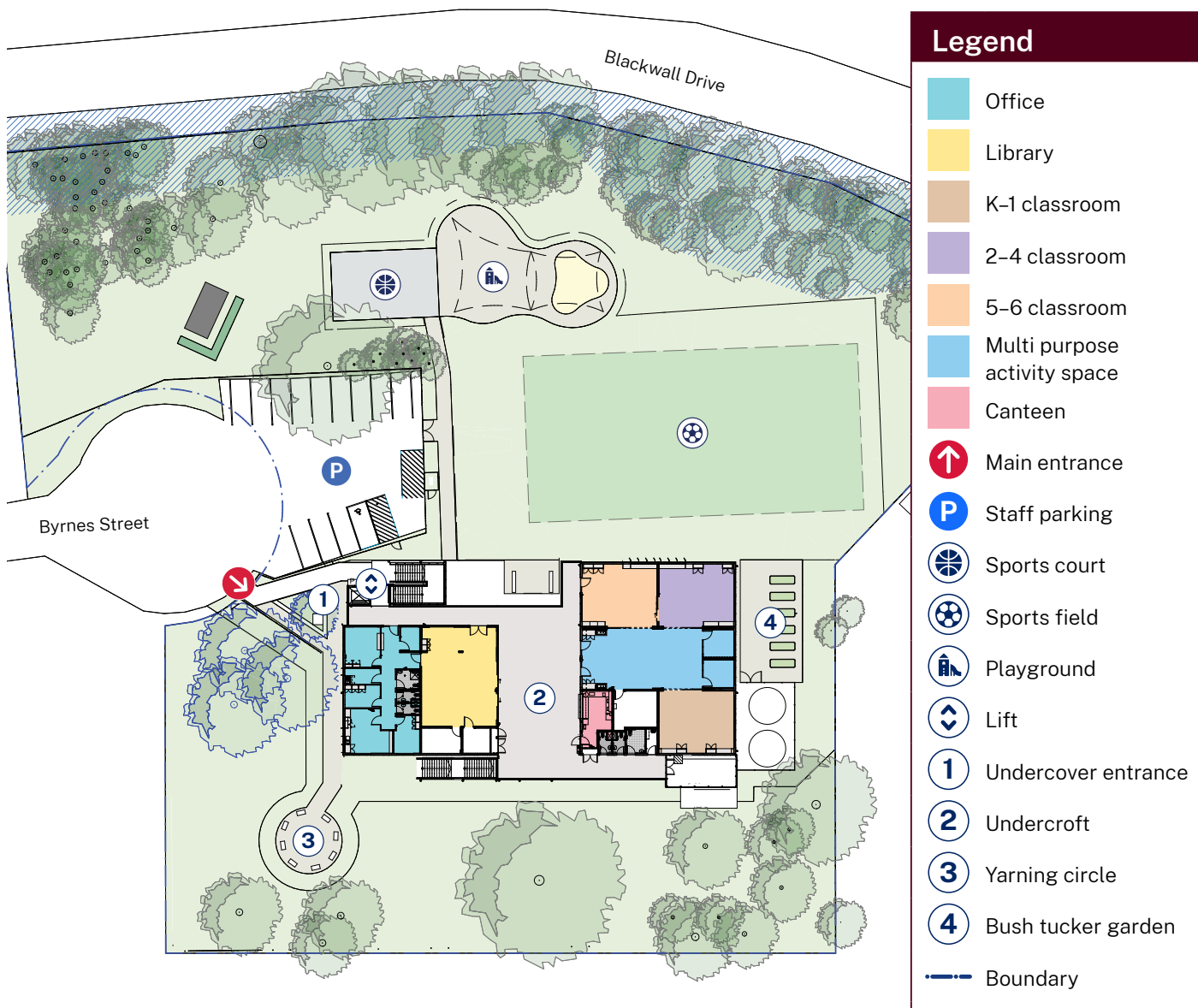

Honouring Broadwater's past

Broadwater Public School has been at the heart of the Broadwater village since 1881 and recognising this history is an important part of the rebuild. Cherished items have been retained and returned, including the school bell, plaques and the "pencil fence". The "Love Tree" remains a feature of Broadwater Public School, visible from the raised spaces and the school grounds.



New classroom



Multi purpose space



Connecting to Bundjalung Country



Pencil fence and school bell

Contact us

For information about school activities and operations, contact the school directly:

Principal (relieving): Bronwyn Cole

Website: broadwater-p.schools.nsw.gov.au

Email: broadwater-p.school@det.nsw.edu.au

Phone: 02 6682 8226

Address: 9 Byrnes St, Broadwater NSW 2472

For more information about this project, contact School Infrastructure:

Website: schoolinfrastructure.nsw.gov.au

Email: schoolinfrastructure@det.nsw.edu.au

Phone: 1300 482 651