



Bletchington Public School

Day 1 Term 1 Welcome Pack | January 2023

Welcome to your school

We're excited that Stage 1 of the upgrade of Bletchington Public School is finished and ready for use by students and staff.

Stage 1 of the Bletchington Public School upgrade has delivered:



A new 2-storey learning hub including 10 new flexible learning spaces



A new ICT special programs unit

Stage 2 will deliver:



Refurbishment of existing learning spaces including support classes and multi-purpose areas



A hall upgrade



Upgraded connected walkways



A new covered outdoor learning area (COLA) adjacent to the hall

Message from your Principal

On behalf of Bletchington Public School, I welcome everyone to our exciting new school upgrade. The recent investment in the school has afforded our students and staff with modern and attractive facilities, and opportunities for flexible and innovative learning.

Our 10 new classrooms, which are also known as flexible learning spaces, and new ICT special programs unit allow teachers to use engaging teaching practices across all classes, allowing for individualised learning and collaboration. The fully air-conditioned spaces also ensure students can learn in comfort all year round. The refurbishment of existing learning spaces including support classes and multi-purpose areas, as well as a hall upgrade will provide wonderful new resources for our students, and ensure the school is well resourced to meet the demands of a busy learning-focused school.

The new, spacious and well-resourced 2-storey learning hub will be a valuable asset to all students by providing access to emerging and innovative technologies. Children will enjoy the open design with access to high quality learning environments and the opportunity to collaborate across classes using advancing technologies. A new Covered Outdoor Learning Area (COLA), upgraded connecting walkways and landscaping will complete Bletchington Public School's new look.

It has been a pleasure to be involved in this building project. From planning, design, construction through to delivery, Bletchington Public School and the community have patiently watched our school transform into a modern and well-resourced school. I would like to thank all of the people involved in realising our new facilities as we look forward to an exciting future.

Rob McPherson
Principal

Flexible learning spaces

This exciting project has delivered new learning environments for the next generation of young minds. The new learning environments offer flexibility where teachers can provide more opportunities for student engagement. The learning spaces:

- are adaptable to accommodate small or large groups
- provide accessibility to new technology in a variety of settings
- encourage a personalised learning experience so students learn at their own level and pace.



New school map

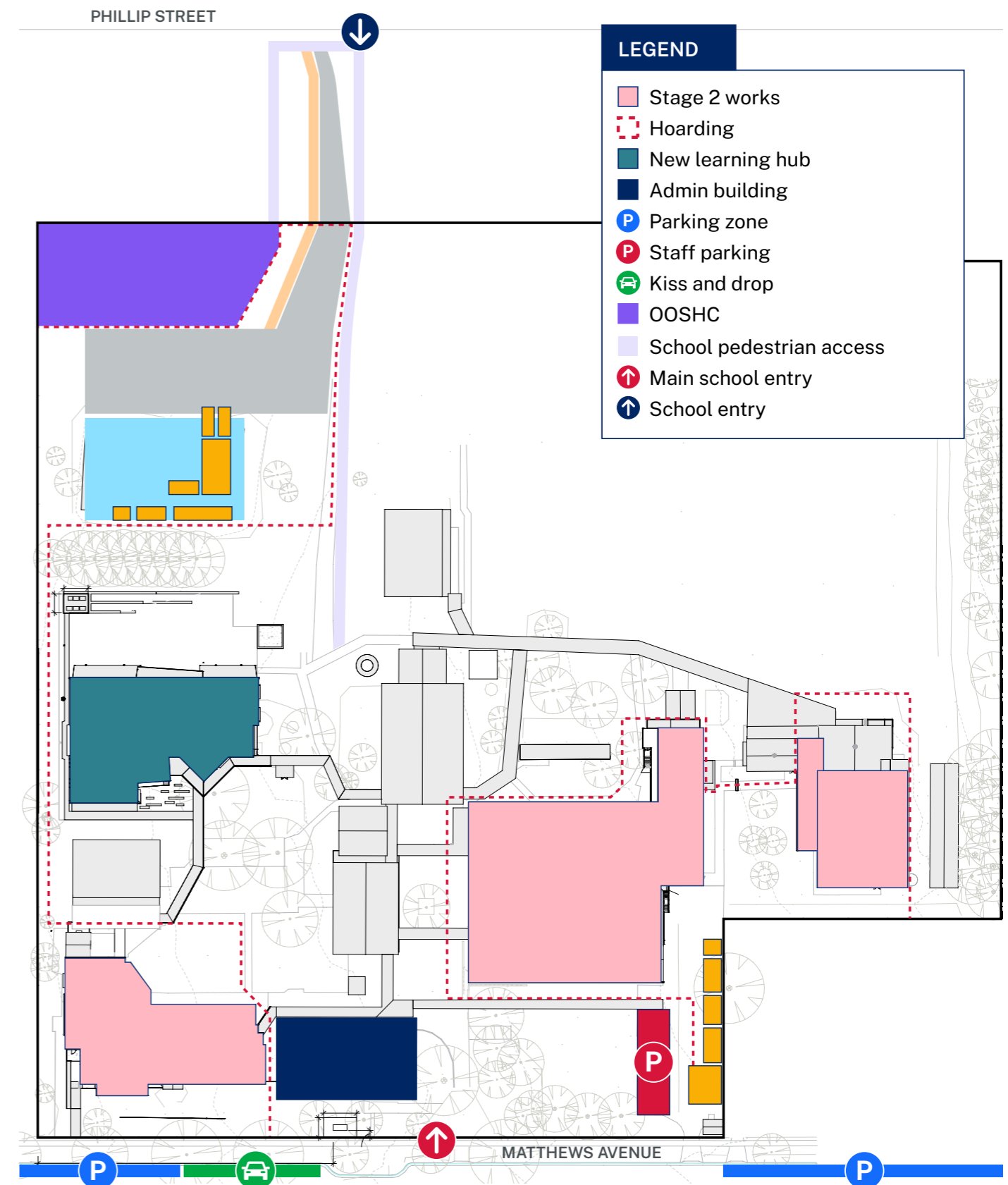



Maker space in the new learning hub

Frequently asked questions

What Stage 1 works are still to be finished?

External works to add paving, soft landscaping, covered walkways and play space will be undertaken throughout Term 1. The refurbishment of existing learning spaces consists of floor finishes and the addition of walls between learning spaces, tiered seating and an accessible ramp in front of Building 1. New furniture will also be provided.

A new COLA will be added alongside the existing hall which will be extended and upgraded with an accessible ramp and new audio visual equipment.

Construction will continue on Stage 2 throughout Terms 1 and 2 2023.

What are the construction hours for this project?

Standard construction hours for this project are 7 am to 5 pm Monday to Saturday. No works will take place on Sundays or public holidays, unless otherwise notified.

Contact us

For more information about this project, contact School Infrastructure NSW:

Website: schoolinfrastructure.nsw.gov.au

Email: schoolinfrastructure@det.nsw.edu.au

Phone: 1300 482 651

For information about school activities and operations, contact the school directly:

Principal: Rob McPherson

Website: bletchingt-p.schools.nsw.gov.au

Email: bletchingt-p.school@det.nsw.edu.au

Phone: 02 6362 3422



Translation and Interpreting Service

If you require interpreter services in **Arabic, Bengali, Hindi, Nepali, Urdu** or any other language call **131 450** and ask this Translation and Interpreting Service to phone School Infrastructure NSW on **1300 482 651**.

