

Bexhill Public School

Works notification

Friday 1 July

A project is underway to upgrade Bexhill Public School. The project will deliver: five new permanent learning spaces, an upgraded administration building, an upgraded OSCH and staff spaces in the former principal's residence, refurbishment of the community hall for shared use by the school, and an upgraded sports court and landscaping.

Site establishment for main works during July school holidays

Starting Wednesday 13 July 2022, works to establish the construction site for main works will start. Temporary fencing around the works area will be installed to ensure the safety of students, staff and visitors. A site offices sheds and toilet will also be installed within the work zone.

As part of the site preparation works to allow for construction of the new school facilities, 20 trees are to be removed from within the works zone. The removal of these trees has been approved by Lismore City Council under the Development Application for the project. Additional trees will be replanted as part of landscaping works.

Changes to school operations: Temporary relocation of the playground

For the first five weeks of work, the current play space will be impacted. To compensate for this disruption, a temporary green play space will be provided in the north-west area of the school while earthworks are undertaken. Play space arrangements will return to normal after this work is complete.

Please refer to the map overleaf for further details.

Working hours

Standard construction working hours will be 7:00am to 6:00pm Monday to Friday, and 8:00am to 1:00pm on Saturdays. No work will take place on Sundays or public holidays unless otherwise notified.

Next steps

In the weeks following site establishment, works will begin on the new school building. School Infrastructure will continue to work closely with the school leadership team to ensure continuity of school operations and to minimise impacts from construction. Thank you for your patience while we deliver this important school infrastructure project.

If you have any questions or concerns contact us on the details below or visit the webpage for more information:

<https://www.schoolinfrastructure.nsw.gov.au/projects/b/bexhill-public-school-upgrade.html>

For more information contact:

School Infrastructure NSW
Email: schoolinfrastructure@det.nsw.edu.au
Phone: 1300 482 651
www.schoolinfrastructure.nsw.gov.au

Site Map

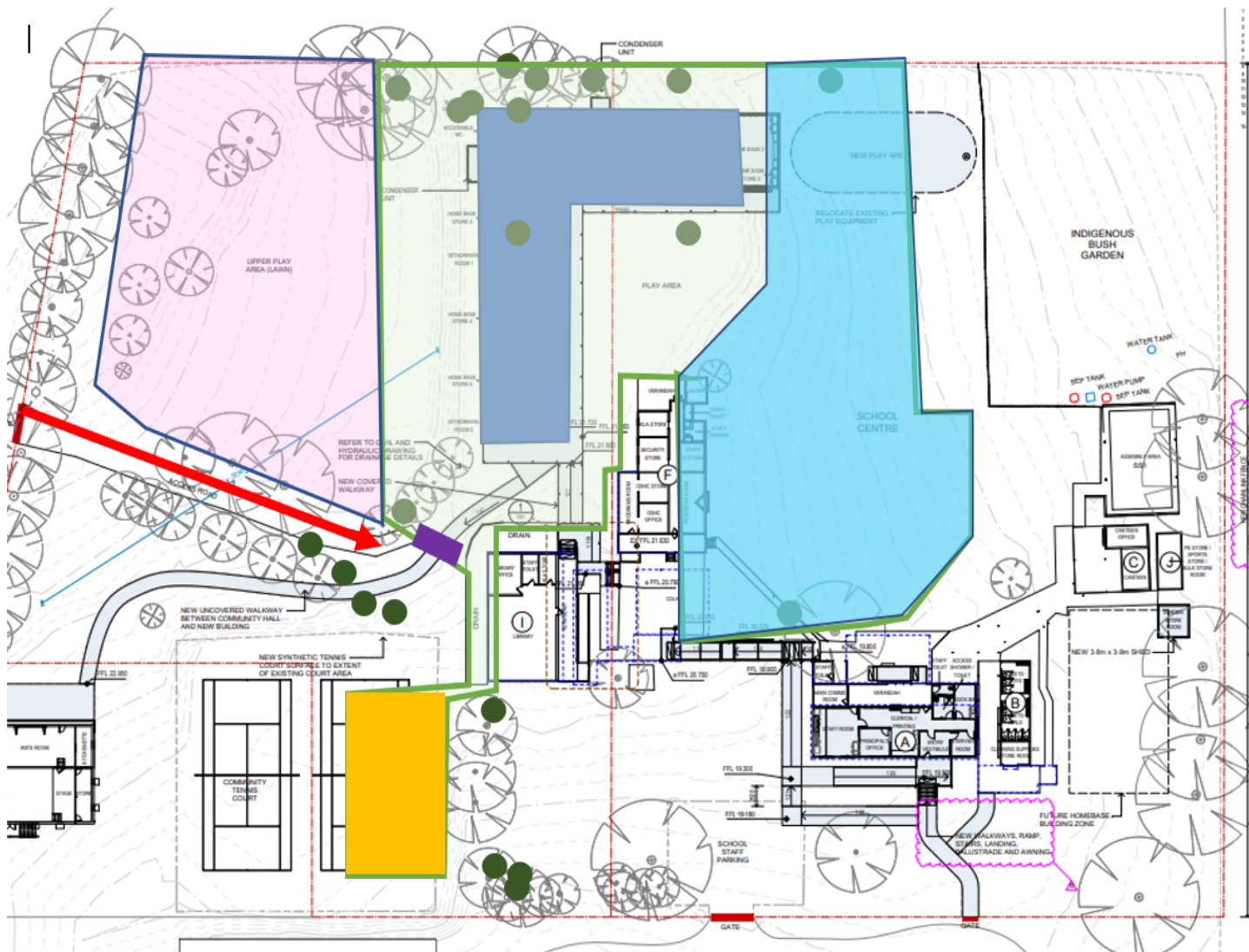

Legend

New School Area



Works area



Temporary fence

Site office, shed toilet



Works zone gate



Vehicle entry/exit

Trees to be removed



Temporary Oval Space

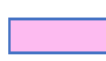

Existing play space



For more information contact:

School Infrastructure NSW
Email: schoolinfrastructure@det.nsw.edu.au
Phone: 1300 482 651
www.schoolinfrastructure.nsw.gov.au

