

# Bangalow Public School

## Works notification

September 2021

A project is underway to upgrade Bangalow Public School. The project includes new and refurbished learning spaces, refurbished administration spaces, conversion of existing spaces for a new library and landscaping.

### Site establishment

Early works for the Bangalow Public School upgrade will start with the refurbishment of Blocks F and H. These works are being done under a Review of Environmental Factors (REF), while the Development Application (DA) for the remainder of the upgrade is being assessed by Byron Shire Council.

Site sheds, temporary fencing and solid hoarding will be installed at the School in the week starting 20 September 2021.

Site sheds will be delivered by flat bed and tilt tray trucks and unloaded with either a truck mounted crane or tilt tray trucks. See map overleaf for the site establishment area. Once set up, temporary services (water and electricity) will then be connected to site sheds.

Vehicle access to the works zone during and after establishment will be via Market Street and the Showground Ring Road.

Construction staff will park in the Showground Ring Road as shown in the map overleaf.

### Traffic management

Traffic management will be in place to safely direct traffic and pedestrians. All construction traffic will enter and exit in a forward-facing direction.

Deliveries for early works will use the Showground Ring Road off Market Street. Onsite traffic control personnel will be present to manage entry and exit of construction vehicles. Site vehicles will give way to pedestrians at all times. Where possible deliveries to the site will be made outside of peak drop off and pick up times.

Gates to the site compound are to be kept closed when not in use and contractor emergency contact details will be displayed at the compound entry.

### Next steps – refurbishment of Block F

In the weeks following site establishment work will begin to refurbish Block F to provide a new library including flexible learning space, a library office and storage. This work will include internal demolition of walls and reconfiguration of the building internal layout.

School Infrastructure NSW (SINSW) will work closely with the school leadership team to ensure continuity of school operations and to minimise any potential impact on student learning during construction.

Works will start on Block H following the completion of Block F refurbishment works.

---

#### For more information contact:

School Infrastructure NSW  
Email: [schoolinfrastructure@det.nsw.edu.au](mailto:schoolinfrastructure@det.nsw.edu.au)  
Phone: 1300 482 651  
[www.schoolinfrastructure.nsw.gov.au](http://www.schoolinfrastructure.nsw.gov.au)

## Hours of work

Works will be completed between the hours of 7 am and 5 pm Monday to Saturdays, with no work on public holidays or Sundays unless otherwise notified.

We are here to make sure that the works are completed safely and efficiently and we will minimise impacts on the community at every opportunity.

Thank you for your patience while we deliver this important school infrastructure.

## Site map

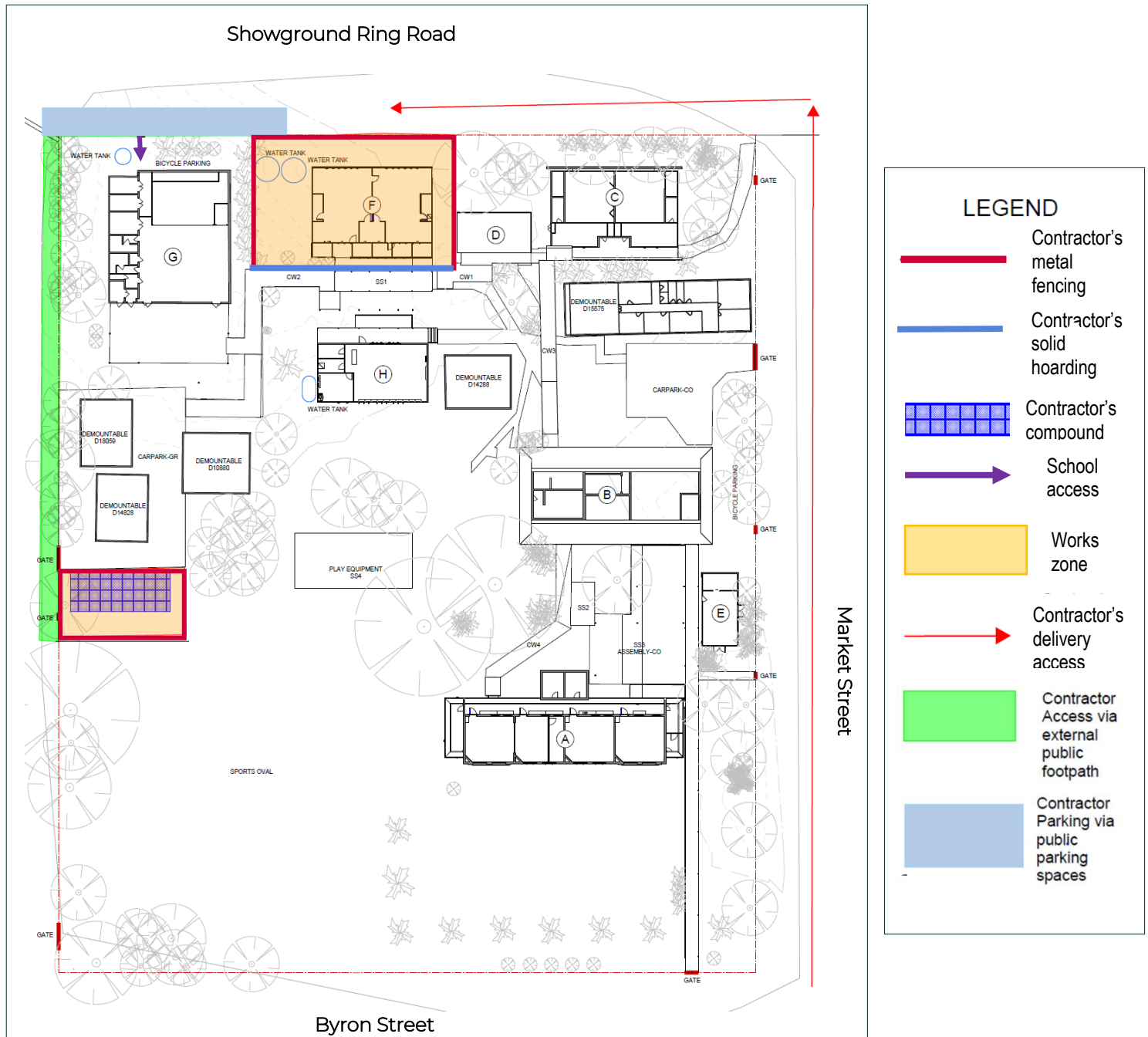

### For more information contact:

School Infrastructure NSW  
Email: [schoolinfrastructure@det.nsw.edu.au](mailto:schoolinfrastructure@det.nsw.edu.au)  
Phone: 1300 482 651  
[www.schoolinfrastructure.nsw.gov.au](http://www.schoolinfrastructure.nsw.gov.au)