



New classroom building (Building I) Bangalow Public School

# Bangalow Public School Upgrade

Welcome Pack | June 2023

## Welcome to your new classrooms

We are excited that your new school facilities are ready for you to use. The upgrade to your school includes:



8 new flexible learning spaces



New accessible amenities block



Refurbished library and classroom

The next stage of upgrade work to your school will include:



Refurbished administration spaces



Landscaping

Thank you for your patience during construction. We are thrilled to deliver this project for your school community and hope that you enjoy your new spaces.

# Message from your Principal

This week, many of our students and teachers in Years 1-6 will be moving into our beautiful new building, which already has brand new flexible furniture in place. The new building is an important milestone that I am very excited about. It provides 8 new learning spaces (classrooms) in a bright, two-storey building overlooking our school grounds. Each pair of classrooms share a withdrawal room and practical activities area, creating four 'pods'. The building and classrooms look fantastic, and I am sure that our students, teachers and community will love these impressive new spaces as much as I do.

Our new amenities block is also ready for us to use. The new buildings are in addition to our larger, refurbished

library, and previously refurbished classroom, which were both completed last year.

There is even more work happening during 2023 on our school buildings and grounds. Once it is finished, our school upgrade will provide a learning environment that will further help our students learn and thrive.

I am so proud of our students, staff and families at Bangalow Public School and the supportive environment we nurture together. Thank you everyone for your patience throughout the process.

**Carol Antoun, Principal**

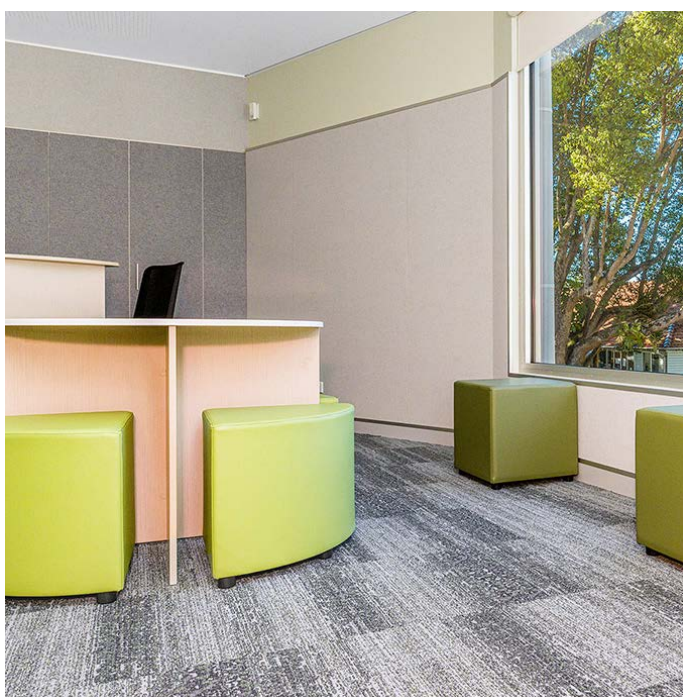

First floor learning space

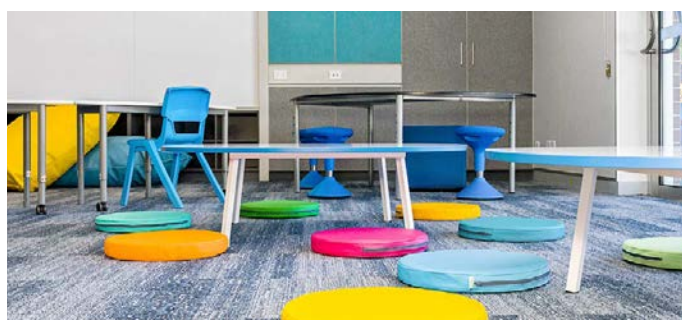

Year 1 and 2 learning spaces, ground floor



New flexible learning spaces on first floor



New flexible learning spaces on the ground floor



# New flexible learning spaces

## Ground floor

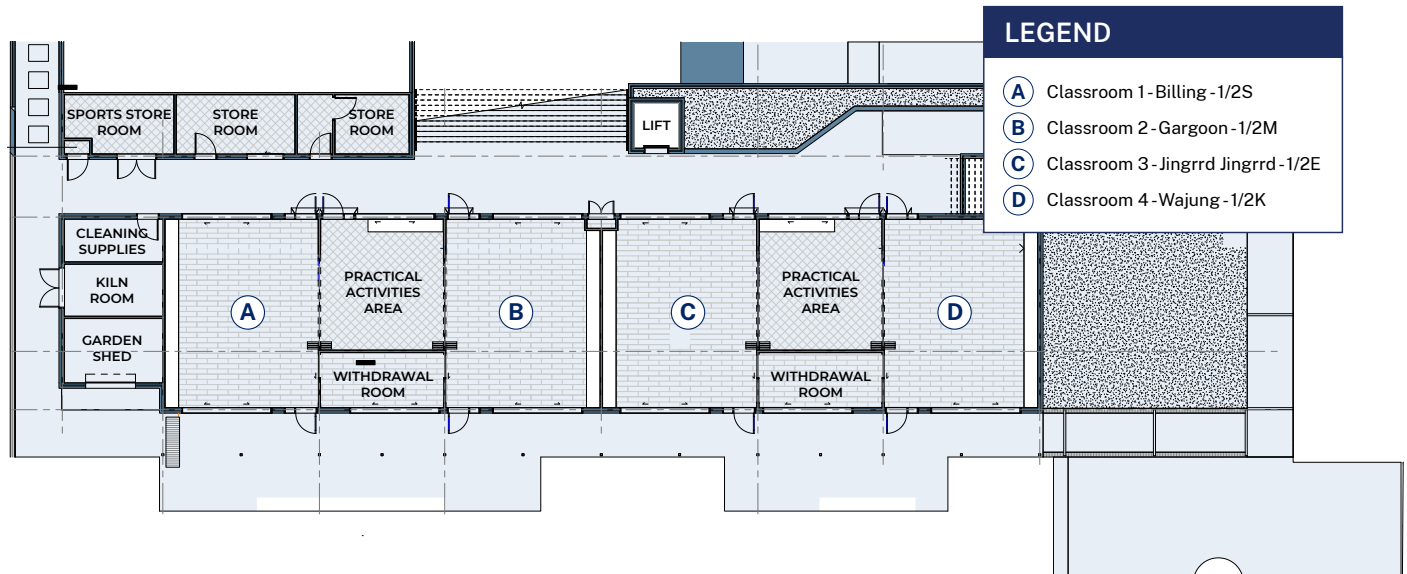

## First floor

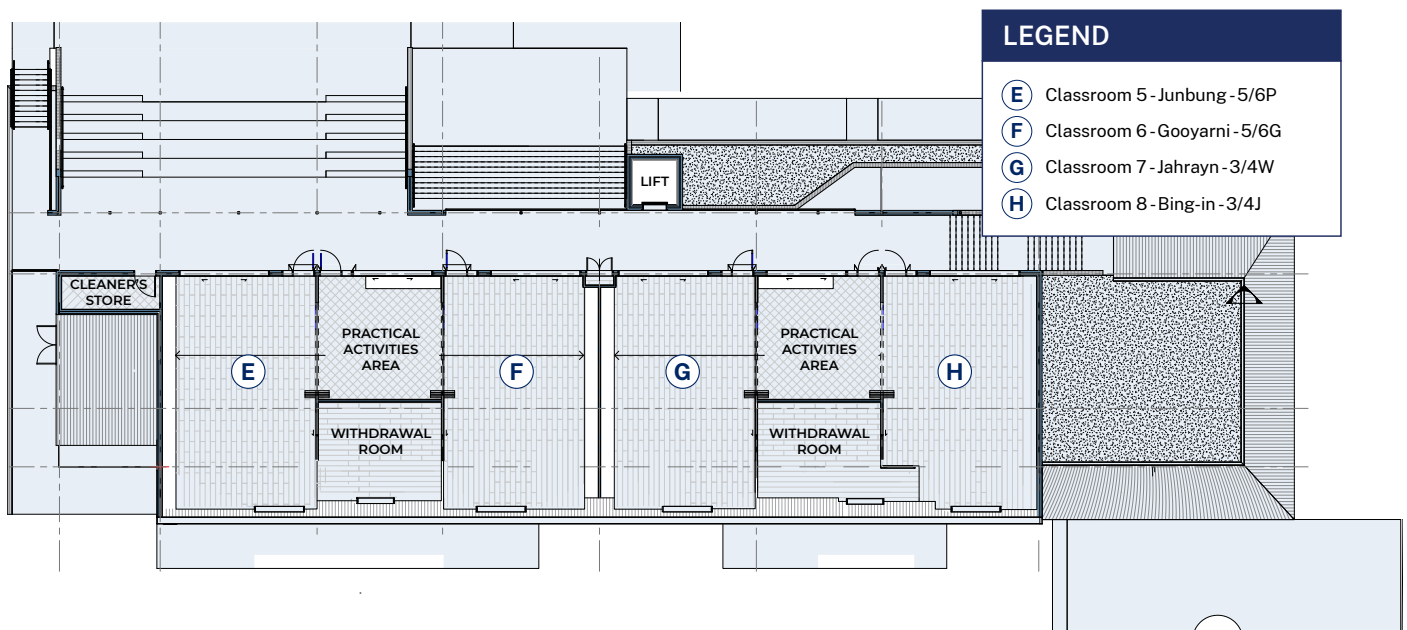

The new classroom building at Bangalow Public School includes 8 flexible learning spaces that allow teachers to move walls and:

- bring two classes together, or teach in smaller groups
- provides opportunities for inclusive learning zones with break-out spaces that enable students to learn in new ways and with new technologies
- allows Bangalow Public School students to build skills in collaboration, communication, critical thinking, problem solving and creativity through our Contemporary Learning Modes.

The classrooms are connected by covered walkways, with bag racks located outside classrooms for students.

The ground floor also includes a new kiln for the school.

# Accessible spaces

Bangalow Public School's new classroom building includes ramps and a lift.

The new amenities block includes girl's toilets, an accessible toilet, change area and laundry.

The buildings are connected by a new covered walkway.

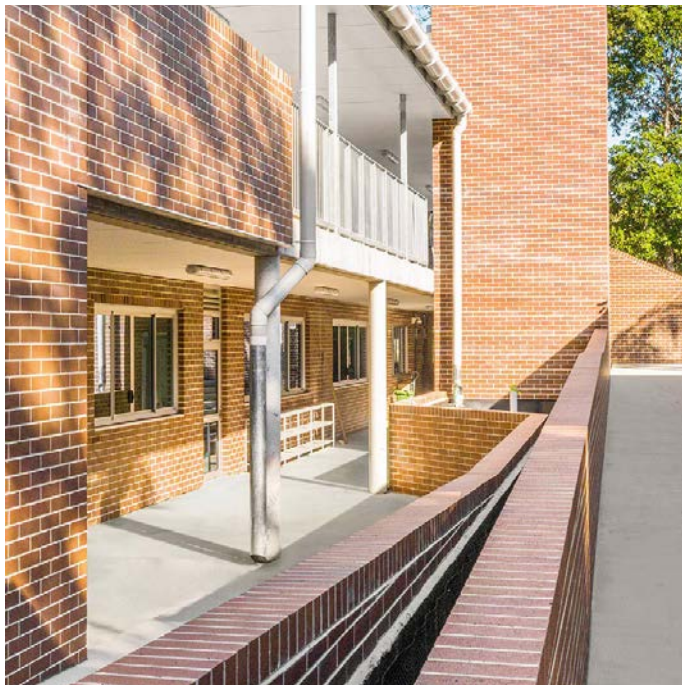

The new classroom building



New accessible amenities block



New amenities block

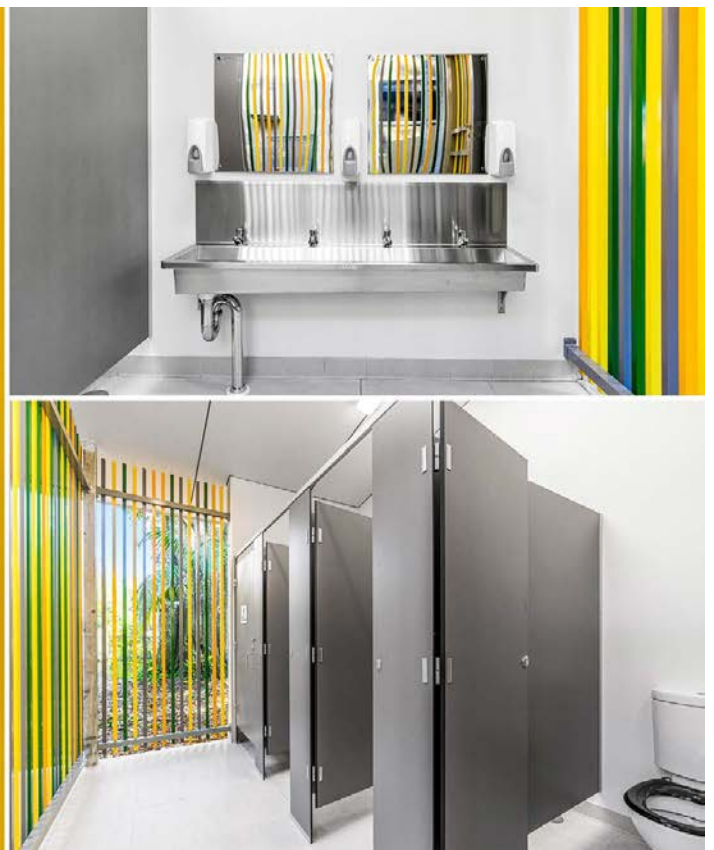



# New site map

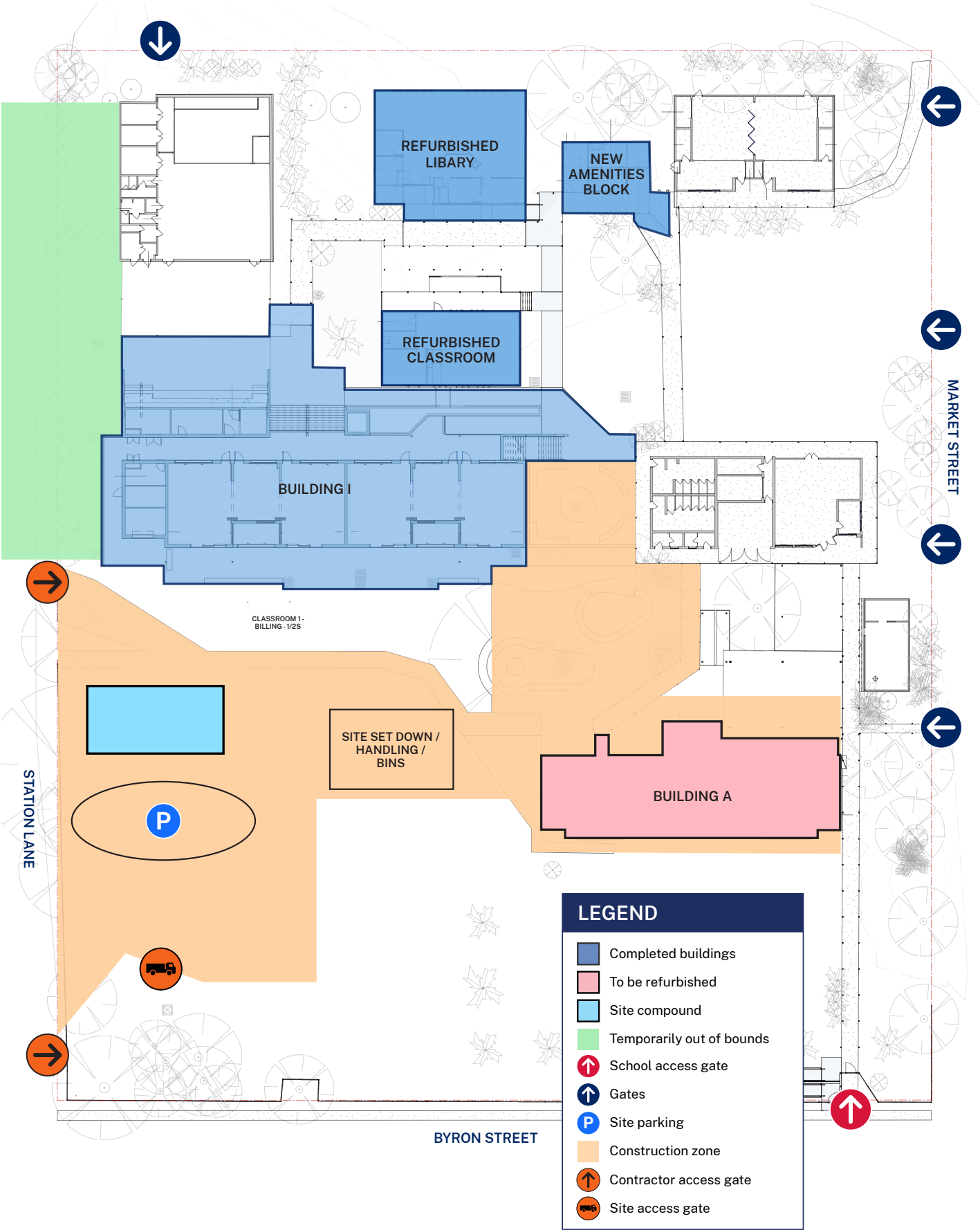

## Frequently asked questions

### Which classes will be using the classrooms in Building I?

Years 1 and 2 will move into flexible classroom spaces on the ground floor. Year 3, 4, 5 and 6 will learn from spaces on the first floor.

### What is the pale green area on the school map?

The area on the ground floor of the Station Lane side of the building will be temporarily out of bounds while a new handrail is being fitted.

### What work is next in the upgrade?

The demountable buildings at the front of Building A will be removed from the school. This will not impact access to the school or day to day operations. We will provide more information about this before the work happens.

Now that students are moving into their new classrooms, the heritage building (Building A) will be refurbished to provide a new location for the administration spaces. Once this work is complete, administration staff will relocate into the heritage building and the existing administration demountable building will be removed.

The project also includes improvements to the school grounds, including landscaping and new seating areas.

### When will the upgrade be completed?

We are aiming to complete the upgrade in early 2024. This is dependent on weather.

### Will there still be construction fencing in the school grounds?

Yes. Now the new classroom building is finished, construction fencing will be moved to allow the next stages of work to be done safely. This includes fencing around the heritage building, Building A. Please see school map for more information.

Contractor access will continue to be via Station Lane.

### Will there be any changes to the school entrances?

Students will continue to enter the school via the entrance behind the hall, and also the Market Street and Byron Street entrances.

## Contact us

For more information about this project, contact School Infrastructure NSW:

**Website:** [schoolinfrastructure.nsw.gov.au](https://schoolinfrastructure.nsw.gov.au)

**Email:** [schoolinfrastructure@det.nsw.edu.au](mailto:schoolinfrastructure@det.nsw.edu.au)

**Phone:** 1300 482 651

For information about school activities and operations, contact the school directly:

**Principal:** Carol Antoun

**Website:** [bangalow-p.schools.nsw.gov.au](https://bangalow-p.schools.nsw.gov.au)

**Email:** [bangalow-p.school@det.nsw.edu.au](mailto:bangalow-p.school@det.nsw.edu.au)

**Phone:** 02 6687 1434