

Kingsgrove Public Preschool

Project update | November
2024



As part of NSW Government's plan to rebuild public education, the 2024-25 Budget is continuing a \$769 million investment to deliver 100 new public preschools, including new preschools on future primary school sites.

Supporting early childhood education at Kingsgrove Public School

The new public preschool in Georges River will be located at Kingsgrove Public School.

The location of the public preschool has been selected based on careful evaluation and selection criteria with considerations to educational need and demand, how children grow and learn, infrastructure feasibility, and insights gained through consultation.

The new preschool is scheduled to be open by 2027. The school will communicate with their community when enrolment applications can be taken, which is expected to be approximately 6 months before the preschool opening date.

Progress update

We are pleased to confirm that as designs are being finalised, the tender has been released for construction contractors.

To complete master plans more efficiently, we have adopted a standardised design approach which has been developed in consultation with educational experts as well as design and engineering specialists. This approach also complies with the National Quality Framework (NQF).

The key design principles for our new public preschools are that they should be welcoming and safe, connected with community and the environment, and inclusive, quality play-based learning environments.

Each project has established a Project Reference Group (PRG) made up of school and department leadership representatives, and a school community representative.



Email: schoolinfrastructure@det.nsw.edu.au
Phone: 1300 482 651
www.schoolinfrastructure.nsw.gov.au

Example playroom layout (indicative only)

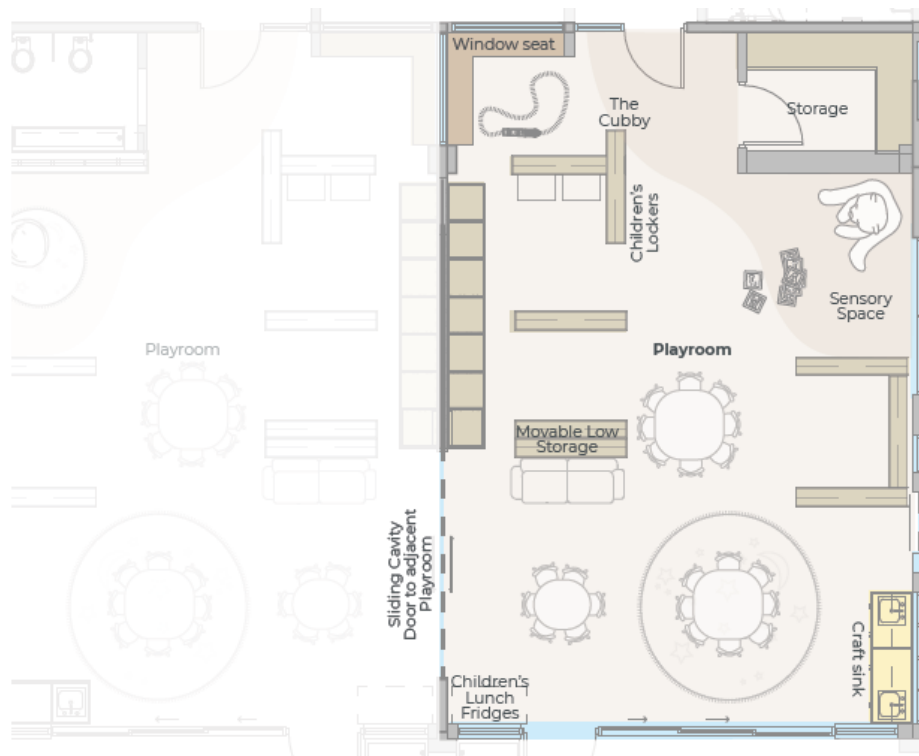

Next steps

The next steps are to finalise the location of the preschool on the public school site and then finalise the design.

As the project progresses, we will provide more information, including the construction and delivery timeline for the preschool. A timeline for the preschool will be provided after each site receives development approval.

How can I stay updated?



As the project progresses, we will share details with the community for feedback. You can view the project page for Kingsgrove Public Preschool by visiting edu.nsw.link/KingsgrovePS-Preschool or by scanning the QR code.