

# Public Preschools in Cessnock

Project update | November 2024



As part of NSW Government's plan to rebuild public education, the 2024-25 Budget is continuing a \$769 million investment to deliver 100 new public preschools, including new preschools on future primary school sites.

## Supporting early childhood education in Cessnock

The new public preschools in Cessnock will be located at Nulkaba Public School, Weston Public School, Cessnock Public School, Kurri Kurri Public School, Kearsley Public School and Ellalong Public School. The preschools will be co-located on existing public primary school sites.

The locations of the public preschools have been selected based on careful evaluation and selection criteria with considerations to educational need and demand, how children grow and learn, infrastructure feasibility, and insights gained through consultation.

The new preschools are scheduled to be open by 2027. Each school will communicate with their community when enrolment applications can be taken, which is expected to be approximately 6 months before the preschool opening date.

## Progress update

We are pleased to confirm that as designs are being finalised, tenders are set to be released in the coming months for construction contractors.

To complete master plans more efficiently, we have adopted a standardised design approach which has been developed in consultation with educational experts as well as design and engineering specialists. This approach also complies with the National Quality Framework (NQF).

The key design principles for our new public preschools are that they should be welcoming and safe, connected with community and the environment, and inclusive, quality play-based learning environments.



Each preschool has established a Project Reference Group (PRG) made up of school and department leadership representatives, and a school community representative.

**Map of new public preschools in Cessnock**

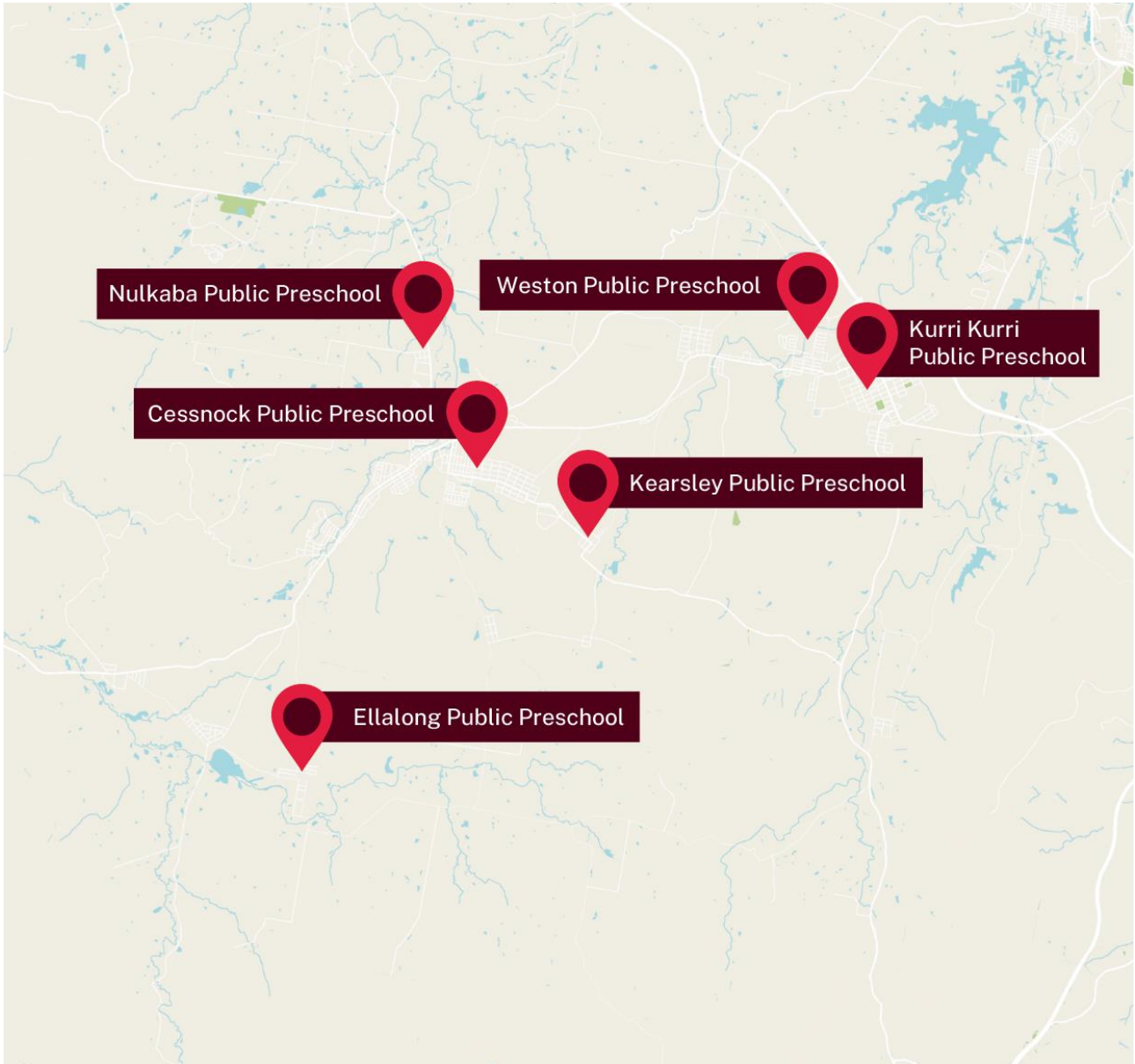

## Example playroom layout (indicative only)

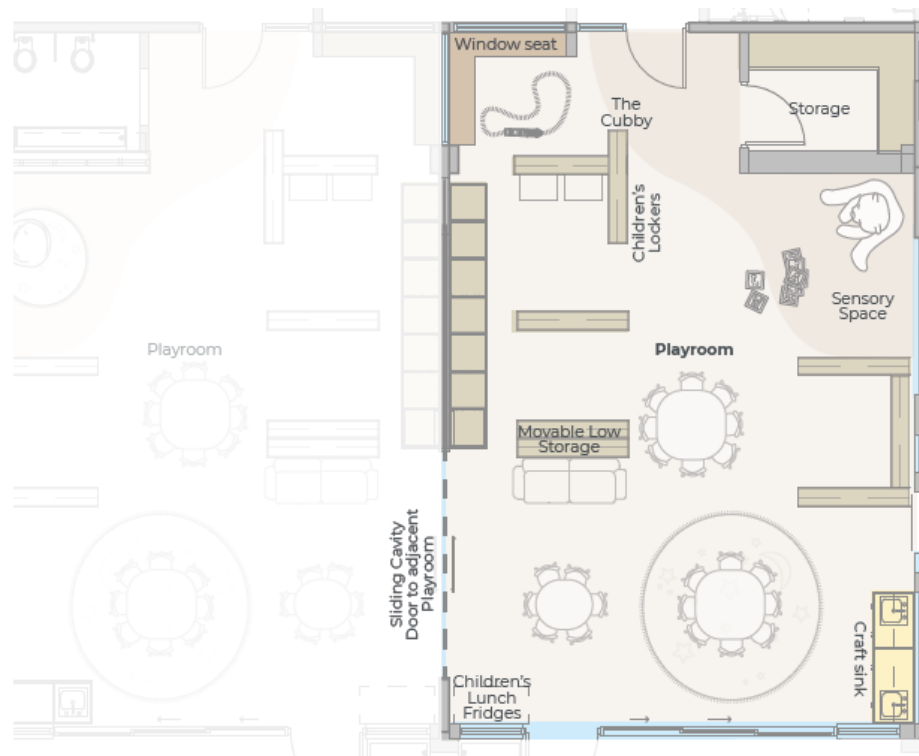

### Next steps

The next steps are to finalise the location of each preschool on each public school site and then finalise the design.

As the projects progress, we will provide more information, including the construction and delivery timeline for each preschool. A timeline for each preschool will be provided after each site receives development approval.

### How can I stay updated?

As the project progresses, we will share details with the community for feedback. A dedicated project page for each preschool will be updated as the project progresses. You can view the project page by visiting [schoolinfrastructure.nsw.gov.au](https://schoolinfrastructure.nsw.gov.au) and searching the name of the preschool.