

Public Preschools in Campbelltown

Project update | November 2024



As part of NSW Government's plan to rebuild public education, the 2024-25 Budget is continuing a \$769 million investment to deliver 100 new public preschools, including new preschools on future primary school sites.

Supporting early childhood education in Campbelltown

The new public preschools in Campbelltown will be located at Curran Public School, Sackville Street Public School, Robert Townson Public School, Kearns Public School, Eschol Park Public School, Blairmount Public School, Leumeah Public School, Ruse Public School, Bradbury Public School, Thomas Acres Public School and Woodland Road Public School.

The preschools will be co-located on existing public primary school sites.

The locations of the public preschools have been selected based on careful evaluation and selection criteria with considerations to educational need and demand, how children grow and learn, infrastructure feasibility, and insights gained through consultation.

The new preschools are scheduled to be open by 2027. Each school will communicate with their community when enrolment applications can be taken, which is expected to be approximately 6 months before the preschool opening date.

Progress update

We are pleased to confirm that as designs are being finalised, the tender has been released for construction contracts for Curran Public Preschool, Sackville Street Public Preschool, Robert Townson Public Preschool, Kearns Public Preschool, Eschol Park Public Preschool, Blairmount Public Preschool, Leumeah Public Preschool, Ruse Public Preschool, Bradbury Public Preschool, Thomas Acres Public Preschool and Woodland Road Public Preschool.

To complete master plans more efficiently, we have adopted a standardised design approach which has been developed in consultation with educational experts as well as design and engineering specialists. This approach also complies with the National Quality Framework (NQF).



Email: schoolinfrastructure@det.nsw.edu.au
Phone: 1300 482 651
www.schoolinfrastructure.nsw.gov.au

The key design principles for our new public preschools are that they should be welcoming and safe, connected with community and the environment, and inclusive, quality play-based learning environments.

Each preschool has established a Project Reference Group (PRG) made up of school and department leadership representatives, and a school community representative.

Map of new public preschools in Campbelltown

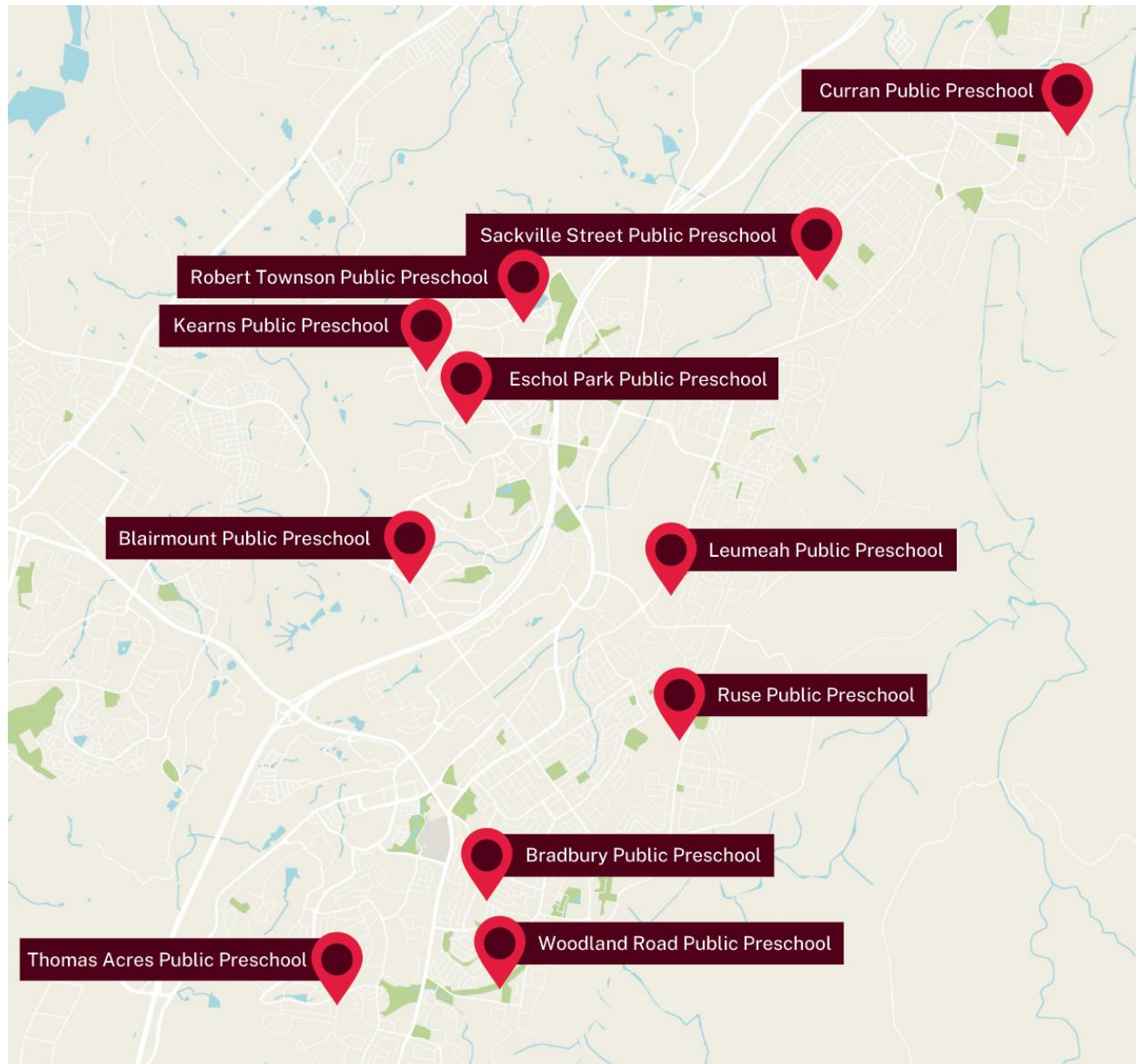

Example playroom layout (indicative only)

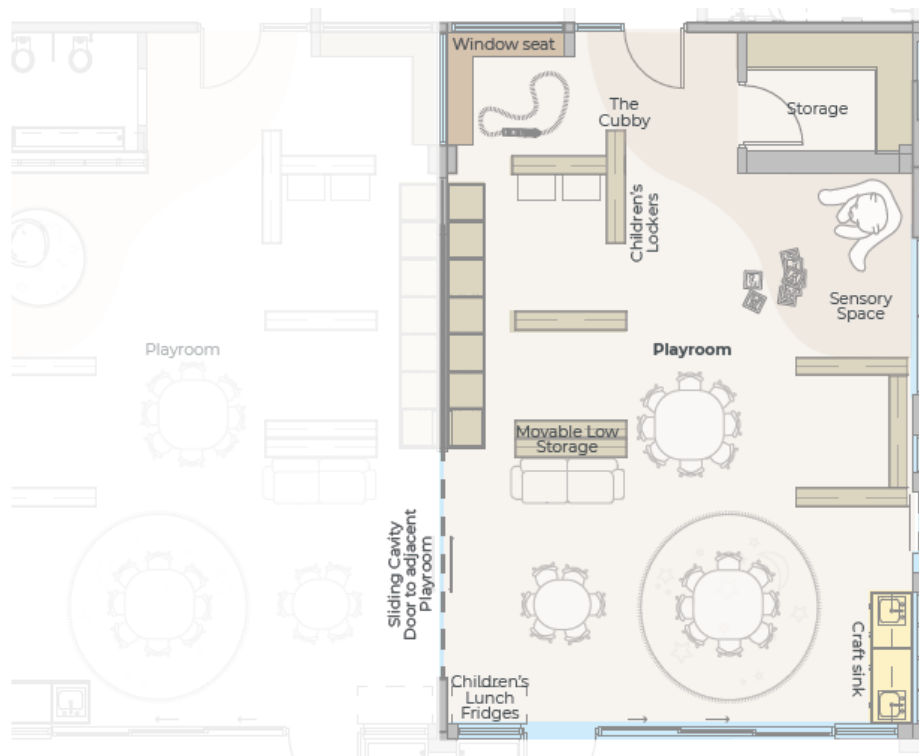

Next steps

The next steps are to finalise the location of each preschool on each public school site and then finalise the design.

As the projects progress, we will provide more information, including the construction and delivery timeline for each preschool. A timeline for each preschool will be provided after each site receives development approval.

How can I stay updated?

As the project progresses, we will share details with the community for feedback. A dedicated project page for each preschool will be updated as the project progresses. You can view the project page by visiting schoolinfrastructure.nsw.gov.au and searching the name of the preschool.