

# Public Preschools in Blacktown

Project update | November 2024



As part of NSW Government's plan to rebuild public education, the 2024-25 Budget is continuing a \$769 million investment to deliver 100 new public preschools, including new preschools on future primary school sites.

## Supporting early childhood education in Blacktown

The new public preschools in Blacktown will be located at Blackett Public School, Melonba Public School, Nirimba Fields Public School, Shalvey Public School, Blacktown North Public School, Emerton Public School, Hebersham Public School, Lynwood Park Public School and Crawford Public School.

The preschools will be co-located on public primary school sites.

The locations of the public preschools have been selected based on careful evaluation and selection criteria with considerations to educational need and demand, how children grow and learn, infrastructure feasibility, and insights gained through consultation.

The new preschools are scheduled to be open by 2027. Each school will communicate with their community when enrolment applications can be taken, which is expected to be approximately 6 months before the preschool opening date.

## Progress update

We are pleased to confirm that as designs are being finalised, the tender has been released for construction contractors for Blackett Public Preschool, Shalvey Public Preschool, Blacktown North Public Preschool, Emerton Public Preschool, Hebersham Public Preschool, Lynwood Park Public Preschool and Crawford Public Preschool.

The tender for the construction contractor for the permanent Nirimba Fields Public School and public preschool was released in August 2024.

The preschool at Melonba Public School is in the early planning stage.

To design preschools more efficiently, we have adopted a standardised design approach which has been developed in consultation with educational experts as well as design and



Email: [schoolinfrastructure@det.nsw.edu.au](mailto:schoolinfrastructure@det.nsw.edu.au)  
Phone: 1300 482 651  
[www.schoolinfrastructure.nsw.gov.au](http://www.schoolinfrastructure.nsw.gov.au)

engineering specialists. This approach also complies with the National Quality Framework (NQF).

The key design principles for our new public preschools are that they should be welcoming and safe, connected with community and the environment, and inclusive, quality play-based learning environments.

Each preschool is working within a governance framework, including a Project Reference Groups (PRG) made up of school and department leadership representatives, and a school community representative.

### Map of new public preschools in Blacktown

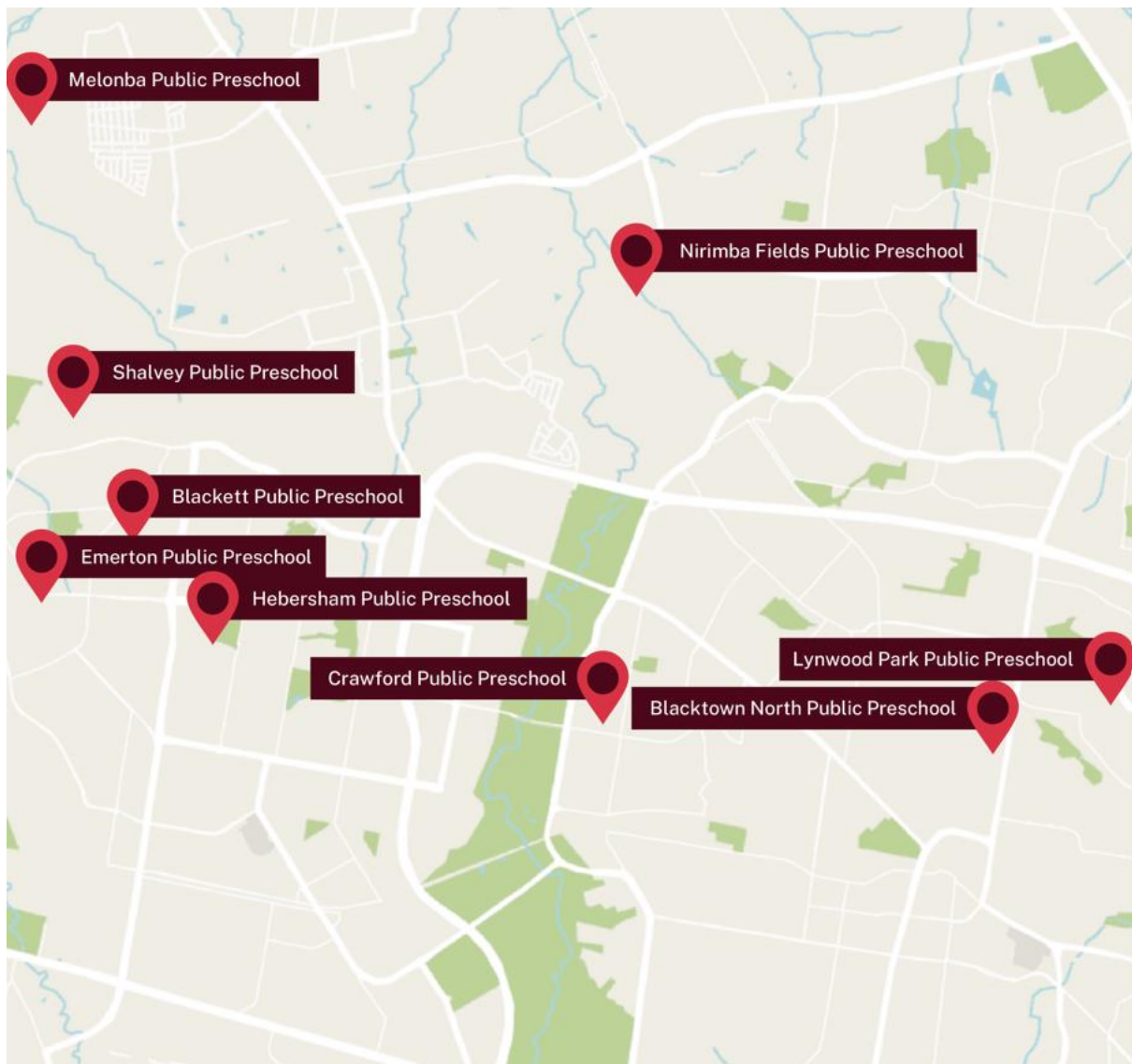

## Example playroom layout (indicative only)

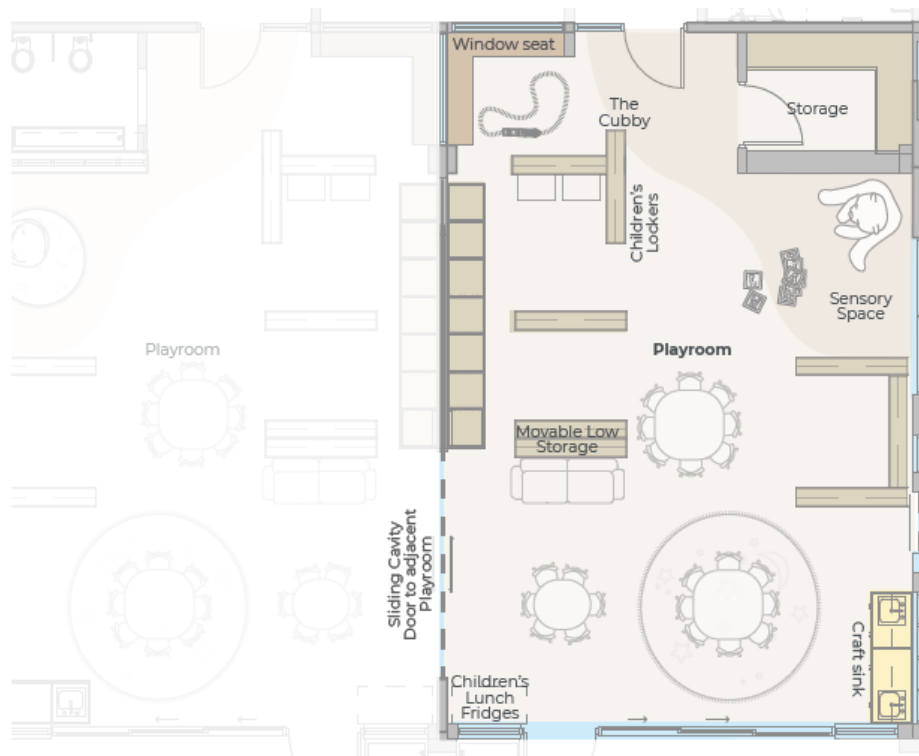

## Next steps

The next steps are to finalise the location of each preschool on each public school site and then continue to develop the design.

As the projects progress, we will provide more information, including the construction and delivery timeline for each preschool. A timeline for each preschool will be provided after each site receives development approval.

## How can I stay updated?

As the project progresses, we will share details with the community for feedback. A dedicated project page for each preschool will be updated as the project progresses. You can view the project page by visiting [schoolinfrastructure.nsw.gov.au](https://schoolinfrastructure.nsw.gov.au) and searching the name of the preschool.