

Arthur Phillip High School

Everything you need to know for starting at the new school

November 2019



The NSW Government is investing \$6.7 billion over the next four years to deliver 190 new and upgraded schools to support communities across NSW. In addition, a record \$1.3 billion is being spent on school maintenance over five years. This is the largest investment in public education infrastructure in the history of NSW.



New, modern and flexible learning and teaching facilities for up to 2,000 high school students



Technology-rich learning spaces



Specialist teaching facilities



Enhanced open spaces



Large amphitheatre



A new gymnasium and recreational areas for high school students



Connected outdoor spaces that enable play and collaborative learning

Project overview

A project to redevelop Arthur Phillip High School into the first public high-rise high school in NSW is almost complete.

The new high school will be ready for the start of school in 2020 and will:

- Accommodate up to 2,000 students
- Incorporate flexible learning spaces with adaptable / moveable furniture and room configurations
- Include technology-rich learning environments, with an emphasis on mobility and flexibility, and
- Deliver innovative, connected outdoor spaces that enable play and collaborative learning.

Staged delivery

The project will be delivered in stages:

- **Initial stage** – new learning spaces and facilities to open for Years 7-12 students for Day 1, Term 1, 2020.
- **Final stage** – non-heritage buildings within the existing APHS to be removed and converted into outdoor play areas (to be completed by late 2020).

Back to school in 2020

Where is the new Arthur Phillip High School located?

Ready for the first day back at school 2020, Arthur Phillip High School will move into its new high-rise school on Macquarie Street. The school entry will be from Macquarie Street and will provide both pedestrian and accessible access.

Tours of the new school

The Department is delighted to deliver this landmark education project for students, families and the broader community.

An opportunity to tour the school will be available in early 2020. More details will be shared at the end of Term 4.

Additional tours for the school community will take place in Terms 1 and 2 during key school events.

When do I return to school?

As is normal practice in many high schools, year groups will return to school on consecutive days.

- Thursday 30 January 2020 – Years 11 and 12 (8:40am) for their orientation to the new school building before returning for full classes on Tuesday 4 February 2020
- Friday 31 January 2020 – Year 7 (8:30am) for their orientation to high school and the new school building before returning for full classes on Tuesday 4 February 2020
- Monday 3 February 2020 – Years 8, 9 and 10 (8:50am) for their orientation to the new school building before returning for full classes on Tuesday 4 February 2020.

When does the school day start and finish?

In 2020:

- Year 7 & 8 will start school at 8:30am and finish school at 3:00pm everyday, except Wednesday will finish at 2:20pm
- Year 9 & 10 will start school at 8:50am and finish school at 3:20pm everyday, except Tuesday and Wednesday will finish at 2:40pm
- Year 11 & 12 will start at 8:40am and finish school at 3:10pm everyday, except Wednesday will finish at 1:30pm

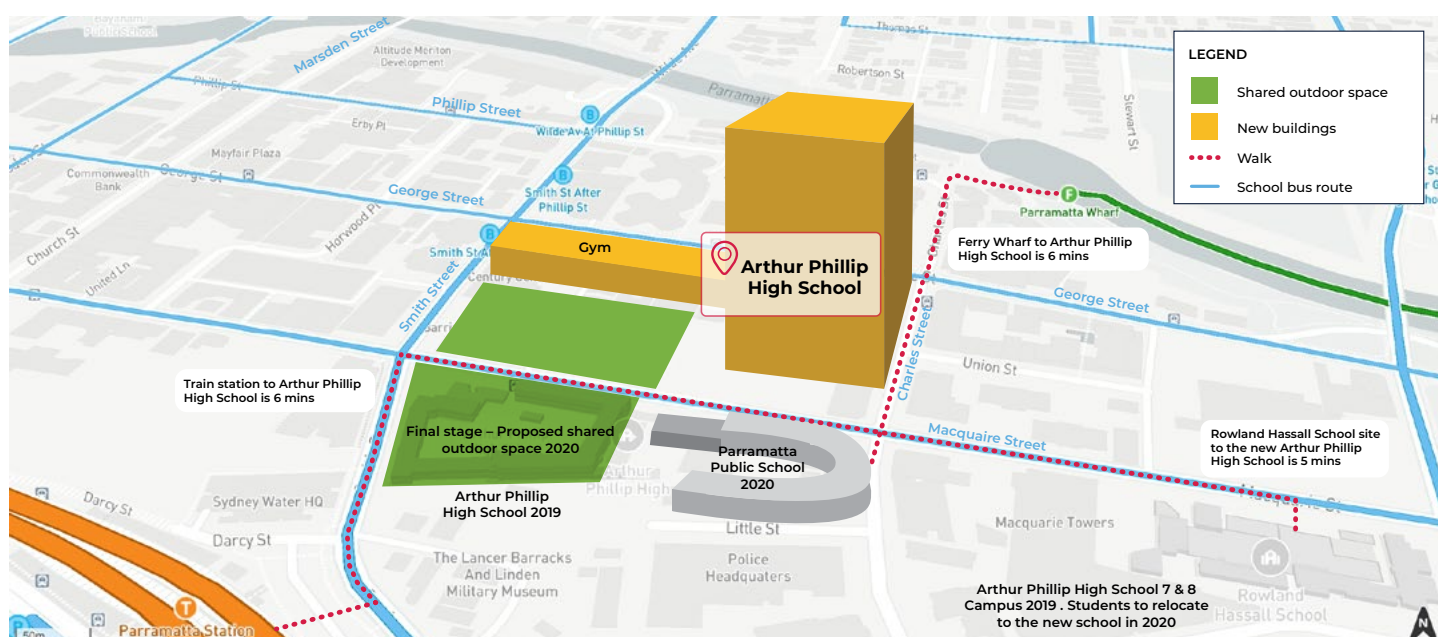

What to expect

Welcome to your new school



Arthur Phillip High School entrance on Macquarie Street

Where do I go?

The first day of the 2020 school year will be exciting for the students, teachers and parents of Arthur Phillip High School. Guides will be in place around the surrounding streets to direct students to the main entry of the new school. Please review the following important information for your first day back at school:

1. Enter the main entrance on Macquarie Street.
2. Students will meet staff in front of the new school gym and then you will be escorted into the auditorium where you will be seated in your class groups.
3. Principal's welcome will cover key information about your new school and you will be issued with your swipe access card and timetable.
4. Each class will then be escorted to your dedicated Learning Hub level and given a tour of the new spaces.

What's in my Learning Hub?

The new facilities will incorporate flexible learning spaces with adaptable/moveable furniture and room configurations.

The learning spaces will be technology-enabled to serve multiple learning contexts from large class groups to small clusters, providing better opportunities for collaboration and personalised learning and prepares the student to solve complex, real world problems and inspire entrepreneurial leadership.

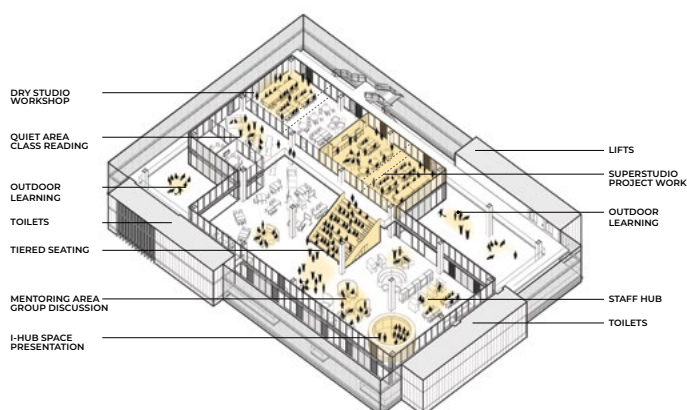

What's on each level?



Lower ground – Welcome Centre

Ground – Movement and Sound Hubs, Canteen and Gym

Level 1 – Development Hubs and Design Hubs

Level 2 – Learning Hub Year 7 (Red)

Level 3 – Learning Hub Year 8 (Blue)

Level 4 – Learning Hub Year 9 (Magenta)

Level 5 – Development Hubs and Design Hubs

Level 6 – Learning Hub Year 10 (Green)

Level 7 – Learning Hub Year 11 (Yellow)

Level 8 – Learning Hub Year 12 (Light Blue)

Level 9 – Development Hubs

When will I get my timetable?

Students will receive their timetable on the first day they return to school.

When are the break times?

All students will have three breaks during the school day. Recess 1, Recess 2 and Lunch.

What's inside our first high-rise public school

What does the new school look like?

Arthur Phillip High School will be ready for the first day back to school in 2020.



Artist impression of the Arthur Phillip High School upgrade

The following images are photographs of a completed learning hub for Year 7 located on Level 2. During Term 3 and 4, students and staff have visited the completed level, tested classroom configurations and received training to support the transition and orientation into the new learning environment.

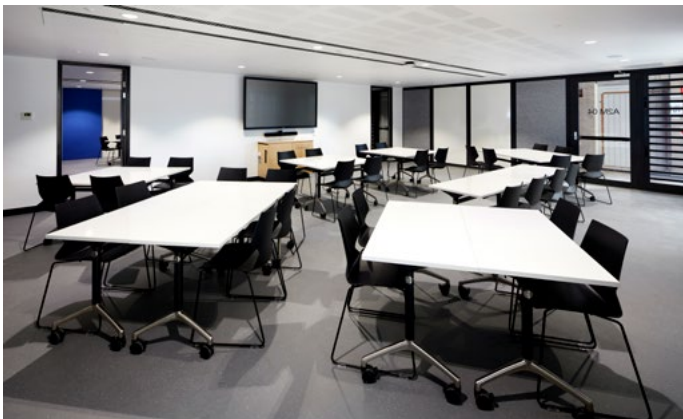

Example of a dry studio learning space



Example of a wet studio learning space



Example of a small seminar room



Tiered seating and open learning spaces available for each Learning Hub



I-Hub learning space

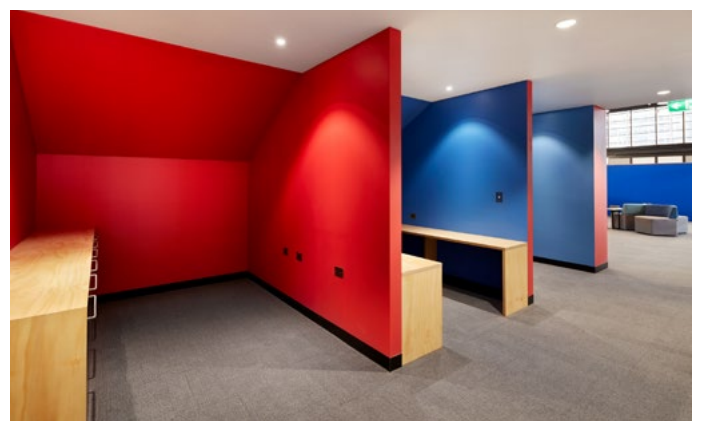

Study and small team work areas

While we are putting on the finishing touches, there are new specialised learning spaces supporting STEAM learning for all year groups.



Artist impression of Level 5 Development and Design Hubs



Artist impression of Level 5 Development and Design Hubs



Artist impression of Level 5 Development and Design Hubs



Artist impression of Level 9 Development Hubs

Arthur Phillip High School focuses on:



Promoting learning excellence



Empowering learners to grow and flourish



Where students recognise and embrace opportunities to thrive



United in our diversity



Where student voice is valued



Partnering with families to support student growth



Challenging and supporting students to pursue excellence



Authentic digital learning



A wellbeing focus where students thrive



Building positive relationships through inclusivity



Nurturing a culture of belonging



Passionate, innovative learners working collaboratively



Nurturing positive, respectful relationships



Collaborating to solve complex, real world problems



Inspiring entrepreneurial leadership through community partnerships



Inspiring and innovative learning spaces



Striving for respect, success and responsibility

School vision

At Arthur Phillip High School, we are committed to promoting learning excellence in an inclusive, dynamic and flexible environment. Our collaborative, future focused learning approach maximises engagement and achievement by challenging and supporting students to pursue excellence and develop a passion for learning, through responsible, informed leadership and proactive global citizenry.

Our staff understand the crucial role they play in providing a diverse, multi skilled curriculum with an emphasis on developing literacy and numeracy skills for our rapidly changing community. In our new multi storey future focused school, collaboration and innovation are essential elements in curriculum delivery and imperative for success. Staff also recognise the importance of developing the whole child through our focus on wellbeing, physical activity, creative and performing arts and student leadership.

At Arthur Phillip High School we cultivate programs and initiatives that celebrate and embrace our multicultural community. We recognise the key role our parents play and provide seamless transition points for students entering Year 7 and leaving for tertiary studies or the workplace at the end of Year 12.

School values

At Arthur Phillip High School students STRIVE for:

RESPECT – To be polite and courteous to others and show respect for all members of the school community

SUCCESS – To learn, participate and realise my potential

RESPONSIBILITY – To recognise and understand my obligations as a member of the APHS community

How our students learn

At Arthur Phillip High School teachers work collaboratively to develop student skills and competence in literacy, numeracy, information communication technology, critical and creative thinking, personal and social capability, and ethical understanding.

Focusing on inquiry-based learning, students are immersed in the curriculum through experiential practice motivating and engaging them to interact on a deeper level with knowledge. Through personalised learning, students are guided in the setting of SMART goals, taking responsibility for their learning, and developing reflection skills essential for success.

Staff are committed to creating opportunities for peer collaboration and the sharing of student learning with the broader community. Through face-to-face, online and blended learning approaches, students are connected to local and global communities. An entrepreneurial framework fosters lifelong skills through learning strategies such as play, project-based learning, genius hour and passion projects. Within this framework students are engaged in meaningful and authentic tasks challenging them to explore significant community and global issues as well as their own areas of interest.

At Arthur Phillip High School students are exposed to STEM challenges which integrate science, technology, engineering and mathematics. These challenges further develop skills such as problem solving; creativity; critical analysis; teamwork; independent thinking; initiative; communication and digital literacy. The use of a customised digital learning platform connects students to an online collaborative learning community, creating their own personal workplace where teachers provide feedback and guidance.

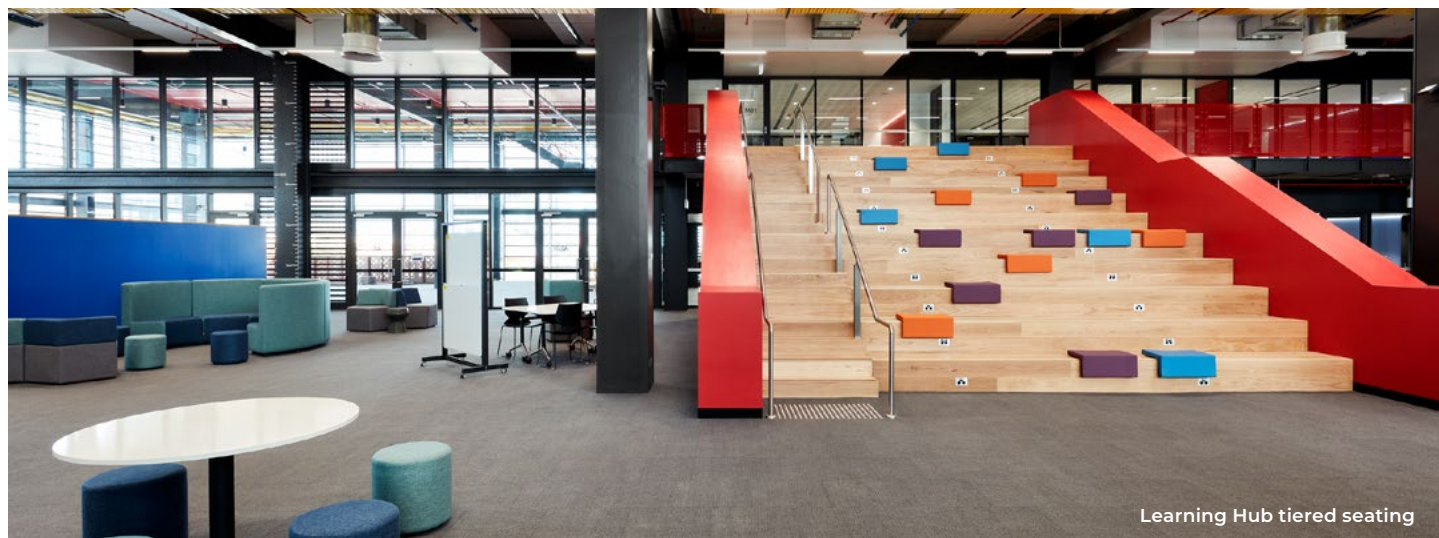

Learning Hub tiered seating

Frequently asked questions

How do I know where to go?

From the moment students collect their access cards, school staff will communicate where students are required to be. Some key information is provided below to make things easier:

1. To improve navigation, school floors have different colours
2. School maps will be provided to students and wayfinding directions placed around the school grounds
3. For two weeks, guides will be placed on each floor of the school to assist students in finding their way

What happens if I arrive late?

Students that arrive after their year level start time are expected to report to the school administration building (main entrance on Macquarie Street) and sign in.

Do I get access to the specialised spaces?

Yes. Access for each student is limited to their respective class and requirements. The STEAM levels covering science, food technology, textiles, 3D printing, wood/metal work, drama and performance provide specialist learning environments to drive collaboration and innovation, which are essential elements in curriculum delivery.

Do I have to take the lift?

The school has introduced a lift policy to manage the movement of students and limit the use of lifts during the school day.

Years 7 and 8 will take the stairs to access their homebase level. Staff will escort students when classes require use of the specialist areas on levels 1, 5 and 9.

Years 9, 10, 11 and 12 swipe card will provide lift access to their respective learning hub levels. Staff will escort students when classes require use of the specialist levels on 1, 5 and 9.

Where is the canteen?

The canteen is located on the ground level of the school. Students will be shown all necessary amenities during their class tour on the first day of school.

Where is the sick bay?

There are two sick bays. Both are located on the lower ground level of the school near the Welcome Centre. Students will be shown all necessary amenities during their orientation tour on the first day of school.

Where is the Counsellor?

The School Counsellor's meeting space is located on the lower ground level near the Welcome Centre. Students will be shown all necessary amenities during their orientation tour on the first day of school.

Where are the play areas?

In early 2020, students will have access to the two new sports courts, multipurpose sports hall and associated landscaped areas. Robyn Thomas Reserve will remain a part of the curriculum.

Additional play areas and landscaping works will be delivered throughout 2020.

Has the uniform changed?

Yes. At the beginning of 2019 Year 7 and Year 11 transitioned into the new school uniform. From the start of the 2020 school year every student is expected to be in the new full school uniform. Please check the APHS website for the current uniform policy or contact the school. Students are reminded to wear their full school uniform every day to school and are required to change into their PE uniform if they have Sport, PE or dance. The school uniform can only be purchased at Lowes in Parramatta. Students are reminded they must wear hard leather lace up school shoes to school everyday.

What are the new school policies?

On the first day of school an induction and overview of the new policies and procedures will be outlined.

What kind of school will it be?

The school will be for students in Year 7 to Year 12 inclusive. It will be a contemporary learning environment offering modern facilities.

Innovative learning prepares students across all curriculum areas and learning stages with skills and capabilities to thrive in a rapidly changing and interconnected world. It connects students and engages their sense of curiosity.

During Term 4, 2019, school staff will continue to gain access to the new school and innovative teaching spaces as part of a professional development and transition program. With the support of the Principal, staff and students are set to thrive in their new learning environment next year.



Artist impression of the aerial view of Arthur Phillip High School and Parramatta Public School redevelopment

School address

Arthur Phillip High School
102-116 Macquarie Street
Parramatta NSW 2150

School contact

For more information about the transition to the new school please contact the Transition Coordinator, Erla McMaster on:

02 9635 8638 or email
arthurphil-h.school@det.nsw.edu.au