



Artist impression of the multipurpose hall

Armidale Secondary School

Project update | September 2021

Investing in our schools

The NSW Government is investing \$7.9 billion over the next four years, continuing its program to deliver 215 new and upgraded schools to support communities across NSW. This is the largest investment in public education infrastructure in the history of NSW.

The NSW Department of Education is committed to delivering new and upgraded schools for communities across NSW. The delivery of these important projects is essential to the future learning needs of our students and supports growth in the local economy.

Project overview

The new Armidale Secondary College is now open. A standalone multipurpose hall for Armidale Secondary College will be delivered as part of the redevelopment.

The multipurpose hall will include a performance space, stage and green room, two indoor basketball courts, a fitness studio and a movement studio along with staff facilities and two general learning spaces.

Progress summary

Planning approval has been received and the contract for construction has been awarded to Richard Crookes Constructions. From 6 September 2021, the contractor will start site establishment including the delivery and installation of compound site sheds and connecting services.

Next steps

From week starting 20 September 2021, preparation for the foundation of the building will start with bulk excavation, and laying of foundation piles. Main works construction is anticipated to start in October, starting with concrete pour works.

For more information contact:

School Infrastructure NSW
Email: schoolinfrastructure@det.nsw.edu.au
Phone: 1300 482 651
www.schoolinfrastructure.nsw.gov.au

Working hours

Work hours will be from 7 am to 6 pm Monday to Friday and 8 am to 1 pm Saturdays. No work will take place on Sundays or public holidays unless notified. The community will be kept informed of any changes to the approved working hours.

Noisy works such as rock breaking, rock hammering, sheet piling, pile driving and similar activities will only be carried out between 9 am to 12 pm and 2 pm to 5 pm Monday to Friday, and 9 am to 12 pm Saturday, as per the planning approval.

Layout of the new multipurpose hall

The multipurpose hall was designed in line with NSW Department of Education guidelines, and in consultation with representatives of the school during the design of the Armidale Secondary College redevelopment.

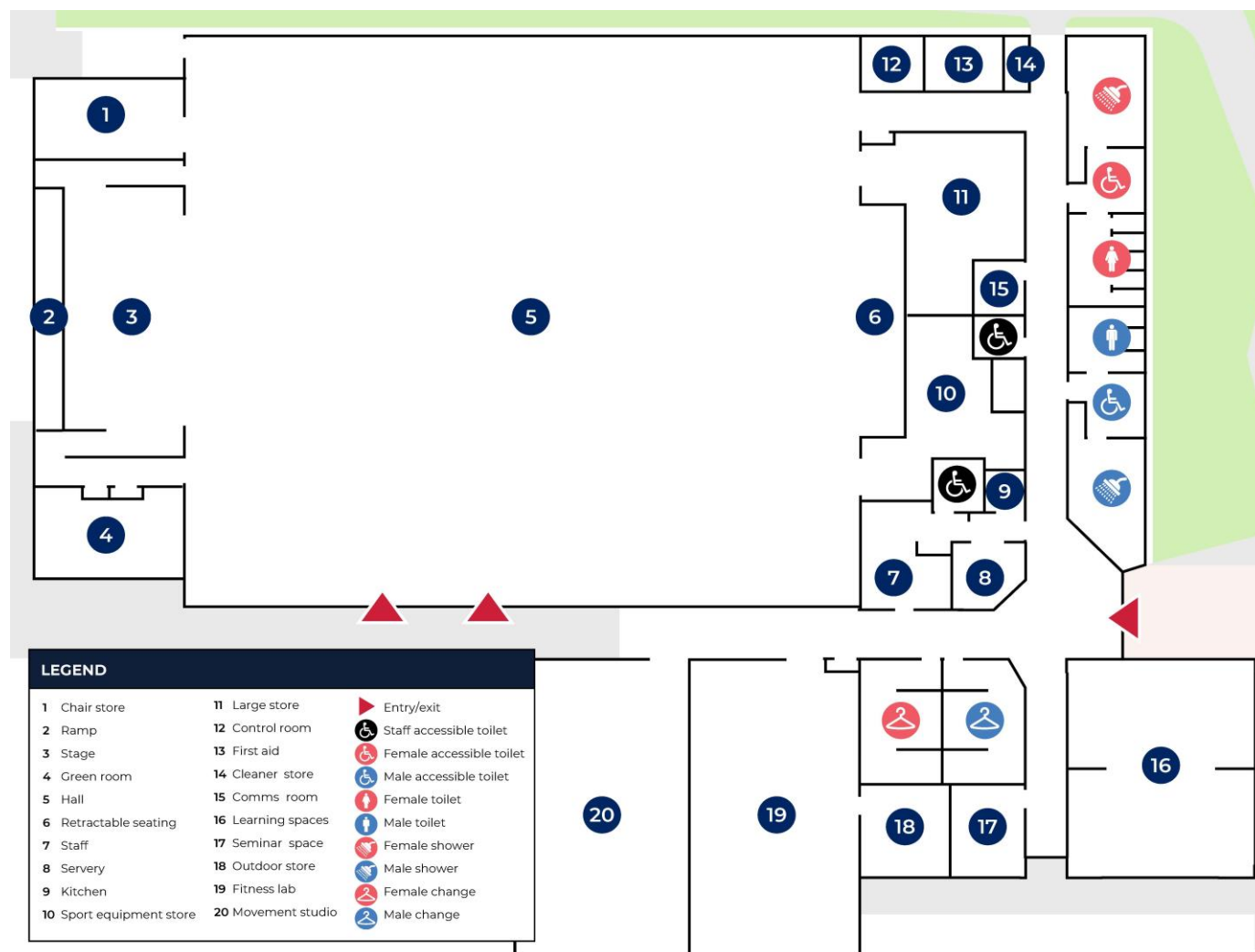

For more information contact:

School Infrastructure NSW
 Email: schoolinfrastructure@det.nsw.edu.au
 Phone: 1300 482 651
www.schoolinfrastructure.nsw.gov.au



Caption: Site layout of the Armidale Secondary College multipurpose hall

What measures will be put in place to minimise construction impacts on students?

Fencing around the construction site is already in place, separating it from the rest of the school. Protective hoarding will be in place in sections connected with the agricultural facility to further secure operational areas used by staff and students. See site map above.

How will students access agricultural paddocks?

Access to some of the agriculture paddocks will be impacted, with temporary construction fencing in place. Access to these areas will be managed by the Contractor to provide safe access when required.

How will contractors enter the work site?

The site will be accessed via a separate gate on Barry Street minimising day to day impacts on the school. Traffic management and control measures will be in place to manage site deliveries and direct traffic and pedestrians.

Earthmoving equipment will be moved onto site and will include some noisy work. School Infrastructure NSW will work closely with the school leadership team to ensure continuity of school operations and to minimise any potential impact on student learning during construction.

We are here to make sure that work is completed safely and efficiently and will minimise impacts on the community at every opportunity. Thank you for your patience while we deliver this important school infrastructure.

For more information contact:

School Infrastructure NSW
Email: schoolinfrastructure@det.nsw.edu.au
Phone: 1300 482 651
www.schoolinfrastructure.nsw.gov.au