

Alexandria Park Community School

We are redeveloping Alexandria Park Community School so students from Kindergarten to Year 12 can learn in more innovative learning environments.

Phase 1 includes:



67 permanent learning spaces



6 special education learning spaces



A special program space



9 workshop spaces



A library



New staff and administration areas



Outdoor play space



Alexandria Park Community School is on Cadigal Land

Artist impression of the Alexandria Park Community School redevelopment

School Infrastructure NSW pays respect to and acknowledges the traditional custodians of the Cadigal land on which Alexandria Park Community School is located, and also pays respect to Elders both past, present and emerging.

schoolinfrastructure.nsw.gov.au

Alexandria Park Community School

For more information phone: 1300 482 651
Email: schoolinfrastructure@det.nsw.edu.au



Phase 1 – Term 4 2020

Phase 1 construction works will be finished and handed over to the school in September 2020. Students and staff will start attending classes in the new buildings from the start of Term 4 2020.

Day 1 Term 4 2020, Monday 12 October 2020:
staff start in the new buildings, **school development / pupil free day**.

Day 2 Term 4 2020, Tuesday 13 October 2020:
students start in the new buildings.

The relocation of the school's furniture and equipment will take place over the school vacation period.



Artist impression of the Alexandria Park Community School redevelopment

Alexandria Park Community School

For more information phone: 1300 482 651
Email: schoolinfrastructure@det.nsw.edu.au

What are innovative learning environments?

Our children's education is vital – they are the next leaders, the future workforce and the foundation of communities for generations to come.

Innovative learning prepares students across all curriculum areas and learning stages with skills and capabilities to thrive in a rapidly changing and interconnected world. It connects students, engages their sense of curiosity, and allows flexible, technology-rich spaces for one-to-one, small group and whole class activities. Innovative learning fosters collaborative learning between students and teachers.



Space

- There are zones for different activities, with varied furniture and resources – such as booths, standing tables, studios and bean bags.
- Spaces can be connected by glass or sliding doors with furniture in corridors and on balconies to extend the learning space.
- No front of classroom.
- Spaces are designed to be shared by multiple classes.



Students

- Students have the ability to move around the learning space to encourage collaborative learning.
- Students working across a range of projects simultaneously.
- Students engaged in hands on learning, building and investigating.



Teachers

- Movement around the learning space rather than the teacher being at the front of the room.
- Teachers plan learning together, for example in stage or faculty teams.
- Teachers teaching together to better meet the needs of students.



Learning

- Personalised learning, so each student is learning at their own level and pace.
- Students learning in large groups, small groups or individually.
- Students are working towards the same project in different subject areas, encouraging cross disciplinary learning.



Technology

- Technology integrated into the space to extend learning.
- Accessibility of technology to suit different activities at point of need, for example filming and recording equipment.
- WiFi accessible across all learning areas.

Alexandria Park Community School

For more information phone: 1300 482 651
Email: schoolinfrastructure@det.nsw.edu.au

Significant milestone timeline

Phase 1 construction is nearing completion.
Phase 2 will start in October 2020.



Artist impression of the Alexandria Park Community School redevelopment

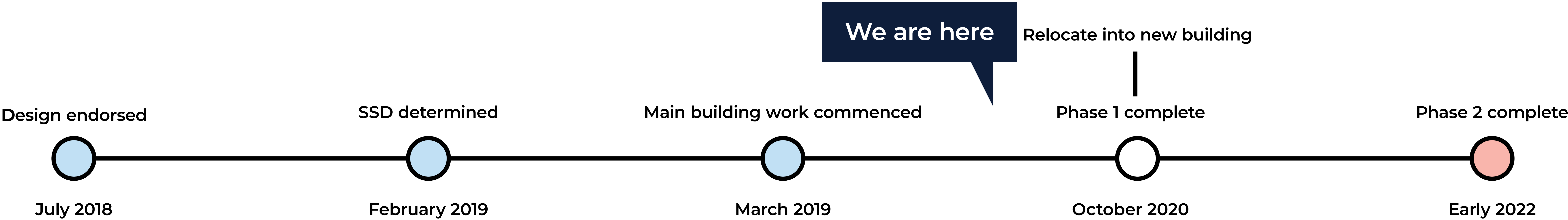

Alexandria Park Community School

For more information phone: 1300 482 651
Email: schoolinfrastructure@det.nsw.edu.au

School overview

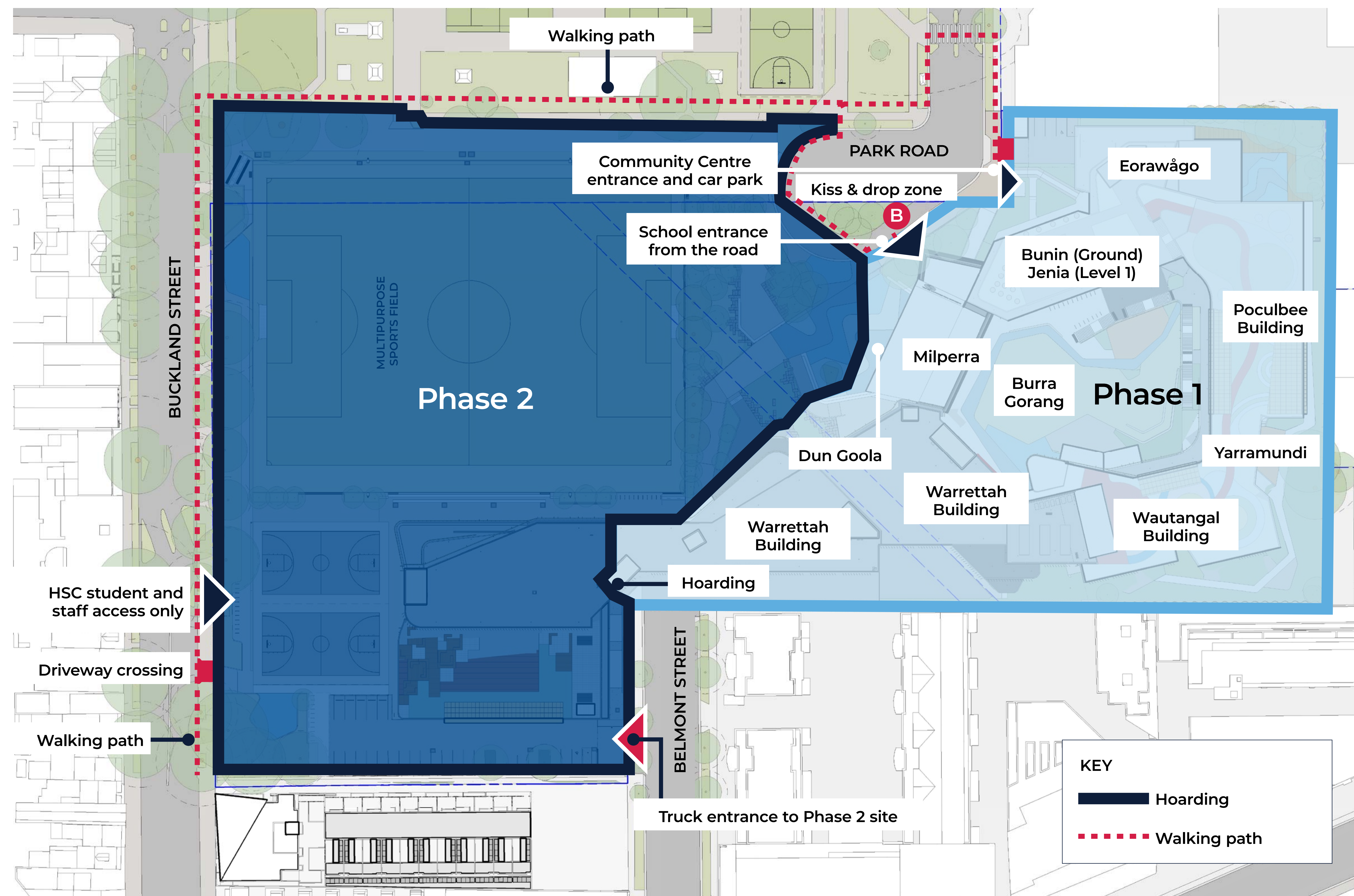

Alexandria Park Community School

For more information phone: 1300 482 651
Email: schoolinfrastructure@det.nsw.edu.au

Gomberee language guide

Alexandria Park Community School has worked closely with the Metropolitan Lands Council, the Aboriginal Educational Consultative Group, Uncle Terry Denzil and local Aboriginal people in the community to name important areas in the new school in the Gomberee language.

| Gomberee Language Name | Concept | Location | Gomberee Language Name | Concept | Location |
|------------------------|-------------------|---|------------------------|----------------------------|---|
| Bunin | Welcome | School offices – ground floor | Yakka Taka | Learning /working together | Warrettah building – Levels 1 & 2 |
| Burra Gorang | Firm ground | Central courtyard play area | Yarramundi | Story teller | Courtyard amphitheatre between Wautangal and Poculbee buildings |
| Crua | To be cooking | Warrettah building ground floor | Warrettah | Waratah | High School learning spaces |
| Eorawago | For the people | Community centre | Poculbee | Purple Iris | Primary School learning spaces |
| Jenla | Let us help | School office building Level 1 staff hubs | Wautangal | Banksia | Primary and secondary learning spaces |
| Maani | Hunting/gathering | School office building rooftop | Getiela | Go Play | Multipurpose sports field – Phase 2 early 2022 |
| Milperra | Meeting place | Main school entrance – Park Road | Mujmoonah | Forest Gum | High School learning spaces – Phase 2 early 2022 |
| Oraywa | In the clouds | Poculbee building – rooftop play area | Dun Goola | Rain garden | Adjacent to Milperra – Phase 2 early 2022 |

Alexandria Park Community School

For more information phone: 1300 482 651
Email: schoolinfrastructure@det.nsw.edu.au

Phase 2

Site establishment for Phase 2, including the installation of hoarding, will start in October 2020.

Construction activities will start in late 2020 with the removal of the temporary school.

Phase 2 includes:

**17** high school permanent learning spaces

**3** workshop spaces

**A** multipurpose hall

**A** gymnasium

**Multiple** sports courts

**Outdoor** play spaces



Artist impression of the Alexandria Park Community School redevelopment

Project timeline

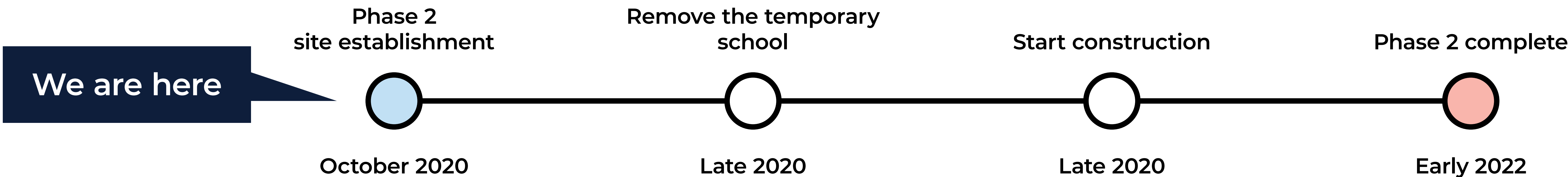

Alexandria Park Community School

For more information phone: 1300 482 651
Email: schoolinfrastructure@det.nsw.edu.au

Phase 2 map

The multipurpose sports field is a joint-use partnership with City of Sydney.

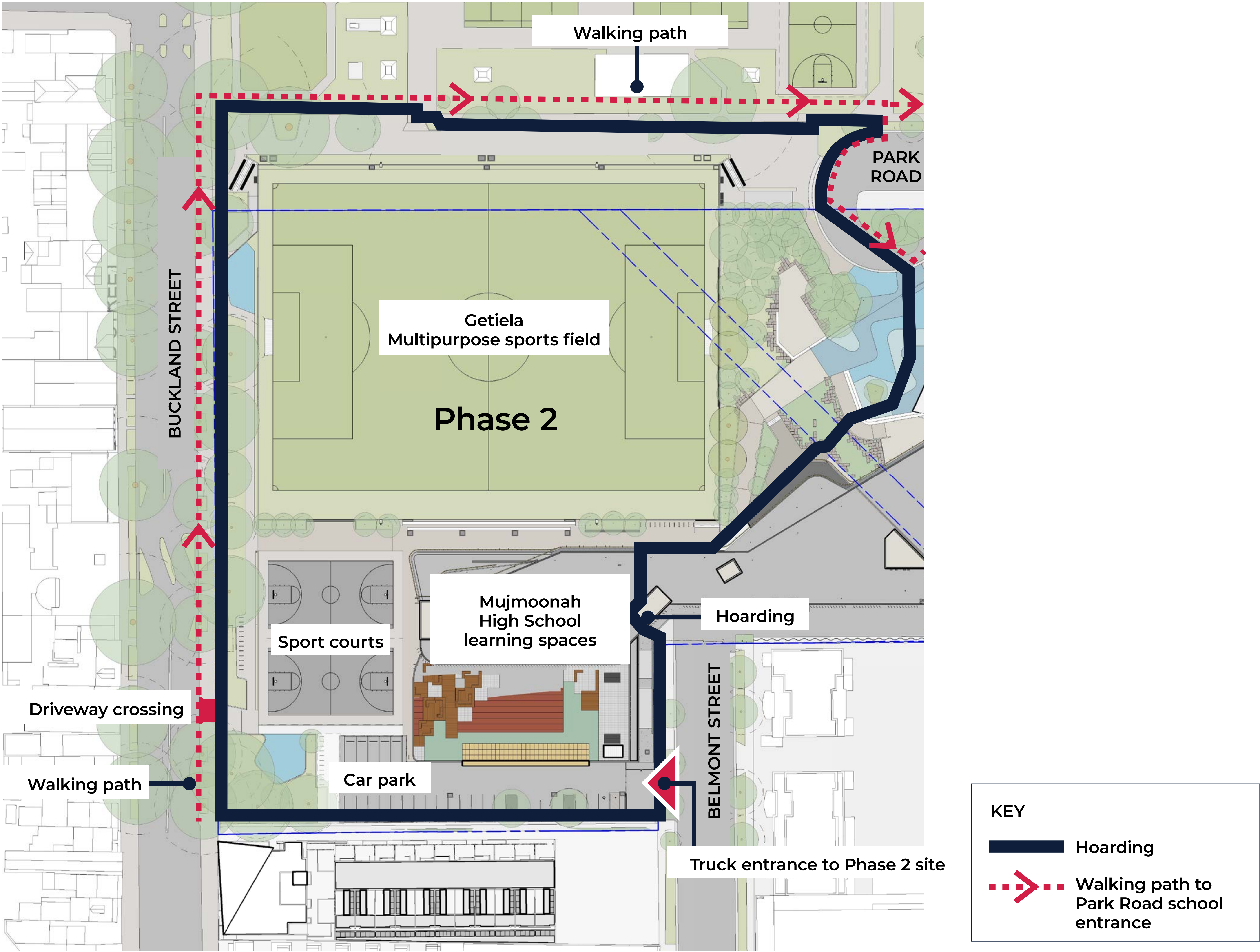

Alexandria Park Community School

For more information phone: 1300 482 651
Email: schoolinfrastructure@det.nsw.edu.au

Transport Access Guide

Travel to Alexandria Park Community School for staff and students is easy with convenient public transport. This guide provides information on the different travel options to the school for staff and students.

Active modes

Cycling

Bicycle and scooter parking is available for students and staff on school grounds.

Walking

The walk from train stations and the future Waterloo Metro station is well paved with signalised intersections and zebra crossings.

Public transport

Train

The school can be accessed from either Redfern, Green Square and Erskineville stations.

Redfern station is a 12-minute walk via the Australian Technology Park with services on the T1, T2, T3, T4, T8 and T9 lines.

Green Square station is a 13-minute walk via Wyndham Street with services on the T8 line.

Bus

The bus service 355 runs from Bondi Junction and Marrickville during school peak hours with a total of 6 services. The bus stops directly outside the school on Power Avenue.

Car travel

Parking

There is street parking surround the school on Power Avenue, Belmont Street and Buckland Street.

Accessible parking is available for the community centre.

Drop off / Pick up

A kiss and drop zone is located on Park Road.

Please see map on next board.

Transport Access Guide Map

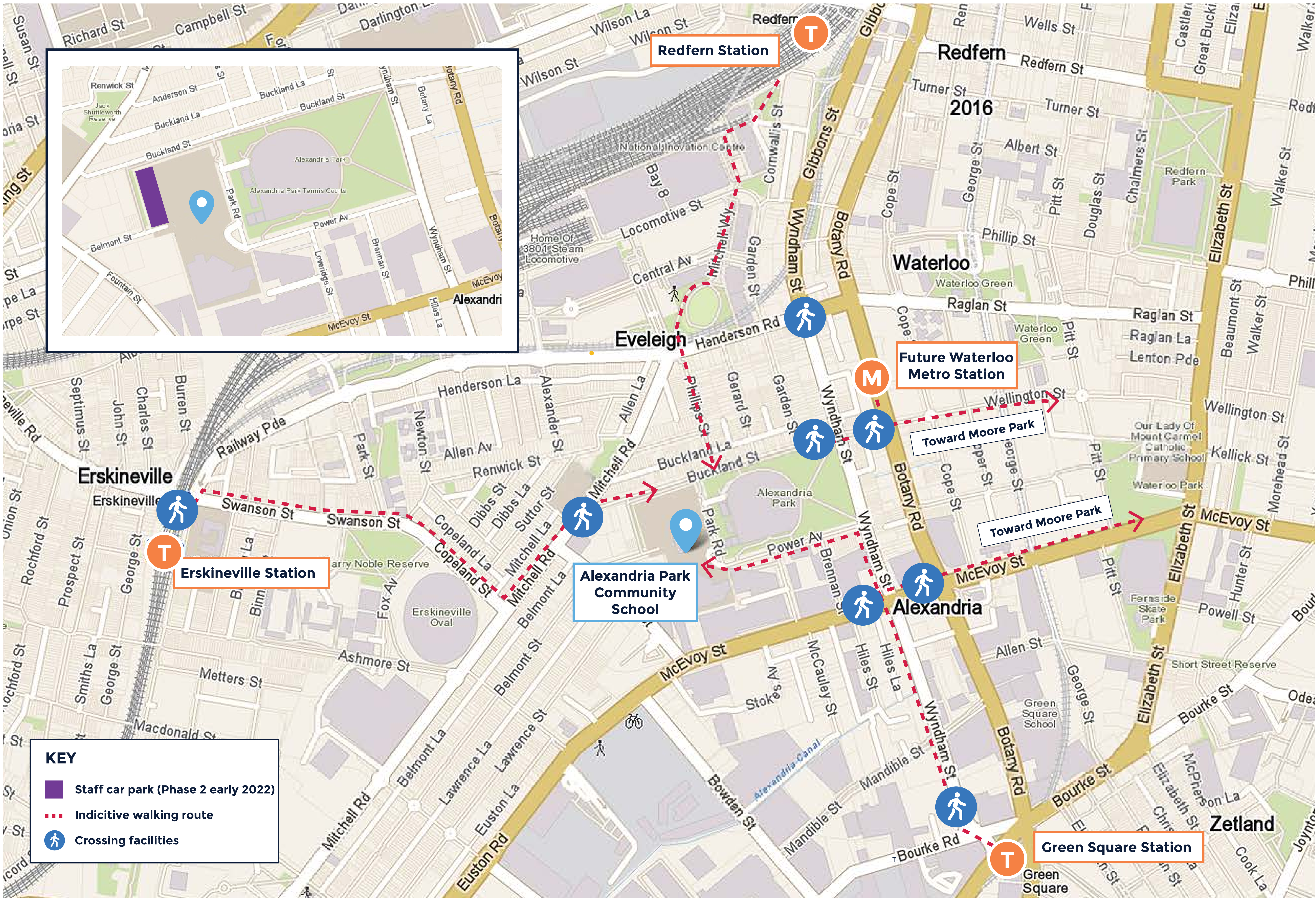

Alexandria Park Community School

For more information phone: 1300 482 651
Email: schoolinfrastructure@det.nsw.edu.au