

Melonba Public Preschool

Project update | March 2026

Artist's impression: Example of a new public preschool.



100 new public preschools

As part of the plan to rebuild public education, the NSW Government is investing \$769 million to deliver 100 new public preschools, co-located with public primary schools in NSW, to boost access to public preschool across the state. This is the largest investment in public preschools in NSW history, helping more children access a high-quality preschool program before starting school.

Project overview

Work is underway to deliver a new public preschool at Melonba Public School. The new public preschool will provide quality, play-based, intentional educational learning programs guided by the Early Years Learning Framework in a safe and engaging environment for preschool children. The new public preschool will accommodate up to 60 children per day and will include:

- 3 preschool rooms
- an outside play area
- administration area, amenities, staff kitchen and storage.

Progress summary

We have been working with the construction contractor to progress the design of the new preschool and have started developing a construction program for the project.

The statutory planning documentation required is being completed. Once we receive planning approval, we will confirm the construction program and notify the community of a proposed construction start date.

Next steps

Upcoming activities will include:

- finalising the design
- acquire statutory planning approval
- finalise the construction program and prepare to establish site.



Email: schoolinfrastructure@det.nsw.edu.au
Phone: 1300 482 651
schoolinfrastructure.nsw.gov.au

Indicative layout

The plan below shows the proposed layout of the new preschool. There may be some changes as we progress the design to allow for construction requirements and statutory approvals.

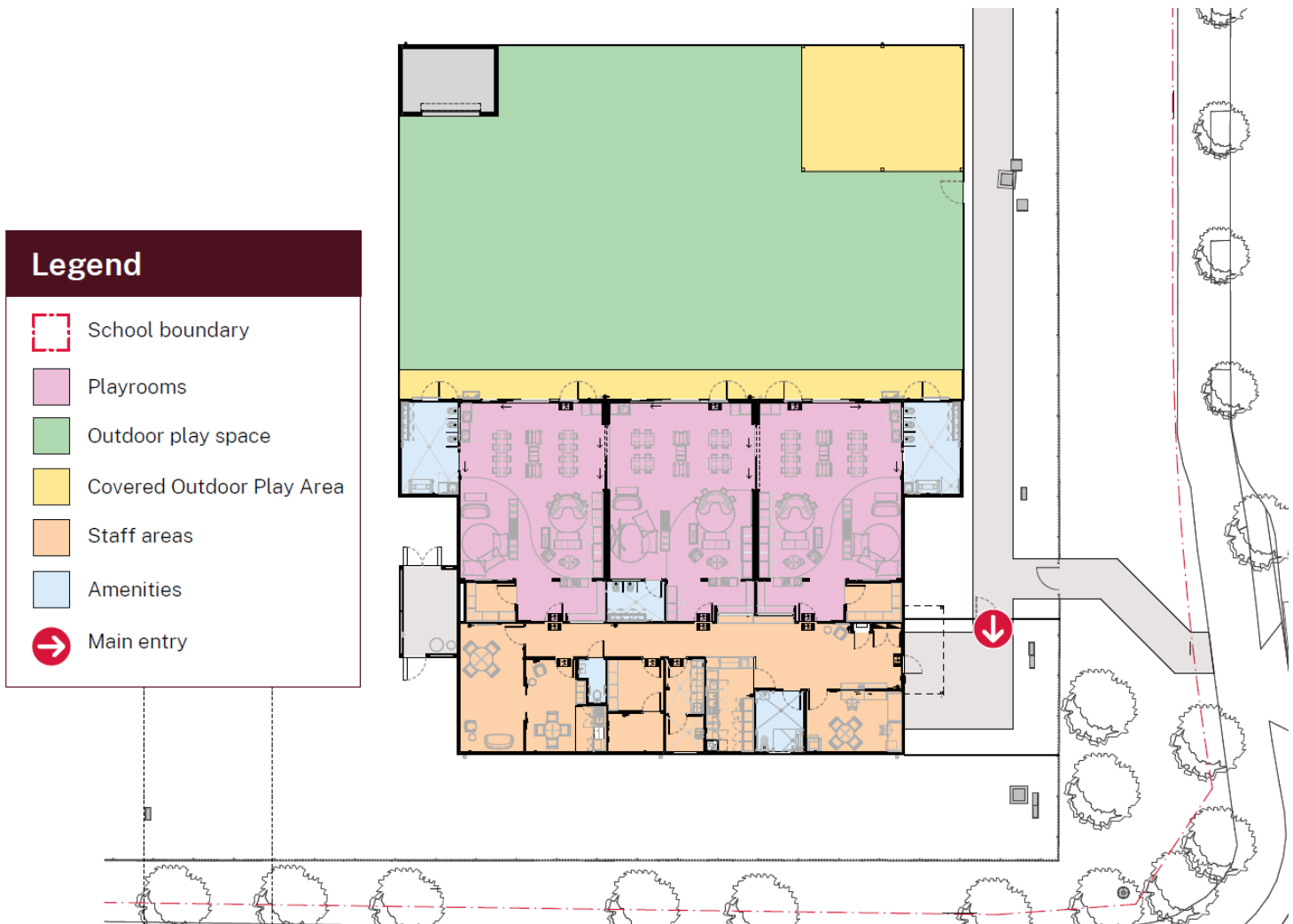

Contact us

You can find out more about the project by following the links or scanning the QR codes below.



Project webpage:
[edu.nsw.link/MelonbaPublic
 Preschool](https://edu.nsw.link/MelonbaPublicPreschool)



Sign up to receive ongoing updates directly to your email.
[edu.nsw.link/MelonbaPublic
 Preschool/sign up](https://edu.nsw.link/MelonbaPublicPreschool/sign up)



For a Translation and Interpreting Service call 131 450 and ask them to call the Department of Education - School Infrastructure on 1300 482 651.