

Asbestos Register

(Hazardous Materials and Risk Assessment)

School:	Lindfield Public School (2403)
Region:	Northern Sydney AMU
State Electorate:	Davidson
Local Government Area:	Ku-Ring-Gai

Last Reviewed By:	AECOM 28-JUN-2016
Last Revised By:	Greencap 25-JUL-2020

Historical Fibro In Grounds Investigations/Events	No
<p>No previous investigations have been recorded against the school. However, asbestos containing materials maybe present in grounds from time to time and caution must be exercised prior to any grounds disturbance.</p>	

2403 - Lindfield Public School
Site Plan (12767)

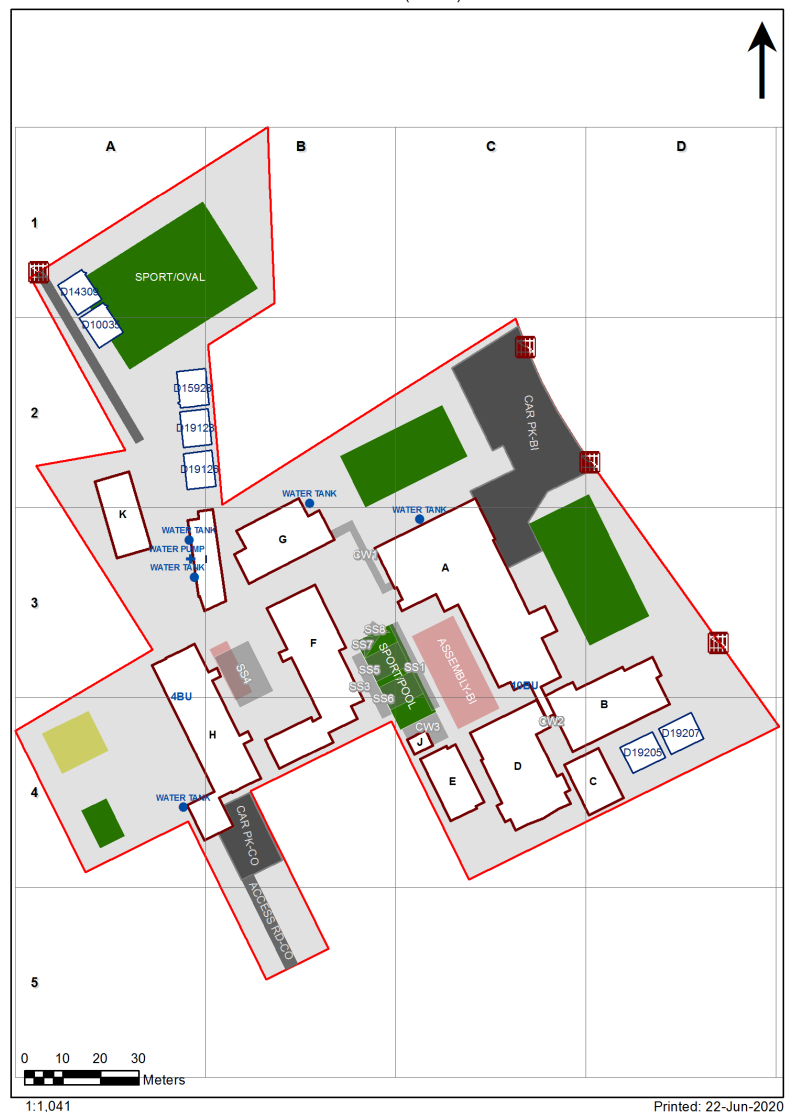

Preface to Asbestos Register

Limitations

Asbestos Registers established (first surveyed 2007/08) and maintained for the Department of Education (DoE) are limited in extent, in that:

1. All inspections and surveys of materials and finishes in DoE facilities are non-disturbance, with
2. Samples undertaken by hygienist to determine whether a sample is an Asbestos Containing Material (ACM),
3. The hygienist may apply a single sample to like materials within a space and adjoining spaces, but not normally between buildings,
4. Successive inspections have reduced any inconclusive records such as 'assumed asbestos' in difficult to access areas, by undertaking additional sampling with lifting devices.
5. In compliance with WHS Act 2011 and WHS Regulations 2017, additional inspections have been undertaken in ceiling spaces and sub-floor areas where access is possible.
 - o Where the ground floor is slab on ground, no inspection is made beneath the slab.
 - o Where fibro fragments (ACM taken for sampling) are located in ceiling spaces or sub floor voids air monitoring is normally undertaken at time of sampling, and clearance undertaken as soon as practicable.
6. No attempt has been made to identify any ACM that is hidden from view or encapsulated within
 - o Any wall cavity
 - o Sub floor area, particularly formwork for slabs in/on ground,
 - o Services (that may use ACM) such as: pipe lagging, asbestos cement pipes, flues.
7. All known ACM in Grounds (Fibro in Grounds) is made available in associated site specific asbestos management plans in DoE electronic files.
Notwithstanding information provided, ACM may be present in grounds from time to time and caution must be exercised prior to any grounds disturbance.

Use of the Asbestos Register

Prior to any disturbance works being undertaken in a building to which this asbestos register applies it will be necessary to confirm the extent of any ACM by a disturbance investigation:

- If the building was built prior to 2003
- If any ACM has been identified in the Asbestos Register for the building.

Update of Asbestos Registers

Asbestos Register Data is updated regularly by the DoE Hygienist Panel via the Online Asbestos Register Tool (Managed by Business Systems, School Infrastructure NSW). Internal users can view the latest edition of the Asbestos Register in the AMS.

Please note: The Department's external website may not contain the latest revision of the Asbestos Register.

Notes 1: Vermiculite

- During 2018/19, all vermiculite occurrences in DoE schools identified in 2007/08, were 'composite tested' in accordance with a safe work NSW agreed procedure. This required multiple testing of all vermiculite occurrences.
- During the period 2007/08 to 2018/19, some vermiculite has been over sheeted and a warning is indicated for schools where this has happened.

Note 2: DoE website link for information is here:

<https://www.schoolinfrastructure.nsw.gov.au/about-us/working-with-us/schools-asbestos-register.html>
<https://education.nsw.gov.au/about-us/strategies-and-reports/our-reports-and-reviews/schools-asbestos-register>

Note 3: Material Condition Assessment

The material condition assessment descriptors from Section 3 of the Asbestos Management Plan (AMP) is extracted below. Please read the AMP in its entirety for further information.

3.3.2.1 Material condition assessment

The OART records the material condition of identified ACM in the following format:

Rating	Description
Good condition (1)	For non-friable asbestos that is sealed and has no visible damage. This primarily related to asbestos cement (AC) sheet and vinyl tiles
Minimal damage (2)	For non-friable asbestos that has a very small amount of damage, eg hairline cracks.
Some damage / unsealed (3)	For non-friable asbestos with significant breakage or several small areas where material has been damaged, revealing loose asbestos fibres. Non-friable asbestos that is unsealed.
Poor condition (4)	For non-friable asbestos that has extensive damage. Visible asbestos debris
Friable asbestos (5)	Any occurrence of friable asbestos

Product	Material Description	Extent	Location	Material Condition	Risk Status	Remediation Priority	Result
B00A - Administration/General Learning - 1976 - Brick/Block							
Exterior							
Ceiling Voids - Flat Roof	No Asbestos Found						
Eaves Linings	Flat AC Sheeting	30.00m2	South/west. Eaves to 1021	Good Condition (1)	Low (1)	Low Priority (2-3)	Assumed Asbestos
Wall Cladding	Flat AC Sheeting	400.00m2	East facing, West facing	Good Condition (1)	Low (1)	Low Priority (2-3)	Chrysotile (white asbestos) , Amosite (brown asbestos)
Wall Linings Internal - Infill	Flat AC Sheeting	4	North facing, above library windows	Good Condition (1)	Low (1)	Low Priority (2-3)	Chrysotile (white asbestos)
Interior							
B00A - R0001 - Staff Room - 81.01 m2							
Ceiling Structures/Linings	Vermiculite - Composite Sample - (70 - 120 m2) - (X8)						
Floor Coverings Res/Textile	Vinyl Tiles (Under Floor Covering/Carpet)	8m2	All surfaces	Good Condition (1)	Low (1)	Low Priority (2-3)	Chrysotile (white asbestos)
Floor Coverings Res/Textile	Vinyl Sheet						
B00A - R0002 - Cleaning Distributed Store - 3.87 m2							
Ceiling Structures/Linings	Vermiculite - Composite Sample - (< 10 m2) - (X2)						
Floor Coverings Res/Textile	Vinyl Tiles	4.00m2	All surfaces	Good Condition (1)	Low (1)	Low Priority (2-3)	Chrysotile (white asbestos)
B00A - R0003 - General Storeroom - 10.81 m2							
Ceiling Structures/Linings	Vermiculite - Composite Sample - (10 - 40 m2) - (X3)						
Floor Coverings Res/Textile	Vinyl Tiles	11.00m2	All surfaces	Good Condition (1)	Low (1)	Low Priority (2-3)	Chrysotile (white asbestos)
B00A - R0004 - Duplicating Workroom - 18.8 m2							
Ceiling Structures/Linings	Vermiculite - Composite Sample - (10 - 40 m2) - (X3)						
Floor Coverings Res/Textile	Vinyl Tiles (Under Floor Covering/Carpet)	19m2	All surfaces	Good Condition (1)	Low (1)	Low Priority (2-3)	Chrysotile (white asbestos)
B00A - R0005 - Principal - 20.08 m2							
Ceiling Structures/Linings	Vermiculite - Composite Sample - (10 - 40 m2) - (X3)						
B00A - R0006 - General Storeroom - 2.29 m2							
Ceiling Structures/Linings	No Asbestos Found						
B00A - R0007 - Sick Bay - 7.53 m2							
Ceiling Structures/Linings	Vermiculite - Composite Sample - (< 10 m2) - (X2)						
Floor Coverings Res/Textile	Vinyl Tiles						
B00A - R0008 - Clerical Office - 14.13 m2							
Ceiling Structures/Linings	Vermiculite - Composite Sample - (10 - 40 m2) - (X3)						
B00A - R0009 - Entry Vestibule - 20.54 m2							
Ceiling Structures/Linings	Vermiculite - Composite Sample - (10 - 40 m2) - (X3)						
Floor Coverings Res/Textile	Vinyl Sheet						
Floor Coverings Res/Textile	Vinyl Tiles (Under Floor Covering/Carpet)	21m2	All surfaces	Good Condition (1)	Low (1)	Low Priority (2-3)	Chrysotile (white asbestos)
B00A - R0010 - Music Store - 5.87 m2							

Ceiling Structures/Linings	Vermiculite - Composite Sample - (< 10 m2) - (X2)							
B00A - R0011 - Movement - 58.5 m2								
Ceiling Structures/Linings	Vermiculite - Composite Sample - (40 - 70 m2) - (X5)							
B00A - R0012 - General Storeroom - 14.44 m2								
Ceiling Structures/Linings	Vermiculite - Composite Sample - (10 - 40 m2) - (X3)							
Floor Coverings Res/Textile	Vinyl Tiles	14.00m2	All surfaces	Good Condition (1)	Low (1)	Low Priority (2-3)	Chrysotile (white asbestos)	
B00A - R0013 - Clerical Office - 12.22 m2								
Ceiling Structures/Linings	Vermiculite - Composite Sample - (10 - 40 m2) - (X3)							
B00A - R0014 - Staff Room Annexe - 12.33 m2								
Ceiling Structures/Linings	Vermiculite - Composite Sample - (10 - 40 m2) - (X3)							
B00A - R0015 - Staff Toilet - 4.87 m2								
Ceiling Structures/Linings	Vermiculite - Composite Sample - (10 - 40 m2) - (X3)							
B00A - R0016 - Staff Toilet - 5.92 m2								
Ceiling Structures/Linings	Vermiculite - Composite Sample - (< 10 m2) - (X2)							
Wall Linings Internal - Infill	Flat AC Sheeting	0.5m2	Above north door	Good Condition (1)	Low (1)	Low Priority (2-3)	Chrysotile (white asbestos)	
Wall Linings Internal - Bulk Head	Flat AC Sheeting	2m2	North	Good Condition (1)	Low (1)	Low Priority (2-3)	Chrysotile (white asbestos)	
B00A - R0017 - Deputy Principal - 12.25 m2								
Ceiling Structures/Linings	Vermiculite - Composite Sample - (10 - 40 m2) - (X3)							
Wall Linings Internal - Bulk Head	Flat AC Sheeting	3m2	North	Good Condition (1)	Low (1)	Low Priority (2-3)	Chrysotile (white asbestos)	
Wall Linings Internal - Infill	Flat AC Sheeting	0.5m2	Above north door	Good Condition (1)	Low (1)	Low Priority (2-3)	Chrysotile (white asbestos)	
B00A - R0018 - Movement - 42 m2								
Floor Coverings Res/Textile	Vinyl Sheet							
Floor Coverings Res/Textile	Vinyl Tiles (Under Floor Covering/Carpet)	42m2	All surfaces	Good Condition (1)	Low (1)	Low Priority (2-3)	Chrysotile (white asbestos)	
Ceiling Structures/Linings	Vermiculite - Composite Sample - (40 - 70 m2) - (X5)							
B00A - R0019 - Movement - 1.24 m2								
No Asbestos								
B00A - R0020 - Distribution Board - .37 m2								
Note: No inspection of live electrical installation								
No Asbestos								
B00A - R0021 - Canteen - 42.14 m2								
Ceiling Structures/Linings	Vermiculite - Composite Sample - (40 - 70 m2) - (X5)							
Floor Coverings Res/Textile	Vinyl Sheet							
Floor Coverings Res/Textile	Vinyl Tiles (Under Floor Covering/Carpet)	42m2	All surfaces	Good Condition (1)	Low (1)	Low Priority (2-3)	Chrysotile (white asbestos)	
B00A - R0022 - Canteen Office/Store - 3.12 m2								
Ceiling Structures/Linings	Vermiculite - Composite Sample - (< 10 m2) - (X2)							
Floor Coverings Res/Textile	Vinyl Tiles (Under Floor Covering/Carpet)	3m2	All surfaces	Good Condition (1)	Low (1)	Low Priority (2-3)	Chrysotile (white asbestos)	
Floor Coverings Res/Textile	Vinyl Sheet							

B00A - R0023 - Staff Toilet - 3.64 m2							
Ceiling Structures/Linings	Vermiculite - Composite Sample - (< 10 m2) - (X2)						
B00A - R0024 - Canteen Office/Store - 7.27 m2							
Ceiling Structures/Linings	Vermiculite - Composite Sample - (< 10 m2) - (X2)						
Floor Coverings Res/Textile	Vinyl Tiles (Under Floor Covering/Carpet)	7m2	All surfaces	Good Condition (1)	Low (1)	Low Priority (2-3)	Chrysotile (white asbestos)
Floor Coverings Res/Textile	Vinyl Sheet						
B00A - R0026 - Movement - 128.54 m2							
Ceiling Structures/Linings	Vermiculite - Composite Sample - (120 - 250 m2) - (X15)						
B00A - R0027 - General Storeroom - 7.88 m2							
Floor Coverings Res/Textile	Vinyl Tiles	8.00m2	All surfaces	Some Damage - Unsealed (3)	Low (1)	Medium Priority (4-5)	Chrysotile (white asbestos)
B00A - R0028 - Sports Store - 10.53 m2							
Wall Linings Internal - Service Risers / Boxing	Flat AC Sheeting	11.00m2	Upper portion	Some Damage - Unsealed (3)	Low (1)	Medium Priority (4-5)	Chrysotile (white asbestos) , Amosite (brown asbestos)
B00A - R0029 - Garden Store - 10.6 m2							
No Asbestos							
B00A - R0030 - Garden Store - 5.91 m2							
No Asbestos							
B00A - R0031 - Movement - 5.5 m2							
No Asbestos							
B00A - R0032 - Toilets - Boys - 12.97 m2							
Ceiling Structures/Linings	Vermiculite - Composite Sample - (10 - 40 m2) - (X3)						
Wall Linings Internal - Bulk Head	Flat AC Sheeting	4m2	North, East and South walls	Good Condition (1)	Low (1)	Low Priority (2-3)	Chrysotile (white asbestos) , Amosite (brown asbestos)
B00A - R0033 - Shower/Change - 31.39 m2							
Ceiling Structures/Linings	Vermiculite - Composite Sample - (10 - 40 m2) - (X3)						
B00A - R0034 - Shower/Change - 31.39 m2							
Ceiling Structures/Linings	Vermiculite - Composite Sample - (10 - 40 m2) - (X3)						
B00A - R0035 - Movement - 82.3 m2							
No Asbestos							
B00A - R0036 - Movement - 64.63 m2							
No Asbestos							
B00A - R0037 - Movement - 141.41 m2							
No Asbestos							
B00A - R0038 - Stairs - 12.03 m2							
Ceiling Structures/Linings	Flat AC Sheeting						
B00A - R0039 - Stairs - 4.8 m2							
No Asbestos							
B00A - R0040 - Stairs - 5.07 m2							
No Asbestos							
B00A - R1001 - Reading Area - 263.2 m2							
No Asbestos							
B00A - R1002 - Toilets - Girls - 8.03 m2							

Ceiling Structures/Linings	Flat AC Sheeting	9.00m2	All surfaces	Good Condition (1)	Low (1)	Low Priority (2-3)	Chrysotile (white asbestos)
B00A - R1003 - Toilets - Boys - 8.03 m2							
Ceiling Structures/Linings	Flat AC Sheeting	9.00m2	All surfaces	Good Condition (1)	Low (1)	Low Priority (2-3)	Chrysotile (white asbestos)
B00A - R1004 - Distribution Board - 1.39 m2				Note: No inspection of live electrical installation			
No Asbestos							
B00A - R1005 - Cleaning Distributed Store - 1.39 m2							
No Asbestos							
B00A - R1006 - Movement - 11.69 m2							
No Asbestos							
B00A - R1007 - Library Office/Workroom - 7.3 m2							
No Asbestos							
B00A - R1008 - Library Office/Workroom - 20.96 m2							
Floor Coverings Res/Textile	Vinyl Tiles	21.00m2	All surfaces	Good Condition (1)	Low (1)	Low Priority (2-3)	Chrysotile (white asbestos)
B00A - R1009 - Communications Room - 14.06 m2							
Floor Coverings Res/Textile	Vinyl Tiles	15.00m2	All surfaces	Good Condition (1)	Low (1)	Low Priority (2-3)	Chrysotile (white asbestos)
B00A - R1010 - Movement - 4.13 m2							
Floor Coverings Res/Textile	Vinyl Tiles	5.00m2	All surfaces	Good Condition (1)	Low (1)	Low Priority (2-3)	Chrysotile (white asbestos)
B00A - R1011 - General Storeroom - 16.57 m2							
Floor Coverings Res/Textile	Vinyl Tiles	17.00m2	All surfaces	Good Condition (1)	Low (1)	Low Priority (2-3)	Chrysotile (white asbestos)
B00A - R1012 - K.L.A. Store - 19.12 m2							
No Asbestos							
B00A - R1013 - Seminar/Study - 18.87 m2							
No Asbestos							
B00A - R1014 - Communications Room - 18.51 m2							
No Asbestos							
B00A - R1015 - Distribution Board - .7 m2				Note: No inspection of live electrical installation			
Wall Linings Internal	Flat AC Sheeting	1m2	West, upper	Good Condition (1)	Low (1)	Low Priority (2-3)	Chrysotile (white asbestos) , Amosite (brown asbestos)
Electrical Backing Board		1.00Unit	West	Good Condition (1)	Low (1)	Low Priority (2-3)	Assumed Asbestos
B00A - R1019 - Home Base - 56.29 m2							
No Asbestos							
B00A - R1020 - Practical Activities - 1hb - 20.51 m2							
Floor Coverings Res/Textile	Vinyl Tiles	21.00m2	All surfaces	Good Condition (1)	Low (1)	Low Priority (2-3)	Chrysotile (white asbestos)
B00A - R1021 - Movement - 81.15 m2							
Ceiling Structures/Linings	Flat AC Sheeting	82.00m2	All surfaces	Good Condition (1)	Low (1)	Low Priority (2-3)	Chrysotile (white asbestos) , Amosite (brown asbestos)
B00A - R1022 - Home Base - 49.9 m2							
No Asbestos							
B00A - R1023 - Home Base Store - 1.35 m2							
No Asbestos							
B00A - R1024 - Practical Activities - 1hb - 16.97 m2							
Floor Coverings Res/Textile	Vinyl Tiles	8.00m2	All surfaces	Good Condition (1)	Low (1)	Low Priority (2-3)	Chrysotile (white asbestos)
B00A - R1025 - Toilets - Girls - 12.1 m2							
Ceiling Structures/Linings	Flat AC Sheeting						

B00A - R1026 - Practical Activities - 1hb - 16.97 m2							
Floor Coverings Res/Textile	Vinyl Tiles	17.00m2	All surfaces	Good Condition (1)	Low (1)	Low Priority (2-3)	Chrysotile (white asbestos)
B00A - R1027 - Home Base - 49.9 m2							
No Asbestos							
B00A - R1028 - Home Base Store - 1.35 m2							
No Asbestos							
B00A - R1029 - Movement - 171.41 m2							
Ceiling Structures/Linings	Flat AC Sheeting						
Floor Coverings Res/Textile	Vinyl Tiles	172.00m2	All surfaces	Good Condition (1)	Low (1)	Low Priority (2-3)	Chrysotile (white asbestos)
B00A - R1030 - Stairs - 17.23 m2							
Ceiling Structures/Linings	Flat AC Sheeting						
B00A - R1031 - Home Base - 69.33 m2							
No Asbestos							
B00A - R1032 - Stairs - 15.13 m2							
Ceiling Structures/Linings	Flat AC Sheeting						
B00B - General Learning - 1903 - Brick/Block							
Exterior							
Ceiling Voids - Flat Roof	Non Accessible Area						
Eaves Linings	Flat AC Sheeting						
Underfloor Voids	Flat AC Sheeting						
Wall Linings Internal - Bulk Head	Flat AC Sheeting	4	North, central, outside R1006, Between roof levels	Good Condition (1)	Low (1)	Low Priority (2-3)	Assumed Asbestos
Interior							
B00B - R0001 - Home Base - 50.49 m2							
Floor Coverings Res/Textile	Vinyl Tiles (Under Floor Covering/Carpet)	50m2	All surfaces	Good Condition (1)	Low (1)	Low Priority (2-3)	Chrysotile (white asbestos)
B00B - R0002 - Home Base - 51.48 m2							
Floor Coverings Res/Textile	Vinyl Sheet						
Floor Coverings Res/Textile	Vinyl Tiles (Under Floor Covering/Carpet)	51m2	All surfaces	Good Condition (1)	Low (1)	Low Priority (2-3)	Chrysotile (white asbestos)
B00B - R0004 - Practical Activities - 1hb - 14.69 m2							
Floor Coverings Res/Textile	Vinyl Sheet						
Floor Coverings Res/Textile	Vinyl Tiles (Under Floor Covering/Carpet)	15m2	All surfaces	Good Condition (1)	Low (1)	Low Priority (2-3)	Chrysotile (white asbestos)
B00B - R0005 - Home Base - 79.46 m2							
No Asbestos							
B00B - R0006 - Cleaning Distributed Store - 1.85 m2							
No Asbestos							
B00B - R0007 - Uniform Shop - 15.19 m2							
Floor Coverings Res/Textile	Vinyl Tiles (Under Floor Covering/Carpet)						
Ceiling Structures/Linings	Flat AC Sheeting	15.00m2	Throughout	Good Condition (1)	Low (1)	Low Priority (2-3)	Chrysotile (white asbestos)
B00B - R0008 - Staff Room Annexe - 12.27 m2							
Floor Coverings Res/Textile	Vinyl Tiles (Under Floor Covering/Carpet)						
B00B - R0009 - Toilets - Girls - 11.82 m2							

Ceiling Structures/Linings	Flat AC Sheeting	12.00m2	All surfaces	Good Condition (1)	Low (1)	Low Priority (2-3)	Chrysotile (white asbestos)
B00B - R0010 - No Access - 3.87 m2							
No Asbestos							
B00B - R0011 - Toilets - Boys - 11.74 m2							
No Asbestos							
B00B - R0012 - Movement - 12.89 m2							
No Asbestos							
B00B - R0013 - Movement - 66.69 m2							
Floor Coverings Res/Textile	Vinyl Sheet						
B00B - R0014 - Stairs - 3.11 m2							
Floor Coverings Res/Textile	Vinyl Sheet						
B00B - R0015 - Movement - 1.13 m2							
Floor Coverings Res/Textile	Vinyl Sheet						
B00B - R0016 - Stairs - 5.77 m2							
Floor Coverings Res/Textile	Vinyl Sheet						
B00B - R0017 - Stairs - 6.83 m2							
No Asbestos							
B00B - R1001 - Home Base - 50.98 m2							
Floor Coverings Res/Textile	Vinyl Tiles (Under Floor Covering/Carpet)	51m2	All surfaces	Good Condition (1)	Low (1)	Low Priority (2-3)	Chrysotile (white asbestos)
B00B - R1002 - Home Base - 52.01 m2							
Floor Coverings Res/Textile	Vinyl Tiles (Under Floor Covering/Carpet)	52m2	All surfaces	Good Condition (1)	Low (1)	Low Priority (2-3)	Chrysotile (white asbestos)
Furniture / Fixtures	Vinyl Lining						
B00B - R1006 - General Storeroom - 12.17 m2							
Floor Coverings Res/Textile	Vinyl Sheet						
B00B - R1007 - Craft Store - 7.81 m2							
Floor Coverings Res/Textile	Vinyl Sheet						
Floor Coverings Res/Textile	Vinyl Tiles (Under Floor Covering/Carpet)						
Floor Coverings Res/Textile	Vinyl Tiles (Under Floor Covering/Carpet)						
B00B - R1008 - Movement - 70.31 m2							
Floor Coverings Res/Textile	Vinyl Sheet						
B00B - R1009 - Stairs - 15.94 m2							
Floor Coverings Res/Textile	Vinyl Sheet						
B00B - R1010 - Stairs - 13.45 m2							
Floor Coverings Res/Textile	Vinyl Sheet						
B00B - R1011 - Home Base - 93.3 m2							
No Asbestos							
B00B - R1012 - Practical Activity Area - 1.95 m2							
Floor Coverings Res/Textile	Vinyl Tiles	2.00m2	All surfaces	Good Condition (1)	Low (1)	Low Priority (2-3)	
B00C - General Learning - 1976 - Timber							
Exterior							
Ceiling Voids - Flat Roof	No Asbestos Found						

Underfloor Voids	No Asbestos Found						
Interior							
B00C - R0001 - Home Base - 52.79 m2							
No Asbestos							
B00C - R0002 - Home Base - 52.87 m2							
No Asbestos							
B00C - R0003 - General Storeroom - 5.9 m2							
No Asbestos							
B00C - R0004 - Movement - 28.98 m2							
No Asbestos							
B00D - Communal Facilities - 1903 - Brick/Block							
Exterior							
Ceiling Voids - Flat Roof	Non Accessible Area						
Underfloor Voids	Non Accessible Area						
Underfloor Voids - Slab on Ground	Non Accessible Area						
Interior							
B00D - R0003 - Movement - 3.94 m2							
No Asbestos							
B00D - R0004 - Staff Toilet - 1.71 m2							
No Asbestos							
B00D - R0005 - Movement - 3.14 m2							
No Asbestos							
B00D - R0006 - General Storeroom - 5.98 m2							
No Asbestos							
B00D - R0007 - Raised Platform - 48.81 m2							
No Asbestos							
B00D - R0008 - Movement - 3.16 m2							
No Asbestos							
B00D - R0009 - Store - 6.01 m2							
No Asbestos							
B00D - R0010 - Staff Toilet - 1.71 m2							
No Asbestos							
B00D - R0012 - Movement - 3.94 m2							
No Asbestos							
B00D - R0013 - Movement - 6.27 m2							
No Asbestos							
B00D - R0014 - Movement - 6.27 m2							
No Asbestos							
B00D - R0015 - Communal Space - 212.73 m2							
No Asbestos							
B00D - R0016 - Covered Outdoor Learning Area - 156.32 m2							
No Asbestos							
B00D - R9001 - General Storeroom - 1.91 m2							
No Asbestos							
B00D - R9002 - Movement - 2.96 m2							
Floor Coverings Res/Textile	Vinyl Tiles	3m2	All surfaces	Good Condition (1)	Low (1)	Low Priority (2-3)	Chrysotile (white asbestos)
B00D - R9003 - Craft Store - 6.07 m2							
Floor Coverings Res/Textile	Vinyl Tiles	7m2	All surfaces	Good Condition (1)	Low (1)	Low Priority (2-3)	Chrysotile (white asbestos)
B00D - R9004 - Special Programs Room - 46.76 m2							

Floor Coverings Res/Textile	Vinyl Tiles	47m2	All surfaces	Good Condition (1)	Low (1)	Low Priority (2-3)	Chrysotile (white asbestos)
B00D - R9005 - Craft Store - 3.99 m2							
No Asbestos							
B00D - R9006 - General Storeroom - 9.25 m2							
No Asbestos							
B00E - General Learning - 1976 - Timber							
Exterior							
Ceiling Voids - Flat Roof	Non Accessible Area						
Underfloor Voids	No Asbestos Found						
Eaves Linings	Flat AC Sheeting	60m2	East facing, West facing	Good Condition (1)	Low (1)	Low Priority (2-3)	Chrysotile (white asbestos) , Amosite (brown asbestos)
Interior							
B00E - R0001 - Home Base - 53.91 m2							
No Asbestos							
B00E - R0002 - Home Base Store - 5.17 m2							
Ceiling Structures/Linings	Flat AC Sheeting	6m2	All surfaces	Good Condition (1)	Low (1)	Low Priority (2-3)	Chrysotile (white asbestos) , Amosite (brown asbestos)
B00E - R0004 - Movement - 26.6 m2							
Ceiling Structures/Linings	Flat AC Sheeting	28m2	All surfaces	Good Condition (1)	Low (1)	Low Priority (2-3)	Chrysotile (white asbestos) , Amosite (brown asbestos)
B00E - R0005 - Special Programs Room - 53.9 m2							
Floor Coverings Res/Textile	Vinyl Tiles (Under Floor Covering/Carpet)						
B00E - R0006 - General Storeroom - 3.15 m2							
Ceiling Structures/Linings	Flat AC Sheeting	4m2	All surfaces	Good Condition (1)	Low (1)	Low Priority (2-3)	Chrysotile (white asbestos) , Amosite (brown asbestos)
Floor Coverings Res/Textile	Vinyl Sheet						
B00E - R0007 - Home Base Store - 18.98 m2							
Ceiling Structures/Linings	Flat AC Sheeting	19m2	All surfaces	Good Condition (1)	Low (1)	Low Priority (2-3)	Chrysotile (white asbestos) , Amosite (brown asbestos)
Floor Coverings Res/Textile	Vinyl Tiles (Under Floor Covering/Carpet)						
B00E - R0008 - General Storeroom - 5.19 m2							
Floor Coverings Res/Textile	Vinyl Tiles	6m2	All surfaces	Good Condition (1)	Low (1)	Low Priority (2-3)	Chrysotile (white asbestos)
Ceiling Structures/Linings	Flat AC Sheeting	6m2	All surfaces	Good Condition (1)	Low (1)	Low Priority (2-3)	Chrysotile (white asbestos) , Amosite (brown asbestos)
B00F - General Learning - 1976 - Brick/Veneer							
Exterior							
Ceiling Voids - Flat Roof	Non Accessible Area						
Underfloor Voids	No Asbestos Found						
Eaves Linings	Flat AC Sheeting	60.00m2	East facing, West facing	Good Condition (1)	Low (1)	Low Priority (2-3)	Assumed Asbestos
Interior							
B00F - R0001 - Home Base - 56.94 m2							
No Asbestos							
B00F - R0002 - Home Base Store - 10.32 m2							

Ceiling Structures/Linings	Flat AC Sheeting							
B00F - R0003 - Cleaning Distributed Store - 2.65 m2								
No Asbestos								
B00F - R0004 - General Storeroom - .77 m2								
No Asbestos								
B00F - R0005 - Staff Room Annexe - 13.81 m2								
Floor Coverings Res/Textile	Vinyl Tiles (Under Floor Covering/Carpet)							
B00F - R0006 - Distribution Board - .71 m2								
Note: No inspection of live electrical installation								
No Asbestos								
B00F - R0007 - Movement - 29.54 m2								
Floor Coverings Res/Textile	Vinyl Sheet							
Wall Linings Internal - Infill	Flat AC Sheeting	1m2	Above both east and west doors	Good Condition (1)	Low (1)	Low Priority (2-3)	Chrysotile (white asbestos) , Amosite (brown asbestos)	
B00F - R0008 - Movement - 4.95 m2								
Ceiling Structures/Linings	Flat AC Sheeting	5m2	All surfaces	Good Condition (1)	Low (1)	Low Priority (2-3)	Chrysotile (white asbestos) , Amosite (brown asbestos)	
B00F - R0009 - Home Base Store - 10.45 m2								
No Asbestos								
B00F - R0010 - Home Base - 57.49 m2								
No Asbestos								
B00F - R0011 - Home Base - 71.85 m2								
No Asbestos								
B00F - R0012 - Home Base Store - 13.88 m2								
No Asbestos								
B00F - R0014 - Toilets - Boys/Girls - 3.41 m2								
Wall Linings Internal	Flat AC Sheeting	8m2	All surfaces	Good Condition (1)	Low (1)	Low Priority (2-3)	Chrysotile (white asbestos) , Amosite (brown asbestos)	
Ceiling Structures/Linings	Flat AC Sheeting	4.00m2	All surfaces	Good Condition (1)	Low (1)	Low Priority (2-3)	Chrysotile (white asbestos) , Amosite (brown asbestos)	
B00F - R0015 - Movement - 5.52 m2								
Ceiling Structures/Linings	Flat AC Sheeting	6m2	All surfaces	Good Condition (1)	Low (1)	Low Priority (2-3)	Chrysotile (white asbestos) , Amosite (brown asbestos)	
Gable Ends	Flat AC Sheeting	2	North facing	Good Condition (1)	Low (1)	Low Priority (2-3)	Chrysotile (white asbestos) , Amosite (brown asbestos)	
B00F - R0016 - Movement - 16.29 m2								
No Asbestos								
B00F - R0017 - Toilets - Boys/Girls - 3.62 m2								
No Asbestos								
B00F - R0018 - Home Base - 86.67 m2								
No Asbestos								
B00F - R0019 - Movement - 52.12 m2								
No Asbestos								
B00F - R0021 - Movement - 102.35 m2								
No Asbestos								
B00F - R9001 - Sports Store - 69.91 m2								
Floor Coverings Res/Textile	Vinyl Sheet							
B00G - General Learning - 2011 - Brick/Veneer								

Exterior		
Underfloor Voids	No Asbestos Found	
Ceiling Voids	No Asbestos Found	
Interior		
B00G-R0001 - Home Base - 60.91 m2		
No Asbestos		
B00G-R0002 - Home Base - 60.9 m2		
No Asbestos		
B00G-R0003 - Home Base Store - 6.12 m2		
No Asbestos		
B00G-R0004 - Practical Activities - 1hb - 18.81 m2		
No Asbestos		
B00G-R0005 - Withdrawal Space - 2hb - 11.51 m2		
No Asbestos		
B00G-R0006 - Practical Activities - 1hb - 18.91 m2		
No Asbestos		
B00G-R0007 - Home Base Store - 6.12 m2		
No Asbestos		
B00G-R0008 - General Storeroom - 4.15 m2		
No Asbestos		
B00G-R0009 - External Movement - 67.99 m2		
No Asbestos		
B00G-R0010 - Stairs - 4.47 m2		
No Asbestos		
B00G-R0011 - Stairs - 14.04 m2		
No Asbestos		
B00G-R0012 - Stairs - 11.92 m2		
No Asbestos		
B00G-R1001 - Home Base - 60.9 m2		
No Asbestos		
B00G-R1002 - Home Base - 60.8 m2		
No Asbestos		
B00G-R1003 - Home Base Store - 6.12 m2		
No Asbestos		
B00G-R1004 - Practical Activities - 1hb - 18.65 m2		
No Asbestos		
B00G-R1005 - Withdrawal Space - 2hb - 11.51 m2		
No Asbestos		
B00G-R1006 - Practical Activities - 1hb - 18.7 m2		
No Asbestos		
B00G-R1007 - Home Base Store - 6.12 m2		
No Asbestos		
B00G-R1008 - External Movement - 67.99 m2		
No Asbestos		
B00G-R1009 - External Stairs - 18.45 m2		
No Asbestos		
B00G-R1010 - External Stairs - 18.98 m2		
No Asbestos		
B00G-R9001 - Home Base - 58.61 m2		
No Asbestos		

B00G - R9002 - Practical Activities - 1hb - 18.65 m2							
No Asbestos							
B00G - R9003 - Home Base Store - 5.95 m2							
No Asbestos							
B00G - R9004 - Withdrawal Space - 1hb - 8.81 m2							
No Asbestos							
B00G - R9005 - General Storeroom - 3.8 m2							
No Asbestos							
B00G - R9006 - External Movement - 35.17 m2							
No Asbestos							
B00G - R9007 - External Movement - 14.93 m2							
No Asbestos							
B00G - R9008 - Stairs - 14.35 m2							
No Asbestos							
B00H - General Learning - 1976 - Brick/Block							
Exterior							
Ceiling Voids - Flat Roof	Non Accessible Area						
Underfloor Voids	Non Accessible Area						
Eaves Linings	Flat AC Sheeting	200.00m2	East facing, West facing	Good Condition (1)	Low (1)	Low Priority (2-3)	Chrysotile (white asbestos), Amosite (brown asbestos)
Wall Linings Internal - Infill / Balustrade	Flat AC Sheeting						
Interior							
B00H - R0001 - Home Base - 57.69 m2							
No Asbestos							
B00H - R0002 - Home Base Store - 4.99 m2							
No Asbestos							
B00H - R0003 - Home Base Store - 11.5 m2							
Floor Coverings Res/Textile	Vinyl Tiles						
B00H - R0005 - Movement - 5.64 m2							
Wall Linings Internal - Infill	Flat AC Sheeting	0.5m2	East, above door	Good Condition (1)	Low (1)	Low Priority (2-3)	Chrysotile (white asbestos), Amosite (brown asbestos)
B00H - R0006 - Movement - 4.56 m2							
Ceiling Structures/Linings	Flat AC Sheeting	5m2	All surfaces	Good Condition (1)	Low (1)	Low Priority (2-3)	Chrysotile (white asbestos), Amosite (brown asbestos)
B00H - R0007 - Home Base Store - 5 m2							
No Asbestos							
B00H - R0008 - Home Base - 57.3 m2							
No Asbestos							
B00H - R0009 - Home Base - 57.3 m2							
No Asbestos							
B00H - R0010 - Home Base Store - 5 m2							
No Asbestos							
B00H - R0011 - Home Base Store - 11.5 m2							
Floor Coverings Res/Textile	Vinyl Tiles						
B00H - R0012 - Movement - 5.64 m2							
Wall Linings Internal - Infill	Flat AC Sheeting						
B00H - R0013 - Movement - 4.56 m2							

Ceiling Structures/Linings	Flat AC Sheeting	5m2	All surfaces	Good Condition (1)	Low (1)	Low Priority (2-3)	Chrysotile (white asbestos) , Amosite (brown asbestos)
B00H - R0014 - Home Base Store - 5 m2							
No Asbestos							
B00H - R0015 - Home Base - 57.06 m2							
No Asbestos							
B00H - R0016 - Movement - 1.38 m2							
Ceiling Structures/Linings	Flat AC Sheeting	1.4m2	All surfaces	Good Condition (1)	Low (1)	Low Priority (2-3)	Chrysotile (white asbestos) , Amosite (brown asbestos)
B00H - R0017 - Movement - 22.66 m2							
No Asbestos							
B00H - R0018 - Home Base - 57.53 m2							
No Asbestos							
B00H - R0019 - Home Base Store - 7.65 m2							
No Asbestos							
B00H - R0020 - Home Base Store - 7.24 m2							
No Asbestos							
B00H - R9003 - Special Programs Room - 21.13 m2							
Floor Coverings Res/Textile	Vinyl Tiles	6.00m2	All surfaces	Good Condition (1)	Low (1)	Low Priority (2-3)	Chrysotile (white asbestos)
Floor Coverings Res/Textile	Vinyl Tiles (Under Floor Covering/Carpet)	15m2	All surfaces	Good Condition (1)	Low (1)	Low Priority (2-3)	Chrysotile (white asbestos)
B00H - R9004 - Craft Store - 9.92 m2							
Floor Coverings Res/Textile	Vinyl Tiles	10m2	All surfaces	Good Condition (1)	Low (1)	Low Priority (2-3)	Chrysotile (white asbestos)
B00H - R9005 - Cleaning Distributed Store - .76 m2							
Ceiling Structures/Linings	Flat AC Sheeting	1m2	All surfaces	Good Condition (1)	Low (1)	Low Priority (2-3)	Chrysotile (white asbestos)
Floor Coverings Res/Textile	Vinyl Tiles	1.00m2	All surfaces	Good Condition (1)	Low (1)	Low Priority (2-3)	Chrysotile (white asbestos)
B00H - R9006 - General Storeroom - 23.72 m2							
Floor Coverings Res/Textile	Vinyl Tiles	24.00m2	All surfaces	Good Condition (1)	Low (1)	Low Priority (2-3)	Chrysotile (white asbestos)
B00H - R9007 - Toilets - Boys/Girls - 4.04 m2							
Partition Walls (Cubicles)	Flat AC Sheeting						
B00H - R9008 - Movement - 13.29 m2							
Floor Coverings Res/Textile	Vinyl Tiles	14.00m2	All surfaces	Good Condition (1)	Low (1)	Low Priority (2-3)	Chrysotile (white asbestos)
B00H - R9009 - Out Of School Hours Care Centre - 36.19 m2							
Require Inspection							
B00H - R9010 - Out Of School Hours Care Centre - 103.96 m2							
Require Inspection							
B00H - R9011 - Out Of School Hours Care Centre - 7.34 m2							
Require Inspection							
B00H - R9012 - External Movement - 155.4 m2							
Require Inspection							
B00I - Pupil Facilities - 1976 - Brick/Block							
Exterior							
Ceiling Voids - Flat Roof	Non Accessible Area						
Underfloor Voids	Non Accessible Area						

Eaves Linings	Flat AC Sheeting	60m2	All surfaces	Good Condition (1)	Low (1)	Low Priority (2-3)	Chrysotile (white asbestos) , Amosite (brown asbestos)
Wall Cladding	Flat AC Sheeting						
Interior							
B00I - R0001 - Toilets - Girls - 32.12 m2							
Partition Walls (Cubicles)	Flat AC Sheeting	16.00m2	All surfaces	Good Condition (1)	Low (1)	Low Priority (2-3)	Chrysotile (white asbestos)
Ceiling Structures/Linings	Flat AC Sheeting	32m2	All surfaces	Good Condition (1)	Low (1)	Low Priority (2-3)	Chrysotile (white asbestos) , Amosite (brown asbestos)
B00I - R0002 - Drinking Facilities - 13.79 m2							
Ceiling Structures/Linings	Flat AC Sheeting	14m2	All surfaces	Good Condition (1)	Low (1)	Low Priority (2-3)	Chrysotile (white asbestos) , Amosite (brown asbestos)
B00I - R0003 - Drinking Facilities - 13.79 m2							
Ceiling Structures/Linings	Flat AC Sheeting	14m2	All surfaces	Good Condition (1)	Low (1)	Low Priority (2-3)	Chrysotile (white asbestos) , Amosite (brown asbestos)
B00I - R0004 - Toilets - Boys - 32.11 m2							
Partition Walls (Cubicles)	Flat AC Sheeting	16.00m2	All surfaces	Good Condition (1)	Low (1)	Low Priority (2-3)	Chrysotile (white asbestos)
Ceiling Structures/Linings	Flat AC Sheeting	32m2	All surfaces	Good Condition (1)	Low (1)	Low Priority (2-3)	Chrysotile (white asbestos) , Amosite (brown asbestos)
B00I - R0005 - General Assistant/Bulk Store - 52.09 m2							
No Asbestos							
B00J - Building Services - 1976 - Brick/Block							
Exterior							
Ceiling Voids - Flat Roof	Non Accessible Area						
Underfloor Voids - Slab on Ground	Non Accessible Area						
Gable Ends	Flat AC Sheeting	4m2	East and west	Good Condition (1)	Low (1)	Low Priority (2-3)	Chrysotile (white asbestos)
Interior							
B00J - R0001 - Plant - 21.05 m2							
No Asbestos							
B00K - Other-Community Use - 2005 - Steel							
Exterior							
Underfloor Voids	No Asbestos Found						
Ceiling Voids	No Asbestos Found						
Interior							
B00K - R0001 - Other-Community Use - 66.31 m2							
Floor Coverings Res/Textile	No Asbestos Found						
B00K - R0002 - Other-Community Use - 10.25 m2							
Floor Coverings Res/Textile	Vinyl Sheet						
B00K - R0003 - Other-Community Use - 66.15 m2							
Floor Coverings Res/Textile	No Asbestos Found						
B00K - R0004 - Other-Community Use - 10.37 m2							
Floor Coverings Res/Textile	Vinyl Sheet						
B00K - R0005 - Other-Community Use - 37.07 m2							

Floor Coverings Res/Textile	Flat AC Sheeting	
--------------------------------	------------------	--

Demountables

OS 602 10035 - Learning Unit - Standard With P.A.A. - Placement Date : 30-DEC-2009

Note: This refurbished demountable may have asbestos present in remnant mastic in window frames.

No Asbestos Found

OS 602 14309 - Learning Unit - Standard With P.A.A. - Placement Date : 09-JAN-2016

Note: This refurbished demountable may have asbestos present in remnant mastic in window frames.

No Asbestos Found

OS 603 15928 - Learning Unit - Standard With P.A.A. A/C - Placement Date : 16-DEC-2004

Note: This refurbished demountable may have asbestos present in remnant mastic in window frames.

No Asbestos Found

OS 606 19123 - Learning Unit - Standard With P.A.A A/C - Placement Date : 29-NOV-2017

Note: This refurbished demountable may have asbestos present in remnant mastic in window frames.

No Asbestos Found

OS 606 19126 - Learning Unit - Standard With P.A.A A/C - Placement Date : 22-DEC-2017

Note: This refurbished demountable may have asbestos present in remnant mastic in window frames.

No Asbestos Found

OS 606 19205 - Learning Unit - Standard With P.A.A A/C - Placement Date : 05-MAY-2018

Note: This refurbished demountable may have asbestos present in remnant mastic in window frames.

No Asbestos Found

OS 606 19207 - Learning Unit - Standard With P.A.A A/C - Placement Date : 29-FEB-2020

Note: This refurbished demountable may have asbestos present in remnant mastic in window frames.

No Asbestos Found