

# Asbestos Register

(Hazardous Materials and Risk Assessment)

<b>School:</b>	<b>Lawson Public School (2381)</b>
<b>Region:</b>	<b>Western Sydney AMU</b>
<b>State Electorate:</b>	<b>Blue Mountains</b>
<b>Local Government Area:</b>	<b>Blue Mountains</b>

<b>Last Reviewed By:</b>	<b>Greencap 19-DEC-2017</b>
<b>Last Revised By:</b>	

<b>Historical Fibro In Grounds Investigations/Events</b>	<b>Yes</b>
Please refer to the latest site specific Asbestos Management Plans available from the Department's website (Refer to Note 2).	

2381 - Lawson Public School  
Site Plan (12759)

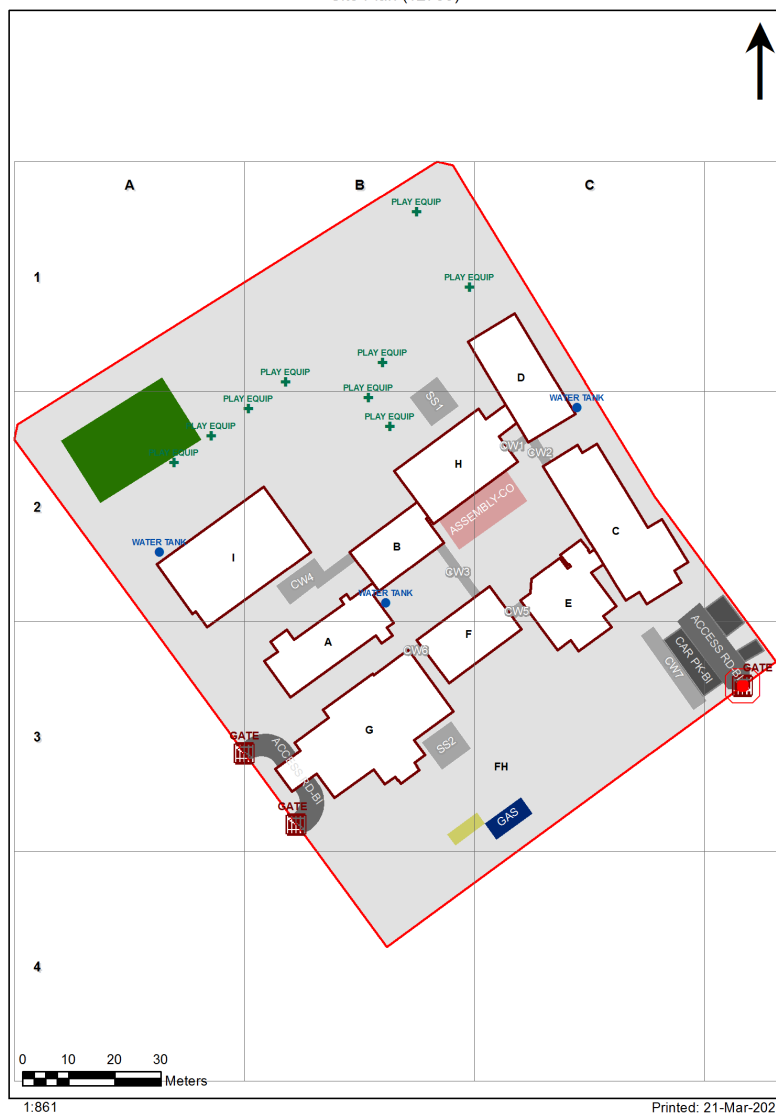

1:861

Printed: 21-Mar-2020

# Preface to Asbestos Register

## Limitations

Asbestos Registers established (first surveyed 2007/08) and maintained for the Department of Education (DoE) are limited in extent, in that:

1. All inspections and surveys of materials and finishes in DoE facilities are non-disturbance, with
2. Samples undertaken by hygienist to determine whether a sample is an Asbestos Containing Material (ACM),
3. The hygienist may apply a single sample to like materials within a space and adjoining spaces, but not normally between buildings,
4. Successive inspections have reduced any inconclusive records such as 'assumed asbestos' in difficult to access areas, by undertaking additional sampling with lifting devices.
5. In compliance with WHS Act 2011 and WHS Regulations 2017, additional inspections have been undertaken in ceiling spaces and sub-floor areas where access is possible.
  - o Where the ground floor is slab on ground, no inspection is made beneath the slab.
  - o Where fibro fragments (ACM taken for sampling) are located in ceiling spaces or sub floor voids air monitoring is normally undertaken at time of sampling, and clearance undertaken as soon as practicable.
6. No attempt has been made to identify any ACM that is hidden from view or encapsulated within
  - o Any wall cavity
  - o Sub floor area, particularly formwork for slabs in/on ground,
  - o Services (that may use ACM) such as: pipe lagging, asbestos cement pipes, flues.
7. All known ACM in Grounds (Fibro in Grounds) is made available in associated site specific asbestos management plans in DoE electronic files.  
Notwithstanding information provided, ACM may be present in grounds from time to time and caution must be exercised prior to any grounds disturbance.

## Use of the Asbestos Register

Prior to any disturbance works being undertaken in a building to which this asbestos register applies it will be necessary to confirm the extent of any ACM by a disturbance investigation:

- If the building was built prior to 2003
- If any ACM has been identified in the Asbestos Register for the building.

## Update of Asbestos Registers

Asbestos Register Data is updated regularly by the DoE Hygienist Panel via the Online Asbestos Register Tool (Managed by Business Systems, School Infrastructure NSW). Internal users can view the latest edition of the Asbestos Register in the AMS.

Please note: The Department's external website may not contain the latest revision of the Asbestos Register.

## Notes 1: Vermiculite

- During 2018/19, all vermiculite occurrences in DoE schools identified in 2007/08, were 'composite tested' in accordance with a safe work NSW agreed procedure. This required multiple testing of all vermiculite occurrences.
- During the period 2007/08 to 2018/19, some vermiculite has been over sheeted and a warning is indicated for schools where this has happened.

## Note 2: DoE website link for information is here:

<https://www.schoolinfrastructure.nsw.gov.au/about-us/working-with-us/schools-asbestos-register.html>  
<https://education.nsw.gov.au/about-us/strategies-and-reports/our-reports-and-reviews/schools-asbestos-register>

## Note 3: Material Condition Assessment

The material condition assessment descriptors from Section 3 of the Asbestos Management Plan (AMP) is extracted below. Please read the AMP in its entirety for further information.

### 3.3.2.1 Material condition assessment

The OART records the material condition of identified ACM in the following format:

Rating	Description
Good condition (1)	For non-friable asbestos that is sealed and has no visible damage. This primarily related to asbestos cement (AC) sheet and vinyl tiles
Minimal damage (2)	For non-friable asbestos that has a very small amount of damage, eg hairline cracks.
Some damage / unsealed (3)	For non-friable asbestos with significant breakage or several small areas where material has been damaged, revealing loose asbestos fibres. Non-friable asbestos that is unsealed.
Poor condition (4)	For non-friable asbestos that has extensive damage. Visible asbestos debris
Friable asbestos (5)	Any occurrence of friable asbestos

Product	Material Description	Extent	Location	Material Condition	Risk Status	Remediation Priority	Result
<b>B00A - General Learning/Staff Facilities - 1918 - Brick/Block</b>							
<b>Exterior</b>							
Eaves Linings	Flat AC Sheeting	20m2	Throughout	Good Condition (1)	Low (1)	Low Priority (2-3)	Chrysotile (white asbestos)
Ceiling Voids	Non Accessible Area						
Underfloor Voids	AC Fragments/Debris	1	Variable positions	Some Damage - Unsealed (3)	Low (1)	Low Priority (2-3)	Assumed Asbestos
Underfloor Voids	Requires Inspection						
<b>Interior</b>							
<b>B00A - R0001 - Movement - 26.07 m2</b>							
No Asbestos							
<b>B00A - R0002 - Craft Store - 10.79 m2</b>							
No Asbestos							
<b>B00A - R0003 - Movement - 1.78 m2</b>							
Ceiling Structures/Linings	Flat AC Sheeting	1m2	Throughout	Good Condition (1)	Low (1)	Low Priority (2-3)	Chrysotile (white asbestos)
<b>B00A - R0004 - Home Base - 69.68 m2</b>							
No Asbestos							
<b>B00A - R0005 - Movement - 40.58 m2</b>							
Floor Coverings Res/Textile	Vinyl Tiles	41m2	Throughout	Good Condition (1)	Low (1)	Low Priority (2-3)	Chrysotile (white asbestos)
<b>B00A - R0006 - Home Base - 71.63 m2</b>							
No Asbestos							
<b>B00A - R0007 - General Storeroom - 10.9 m2</b>							
Floor Coverings Res/Textile	Vinyl Tiles	11m2	Throughout	Good Condition (1)	Low (1)	Low Priority (2-3)	Chrysotile (white asbestos)
<b>B00A - R0008 - Staff Room Annexe - 12.42 m2</b>							
Floor Coverings Res/Textile	Vinyl Tiles	13m2	Throughout	Good Condition (1)	Low (1)	Low Priority (2-3)	Chrysotile (white asbestos)
<b>B00A - R0009 - Practical Activities - 1hb - 6.58 m2</b>							
Ceiling Structures/Linings	Flat AC Sheeting	7m2	Throughout	Good Condition (1)	Low (1)	Low Priority (2-3)	Chrysotile (white asbestos)
Wall Linings Internal	Flat AC Sheeting	15m2	Throughout	Good Condition (1)	Low (1)	Low Priority (2-3)	Chrysotile (white asbestos)
<b>B00A - R0010 - Movement - 4.13 m2</b>							
Ceiling Structures/Linings	Flat AC Sheeting	4m2	Throughout	Good Condition (1)	Low (1)	Low Priority (2-3)	Chrysotile (white asbestos)
<b>B00A - R0011 - Garden Store - 4.48 m2</b>							
No Asbestos							
<b>B00A - R0012 - Stairs - 3.01 m2</b>							
Ceiling Structures/Linings	Flat AC Sheeting	3m2	Throughout	Good Condition (1)	Low (1)	Low Priority (2-3)	Chrysotile (white asbestos)
<b>B00B - Tiered Learning/Pupil Facilities - 1966 - Brick/Block</b>							
<b>Exterior</b>							
Underfloor Voids - Slab on Ground	No Asbestos Found						
Ceiling Voids	No Asbestos Found						
Ceiling Voids	Requires Inspection						
<b>Interior</b>							
<b>B00B - R0001 - Movement - 109.55 m2</b>							

No Asbestos		
<b>B00B - R0002 - Toilets - Girls - 7.48 m2</b>		
No Asbestos		
<b>B00B - R0003 - Distribution Board - 2.8 m2</b>		<b>Note: No inspection of live electrical installation</b>
No Asbestos		
<b>B00B - R0004 - Special Programs Store - 2.34 m2</b>		
Floor Coverings Res/Textile	No Asbestos Found	
<b>B00B - R0005 - Special Programs Room - 32.85 m2</b>		
Floor Coverings Res/Textile	No Asbestos Found	
<b>B00B - R0006 - Toilets - Boys - 8.12 m2</b>		
No Asbestos		
<b>B00B - R0007 - Kiln Room - 5.64 m2</b>		
No Asbestos		
<b>B00C - Administration/General Learning - 1991 - Brick/Block</b>		
<b>Exterior</b>		
Ceiling Voids	No Asbestos Found	
Underfloor Voids	No Asbestos Found	
Underfloor Voids	No Asbestos Found	
<b>Interior</b>		
<b>B00C - R0001 - Movement - 85.1 m2</b>		
No Asbestos		
<b>B00C - R0002 - Staff Room - 49.14 m2</b>		
Floor Coverings Res/Textile	No Asbestos Found	
<b>B00C - R0003 - Staff Toilet - 4.11 m2</b>		
No Asbestos		
<b>B00C - R0004 - Staff Toilet - 4.11 m2</b>		
No Asbestos		
<b>B00C - R0005 - Staff Toilet - 4.11 m2</b>		
No Asbestos		
<b>B00C - R0006 - Cleaning Distributed Store - .78 m2</b>		
No Asbestos		
<b>B00C - R0007 - Security Store - 17.1 m2</b>		
No Asbestos		
<b>B00C - R0008 - Interview - 13.15 m2</b>		
Floor Coverings Res/Textile	No Asbestos Found	
<b>B00C - R0009 - Entry Vestibule - 27.55 m2</b>		
Floor Coverings Res/Textile	No Asbestos Found	
<b>B00C - R0010 - Sick Bay - 8.71 m2</b>		
No Asbestos		
<b>B00C - R0011 - Staff Shower/Change - 7.27 m2</b>		
No Asbestos		
<b>B00C - R0012 - Duplicating Workroom - 20.92 m2</b>		
No Asbestos		
<b>B00C - R0013 - Principal - 17.03 m2</b>		
Floor Coverings Res/Textile	No Asbestos Found	

<b>B00C - R0014 - Clerical Office - 17.77 m2</b>		
Floor Coverings Res/Textile	No Asbestos Found	
<b>B00C - R0015 - Movement - 7.51 m2</b>		
Floor Coverings Res/Textile	No Asbestos Found	
<b>B00C - R0016 - Movement - 3.05 m2</b>		
No Asbestos		
<b>B00C - R0017 - Distribution Board - .81 m2</b>		<b>Note: No inspection of live electrical installation</b>
No Asbestos		
<b>B00C - R0018 - Movement - 16.55 m2</b>		
Floor Coverings Res/Textile	No Asbestos Found	
<b>B00C - R0019 - Staff Room Annexe - 13.45 m2</b>		
Floor Coverings Res/Textile	No Asbestos Found	
<b>B00C - R0020 - Staff Room Annexe - 13.36 m2</b>		
Floor Coverings Res/Textile	No Asbestos Found	
<b>B00C - R0021 - Staff Room Annexe - 19.12 m2</b>		
Floor Coverings Res/Textile	No Asbestos Found	
<b>B00C - R0022 - Stairs - 6.8 m2</b>		
Floor Coverings Res/Textile	No Asbestos Found	
<b>B00C - R1001 - Movement - 41.82 m2</b>		
No Asbestos		
<b>B00C - R1002 - Cleaning Distributed Store - .54 m2</b>		
No Asbestos		
<b>B00C - R1003 - Distribution Board - .92 m2</b>		<b>Note: No inspection of live electrical installation</b>
No Asbestos		
<b>B00C - R1004 - Practical Activities - 1hb - 20.35 m2</b>		
No Asbestos		
<b>B00C - R1005 - Home Base - 58.52 m2</b>		
Floor Coverings Res/Textile	No Asbestos Found	
<b>B00C - R1006 - Home Base Store - 5.78 m2</b>		
Floor Coverings Res/Textile	No Asbestos Found	
<b>B00C - R1007 - Withdrawal Space - 1hb - 11.82 m2</b>		
Floor Coverings Res/Textile	No Asbestos Found	
<b>B00C - R1008 - Home Base Store - 5.78 m2</b>		
Floor Coverings Res/Textile	No Asbestos Found	
<b>B00C - R1009 - Home Base - 58.52 m2</b>		
Floor Coverings Res/Textile	No Asbestos Found	
<b>B00C - R1010 - Practical Activities - 1hb - 20.27 m2</b>		
No Asbestos		
<b>B00C - R1011 - Stairs - 5.71 m2</b>		
Floor Coverings Res/Textile	No Asbestos Found	
<b>B00D - Pupil Facilities/Administration - 1990 - Brick/Block</b>		
Exterior		

Underfloor Voids - Slab on Ground	No Asbestos Found	
Ceiling Voids	No Asbestos Found	
<b>Interior</b>		
<b>B00D - R0002 - Movement - 85.72 m2</b>		
No Asbestos		
<b>B00D - R0004 - Community Clinic - 20.43 m2</b>		
Floor Coverings Res/Textile	No Asbestos Found	
<b>B00D - R0005 - General Assistant/Bulk Store - 5.26 m2</b>		
No Asbestos		
<b>B00D - R0006 - Cleaning Supplies - 7.94 m2</b>		
No Asbestos		
<b>B00D - R0007 - Cleaning Supplies - 6.59 m2</b>		
No Asbestos		
<b>B00D - R0008 - Distribution Board - .36 m2</b>		
No Asbestos		<b>Note: No inspection of live electrical installation</b>
<b>B00D - R0009 - General Assistant/Bulk Store - 13.11 m2</b>		
No Asbestos		
<b>B00D - R0010 - Toilets - Boys - 19.81 m2</b>		
No Asbestos		
<b>B00D - R0011 - Disabled Toilet - 4.92 m2</b>		
No Asbestos		
<b>B00D - R0012 - Toilets - Girls - 19.76 m2</b>		
No Asbestos		
<b>B00D - R0013 - Canteen - 26.17 m2</b>		
No Asbestos		
<b>B00D - R0014 - Canteen Office/Store - 9.06 m2</b>		
No Asbestos		
<b>B00D - R0015 - Community Clinic - 7.23 m2</b>		
Floor Coverings Res/Textile	No Asbestos Found	
<b>B00D - R0016 - Community Clinic - 2.52 m2</b>		
No Asbestos		
<b>B00E - General Learning - 1990 - Brick/Block</b>		
<b>Exterior</b>		
Ceiling Voids	No Asbestos Found	
Underfloor Voids	No Asbestos Found	
<b>Interior</b>		
<b>B00E - R0002 - Practical Activities - 1hb - 20.27 m2</b>		
No Asbestos		
<b>B00E - R0003 - Home Base - 58.14 m2</b>		
Floor Coverings Res/Textile	No Asbestos Found	
<b>B00E - R0004 - Home Base Store - 5.78 m2</b>		
Floor Coverings Res/Textile	No Asbestos Found	
<b>B00E - R0005 - Withdrawal Space - 1hb - 11.67 m2</b>		
Floor Coverings Res/Textile	No Asbestos Found	
<b>B00E - R0006 - Home Base Store - 5.78 m2</b>		

Floor Coverings Res/Textile	No Asbestos Found	
<b>B00E - R0007 - Home Base - 58.52 m2</b>		
Floor Coverings Res/Textile	No Asbestos Found	
<b>B00E - R0008 - Practical Activities - 1hb - 20.27 m2</b>		
No Asbestos		
<b>B00E - R0009 - Movement - 47.06 m2</b>		
No Asbestos		
<b>B00E - R0010 - Movement - 10.7 m2</b>		
No Asbestos		
<b>B00E - R0011 - Movement - 13.44 m2</b>		
No Asbestos		
<b>B00E - R0012 - Plant - 4.94 m2</b>		
No Asbestos		
<b>B00E - R0013 - Lift - 2.1 m2</b>		
No Asbestos		
<b>B00E - R1002 - Practical Activities - 1hb - 20.28 m2</b>		
No Asbestos		
<b>B00E - R1003 - Home Base - 58.52 m2</b>		
Floor Coverings Res/Textile	No Asbestos Found	
<b>B00E - R1004 - Home Base Store - 5.78 m2</b>		
Floor Coverings Res/Textile	No Asbestos Found	
<b>B00E - R1005 - Withdrawal Space - 1hb - 11.82 m2</b>		
Floor Coverings Res/Textile	No Asbestos Found	
<b>B00E - R1006 - Home Base Store - 5.78 m2</b>		
Floor Coverings Res/Textile	No Asbestos Found	
<b>B00E - R1007 - Home Base - 58.52 m2</b>		
Floor Coverings Res/Textile	No Asbestos Found	
<b>B00E - R1008 - Practical Activities - 1hb - 20.28 m2</b>		
No Asbestos		
<b>B00E - R1009 - Movement - 58.86 m2</b>		
No Asbestos		
<b>B00E - R1010 - Lift - 2.1 m2</b>		
No Asbestos		
<b>B00F - Library - 1918 - Brick/Veneer</b>		
<b>Exterior</b>		
Ceiling Voids - Raked Ceiling	No Asbestos Found	
Underfloor Voids - Slab on Ground	No Asbestos Found	
<b>Interior</b>		
<b>B00F - R0001 - Movement - 76.5 m2</b>		
No Asbestos		
<b>B00F - R0002 - Reading Area - 88.41 m2</b>		
No Asbestos		
<b>B00F - R0003 - K.L.A. Store - 10.09 m2</b>		
No Asbestos		
<b>B00F - R0004 - Library Office/Workroom - 19.98 m2</b>		

No Asbestos							
<b>B00F - R0005 - Distribution Board - 1.53 m2</b>							<b>Note: No inspection of live electrical installation</b>
Wall Linings Internal	Flat AC Sheeting	10m2	Throughout	Some Damage - Unsealed (3)	Low (1)	Low Priority (2-3)	Chrysotile (white asbestos)
<b>B00G - Support Unit - 1990 - Brick/Veneer</b>							
<b>Exterior</b>							
Ceiling Voids	No Asbestos Found						
Underfloor Voids	No Asbestos Found						
<b>Interior</b>							
<b>B00G - R0001 - Movement - 15.07 m2</b>							
No Asbestos							
<b>B00G - R0002 - Withdrawal - S - 8.61 m2</b>							
Floor Coverings Res/Textile	No Asbestos Found						
<b>B00G - R0003 - Home Base Store - S - 8.06 m2</b>							
Floor Coverings Res/Textile	No Asbestos Found						
<b>B00G - R0004 - Home Base - S - 49.84 m2</b>							
Floor Coverings Res/Textile	No Asbestos Found						
<b>B00G - R0005 - Practical Activities - S - 1hb - 13.07 m2</b>							
No Asbestos							
<b>B00G - R0006 - Home Base Store - S - 7.39 m2</b>							
Floor Coverings Res/Textile	No Asbestos Found						
<b>B00G - R0007 - Staff Room Annexe - 9.31 m2</b>							
Floor Coverings Res/Textile	No Asbestos Found						
<b>B00G - R0008 - Home Base - S - 49.7 m2</b>							
Floor Coverings Res/Textile	No Asbestos Found						
<b>B00G - R0009 - Practical Activities - S - 1hb - 13.04 m2</b>							
No Asbestos							
<b>B00G - R0010 - Toilet - S - 31.89 m2</b>							
No Asbestos							
<b>B00G - R0011 - Laundry - S - 13.57 m2</b>							
No Asbestos							
<b>B00G - R0012 - Toilet - S - 31.91 m2</b>							
No Asbestos							
<b>B00G - R0013 - Main Switch Board - 1.65 m2</b>							
No Asbestos							
<b>B00G - R0014 - Staff Kitchen - 2.76 m2</b>							
No Asbestos							
<b>B00G - R0015 - Practical Activities - S - 1hb - 63.79 m2</b>							
No Asbestos							
<b>B00G - R0016 - Practical Activities - S - 1hb - 12.98 m2</b>							
No Asbestos							
<b>B00G - R0017 - Home Base - S - 48.71 m2</b>							
Floor Coverings Res/Textile	No Asbestos Found						
<b>B00G - R0018 - Staff Room Annexe - 9.31 m2</b>							
Floor Coverings Res/Textile	No Asbestos Found						



<b>B00G - R0019 - Home Base Store - S - 7.39 m2</b>		
Floor Coverings Res/Textile	No Asbestos Found	
<b>B00G - R0020 - Cleaning Distributed Store - 3.09 m2</b>		
No Asbestos		
<b>B00G - R0021 - Wheelchair Store - 37.06 m2</b>		
No Asbestos		
<b>B00G - R0022 - Covered Vehicle Area/Porte Cochere - 36.85 m2</b>		
No Asbestos		
<b>B00G - R0023 - Movement - 30.31 m2</b>		
No Asbestos		
<b>B00G - R0024 - Outdoor Learning Area - 52.68 m2</b>		
Floor Coverings Res/Textile	No Asbestos Found	
<b>B00H - General Learning/Staff Facilities - 1966 - Brick/Veneer</b>		
<b>Exterior</b>		
Ceiling Voids	No Asbestos Found	
Underfloor Voids	No Asbestos Found	
<b>Interior</b>		
<b>B00H - R0001 - Home Base - 57.92 m2</b>		
Floor Coverings Res/Textile	No Asbestos Found	
<b>B00H - R0002 - Home Base Store - 4.24 m2</b>		
No Asbestos		
<b>B00H - R0003 - Personal Effects Storage - 8.88 m2</b>		
Floor Coverings Res/Textile	No Asbestos Found	
<b>B00H - R0004 - Movement - 6.51 m2</b>		
No Asbestos		
<b>B00H - R0005 - Craft Store - .55 m2</b>		
No Asbestos		
<b>B00H - R0006 - Cleaning Distributed Store - .51 m2</b>		
No Asbestos		
<b>B00H - R0007 - Home Base Store - 4.16 m2</b>		
No Asbestos		
<b>B00H - R0008 - Home Base - 56.88 m2</b>		
Floor Coverings Res/Textile	No Asbestos Found	
<b>B00H - R0009 - Movement - 2.74 m2</b>		
Floor Coverings Res/Textile	No Asbestos Found	
<b>B00H - R0010 - Staff Toilet - 3.4 m2</b>		
No Asbestos		
<b>B00H - R0011 - Sports Store - 21.58 m2</b>		
No Asbestos		
<b>B00H - R0014 - Movement - 64.25 m2</b>		
No Asbestos		
<b>B00H - R0015 - Covered Outdoor Learning Area - 63.17 m2</b>		
No Asbestos		
<b>B00H - R0016 - Covered Outdoor Learning Area - 23.39 m2</b>		
No Asbestos		
<b>B00I - Pupil Facilities/Communal Facilities - 2010 - Brick/Veneer</b>		

<b>Exterior</b>		
Underfloor Voids - Slab on Ground	No Asbestos Found	
Ceiling Voids	No Asbestos Found	
<b>Interior</b>		
<b>B001 - R0001 - Communal Space - 146.33 m2</b>		
No Asbestos		
<b>B001 - R0002 - Raised Platform - 56.92 m2</b>		
No Asbestos		
<b>B001 - R0003 - Movement - 7.79 m2</b>		
No Asbestos		
<b>B001 - R0004 - Movement - 11.53 m2</b>		
No Asbestos		
<b>B001 - R0005 - Movement - 13.9 m2</b>		
No Asbestos		
<b>B001 - R0006 - Hall Chair Store - 9.54 m2</b>		
No Asbestos		
<b>B001 - R0007 - Communal/Performance Store - 9.49 m2</b>		
No Asbestos		
<b>B001 - R0008 - P.E Store - 13.06 m2</b>		
No Asbestos		
<b>B001 - R0009 - Toilet - Lobby - 2.31 m2</b>		
No Asbestos		
<b>B001 - R0010 - Toilets - Girls - 7.08 m2</b>		
No Asbestos		
<b>B001 - R0011 - Sound Cupboard - 2.25 m2</b>		
No Asbestos		
<b>B001 - R0012 - Toilet - Lobby - 3.17 m2</b>		
No Asbestos		
<b>B001 - R0013 - Toilets - Boys - 5.55 m2</b>		
No Asbestos		
<b>B001 - R0014 - Cleaning Distributed Store - 5.28 m2</b>		
No Asbestos		
<b>B001 - R0015 - Disabled Shower/Toilet - 6.76 m2</b>		
No Asbestos		
<b>B001 - R0016 - Main Switch Board - 3.29 m2</b>		
No Asbestos		
<b>B001 - R0017 - Covered Outdoor Learning Area - 160.18 m2</b>		
No Asbestos		

## Demountables

There are no Demountable(s) Located at this school as per the AMS records as of 09-Sep-2020