

# Asbestos Register

(Hazardous Materials and Risk Assessment)

<b>School:</b>	<b>Kogarah High School (8320)</b>
<b>Region:</b>	<b>Sydney AMU</b>
<b>State Electorate:</b>	<b>Kogarah</b>
<b>Local Government Area:</b>	<b>Georges River</b>

<b>Last Reviewed By:</b>	<b>Greencap 14-DEC-2017</b>
<b>Last Revised By:</b>	

<b>Historical Fibro In Grounds Investigations/Events</b>	<b>No</b>
<p>No previous investigations have been recorded against the school. However, asbestos containing materials maybe present in grounds from time to time and caution must be exercised prior to any grounds disturbance.</p>	

8320 - Kogarah High School  
Site Plan (12590)

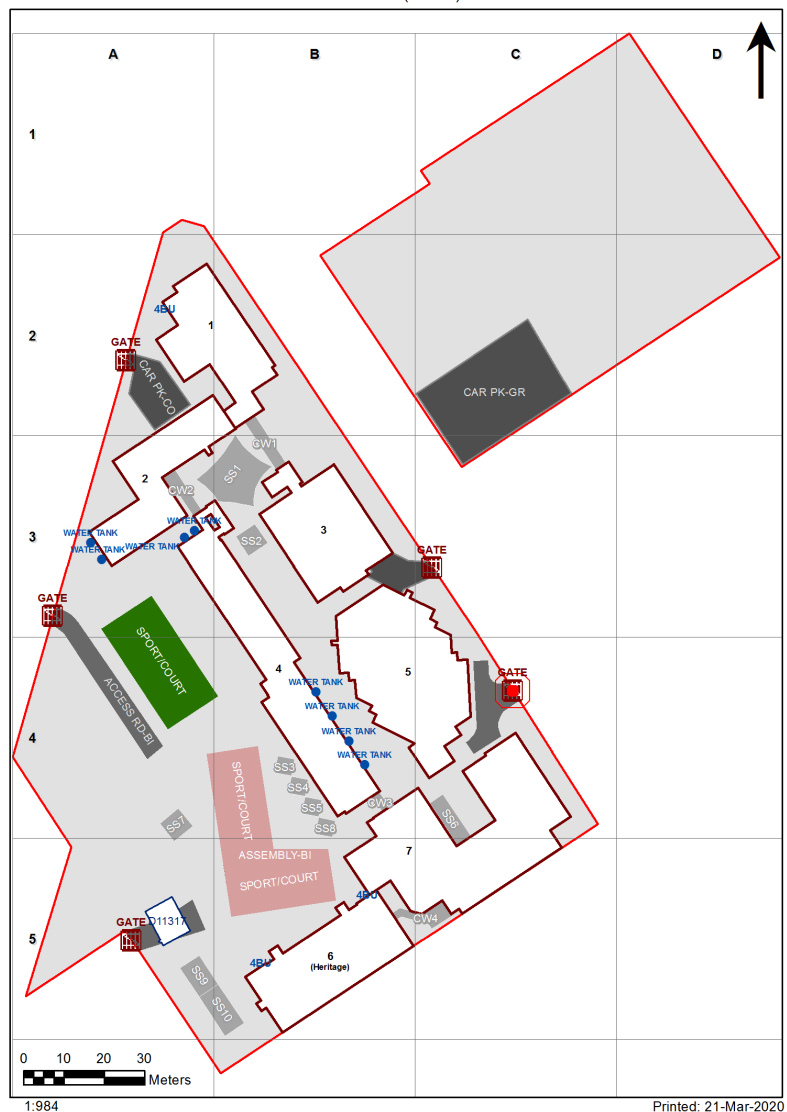

# Preface to Asbestos Register

## Limitations

Asbestos Registers established (first surveyed 2007/08) and maintained for the Department of Education (DoE) are limited in extent, in that:

1. All inspections and surveys of materials and finishes in DoE facilities are non-disturbance, with
2. Samples undertaken by hygienist to determine whether a sample is an Asbestos Containing Material (ACM),
3. The hygienist may apply a single sample to like materials within a space and adjoining spaces, but not normally between buildings,
4. Successive inspections have reduced any inconclusive records such as 'assumed asbestos' in difficult to access areas, by undertaking additional sampling with lifting devices.
5. In compliance with WHS Act 2011 and WHS Regulations 2017, additional inspections have been undertaken in ceiling spaces and sub-floor areas where access is possible.
  - o Where the ground floor is slab on ground, no inspection is made beneath the slab.
  - o Where fibro fragments (ACM taken for sampling) are located in ceiling spaces or sub floor voids air monitoring is normally undertaken at time of sampling, and clearance undertaken as soon as practicable.
6. No attempt has been made to identify any ACM that is hidden from view or encapsulated within
  - o Any wall cavity
  - o Sub floor area, particularly formwork for slabs in/on ground,
  - o Services (that may use ACM) such as: pipe lagging, asbestos cement pipes, flues.
7. All known ACM in Grounds (Fibro in Grounds) is made available in associated site specific asbestos management plans in DoE electronic files.  
Notwithstanding information provided, ACM may be present in grounds from time to time and caution must be exercised prior to any grounds disturbance.

## Use of the Asbestos Register

Prior to any disturbance works being undertaken in a building to which this asbestos register applies it will be necessary to confirm the extent of any ACM by a disturbance investigation:

- If the building was built prior to 2003
- If any ACM has been identified in the Asbestos Register for the building.

## Update of Asbestos Registers

Asbestos Register Data is updated regularly by the DoE Hygienist Panel via the Online Asbestos Register Tool (Managed by Business Systems, School Infrastructure NSW). Internal users can view the latest edition of the Asbestos Register in the AMS.

Please note: The Department's external website may not contain the latest revision of the Asbestos Register.

## Notes 1: Vermiculite

- During 2018/19, all vermiculite occurrences in DoE schools identified in 2007/08, were 'composite tested' in accordance with a safe work NSW agreed procedure. This required multiple testing of all vermiculite occurrences.
- During the period 2007/08 to 2018/19, some vermiculite has been over sheeted and a warning is indicated for schools where this has happened.

## Note 2: DoE website link for information is here:

<https://www.schoolinfrastructure.nsw.gov.au/about-us/working-with-us/schools-asbestos-register.html>

<https://education.nsw.gov.au/about-us/strategies-and-reports/our-reports-and-reviews/schools-asbestos-register>

## Note 3: Material Condition Assessment

The material condition assessment descriptors from Section 3 of the Asbestos Management Plan (AMP) is extracted below. Please read the AMP in its entirety for further information.

### 3.3.2.1 Material condition assessment

The OART records the material condition of identified ACM in the following format:

Rating	Description
Good condition (1)	For non-friable asbestos that is sealed and has no visible damage. This primarily related to asbestos cement (AC) sheet and vinyl tiles
Minimal damage (2)	For non-friable asbestos that has a very small amount of damage, eg hairline cracks.
Some damage / unsealed (3)	For non-friable asbestos with significant breakage or several small areas where material has been damaged, revealing loose asbestos fibres. Non-friable asbestos that is unsealed.
Poor condition (4)	For non-friable asbestos that has extensive damage. Visible asbestos debris
Friable asbestos (5)	Any occurrence of friable asbestos

Product	Material Description	Extent	Location	Material Condition	Risk Status	Remediation Priority	Result
<b>B001 - Technological &amp; Applied Studies - 1972 - Brick/Block</b>							
<b>Exterior</b>							
Underfloor Voids - Slab on Ground	No Asbestos Found						
Ceiling Voids - Raked Ceiling	No Asbestos Found						
Eaves Linings	Flat AC Sheeting	30m2	Variable positions	Good Condition (1)	Low (1)	Low Priority (2-3)	Assumed Asbestos
<b>Interior</b>							
<b>B001 - R0001 - Distribution Board Cupboard - .88 m2</b>						<b>Note: No inspection of live electrical installation</b>	
No Asbestos							
<b>B001 - R0002 - Toilets-Girls - 42.16 m2</b>							
Ceiling Structures/Linings	Vermiculite - Composite Sample - ( 40 - 70 m2) - ( X5 )						
<b>B001 - R0003 - Materials Technology L.S. - 82.48 m2</b>							
Ceiling Structures/Linings	Vermiculite - Composite Sample - ( 70 - 120 m2) - ( X8 )						
<b>B001 - R0004 - Welding Area - 16.03 m2</b>							
Ceiling Structures/Linings	Vermiculite - Composite Sample - ( 10 - 40 m2) - ( X3 )						
<b>B001 - R0005 - Resource/Project Store - 16.17 m2</b>							
Ceiling Structures/Linings	Vermiculite - Composite Sample - ( 10 - 40 m2) - ( X3 )						
<b>B001 - R0006 - Materials Technology L.S. - 83.02 m2</b>							
Ceiling Structures/Linings	Vermiculite - Composite Sample - ( 70 - 120 m2) - ( X8 )						
<b>B001 - R0007 - Resource/Project Store - 15.87 m2</b>							
Ceiling Structures/Linings	Vermiculite - Composite Sample - ( 10 - 40 m2) - ( X3 )						
<b>B001 - R0008 - Art Learning Space - 63.58 m2</b>							
Ceiling Structures/Linings	Vermiculite - Composite Sample - ( 40 - 70 m2) - ( X5 )						
Floor Coverings Res/Textile	Vinyl Tiles	64m2	All surfaces	Good Condition (1)	Low (1)	Low Priority (2-3)	Chrysotile (white asbestos)
<b>B001 - R0009 - Resources Store - 8.27 m2</b>							
Ceiling Structures/Linings	Vermiculite - Composite Sample - ( < 10 m2) - ( X2 )						
Floor Coverings Res/Textile	Vinyl Tiles	9m2	Throughout	Good Condition (1)	Low (1)	Low Priority (2-3)	Chrysotile (white asbestos)
<b>B001 - R0010 - Kiln Space - 13.45 m2</b>							
Ceiling Structures/Linings	Vermiculite - Composite Sample - ( 10 - 40 m2) - ( X3 )						
<b>B001 - R0011 - General Storeroom - 4.89 m2</b>							
Floor Coverings Res/Textile	Vinyl Tiles	5m2	Throughout	Good Condition (1)	Low (1)	Low Priority (2-3)	Chrysotile (white asbestos)
<b>B001 - R0012 - Movement - 68.81 m2</b>							
Ceiling Structures/Linings	Vermiculite - Composite Sample - ( 40 - 70 m2) - ( X5 )						
<b>B001 - R0013 - Materials Store - 10.85 m2</b>							
Ceiling Structures/Linings	No Asbestos Found						
<b>B001 - R0014 - General Storeroom - 8.97 m2</b>							
No Asbestos							
<b>B001 - R0015 - General Storeroom - 4.71 m2</b>							
No Asbestos							

<b>B001 - R0016 - General Storeroom - 9.8 m2</b>							
Ceiling Structures/Linings	Flat AC Sheeting	10m2	Throughout	Good Condition (1)	Low (1)	Low Priority (2-3)	Chrysotile (white asbestos)
<b>B001 - R0017 - External Movement - 45.53 m2</b>							
No Asbestos							
<b>B001 - R0018 - External Stairs - .38 m2</b>							
No Asbestos							
<b>B001 - R0019 - Stairs - 11.99 m2</b>							
No Asbestos							
<b>B001 - R1001 - Distribution Board Cupboard - .87 m2</b>						<b>Note: No inspection of live electrical installation</b>	
No Asbestos							
<b>B001 - R1002 - Cleaning Store - Distributed - 10.97 m2</b>							
Ceiling Structures/Linings	Vermiculite - Composite Sample - ( 10 - 40 m2) - ( X3 )						
<b>B001 - R1003 - Toilets-Boys - 42.06 m2</b>							
Ceiling Structures/Linings	Vermiculite - Composite Sample - ( 40 - 70 m2) - ( X5 )						
<b>B001 - R1004 - Materials Technology L.S. - 82.57 m2</b>							
Ceiling Structures/Linings	Vermiculite - Composite Sample - ( 70 - 120 m2) - ( X8 )						
<b>B001 - R1005 - Materials Store - 15.69 m2</b>							
Ceiling Structures/Linings	Vermiculite - Composite Sample - ( 10 - 40 m2) - ( X3 )						
<b>B001 - R1006 - Dust Extraction Space - 5.69 m2</b>							
No Asbestos							
<b>B001 - R1007 - Materials Store - 9.53 m2</b>							
Ceiling Structures/Linings	Vermiculite - Composite Sample - ( 10 - 40 m2) - ( X3 )						
<b>B001 - R1008 - Materials Technology L.S. - 82.84 m2</b>							
Ceiling Structures/Linings	Vermiculite - Composite Sample - ( 70 - 120 m2) - ( X8 )						
<b>B001 - R1009 - Materials Store - 15.69 m2</b>							
Ceiling Structures/Linings	Vermiculite - Composite Sample - ( 10 - 40 m2) - ( X3 )						
<b>B001 - R1010 - Resource/Project Store - 11.6 m2</b>							
Ceiling Structures/Linings	Vermiculite - Composite Sample - ( 10 - 40 m2) - ( X3 )						
<b>B001 - R1011 - Staff - Toilet - 5.53 m2</b>							
Ceiling Structures/Linings	Vermiculite - Composite Sample - ( < 10 m2) - ( X2 )						
<b>B001 - R1012 - Staff - Toilet - 6.86 m2</b>							
Ceiling Structures/Linings	Vermiculite - Composite Sample - ( < 10 m2) - ( X2 )						
<b>B001 - R1013 - Staff Study - 25.7 m2</b>							
Ceiling Structures/Linings	Vermiculite - Composite Sample - ( 10 - 40 m2) - ( X3 )						
<b>B001 - R1014 - Staff Study - 26.37 m2</b>							
Ceiling Structures/Linings	Vermiculite - Composite Sample - ( 10 - 40 m2) - ( X3 )						
<b>B001 - R1015 - Movement - 74.11 m2</b>							
Ceiling Structures/Linings	Vermiculite - Composite Sample - ( 70 - 120 m2) - ( X8 )						
<b>B001 - R1016 - External Movement - 41.41 m2</b>							
No Asbestos							
<b>B001 - R1017 - External Stairs - 4.97 m2</b>							
No Asbestos							

<b>B001 - R1018 - Stairs - 16.99 m2</b>							
No Asbestos							
<b>B001 - R2001 - Distribution Board Cupboard - .84 m2</b>							<b>Note: No inspection of live electrical installation</b>
No Asbestos							
<b>B001 - R2002 - Art Learning Space - 65.67 m2</b>							
Floor Coverings Res/Textile	Vinyl Tiles	66m2	All surfaces	Good Condition (1)	Low (1)	Low Priority (2-3)	Chrysotile (white asbestos)
Ceiling Structures/Linings	Vermiculite - Composite Sample - ( 40 - 70 m2) - ( X5 )						
<b>B001 - R2003 - Art Learning Space - 67.13 m2</b>							
Floor Coverings Res/Textile	Vinyl Tiles	68m2	All surfaces	Good Condition (1)	Low (1)	Low Priority (2-3)	Chrysotile (white asbestos)
Ceiling Structures/Linings	Vermiculite - Composite Sample - ( 40 - 70 m2) - ( X5 )						
<b>B001 - R2004 - General Storeroom - 15.53 m2</b>							
Floor Coverings Res/Textile	Vinyl Tiles	16m2	All surfaces	Good Condition (1)	Low (1)	Low Priority (2-3)	Chrysotile (white asbestos)
Ceiling Structures/Linings	Vermiculite - Composite Sample - ( 10 - 40 m2) - ( X3 )						
<b>B001 - R2005 - Art Learning Space - 52.43 m2</b>							
Ceiling Structures/Linings	Vermiculite - Composite Sample - ( 40 - 70 m2) - ( X5 )						
Floor Coverings Res/Textile	Vinyl Tiles (Under Floor Covering/Carpet)	53m2	Throughout	Good Condition (1)	Low (1)	Low Priority (2-3)	Chrysotile (white asbestos)
<b>B001 - R2006 - Design L.S. - 65.39 m2</b>							
Ceiling Structures/Linings	Vermiculite - Composite Sample - ( 40 - 70 m2) - ( X5 )						
Floor Coverings Res/Textile	Vinyl Tiles	66m2	Throughout	Good Condition (1)	Low (1)	Low Priority (2-3)	Chrysotile (white asbestos)
<b>B001 - R2007 - Design L.S. - 28.41 m2</b>							
Ceiling Structures/Linings	Non Accessible Area						
<b>B001 - R2008 - Computer Learning Space - 57.48 m2</b>							
Ceiling Structures/Linings	Vermiculite - Composite Sample - ( 40 - 70 m2) - ( X5 )						
Floor Coverings Res/Textile	Vinyl Tiles	58m2	Throughout	Good Condition (1)	Low (1)	Low Priority (2-3)	Chrysotile (white asbestos)
<b>B001 - R2009 - Movement - 65.76 m2</b>							
Floor Coverings Res/Textile	Vinyl Tiles						
Ceiling Structures/Linings	Vermiculite - Composite Sample - ( 40 - 70 m2) - ( X5 )						
<b>B001 - R2010 - Movement - 36.2 m2</b>							
No Asbestos							
<b>B001 - R2011 - Stairs - 4.97 m2</b>							
No Asbestos							
<b>B001 - R2012 - Stairs - 17.23 m2</b>							
Ceiling Structures/Linings	Vermiculite - Composite Sample - ( 10 - 40 m2) - ( X3 )						
<b>B002 - Science/General Learning - 1963 - Brick/Block</b>							
<b>Exterior</b>							
Eaves Linings	Flat AC Sheeting	120m2	Variable positions	Good Condition (1)	Low (1)	Low Priority (2-3)	Assumed Asbestos
Ceiling Voids - Raked Ceiling	No Asbestos Found						
Underfloor Voids	No Asbestos Found						
<b>Interior</b>							

<b>B002 - R0001 - Laboratory L.S. - 101.48 m2</b>							
Ceiling Structures/Linings	Vermiculite - Composite Sample - ( 70 - 120 m2) - ( X8 )						
<b>B002 - R0002 - Preparation - 29.01 m2</b>							
Floor Coverings Res/Textile	Vinyl Tiles						
Ceiling Structures/Linings	Vermiculite - Composite Sample - ( 10 - 40 m2) - ( X3 )						
<b>B002 - R0003 - General Storeroom - 9.69 m2</b>							
Floor Coverings Res/Textile	Vinyl Tiles						
Ceiling Structures/Linings	Vermiculite - Composite Sample - ( 10 - 40 m2) - ( X3 )						
<b>B002 - R0004 - Laboratory L.S. - 93.61 m2</b>							
Ceiling Structures/Linings	Vermiculite - Composite Sample - ( 70 - 120 m2) - ( X8 )						
<b>B002 - R0005 - Distribution Board Cupboard - .69 m2</b>							
No Asbestos							<b>Note: No inspection of live electrical installation</b>
<b>B002 - R0006 - General Storeroom - 3.28 m2</b>							
Ceiling Structures/Linings	Vermiculite - Composite Sample - ( < 10 m2) - ( X2 )						
Floor Coverings Res/Textile	Vinyl Tiles						
<b>B002 - R0007 - Laboratory L.S. - 99.25 m2</b>							
Ceiling Structures/Linings	Vermiculite - Composite Sample - ( 70 - 120 m2) - ( X8 )						
Plant / Equipment - Fume Cupboard	Flat AC Sheeting	1	Throughout	Good Condition (1)	Low (1)	Low Priority (2-3)	Chrysotile (white asbestos) , Crocidolite (blue asbestos)
Floor Coverings Res/Textile	Vinyl Tiles						
Plant / Equipment - Fume Cupboard	Fibre Cement Pipe	2	Upper portion	Good Condition (1)	Low (1)	Low Priority (2-3)	Chrysotile (white asbestos) , Crocidolite (blue asbestos)
<b>B002 - R0008 - General Storeroom - 6.68 m2</b>							
Ceiling Structures/Linings	Vermiculite - Composite Sample - ( < 10 m2) - ( X2 )						
<b>B002 - R0009 - Preparation - 26.43 m2</b>							
Ceiling Structures/Linings	Vermiculite - Composite Sample - ( 10 - 40 m2) - ( X3 )						
<b>B002 - R0010 - Cleaning Store - Distributed - 3.3 m2</b>							
Ceiling Structures/Linings	Vermiculite - Composite Sample - ( < 10 m2) - ( X2 )						
<b>B002 - R0011 - Staff Study - 26.32 m2</b>							
Ceiling Structures/Linings	Vermiculite - Composite Sample - ( 10 - 40 m2) - ( X3 )						
<b>B002 - R0012 - Staff Toilet - 6.54 m2</b>							
Ceiling Structures/Linings	Vermiculite - Composite Sample - ( < 10 m2) - ( X2 )						
Wall Linings Internal - Infill	Compressed AC Sheet	1m2	East	Good Condition (1)	Low (1)	Low Priority (2-3)	Chrysotile (white asbestos)
<b>B002 - R0013 - Movement - 59.98 m2</b>							
Floor Coverings Res/Textile	Vinyl Tiles						
Ceiling Structures/Linings	Vermiculite - Composite Sample - ( 40 - 70 m2) - ( X5 )						
<b>B002 - R0014 - General Storeroom - 1.37 m2</b>							
No Asbestos							
<b>B002 - R0015 - Stairs - 9.99 m2</b>							
No Asbestos							

<b>B002 - R1001 - General Learning Space - 52.72 m2</b>							
Ceiling Structures/Linings	Vermiculite - Composite Sample - ( 40 - 70 m2) - ( X5 )						
Floor Coverings Res/Textile	Vinyl Sheet						
Floor Coverings Res/Textile	Vinyl Tiles - Adhesive						
<b>B002 - R1002 - General Learning Space - 52.79 m2</b>							
Ceiling Structures/Linings	Vermiculite - Composite Sample - ( 40 - 70 m2) - ( X5 )						
Plumbing / Pipework	Fibre Cement Pipe	1	South facing	Good Condition (1)	Low (1)	Low Priority (2-3)	Chrysotile (white asbestos)
Floor Coverings Res/Textile	Vinyl Sheet						
Floor Coverings Res/Textile	Vinyl Tiles - Adhesive						
<b>B002 - R1003 - General Learning Space - 52.79 m2</b>							
Ceiling Structures/Linings	Vermiculite - Composite Sample - ( 40 - 70 m2) - ( X5 )						
Plumbing / Pipework	Fibre Cement Pipe	1	South facing	Good Condition (1)	Low (1)	Low Priority (2-3)	Chrysotile (white asbestos)
Floor Coverings Res/Textile	Vinyl Sheet						
Floor Coverings Res/Textile	Vinyl Tiles - Adhesive						
<b>B002 - R1004 - General Learning Space - 53.23 m2</b>							
Ceiling Structures/Linings	Vermiculite - Composite Sample - ( 40 - 70 m2) - ( X5 )						
Floor Coverings Res/Textile	Vinyl Sheet						
Floor Coverings Res/Textile	Vinyl Tiles - Adhesive						
<b>B002 - R1005 - Distribution Board Cupboard - .65 m2</b>							
<b>Note: No inspection of live electrical installation</b>							
No Asbestos							
<b>B002 - R1006 - Staff - Toilet - 6.72 m2</b>							
Ceiling Structures/Linings	Vermiculite - Composite Sample - ( < 10 m2) - ( X2 )						
<b>B002 - R1007 - Seminar - Type 1 - 26.65 m2</b>							
Ceiling Structures/Linings	Vermiculite - Composite Sample - ( 10 - 40 m2) - ( X3 )						
Floor Coverings Res/Textile	Vinyl Sheet						
Floor Coverings Res/Textile	Vinyl Tiles - Adhesive						
<b>B002 - R1008 - Cleaning Store - Distributed - 3.28 m2</b>							
Ceiling Structures/Linings	Vermiculite - Composite Sample - ( < 10 m2) - ( X2 )						
<b>B002 - R1009 - Staff Study - 51.69 m2</b>							
Ceiling Structures/Linings	Vermiculite - Composite Sample - ( 40 - 70 m2) - ( X5 )						
<b>B002 - R1010 - General Learning Space - 67.5 m2</b>							
Ceiling Structures/Linings	Vermiculite - Composite Sample - ( 40 - 70 m2) - ( X5 )						
Plumbing / Pipework	Fibre Cement Pipe	1	West facing	Good Condition (1)	Low (1)	Low Priority (2-3)	Chrysotile (white asbestos)
Floor Coverings Res/Textile	Vinyl Tiles - Adhesive						
Floor Coverings Res/Textile	Vinyl Sheet						

<b>B002 - R1011 - Movement - 100.64 m2</b>							
Ceiling Structures/Linings	Vermiculite - Composite Sample - ( 70 - 120 m2) - ( X8 )						
<b>B002 - R1012 - Stairs - 14.14 m2</b>							
Ceiling Structures/Linings	Vermiculite - Composite Sample - ( 10 - 40 m2) - ( X3 )						
<b>B003 - Library/Science Learning - 1970 - Brick/Block</b>							
<b>Exterior</b>							
Ceiling Voids - Raked Ceiling	No Asbestos Found						
Underfloor Voids - Slab on Ground	No Asbestos Found						
<b>Interior</b>							
<b>B003 - M1001 - General Storeroom - 14.73 m2</b>							
No Asbestos							
<b>B003 - M1002 - Senior Seminar - 14.8 m2</b>							
Ceiling Structures/Linings	Non Accessible Area	m2					
<b>B003 - M1003 - General Storeroom - 14.68 m2</b>							
Material - Stored / Debris Material	Fibre Cement Pipe	2	Middle portion	Some Damage - Unsealed (3)	Low (1)	Medium Priority (4-5)	Chrysotile (white asbestos) , Amosite (brown asbestos)
<b>B003 - M1004 - Main Area - 69.21 m2</b>							
No Asbestos							
<b>B003 - M1005 - Seminar - 38.36 m2</b>							
Ceiling Structures/Linings	No Asbestos Found						
<b>B003 - M1006 - General Storeroom - 12.74 m2</b>							
Ceiling Structures/Linings	Non Accessible Area	m2					
<b>B003 - M1007 - Distribution Board Cupboard - 3.42 m2</b>							
						<b>Note: No inspection of live electrical installation</b>	
No Asbestos							
<b>B003 - M1008 - Stairs - 3.45 m2</b>							
Ceiling Structures/Linings	Vermiculite - Composite Sample - ( < 10 m2) - ( X2 )						
<b>B003 - M1009 - Stairs - 3.72 m2</b>							
Ceiling Structures/Linings	Vermiculite - Composite Sample - ( < 10 m2) - ( X2 )						
<b>B003 - R0001 - Laboratory L.S. - 90.86 m2</b>							
Ceiling Structures/Linings	Non Accessible Area	m2					
<b>B003 - R0004 - Laboratory L.S. - 91.05 m2</b>							
Ceiling Structures/Linings	Non Accessible Area	m2					
<b>B003 - R0005 - General Learning Space - 82.97 m2</b>							
Ceiling Structures/Linings	Vermiculite - Composite Sample - ( 70 - 120 m2) - ( X8 )						
Floor Coverings Res/Textile	Vinyl Tiles (Under Floor Covering/Carpet)	83m2	Throughout	Good Condition (1)	Low (1)	Low Priority (2-3)	Chrysotile (white asbestos)
<b>B003 - R0006 - Staff Study - 7.73 m2</b>							
Ceiling Structures/Linings	Vermiculite - Composite Sample - ( < 10 m2) - ( X2 )						
Floor Coverings Res/Textile	Vinyl Tiles (Under Floor Covering/Carpet)	9m2	Throughout	Good Condition (1)	Low (1)	Low Priority (2-3)	Chrysotile (white asbestos)
<b>B003 - R0007 - Staff Study - 10.32 m2</b>							
Ceiling Structures/Linings	Vermiculite - Composite Sample - ( 10 - 40 m2) - ( X3 )						



Floor Coverings Res/Textile	Vinyl Tiles (Under Floor Covering/Carpet)	11m2	Throughout	Good Condition (1)	Low (1)	Low Priority (2-3)	Chrysotile (white asbestos)
<b>B003 - R0008 - Preparation - 37.17 m2</b>							
Floor Coverings Res/Textile	Vinyl Tiles	38m2	All surfaces	Good Condition (1)	Low (1)	Low Priority (2-3)	Chrysotile (white asbestos)
Ceiling Structures/Linings	Vermiculite - Composite Sample - ( 10 - 40 m2) - ( X3 )						
<b>B003 - R0009 - Laboratory L.S. - 90.49 m2</b>							
Ceiling Structures/Linings	Non Accessible Area	m2					
<b>B003 - R0010 - Distribution Board Cupboard - .51 m2</b>							
<b>Note: No inspection of live electrical installation</b>							
Electrical - Mounting Board	Resinous Board	2	South facing	Good Condition (1)	Low (1)	Low Priority (2-3)	Chrysotile (white asbestos)
Floor Coverings Res/Textile	Vinyl Tiles	1m2	Throughout	Good Condition (1)	Low (1)	Low Priority (2-3)	Chrysotile (white asbestos)
<b>B003 - R0011 - Apparatus Store - 16.52 m2</b>							
Floor Coverings Res/Textile	Vinyl Tiles	17m2	Throughout	Good Condition (1)	Low (1)	Low Priority (2-3)	Chrysotile (white asbestos)
<b>B003 - R0012 - Movement - 40.34 m2</b>							
Floor Coverings Res/Textile	Vinyl Tiles	41m2	All surfaces	Good Condition (1)	Low (1)	Low Priority (2-3)	Chrysotile (white asbestos)
<b>B003 - R0013 - Pupil Entry - 28.24 m2</b>							
Ceiling Structures/Linings	No Asbestos Found						
<b>B003 - R0014 - General Storeroom - 4.43 m2</b>							
No Asbestos							
<b>B003 - R0015 - Plant - 10.51 m2</b>							
Plant / Equipment - Boiler	Insulation Material - Rope	1	South facing	Friable Asbestos (5)	Low (1)	Low Priority (2-3)	Chrysotile (white asbestos)
Plant / Equipment - Boiler	Encapsulated Asbestos material within unit						
Plumbing / Pipework	Insulation Material						
Electrical - Backing Board	Resinous Board	1	Adjacent entrance	Good Condition (1)	Low (1)	Low Priority (2-3)	Assumed Asbestos
<b>B003 - R0016 - External Stairs - 11.82 m2</b>							
No Asbestos							
<b>B003 - R0017 - Preparation - 48.78 m2</b>							
Ceiling Structures/Linings	Non Accessible Area	m2					
<b>B003 - R1001 - Seminar - 12.87 m2</b>							
Ceiling Structures/Linings	Non Accessible Area	m2					
Ceiling Structures/Linings	Flat AC Sheeting	2m2	East facing	Good Condition (1)	Low (1)	Low Priority (2-3)	Chrysotile (white asbestos)
<b>B003 - R1002 - Seminar - 12.33 m2</b>							
Ceiling Structures/Linings	Non Accessible Area	m2					
<b>B003 - R1003 - Cleaning Store - Distributed - .38 m2</b>							
No Asbestos							
<b>B003 - R1004 - Cleaning Store - Distributed - 4.61 m2</b>							
Ceiling Structures/Linings	No Asbestos Found						
Electrical - Mounting Board	Resinous Board	1	West facing	Good Condition (1)	Low (1)	Low Priority (2-3)	Chrysotile (white asbestos)
<b>B003 - R1005 - Distribution Board Cupboard - .31 m2</b>							
<b>Note: No inspection of live electrical installation</b>							
Electrical - Mounting Board	Resinous Board	2	West	Good Condition (1)	Low (1)	Low Priority (2-3)	Chrysotile (white asbestos)
<b>B003 - R1006 - Seminar - 12.99 m2</b>							

Ceiling Structures/Linings	Non Accessible Area	m2					
<b>B003 - R1007 - Seminar - 13.59 m2</b>							
Ceiling Structures/Linings	Non Accessible Area	m2					
Ceiling Structures/Linings	Flat AC Sheeting	2m2	West facing	Good Condition (1)	Low (1)	Low Priority (2-3)	Chrysotile (white asbestos)
<b>B003 - R1008 - Main Area - 327.18 m2</b>							
Ceiling Structures/Linings	Flat AC Sheeting	32m2	East facing, West facing, Lower portion	Good Condition (1)	Low (1)	Low Priority (2-3)	Chrysotile (white asbestos)
Ceiling Structures/Linings	Vermiculite - Composite Sample - (> 250 m2) - ( X25 )						
<b>B003 - R1009 - Audio Visual Workroom - 28.5 m2</b>							
Ceiling Structures/Linings	Non Accessible Area	m2					
Ceiling Structures/Linings	Flat AC Sheeting	3m2	West facing	Good Condition (1)	Low (1)	Low Priority (2-3)	Chrysotile (white asbestos)
<b>B003 - R1010 - General Storeroom - 12.24 m2</b>							
Ceiling Structures/Linings	Non Accessible Area	m2					
Ceiling Structures/Linings	Flat AC Sheeting	1m2	West facing	Good Condition (1)	Low (1)	Low Priority (2-3)	Chrysotile (white asbestos)
<b>B003 - R1011 - Workroom - 17.79 m2</b>							
Ceiling Structures/Linings	Non Accessible Area	m2					
<b>B003 - R1012 - Librarian - 11.43 m2</b>							
Ceiling Structures/Linings	Non Accessible Area	m2					
<b>B003 - R1013 - Staff - Toilet - 3.11 m2</b>							
Ceiling Structures/Linings	No Asbestos Found						
<b>B003 - R1014 - Staff - Toilet - 3.22 m2</b>							
Ceiling Structures/Linings	No Asbestos Found						
<b>B003 - R1015 - Seminar - 71.15 m2</b>							
Ceiling Structures/Linings	Flat AC Sheeting	4m2	East facing	Good Condition (1)	Low (1)	Low Priority (2-3)	Chrysotile (white asbestos)
Ceiling Structures/Linings	Vermiculite - Composite Sample - ( 70 - 120 m2) - ( X8 )						
<b>B003 - R1016 - Plant - 5.84 m2</b>							
Ceiling Structures/Linings	No Asbestos Found						
<b>B003 - R1017 - Plant - 6.37 m2</b>							
Ceiling Structures/Linings	No Asbestos Found						
<b>B003 - R1018 - Stairs - 17.05 m2</b>							
No Asbestos							
<b>B003 - R1020 - External Movement - 24.91 m2</b>							
No Asbestos							
<b>B003 - R1021 - Movement - 1.46 m2</b>							
No Asbestos							
<b>B003 - R1022 - Stairs - .5 m2</b>							
Ceiling Structures/Linings	Vermiculite - Composite Sample - (< 10 m2) - ( X2 )						
<b>B003 - R1023 - Stairs - .5 m2</b>							
Ceiling Structures/Linings	Vermiculite - Composite Sample - (< 10 m2) - ( X2 )						

## B004 - General Learning/Various - 1963 - Brick/Block

### Exterior

Eaves Linings	Flat AC Sheeting	130m2	Variable positions	Good Condition (1)	Low (1)	Low Priority (2-3)	Assumed Asbestos
Ceiling Voids	Non Accessible Area						
Underfloor Voids - Slab on Ground	No Asbestos Found						

### Interior

#### B004 - R0001 - General Storeroom - 26.43 m2

Ceiling Structures/Linings	Vermiculite - Composite Sample - ( 10 - 40 m2) - ( X3 )						
Plumbing / Pipework	Fibre Cement Pipe	1	North facing	Good Condition (1)	Low (1)	Low Priority (2-3)	Chrysotile (white asbestos) , Amosite (brown asbestos)

#### B004 - R0002 - General Storeroom - 7.25 m2

Ceiling Structures/Linings	Vermiculite - Composite Sample - ( < 10 m2) - ( X2 )						
Floor Coverings Res/Textile	Vinyl Tiles	8m2	All surfaces	Good Condition (1)	Low (1)	Low Priority (2-3)	Chrysotile (white asbestos)
Plumbing / Pipework	Fibre Cement Pipe	2	South facing	Good Condition (1)	Low (1)	Low Priority (2-3)	Chrysotile (white asbestos) , Amosite (brown asbestos)

#### B004 - R0003 - Distribution Board Cupboard - 9.32 m2

Note: No inspection of live electrical installation

Ceiling Structures/Linings	Vermiculite - Composite Sample - ( 10 - 40 m2) - ( X3 )						
Electrical - Mounting Board	Resinous Board	4	Variable positions	Good Condition (1)	Low (1)	Low Priority (2-3)	Chrysotile (white asbestos)

#### B004 - R0006 - Food/Research Space - 13.22 m2

No Asbestos

#### B004 - R0007 - Food/Research Space - 12.68 m2

No Asbestos

#### B004 - R0008 - Food/Research Space - 66.91 m2

Ceiling Structures/Linings	Vermiculite - Composite Sample - ( 40 - 70 m2) - ( X5 )						
----------------------------	---------------------------------------------------------	--	--	--	--	--	--

#### B004 - R0009 - General Storeroom - 6.53 m2

Ceiling Structures/Linings	Vermiculite - Composite Sample - ( < 10 m2) - ( X2 )						
----------------------------	------------------------------------------------------	--	--	--	--	--	--

#### B004 - R0010 - General Storeroom - 3.01 m2

Ceiling Structures/Linings	Vermiculite - Composite Sample - ( < 10 m2) - ( X2 )						
Plant / Equipment - Flue	Fibre Cement Pipe	2	South	Good Condition (1)	Low (1)	Low Priority (2-3)	Chrysotile (white asbestos) , Amosite (brown asbestos)

#### B004 - R0011 - General Storeroom - 3.01 m2

No Asbestos

#### B004 - R0012 - Cleaning Store - Distributed - 3.6 m2

Ceiling Structures/Linings	Vermiculite - Composite Sample - ( < 10 m2) - ( X2 )						
----------------------------	------------------------------------------------------	--	--	--	--	--	--

#### B004 - R0013 - Distribution Board Cupboard - .48 m2

Note: No inspection of live electrical installation

Electrical - Backing Board	Resinous Board	1	North	Good Condition (1)	Low (1)	Low Priority (2-3)	Chrysotile (white asbestos)
Electrical - Backing Board	Resinous Board	1	North	Good Condition (1)	Low (1)	Low Priority (2-3)	Chrysotile (white asbestos)

#### B004 - R0014 - Music Learning Space - 83.3 m2

Ceiling Structures/Linings	Vermiculite - Composite Sample - ( 70 - 120 m2) - ( X8 )						
----------------------------	----------------------------------------------------------	--	--	--	--	--	--

#### B004 - R0015 - Resources - 17.77 m2

Ceiling Structures/Linings	Vermiculite - Composite Sample - ( 10 - 40 m2) - ( X3 )						
----------------------------	---------------------------------------------------------	--	--	--	--	--	--

Floor Coverings Res/Textile	Vinyl Tiles							
Floor Coverings Res/Textile	Vinyl Tiles - Adhesive							
<b>B004 - R0016 - Administration - Clerical - 61.03 m2</b>								
Ceiling Structures/Linings	Vermiculite - Composite Sample - ( 40 - 70 m2) - ( X5 )							
<b>B004 - R0017 - Computer Learning Space - 49.11 m2</b>								
Ceiling Structures/Linings	Vermiculite - Composite Sample - ( 10 - 40 m2) - ( X3 )							
<b>B004 - R0018 - Cleaning Store - Distributed - 3.6 m2</b>								
Ceiling Structures/Linings	Vermiculite - Composite Sample - ( < 10 m2) - ( X2 )							
<b>B004 - R0019 - Staff - Toilet - 6.3 m2</b>								
Ceiling Structures/Linings	Vermiculite - Composite Sample - ( < 10 m2) - ( X2 )							
<b>B004 - R0020 - Toilets-Boys - 26.05 m2</b>								
Partition Walls (Cubicles)	Compressed AC Sheet	14m2	All surfaces	Good Condition (1)	Low (1)	Low Priority (2-3)	Chrysotile (white asbestos)	
<b>B004 - R0022 - Movement - 169.94 m2</b>								
Ceiling Structures/Linings	Vermiculite - Composite Sample - ( 120 - 250 m2) - ( X15 )							
<b>B004 - R0023 - General Storeroom - 5.58 m2</b>								
No Asbestos								
<b>B004 - R0024 - Stairs - 1.17 m2</b>								
Ceiling Structures/Linings	Vermiculite - Composite Sample - ( < 10 m2) - ( X2 )							
<b>B004 - R0025 - Stairs - 6.35 m2</b>								
No Asbestos								
<b>B004 - R0026 - Stairs - 5.67 m2</b>								
No Asbestos								
<b>B004 - R0027 - Food Technology L.S. - 88.18 m2</b>								
No Asbestos								
<b>B004 - R0028 - External Movement - 72.48 m2</b>								
No Asbestos								
<b>B004 - R0029 - External Movement - 6.09 m2</b>								
No Asbestos								
<b>B004 - R0030 - Movement - 6.45 m2</b>								
No Asbestos								
<b>B004 - R0031 - Lift - 2.24 m2</b>								
No Asbestos								
<b>B004 - R0032 - Movement - 6.71 m2</b>								
No Asbestos								
<b>B004 - R0033 - Movement - 3.09 m2</b>								
No Asbestos								
<b>B004 - R0034 - External Movement - 16.57 m2</b>								
No Asbestos								
<b>B004 - R1001 - Staff - Toilet - 6.14 m2</b>								
Ceiling Structures/Linings	Vermiculite - Composite Sample - ( < 10 m2) - ( X2 )							
<b>B004 - R1002 - General Storeroom - 5.39 m2</b>								
Ceiling Structures/Linings	Vermiculite - Composite Sample - ( < 10 m2) - ( X2 )							
Floor Coverings Res/Textile	Vinyl Sheet							
<b>B004 - R1003 - Distribution Board Cupboard - .68 m2</b>								

Note: No inspection of live electrical installation

Electrical - Backing Board	Resinous Board	1	West	Good Condition (1)	Low (1)	Low Priority (2-3)	Chrysotile (white asbestos)
Electrical - Backing Board	Resinous Board	1	West	Good Condition (1)	Low (1)	Low Priority (2-3)	Chrysotile (white asbestos)
<b>B004 - R1004 - Staff Study - 26.14 m2</b>							
Ceiling Structures/Linings	Vermiculite - Composite Sample - ( 10 - 40 m2) - ( X3 )						
Floor Coverings Res/Textile	Vinyl Tiles (Under Floor Covering/Carpet)	27m2	Throughout	Good Condition (1)	Low (1)	Low Priority (2-3)	Chrysotile (white asbestos)
<b>B004 - R1005 - Design L.S. - 66.41 m2</b>							
Ceiling Structures/Linings	Vermiculite - Composite Sample - ( 40 - 70 m2) - ( X5 )						
Floor Coverings Res/Textile	Vinyl Sheet						
<b>B004 - R1006 - General Storeroom - 8.7 m2</b>							
Ceiling Structures/Linings	Vermiculite - Composite Sample - ( < 10 m2) - ( X2 )						
Floor Coverings Res/Textile	Vinyl Sheet						
<b>B004 - R1007 - General Storeroom - 5.26 m2</b>							
Ceiling Structures/Linings	Vermiculite - Composite Sample - ( < 10 m2) - ( X2 )						
Floor Coverings Res/Textile	Vinyl Sheet						
<b>B004 - R1008 - General Storeroom - 11.29 m2</b>							
Ceiling Structures/Linings	Vermiculite - Composite Sample - ( 10 - 40 m2) - ( X3 )						
Floor Coverings Res/Textile	Vinyl Sheet						
<b>B004 - R1009 - Design L.S. - 67.11 m2</b>							
Ceiling Structures/Linings	Vermiculite - Composite Sample - ( 40 - 70 m2) - ( X5 )						
Floor Coverings Res/Textile	Vinyl Sheet						
<b>B004 - R1010 - General Storeroom - 10.8 m2</b>							
Ceiling Structures/Linings	Vermiculite - Composite Sample - ( 10 - 40 m2) - ( X3 )						
<b>B004 - R1011 - General Storeroom - 14.86 m2</b>							
Ceiling Structures/Linings	Vermiculite - Composite Sample - ( 10 - 40 m2) - ( X3 )						
<b>B004 - R1012 - General Learning Space - 52.94 m2</b>							
Ceiling Structures/Linings	Vermiculite - Composite Sample - ( 40 - 70 m2) - ( X5 )						
Floor Coverings Res/Textile	Vinyl Tiles (Under Floor Covering/Carpet)	53m2	Throughout	Good Condition (1)	Low (1)	Low Priority (2-3)	Chrysotile (white asbestos)
<b>B004 - R1013 - General Learning Space - 53.31 m2</b>							
Ceiling Structures/Linings	Vermiculite - Composite Sample - ( 40 - 70 m2) - ( X5 )						
Floor Coverings Res/Textile	Vinyl Tiles (Under Floor Covering/Carpet)	54m2	Throughout	Good Condition (1)	Low (1)	Low Priority (2-3)	Chrysotile (white asbestos)
Plant / Equipment - Flue	Fibre Cement Pipe	3	East	Good Condition (1)	Low (1)	Low Priority (2-3)	Chrysotile (white asbestos) , Amosite (brown asbestos)
<b>B004 - R1014 - General Learning Space - 53.46 m2</b>							
Floor Coverings Res/Textile	Vinyl Tiles (Under Floor Covering/Carpet)	54m2	Throughout	Good Condition (1)	Low (1)	Low Priority (2-3)	Chrysotile (white asbestos)
Ceiling Structures/Linings	Vermiculite - Composite Sample - ( 40 - 70 m2) - ( X5 )						

Plant / Equipment - Flue	Fibre Cement Pipe	3	East	Good Condition (1)	Low (1)	Low Priority (2-3)	Chrysotile (white asbestos), Amosite (brown asbestos)
<b>B004 - R1015 - Staff Study - 25.2 m2</b>							
Ceiling Structures/Linings	Vermiculite - Composite Sample - ( 10 - 40 m2) - ( X3 )						
Floor Coverings Res/Textile	Vinyl Tiles (Under Floor Covering/Carpet)	26m2	Throughout	Good Condition (1)	Low (1)	Low Priority (2-3)	Chrysotile (white asbestos)
<b>B004 - R1016 - Staff Study - 13 m2</b>							
Ceiling Structures/Linings	Vermiculite - Composite Sample - ( 10 - 40 m2) - ( X3 )						
Floor Coverings Res/Textile	Vinyl Tiles (Under Floor Covering/Carpet)	13m2	Throughout	Good Condition (1)	Low (1)	Low Priority (2-3)	Chrysotile (white asbestos)
<b>B004 - R1017 - Staff Study - 12.75 m2</b>							
Ceiling Structures/Linings	Vermiculite - Composite Sample - ( 10 - 40 m2) - ( X3 )						
Floor Coverings Res/Textile	Vinyl Tiles (Under Floor Covering/Carpet)	13m2	Throughout	Good Condition (1)	Low (1)	Low Priority (2-3)	Chrysotile (white asbestos)
<b>B004 - R1018 - Distribution Board Cupboard - .72 m2</b>				<b>Note: No inspection of live electrical installation</b>			
Electrical - Backing Board	Resinous Board	1	West	Good Condition (1)	Low (1)	Low Priority (2-3)	Chrysotile (white asbestos)
Electrical - Backing Board	Resinous Board	1	West	Good Condition (1)	Low (1)	Low Priority (2-3)	Chrysotile (white asbestos)
<b>B004 - R1019 - Cleaning Store - Distributed - 6.56 m2</b>							
Ceiling Structures/Linings	Vermiculite - Composite Sample - ( < 10 m2) - ( X2 )						
<b>B004 - R1020 - Toilets-Girls - 30.06 m2</b>							
Partition Walls (Cubides)	Compressed AC Sheet	38m2	All surfaces	Good Condition (1)	Low (1)	Low Priority (2-3)	Chrysotile (white asbestos)
<b>B004 - R1022 - Movement - 177.02 m2</b>							
Ceiling Structures/Linings	Vermiculite - Composite Sample - ( 120 - 250 m2) - ( X15 )						
<b>B004 - R1023 - Stairs - 9.52 m2</b>							
Ceiling Structures/Linings	Vermiculite - Composite Sample - ( 10 - 40 m2) - ( X3 )						
<b>B004 - R1024 - Stairs - 8.08 m2</b>							
Ceiling Structures/Linings	Vermiculite - Composite Sample - ( < 10 m2) - ( X2 )						
<b>B004 - R1025 - Stairs - 13.86 m2</b>							
Ceiling Structures/Linings	Vermiculite - Composite Sample - ( 10 - 40 m2) - ( X3 )						
<b>B004 - R1026 - Movement - 22.18 m2</b>							
No Asbestos							
<b>B004 - R1027 - Movement - 6.5 m2</b>							
No Asbestos							
<b>B004 - R1028 - Movement - 6.45 m2</b>							
No Asbestos							
<b>B005 - Multi Purpose Facilities - 1974 - Brick/Block</b>							
<b>Exterior</b>							
Underfloor Voids - Slab on Ground	No Asbestos Found						
Ceiling Voids - Raked Ceiling	Non Accessible Area						
<b>Interior</b>							
<b>B005 - M1001 - Plant - 19.84 m2</b>							
Electrical - Backing Board	Resinous Board	1	North	Good Condition (1)	Low (1)	Low Priority (2-3)	Assumed Asbestos
<b>B005 - M1002 - Plant - 20.82 m2</b>							

No Asbestos							
<b>B005 - R0001 - General Storeroom - 12.3 m2</b>							
Floor Coverings Res/Textile	Vinyl Tiles	14m2	Throughout	Good Condition (1)	Low (1)	Low Priority (2-3)	Chrysotile (white asbestos)
<b>B005 - R0002 - Distribution Board Cupboard - .99 m2</b>							
<b>Note: No inspection of live electrical installation</b>							
Ceiling Structures/Linings	Flat AC Sheeting	1m2	Throughout	Minimal Damage (2)	Low (1)	Low Priority (2-3)	Chrysotile (white asbestos)
Floor Coverings Res/Textile	Compressed AC Sheet	1m2	Throughout	Good Condition (1)	Low (1)	Low Priority (2-3)	Chrysotile (white asbestos)
Door - Lining	Millboard	2	West	Good Condition (1)	Low (1)	Low Priority (2-3)	Chrysotile (white asbestos)
<b>B005 - R0003 - Cleaning Store - Distributed - 2.88 m2</b>							
Floor Coverings Res/Textile	Vinyl Tiles	3m2	All surfaces	Good Condition (1)	Low (1)	Low Priority (2-3)	Chrysotile (white asbestos)
<b>B005 - R0004 - Toilets-Girls - 26.91 m2</b>							
No Asbestos							
<b>B005 - R0005 - Movement - 73.48 m2</b>							
No Asbestos							
<b>B005 - R0006 - Student Canteen - 17.61 m2</b>							
No Asbestos							
<b>B005 - R0007 - Toilets-Boys - 26.86 m2</b>							
No Asbestos							
<b>B005 - R0008 - Multi-Purpose Space - 455.93 m2</b>							
No Asbestos							
<b>B005 - R0009 - Chair Store - 20.58 m2</b>							
No Asbestos							
<b>B005 - R0010 - Movement - 7.79 m2</b>							
No Asbestos							
<b>B005 - R0011 - Stage - 117.26 m2</b>							
No Asbestos							
<b>B005 - R0012 - Movement - 7.55 m2</b>							
No Asbestos							
<b>B005 - R0013 - Chair Store - 19.17 m2</b>							
No Asbestos							
<b>B005 - R0014 - Staff - Toilet - 1.77 m2</b>							
No Asbestos							
<b>B005 - R0015 - External Movement - 15.84 m2</b>							
No Asbestos							
<b>B005 - R0016 - External Movement - 3 m2</b>							
No Asbestos							
<b>B005 - R0017 - External Movement - 3.02 m2</b>							
No Asbestos							
<b>B005 - R0018 - External Movement - 1.58 m2</b>							
No Asbestos							
<b>B005 - R0019 - External Movement - 2.25 m2</b>							
No Asbestos							
<b>B005 - R0020 - External Movement - 2.61 m2</b>							
No Asbestos							
<b>B005 - R0021 - External Movement - 2.61 m2</b>							
No Asbestos							
<b>B005 - R0022 - Other - 1.31 m2</b>							
No Asbestos							
<b>B005 - R0023 - External Movement - 57.5 m2</b>							

No Asbestos							
<b>B005 - R1001 - Performing Arts Changeroom - 16.54 m2</b>							
Floor Coverings Res/Textile	Vinyl Tiles	17m2	All surfaces	Good Condition (1)	Low (1)	Low Priority (2-3)	Chrysotile (white asbestos)
<b>B005 - R1002 - Staff - Toilet - 1.72 m2</b>							
No Asbestos							
<b>B005 - R1003 - Shower/Change - 1.72 m2</b>							
No Asbestos							
<b>B005 - R1004 - Movement - 6.51 m2</b>							
No Asbestos							
<b>B005 - R1005 - Control Room - 14.68 m2</b>							
No Asbestos							
<b>B005 - R1006 - Movement - 4.18 m2</b>							
No Asbestos							
<b>B005 - R1007 - Performing Arts Changeroom - 16.4 m2</b>							
Floor Coverings Res/Textile	Vinyl Tiles	17m2	All surfaces	Good Condition (1)	Low (1)	Low Priority (2-3)	Chrysotile (white asbestos)
<b>B005 - R1008 - Shower/Change - 1.64 m2</b>							
No Asbestos							
<b>B005 - R1009 - Staff - Toilet - 1.72 m2</b>							
No Asbestos							
<b>B005 - R1010 - Stairs - 1.55 m2</b>							
No Asbestos							
<b>B005 - R1011 - Stairs - 1.55 m2</b>							
No Asbestos							
<b>B006 - General Learning - 1920 - Brick/Block</b>							
<b>Exterior</b>							
Underfloor Voids	Flat AC Sheeting	2	Variable positions	Some Damage - Unsealed (3)	Low (1)	Medium Priority (4-5)	Chrysotile (white asbestos)
Ceiling Voids	Non Accessible Area						
<b>Interior</b>							
<b>B006 - R0001 - Cleaning Store - Distributed - 4.92 m2</b>							
Floor Coverings Res/Textile	Vinyl Tiles	5m2	Throughout	Good Condition (1)	Low (1)	Low Priority (2-3)	Chrysotile (white asbestos)
<b>B006 - R0002 - General Storeroom - 12.32 m2</b>							
Floor Coverings Res/Textile	Vinyl Tiles	13m2	Throughout	Good Condition (1)	Low (1)	Low Priority (2-3)	Chrysotile (white asbestos)
Furniture / Fixtures - Blackboard	Compressed AC Sheet						
<b>B006 - R0004 - General Learning Space - 48.74 m2</b>							
Floor Coverings Res/Textile	Vinyl Tiles (Under Floor Covering/Carpet)	49m2	Throughout	Good Condition (1)	Low (1)	Low Priority (2-3)	Chrysotile (white asbestos)
<b>B006 - R0005 - General Learning Space - 48.48 m2</b>							
Floor Coverings Res/Textile	Vinyl Tiles (Under Floor Covering/Carpet)	49m2	Throughout	Good Condition (1)	Low (1)	Low Priority (2-3)	Chrysotile (white asbestos)
<b>B006 - R0008 - Staff Study - 47.63 m2</b>							
Floor Coverings Res/Textile	Vinyl Tiles (Under Floor Covering/Carpet)	48m2	Throughout	Good Condition (1)	Low (1)	Low Priority (2-3)	Chrysotile (white asbestos)
<b>B006 - R0009 - General Learning Space - 48.2 m2</b>							
Floor Coverings Res/Textile	Vinyl Tiles (Under Floor Covering/Carpet)	49m2	Throughout	Good Condition (1)	Low (1)	Low Priority (2-3)	Chrysotile (white asbestos)
<b>B006 - R0010 - General Learning Space - 47.62 m2</b>							
Floor Coverings Res/Textile	Vinyl Tiles (Under Floor Covering/Carpet)	48m2	Throughout	Good Condition (1)	Low (1)	Low Priority (2-3)	Chrysotile (white asbestos)



<b>B006 - R0011 - Interview/Office - Type 1 - 12.66 m2</b>							
Floor Coverings Res/Textile	Vinyl Tiles (Under Floor Covering/Carpet)	13m2	Throughout	Good Condition (1)	Low (1)	Low Priority (2-3)	Chrysotile (white asbestos)
<b>B006 - R0012 - Cleaning Store - Distributed - 4.94 m2</b>							
Floor Coverings Res/Textile	Vinyl Tiles	5m2	Throughout	Good Condition (1)	Low (1)	Low Priority (2-3)	Chrysotile (white asbestos)
<b>B006 - R0013 - Administration - Clerical - 28.3 m2</b>							
Floor Coverings Res/Textile	Vinyl Tiles (Under Floor Covering/Carpet)	29m2	Throughout	Good Condition (1)	Low (1)	Low Priority (2-3)	Chrysotile (white asbestos)
<b>B006 - R0014 - Staff Kitchen - 15.22 m2</b>							
Floor Coverings Res/Textile	Vinyl Tiles	16m2	Throughout	Good Condition (1)	Low (1)	Low Priority (2-3)	Chrysotile (white asbestos)
<b>B006 - R0015 - Staff Study - 19.75 m2</b>							
Floor Coverings Res/Textile	Vinyl Tiles (Under Floor Covering/Carpet)	20m2	Throughout	Good Condition (1)	Low (1)	Low Priority (2-3)	Chrysotile (white asbestos)
<b>B006 - R0016 - Staff - Toilet - 4.17 m2</b>							
No Asbestos							
<b>B006 - R0017 - Computer Room - 14.95 m2</b>							
Floor Coverings Res/Textile	Vinyl Tiles (Under Floor Covering/Carpet)	15m2	Throughout	Good Condition (1)	Low (1)	Low Priority (2-3)	Chrysotile (white asbestos)
<b>B006 - R0018 - Entry - 18.77 m2</b>							
No Asbestos							
<b>B006 - R0019 - Movement - 138.23 m2</b>							
Floor Coverings Res/Textile	Vinyl Tiles (Under Floor Covering/Carpet)	139m2	Throughout	Good Condition (1)	Low (1)	Low Priority (2-3)	Chrysotile (white asbestos)
<b>B006 - R0020 - Stairs - 7.32 m2</b>							
No Asbestos							
<b>B006 - R0021 - Stairs - 7.42 m2</b>							
No Asbestos							
<b>B006 - R0022 - External Movement - 5.8 m2</b>							
No Asbestos							
<b>B006 - R0023 - External Movement - 3.09 m2</b>							
No Asbestos							
<b>B006 - R0024 - Staff Study - 14.83 m2</b>							
Floor Coverings Res/Textile	Vinyl Tiles (Under Floor Covering/Carpet)	15m2	Throughout	Good Condition (1)	Low (1)	Low Priority (2-3)	Chrysotile (white asbestos)
<b>B006 - R0025 - External Movement - 6.03 m2</b>							
Ceiling Structures/Linings	Flat AC Sheeting						
<b>B006 - R1001 - Movement - 120.76 m2</b>							
No Asbestos							
<b>B006 - R1002 - General Learning Space - 48.96 m2</b>							
Floor Coverings Res/Textile	Vinyl Tiles (Under Floor Covering/Carpet)	49m2	Throughout	Good Condition (1)	Low (1)	Low Priority (2-3)	Chrysotile (white asbestos)
<b>B006 - R1003 - General Learning Space - 49.69 m2</b>							
Floor Coverings Res/Textile	Vinyl Tiles (Under Floor Covering/Carpet)	50m2	Throughout	Good Condition (1)	Low (1)	Low Priority (2-3)	Chrysotile (white asbestos)
<b>B006 - R1004 - Computer Learning Space - 50.03 m2</b>							
Floor Coverings Res/Textile	Vinyl Tiles (Under Floor Covering/Carpet)	51m2	Throughout	Good Condition (1)	Low (1)	Low Priority (2-3)	Chrysotile (white asbestos)
<b>B006 - R1005 - General Learning Space - 49.77 m2</b>							
Floor Coverings Res/Textile	Vinyl Tiles (Under Floor Covering/Carpet)	50m2	Throughout	Good Condition (1)	Low (1)	Low Priority (2-3)	Chrysotile (white asbestos)
<b>B006 - R1006 - General Learning Space - 49.02 m2</b>							
Floor Coverings Res/Textile	Vinyl Tiles (Under Floor Covering/Carpet)	50m2	Throughout	Good Condition (1)	Low (1)	Low Priority (2-3)	Chrysotile (white asbestos)

<b>B006 - R1007 - General Storeroom - 9.89 m2</b>							
Floor Coverings Res/Textile	Vinyl Tiles	10m2	Throughout	Good Condition (1)	Low (1)	Low Priority (2-3)	Chrysotile (white asbestos)
<b>B006 - R1008 - Staff Study - 26.44 m2</b>							
Floor Coverings Res/Textile	Vinyl Tiles (Under Floor Covering/Carpet)	27m2	Throughout	Good Condition (1)	Low (1)	Low Priority (2-3)	Chrysotile (white asbestos)
<b>B006 - R1009 - General Learning Space - 45.96 m2</b>							
Floor Coverings Res/Textile	Vinyl Tiles (Under Floor Covering/Carpet)	46m2	Throughout	Good Condition (1)	Low (1)	Low Priority (2-3)	Chrysotile (white asbestos)
<b>B006 - R1010 - Staff Study - 71.96 m2</b>							
Floor Coverings Res/Textile	Vinyl Tiles (Under Floor Covering/Carpet)	72m2	Throughout	Good Condition (1)	Low (1)	Low Priority (2-3)	Chrysotile (white asbestos)
<b>B006 - R1011 - Cleaning Store - Distributed - 7.03 m2</b>							
Floor Coverings Res/Textile	Vinyl Tiles	8m2	Throughout	Good Condition (1)	Low (1)	Low Priority (2-3)	Chrysotile (white asbestos)
<b>B006 - R1012 - Staff - Toilet - 2.99 m2</b>							
Floor Coverings Res/Textile	Vinyl Tiles	3m2	Throughout	Good Condition (1)	Low (1)	Low Priority (2-3)	Chrysotile (white asbestos)
<b>B006 - R1013 - Stairs - 11.4 m2</b>							
No Asbestos							
<b>B006 - R1014 - Stairs - 12.82 m2</b>							
No Asbestos							
<b>B006 - R2001 - Staff Toilet - 4.13 m2</b>							
Floor Coverings Res/Textile	Vinyl Tiles	5m2	Throughout	Good Condition (1)	Low (1)	Low Priority (2-3)	Chrysotile (white asbestos)
<b>B006 - R2002 - Movement - 2.18 m2</b>							
Floor Coverings Res/Textile	Vinyl Tiles	3m2	Throughout	Good Condition (1)	Low (1)	Low Priority (2-3)	Chrysotile (white asbestos)
<b>B006 - R2003 - General Storeroom - 3.85 m2</b>							
Floor Coverings Res/Textile	Vinyl Tiles	4m2	Throughout	Good Condition (1)	Low (1)	Low Priority (2-3)	Chrysotile (white asbestos)
<b>B006 - R2004 - General Storeroom - 10.62 m2</b>							
Floor Coverings Res/Textile	Vinyl Tiles	11m2	Throughout	Good Condition (1)	Low (1)	Low Priority (2-3)	Chrysotile (white asbestos)
<b>B006 - R2005 - General Learning Space - 49.77 m2</b>							
Floor Coverings Res/Textile	Vinyl Tiles (Under Floor Covering/Carpet)	50m2	Throughout	Good Condition (1)	Low (1)	Low Priority (2-3)	Chrysotile (white asbestos)
<b>B006 - R2006 - General Learning Space - 49.77 m2</b>							
Floor Coverings Res/Textile	Vinyl Tiles (Under Floor Covering/Carpet)	50m2	Throughout	Good Condition (1)	Low (1)	Low Priority (2-3)	Chrysotile (white asbestos)
<b>B006 - R2007 - Special Learning Space - 50.79 m2</b>							
Floor Coverings Res/Textile	Vinyl Tiles (Under Floor Covering/Carpet)	51m2	Throughout	Good Condition (1)	Low (1)	Low Priority (2-3)	Chrysotile (white asbestos)
<b>B006 - R2008 - General Learning Space - 50.78 m2</b>							
Floor Coverings Res/Textile	Vinyl Tiles (Under Floor Covering/Carpet)	51m2	Throughout	Good Condition (1)	Low (1)	Low Priority (2-3)	Chrysotile (white asbestos)
<b>B006 - R2009 - Art Learning Space-I.E.C. - 50.73 m2</b>							
Floor Coverings Res/Textile	Vinyl Tiles (Under Floor Covering/Carpet)	51m2	Throughout	Good Condition (1)	Low (1)	Low Priority (2-3)	Chrysotile (white asbestos)
<b>B006 - R2010 - Movement - 111.45 m2</b>							
Floor Coverings Res/Textile	Vinyl Tiles (Under Floor Covering/Carpet)	112m2	Throughout	Good Condition (1)	Low (1)	Low Priority (2-3)	Chrysotile (white asbestos)
<b>B006 - R2011 - Resources Store - 10.46 m2</b>							
Floor Coverings Res/Textile	Vinyl Tiles	11m2	Throughout	Good Condition (1)	Low (1)	Low Priority (2-3)	Chrysotile (white asbestos)
<b>B006 - R2012 - General Storeroom - 32.5 m2</b>							
Floor Coverings Res/Textile	Vinyl Tiles (Under Floor Covering/Carpet)	33m2	Throughout	Good Condition (1)	Low (1)	Low Priority (2-3)	Chrysotile (white asbestos)

<b>B006 - R2013 - Special Learning Space - 41.98 m2</b>							
Floor Coverings Res/Textile	Vinyl Tiles (Under Floor Covering/Carpet)	42m2	Throughout	Good Condition (1)	Low (1)	Low Priority (2-3)	Chrysotile (white asbestos)
<b>B006 - R2014 - General Learning Space-I.E.C. - 30.62 m2</b>							
Floor Coverings Res/Textile	Vinyl Tiles (Under Floor Covering/Carpet)	31m2	Throughout	Good Condition (1)	Low (1)	Low Priority (2-3)	Chrysotile (white asbestos)
<b>B006 - R2015 - Special Learning Space - 40.7 m2</b>							
Floor Coverings Res/Textile	Vinyl Tiles (Under Floor Covering/Carpet)	41m2	Throughout	Good Condition (1)	Low (1)	Low Priority (2-3)	Chrysotile (white asbestos)
<b>B006 - R2016 - Stairs - 11.99 m2</b>							
No Asbestos							
<b>B006 - R2017 - Stairs - 12.96 m2</b>							
No Asbestos							
<b>B006 - R9001 - Garden Store Room - 9.13 m2</b>							
No Asbestos							
<b>B007 - Administration/Various - 1979 - Brick/Block</b>							
<b>Exterior</b>							
Eaves Linings	Flat AC Sheeting	100m2	Variable positions	Good Condition (1)	Low (1)	Low Priority (2-3)	Assumed Asbestos
Ceiling Voids	Non Accessible Area						
Underfloor Voids	No Asbestos Found						
<b>Interior</b>							
<b>B007 - R0001 - Duplicating Workroom - 26.72 m2</b>							
Ceiling Structures/Linings	Vermiculite - Composite Sample - ( 10 - 40 m2) - ( X3 )						
<b>B007 - R0002 - General Storeroom - 13.31 m2</b>							
Floor Coverings Res/Textile	Vinyl Tiles	14m2	All surfaces	Good Condition (1)	Low (1)	Low Priority (2-3)	Chrysotile (white asbestos)
Ceiling Structures/Linings	Vermiculite - Composite Sample - ( 10 - 40 m2) - ( X3 )						
<b>B007 - R0003 - Administration - Clerical - 34.29 m2</b>							
Ceiling Structures/Linings	Vermiculite - Composite Sample - ( 10 - 40 m2) - ( X3 )						
<b>B007 - R0004 - Movement - 20.55 m2</b>							
Ceiling Structures/Linings	Vermiculite - Composite Sample - ( 10 - 40 m2) - ( X3 )						
<b>B007 - R0005 - Staff - Toilet - 3.74 m2</b>							
Ceiling Structures/Linings	Vermiculite - Composite Sample - ( < 10 m2) - ( X2 )						
<b>B007 - R0006 - Staff - Toilet - 4.05 m2</b>							
Ceiling Structures/Linings	Vermiculite - Composite Sample - ( < 10 m2) - ( X2 )						
<b>B007 - R0007 - Ancillary Staff - 24.45 m2</b>							
Ceiling Structures/Linings	Vermiculite - Composite Sample - ( 10 - 40 m2) - ( X3 )						
<b>B007 - R0008 - Movement - 12.98 m2</b>							
Ceiling Structures/Linings	Vermiculite - Composite Sample - ( 10 - 40 m2) - ( X3 )						
<b>B007 - R0009 - Distribution Board Cupboard - 1.41 m2</b>							
<b>Note: No inspection of live electrical installation</b>							
Electrical - Backing Board	Resinous Board	3	South	Good Condition (1)	Low (1)	Low Priority (2-3)	Chrysotile (white asbestos)
Electrical - Backing Board	Resinous Board	3	South	Good Condition (1)	Low (1)	Low Priority (2-3)	Chrysotile (white asbestos)
<b>B007 - R0010 - Principal Office - 20.71 m2</b>							
Ceiling Structures/Linings	Vermiculite - Composite Sample - ( 10 - 40 m2) - ( X3 )						

<b>B007 - R0011 - Cleaning Store - Distributed - 4.61 m2</b>							
No Asbestos							
<b>B007 - R0012 - Movement - 38.66 m2</b>							
Ceiling Structures/Linings	Vermiculite - Composite Sample - ( 10 - 40 m2) - ( X3 )						
<b>B007 - R0013 - General Storeroom - 14.11 m2</b>							
Ceiling Structures/Linings	Vermiculite - Composite Sample - ( 10 - 40 m2) - ( X3 )						
<b>B007 - R0014 - Clinic - Boys - 14.65 m2</b>							
Floor Coverings Res/Textile	Vinyl Tiles	15m2	All surfaces	Good Condition (1)	Low (1)	Low Priority (2-3)	Chrysotile (white asbestos)
Ceiling Structures/Linings	Vermiculite - Composite Sample - ( 10 - 40 m2) - ( X3 )						
<b>B007 - R0015 - Clinic-Toilets - 3.4 m2</b>							
Ceiling Structures/Linings	Vermiculite - Composite Sample - ( < 10 m2) - ( X2 )						
<b>B007 - R0016 - Duplicating Workroom - 11.68 m2</b>							
Floor Coverings Res/Textile	Vinyl Tiles	12m2	All surfaces	Good Condition (1)	Low (1)	Low Priority (2-3)	Chrysotile (white asbestos)
Ceiling Structures/Linings	Vermiculite - Composite Sample - ( 10 - 40 m2) - ( X3 )						
<b>B007 - R0017 - Staff - Toilet - 3.15 m2</b>							
Ceiling Structures/Linings	Vermiculite - Composite Sample - ( < 10 m2) - ( X2 )						
<b>B007 - R0018 - Deputy Principal Office - 15.75 m2</b>							
Floor Coverings Res/Textile	Vinyl Tiles	16m2	All surfaces	Good Condition (1)	Low (1)	Low Priority (2-3)	Chrysotile (white asbestos)
Ceiling Structures/Linings	Vermiculite - Composite Sample - ( 10 - 40 m2) - ( X3 )						
<b>B007 - R0019 - Gymnasium - 287.36 m2</b>							
No Asbestos							
<b>B007 - R0020 - Stage - 58.77 m2</b>							
No Asbestos							
<b>B007 - R0021 - Distribution Board Cupboard - .58 m2</b>							<b>Note: No inspection of live electrical installation</b>
Electrical - Backing Board	Resinous Board	1	North	Good Condition (1)	Low (1)	Low Priority (2-3)	Assumed Asbestos
<b>B007 - R0022 - Movement - 21.07 m2</b>							
No Asbestos							
<b>B007 - R0023 - Sport Equipment Store - 52.44 m2</b>							
No Asbestos							
<b>B007 - R0024 - External Movement - 190.46 m2</b>							
No Asbestos							
<b>B007 - R0025 - Cleaning Supplies Store - 2.93 m2</b>							
Door - Insulation	Encapsulated Asbestos material within unit						
<b>B007 - R0026 - Cleaning Supplies Store - 9.1 m2</b>							
Door - Insulation	Encapsulated Asbestos material within unit						
<b>B007 - R0027 - Maintenance Bulk Store - 4.71 m2</b>							
No Asbestos							
<b>B007 - R0028 - Distribution Board Cupboard - .55 m2</b>							<b>Note: No inspection of live electrical installation</b>
Electrical - Backing Board	Resinous Board	3	West	Good Condition (1)	Low (1)	Low Priority (2-3)	Chrysotile (white asbestos)
Electrical - Backing Board	Resinous Board	3	West	Good Condition (1)	Low (1)	Low Priority (2-3)	Chrysotile (white asbestos)
<b>B007 - R0029 - Garden Store Room - 12.83 m2</b>							

No Asbestos							
<b>B007 - R0030 - Student Canteen - 67.66 m2</b>							
Floor Coverings Res/Textile	Vinyl Tiles	68m2	All surfaces	Good Condition (1)	Low (1)	Low Priority (2-3)	Chrysotile (white asbestos)
<b>B007 - R0031 - Staff - Toilet - 7.36 m2</b>							
Floor Coverings Res/Textile	Vinyl Tiles	8m2	All surfaces	Good Condition (1)	Low (1)	Low Priority (2-3)	Chrysotile (white asbestos)
<b>B007 - R0032 - External Movement - 24.29 m2</b>							
No Asbestos							
<b>B007 - R0033 - External Stairs - 14.3 m2</b>							
No Asbestos							
<b>B007 - R0034 - Stairs - 4.76 m2</b>							
No Asbestos							
<b>B007 - R0035 - External Movement - 1.59 m2</b>							
No Asbestos							
<b>B007 - R0036 - External Movement - 70.21 m2</b>							
No Asbestos							
<b>B007 - R1001 - Commonroom - 122.61 m2</b>							
No Asbestos							
<b>B007 - R1002 - Staff Study - 11.9 m2</b>							
No Asbestos							
<b>B007 - R1003 - Interview/Office - Type 1 - 11.82 m2</b>							
No Asbestos							
<b>B007 - R1004 - Interview/Office - Type 1 - 11.76 m2</b>							
No Asbestos							
<b>B007 - R1005 - Staff - Toilet - 5.12 m2</b>							
No Asbestos							
<b>B007 - R1006 - Staff - Toilet - 5.13 m2</b>							
No Asbestos							
<b>B007 - R1007 - General Storeroom - 21.75 m2</b>							
Floor Coverings Res/Textile	Vinyl Tiles	22m2	Throughout	Good Condition (1)	Low (1)	Low Priority (2-3)	Chrysotile (white asbestos)
<b>B007 - R1008 - Movement - 34.33 m2</b>							
No Asbestos							
<b>B007 - R1009 - Careers Advisers Office - 34.32 m2</b>							
No Asbestos							
<b>B007 - R1010 - Distribution Board Cupboard - .58 m2</b>							
<b>Note: No inspection of live electrical installation</b>							
Electrical - Backing Board	Resinous Board	2	West	Good Condition (1)	Low (1)	Low Priority (2-3)	Chrysotile (white asbestos)
Electrical - Backing Board	Resinous Board	2	West	Good Condition (1)	Low (1)	Low Priority (2-3)	Chrysotile (white asbestos)
<b>B007 - R1011 - Cleaning Store - Distributed - 4.68 m2</b>							
No Asbestos							
<b>B007 - R1012 - External Movement - 26.84 m2</b>							
No Asbestos							
<b>B007 - R1013 - Movement - 62.11 m2</b>							
Floor Coverings Res/Textile	Vinyl Tiles	63m2	All surfaces	Good Condition (1)	Low (1)	Low Priority (2-3)	Chrysotile (white asbestos)
<b>B007 - R1014 - Shower/Change - 43.42 m2</b>							
Partition Walls (Cubides)	Compressed AC Sheet	30m2	North facing	Good Condition (1)	Low (1)	Low Priority (2-3)	Chrysotile (white asbestos)
<b>B007 - R1015 - Toilets-Girls - 38.69 m2</b>							
Partition Walls (Cubides)	Compressed AC Sheet	40m2	North facing	Good Condition (1)	Low (1)	Low Priority (2-3)	Chrysotile (white asbestos)

<b>B007 - R1016 - Shower/Change - 36.59 m2</b>							
Partition Walls (Cubides)	Compressed AC Sheet	3.m2	North facing	Good Condition (1)	Low (1)	Low Priority (2-3)	Chrysotile (white asbestos)
<b>B007 - R1017 - Staff Study - 7.7 m2</b>							
Floor Coverings Res/Textile	Vinyl Tiles	8m2	All surfaces	Good Condition (1)	Low (1)	Low Priority (2-3)	Chrysotile (white asbestos)
<b>B007 - R1018 - Staff Study - 9.23 m2</b>							
Floor Coverings Res/Textile	Vinyl Tiles	10m2	All surfaces	Good Condition (1)	Low (1)	Low Priority (2-3)	Chrysotile (white asbestos)
<b>B007 - R1019 - Cleaning Store - Distributed - 6.16 m2</b>							
No Asbestos							
<b>B007 - R1020 - Distribution Board Cupboard - .53 m2</b>							
							<b>Note: No inspection of live electrical installation</b>
Electrical - Backing Board	Resinous Board	2	South	Good Condition (1)	Low (1)	Low Priority (2-3)	Chrysotile (white asbestos)
Electrical - Backing Board	Resinous Board	2	South	Good Condition (1)	Low (1)	Low Priority (2-3)	Chrysotile (white asbestos)
<b>B007 - R1021 - Shower/Change - 43.57 m2</b>							
No Asbestos							
<b>B007 - R1022 - Toilets-Girls - 36.23 m2</b>							
Partition Walls (Cubides)	Compressed AC Sheet	30m2	North facing	Good Condition (1)	Low (1)	Low Priority (2-3)	Chrysotile (white asbestos)
<b>B007 - R1023 - Shower/Change - 46.74 m2</b>							
No Asbestos							
<b>B007 - R1024 - External Movement - 4.95 m2</b>							
No Asbestos							
<b>B007 - R1025 - External Movement - 6.36 m2</b>							
No Asbestos							
<b>B007 - R1026 - External Movement - 1.66 m2</b>							
No Asbestos							
<b>B007 - R1027 - External Stairs - 18.6 m2</b>							
No Asbestos							
<b>B007 - R1028 - Stairs - 10.25 m2</b>							
No Asbestos							
<b>B007 - R2001 - Staff Study - 28.44 m2</b>							
No Asbestos							
<b>B007 - R2002 - Cleaning Store - Distributed - 4.05 m2</b>							
No Asbestos							
<b>B007 - R2003 - General Learning Space - 53.08 m2</b>							
No Asbestos							
<b>B007 - R2004 - General Learning Space - 54.04 m2</b>							
No Asbestos							
<b>B007 - R2005 - General Learning Space - 51.03 m2</b>							
No Asbestos							
<b>B007 - R2006 - General Learning Space - 52.15 m2</b>							
No Asbestos							
<b>B007 - R2007 - General Learning Space - 51.07 m2</b>							
No Asbestos							
<b>B007 - R2008 - Distribution Board Cupboard - .77 m2</b>							
							<b>Note: No inspection of live electrical installation</b>
Ceiling Structures/Linings	Flat AC Sheeting	1m2	Throughout	Good Condition (1)	Low (1)	Low Priority (2-3)	Chrysotile (white asbestos) , Amosite (brown asbestos)
Electrical - Backing Board	Resinous Board	2	South	Good Condition (1)	Low (1)	Low Priority (2-3)	Chrysotile (white asbestos)
Electrical - Backing Board	Resinous Board	2	South	Good Condition (1)	Low (1)	Low Priority (2-3)	Chrysotile (white asbestos)

<b>B007 - R2009 - Movement - 49.4 m2</b>							
No Asbestos							
<b>B007 - R2010 - External Movement - 10.34 m2</b>							
Ceiling Structures/Linings	Flat AC Sheeting	4m2	Doorway ceiling	Good Condition (1)	Low (1)	Low Priority (2-3)	Chrysotile (white asbestos) , Amosite (brown asbestos)
<b>B007 - R2011 - External Stairs - 19.41 m2</b>							
No Asbestos							
<b>B007 - R2012 - External Movement - 10.13 m2</b>							
No Asbestos							

**Demountables**

**OS 601 11317 - Learning Unit - Standard/Withdrawal - Placement Date : 29-JAN-2010**

**Note: This refurbished demountable may have asbestos present in remnant mastic in window frames.**

No Asbestos Found