

Asbestos Register

(Hazardous Materials and Risk Assessment)

School:	Kurrajong Public School (2342)
Region:	Western Sydney AMU
State Electorate:	Hawkesbury
Local Government Area:	Hawkesbury

Last Reviewed By:	Greencap 22-JUN-2015
Last Revised By:	

Historical Fibro In Grounds Investigations/Events	Yes
Please refer to the latest site specific Asbestos Management Plans available from the Department's website (Refer to Note 2).	

2342 - Kurrajong Public School
Site Plan (12601)

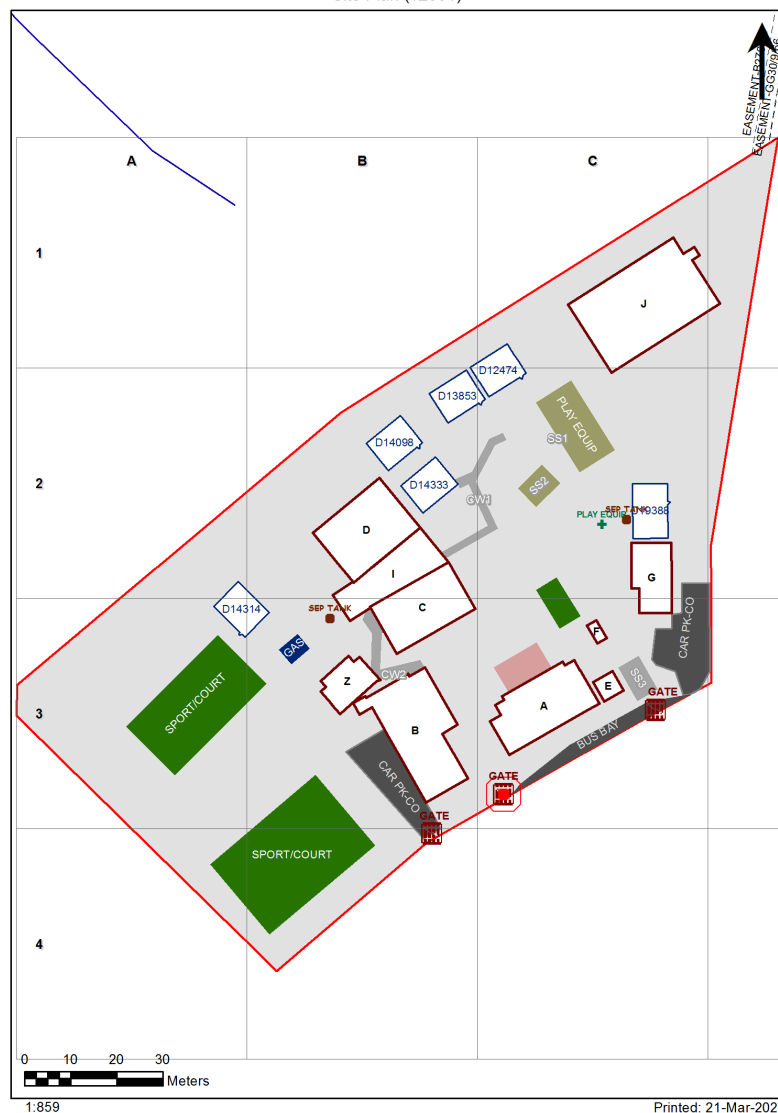

Preface to Asbestos Register

Limitations

Asbestos Registers established (first surveyed 2007/08) and maintained for the Department of Education (DoE) are limited in extent, in that:

1. All inspections and surveys of materials and finishes in DoE facilities are non-disturbance, with
2. Samples undertaken by hygienist to determine whether a sample is an Asbestos Containing Material (ACM),
3. The hygienist may apply a single sample to like materials within a space and adjoining spaces, but not normally between buildings,
4. Successive inspections have reduced any inconclusive records such as 'assumed asbestos' in difficult to access areas, by undertaking additional sampling with lifting devices.
5. In compliance with WHS Act 2011 and WHS Regulations 2017, additional inspections have been undertaken in ceiling spaces and sub-floor areas where access is possible.
 - o Where the ground floor is slab on ground, no inspection is made beneath the slab.
 - o Where fibro fragments (ACM taken for sampling) are located in ceiling spaces or sub floor voids air monitoring is normally undertaken at time of sampling, and clearance undertaken as soon as practicable.
6. No attempt has been made to identify any ACM that is hidden from view or encapsulated within
 - o Any wall cavity
 - o Sub floor area, particularly formwork for slabs in/on ground,
 - o Services (that may use ACM) such as: pipe lagging, asbestos cement pipes, flues.
7. All known ACM in Grounds (Fibro in Grounds) is made available in associated site specific asbestos management plans in DoE electronic files.
Notwithstanding information provided, ACM may be present in grounds from time to time and caution must be exercised prior to any grounds disturbance.

Use of the Asbestos Register

Prior to any disturbance works being undertaken in a building to which this asbestos register applies it will be necessary to confirm the extent of any ACM by a disturbance investigation:

- If the building was built prior to 2003
- If any ACM has been identified in the Asbestos Register for the building.

Update of Asbestos Registers

Asbestos Register Data is updated regularly by the DoE Hygienist Panel via the Online Asbestos Register Tool (Managed by Business Systems, School Infrastructure NSW). Internal users can view the latest edition of the Asbestos Register in the AMS.

Please note: The Department's external website may not contain the latest revision of the Asbestos Register.

Notes 1: Vermiculite

- During 2018/19, all vermiculite occurrences in DoE schools identified in 2007/08, were 'composite tested' in accordance with a safe work NSW agreed procedure. This required multiple testing of all vermiculite occurrences.
- During the period 2007/08 to 2018/19, some vermiculite has been over sheeted and a warning is indicated for schools where this has happened.

Note 2: DoE website link for information is here:

<https://www.schoolinfrastructure.nsw.gov.au/about-us/working-with-us/schools-asbestos-register.html>
<https://education.nsw.gov.au/about-us/strategies-and-reports/our-reports-and-reviews/schools-asbestos-register>

Note 3: Material Condition Assessment

The material condition assessment descriptors from Section 3 of the Asbestos Management Plan (AMP) is extracted below. Please read the AMP in its entirety for further information.

3.3.2.1 Material condition assessment

The OART records the material condition of identified ACM in the following format:

Rating	Description
Good condition (1)	For non-friable asbestos that is sealed and has no visible damage. This primarily related to asbestos cement (AC) sheet and vinyl tiles
Minimal damage (2)	For non-friable asbestos that has a very small amount of damage, eg hairline cracks.
Some damage / unsealed (3)	For non-friable asbestos with significant breakage or several small areas where material has been damaged, revealing loose asbestos fibres. Non-friable asbestos that is unsealed.
Poor condition (4)	For non-friable asbestos that has extensive damage. Visible asbestos debris
Friable asbestos (5)	Any occurrence of friable asbestos

Product	Material Description	Extent	Location	Material Condition	Risk Status	Remediation Priority	Result
B00A - General Learning/Administration - 1963 - Brick/Veneer							
Exterior							
Eaves Linings	Flat AC Sheeting	30m2	East, West	Good Condition (1)	Low (1)	Low Priority (2-3)	Chrysotile (white asbestos) , Amosite (brown asbestos) , Crocidolite (blue asbestos)
Gable Verge Lining	Flat AC Sheeting	20m2	North, South	Good Condition (1)	Low (1)	Low Priority (2-3)	Chrysotile (white asbestos) , Amosite (brown asbestos) , Crocidolite (blue asbestos)
Underfloor Voids	No Asbestos Found						
Ceiling Voids	No Asbestos Found						
Interior							
B00A - R0001 - Movement - 4.86 m2							
Ceiling Structures/Linings	Flat AC Sheeting	5m2	Throughout	Good Condition (1)	Low (1)	Low Priority (2-3)	Chrysotile (white asbestos) , Amosite (brown asbestos) , Crocidolite (blue asbestos)
B00A - R0002 - Movement - 3.2 m2							
No Asbestos							
B00A - R0003 - Personal Effects Storage - 4.9 m2							
No Asbestos							
B00A - R0004 - Home Base Store - 5.5 m2							
Electrical - Backing Board	Resinous Board	1	North	Good Condition (1)	Low (1)	Low Priority (2-3)	Assumed Asbestos
B00A - R0005 - Home Base - 56.22 m2							
Wall Linings Internal - Backing Board	Compressed AC Sheet	2m2	North lower portion	Good Condition (1)	Low (1)	Low Priority (2-3)	Chrysotile (white asbestos)
B00A - R0006 - Home Base - 56.38 m2							
Wall Linings Internal - Backing Board	Compressed AC Sheet	2m2	South lower portion	Good Condition (1)	Low (1)	Low Priority (2-3)	Chrysotile (white asbestos)
B00A - R0007 - Home Base Store - 6.69 m2							
No Asbestos							
B00A - R0008 - General Storeroom - 3.43 m2							
No Asbestos							
B00A - R0009 - Movement - 7.62 m2							
Floor Coverings Res/Textile	Vinyl Tiles (Under Floor Covering/Carpet)						
Floor Coverings Res/Textile	Vinyl Tiles - Adhesive						
B00A - R0010 - Principal - 14.33 m2							
Floor Coverings Res/Textile	Vinyl Sheet						
Floor Coverings Res/Textile	Vinyl Sheet - Adhesive						
B00A - R0011 - Clerical Office - 7.73 m2							
No Asbestos							
B00A - R0012 - Movement - 4.81 m2							
Ceiling Structures/Linings	Flat AC Sheeting	5m2	Throughout	Good Condition (1)	Low (1)	Low Priority (2-3)	Chrysotile (white asbestos) , Amosite (brown asbestos) , Crocidolite (blue asbestos)
B00A - R0013 - External Movement - 50.62 m2							
No Asbestos							
B00A - R9001 - General Assistant/Bulk Store - 27.5 m2							
No Asbestos							

B00B - General Learning/Pupil Facilities - 1971 - Brick/Block

Exterior

Eaves Linings	Flat AC Sheeting	10m2	South	Good Condition (1)	Low (1)	Low Priority (2-3)	Chrysotile (white asbestos)
Gable Verge Lining	Flat AC Sheeting	20m2	East, West	Good Condition (1)	Low (1)	Low Priority (2-3)	Chrysotile (white asbestos)
Wall Linings Internal - Infill	Flat AC Sheeting	22	North, South, Lower portion	Good Condition (1)	Low (1)	Low Priority (2-3)	Chrysotile (white asbestos)
Ceiling Voids	No Asbestos Found						
Underfloor Voids	No Asbestos Found						

Interior

B00B - R0001 - Toilets - Boys/Girls - 4.56 m2

No Asbestos

B00B - R0002 - External Movement - 43.48 m2

Ceiling Structures/Linings	Flat AC Sheeting	44m2	Throughout	Good Condition (1)	Low (1)	Low Priority (2-3)	Chrysotile (white asbestos)
----------------------------	------------------	------	------------	--------------------	---------	--------------------	-----------------------------

B00B - R0003 - Special Programs Room - 28.21 m2

Floor Coverings Res/Textile	Vinyl Tiles	29m2	Throughout	Good Condition (1)	Low (1)	Low Priority (2-3)	Chrysotile (white asbestos)
-----------------------------	-------------	------	------------	--------------------	---------	--------------------	-----------------------------

Floor Coverings Res/Textile	Vinyl Tiles - Adhesive						
-----------------------------	------------------------	--	--	--	--	--	--

B00B - R0004 - Personal Effects Storage - 7.12 m2

No Asbestos

B00B - R0005 - Home Base Store - 6.22 m2

No Asbestos

B00B - R0006 - Home Base - 56.42 m2

No Asbestos

B00B - R0007 - Home Base - 83.66 m2

No Asbestos

B00B - R0008 - Practical Activities - 1hb - 1.71 m2

No Asbestos

B00B - R0009 - Toilets - Boys/Girls - 3.34 m2

No Asbestos

B00B - R0010 - Home Base Store - 3.15 m2

No Asbestos

B00B - R0011 - Personal Effects Storage - 6.95 m2

No Asbestos

B00B - R0012 - External Movement - 15.08 m2

No Asbestos

B00B - R9002 - Canteen - 34.38 m2

Furniture / Fixtures	Resinous Membrane						
Furniture / Fixtures - Sink	Vinyl Tiles - Adhesive	0.5	South	Good Condition (1)	Low (1)	Low Priority (2-3)	Chrysotile (white asbestos)

B00B - R9003 - Special Programs Room - 13.95 m2

No Asbestos

B00B - R9005 - Garden Store - 3.15 m2

No Asbestos

B00B - R9006 - Garden Store - 3.15 m2

No Asbestos

B00B - R9007 - Canteen Covered Area - 28.09 m2							
Wall Linings Internal	Flat AC Sheeting						
B00B - R9008 - General Storeroom - 2.14 m2							
Wall Linings Internal	Flat AC Sheeting						
B00B - R9009 - External Movement - 35.88 m2							
No Asbestos							
B00B - R9010 - General Storeroom - 5.66 m2							
Wall Linings Internal	Flat AC Sheeting						
B00C - Library - 1963 - Brick/Veneer							
Exterior							
Ceiling Voids - Raked Ceiling	Non Accessible Area						
Underfloor Voids - Slab on Ground	Non Accessible Area						
Interior							
B00C - R0001 - Movement - 89.32 m2							
No Asbestos							
B00C - R0002 - Communications Room - 9.99 m2							
No Asbestos							
B00C - R0003 - Library Office/Workroom - 20.09 m2							
Floor Coverings Res/Textile	Vinyl Tiles						
B00C - R0004 - Distribution Board - 1.57 m2							
						Note: No inspection of live electrical installation	
Wall Linings Internal	Flat AC Sheeting	8m2	North, West	Good Condition (1)	Low (1)	Low Priority (2-3)	Chrysotile (white asbestos)
B00C - R0005 - Reading Area - 89.08 m2							
No Asbestos							
B00D - General Learning - 1963 - Brick/Veneer							
Exterior							
Underfloor Voids	No Asbestos Found						
Ceiling Voids	No Asbestos Found						
Interior							
B00D - R0001 - Home Base Store - 5.8 m2							
No Asbestos							
B00D - R0002 - Home Base - 59.22 m2							
No Asbestos							
B00D - R0003 - Practical Activities - 1hb - 18.11 m2							
No Asbestos							
B00D - R0004 - Movement - 34.29 m2							
No Asbestos							
B00D - R0005 - Practical Activities - 1hb - 18.06 m2							
No Asbestos							
B00D - R0006 - Home Base - 59.29 m2							
No Asbestos							
B00D - R0007 - Home Base Store - 5.78 m2							
No Asbestos							
B00D - R0008 - Movement - 13.97 m2							
No Asbestos							
B00D - R0009 - Withdrawal Space - 1hb - 11.85 m2							
No Asbestos							
B00D - R0010 - Movement - 13.98 m2							
No Asbestos							

B00E - Administration - 1963 - Fibre Cement Clad**Exterior**

Eaves Linings	Flat AC Sheeting						
Wall Cladding	Flat AC Sheeting						
Ceiling Voids - Flat Roof	Non Accessible Area						
Underfloor Voids	Packing	1	Variable positions	Minimal Damage (2)	Low (1)	Low Priority (2-3)	Chrysotile (white asbestos)
Floor Coverings Res/Textile	Compressed AC Sheet						

Interior**B00E - R0001 - Community Clinic - 6.82 m2**

Wall Linings Internal	Flat AC Sheeting	14m2	Throughout	Good Condition (1)	Low (1)	Low Priority (2-3)	Chrysotile (white asbestos)
Ceiling Structures/Linings	Flat AC Sheeting						
Floor Coverings Res/Textile	Vinyl Tiles						

B00E - R0002 - Community Clinic - 10.24 m2

Wall Linings Internal	Flat AC Sheeting	20m2	Throughout	Good Condition (1)	Low (1)	Low Priority (2-3)	Chrysotile (white asbestos)
Ceiling Structures/Linings	Flat AC Sheeting						
Floor Coverings Res/Textile	Vinyl Tiles						

B00E - R0003 - Community Clinic - 3.67 m2

Wall Linings Internal	Flat AC Sheeting	10m2	Throughout	Good Condition (1)	Low (1)	Low Priority (2-3)	Chrysotile (white asbestos)
Ceiling Structures/Linings	Flat AC Sheeting						
Floor Coverings Res/Textile	Vinyl Tiles						

B00F - Shed - 1950 - Timber Shed**Exterior**

Ceiling Voids	No Asbestos Found						
Underfloor Voids - Slab on Ground	Non Accessible Area						

Interior**B00F - R0001 - Sports Store - 9.73 m2**

Wall Linings Internal	Flat AC Sheeting						
-----------------------	------------------	--	--	--	--	--	--

B00G - Administration - 1999 - Brick/Veneer**Exterior**

Eaves Linings	Flat AC Sheeting	20m2	Throughout	Good Condition (1)	Low (1)	Low Priority (2-3)	Chrysotile (white asbestos)
Ceiling Voids	No Asbestos Found						
Underfloor Voids	No Asbestos Found						

Interior**B00G - R0001 - Entry Vestibule - 10.82 m2**

Floor Coverings Res/Textile	Vinyl Sheet						
-----------------------------	-------------	--	--	--	--	--	--

B00G - R0002 - Clerical Office - 10.65 m2

No Asbestos							
-------------	--	--	--	--	--	--	--

B00G - R0003 - Movement - 4.9 m2							
Floor Coverings Res/Textile	Vinyl Sheet						
B00G - R0004 - Staff Toilet - 2.74 m2							
Wall Linings Internal	Flat AC Sheeting	12m2	Throughout	Good Condition (1)	Low (1)	Low Priority (2-3)	Chrysotile (white asbestos)
B00G - R0005 - Sick Bay - 9 m2							
Floor Coverings Res/Textile	Vinyl Sheet						
B00G - R0006 - Staff Shower/Change - 3.85 m2							
Wall Linings Internal	Flat AC Sheeting	14m2	Throughout	Good Condition (1)	Low (1)	Low Priority (2-3)	Chrysotile (white asbestos)
Ceiling Structures/Linings	Flat AC Sheeting	4m2	Throughout	Good Condition (1)	Low (1)	Low Priority (2-3)	Chrysotile (white asbestos)
B00G - R0007 - Cleaning Supplies - .35 m2							
Ceiling Structures/Linings	Flat AC Sheeting	1m2	Throughout	Good Condition (1)	Low (1)	Low Priority (2-3)	Chrysotile (white asbestos)
B00G - R0008 - Principal - 14.53 m2							
Floor Coverings Res/Textile	Vinyl Sheet						
B00G - R0009 - Staff Room - 29.11 m2							
Floor Coverings Res/Textile	Vinyl Sheet						
B00G - R0010 - Staff Kitchen - 10.49 m2							
Wall Linings Internal	Flat AC Sheeting	20m2	Throughout	Good Condition (1)	Low (1)	Low Priority (2-3)	Chrysotile (white asbestos)
B00G - R0011 - Duplicating Workroom - 4.18 m2							
Wall Linings Internal	Flat AC Sheeting	10m2	Throughout	Good Condition (1)	Low (1)	Low Priority (2-3)	Chrysotile (white asbestos)
Ceiling Structures/Linings	Flat AC Sheeting	5m2	Throughout	Good Condition (1)	Low (1)	Low Priority (2-3)	Chrysotile (white asbestos)
B00G - R0012 - Security Store - 2.29 m2							
Wall Linings Internal	Flat AC Sheeting	8m2	Throughout	Good Condition (1)	Low (1)	Low Priority (2-3)	Chrysotile (white asbestos)
Ceiling Structures/Linings	Flat AC Sheeting	3m2	Throughout	Good Condition (1)	Low (1)	Low Priority (2-3)	Chrysotile (white asbestos)
B00G - R0013 - Movement - 2.23 m2							
Ceiling Structures/Linings	Flat AC Sheeting	3m2	Throughout	Good Condition (1)	Low (1)	Low Priority (2-3)	Chrysotile (white asbestos)
B00I - Pupil Facilities - 2008 - Brick/Veneer							
Exterior							
Ceiling Voids	No Asbestos Found						
Underfloor Voids - Slab on Ground	Non Accessible Area						
Interior							
B00I - R0001 - Raised Platform - 31.93 m2							
No Asbestos							
B00I - R0002 - Stairs - 1.44 m2							

No Asbestos							
B00I - R0003 - Covered Outdoor Learning Area - 153.7 m2							
No Asbestos							
B00J - Pupil Facilities/Multi Purpose Facilities - 2010 - Brick/Veneer							
Exterior							
Ceiling Voids	No Asbestos Found						
Underfloor Voids - Slab on Ground	Non Accessible Area						
Interior							
B00J - R0001 - Communal Space - 146.63 m2							
No Asbestos							
B00J - R0002 - Raised Platform - 59.63 m2							
No Asbestos							
B00J - R0003 - Chair Storeroom - 9.55 m2							
No Asbestos							
B00J - R0004 - Communal/Performance Store - 9.55 m2							
No Asbestos							
B00J - R0005 - P.E Store - 13.12 m2							
No Asbestos							
B00J - R0006 - Toilet - Lobby - 2.29 m2							
No Asbestos							
B00J - R0007 - Toilets - Girls - 7.2 m2							
No Asbestos							
B00J - R0008 - Sound Cupboard - 2.02 m2							
No Asbestos							
B00J - R0009 - Toilet - Lobby - 3.3 m2							
No Asbestos							
B00J - R0010 - Toilets - Boys - 5.65 m2							
No Asbestos							
B00J - R0011 - Cleaning Distributed Store - 3.68 m2							
No Asbestos							
B00J - R0012 - Plant - 1.6 m2							
No Asbestos							
B00J - R0013 - Main Switch Board - 3.47 m2							
No Asbestos							
B00J - R0014 - Access Shower/Toilet/Change - 6.67 m2							
No Asbestos							
B00J - R0015 - Covered Outdoor Learning Area - 152.08 m2							
No Asbestos							
B00J - R0016 - Movement - 11.96 m2							
No Asbestos							
B00J - R0017 - Movement - 6.6 m2							
No Asbestos							
B00J - R0018 - Ramp - 12.65 m2							
No Asbestos							
B00J - R0019 - External Movement - 4.14 m2							
No Asbestos							
B00Z - Pupil Facilities - 1963 - Brick/Block							
Exterior							
Eaves Linings	Flat AC Sheeting	10m2	Throughout	Good Condition (1)	Low (1)	Low Priority (2-3)	Chrysotile (white asbestos)

Underfloor Voids - Slab on Ground	Non Accessible Area						
Ceiling Voids - Flat Roof	Non Accessible Area						
Interior							
B00Z - R0001 - External Movement - 4.89 m2							
No Asbestos							
B00Z - R0002 - Toilets - Girls - 18.08 m2							
Partition Walls (Cubicles)	Compressed AC Sheet						
Ceiling Structures/Linings	Flat AC Sheeting	19m2	Throughout	Good Condition (1)	Low (1)	Low Priority (2-3)	Chrysotile (white asbestos)
B00Z - R0003 - Toilets - Boys - 18.18 m2							
Partition Walls (Cubicles)	Compressed AC Sheet						
Ceiling Structures/Linings	Flat AC Sheeting	19m2	Throughout	Good Condition (1)	Low (1)	Low Priority (2-3)	Chrysotile (white asbestos)
B00Z - R0004 - External Movement - 4.96 m2							
No Asbestos							
B00Z - R0005 - External Movement - 31.13 m2							
No Asbestos							

Demountables

OS 602 12474 - Learning Unit - Standard With P.A.A. - Placement Date : 07-FEB-2014

Note: This refurbished demountable may have asbestos present in remnant mastic in window frames.

No Asbestos Found

OS 602 13853 - Learning Unit - Standard With P.A.A. - Placement Date : 30-DEC-2011

Note: This refurbished demountable may have asbestos present in remnant mastic in window frames.

No Asbestos Found

OS 601 14098 - Learning Unit - Standard/Withdrawal - Placement Date : 18-APR-2008

Exterior

Eaves Linings	Flat AC Sheeting	11.52m2	Assumed Asbestos
Landing	Compressed AC Sheet	1.2m2	Assumed Asbestos
Step Treads	Compressed AC Sheet	1.08m2	Assumed Asbestos

Interior

R1- Entry

End Wall Panel	Flat AC Sheeting	18m2	Assumed Asbestos
Ceiling Structures/Linings	Flat AC Sheeting	8m2	Assumed Asbestos

R2- General Learning Space

End Wall Panel	Flat AC Sheeting	18m2	Assumed Asbestos
Ceiling Structures/Linings	Flat AC Sheeting	55m2	Assumed Asbestos

R3- Store

Ceiling Structures/Linings	Flat AC Sheeting	10m2	Assumed Asbestos
----------------------------	------------------	------	------------------

OS 601 14314 - Learning Unit - Standard/Withdrawal - Placement Date : 04-JAN-2019

Exterior

Eaves Linings	Flat AC Sheeting	11.52m2	Assumed Asbestos
Landing	Compressed AC Sheet	1.2m2	Assumed Asbestos
Step Treads	Compressed AC Sheet	1.08m2	Assumed Asbestos

Interior

R1- Entry

End Wall Panel	Flat AC Sheeting	18m2	Assumed Asbestos
Ceiling Structures/Linings	Flat AC Sheeting	8m2	Assumed Asbestos

R2- General Learning Space

End Wall Panel	Flat AC Sheeting	18m2	Assumed Asbestos
Ceiling Structures/Linings	Flat AC Sheeting	55m2	Assumed Asbestos

R3- Store

Ceiling Structures/Linings	Flat AC Sheeting	10m2	Assumed Asbestos
----------------------------	------------------	------	------------------

OS 601 14333 - Learning Unit - Standard/Withdrawal - Placement Date : 30-JUN-1995

Exterior

Eaves Linings	Flat AC Sheeting	11.52m2	Assumed Asbestos
Landing	Compressed AC Sheet	1.2m2	Assumed Asbestos
Step Treads	Compressed AC Sheet	1.08m2	Assumed Asbestos

Interior

R1- Entry

End Wall Panel	Flat AC Sheeting	18m2	Assumed Asbestos
Ceiling Structures/Linings	Flat AC Sheeting	8m2	Assumed Asbestos

R2- General Learning Space

End Wall Panel	Flat AC Sheeting	18m2	Assumed Asbestos
Ceiling Structures/Linings	Flat AC Sheeting	55m2	Assumed Asbestos

R3- Store

Ceiling Structures/Linings	Flat AC Sheeting	10m2	Assumed Asbestos
----------------------------	------------------	------	------------------

OS 621 19388 - Learning Unit Single - PWD - Placement Date : 14-FEB-2019

Note: This refurbished demountable may have asbestos present in remnant mastic in window frames.

No Asbestos Found