

Asbestos Register

(Hazardous Materials and Risk Assessment)

School:	Kiama Public School (2293)
Region:	Southern NSW AMU
State Electorate:	Kiama
Local Government Area:	Kiama

Last Reviewed By:	Greencap 14-MAR-2017
Last Revised By:	

Historical Fibro In Grounds Investigations/Events	No
<p>No previous investigations have been recorded against the school. However, asbestos containing materials maybe present in grounds from time to time and caution must be exercised prior to any grounds disturbance.</p>	

2293 - Kiama Public School
Site Plan (12578)

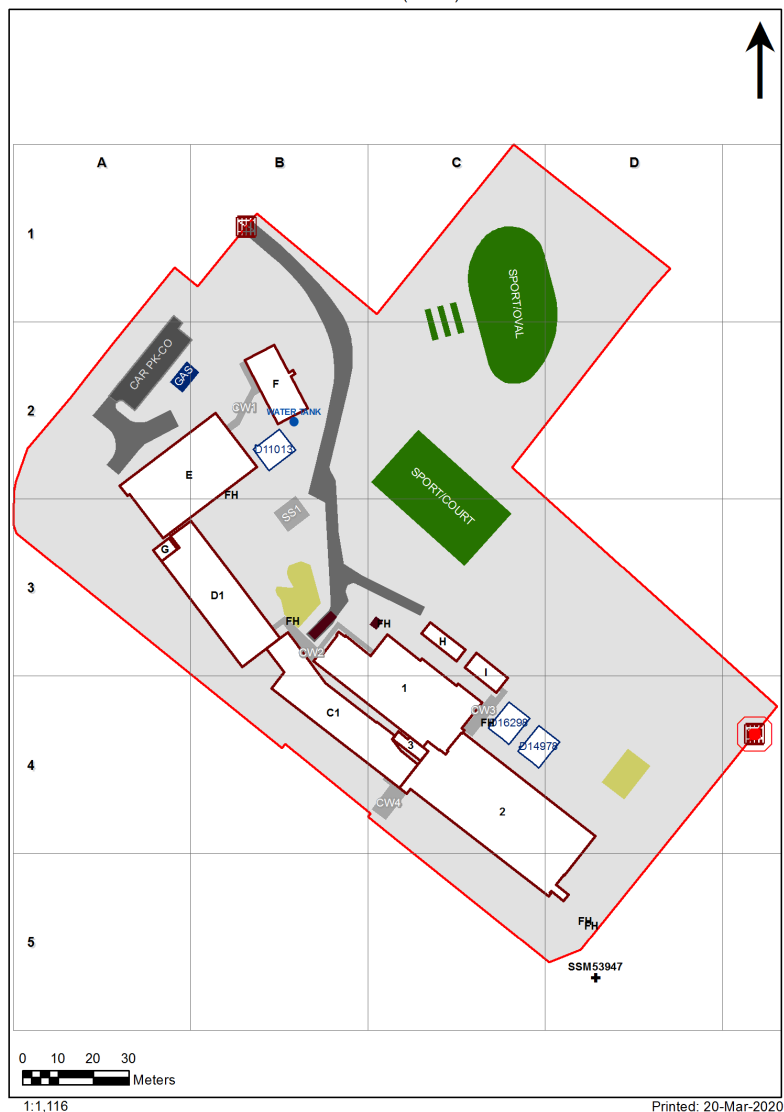

Preface to Asbestos Register

Limitations

Asbestos Registers established (first surveyed 2007/08) and maintained for the Department of Education (DoE) are limited in extent, in that:

1. All inspections and surveys of materials and finishes in DoE facilities are non-disturbance, with
2. Samples undertaken by hygienist to determine whether a sample is an Asbestos Containing Material (ACM),
3. The hygienist may apply a single sample to like materials within a space and adjoining spaces, but not normally between buildings,
4. Successive inspections have reduced any inconclusive records such as 'assumed asbestos' in difficult to access areas, by undertaking additional sampling with lifting devices.
5. In compliance with WHS Act 2011 and WHS Regulations 2017, additional inspections have been undertaken in ceiling spaces and sub-floor areas where access is possible.
 - o Where the ground floor is slab on ground, no inspection is made beneath the slab.
 - o Where fibro fragments (ACM taken for sampling) are located in ceiling spaces or sub floor voids air monitoring is normally undertaken at time of sampling, and clearance undertaken as soon as practicable.
6. No attempt has been made to identify any ACM that is hidden from view or encapsulated within
 - o Any wall cavity
 - o Sub floor area, particularly formwork for slabs in/on ground,
 - o Services (that may use ACM) such as: pipe lagging, asbestos cement pipes, flues.
7. All known ACM in Grounds (Fibro in Grounds) is made available in associated site specific asbestos management plans in DoE electronic files.
Notwithstanding information provided, ACM may be present in grounds from time to time and caution must be exercised prior to any grounds disturbance.

Use of the Asbestos Register

Prior to any disturbance works being undertaken in a building to which this asbestos register applies it will be necessary to confirm the extent of any ACM by a disturbance investigation:

- If the building was built prior to 2003
- If any ACM has been identified in the Asbestos Register for the building.

Update of Asbestos Registers

Asbestos Register Data is updated regularly by the DoE Hygienist Panel via the Online Asbestos Register Tool (Managed by Business Systems, School Infrastructure NSW). Internal users can view the latest edition of the Asbestos Register in the AMS.

Please note: The Department's external website may not contain the latest revision of the Asbestos Register.

Notes 1: Vermiculite

- During 2018/19, all vermiculite occurrences in DoE schools identified in 2007/08, were 'composite tested' in accordance with a safe work NSW agreed procedure. This required multiple testing of all vermiculite occurrences.
- During the period 2007/08 to 2018/19, some vermiculite has been over sheeted and a warning is indicated for schools where this has happened.

Note 2: DoE website link for information is here:

<https://www.schoolinfrastructure.nsw.gov.au/about-us/working-with-us/schools-asbestos-register.html>

<https://education.nsw.gov.au/about-us/strategies-and-reports/our-reports-and-reviews/schools-asbestos-register>

Note 3: Material Condition Assessment

The material condition assessment descriptors from Section 3 of the Asbestos Management Plan (AMP) is extracted below. Please read the AMP in its entirety for further information.

3.3.2.1 Material condition assessment

The OART records the material condition of identified ACM in the following format:

Rating	Description
Good condition (1)	For non-friable asbestos that is sealed and has no visible damage. This primarily related to asbestos cement (AC) sheet and vinyl tiles
Minimal damage (2)	For non-friable asbestos that has a very small amount of damage, eg hairline cracks.
Some damage / unsealed (3)	For non-friable asbestos with significant breakage or several small areas where material has been damaged, revealing loose asbestos fibres. Non-friable asbestos that is unsealed.
Poor condition (4)	For non-friable asbestos that has extensive damage. Visible asbestos debris
Friable asbestos (5)	Any occurrence of friable asbestos

Product	Material Description	Extent	Location	Material Condition	Risk Status	Remediation Priority	Result
B001 - General Learning/Pupil Facilities - 1968 - Brick/Block							
Exterior							
Ceiling Voids - Flat Roof	No Asbestos Found						
Underfloor Voids - Slab on Ground	No Asbestos Found						
Eaves Linings	Flat AC Sheeting						
Interior							
B001 - R0019 - External Movement - 85.05 m2							
Ceiling Structures/Linings	Flat AC Sheeting						
B001 - R0020 - Home Base Store - 7.52 m2							
No Asbestos							
B001 - R0021 - Practical Activities/Movement - 1hb - 18.8 m2							
No Asbestos							
B001 - R0022 - Home Base - 50.8 m2							
No Asbestos							
B001 - R0023 - Withdrawal Space - 2hb - 12.07 m2							
No Asbestos							
B001 - R0024 - Home Base - 50.8 m2							
No Asbestos							
B001 - R0025 - Practical Activities/Movement - 1hb - 18.86 m2							
No Asbestos							
B001 - R0026 - Home Base Store - 7.36 m2							
No Asbestos							
B001 - R0027 - Home Base Store - 7.37 m2							
No Asbestos							
B001 - R0028 - Practical Activities/Movement - 1hb - 18.9 m2							
No Asbestos							
B001 - R0029 - Distribution Board - .73 m2							
No Asbestos							Note: No inspection of live electrical installation
B001 - R0030 - Home Base - 51.09 m2							
No Asbestos							
B001 - R0031 - Withdrawal Space - 2hb - 11.74 m2							
No Asbestos							
B001 - R0032 - Practical Activities/Movement - 1hb - 19.52 m2							
No Asbestos							
B001 - R0033 - Home Base - 51.4 m2							
No Asbestos							
B001 - R0034 - Home Base Store - 7.29 m2							
No Asbestos							
B001 - R9004 - Home Base - 55.85 m2							
Wall Linings Internal	Flat AC Sheeting						
B001 - R9005 - Plant - 11.05 m2							
No Asbestos							
B001 - R9006 - Cleaning Distributed Store - 1.37 m2							
No Asbestos							
B001 - R9009 - Toilets - Boys - 29.29 m2							
No Asbestos							
B001 - R9011 - Practical Activities - 17.28 m2							
Wall Linings Internal	Flat AC Sheeting						
B001 - R9012 - Home Base Store - 17.28 m2							
Wall Linings Internal	Flat AC Sheeting						

B001 - R9013 - Toilets - Girls - 27.79 m2		
No Asbestos		
B001 - R9014 - External Movement - 280.96 m2		
No Asbestos		
B002 - General Learning/Pupil Facilities - 1968 - Brick/Block		
Exterior		
Ceiling Voids - Flat Roof	No Asbestos Found	
Underfloor Voids - Slab on Ground	No Asbestos Found	
Eaves Linings	Flat AC Sheeting	
External Wall Structure - Awnings	Flat AC Sheeting	
External Roof Structure	Compressed AC Sheet	
Interior		
B002 - R0012 - Staff Toilet - 5.13 m2		
Wall Linings Internal	Flat AC Sheeting	
B002 - R0013 - Staff Toilet - 5.03 m2		
Wall Linings Internal	Flat AC Sheeting	
B002 - R0024 - External Movement - 8.2 m2		
Ceiling Structures/Linings	Flat AC Sheeting	
B002 - R0025 - Movement - 2.57 m2		
Ceiling Structures/Linings	Flat AC Sheeting	
B002 - R0026 - Practical Activities/Movement - 1hb - 19.19 m2		
No Asbestos		
B002 - R0027 - Home Base Store - 7.19 m2		
No Asbestos		
B002 - R0028 - Home Base - 50.63 m2		
No Asbestos		
B002 - R0029 - Withdrawal Space - 2hb - 12.19 m2		
No Asbestos		
B002 - R0030 - Home Base - 50.68 m2		
No Asbestos		
B002 - R0031 - Practical Activities/Movement - 1hb - 19.29 m2		
No Asbestos		
B002 - R0032 - Home Base Store - 7.19 m2		
No Asbestos		
B002 - R0033 - Interview - 14.96 m2		
No Asbestos		
B002 - R0034 - Distribution Board - 1.22 m2		
No Asbestos		
B002 - R0035 - Practical Activities/Movement - 1hb - 19.13 m2		
No Asbestos		
B002 - R0036 - Home Base Store - 7.55 m2		
No Asbestos		
B002 - R0037 - Home Base - 50.68 m2		
No Asbestos		
B002 - R0038 - Withdrawal Space - 2hb - 12.11 m2		
No Asbestos		
B002 - R0039 - Home Base - 55.45 m2		
No Asbestos		
B002 - R0040 - Practical Activities/Movement - 1hb - 21.33 m2		
No Asbestos		
B002 - R0041 - Home Base Store - 7.39 m2		

Note: No inspection of live electrical installation

No Asbestos		
B002 - R0042 - Stairs - 8.61 m2		
Ceiling Structures/Linings	Flat AC Sheeting	
B002 - R0044 - External Movement - 164.45 m2		
No Asbestos		
B002 - R9001 - Cleaning Distributed Store - 11.21 m2		
No Asbestos		
B002 - R9006 - Kiln Room - 10.59 m2		
No Asbestos		
B002 - R9010 - Movement - 112.9 m2		
Ceiling Structures/Linings	Flat AC Sheeting	
B002 - R9011 - Sports Store - 5.47 m2		
No Asbestos		
B002 - R9012 - Special Programs Store - 15.21 m2		
No Asbestos		
B002 - R9013 - Special Programs Room - 45.49 m2		
No Asbestos		
B002 - R9014 - Plant - 23.24 m2		
No Asbestos		
B002 - R9015 - Toilets - Girls - 26.87 m2		
No Asbestos		
B002 - R9016 - Toilets - Boys - 30.93 m2		
No Asbestos		
B002 - R9017 - Movement - 2.48 m2		
No Asbestos		
B002 - R9018 - Stairs - 5.85 m2		
No Asbestos		
B002 - R9019 - Covered Outdoor Learning Area - 482.61 m2		
No Asbestos		
B003 - Library/General Learning - 1871 - Brick/Block		
Exterior		
Ceiling Voids - Flat Roof	No Asbestos Found	
Underfloor Voids - Slab on Ground	No Asbestos Found	
External Roof Structure	Compressed AC Sheet	
Eaves Linings	Flat AC Sheeting	
Interior		
B003 - R0008 - Stairs - 16.81 m2		
Ceiling Structures/Linings	Flat AC Sheeting	
B003 - R9001 - Garden Store - 4.57 m2		
No Asbestos		
B003 - R9002 - General Assistant/Bulk Store - 5.95 m2		
No Asbestos		
B003 - R9004 - Stairs - 10 m2		
No Asbestos		
B003 - R9005 - Movement - 2.15 m2		
No Asbestos		
B00E - Communal Facilities/Pupil Facilities - 2000 - Brick/Veneer		
Exterior		
Underfloor Voids - Slab on Ground	No Asbestos Found	
Ceiling Voids	No Asbestos Found	
Interior		

B00E - R0001 - Covered Outdoor Learning Area - 254.74 m2		
No Asbestos		
B00E - R0002 - Communal Space - 145.43 m2		
No Asbestos		
B00E - R0003 - Movement - 24.77 m2		
No Asbestos		
B00E - R0004 - Raised Platform - 49.37 m2		
No Asbestos		
B00E - R0005 - Movement - 10.78 m2		
No Asbestos		
B00E - R0006 - External Movement - 7.2 m2		
No Asbestos		
B00E - R0007 - Toilets - Girls - 9.82 m2		
No Asbestos		
B00E - R0008 - Hall Chair Store - 8.69 m2		
No Asbestos		
B00E - R0009 - Distribution Board - .55 m2		Note: No inspection of live electrical installation
No Asbestos		
B00E - R0010 - P.E Store - 11.75 m2		
No Asbestos		
B00E - R0011 - Garden Store - 8.37 m2		
No Asbestos		
B00E - R0012 - Cleaning Distributed Store - 2.7 m2		
No Asbestos		
B00E - R0013 - Communications Cupboard - .71 m2		
No Asbestos		
B00E - R0014 - Toilets - Boys - 8.18 m2		
No Asbestos		
B00E - R0015 - Disabled Toilet - 4.76 m2		
No Asbestos		
B00E - R0016 - Distribution Board - 1.13 m2		Note: No inspection of live electrical installation
No Asbestos		
B00E - R0017 - Cleaning Supplies - 7.58 m2		
No Asbestos		
B00E - R0018 - Canteen Office/Store - 9.97 m2		
No Asbestos		
B00E - R0019 - Canteen - 25.84 m2		
No Asbestos		
B00F - General Learning - 2001 - Timber		
Exterior		
Underfloor Voids - Slab on Ground	No Asbestos Found	
Ceiling Voids	No Asbestos Found	
Interior		
B00F - R0001 - Home Base Store - 6.97 m2		
No Asbestos		
B00F - R0002 - Home Base Store - 15.44 m2		
No Asbestos		
B00F - R0003 - External Movement - 24.78 m2		
No Asbestos		
B00F - R0004 - Special Programs Room - 11.95 m2		
No Asbestos		

B00F - R0005 - Staff Kitchen - 22.74 m2		
No Asbestos		
B00F - R0006 - Withdrawal Space - 1hb - 8.38 m2		
No Asbestos		
B00F - R0007 - Home Base Store - 10.45 m2		
No Asbestos		
B00F - R0008 - Practical Activities/Movement - 1hb - 21 m2		
No Asbestos		
B00F - R0009 - Home Base - 54.75 m2		
No Asbestos		
B00F - R0010 - External Movement - 1.15 m2		
No Asbestos		
B00G - Sports Store - 2009 - Metal Shed		
Exterior		
Underfloor Voids - Slab on Ground	No Asbestos Found	
Ceiling Voids	No Asbestos Found	
Interior		
B00G - R0001 - P.E Store - 20.3 m2		
No Asbestos		
B00H - Building Services - 2011 - Brick/Veneer		
Exterior		
Underfloor Voids - Slab on Ground	No Asbestos Found	
Ceiling Voids	No Asbestos Found	
Interior		
B00H - R0001 - Sports Store - 14.78 m2		
No Asbestos		
B00H - R0002 - General Assistant/Bulk Store - 17.29 m2		
No Asbestos		
B00H - R0003 - Garden Store - 14.75 m2		
No Asbestos		
B00I - General Learning - 2011 - Brick/Veneer		
Exterior		
Underfloor Voids - Slab on Ground	No Asbestos Found	
Ceiling Voids	No Asbestos Found	
Interior		
B00I - R0001 - Special Programs Store - 5.88 m2		
No Asbestos		
B00I - R0002 - Special Programs Store - 5.85 m2		
No Asbestos		
B00I - R0003 - Special Programs Room - 38.14 m2		
No Asbestos		
B0C1 - Administration/Library - 1999 - Brick/Veneer		
Exterior		
Wall Cladding	Compressed AC Sheet	
Ceiling Voids	No Asbestos Found	
Underfloor Voids - Slab on Ground	No Asbestos Found	
Interior		
B0C1 - R0001 - External Movement - 140.19 m2		
No Asbestos		
B0C1 - R0002 - External Stairs - 13.71 m2		

No Asbestos		
B0C1 - R0003 - Entry Vestibule - 18.6 m2		
Floor Coverings Res/Textile	No Asbestos Found	
B0C1 - R0004 - Clerical Office - 24.65 m2		
Floor Coverings Res/Textile	No Asbestos Found	
B0C1 - R0005 - Sick Bay - 10.63 m2		
No Asbestos		
B0C1 - R0006 - Disabled Toilet - 4.88 m2		
No Asbestos		
B0C1 - R0007 - Cleaning Distributed Store - 3.85 m2		
No Asbestos		
B0C1 - R0008 - Staff Toilet - 3.71 m2		
No Asbestos		
B0C1 - R0009 - Staff Toilet - 3.71 m2		
No Asbestos		
B0C1 - R0010 - Staff Toilet - 3.71 m2		
No Asbestos		
B0C1 - R0011 - General Storeroom - 15.85 m2		
No Asbestos		
B0C1 - R0012 - Staff Room Annexe - 19.68 m2		
Floor Coverings Res/Textile	No Asbestos Found	
B0C1 - R0013 - Staff Room - 51.06 m2		
Floor Coverings Res/Textile	No Asbestos Found	
B0C1 - R0014 - Movement - 43.87 m2		
Floor Coverings Res/Textile	No Asbestos Found	
B0C1 - R0015 - Interview - 11.17 m2		
Floor Coverings Res/Textile	No Asbestos Found	
B0C1 - R0016 - Deputy Principal - 15.13 m2		
Floor Coverings Res/Textile	No Asbestos Found	
B0C1 - R0017 - Deputy Principal - 13.29 m2		
Floor Coverings Res/Textile	No Asbestos Found	
B0C1 - R0018 - Principal - 17.95 m2		
Floor Coverings Res/Textile	No Asbestos Found	
B0C1 - R0019 - Duplicating Workroom - 23 m2		
No Asbestos		
B0C1 - R0020 - Distribution Board - .63 m2		
		Note: No inspection of live electrical installation
No Asbestos		
B0C1 - R0021 - Lift - 2.5 m2		
No Asbestos		
B0C1 - R0022 - External Stairs - 12.71 m2		
No Asbestos		
B0C1 - R0023 - External Movement - 16.51 m2		
No Asbestos		
B0C1 - R1001 - External Movement - 140.12 m2		
No Asbestos		
B0C1 - R1002 - Reading Area - 190.11 m2		
Floor Coverings Res/Textile	No Asbestos Found	
B0C1 - R1003 - Communications Room - 17.55 m2		
Floor Coverings Res/Textile	No Asbestos Found	
B0C1 - R1004 - Library Office/Workroom - 25.56 m2		
Floor Coverings Res/Textile	No Asbestos Found	
B0C1 - R1005 - K.L.A. Store - 6.75 m2		

Floor Coverings Res/Textile	No Asbestos Found	
B0C1 - R1006 - Distribution Board - .54 m2		Note: No inspection of live electrical installation
No Asbestos		
B0C1 - R1007 - Cleaning Distributed Store - 3.93 m2		
No Asbestos		
B0C1 - R1008 - Special Programs Room - 39.15 m2		
Floor Coverings Res/Textile	No Asbestos Found	
B0C1 - R1009 - General Storeroom - 4.93 m2		
Floor Coverings Res/Textile	No Asbestos Found	
B0C1 - R1010 - Disabled Toilet - 4.88 m2		
No Asbestos		
B0C1 - R1011 - Lift - 2.5 m2		
No Asbestos		
B0C1 - R1012 - External Stairs - 11.85 m2		
No Asbestos		
B0C1 - R1013 - External Movement - 10.02 m2		
No Asbestos		
B0C1 - R1014 - External Stairs - 13.63 m2		
No Asbestos		
B0C1 - R9001 - Movement - 19 m2		
No Asbestos		
B0C1 - R9002 - Plant - 8.43 m2		
No Asbestos		
B0C1 - R9003 - Lift - 2.5 m2		
No Asbestos		
B0C1 - R9004 - General Storeroom - 17.67 m2		
No Asbestos		
B0D1 - General Learning - 1999 - Brick/Veneer		
Exterior		
Underfloor Voids - Slab on Ground	No Asbestos Found	
Wall Cladding	Compressed AC Sheet	
Ceiling Voids	No Asbestos Found	
Interior		
B0D1 - R0001 - External Movement - 85.17 m2		
No Asbestos		
B0D1 - R0002 - Main Switch Board - 2.64 m2		
No Asbestos		
B0D1 - R0003 - Personal Effects Storage - 1.76 m2		
No Asbestos		
B0D1 - R0004 - Practical Activities - 1hb - 19.55 m2		
No Asbestos		
B0D1 - R0005 - Home Base Store - 7.21 m2		
No Asbestos		
B0D1 - R0006 - Home Base - 58.67 m2		
Floor Coverings Res/Textile	No Asbestos Found	
B0D1 - R0007 - Withdrawal Space - 1hb - 11.16 m2		
Floor Coverings Res/Textile	No Asbestos Found	
B0D1 - R0008 - Home Base - 58.45 m2		
Floor Coverings Res/Textile	No Asbestos Found	
B0D1 - R0009 - Home Base Store - 10.82 m2		
No Asbestos		

B0D1 - R0010 - Practical Activities - 1hb - 19.07 m2		
No Asbestos		
B0D1 - R0011 - Personal Effects Storage - 1.81 m2		
No Asbestos		
B0D1 - R0012 - Distribution Board - .69 m2		Note: No inspection of live electrical installation
No Asbestos		
B0D1 - R0013 - Personal Effects Storage - 1.75 m2		
No Asbestos		
B0D1 - R0014 - Practical Activities - 1hb - 19.12 m2		
No Asbestos		
B0D1 - R0015 - Home Base Store - 10.59 m2		
No Asbestos		
B0D1 - R0016 - Home Base - 58.29 m2		
Floor Coverings Res/Textile	No Asbestos Found	
B0D1 - R0017 - Withdrawal Space - 1hb - 11.16 m2		
Floor Coverings Res/Textile	No Asbestos Found	
B0D1 - R0018 - Home Base - 58.28 m2		
Floor Coverings Res/Textile	No Asbestos Found	
B0D1 - R0019 - Home Base Store - 10.69 m2		
No Asbestos		
B0D1 - R0020 - Practical Activities - 1hb - 19.22 m2		
No Asbestos		
B0D1 - R0021 - Personal Effects Storage - 1.73 m2		
No Asbestos		
B0D1 - R0022 - Cleaning Distributed Store - 4.3 m2		
No Asbestos		
B0D1 - R0023 - External Stairs - 11.73 m2		
No Asbestos		
B0D1 - R1001 - External Movement - 84.83 m2		
No Asbestos		
B0D1 - R1002 - Personal Effects Storage - 1.79 m2		
No Asbestos		
B0D1 - R1003 - Practical Activities - 1hb - 20.47 m2		
No Asbestos		
B0D1 - R1004 - Home Base Store - 10.53 m2		
No Asbestos		
B0D1 - R1005 - Home Base - 57.75 m2		
Floor Coverings Res/Textile	No Asbestos Found	
B0D1 - R1006 - Withdrawal Space - 1hb - 11.24 m2		
Floor Coverings Res/Textile	No Asbestos Found	
B0D1 - R1007 - Personal Effects Storage - 1.76 m2		
No Asbestos		
B0D1 - R1008 - Practical Activities - 1hb - 19.8 m2		
No Asbestos		
B0D1 - R1009 - Home Base - 57.91 m2		
Floor Coverings Res/Textile	No Asbestos Found	
B0D1 - R1010 - Home Base Store - 9.53 m2		
Floor Coverings Res/Textile	No Asbestos Found	
B0D1 - R1011 - Distribution Board - .6 m2		Note: No inspection of live electrical installation
No Asbestos		
B0D1 - R1012 - Personal Effects Storage - 1.78 m2		
No Asbestos		

B0D1 - R1013 - Practical Activities - 1hb - 19.86 m2	
No Asbestos	
B0D1 - R1014 - Cleaning Distributed Store - 2 m2	
No Asbestos	
B0D1 - R1015 - Home Base Store - 10.23 m2	
No Asbestos	
B0D1 - R1016 - Home Base - 57.3 m2	
Floor Coverings Res/Textile	No Asbestos Found
B0D1 - R1017 - Withdrawal Space - 1hb - 11.28 m2	
Floor Coverings Res/Textile	No Asbestos Found
B0D1 - R1018 - Home Base - 58.13 m2	
Floor Coverings Res/Textile	No Asbestos Found
B0D1 - R1019 - Home Base Store - 10.41 m2	
Floor Coverings Res/Textile	No Asbestos Found
B0D1 - R1020 - Practical Activities - 1hb - 20.43 m2	
No Asbestos	
B0D1 - R1021 - Personal Effects Storage - 1.78 m2	
No Asbestos	
B0D1 - R1022 - External Stairs - 17.92 m2	
No Asbestos	

Demountables

OS 602 11013 - Learning Unit - Standard With P.A.A. - Placement Date : 06-MAY-2017

Note: This refurbished demountable may have asbestos present in remnant mastic in window frames.

No Asbestos Found

OS 602 14978 - Learning Unit - Standard With P.A.A. - Placement Date : 16-NOV-2017

Note: This refurbished demountable may have asbestos present in remnant mastic in window frames.

No Asbestos Found

OS 602 16298 - Learning Unit - Standard With P.A.A. - Placement Date : 12-MAR-2015

No Asbestos Found