

# Asbestos Register

(Hazardous Materials and Risk Assessment)

School:	Karangı Public School (2260)
Region:	North Coast AMU
State Electorate:	Coffs Harbour
Local Government Area:	Coffs Harbour

Last Reviewed By:	Greencap 05-MAY-2016
Last Revised By:	

Historical Fibro In Grounds Investigations/Events	<b>Yes</b>
Please refer to the latest site specific Asbestos Management Plans available from the Department's website (Refer to Note 2).	

2260 - Karangı Public School  
Site Plan (12961)

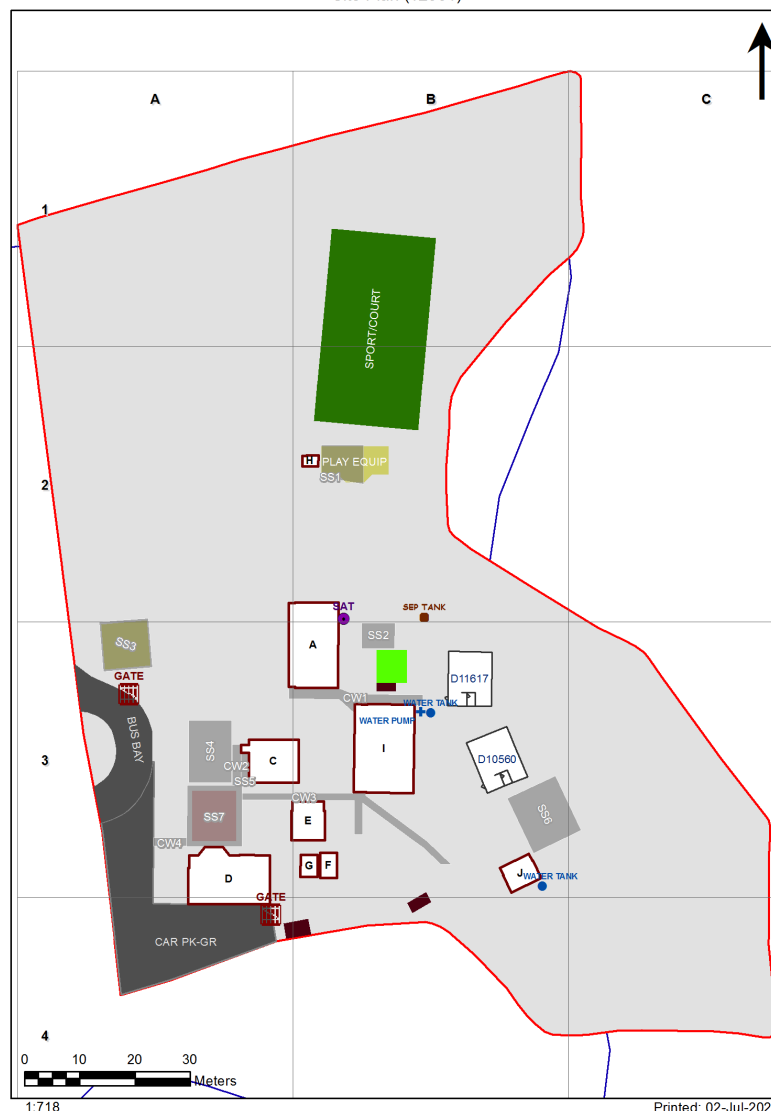

# Preface to Asbestos Register

## Limitations

Asbestos Registers established (first surveyed 2007/08) and maintained for the Department of Education (DoE) are limited in extent, in that:

1. All inspections and surveys of materials and finishes in DoE facilities are non-disturbance, with
2. Samples undertaken by hygienist to determine whether a sample is an Asbestos Containing Material (ACM),
3. The hygienist may apply a single sample to like materials within a space and adjoining spaces, but not normally between buildings,
4. Successive inspections have reduced any inconclusive records such as 'assumed asbestos' in difficult to access areas, by undertaking additional sampling with lifting devices.
5. In compliance with WHS Act 2011 and WHS Regulations 2017, additional inspections have been undertaken in ceiling spaces and sub-floor areas where access is possible.
  - o Where the ground floor is slab on ground, no inspection is made beneath the slab.
  - o Where fibro fragments (ACM taken for sampling) are located in ceiling spaces or sub floor voids air monitoring is normally undertaken at time of sampling, and clearance undertaken as soon as practicable.
6. No attempt has been made to identify any ACM that is hidden from view or encapsulated within
  - o Any wall cavity
  - o Sub floor area, particularly formwork for slabs in/on ground,
  - o Services (that may use ACM) such as: pipe lagging, asbestos cement pipes, flues.
7. All known ACM in Grounds (Fibro in Grounds) is made available in associated site specific asbestos management plans in DoE electronic files.  
Notwithstanding information provided, ACM may be present in grounds from time to time and caution must be exercised prior to any grounds disturbance.

## Use of the Asbestos Register

Prior to any disturbance works being undertaken in a building to which this asbestos register applies it will be necessary to confirm the extent of any ACM by a disturbance investigation:

- If the building was built prior to 2003
- If any ACM has been identified in the Asbestos Register for the building.

## Update of Asbestos Registers

Asbestos Register Data is updated regularly by the DoE Hygienist Panel via the Online Asbestos Register Tool (Managed by Business Systems, School Infrastructure NSW). Internal users can view the latest edition of the Asbestos Register in the AMS.

Please note: The Department's external website may not contain the latest revision of the Asbestos Register.

### Notes 1: Vermiculite

- During 2018/19, all vermiculite occurrences in DoE schools identified in 2007/08, were 'composite tested' in accordance with a safe work NSW agreed procedure. This required multiple testing of all vermiculite occurrences.
- During the period 2007/08 to 2018/19, some vermiculite has been over sheeted and a warning is indicated for schools where this has happened.

### Note 2: DoE website link for information is here:

<https://www.schoolinfrastructure.nsw.gov.au/about-us/working-with-us/schools-asbestos-register.html>  
<https://education.nsw.gov.au/about-us/strategies-and-reports/our-reports-and-reviews/schools-asbestos-register>

### Note 3: Material Condition Assessment

The material condition assessment descriptors from Section 3 of the Asbestos Management Plan (AMP) is extracted below. Please read the AMP in its entirety for further information.

#### 3.3.2.1 Material condition assessment

The OART records the material condition of identified ACM in the following format:

Rating	Description
Good condition (1)	For non-friable asbestos that is sealed and has no visible damage. This primarily related to asbestos cement (AC) sheet and vinyl tiles
Minimal damage (2)	For non-friable asbestos that has a very small amount of damage, eg hairline cracks.
Some damage / unsealed (3)	For non-friable asbestos with significant breakage or several small areas where material has been damaged, revealing loose asbestos fibres. Non-friable asbestos that is unsealed.
Poor condition (4)	For non-friable asbestos that has extensive damage. Visible asbestos debris
Friable asbestos (5)	Any occurrence of friable asbestos

Product	Material Description	Extent	Location	Material Condition	Risk Status	Remediation Priority	Result
<b>B00A - Administration - 1986 - Brick/Veneer</b>							
<b>Exterior</b>							
Eaves Linings	Flat AC Sheeting						
Wall Linings Internal - Infill	Flat AC Sheeting						
Ceiling Voids	No Asbestos Found						
Underfloor Voids	No Asbestos Found						
<b>Interior</b>							
<b>B00A - R0011 - External Movement - 16.82 m2</b>							
Ceiling Structures/Linings	Flat AC Sheeting						
<b>B00A - R0012 - Staff Room - 34.4 m2</b>							
Wall Linings Internal	Flat AC Sheeting						
<b>B00A - R0013 - Staff Kitchen - 11.93 m2</b>							
No Asbestos							
<b>B00A - R0014 - Sick Bay - 7.42 m2</b>							
No Asbestos							
<b>B00A - R0015 - Entry Vestibule - 7.29 m2</b>							
No Asbestos							
<b>B00A - R0016 - Movement - 5.78 m2</b>							
No Asbestos							
<b>B00A - R0017 - Staff Toilet - 1.91 m2</b>							
No Asbestos							
<b>B00A - R0018 - Staff Shower/Change - 3.1 m2</b>							
Wall Linings Internal	Flat AC Sheeting						
<b>B00A - R0019 - Movement - 2.56 m2</b>							
No Asbestos							
<b>B00A - R0020 - Clerical Office - 23.67 m2</b>							
No Asbestos							
<b>B00A - R0021 - Movement - 10.16 m2</b>							
No Asbestos							
<b>B00C - General Learning - 1955 - Timber</b>							
<b>Exterior</b>							
Ceiling Voids - Raked Ceiling	No Asbestos Found						
Eaves Linings	Flat AC Sheeting	15m2	East West	Good Condition (1)	Low (1)	Low Priority (2-3)	Chrysotile (white asbestos)
Underfloor Voids	No Asbestos Found						
<b>Interior</b>							
<b>B00C - R0001 - Personal Effects Storage - 4.81 m2</b>							
Wall Linings Internal	Flat AC Sheeting						
<b>B00C - R0002 - Withdrawal Space - 1hb - 12.99 m2</b>							
Wall Linings Internal	Flat AC Sheeting						
<b>B00C - R0003 - Special Programs Room - 30.56 m2</b>							
No Asbestos							
<b>B00C - R0004 - Practical Activities - 1hb - 14.67 m2</b>							
Floor Coverings Res/Textile	Vinyl Tiles						
<b>B00C - R0005 - External Movement - 2.04 m2</b>							
No Asbestos							

## B00D - Administration/General Learning - 1919 - Timber

### Exterior

Ceiling Voids - Flat Roof	Non Accessible Area						
Eaves Linings	Flat AC Sheeting	40m2	Throughout	Good Condition (1)	Low (1)	Low Priority (2-3)	Chrysotile (white asbestos)
Underfloor Voids	No Asbestos Found						

### Interior

#### B00D - R0003 - External Movement - 27.49 m2

Ceiling Structures/Linings	Flat AC Sheeting	28m2	Throughout	Good Condition (1)	Low (1)	Low Priority (2-3)	Chrysotile (white asbestos)
----------------------------	------------------	------	------------	--------------------	---------	--------------------	-----------------------------

#### B00D - R0004 - Clerical Office - 11.92 m2

Wall Linings Internal	Flat AC Sheeting	35m2	Throughout	Good Condition (1)	Low (1)	Low Priority (2-3)	Chrysotile (white asbestos)
-----------------------	------------------	------	------------	--------------------	---------	--------------------	-----------------------------

#### B00D - R0006 - Staff Kitchen - 5.57 m2

Wall Linings Internal	Flat AC Sheeting	35m2	Throughout	Good Condition (1)	Low (1)	Low Priority (2-3)	Chrysotile (white asbestos)
-----------------------	------------------	------	------------	--------------------	---------	--------------------	-----------------------------

#### B00D - R0007 - General Storeroom - 7.18 m2

Floor Coverings Res/Textile	Vinyl Tiles	8m2	Throughout	Good Condition (1)	Low (1)	Low Priority (2-3)	Chrysotile (white asbestos)
Wall Linings Internal	Flat AC Sheeting	25m2	Throughout	Good Condition (1)	Low (1)	Low Priority (2-3)	Chrysotile (white asbestos)
Floor Coverings Res/Textile	Vinyl Tiles - Adhesive						

#### B00D - R0008 - Home Base - 76.54 m2

Wall Linings Internal	Flat AC Sheeting	100m2	Throughout	Good Condition (1)	Low (1)	Low Priority (2-3)	Chrysotile (white asbestos)
Floor Coverings Res/Textile	Vinyl Tiles	77m2	Throughout	Good Condition (1)	Low (1)	Low Priority (2-3)	Chrysotile (white asbestos)
Floor Coverings Res/Textile	Vinyl Tiles - Adhesive						

## B00E - Pupil Facilities - 1970 - Brick/Block

### Exterior

Ceiling Voids - Flat Roof	Non Accessible Area						
Underfloor Voids - Slab on Ground	No Asbestos Found						
Eaves Linings	Flat AC Sheeting	35m2	Throughout	Good Condition (1)	Low (1)	Low Priority (2-3)	Chrysotile (white asbestos) , Amosite (brown asbestos)
Plumbing / Pipework	Fibre Cement Pipe	3	South	Good Condition (1)	Low (1)	Low Priority (2-3)	Chrysotile (white asbestos) , Amosite (brown asbestos)

### Interior

#### B00E - R0001 - Drinking Facilities - 4.68 m2

Ceiling Structures/Linings	Flat AC Sheeting	5m2	Throughout	Good Condition (1)	Low (1)	Low Priority (2-3)	Chrysotile (white asbestos) , Amosite (brown asbestos)
----------------------------	------------------	-----	------------	--------------------	---------	--------------------	--

#### B00E - R0002 - Toilets - Boys - 12.39 m2

Ceiling Structures/Linings	Flat AC Sheeting	13m2	Throughout	Good Condition (1)	Low (1)	Low Priority (2-3)	Chrysotile (white asbestos) , Amosite (brown asbestos)
Partition Walls (Cubicles)	Compressed AC Sheet	1m2	South	Good Condition (1)	Low (1)	Low Priority (2-3)	Chrysotile (white asbestos)

#### B00E - R0003 - Drinking Facilities - 4.68 m2

Ceiling Structures/Linings	Flat AC Sheeting	5m2	Throughout	Good Condition (1)	Low (1)	Low Priority (2-3)	Chrysotile (white asbestos) , Amosite (brown asbestos)
----------------------------	------------------	-----	------------	--------------------	---------	--------------------	--

#### B00E - R0004 - Toilets - Girls - 9.07 m2

Ceiling Structures/Linings	Flat AC Sheeting	10m2	Throughout	Good Condition (1)	Low (1)	Low Priority (2-3)	Chrysotile (white asbestos) , Amosite (brown asbestos)
----------------------------	------------------	------	------------	--------------------	---------	--------------------	--

Partition Walls (Cubicles)	Compressed AC Sheet	5m2	South	Good Condition (1)	Low (1)	Low Priority (2-3)	Chrysotile (white asbestos)
<b>B00E - R0005 - Toilets - Boys/Girls - 1.88 m2</b>							
Ceiling Structures/Linings	Flat AC Sheeting	2m2	Throughout	Good Condition (1)	Low (1)	Low Priority (2-3)	Chrysotile (white asbestos) , Amosite (brown asbestos)
<b>B00E - R0006 - Toilets - Boys/Girls - 1.68 m2</b>							
Ceiling Structures/Linings	Flat AC Sheeting	2m2	Throughout	Good Condition (1)	Low (1)	Low Priority (2-3)	Chrysotile (white asbestos) , Amosite (brown asbestos)
<b>B00F - Shed - 1986 - Metal Shed</b>							
<b>Exterior</b>							
Ceiling Voids	No Asbestos Found						
Underfloor Voids	No Asbestos Found						
<b>Interior</b>							
<b>B00F - R0001 - Sports Store - 13.45 m2</b>							
No Asbestos							
<b>B00G - Shed - 2004 - Metal Shed</b>							
<b>Exterior</b>							
Underfloor Voids - Slab on Ground	No Asbestos Found						
Ceiling Voids	No Asbestos Found						
<b>Interior</b>							
<b>B00G - R0001 - Sports Store - 11.9 m2</b>							
No Asbestos							
<b>B00H - Building Services - 2003 - Timber</b>							
<b>Exterior</b>							
Underfloor Voids - Slab on Ground	No Asbestos Found						
Ceiling Voids	No Asbestos Found						
<b>Interior</b>							
<b>B00H - R0001 - Plant - 3.71 m2</b>							
No Asbestos							
<b>B00H - R0002 - External Movement - 1.52 m2</b>							
No Asbestos							
<b>B00I - Library - 2010 - Fibre Cement Clad</b>							
<b>Exterior</b>							
Ceiling Voids	No Asbestos Found						
Underfloor Voids	No Asbestos Found						
<b>Interior</b>							
<b>B00I - R0001 - Reading Area - 91.74 m2</b>							
No Asbestos							
<b>B00I - R0002 - Library Office/Workroom - 20.39 m2</b>							
No Asbestos							
<b>B00I - R0003 - Communications Room - 7.21 m2</b>							
No Asbestos							
<b>B00I - R0004 - K.L.A. Store - 7.56 m2</b>							
No Asbestos							
<b>B00I - R0005 - External Movement - 35.3 m2</b>							
No Asbestos							

## B00J - Pupil Facilities - 2014 - Steel

### Exterior

Underfloor Voids	No Asbestos Found	
Ceiling Voids	No Asbestos Found	
Underfloor Voids	No Asbestos Found	
Ceiling Voids	No Asbestos Found	

### Interior

#### B00J - R0001 - Canteen Covered Area - 8.4 m2

No Asbestos	
-------------	--

#### B00J - R0002 - Canteen - 19.64 m2

No Asbestos	
-------------	--

## Demountables

### OS 602 10560 - Learning Unit - Standard With P.A.A. - Placement Date : 26-MAR-2015

**Note:** This refurbished demountable may have asbestos present in remnant mastic in window frames.

No Asbestos Found

### OS 602 11617 - Learning Unit - Standard With P.A.A. - Placement Date : 28-JAN-2014

**Note:** This refurbished demountable may have asbestos present in remnant mastic in window frames.

No Asbestos Found