

Asbestos Register

(Hazardous Materials and Risk Assessment)

School:	James Fallon High School (8266)
Region:	Southern NSW AMU
State Electorate:	Albury
Local Government Area:	Albury

Last Reviewed By:	AECOM 29-OCT-2014
Last Revised By:	WSP 27-AUG-2020

Historical Fibro In Grounds Investigations/Events	No
<p>No previous investigations have been recorded against the school. However, asbestos containing materials maybe present in grounds from time to time and caution must be exercised prior to any grounds disturbance.</p>	

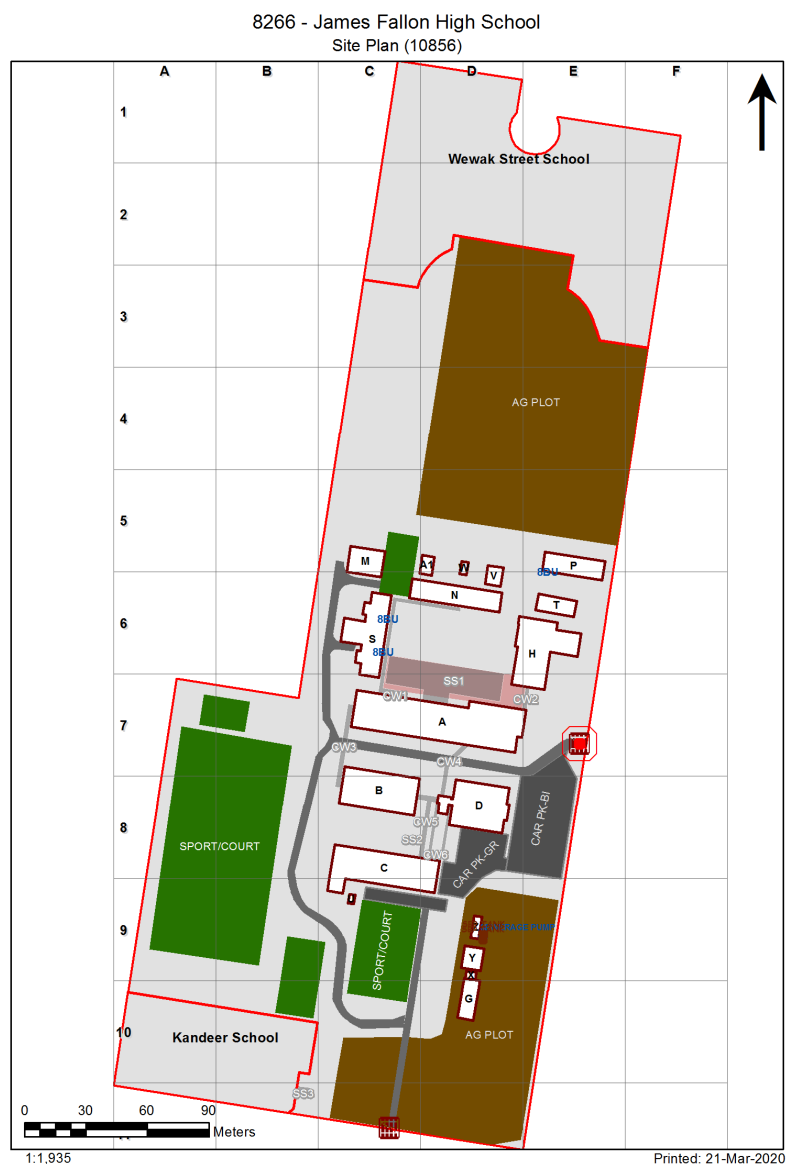

Preface to Asbestos Register

Limitations

Asbestos Registers established (first surveyed 2007/08) and maintained for the Department of Education (DoE) are limited in extent, in that:

1. All inspections and surveys of materials and finishes in DoE facilities are non-disturbance, with
2. Samples undertaken by hygienist to determine whether a sample is an Asbestos Containing Material (ACM),
3. The hygienist may apply a single sample to like materials within a space and adjoining spaces, but not normally between buildings,
4. Successive inspections have reduced any inconclusive records such as 'assumed asbestos' in difficult to access areas, by undertaking additional sampling with lifting devices.
5. In compliance with WHS Act 2011 and WHS Regulations 2017, additional inspections have been undertaken in ceiling spaces and sub-floor areas where access is possible.
 - o Where the ground floor is slab on ground, no inspection is made beneath the slab.
 - o Where fibro fragments (ACM taken for sampling) are located in ceiling spaces or sub floor voids air monitoring is normally undertaken at time of sampling, and clearance undertaken as soon as practicable.
6. No attempt has been made to identify any ACM that is hidden from view or encapsulated within
 - o Any wall cavity
 - o Sub floor area, particularly formwork for slabs in/on ground,
 - o Services (that may use ACM) such as: pipe lagging, asbestos cement pipes, flues.
7. All known ACM in Grounds (Fibro in Grounds) is made available in associated site specific asbestos management plans in DoE electronic files.
Notwithstanding information provided, ACM may be present in grounds from time to time and caution must be exercised prior to any grounds disturbance.

Use of the Asbestos Register

Prior to any disturbance works being undertaken in a building to which this asbestos register applies it will be necessary to confirm the extent of any ACM by a disturbance investigation:

- If the building was built prior to 2003
- If any ACM has been identified in the Asbestos Register for the building.

Update of Asbestos Registers

Asbestos Register Data is updated regularly by the DoE Hygienist Panel via the Online Asbestos Register Tool (Managed by Business Systems, School Infrastructure NSW). Internal users can view the latest edition of the Asbestos Register in the AMS.

Please note: The Department's external website may not contain the latest revision of the Asbestos Register.

Notes 1: Vermiculite

- During 2018/19, all vermiculite occurrences in DoE schools identified in 2007/08, were 'composite tested' in accordance with a safe work NSW agreed procedure. This required multiple testing of all vermiculite occurrences.
- During the period 2007/08 to 2018/19, some vermiculite has been over sheeted and a warning is indicated for schools where this has happened.

Note 2: DoE website link for information is here:

<https://www.schoolinfrastructure.nsw.gov.au/about-us/working-with-us/schools-asbestos-register.html>

<https://education.nsw.gov.au/about-us/strategies-and-reports/our-reports-and-reviews/schools-asbestos-register>

Note 3: Material Condition Assessment

The material condition assessment descriptors from Section 3 of the Asbestos Management Plan (AMP) is extracted below. Please read the AMP in its entirety for further information.

3.3.2.1 Material condition assessment

The OART records the material condition of identified ACM in the following format:

Rating	Description
Good condition (1)	For non-friable asbestos that is sealed and has no visible damage. This primarily related to asbestos cement (AC) sheet and vinyl tiles
Minimal damage (2)	For non-friable asbestos that has a very small amount of damage, eg hairline cracks.
Some damage / unsealed (3)	For non-friable asbestos with significant breakage or several small areas where material has been damaged, revealing loose asbestos fibres. Non-friable asbestos that is unsealed.
Poor condition (4)	For non-friable asbestos that has extensive damage. Visible asbestos debris
Friable asbestos (5)	Any occurrence of friable asbestos

Product	Material Description	Extent	Location	Material Condition	Risk Status	Remediation Priority	Result
B00A - Various - 1958 - Brick/Block							
Exterior							
Ceiling Voids - Raked Ceiling	Non Accessible Area						
Underfloor Voids	Non Accessible Area						
Underfloor Voids	Flat AC Sheeting		Throughout	Some Damage - Unsealed (3)	Low (1)	Low Priority (2-3)	Assumed Asbestos
Interior							
B00A - R0001 - Administration - Clerical - 31.9 m2							
No Asbestos							
B00A - R0002 - Public Entry - 38.51 m2							
No Asbestos							
B00A - R0003 - General Storeroom - 2.24 m2							
No Asbestos							
B00A - R0004 - General Storeroom - 4.64 m2							
No Asbestos							
B00A - R0005 - Principal Office - 16.93 m2							
No Asbestos							
B00A - R0006 - Ancillary Staff - 18.04 m2							
Floor Coverings Res/Textile	Vinyl Tiles	19m2	All surfaces	Good Condition (1)	Low (1)	Low Priority (2-3)	Chrysotile (white asbestos)
B00A - R0009 - Cleaning Store - Distributed - 2.99 m2							
No Asbestos							
B00A - R0010 - Staff Study - 12.66 m2							
No Asbestos							
B00A - R0011 - Clinic - Girls - 10.78 m2							
Floor Coverings Res/Textile	Vinyl Tiles	11m2	All surfaces	Good Condition (1)	Low (1)	Low Priority (2-3)	Chrysotile (white asbestos)
B00A - R0012 - Clinic-Toilets - 5.45 m2							
No Asbestos							
B00A - R0013 - Clinic-Toilets - 1.85 m2							
No Asbestos							
B00A - R0014 - Clinic - Boys - 13.98 m2							
Floor Coverings Res/Textile	Vinyl Tiles	14m2	All surfaces	Good Condition (1)	Low (1)	Low Priority (2-3)	Chrysotile (white asbestos)
B00A - R0015 - Office/Store - 5.71 m2							
Floor Coverings Res/Textile	Vinyl Tiles	6m2	All surfaces	Good Condition (1)	Low (1)	Low Priority (2-3)	Chrysotile (white asbestos)
B00A - R0016 - Distribution Board Cupboard - .38 m2							
No Asbestos							
B00A - R0017 - General Storeroom - 12.56 m2							
No Asbestos							
B00A - R0018 - Main Switchroom - 6.05 m2							
No Asbestos							
B00A - R0019 - Cleaning Store - Distributed - 6.19 m2							
No Asbestos							
B00A - R0025 - Food Technology L.S. - 65.05 m2							
No Asbestos							
B00A - R0026 - General Storeroom - 6.1 m2							
Floor Coverings Res/Textile	Vinyl Tiles						
B00A - R0027 - Materials Store - 6.26 m2							

Note: No inspection of live electrical installation

No Asbestos							
B00A - R0032 - Movement - 3.94 m2							
No Asbestos							
B00A - R0038 - Movement - 4.09 m2							
No Asbestos							
B00A - R0039 - Staff Study - 25.62 m2							
No Asbestos							
B00A - R0040 - General Learning Space - 52.01 m2							
No Asbestos							
B00A - R0041 - Deputy Principal Office - 25.58 m2							
No Asbestos							
B00A - R0042 - Deputy Principal Office - 12.84 m2							
No Asbestos							
B00A - R0043 - Commonroom - 91.45 m2							
No Asbestos							
B00A - R0044 - Movement - 4.13 m2							
No Asbestos							
B00A - R0045 - General Storeroom - 13.8 m2							
No Asbestos							
B00A - R0046 - Leading Teacher - 11.21 m2							
No Asbestos							
B00A - R0047 - General Storeroom - 3.32 m2							
No Asbestos							
B00A - R0048 - Duplicating Workroom - 17.77 m2							
No Asbestos							
B00A - R0049 - Interview/Office - Type 1 - 13.83 m2							
No Asbestos							
B00A - R0050 - Office/Store - 11.74 m2							
Floor Coverings Res/Textile	Vinyl Tiles	12m2	All surfaces	Good Condition (1)	Low (1)	Low Priority (2-3)	Chrysotile (white asbestos)
B00A - R0051 - Administration - Clerical - 20.94 m2							
No Asbestos							
B00A - R0052 - General Storeroom - 6.3 m2							
Floor Coverings Res/Textile	Vinyl Tiles	7m2	All surfaces	Good Condition (1)	Low (1)	Low Priority (2-3)	Chrysotile (white asbestos)
B00A - R0055 - Movement - 112 m2							
No Asbestos							
B00A - R0056 - Toilets-Disabled - 21.13 m2							
Wall Linings Internal	Flat AC Sheeting						
B00A - R0057 - Student Laundry - Type 3 - 10.69 m2							
Wall Linings Internal	Flat AC Sheeting						
B00A - R0058 - Toilets-Disabled - 21.23 m2							
Wall Linings Internal	Flat AC Sheeting						
B00A - R0059 - General Learning Space - S/P - 64.96 m2							
No Asbestos							
B00A - R0060 - Movement - 17.87 m2							
No Asbestos							
B00A - R0061 - Cleaning Store - Distributed - 4.68 m2							
No Asbestos							
B00A - R0062 - General Learning Space - S/P - 60.98 m2							
No Asbestos							

B00A - R0063 - Staff Kitchen - 6.76 m2	
No Asbestos	
B00A - R0064 - Practical Activity Area - 6.08 m2	
No Asbestos	
B00A - R0065 - Home Base Store - S - 7.42 m2	
No Asbestos	
B00A - R0066 - General Learning Space - S/P - 68.09 m2	
No Asbestos	
B00A - R0067 - Practical Activity Area - 6.03 m2	
No Asbestos	
B00A - R0068 - Movement - 49.79 m2	
No Asbestos	
B00A - R0069 - Movement - 10.69 m2	
Wall Linings Internal	Flat AC Sheeting
B00A - R0070 - Movement - 237.57 m2	
No Asbestos	
B00A - R0071 - Stairs - 2.44 m2	
No Asbestos	
B00A - R0072 - Stairs - 3.26 m2	
No Asbestos	
B00A - R0073 - Stairs - 3.34 m2	
No Asbestos	
B00A - R0074 - Stairs - 3.46 m2	
No Asbestos	
B00A - R0075 - Toilet - Lobby - 7.59 m2	
No Asbestos	
B00A - R0076 - Toilet - Lobby - 7.94 m2	
No Asbestos	
B00A - R0077 - Staff - Toilet - 3.66 m2	
No Asbestos	
B00A - R0078 - Staff - Toilet - 3.37 m2	
No Asbestos	
B00A - R0079 - Preparation - Materials - 15.77 m2	
No Asbestos	
B00A - R0080 - Pantry - 11.15 m2	
No Asbestos	
B00A - R0081 - Food Technology L.S. - 82.23 m2	
No Asbestos	
B00A - R0082 - Food/Research Space - 18.78 m2	
No Asbestos	
B00A - R1001 - General Learning Space - 52.24 m2	
No Asbestos	
B00A - R1002 - Cleaning Store - Distributed - 4.68 m2	
No Asbestos	
B00A - R1003 - Movement - 5.09 m2	
No Asbestos	
B00A - R1004 - General Learning Space - 52.16 m2	
No Asbestos	
B00A - R1005 - General Storeroom - 12.5 m2	
Floor Coverings Res/Textile	Vinyl Tiles
B00A - R1006 - General Learning Space - 65.05 m2	

No Asbestos		
B00A - R1007 - Senior Study - 133.65 m2		
Floor Coverings Res/Textile	Vinyl Tiles	
B00A - R1008 - General Storeroom - 9.73 m2		
No Asbestos		
B00A - R1009 - Staff Study - 52.03 m2		
No Asbestos		
B00A - R1010 - General Storeroom - 5.76 m2		
No Asbestos		
B00A - R1011 - General Storeroom - 3.02 m2		
No Asbestos		
B00A - R1012 - General Learning Space - 55.55 m2		
No Asbestos		
B00A - R1013 - Computer Learning Space - 52.24 m2		
No Asbestos		
B00A - R1014 - Computer Resource - 12.59 m2		
No Asbestos		
B00A - R1015 - General Storeroom - 5.96 m2		
Floor Coverings Res/Textile	Vinyl Tiles	
Floor Coverings Res/Textile	Vinyl Tiles - Adhesive - Black	
B00A - R1016 - Music Store - 6.12 m2		
Floor Coverings Res/Textile	Vinyl Tiles - Adhesive - Black	
Floor Coverings Res/Textile	Vinyl Tiles	
B00A - R1017 - Music Learning Space - 52.02 m2		
No Asbestos		
B00A - R1018 - Cleaning Store - Distributed - 4.39 m2		
No Asbestos		
B00A - R1019 - General Learning Space - 52.02 m2		
No Asbestos		
B00A - R1020 - General Learning Space - 52.03 m2		
No Asbestos		
B00A - R1021 - General Learning Space - 51.95 m2		
No Asbestos		
B00A - R1022 - Performing Arts Store - 14.75 m2		
No Asbestos		
B00A - R1023 - Performing Arts Changeroom - 14.92 m2		
No Asbestos		
B00A - R1024 - Performance Workspace - 74.33 m2		
No Asbestos		
B00A - R1025 - General Learning Space - 52.39 m2		
No Asbestos		
B00A - R1026 - General Learning Space - 52.09 m2		
No Asbestos		
B00A - R1027 - General Learning Space - 52.17 m2		
No Asbestos		
B00A - R1028 - General Learning Space - 52.18 m2		
No Asbestos		
B00A - R1029 - Movement - 253.87 m2		

No Asbestos							
B00A - R1030 - Stairs - 12.96 m2							
No Asbestos							
B00A - R1031 - Stairs - 13.2 m2							
No Asbestos							
B00A - R1032 - Stairs - 12.74 m2							
No Asbestos							
B00A - R1033 - Stairs - 13.35 m2							
No Asbestos							
B00B - Art/Science - 1958 - Brick/Block							
Exterior							
Eaves Linings	Flat AC Sheeting	40m2	North facing, South facing	Good Condition (1)	Low (1)	Low Priority (2-3)	Chrysotile (white asbestos)
Ceiling Voids - Raked Ceiling	Non Accessible Area						
Underfloor Voids	AC Fragments/Debris		Throughout	Some Damage - Unsealed (3)	Low (1)	Low Priority (2-3)	Chrysotile (white asbestos)
Underfloor Voids	Flat AC Sheeting		Throughout	Some Damage - Unsealed (3)	Low (1)	Low Priority (2-3)	Chrysotile (white asbestos)
Underfloor Voids	AC Fragments/Debris - Flat AC Sheet		Throughout	Some Damage - Unsealed (3)	Low (1)	Low Priority (2-3)	Chrysotile (white asbestos)
Interior							
B00B - R0001 - Laboratory L.S. - 86.62 m2							
Furniture / Fixtures	Flat AC Sheeting	2	North facing	Some Damage - Unsealed (3)	Low (1)	Low Priority (2-3)	Chrysotile (white asbestos) , Amosite (brown asbestos)
Ceiling Structures/Linings	Vermiculite - Composite Sample - (70 - 120 m2) - (X8)						
B00B - R0002 - Movement - 3.21 m2							
No Asbestos							
B00B - R0003 - Staff - Toilet - 6.44 m2							
No Asbestos							
B00B - R0004 - Cleaning Store - Distributed - 1.87 m2							
No Asbestos							
B00B - R0005 - Distribution Board Cupboard - 1.11 m2							
No Asbestos							
B00B - R0006 - Toilets-Boys - 23.97 m2							
Furniture / Fixtures - Cistern	Fibre Cement Casting (Monocrete)						
Ceiling Structures/Linings	No Asbestos Found						
B00B - R0007 - General Learning Space - 52.53 m2							
Ceiling Structures/Linings	Vermiculite - Composite Sample - (40 - 70 m2) - (X5)						
B00B - R0008 - Staff Study - 52.46 m2							
Ceiling Structures/Linings	Vermiculite - Composite Sample - (40 - 70 m2) - (X5)						
B00B - R0009 - General Learning Space - 52.53 m2							
Ceiling Structures/Linings	Vermiculite - Composite Sample - (40 - 70 m2) - (X5)						
B00B - R0010 - Toilets-Girls - 25.24 m2							
No Asbestos							
B00B - R0011 - Cleaning Store - Distributed - 4.96 m2							
No Asbestos							
B00B - R0012 - Staff - Toilet - 6.38 m2							
No Asbestos							

B00B - R0013 - Movement - 149.79 m2							
Floor Coverings Res/Textile	Vinyl Tiles	150m2	All surfaces	Good Condition (1)	Low (1)	Low Priority (2-3)	Chrysotile (white asbestos)
Ceiling Structures/Linings	Vermiculite - Composite Sample - (120 - 250 m2) - (X15)						
B00B - R0014 - Staff Study - 25.68 m2							
Ceiling Structures/Linings	Vermiculite - Composite Sample - (10 - 40 m2) - (X3)						
B00B - R0016 - Apparatus Store - 9.27 m2							
Ceiling Structures/Linings	Vermiculite - Composite Sample - (10 - 40 m2) - (X3)						
B00B - R0017 - Preparation - 28.44 m2							
Ceiling Structures/Linings	Vermiculite - Composite Sample - (10 - 40 m2) - (X3)						
B00B - R0018 - Stairs - 4.11 m2							
Ceiling Structures/Linings	Vermiculite - Composite Sample - (< 10 m2) - (X2)						
B00B - R0019 - Stairs - 1.08 m2							
Ceiling Structures/Linings	Vermiculite - Composite Sample - (< 10 m2) - (X2)						
B00B - R0020 - Practical Activities - 18.06 m2							
Window	Mastic						
Wall Linings Internal	Flat AC Sheeting						
B00B - R0021 - General Learning Space - 65.04 m2							
Window	Mastic						
B00B - R1001 - Audio Visual Workroom - 13.1 m2							
Floor Coverings Res/Textile	Vinyl Tiles	14m2	All surfaces	Good Condition (1)	Low (1)	Low Priority (2-3)	Chrysotile (white asbestos)
B00B - R1002 - Secure Storeroom - 12.99 m2							
Floor Coverings Res/Textile	Vinyl Tiles	13m2	All surfaces	Good Condition (1)	Low (1)	Low Priority (2-3)	Chrysotile (white asbestos)
B00B - R1003 - Distribution Board Cupboard - .87 m2							
Note: No inspection of live electrical installation							
Wall Linings Internal	Flat AC Sheeting	8m2	All surfaces	Some Damage - Unsealed (3)	Low (1)	Low Priority (2-3)	Chrysotile (white asbestos)
Ceiling Structures/Linings	Flat AC Sheeting	1m2	All surfaces	Some Damage - Unsealed (3)	Low (1)	Low Priority (2-3)	Chrysotile (white asbestos)
B00B - R1004 - Cleaning Store - Distributed - 5.22 m2							
No Asbestos							
B00B - R1005 - General Storeroom - 6.35 m2							
Floor Coverings Res/Textile	Vinyl Tiles	7m2	All surfaces	Good Condition (1)	Low (1)	Low Priority (2-3)	Chrysotile (white asbestos)
B00B - R1006 - Art Learning Space - 65.65 m2							
Floor Coverings Res/Textile	Vinyl Tiles	66m2	All surfaces	Good Condition (1)	Low (1)	Low Priority (2-3)	Chrysotile (white asbestos)
B00B - R1007 - Art Learning Space - 65.57 m2							
Floor Coverings Res/Textile	Vinyl Tiles	66m2	All surfaces	Good Condition (1)	Low (1)	Low Priority (2-3)	Chrysotile (white asbestos)
B00B - R1008 - General Storeroom - 6.05 m2							
Floor Coverings Res/Textile	Vinyl Tiles - Adhesive						
Floor Coverings Res/Textile	Vinyl Tiles	6.05m2	Throughout	Good Condition (1)	Low (1)	Low Priority (2-3)	Chrysotile (white asbestos)
B00B - R1009 - General Storeroom - 6.08 m2							
Floor Coverings Res/Textile	Vinyl Tiles	7m2	All surfaces	Good Condition (1)	Low (1)	Low Priority (2-3)	Chrysotile (white asbestos)
B00B - R1010 - Art Learning Space - 53.18 m2							

Floor Coverings Res/Textile	Vinyl Tiles	54m2	All surfaces	Good Condition (1)	Low (1)	Low Priority (2-3)	Chrysotile (white asbestos)
B00B - R1011 - Movement - 122.85 m2							
No Asbestos							
B00B - R1012 - Staff Study - 25.98 m2							
Floor Coverings Res/Textile	Vinyl Tiles	26m2	All surfaces	Good Condition (1)	Low (1)	Low Priority (2-3)	Chrysotile (white asbestos)
B00B - R1013 - Art Learning Space - 52.53 m2							
No Asbestos							
B00B - R1014 - Kiln Space - 25.75 m2							
No Asbestos							
B00B - R1015 - Art Learning Space - 52.6 m2							
Floor Coverings Res/Textile	Vinyl Tiles	53m2	All surfaces	Good Condition (1)	Low (1)	Low Priority (2-3)	Chrysotile (white asbestos)
B00B - R1016 - General Storeroom - 12.95 m2							
Floor Coverings Res/Textile	Vinyl Tiles	13m2	All surfaces	Good Condition (1)	Low (1)	Low Priority (2-3)	Chrysotile (white asbestos)
B00B - R1017 - Darkroom Space - 12.8 m2							
Floor Coverings Res/Textile	Vinyl Tiles	13m2	All surfaces	Good Condition (1)	Low (1)	Low Priority (2-3)	Chrysotile (white asbestos)
B00B - R1019 - Darkroom Space - 10.29 m2							
No Asbestos							
B00B - R1020 - Movement - 1.33 m2							
No Asbestos							
B00B - R1021 - Darkroom Space - 11.85 m2							
No Asbestos							
B00B - R1022 - General Storeroom - 1.23 m2							
No Asbestos							
B00B - R1023 - Seminar - Type 1 - 25.75 m2							
Floor Coverings Res/Textile	Vinyl Tiles	26m2	All surfaces	Good Condition (1)	Low (1)	Low Priority (2-3)	Chrysotile (white asbestos)
B00B - R1024 - Stairs - 13.78 m2							
No Asbestos							
B00B - R1025 - Stairs - 13.94 m2							
No Asbestos							
B00C - Various - 1972 - Brick/Block							
Exterior							
Eaves Linings	Flat AC Sheeting	40m2	North facing, South facing	Good Condition (1)	Low (1)	Low Priority (2-3)	Chrysotile (white asbestos)
Underfloor Voids - Slab on Ground							
Ceiling Voids - Raked Ceiling	Non Accessible Area						
Interior							
B00C - R0001 - General Learning Space - 52.89 m2							
Ceiling Structures/Linings	Vermiculite - Composite Sample - (40 - 70 m2) - (X5)						
B00C - R0002 - General Learning Space - 54.47 m2							
Ceiling Structures/Linings	Vermiculite - Composite Sample - (40 - 70 m2) - (X5)						
B00C - R0003 - General Storeroom - 4.26 m2							
Ceiling Structures/Linings	No Asbestos Found						
Floor Coverings Res/Textile	Vinyl Tiles						

B00C - R0004 - Staff - Toilet - 3.75 m2							
Partition Walls (Cubicles)	Compressed AC Sheet	3m2	All surfaces	Good Condition (1)	Low (1)	Low Priority (2-3)	Chrysotile (white asbestos)
Ceiling Structures/Linings	Vermiculite - Composite Sample - (< 10 m2) - (X2)						
B00C - R0005 - Staff - Toilet - 7.43 m2							
Partition Walls (Cubicles)	Compressed AC Sheet	6m2	All surfaces	Good Condition (1)	Low (1)	Low Priority (2-3)	Chrysotile (white asbestos)
Ceiling Structures/Linings	Vermiculite - Composite Sample - (< 10 m2) - (X2)						
B00C - R0006 - Staff Study - 16.18 m2							
Ceiling Structures/Linings	Vermiculite - Composite Sample - (10 - 40 m2) - (X3)						
Floor Coverings Res/Textile	Vinyl Tiles						
B00C - R0007 - Distribution Board Cupboard - .83 m2							
						Note: No inspection of live electrical installation	
No Asbestos							
B00C - R0008 - General Storeroom - 15.13 m2							
Ceiling Structures/Linings	Vermiculite - Composite Sample - (10 - 40 m2) - (X3)						
Floor Coverings Res/Textile	Vinyl Tiles						
B00C - R0009 - General Storeroom - 32.91 m2							
Ceiling Structures/Linings	Vermiculite - Composite Sample - (10 - 40 m2) - (X3)						
Floor Coverings Res/Textile	Vinyl Tiles						
B00C - R0010 - Staff Study - 32.95 m2							
Ceiling Structures/Linings	Vermiculite - Composite Sample - (10 - 40 m2) - (X3)						
B00C - R0011 - Staff - Toilet - 7.5 m2							
Ceiling Structures/Linings	Vermiculite - Composite Sample - (< 10 m2) - (X2)						
Partition Walls (Cubicles)	Compressed AC Sheet	6m2	All surfaces	Good Condition (1)	Low (1)	Low Priority (2-3)	Chrysotile (white asbestos)
B00C - R0012 - Staff - Toilet - 3.75 m2							
Partition Walls (Cubicles)	Compressed AC Sheet	3m2	All surfaces	Good Condition (1)	Low (1)	Low Priority (2-3)	Chrysotile (white asbestos)
B00C - R0013 - Cleaning Store - Distributed - 4.29 m2							
Ceiling Structures/Linings	No Asbestos Found						
Floor Coverings Res/Textile	Vinyl Tiles						
B00C - R0014 - Music Learning Space - 54.04 m2							
Ceiling Structures/Linings	Vermiculite - Composite Sample - (40 - 70 m2) - (X5)						
B00C - R0015 - Music Store - 6.01 m2							
No Asbestos							
B00C - R0016 - Cleaning Store - Distributed - 5.95 m2							
Ceiling Structures/Linings	Vermiculite - Composite Sample - (< 10 m2) - (X2)						
B00C - R0017 - General Assistants - 12.88 m2							
No Asbestos							
B00C - R0018 - Staff Study - 9.76 m2							
Ceiling Structures/Linings	Vermiculite - Composite Sample - (10 - 40 m2) - (X3)						
B00C - R0019 - Staff Change - 3.05 m2							

Ceiling Structures/Linings	Vermiculite - Composite Sample - (< 10 m2) - (X2)							
B00C - R0020 - Staff Change - 3.18 m2								
Ceiling Structures/Linings	Vermiculite - Composite Sample - (< 10 m2) - (X2)							
B00C - R0021 - Staff Study - 9.19 m2								
Ceiling Structures/Linings	Vermiculite - Composite Sample - (10 - 40 m2) - (X3)							
Floor Coverings Res/Textile	Vinyl Tiles							
B00C - R0022 - Movement - 163.39 m2								
Ceiling Structures/Linings	Vermiculite - Composite Sample - (120 - 250 m2) - (X15)							
B00C - R0023 - General Learning Space - 52.08 m2								
Ceiling Structures/Linings	Vermiculite - Composite Sample - (40 - 70 m2) - (X5)							
B00C - R0024 - General Learning Space - 52.97 m2								
Ceiling Structures/Linings	Vermiculite - Composite Sample - (40 - 70 m2) - (X5)							
B00C - R0025 - General Learning Space - 52.67 m2								
Ceiling Structures/Linings	Vermiculite - Composite Sample - (40 - 70 m2) - (X5)							
B00C - R0026 - General Learning Space - 52.31 m2								
Ceiling Structures/Linings	Vermiculite - Composite Sample - (40 - 70 m2) - (X5)							
B00C - R0027 - Practice/Seminar - 51.67 m2								
No Asbestos								
B00C - R0028 - Stairs - 10.12 m2								
Ceiling Structures/Linings	Vermiculite - Composite Sample - (10 - 40 m2) - (X3)							
B00C - R0029 - Stairs - 10.21 m2								
Ceiling Structures/Linings	Vermiculite - Composite Sample - (10 - 40 m2) - (X3)							
B00C - R1001 - General Learning Space - 52.82 m2								
Ceiling Structures/Linings	Vermiculite - Composite Sample - (40 - 70 m2) - (X5)							
B00C - R1002 - General Learning Space - 54.48 m2								
Ceiling Structures/Linings	Vermiculite - Composite Sample - (40 - 70 m2) - (X5)							
B00C - R1003 - Staff - Toilet - 7.46 m2								
Ceiling Structures/Linings	Vermiculite - Composite Sample - (< 10 m2) - (X2)							
Partition Walls (Cubicles)	Compressed AC Sheet	6m2	All surfaces	Good Condition (1)	Low (1)	Low Priority (2-3)	Chrysotile (white asbestos)	
B00C - R1004 - Staff - Toilet - 3.78 m2								
Partition Walls (Cubicles)	Compressed AC Sheet	3m2	All surfaces	Good Condition (1)	Low (1)	Low Priority (2-3)	Chrysotile (white asbestos)	
Ceiling Structures/Linings	Vermiculite - Composite Sample - (< 10 m2) - (X2)							
B00C - R1005 - Interview/Office - Type 1 - 16.31 m2								
Ceiling Structures/Linings	Vermiculite - Composite Sample - (10 - 40 m2) - (X3)							
B00C - R1006 - Distribution Board Cupboard - .85 m2								
Note: No inspection of live electrical installation								
Ceiling Structures/Linings	Flat AC Sheeting	1m2	All surfaces	Good Condition (1)	Low (1)	Low Priority (2-3)	Chrysotile (white asbestos)	
Electrical - Mounting Board	Resinous Board	2	North facing	Good Condition (1)	Low (1)	Low Priority (2-3)	Assumed Asbestos	
B00C - R1007 - Computer Resource - 15.14 m2								

Ceiling Structures/Linings	Vermiculite - Composite Sample - (10 - 40 m2) - (X3)						
B00C - R1008 - Staff Study - 16.37 m2							
Ceiling Structures/Linings	Vermiculite - Composite Sample - (10 - 40 m2) - (X3)						
B00C - R1009 - Staff Study - 33 m2							
Ceiling Structures/Linings	Vermiculite - Composite Sample - (10 - 40 m2) - (X3)						
B00C - R1010 - General Storeroom - 7.84 m2							
Floor Coverings Res/Textile	Vinyl Tiles	7.85m2	Throughout	Good Condition (1)	Low (1)	Low Priority (2-3)	Chrysotile (white asbestos)
Window	Mastic						
B00C - R1011 - Cleaning Store - Distributed - 7.89 m2							
Ceiling Structures/Linings	Vermiculite - Composite Sample - (< 10 m2) - (X2)						
Floor Coverings Res/Textile	Vinyl Tiles						
B00C - R1012 - Staff - Toilet - 7.4 m2							
Partition Walls (Cubides)	Compressed AC Sheet	6m2	All surfaces	Good Condition (1)	Low (1)	Low Priority (2-3)	Chrysotile (white asbestos)
Ceiling Structures/Linings	Vermiculite - Composite Sample - (< 10 m2) - (X2)						
B00C - R1013 - Staff - Toilet - 3.82 m2							
Partition Walls (Cubides)	Compressed AC Sheet	3m2	All surfaces	Good Condition (1)	Low (1)	Low Priority (2-3)	Chrysotile (white asbestos)
Ceiling Structures/Linings	Vermiculite - Composite Sample - (< 10 m2) - (X2)						
B00C - R1014 - Computer Learning Space - 54.47 m2							
Ceiling Structures/Linings	Vermiculite - Composite Sample - (40 - 70 m2) - (X5)						
B00C - R1015 - General Learning Space - 52.75 m2							
Ceiling Structures/Linings	Vermiculite - Composite Sample - (40 - 70 m2) - (X5)						
B00C - R1016 - Staff Study - 19.23 m2							
Ceiling Structures/Linings	Vermiculite - Composite Sample - (10 - 40 m2) - (X3)						
B00C - R1017 - General Learning Space - 52.3 m2							
Ceiling Structures/Linings	Vermiculite - Composite Sample - (40 - 70 m2) - (X5)						
B00C - R1018 - General Learning Space - 52.82 m2							
Ceiling Structures/Linings	Vermiculite - Composite Sample - (40 - 70 m2) - (X5)						
B00C - R1019 - General Storeroom - 12.77 m2							
Ceiling Structures/Linings	Vermiculite - Composite Sample - (10 - 40 m2) - (X3)						
B00C - R1020 - General Storeroom - 12.88 m2							
Ceiling Structures/Linings	Vermiculite - Composite Sample - (10 - 40 m2) - (X3)						
Floor Coverings Res/Textile	Vinyl Tiles (Under Floor Covering/Carpet)						
B00C - R1021 - General Learning Space - 52.82 m2							
Ceiling Structures/Linings	Vermiculite - Composite Sample - (40 - 70 m2) - (X5)						
B00C - R1022 - Staff Study - 25.63 m2							
Ceiling Structures/Linings	Vermiculite - Composite Sample - (10 - 40 m2) - (X3)						
B00C - R1023 - Movement - 146.28 m2							

Ceiling Structures/Linings	Vermiculite - Composite Sample - (120 - 250 m2) - (X15)							
B00C - R1024 - Stairs - 14.92 m2								
Ceiling Structures/Linings	Vermiculite - Composite Sample - (10 - 40 m2) - (X3)							
B00C - R1025 - Stairs - 14.83 m2								
Ceiling Structures/Linings	Vermiculite - Composite Sample - (10 - 40 m2) - (X3)							
B00D - Library/Science - 1973 - Brick/Block								
Exterior								
Underfloor Voids - Slab on Ground	Non Accessible Area							
Ceiling Voids - Raked Ceiling	Non Accessible Area							
Interior								
B00D - M1001 - No Access - 23.21 m2								
No Asbestos								
B00D - M1002 - Interview/Office - Type 1 - 38.35 m2								
No Asbestos								
B00D - M1003 - Main Area - 67.69 m2								
No Asbestos								
B00D - M1004 - No Access - 2.83 m2								
No Asbestos								
B00D - M1005 - Seminar - 15.33 m2								
No Asbestos								
B00D - M1006 - No Access - 6.96 m2								
No Asbestos								
B00D - R0001 - Laboratory L.S. - 91.24 m2								
Ceiling Structures/Linings	Non Accessible Area	m2						
B00D - R0002 - Main Switchroom - 1.81 m2								
No Asbestos								
B00D - R0003 - Plant - 8.66 m2								
Plumbing / Pipework	Fibre Cement Pipe	5	South facing	Good Condition (1)	Low (1)	Low Priority (2-3)	Chrysotile (white asbestos) , Amosite (brown asbestos)	
Plumbing / Pipework		20	Pipework joins	Good Condition (1)	Low (1)	Low Priority (2-3)	Chrysotile (white asbestos)	
B00D - R0004 - Chemical Store - 16.99 m2								
No Asbestos								
B00D - R0005 - Distribution Board Cupboard - .42 m2								
						Note: No inspection of live electrical installation		
No Asbestos								
B00D - R0006 - Laboratory L.S. - 91.24 m2								
Ceiling Structures/Linings	Non Accessible Area	m2						
B00D - R0007 - Preparation - 44.57 m2								
Ceiling Structures/Linings	Vermiculite - Composite Sample - (40 - 70 m2) - (X5)							
B00D - R0008 - Apparatus Store - 3.28 m2								
Ceiling Structures/Linings	Vermiculite - Composite Sample - (< 10 m2) - (X2)							
B00D - R0009 - Laboratory L.S. - 91.35 m2								
Ceiling Structures/Linings	Non Accessible Area	m2						
B00D - R0010 - Cleaning Store - Distributed - 7.87 m2								
No Asbestos								

B00D - R0011 - Movement - 25.74 m2							
No Asbestos							
B00D - R0012 - Laboratory L.S. - 91.15 m2							
Ceiling Structures/Linings	Non Accessible Area	m2					
B00D - R0013 - Movement - 40.81 m2							
No Asbestos							
B00D - R0016 - Stairs - 7.87 m2							
No Asbestos							
B00D - R0017 - Preparation - Science - 48.61 m2							
Ceiling Structures/Linings	Non Accessible Area	m2					
Window	Mastic						
Wall Linings Internal	Flat AC Sheeting						
B00D - R1001 - Seminar - 13.14 m2							
No Asbestos							
B00D - R1002 - Seminar - 11.22 m2							
No Asbestos							
B00D - R1003 - No Access - 5.98 m2							
No Asbestos							
B00D - R1004 - No Access - 5.98 m2							
No Asbestos							
B00D - R1006 - Cleaning Store - Distributed - .32 m2							
No Asbestos							
B00D - R1007 - Movement - 4.35 m2							
No Asbestos							
B00D - R1008 - Distribution Board Cupboard - .23 m2							Note: No inspection of live electrical installation
No Asbestos							
B00D - R1009 - Seminar - 11.48 m2							
No Asbestos							
B00D - R1010 - Seminar - 13.14 m2							
No Asbestos							
B00D - R1011 - Main Area - 327.34 m2							
Ceiling Structures/Linings	Vermiculite - Composite Sample - (> 250 m2) - (X25)						
B00D - R1012 - Audio Visual Workroom - 28.84 m2							
No Asbestos							
B00D - R1013 - Librarian - 11.26 m2							
No Asbestos							
B00D - R1014 - Audio Visual Workroom - 12.88 m2							
No Asbestos							
B00D - R1015 - Workroom - 17.54 m2							
No Asbestos							
B00D - R1016 - Staff - Toilet - 2.93 m2							
No Asbestos							
B00D - R1017 - Movement - 24.62 m2							
No Asbestos							
B00D - R1018 - Staff - Toilet - 2.91 m2							
No Asbestos							
B00D - R1019 - Computer Learning Space - 71.74 m2							
Ceiling Structures/Linings	Vermiculite - Composite Sample - (70 - 120 m2) - (X8)						
B00D - R1020 - Stairs - 16.57 m2							

No Asbestos							
B00G - Agricultural Science - 1961 - Brick/Block							
Exterior							
Ceiling Voids	No Asbestos Found						
Underfloor Voids - Slab on Ground							
Interior							
B00G - R0001 - Movement - 44.24 m2							
Wall Linings Internal - Infill	Flat AC Sheeting	2m2	East facing	Good Condition (1)	Low (1)	Low Priority (2-3)	Chrysotile (white asbestos)
B00G - R0002 - Machine Storage - 51.07 m2							
No Asbestos							
B00G - R0003 - General Storeroom - 6.78 m2							
No Asbestos							
B00G - R0004 - General Storeroom - 8.36 m2							
No Asbestos							
B00G - R0005 - General Storeroom - 12.64 m2							
No Asbestos							
B00G - R0006 - Class Tools Storage - 20.97 m2							
No Asbestos							
B00H - Multi Purpose Facilities - 1961 - Brick/Block							
Exterior							
Underfloor Voids	Non Accessible Area						
Ceiling Voids - Raked Ceiling	Non Accessible Area						
Interior							
B00H - M0001 - Control Room - 16.46 m2							
No Asbestos							
B00H - R0001 - No Access - 3.93 m2							
No Asbestos							
B00H - R0002 - Movement - 7.05 m2							
Ceiling Structures/Linings	Flat AC Sheeting						
B00H - R0004 - Stage - 106.19 m2							
No Asbestos							
B00H - R0005 - Multi-Purpose Space - 276.14 m2							
No Asbestos							
B00H - R0006 - Chair Store - 11.78 m2							
No Asbestos							
B00H - R0007 - Movement - 31.25 m2							
No Asbestos							
B00H - R0008 - Staff Kitchen - 11.78 m2							
No Asbestos							
B00H - R0010 - Movement - 7.14 m2							
No Asbestos							
B00H - R0011 - General Storeroom - 4.25 m2							
No Asbestos							
B00H - R0012 - Performing Arts Changeroom - 18.16 m2							
No Asbestos							
B00H - R0013 - Toilets-Girls - 3.03 m2							
No Asbestos							
B00H - R0014 - Toilets-Boys - 3.03 m2							

No Asbestos							
B00H - R0015 - Performing Arts Changeroom - 18.2 m2							
Ceiling Structures/Linings	Flat AC Sheeting						
B00H - R0018 - External Movement - 12.42 m2							
No Asbestos							
B00H - R0019 - Performance Workspace - 125.54 m2							
No Asbestos							
B00H - R0020 - External Movement - 9.31 m2							
No Asbestos							
B00M - Technological & Applied Studies - 1961 - Brick/Block							
Exterior							
Eaves Linings	Flat AC Sheeting	16m2	North facing, South facing	Good Condition (1)	Low (1)	Low Priority (2-3)	Chrysotile (white asbestos)
Ceiling Voids	Non Accessible Area						
Underfloor Voids - Slab on Ground							
Interior							
B00M - R0003 - Resource/Project Store - 25.84 m2							
No Asbestos							
B00M - R0004 - Metal Technology Bay - 161.29 m2							
No Asbestos							
B00M - R0005 - Welding Area - 11.64 m2							
No Asbestos							
B00N - Technological & Applied Studies - 1988 - Brick/Block							
Exterior							
Entry Steps	Compressed AC Sheet						
Ceiling Voids - Raked Ceiling	Non Accessible Area						
Underfloor Voids	Non Accessible Area						
Interior							
B00N - R0001 - Resource/Project Store - 21.18 m2							
No Asbestos							
B00N - R0002 - Plant - 5.1 m2							
No Asbestos							
B00N - R0003 - Machine Storage - 5.16 m2							
No Asbestos							
B00N - R0004 - Wood Technology Bay - 95.6 m2							
No Asbestos							
B00N - R0005 - Materials Store - 14.81 m2							
No Asbestos							
B00N - R0006 - Movement - 24.47 m2							
No Asbestos							
B00N - R0007 - Design L.S. - 51.44 m2							
Floor Coverings Res/Textile	No Asbestos Found						
B00N - R0008 - Staff - Toilet - 4.21 m2							
No Asbestos							
B00N - R0009 - General Storeroom - 5.99 m2							
No Asbestos							
B00N - R0010 - Cleaning Store - Distributed - 1.46 m2							
No Asbestos							

B00N - R0011 - Staff Study - 25.33 m2							
No Asbestos							
B00N - R0012 - Welding Area - 10.33 m2							
Furniture / Fixtures	Compressed AC Sheet	2	North facing	Poor Condition - Extensive Damage (4)	Low (1)	Low Priority (2-3)	Chrysotile (white asbestos)
B00N - R0013 - Materials Store - 10.83 m2							
No Asbestos							
B00N - R0014 - Metal Technology Bay - 75.33 m2							
No Asbestos							
B00N - R0015 - Sport Equipment Store - 10.36 m2							
No Asbestos							
B00N - R0016 - Sport Equipment Store - 10.42 m2							
No Asbestos							
B00N - R0017 - Materials Store - 10.32 m2							
No Asbestos							
B00P - Technological & Applied Studies - 1973 - Brick/Block							
Exterior							
Ceiling Voids - Raked Ceiling	Non Accessible Area						
Underfloor Voids - Slab on Ground							
Interior							
B00P - R0001 - Design L.S. - 51.88 m2							
Floor Coverings Res/Textile	Vinyl Tiles						
Ceiling Structures/Linings	Vermiculite - Composite Sample - (40 - 70 m2) - (X5)						
B00P - R0002 - Resource/Project Store - 9.91 m2							
Floor Coverings Res/Textile	Vinyl Tiles						
Ceiling Structures/Linings	Vermiculite - Composite Sample - (10 - 40 m2) - (X3)						
B00P - R0003 - Movement - 12.17 m2							
Floor Coverings Res/Textile	Vinyl Tiles						
Ceiling Structures/Linings	Vermiculite - Composite Sample - (10 - 40 m2) - (X3)						
B00P - R0004 - Materials Store - 21.58 m2							
Ceiling Structures/Linings	Vermiculite - Composite Sample - (10 - 40 m2) - (X3)						
B00P - R0005 - Distribution Board Cupboard - .83 m2							
Ceiling Structures/Linings	Flat AC Sheeting						
B00P - R0006 - Wood Technology Bay - 99.95 m2							
Ceiling Structures/Linings	Vermiculite - Composite Sample - (70 - 120 m2) - (X8)						
B00P - R0007 - Toilets-Girls - 32.52 m2							
Partition Walls (Cubicles)	Compressed AC Sheet	8m2	All surfaces	Good Condition (1)	Low (1)	Low Priority (2-3)	Chrysotile (white asbestos)
B00P - R0008 - Toilets-Boys - 30.13 m2							
Partition Walls (Cubicles)	Compressed AC Sheet	10m2	All surfaces	Good Condition (1)	Low (1)	Low Priority (2-3)	Chrysotile (white asbestos)
B00P - R0009 - Cleaning Store - Distributed - 1.88 m2							
No Asbestos							
B00S - Pupil Facilities - 1961 - Brick/Block							

Exterior							
Underfloor Voids - Slab on Ground							
Ceiling Voids - Raked Ceiling	Non Accessible Area						
Interior							
B00S - R0001 - Toilets-Boys - 48.13 m2							
Ceiling Structures/Linings	Flat AC Sheeting						
B00S - R0002 - Shower/Change - 53.93 m2							
Ceiling Structures/Linings	Flat AC Sheeting						
B00S - R0003 - Cleaning Store - Distributed - 4 m2							
No Asbestos							
B00S - R0004 - General Storeroom - 4.06 m2							
No Asbestos							
B00S - R0006 - Cleaning Store - Distributed - 4.04 m2							
No Asbestos							
B00S - R0007 - Cleaning Supplies Store - 2.89 m2							
Furniture / Fixtures	Flat AC Sheeting	2	South facing	Good Condition (1)	Low (1)	Low Priority (2-3)	Chrysotile (white asbestos), Amosite (brown asbestos)
B00S - R0008 - Shower/Change - 55.31 m2							
Partition Walls (Cubicles)	Compressed AC Sheet	22m2	All surfaces	Good Condition (1)	Low (1)	Low Priority (2-3)	Chrysotile (white asbestos)
B00S - R0009 - Toilets-Girls - 48.13 m2							
No Asbestos							
B00S - R0011 - Movement - 2.06 m2							
Floor Coverings Res/Textile	Vinyl Tiles						
B00S - R0012 - Staff - Toilet - 2.36 m2							
No Asbestos							
B00S - R0013 - Maintenance Bulk Store - 15.02 m2							
No Asbestos							
B00S - R0015 - Sport Equipment Store - 30.59 m2							
No Asbestos							
B00S - R0017 - Movement - 3.85 m2							
No Asbestos							
B00S - R0018 - Movement - 3.78 m2							
No Asbestos							
B00S - R0019 - Performing Arts Store - 46.91 m2							
No Asbestos							
B00S - R0020 - Student Canteen - 48.13 m2							
No Asbestos							
B00S - R0021 - Sport Equipment Store - 31.93 m2							
No Asbestos							
B00S - R0022 - Store - Coolroom - 5.06 m2							
No Asbestos							
B00S - R0023 - Store - Coolroom - 3.37 m2							
No Asbestos							
B00S - R0024 - Student Canteen - 67.36 m2							
No Asbestos							
B00S - R0025 - Office/Store - 8.83 m2							
No Asbestos							

B00S - R0026 - Office/Store - 4.36 m2							
No Asbestos							
B00S - R0027 - Movement - 4.22 m2							
No Asbestos							
B00S - R0028 - General Storeroom - 1.33 m2							
No Asbestos							
B00T - Performing Arts - 2009 - Brick/Veneer							
Exterior							
Ceiling Voids - Raked Ceiling	Non Accessible Area						
Underfloor Voids - Slab on Ground							
Interior							
B00T - R0001 - Movement Studio - 142.71 m2							
No Asbestos							
B00U - Physical Education - 2009 - Brick/Block							
Exterior							
Ceiling Voids	No Asbestos Found						
Underfloor Voids - Slab on Ground							
Interior							
B00U - R0001 - Sport Equipment Store - 9.78 m2							
No Asbestos							
B00V - Storage - 2016 - Metal Shed							
Exterior							
No Asbestos							
Interior							
B00V - R0001 - Garden Store Room - 33.73 m2							
No Asbestos							
B00V - R0002 - Performance Store - 33.73 m2							
No Asbestos							
B00W - Mechanical Services - 2002 - Metal Shed							
Exterior							
No Asbestos							
Interior							
B00W - R0001 - Machine Storage - 20.08 m2							
No Asbestos							
B00X - Other - 1992 - Steel							
Exterior							
No Asbestos							
Interior							
B00X - R0001 - Animal Space - 18.33 m2							
No Asbestos							
B00Y - Other - 1992 - Steel							
Exterior							
No Asbestos							
Interior							
B00Y - R0001 - Animal Space - 101.48 m2							
No Asbestos							
B00Z - Agricultural Science - 2000 - Greenhouse							

Exterior	
No Asbestos	
Interior	
B00Z - R0001 - Agriculture Covered Area - 36.43 m2	
No Asbestos	
B0A1 - Storage - 2019 - Metal Shed	
Exterior	
Require Inspection	
Interior	
B0A1 - R0001 - Machine Storage - 52.12 m2	
Require Inspection	

Demountables

There are no Demountable(s) Located at this school as per the AMS records as of 09-Sep-2020