

Asbestos Register

(Hazardous Materials and Risk Assessment)

School:	James Ruse Agricultural High School (8235)
Region:	Western Sydney AMU
State Electorate:	Parramatta
Local Government Area:	Parramatta

Last Reviewed By:	Greencap 20-DEC-2017
Last Revised By:	WSP 25-AUG-2020

Historical Fibro In Grounds Investigations/Events	Yes
Please refer to the latest site specific Asbestos Management Plans available from the Department's website (Refer to Note 2).	

8235 - James Ruse Agricultural High School
Site Plan (11674)

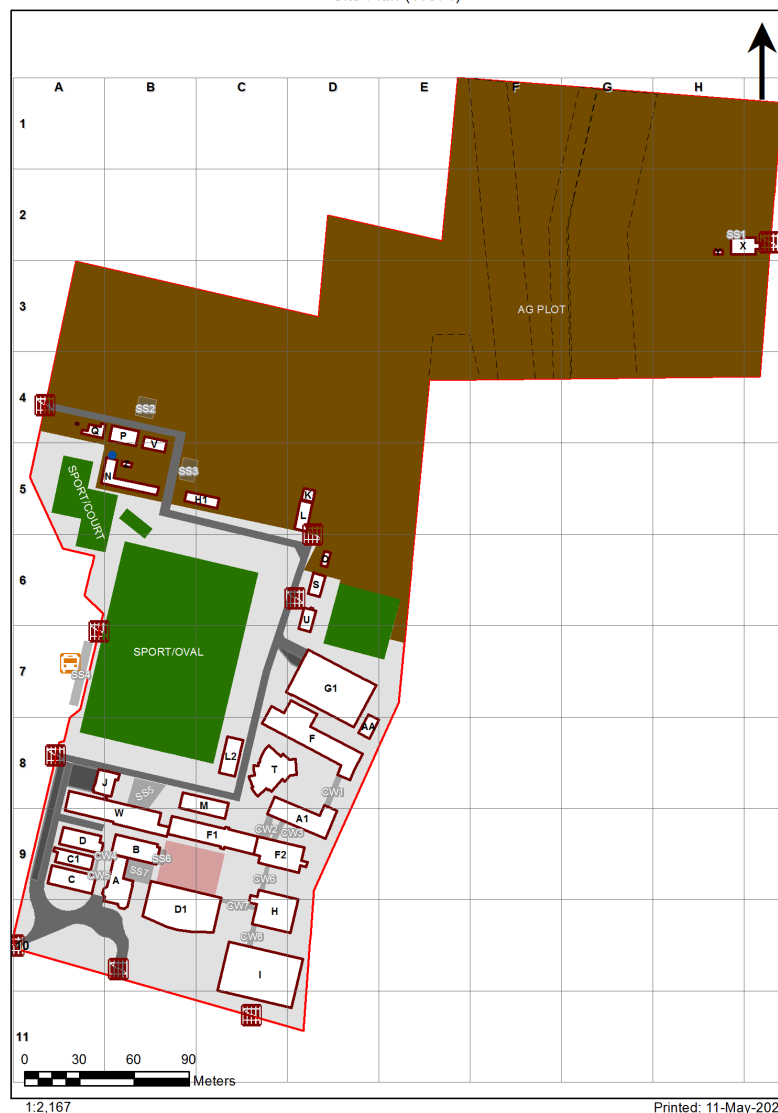

Preface to Asbestos Register

Limitations

Asbestos Registers established (first surveyed 2007/08) and maintained for the Department of Education (DoE) are limited in extent, in that:

1. All inspections and surveys of materials and finishes in DoE facilities are non-disturbance, with
2. Samples undertaken by hygienist to determine whether a sample is an Asbestos Containing Material (ACM),
3. The hygienist may apply a single sample to like materials within a space and adjoining spaces, but not normally between buildings,
4. Successive inspections have reduced any inconclusive records such as 'assumed asbestos' in difficult to access areas, by undertaking additional sampling with lifting devices.
5. In compliance with WHS Act 2011 and WHS Regulations 2017, additional inspections have been undertaken in ceiling spaces and sub-floor areas where access is possible.
 - o Where the ground floor is slab on ground, no inspection is made beneath the slab.
 - o Where fibro fragments (ACM taken for sampling) are located in ceiling spaces or sub floor voids air monitoring is normally undertaken at time of sampling, and clearance undertaken as soon as practicable.
6. No attempt has been made to identify any ACM that is hidden from view or encapsulated within
 - o Any wall cavity
 - o Sub floor area, particularly formwork for slabs in/on ground,
 - o Services (that may use ACM) such as: pipe lagging, asbestos cement pipes, flues.
7. All known ACM in Grounds (Fibro in Grounds) is made available in associated site specific asbestos management plans in DoE electronic files.
Notwithstanding information provided, ACM may be present in grounds from time to time and caution must be exercised prior to any grounds disturbance.

Use of the Asbestos Register

Prior to any disturbance works being undertaken in a building to which this asbestos register applies it will be necessary to confirm the extent of any ACM by a disturbance investigation:

- If the building was built prior to 2003
- If any ACM has been identified in the Asbestos Register for the building.

Update of Asbestos Registers

Asbestos Register Data is updated regularly by the DoE Hygienist Panel via the Online Asbestos Register Tool (Managed by Business Systems, School Infrastructure NSW). Internal users can view the latest edition of the Asbestos Register in the AMS.

Please note: The Department's external website may not contain the latest revision of the Asbestos Register.

Notes 1: Vermiculite

- During 2018/19, all vermiculite occurrences in DoE schools identified in 2007/08, were 'composite tested' in accordance with a safe work NSW agreed procedure. This required multiple testing of all vermiculite occurrences.
- During the period 2007/08 to 2018/19, some vermiculite has been over sheeted and a warning is indicated for schools where this has happened.

Note 2: DoE website link for information is here:

<https://www.schoolinfrastructure.nsw.gov.au/about-us/working-with-us/schools-asbestos-register.html>

<https://education.nsw.gov.au/about-us/strategies-and-reports/our-reports-and-reviews/schools-asbestos-register>

Note 3: Material Condition Assessment

The material condition assessment descriptors from Section 3 of the Asbestos Management Plan (AMP) is extracted below. Please read the AMP in its entirety for further information.

3.3.2.1 Material condition assessment

The OART records the material condition of identified ACM in the following format:

Rating	Description
Good condition (1)	For non-friable asbestos that is sealed and has no visible damage. This primarily related to asbestos cement (AC) sheet and vinyl tiles
Minimal damage (2)	For non-friable asbestos that has a very small amount of damage, eg hairline cracks.
Some damage / unsealed (3)	For non-friable asbestos with significant breakage or several small areas where material has been damaged, revealing loose asbestos fibres. Non-friable asbestos that is unsealed.
Poor condition (4)	For non-friable asbestos that has extensive damage. Visible asbestos debris
Friable asbestos (5)	Any occurrence of friable asbestos

Product	Material Description	Extent	Location	Material Condition	Risk Status	Remediation Priority	Result
B00A - Administration - 1885 - Brick/Veneer							
Exterior							
Ceiling Voids	No Asbestos Found						
Underfloor Voids	No Asbestos Found						
Interior							
B00A - R0001 - Toilets-Girls - 8.54 m2							
No Asbestos							
B00A - R0002 - Staff - Toilet - 5.92 m2							
No Asbestos							
B00A - R0003 - Administration - Clerical - 19.28 m2							
No Asbestos							
B00A - R0004 - General Storeroom - 6.07 m2							
No Asbestos							
B00A - R0005 - Movement - 19.71 m2							
No Asbestos							
B00A - R0006 - Movement - 8.71 m2							
No Asbestos							
B00A - R0007 - Cleaning Store - Distributed - 1.93 m2							
No Asbestos							
B00A - R0008 - Ancillary Staff - 19.34 m2							
No Asbestos							
B00A - R0009 - Administration - Clerical - 29.92 m2							
No Asbestos							
B00A - R0010 - Movement - 17.28 m2							
No Asbestos							
B00A - R0011 - Movement - 18.71 m2							
No Asbestos							
B00A - R0012 - General Storeroom - 2.98 m2							
No Asbestos							
B00A - R0013 - Staff - Toilet - 12.4 m2							
No Asbestos							
B00A - R0014 - Deputy Principal Office - 22.85 m2							
No Asbestos							
B00A - R0015 - General Storeroom - 4.71 m2							
No Asbestos							
B00A - R0016 - Staff - Toilet - 3.05 m2							
No Asbestos							
B00A - R0017 - Principal Office - 29.49 m2							
No Asbestos							
B00A - R0019 - Stairs - .21 m2							
No Asbestos							
B00A - R0020 - Stairs - .28 m2							
No Asbestos							
B00A - R0021 - External Movement - 18.92 m2							
Ceiling Structures/Linings	Flat AC Sheeting	19m2	Throughout	Good Condition (1)	Low (1)	Low Priority (2-3)	Chrysotile (white asbestos), Amosite (brown asbestos)
B00A - R1001 - General Storeroom - 4.99 m2							
No Asbestos							
B00A - R1002 - Interview/Office - Type 1 - 9.18 m2							
No Asbestos							

B00A - R1003 - Seminar - 14.69 m2							
No Asbestos							
B00A - R1004 - Staff - Toilet - 4.18 m2							
No Asbestos							
B00A - R1005 - Cleaning Store - Distributed - 2.55 m2							
No Asbestos							
B00A - R1006 - Movement - 29.19 m2							
No Asbestos							
B00A - R1007 - Resource/Project Store - 19.28 m2							
No Asbestos							
B00A - R1008 - Commonroom - 29.92 m2							
No Asbestos							
B00A - R1009 - Movement - 17.28 m2							
No Asbestos							
B00A - R1010 - General Storeroom - 5.71 m2							
No Asbestos							
B00A - R1011 - Commonroom - 62.26 m2							
No Asbestos							
B00A - R1012 - General Storeroom - 9.11 m2							
No Asbestos							
B00A - R1013 - Stairs - 4.13 m2							
Ceiling Structures/Linings	Fibre Cement Casting (Monocrete)	8m2	Throughout	Good Condition (1)	Low (1)	Low Priority (2-3)	Chrysotile (white asbestos), Amosite (brown asbestos)
B00A - R1014 - Stairs - 1.84 m2							
No Asbestos							
B00B - Senior Learning/Administration - 1959 - Timber							
Exterior							
Eaves Linings	Flat AC Sheeting						
Wall Linings Internal - Infill	Flat AC Sheeting						
Ceiling Voids	No Asbestos Found						
Underfloor Voids	No Asbestos Found						
Interior							
B00B - R0006 - Duplicating Workroom - 61.17 m2							
No Asbestos							
B00B - R0008 - Senior Seminar - 60.44 m2							
No Asbestos							
B00B - R0010 - General Learning Space - 52.86 m2							
No Asbestos							
B00B - R0011 - External Movement - 37.66 m2							
No Asbestos							
B00B - R0013 - General Learning Space - 50.88 m2							
Floor Coverings Res/Textile	Vinyl Tiles (Under Floor Covering/Carpet)						
B00C - Science - 1959 - Timber							
Exterior							
Eaves Linings	Flat AC Sheeting	22m2	North facing, South facing	Good Condition (1)	Low (1)	Low Priority (2-3)	Chrysotile (white asbestos), Amosite (brown asbestos)
Ceiling Voids	No Asbestos Found						
Underfloor Voids	Packing		Throughout	Some Damage - Unsealed (3)	Low (1)	Low Priority (2-3)	Chrysotile (white asbestos), Amosite (brown asbestos), Crocidolite (blue asbestos)

Underfloor Voids	AC Fragments/Debris		Throughout	Some Damage - Unsealed (3)	Low (1)	Low Priority (2-3)	Chrysotile (white asbestos), Amosite (brown asbestos)
Interior							
B00C - R0001 - Cleaning Store - Distributed - 2.99 m2							
No Asbestos							
B00C - R0002 - Movement - 52.7 m2							
Ceiling Structures/Linings	Flat AC Sheeting	53m2	All surfaces	Good Condition (1)	Low (1)	Low Priority (2-3)	Chrysotile (white asbestos), Amosite (brown asbestos)
B00C - R0003 - Laboratory L.S. - 46.74 m2							
Floor Coverings Res/Textile	Vinyl Tiles						
B00C - R0004 - Staff Study - 14.58 m2							
No Asbestos							
B00C - R0005 - Preparation - 24.99 m2							
Floor Coverings Res/Textile	Vinyl Tiles						
Floor Coverings Res/Textile	Vinyl Tiles						
B00C - R0006 - Laboratory L.S. - 89.47 m2							
No Asbestos							
B00D - Music - 1959 - Timber							
Exterior							
Ceiling Voids	No Asbestos Found						
Underfloor Voids	Packing		Throughout	Some Damage - Unsealed (3)	Low (1)	Low Priority (2-3)	Chrysotile (white asbestos), Amosite (brown asbestos), Crocidolite (blue asbestos)
Underfloor Voids	AC Fragments/Debris		Throughout	Some Damage - Unsealed (3)	Low (1)	Low Priority (2-3)	Chrysotile (white asbestos), Amosite (brown asbestos), Crocidolite (blue asbestos)
Eaves Linings	Flat AC Sheeting	22m2	North facing, South facing	Good Condition (1)	Low (1)	Low Priority (2-3)	Chrysotile (white asbestos), Amosite (brown asbestos)
Interior							
B00D - R0002 - Practice/Seminar - 8.79 m2							
No Asbestos							
B00D - R0003 - Practice/Seminar - 8.92 m2							
No Asbestos							
B00D - R0004 - Practice/Seminar - 8.86 m2							
Floor Coverings Res/Textile	Vinyl Tiles	9m2	All surfaces	Good Condition (1)	Low (1)	Low Priority (2-3)	Chrysotile (white asbestos)
B00D - R0005 - Movement - 15.27 m2							
No Asbestos							
B00D - R0006 - Staff Study - 11.5 m2							
Floor Coverings Res/Textile	Vinyl Tiles	12m2	All surfaces	Minimal Damage (2)	Low (1)	Low Priority (2-3)	Chrysotile (white asbestos)
B00D - R0007 - Practice/Seminar - 11.42 m2							
Floor Coverings Res/Textile	Vinyl Tiles	12m2	All surfaces	Good Condition (1)	Low (1)	Low Priority (2-3)	Chrysotile (white asbestos)
B00D - R0011 - Movement - 9.01 m2							
Ceiling Structures/Linings	Flat AC Sheeting	9m2	All surfaces	Good Condition (1)	Low (1)	Low Priority (2-3)	Chrysotile (white asbestos), Amosite (brown asbestos)
B00D - R0012 - Music Learning Space - 127.53 m2							
No Asbestos							
B00F - General Learning/Technological & Applied Studies - 2003 - Brick/Veneer							
Exterior							
Ceiling Voids	No Asbestos Found						

Underfloor Voids	No Asbestos Found	
Interior		
B00F - R0001 - Computer Learning Space - 70.34 m2		
Floor Coverings Res/Textile	No Asbestos Found	
B00F - R0002 - Toilets-Disabled - 4.86 m2		
No Asbestos		
B00F - R0003 - Movement - 2.95 m2		
No Asbestos		
B00F - R0004 - Lift - 1.69 m2		
No Asbestos		
B00F - R0005 - Computer Store - 17.04 m2		
Floor Coverings Res/Textile	No Asbestos Found	
B00F - R0006 - General Learning Space - 66.68 m2		
No Asbestos		
B00F - R0007 - Distribution Board Cupboard - .62 m2		Note: No inspection of live electrical installation
No Asbestos		
B00F - R0008 - Materials Technology L.S. - 120.36 m2		
No Asbestos		
B00F - R0009 - Materials Store - 31.65 m2		
No Asbestos		
B00F - R0010 - Dust Extraction Space - 6.66 m2		
No Asbestos		
B00F - R0011 - L.P.G Store - 3.35 m2		
No Asbestos		
B00F - R0012 - Welding/Hot Metals Area - 6.1 m2		
No Asbestos		
B00F - R0013 - Metal Technology L.S. - 107.38 m2		
No Asbestos		
B00F - R0014 - Resource/Project Store - 28.87 m2		
No Asbestos		
B00F - R0015 - General Learning Space - 67.53 m2		
Floor Coverings Res/Textile	No Asbestos Found	
B00F - R0016 - Movement - 156.97 m2		
No Asbestos		
B00F - R0017 - Stairs - 15 m2		
No Asbestos		
B00F - R0018 - Cleaning Store - Distributed - 6.2 m2		
No Asbestos		
B00F - R1001 - General Learning Space - 59.39 m2		
Floor Coverings Res/Textile	No Asbestos Found	
B00F - R1002 - Staff Study - 33.22 m2		
Floor Coverings Res/Textile	No Asbestos Found	
B00F - R1003 - Movement - 3 m2		
No Asbestos		
B00F - R1004 - Lift - 1.69 m2		
No Asbestos		
B00F - R1005 - General Learning Space - 58.93 m2		

Floor Coverings Res/Textile	No Asbestos Found							
B00F - R1006 - Distribution Board Cupboard - .62 m2								Note: No inspection of live electrical installation
No Asbestos								
B00F - R1007 - General Learning Space - 59.02 m2								
Floor Coverings Res/Textile	No Asbestos Found							
B00F - R1008 - General Learning Space - 59.93 m2								
Floor Coverings Res/Textile	No Asbestos Found							
B00F - R1009 - Staff Study - 24.66 m2								
Floor Coverings Res/Textile	No Asbestos Found							
B00F - R1010 - Computer Learning Space - 60.02 m2								
Floor Coverings Res/Textile	No Asbestos Found							
B00F - R1011 - General Learning Space - 59.24 m2								
Floor Coverings Res/Textile	No Asbestos Found							
B00F - R1012 - Movement - 158.25 m2								
No Asbestos								
B00F - R1013 - Stairs - 23.35 m2								
No Asbestos								
B00H - Science/Staff Facilities - 1970 - Brick/Block								
Exterior								
Eaves Linings	Flat AC Sheeting							
Ceiling Voids	No Asbestos Found							
Underfloor Voids	No Asbestos Found							
Electrical - Communications Pit	Fibre Cement Casting (Monocrete)	1	Northeast corner of building	Some Damage - Unsealed (3)	Medium (2)	Medium Priority (4-5)	Chrysotile (white asbestos)	
Interior								
B00H - R0001 - Movement - 2.75 m2								
Floor Coverings Res/Textile	Vinyl Tiles	3m2	All surfaces	Good Condition (1)	Low (1)	Low Priority (2-3)	Chrysotile (white asbestos)	
B00H - R0002 - Apparatus Store - 14.72 m2								
Ceiling Structures/Linings	Vermiculite - Composite Sample - (10 - 40 m2) - (X3)							
Floor Coverings Res/Textile	Vinyl Tiles	15m2	All surfaces	Good Condition (1)	Low (1)	Low Priority (2-3)	Chrysotile (white asbestos)	
B00H - R0003 - Laboratory L.S. - 92.65 m2								
Ceiling Structures/Linings	Vermiculite - Composite Sample - (70 - 120 m2) - (X8)							
Floor Coverings Res/Textile	Vinyl Tiles	50m2	Room Perimeter	Good Condition (1)	Low (1)	Low Priority (2-3)	Chrysotile (white asbestos)	
B00H - R0006 - Movement - 13.01 m2								
Ceiling Structures/Linings	Vermiculite - Composite Sample - (10 - 40 m2) - (X3)							
Floor Coverings Res/Textile	Vinyl Tiles	14m2	All surfaces	Good Condition (1)	Low (1)	Low Priority (2-3)	Chrysotile (white asbestos)	
B00H - R0008 - Preparation - 48.4 m2								
Ceiling Structures/Linings	Vermiculite - Composite Sample - (40 - 70 m2) - (X5)							

Floor Coverings Res/Textile	Vinyl Tiles	49m2	All surfaces	Good Condition (1)	Low (1)	Low Priority (2-3)	Chrysotile (white asbestos)
B00H - R0009 - Staff - Toilet - 2.07 m2							
Ceiling Structures/Linings	Vermiculite - Composite Sample - (< 10 m2) - (X2)						
B00H - R0010 - Main Switchroom - 3.61 m2							
No Asbestos							
B00H - R0012 - Staff Study - 58.96 m2							
Ceiling Structures/Linings	Vermiculite - Composite Sample - (40 - 70 m2) - (X5)						
B00H - R0013 - Movement - 41.98 m2							
No Asbestos							
B00H - R0014 - Stairs - 14.54 m2							
No Asbestos							
B00H - R0015 - Science Laboratory - 86.92 m2							
Require Inspection							
B00H - R0016 - Movement - 4.23 m2							
Require Inspection							
B00H - R1005 - Preparation - 29.06 m2							
No Asbestos							
B00H - R1006 - Staff - Toilet - 2.96 m2							
No Asbestos							
B00H - R1007 - Cleaning Store - Distributed - 2.01 m2							
No Asbestos							
B00H - R1008 - Distribution Board Cupboard - .81 m2							
						Note: No inspection of live electrical installation	
No Asbestos							
B00H - R1009 - Staff - Toilet - 2.95 m2							
No Asbestos							
B00H - R1010 - Chemical Store - 12.54 m2							
Furniture / Fixtures	Compressed AC Sheet						
B00H - R1013 - Laboratory L.S. - 100.19 m2							
Ceiling Structures/Linings	Vermiculite - Composite Sample - (70 - 120 m2) - (X8)						
B00H - R1014 - Laboratory L.S. - 100.39 m2							
Ceiling Structures/Linings	Vermiculite - Composite Sample - (70 - 120 m2) - (X8)						
B00H - R1015 - Apparatus Store - 50.04 m2							
Ceiling Structures/Linings	Vermiculite - Composite Sample - (40 - 70 m2) - (X5)						
B00H - R1016 - Communications Cupboard - 2.37 m2							
No Asbestos							
B00H - R1018 - Movement - 25.68 m2							
No Asbestos							
B00H - R1019 - Movement - 32.38 m2							
Ceiling Structures/Linings	Flat AC Sheeting						
B00H - R1020 - Stairs - 14.54 m2							
Ceiling Structures/Linings	Flat AC Sheeting						
B00I - Multi Purpose Facilities - 1979 - Brick/Block							
Exterior							

Ceiling Voids	No Asbestos Found						
Underfloor Voids	No Asbestos Found						
Interior							
B00I - M0001 - General Storeroom - 5.53 m2							
No Asbestos							
B00I - M0002 - Control Room - 5.53 m2							
No Asbestos							
B00I - R0001 - Sport Equipment Store - 34.25 m2							
No Asbestos							
B00I - R0002 - Chair Store - 22.25 m2							
No Asbestos							
B00I - R0003 - Movement - 16 m2							
No Asbestos							
B00I - R0004 - Distribution Board Cupboard - 3.42 m2						Note: No inspection of live electrical installation	
No Asbestos							
B00I - R0005 - Toilets-Boys - 18.53 m2							
Partition Walls (Cubicles)	Compressed AC Sheet	6m2	All surfaces	Good Condition (1)	Low (1)	Low Priority (2-3)	Chrysotile (white asbestos)
B00I - R0006 - Shower/Change - 33.9 m2							
No Asbestos							
B00I - R0007 - Stage - 67.8 m2							
No Asbestos							
B00I - R0008 - Movement - 67.86 m2							
No Asbestos							
B00I - R0009 - Shower/Change - 33.9 m2							
Partition Walls (Cubicles)	Compressed AC Sheet	16m2	All surfaces	Good Condition (1)	Low (1)	Low Priority (2-3)	Chrysotile (white asbestos)
B00I - R0010 - Toilets-Girls - 18.53 m2							
Partition Walls (Cubicles)	Compressed AC Sheet	10m2	All surfaces	Good Condition (1)	Low (1)	Low Priority (2-3)	Chrysotile (white asbestos)
B00I - R0011 - Cleaning Store - Distributed - 3.42 m2							
No Asbestos							
B00I - R0012 - Movement - 16 m2							
No Asbestos							
B00I - R0013 - Staff Kitchen - 16.07 m2							
Floor Coverings Res/Textile	Vinyl Tiles						
B00I - R0014 - Chair Store - 9.18 m2							
Floor Coverings Res/Textile	Vinyl Tiles						
B00I - R0015 - General Storeroom - 9.18 m2							
Floor Coverings Res/Textile	Vinyl Tiles						
B00I - R0016 - Performing Arts Store - 21.54 m2							
No Asbestos							
B00I - R0017 - Multi-Purpose Space - 484.06 m2							
No Asbestos							
B00I - R0018 - Movement - 202.29 m2							
No Asbestos							
B00J - Building Services - 1941 - Brick/Block							
Exterior							
Ceiling Voids	No Asbestos Found						
Underfloor Voids	No Asbestos Found						

Interior							
B00J - R0001 - General Assistants - 21.06 m2							
No Asbestos							
B00J - R0002 - Garden Store Room - 13.02 m2							
No Asbestos							
B00J - R0003 - Cleaning Supplies Store - 17.12 m2							
No Asbestos							
B00J - R0004 - Machine Storage - 19.56 m2							
No Asbestos							
B00J - R0005 - General Storeroom - 4.56 m2							
No Asbestos							
B00J - R0006 - Sport Equipment Store - 26.74 m2							
No Asbestos							
B00J - R0007 - Maintenance Bulk Store - 12.53 m2							
No Asbestos							
B00J - R1001 - General Learning Space - 58.54 m2							
Ceiling Structures/Linings	Flat AC Sheeting	59m2	All surfaces	Good Condition (1)	Low (1)	Low Priority (2-3)	Chrysotile (white asbestos)
B00J - R1002 - Resources Store - 2.89 m2							
Ceiling Structures/Linings	Flat AC Sheeting	3m2	All surfaces	Good Condition (1)	Low (1)	Low Priority (2-3)	Chrysotile (white asbestos)
B00J - R1003 - Movement - 1.38 m2							
No Asbestos							
B00K - Agricultural Science - 2003 - Metal Shed							
Exterior							
Ceiling Voids	No Asbestos Found						
Underfloor Voids	No Asbestos Found						
Interior							
B00K - R0001 - Animal Space - 37.84 m2							
No Asbestos							
B00L - Agricultural Science - 2003 - Steel							
Exterior							
Underfloor Voids	No Asbestos Found						
Ceiling Voids	No Asbestos Found						
Interior							
B00L - R0001 - Class Tools Storage - 101.07 m2							
No Asbestos							
B00M - Pupil Facilities/Staff Facilities - 1941 - Brick/Block							
Exterior							
Electrical - Communications Pit	Fibre Cement Casting (Monocrete)	1	Northwest corner of building	Some Damage - Unsealed (3)	Medium (2)	Medium Priority (4-5)	Chrysotile (white asbestos), Amosite (brown asbestos)
Ceiling Voids	No Asbestos Found						
Underfloor Voids	No Asbestos Found						
Interior							
B00M - R0001 - Shower/Change - 30.12 m2							
Partition Walls (Cubicles)	Compressed AC Sheet	28m2	All surfaces	Good Condition (1)	Low (1)	Low Priority (2-3)	Chrysotile (white asbestos), Amosite (brown asbestos)
B00M - R0002 - General Storeroom - 18.64 m2							
No Asbestos							
B00M - R0003 - Staff Shower - 2.78 m2							
No Asbestos							

B00M - R0004 - No Access - 15.81 m2							
No Asbestos							
B00M - R0005 - Distribution Board Cupboard - 1.04 m2							
No Asbestos							
B00M - R0006 - Cleaning Store - Distributed - 3.1 m2							
No Asbestos							
B00M - R0007 - Toilets-Girls - 23.65 m2							
Partition Walls (Cubicles)	Compressed AC Sheet	34m2	All surfaces	Good Condition (1)	Low (1)	Low Priority (2-3)	Chrysotile (white asbestos), Amosite (brown asbestos)
B00M - R0008 - Staff Study - 25.84 m2							
No Asbestos							
B00M - R0009 - Staff - Toilet - 2.55 m2							
No Asbestos							
B00M - R0010 - Staff - Toilet - 2.64 m2							
No Asbestos							
B00M - R0011 - Sport Equipment Store - 4.56 m2							
Floor Coverings Res/Textile	Vinyl Tiles						
B00M - R0012 - General Storeroom - .69 m2							
No Asbestos							
B00M - R0013 - General Storeroom - .4 m2							
No Asbestos							
B00M - R0014 - Staff Study - 13.52 m2							
No Asbestos							
B00M - R0015 - Movement - 46.6 m2							
Ceiling Structures/Linings	Flat AC Sheeting	47m2	All surfaces	Good Condition (1)	Low (1)	Low Priority (2-3)	Chrysotile (white asbestos)
B00M - R0016 - General Storeroom - 3.77 m2							
No Asbestos							
B00N - Agricultural Science - 1941 - Brick/Block							
Exterior							
Ceiling Voids	No Asbestos Found						
Underfloor Voids	No Asbestos Found						
Interior							
B00N - R0001 - General Storeroom - 16.74 m2							
Wall Linings Internal	Flat AC Sheeting	40m2	All surfaces	Good Condition (1)	Low (1)	Low Priority (2-3)	Chrysotile (white asbestos)
Ceiling Structures/Linings	Flat AC Sheeting	17m2	All surfaces	Good Condition (1)	Low (1)	Low Priority (2-3)	Chrysotile (white asbestos)
B00N - R0002 - Machine Storage - 34.53 m2							
No Asbestos							
B00N - R0003 - Class Tools Storage - 16.32 m2							
Wall Linings Internal	Flat AC Sheeting	45m2	All surfaces	Good Condition (1)	Low (1)	Low Priority (2-3)	Chrysotile (white asbestos)
Ceiling Structures/Linings	Flat AC Sheeting	17m2	All surfaces	Good Condition (1)	Low (1)	Low Priority (2-3)	Chrysotile (white asbestos)
Floor Coverings Res/Textile	Vinyl Tiles						
B00N - R0004 - Movement - 2.59 m2							
No Asbestos							
B00N - R0005 - Class Tools Storage - 12.71 m2							
Wall Linings Internal	Flat AC Sheeting	34m2	All surfaces	Good Condition (1)	Low (1)	Low Priority (2-3)	Chrysotile (white asbestos)

Ceiling Structures/Linings	Flat AC Sheeting	13m2	All surfaces	Good Condition (1)	Low (1)	Low Priority (2-3)	Chrysotile (white asbestos)
B00N - R0006 - Machine Storage - 49.57 m2							
No Asbestos							
B00N - R0007 - Staff Study - 10.62 m2							
Wall Linings Internal	Flat AC Sheeting	35m2	All surfaces	Good Condition (1)	Low (1)	Low Priority (2-3)	Chrysotile (white asbestos)
Floor Coverings Res/Textile	Vinyl Tiles						
Ceiling Structures/Linings	Flat AC Sheeting	11m2	All surfaces	Good Condition (1)	Low (1)	Low Priority (2-3)	Chrysotile (white asbestos)
B00N - R0008 - Staff Shower - 1.78 m2							
Wall Linings Internal	Flat AC Sheeting	10m2	All surfaces	Good Condition (1)	Low (1)	Low Priority (2-3)	Chrysotile (white asbestos)
Floor Coverings Res/Textile	Vinyl Tiles						
Ceiling Structures/Linings	Flat AC Sheeting	2m2	All surfaces	Good Condition (1)	Low (1)	Low Priority (2-3)	Chrysotile (white asbestos)
B00N - R0009 - Staff - Toilet - 1.53 m2							
Wall Linings Internal	Flat AC Sheeting	8m2	All surfaces	Good Condition (1)	Low (1)	Low Priority (2-3)	Chrysotile (white asbestos)
Floor Coverings Res/Textile	Vinyl Tiles						
Ceiling Structures/Linings	Flat AC Sheeting	2m2	All surfaces	Good Condition (1)	Low (1)	Low Priority (2-3)	Chrysotile (white asbestos)
B00N - R0010 - Machine Storage - 24.68 m2							
No Asbestos							
B00N - R0011 - Machine Storage - 10.38 m2							
No Asbestos							
B00O - Agricultural Science - 2003 - Steel							
Exterior							
Gable Ends	Flat AC Sheeting						
Ceiling Voids	No Asbestos Found						
Underfloor Voids	No Asbestos Found						
Interior							
B00O - R0001 - Agriculture Covered Area - 18.89 m2							
Wall Linings Internal	Flat AC Sheeting						
B00O - R0002 - General Storeroom - 6 m2							
Wall Linings Internal	Flat AC Sheeting						
Ceiling Structures/Linings	Fibre Cement Casting (Monocrete)						
B00P - Agricultural Science - 1941 - Timber							
Exterior							
Eaves Linings	Flat AC Sheeting						
Ceiling Voids	No Asbestos Found						
Underfloor Voids	No Asbestos Found						
Interior							
B00P - R0001 - Movement - 25.7 m2							
No Asbestos							
B00P - R0002 - General Storeroom - 15.54 m2							
No Asbestos							
B00P - R0003 - General Learning Space - 78.74 m2							

No Asbestos							
B00Q - Agricultural Science - 1970 - Steel							
Exterior							
Ceiling Voids	No Asbestos Found						
Underfloor Voids	No Asbestos Found						
Interior							
B00Q - R0001 - Staff Shower - 3.3 m2							
Wall Linings Internal	Flat AC Sheeting	12m2	All surfaces	Good Condition (1)	Low (1)	Low Priority (2-3)	Chrysotile (white asbestos)
Ceiling Structures/Linings	Flat AC Sheeting	4m2	All surfaces	Good Condition (1)	Low (1)	Low Priority (2-3)	Chrysotile (white asbestos)
B00Q - R0002 - Staff - Toilet - 1.65 m2							
No Asbestos							
B00Q - R0003 - Machine Storage - 33.56 m2							
No Asbestos							
B00Q - R0004 - Ancillary Staff - 13.37 m2							
Floor Coverings Res/Textile	Vinyl Tiles	14m2	Throughout	Poor Condition - Extensive Damage (4)	Medium (2)	High Priority (6-8)	Chrysotile (white asbestos)
B00Q - R0005 - Movement - 4 m2							
No Asbestos							
B00S - Agricultural Science - 2003 - Steel							
Exterior							
Ceiling Voids	No Asbestos Found						
Underfloor Voids	No Asbestos Found						
Interior							
B00S - R0001 - Machine Storage - 75.87 m2							
No Asbestos							
B00T - Tiered Learning - 1999 - Brick/Veneer							
Exterior							
Ceiling Voids	No Asbestos Found						
Underfloor Voids	No Asbestos Found						
Interior							
B00T - R0001 - General Storeroom - 43.54 m2							
No Asbestos							
B00T - R0002 - Tiered Learning Area - 247.19 m2							
Floor Coverings Res/Textile	No Asbestos Found						
B00T - R0003 - Control Room - 12.37 m2							
Floor Coverings Res/Textile	No Asbestos Found						
B00T - R0004 - Movement - 35.99 m2							
Floor Coverings Res/Textile	No Asbestos Found						
B00T - R0005 - Disabled Toilet - 6.44 m2							
No Asbestos							
B00T - R0006 - Cleaning Store - Distributed - 2.91 m2							
No Asbestos							
B00T - R0007 - Staff Kitchen - 12.81 m2							
No Asbestos							
B00T - R9001 - Plant - 39.84 m2							
No Asbestos							

B00U - Agricultural Science - 2003 - Steel

Exterior

Ceiling Voids	No Asbestos Found	
---------------	-------------------	--

Underfloor Voids	No Asbestos Found	
------------------	-------------------	--

Interior

B00U - R0001 - Machine Storage - 75.86 m2

No Asbestos	
-------------	--

B00U - R0002 - Movement - .95 m2

No Asbestos	
-------------	--

B00V - Agricultural Science - 2003 - Metal Shed

Exterior

Ceiling Voids	No Asbestos Found	
---------------	-------------------	--

Underfloor Voids	No Asbestos Found	
------------------	-------------------	--

Interior

B00V - R0001 - Class Tools Storage - 18.73 m2

No Asbestos	
-------------	--

B00V - R0002 - Machine Storage - 56.51 m2

No Asbestos	
-------------	--

B00W - Pupil Facilities - 2004 - Brick/Veneer

Exterior

Ceiling Voids	No Asbestos Found	
---------------	-------------------	--

Underfloor Voids	No Asbestos Found	
------------------	-------------------	--

Interior

B00W - R0001 - Duplicating Workroom - 42.03 m2

No Asbestos	
-------------	--

B00W - R0002 - Administration - Clerical - 10.05 m2

No Asbestos	
-------------	--

B00W - R0003 - Office/Store - 16.99 m2

No Asbestos	
-------------	--

B00W - R0004 - Disabled Toilet - 5.94 m2

No Asbestos	
-------------	--

B00W - R0005 - Movement - 14.73 m2

No Asbestos	
-------------	--

B00W - R0006 - Clinic - Girls - 9.89 m2

No Asbestos	
-------------	--

B00W - R0007 - Clinic - Boys - 8.61 m2

No Asbestos	
-------------	--

B00W - R0008 - Pantry - 10.6 m2

No Asbestos	
-------------	--

B00W - R0009 - Pantry - 8.91 m2

No Asbestos	
-------------	--

B00W - R0010 - Student Canteen - 33.28 m2

No Asbestos	
-------------	--

B00W - R0011 - Student Canteen - 60.01 m2

No Asbestos	
-------------	--

B00W - R0012 - Covered Area - 141.03 m2

No Asbestos	
-------------	--

B00W - R0013 - Movement - 37.54 m2

No Asbestos	
-------------	--

B00W - R0014 - Toilets - Girls - 26.47 m2

No Asbestos	
-------------	--

B00W - R0015 - Toilets - Boys - 26.4 m2							
No Asbestos							
B00W - R0016 - Distribution Board Cupboard - 1.06 m2							Note: No inspection of live electrical installation
No Asbestos							
B00W - R0017 - Movement - 69.66 m2							
No Asbestos							
B00W - R0018 - Movement - 43.78 m2							
No Asbestos							
B00X - Other - 1958 - Brick/Veneer							
Exterior							
Underfloor Voids	Flat AC Sheeting	0.5	Throughout	Minimal Damage (2)	Low (1)	Low Priority (2-3)	Chrysotile (white asbestos)
Underfloor Voids - Stored / Debris Material	Flat AC Sheeting	0.5	Throughout	Minimal Damage (2)	Low (1)	Low Priority (2-3)	Chrysotile (white asbestos), Amosite (brown asbestos)
Wall Cladding	Flat AC Sheeting	85m2	Throughout	Minimal Damage (2)	Low (1)	Low Priority (2-3)	Chrysotile (white asbestos), Amosite (brown asbestos)
Wall Cladding	Flat AC Sheeting	0.5m2	Throughout	Minimal Damage (2)	Low (1)	Low Priority (2-3)	Chrysotile (white asbestos), Amosite (brown asbestos)
Eaves Linings	Flat AC Sheeting	0.5m2	Throughout	Good Condition (1)	Low (1)	Low Priority (2-3)	Chrysotile (white asbestos)
Ceiling Voids - Pitched Roof	No Asbestos Found						
Interior							
B00X - R0001 - External Movement - 7.94 m2							
Wall Linings Internal	Flat AC Sheeting	4m2	West	Good Condition (1)	Low (1)	Low Priority (2-3)	Chrysotile (white asbestos)
Ceiling Structures/Linings	Flat AC Sheeting	6m2	Throughout	Good Condition (1)	Low (1)	Low Priority (2-3)	Chrysotile (white asbestos), Crocidolite (blue asbestos)
Ceiling Structures/Linings	Flat AC Sheeting	0.5m2	Throughout	Good Condition (1)	Low (1)	Low Priority (2-3)	Chrysotile (white asbestos)
B00X - R0002 - Seminar - 52.41 m2							
No Asbestos							
B00X - R0003 - Staff - Toilet - 4.06 m2							
Wall Linings Internal - Infill	Textile						
B00X - R0004 - Movement - 3.95 m2							
No Asbestos							
B00X - R0005 - Staff Lounge - 13.69 m2							
No Asbestos							
B00X - R0006 - Staff Kitchen - 10.28 m2							
Floor Coverings Res/Textile	Vinyl Tiles - Adhesive						
Floor Coverings Res/Textile	Vinyl Sheet						
B00X - R0007 - General Storeroom - 9.15 m2							
No Asbestos							
B00X - R0008 - Movement - 8.33 m2							
Wall Linings Internal	Flat AC Sheeting	1m2	Throughout	Good Condition (1)	Low (1)	Low Priority (2-3)	Chrysotile (white asbestos)
Ceiling Structures/Linings	Flat AC Sheeting						
Wall Linings Internal	Flat AC Sheeting	26m2	Throughout	Good Condition (1)	Low (1)	Low Priority (2-3)	Chrysotile (white asbestos)
B00X - R0009 - General Storeroom - 8.25 m2							

No Asbestos		
B00Y - Other - 1958 - Fibre Cement Clad		
Exterior		
Ceiling Voids - Flat Roof	No Asbestos Found	
Underfloor Voids - Slab on Ground	No Asbestos Found	
Wall Cladding	Flat AC Sheeting	
Interior		
B00Y - R0001 - No Access - 10.35 m2		
Ceiling Structures/Linings	Flat AC Sheeting	
Wall Cladding	Flat AC Sheeting	
B00Z - Agricultural Science - 2007 - Metal Shed		
Exterior		
Ceiling Voids	No Asbestos Found	
Underfloor Voids	No Asbestos Found	
Interior		
B00Z - R0001 - General Storeroom - 12.11 m2		
No Asbestos		
B0A1 - General Learning/Art - 1996 - Brick/Veneer		
Exterior		
Ceiling Voids	No Asbestos Found	
Underfloor Voids	No Asbestos Found	
Interior		
B0A1 - R0001 - Cleaning Store - Distributed - 7.21 m2		
No Asbestos		
B0A1 - R0002 - Art Learning Space - 58.77 m2		
No Asbestos		
B0A1 - R0003 - Kiln Space - 9.12 m2		
No Asbestos		
B0A1 - R0004 - Art Learning Space - 50.68 m2		
No Asbestos		
B0A1 - R0005 - General Learning Space - 60.23 m2		
No Asbestos		
B0A1 - R0006 - Staff Study - 23.6 m2		
Floor Coverings Res/Textile	No Asbestos Found	
B0A1 - R0007 - Secure Storeroom - 6.69 m2		
Floor Coverings Res/Textile	No Asbestos Found	
B0A1 - R0008 - Bulk Store - 13.6 m2		
No Asbestos		
B0A1 - R0009 - Distribution Board Cupboard - .75 m2		
No Asbestos		Note: No inspection of live electrical installation
B0A1 - R0011 - Stairs - 17.42 m2		
No Asbestos		
B0A1 - R0012 - Movement - 122.24 m2		
No Asbestos		
B0A1 - R1001 - Darkroom Space - 29.01 m2		
No Asbestos		
B0A1 - R1002 - General Learning Space - 46.96 m2		
No Asbestos		

Floor Coverings Res/Textile	No Asbestos Found	
B0A1 - R1003 - General Learning Space - 46.97 m2		
Floor Coverings Res/Textile	No Asbestos Found	
B0A1 - R1004 - General Learning Space - 45.05 m2		
Floor Coverings Res/Textile	No Asbestos Found	
B0A1 - R1005 - Study Space - 16.31 m2		
Floor Coverings Res/Textile	No Asbestos Found	
B0A1 - R1006 - Secure Storeroom - 15.45 m2		
Floor Coverings Res/Textile	No Asbestos Found	
B0A1 - R1007 - Distribution Board Cupboard - .63 m2		Note: No inspection of live electrical installation
No Asbestos		
B0A1 - R1008 - Movement - 103.74 m2		
No Asbestos		
B0A1 - R1009 - Stairs - 24.48 m2		
No Asbestos		
B0AA - Building Services - 2007 - Steel		
Exterior		
Ceiling Voids	No Asbestos Found	
Underfloor Voids	No Asbestos Found	
Interior		
B0AA - R0001 - General Assistants - 67.28 m2		
No Asbestos		
B0C1 - Music - 2010 - Timber		
Exterior		
Ceiling Voids	No Asbestos Found	
Underfloor Voids	No Asbestos Found	
Interior		
B0C1 - R0001 - External Movement - 2.75 m2		
No Asbestos		
B0C1 - R0002 - Staff Study - 10.2 m2		
No Asbestos		
B0C1 - R0003 - Staff Kitchen - 5.24 m2		
No Asbestos		
B0C1 - R0004 - Handwashing Facilities - 2.8 m2		
No Asbestos		
B0C1 - R0005 - Staff - Toilet - 1.82 m2		
No Asbestos		
B0C1 - R0006 - Music Learning Space - 119.73 m2		
No Asbestos		
B0C1 - R0007 - External Movement - 4.79 m2		
No Asbestos		
B0D1 - General Learning/Library - 1996 - Brick/Veneer		
Exterior		
Ceiling Voids	No Asbestos Found	
Underfloor Voids	No Asbestos Found	
Interior		
B0D1 - R0001 - General Storeroom - 5.88 m2		

No Asbestos		
B0D1 - R0002 - Staff - Toilet - 6.1 m2		
No Asbestos		
B0D1 - R0003 - Toilets-Girls - 22.22 m2		
No Asbestos		
B0D1 - R0004 - Movement - 77.12 m2		
Floor Coverings Res/Textile	No Asbestos Found	
B0D1 - R0005 - General Learning Space - 46.47 m2		
Floor Coverings Res/Textile	No Asbestos Found	
B0D1 - R0006 - General Learning Space - 53.3 m2		
Floor Coverings Res/Textile	No Asbestos Found	
B0D1 - R0007 - Commonroom - 98.7 m2		
Floor Coverings Res/Textile	No Asbestos Found	
B0D1 - R0008 - Staff Study - 33.73 m2		
Floor Coverings Res/Textile	No Asbestos Found	
B0D1 - R0009 - General Learning Space - 46.13 m2		
Floor Coverings Res/Textile	No Asbestos Found	
B0D1 - R0010 - Cleaning Store - Distributed - 3.66 m2		
No Asbestos		
B0D1 - R0011 - Toilets-Boys - 18.03 m2		
No Asbestos		
B0D1 - R0012 - Staff - Toilet - 6.15 m2		
No Asbestos		
B0D1 - R0013 - General Storeroom - 5.88 m2		
No Asbestos		
B0D1 - R0014 - Movement - 25.03 m2		
No Asbestos		
B0D1 - R0015 - Interview/Office - Type 1 - 12.74 m2		
Floor Coverings Res/Textile	No Asbestos Found	
B0D1 - R0016 - Distribution Board Cupboard - .96 m2		
		Note: No inspection of live electrical installation
No Asbestos		
B0D1 - R0017 - Secure Storeroom - 16.63 m2		
Floor Coverings Res/Textile	No Asbestos Found	
B0D1 - R0018 - General Learning Space - 49.74 m2		
Floor Coverings Res/Textile	No Asbestos Found	
B0D1 - R0019 - General Learning Space - 49.52 m2		
Floor Coverings Res/Textile	No Asbestos Found	
B0D1 - R0020 - General Storeroom - 16.72 m2		
Floor Coverings Res/Textile	No Asbestos Found	
B0D1 - R0021 - Distribution Board Cupboard - .91 m2		
		Note: No inspection of live electrical installation
No Asbestos		
B0D1 - R0022 - Interview/Office - Type 1 - 12.58 m2		
Floor Coverings Res/Textile	No Asbestos Found	

B0D1 - R0023 - Movement - 25 m2		
No Asbestos		
B0D1 - R0024 - Movement - 95.75 m2		
No Asbestos		
B0D1 - R0025 - Movement - 3.76 m2		
No Asbestos		
B0D1 - R0026 - Movement - 3.94 m2		
No Asbestos		
B0D1 - R0027 - Movement - 3.76 m2		
No Asbestos		
B0D1 - R0028 - Movement - 4 m2		
No Asbestos		
B0D1 - R0029 - Movement - 37.84 m2		
No Asbestos		
B0D1 - R0030 - Stairs - 5.34 m2		
No Asbestos		
B0D1 - R0031 - Stairs - 5.34 m2		
No Asbestos		
B0D1 - R1001 - Interview/Office - Type 1 - 13 m2		
Floor Coverings Res/Textile	No Asbestos Found	
B0D1 - R1002 - Careers Advisers Office - 13 m2		
Floor Coverings Res/Textile	No Asbestos Found	
B0D1 - R1003 - Senior Study - 60.47 m2		
Floor Coverings Res/Textile	No Asbestos Found	
B0D1 - R1004 - Main Area - 378.9 m2		
Floor Coverings Res/Textile	No Asbestos Found	
B0D1 - R1005 - Study Space - 60.6 m2		
Floor Coverings Res/Textile	No Asbestos Found	
B0D1 - R1006 - Seminar - 12.97 m2		
Floor Coverings Res/Textile	No Asbestos Found	
B0D1 - R1007 - Seminar - 13.04 m2		
Floor Coverings Res/Textile	No Asbestos Found	
B0D1 - R1008 - Distribution Board Cupboard - .91 m2		
		Note: No inspection of live electrical installation
No Asbestos		
B0D1 - R1009 - Communications Cupboard - 2.14 m2		
No Asbestos		
B0D1 - R1010 - Staff Study - 22.61 m2		
Floor Coverings Res/Textile	No Asbestos Found	
B0D1 - R1011 - Librarian - 10.77 m2		
Floor Coverings Res/Textile	No Asbestos Found	
B0D1 - R1012 - Library Office/Workroom - 36.3 m2		
Floor Coverings Res/Textile	No Asbestos Found	
B0D1 - R1013 - Distribution Board Cupboard - 1.01 m2		
		Note: No inspection of live electrical installation
No Asbestos		
B0D1 - R1014 - Movement - 140.64 m2		

No Asbestos							
B0D1 - R1015 - Stairs - 19.47 m2							
No Asbestos							
B0D1 - R1016 - Stairs - 19.47 m2							
No Asbestos							
B0F1 - General Learning/Science - 1967 - Brick/Block							
Exterior							
Eaves Linings	Flat AC Sheeting	120m2	North facing, South facing	Good Condition (1)	Low (1)	Low Priority (2-3)	Chrysotile (white asbestos), Amosite (brown asbestos)
Wall Linings Internal - Infill	Flat AC Sheeting	180	North facing, South facing, Middle portion, Lower portion	Good Condition (1)	Low (1)	Low Priority (2-3)	Chrysotile (white asbestos), Amosite (brown asbestos)
Ceiling Voids	No Asbestos Found						
Underfloor Voids	No Asbestos Found						
Interior							
B0F1 - R0001 - Cleaning Store - Distributed - 5.32 m2							
No Asbestos							
B0F1 - R0002 - Laboratory L.S. - 67.92 m2							
Ceiling Structures/Linings	Vermiculite - Composite Sample - (40 - 70 m2) - (X5)						
Floor Coverings Res/Textile	Vinyl Tiles	68m2	Throughout	Good Condition (1)	Low (1)	Low Priority (2-3)	Chrysotile (white asbestos)
Floor Coverings Res/Textile	Vinyl Tiles						
B0F1 - R0003 - Staff Study - 8.64 m2							
Ceiling Structures/Linings	Vermiculite - Composite Sample - (< 10 m2) - (X2)						
B0F1 - R0004 - Preparation - 17.29 m2							
Ceiling Structures/Linings	Vermiculite - Composite Sample - (10 - 40 m2) - (X3)						
B0F1 - R0006 - Laboratory L.S. - 93.85 m2							
Ceiling Structures/Linings	Vermiculite - Composite Sample - (70 - 120 m2) - (X8)						
B0F1 - R0007 - Movement - 103.05 m2							
Floor Coverings Res/Textile	Vinyl Tiles	104m2	All surfaces	Good Condition (1)	Low (1)	Low Priority (2-3)	Chrysotile (white asbestos)
Ceiling Structures/Linings	Vermiculite - Composite Sample - (70 - 120 m2) - (X8)						
B0F1 - R0008 - Movement - 22.89 m2							
Ceiling Structures/Linings	Vermiculite - Composite Sample - (10 - 40 m2) - (X3)	23m2	Throughout	Good Condition (1)	Low (1)	Low Priority (2-3)	Assumed Asbestos
B0F1 - R0009 - General Storeroom - 8.17 m2							
No Asbestos							
B0F1 - R0010 - General Learning Space - 101.8 m2							
Ceiling Structures/Linings	Vermiculite - Composite Sample - (70 - 120 m2) - (X8)	102m2	Throughout	Good Condition (1)	Low (1)	Low Priority (2-3)	Assumed Asbestos
B0F1 - R0011 - Movement - 1.39 m2							
No Asbestos							
B0F1 - R0012 - Stairs - .3 m2							
No Asbestos							

B0F1 - R0013 - Movement - 1.59 m2							
No Asbestos							
B0F1 - R0014 - Stairs - 3.9 m2							
Ceiling Structures/Linings	Vermiculite - Composite Sample - (< 10 m2) - (X2)						
B0F1 - R1001 - General Storeroom - 8.52 m2							
Ceiling Structures/Linings	Vermiculite - Composite Sample - (< 10 m2) - (X2)						
Floor Coverings Res/Textile	Vinyl Tiles	9m2	Throughout	Mnimal Damage (2)	Low (1)	Low Priority (2-3)	Chrysotile (white asbestos)
B0F1 - R1002 - Shared Study Space - 26.57 m2							
Ceiling Structures/Linings	Vermiculite - Composite Sample - (10 - 40 m2) - (X3)						
B0F1 - R1003 - General Learning Space - 52.94 m2							
Ceiling Structures/Linings	Vermiculite - Composite Sample - (40 - 70 m2) - (X5)						
B0F1 - R1004 - General Learning Space - 52.94 m2							
Ceiling Structures/Linings	Vermiculite - Composite Sample - (40 - 70 m2) - (X5)						
B0F1 - R1005 - General Learning Space - 52.94 m2							
Ceiling Structures/Linings	Vermiculite - Composite Sample - (40 - 70 m2) - (X5)						
B0F1 - R1006 - General Learning Space - 53.31 m2							
Ceiling Structures/Linings	Vermiculite - Composite Sample - (40 - 70 m2) - (X5)						
B0F1 - R1007 - General Learning Space - 52.57 m2							
Ceiling Structures/Linings	Vermiculite - Composite Sample - (40 - 70 m2) - (X5)						
B0F1 - R1008 - Movement - 102.26 m2							
Floor Coverings Res/Textile	Vinyl Tiles	103m2	All surfaces	Good Condition (1)	Low (1)	Low Priority (2-3)	Chrysotile (white asbestos)
Ceiling Structures/Linings	Vermiculite - Composite Sample - (70 - 120 m2) - (X8)						
B0F1 - R1009 - Stairs - 13.87 m2							
Ceiling Structures/Linings	Vermiculite - Composite Sample - (10 - 40 m2) - (X3)						
Wall Linings Internal - Infill	Flat AC Sheeting	4m2	North facing, Lower portion	Good Condition (1)	Low (1)	Low Priority (2-3)	Chrysotile (white asbestos) , Amosite (brown asbestos)
B0F1 - R1010 - Stairs - 13.91 m2							
Ceiling Structures/Linings	Vermiculite - Composite Sample - (10 - 40 m2) - (X3)						
Wall Linings Internal - Infill	Flat AC Sheeting	4m2	North facing, Lower portion	Good Condition (1)	Low (1)	Low Priority (2-3)	Chrysotile (white asbestos) , Amosite (brown asbestos)
B0F1 - R9001 - General Storeroom - 15.94 m2							
No Asbestos							
B0F1 - R9002 - General Storeroom - 16.12 m2							
No Asbestos							
B0F1 - R9003 - General Storeroom - 15.34 m2							
No Asbestos							

B0F2 - General Learning/Science - 1967 - Brick/Block

Exterior

Eaves Linings	Flat AC Sheeting	60m2	North facing, South facing	Good Condition (1)	Low (1)	Low Priority (2-3)	Chrysotile (white asbestos), Amosite (brown asbestos)
Wall Linings Internal - Infill	Flat AC Sheeting	80	North facing, South facing, Middle portion, Lower portion	Good Condition (1)	Low (1)	Low Priority (2-3)	Chrysotile (white asbestos), Amosite (brown asbestos)
Ceiling Voids	No Asbestos Found						
Underfloor Voids	No Asbestos Found						

Interior

B0F2 - R0002 - Laboratory L.S. - 88.46 m2

Ceiling Structures/Linings	Vermiculite - Composite Sample - (70 - 120 m2) - (X8)						
Furniture / Fixtures	Compressed AC Sheet	1	North facing	Good Condition (1)	Low (1)	Low Priority (2-3)	Chrysotile (white asbestos), Amosite (brown asbestos)
Furniture / Fixtures	Compressed AC Sheet	2	North facing	Good Condition (1)	Low (1)	Low Priority (2-3)	Chrysotile (white asbestos)

B0F2 - R0006 - Movement - 7.97 m2

No Asbestos

B0F2 - R0007 - Chemical Store - 6.64 m2

Floor Coverings Res/Textile	Vinyl Tiles						
-----------------------------	-------------	--	--	--	--	--	--

B0F2 - R0008 - Distribution Board Cupboard - .6 m2

Note: No inspection of live electrical installation

Ceiling Structures/Linings	Flat AC Sheeting	1m2	All surfaces	Minimal Damage (2)	Low (1)	Low Priority (2-3)	Chrysotile (white asbestos), Amosite (brown asbestos)
----------------------------	------------------	-----	--------------	--------------------	---------	--------------------	---

B0F2 - R0010 - Movement - 30.08 m2

No Asbestos

B0F2 - R0011 - Preparation - 16.58 m2

Ceiling Structures/Linings	Vermiculite - Composite Sample - (10 - 40 m2) - (X3)						
----------------------------	---	--	--	--	--	--	--

B0F2 - R0012 - Computer Learning Space - 35.66 m2

Ceiling Structures/Linings	Vermiculite - Composite Sample - (10 - 40 m2) - (X3)						
----------------------------	---	--	--	--	--	--	--

B0F2 - R0013 - Lift - 1.42 m2

No Asbestos

B0F2 - R0014 - No Access - 2.91 m2

No Asbestos

B0F2 - R0015 - Movement - 109.97 m2

Ceiling Structures/Linings	Vermiculite - Composite Sample - (70 - 120 m2) - (X8)						
----------------------------	--	--	--	--	--	--	--

B0F2 - R0016 - Stairs - 10.77 m2

No Asbestos

B0F2 - R0017 - Stairs - 10.69 m2

No Asbestos

B0F2 - R1005 - Cleaning Store - Distributed - 2.66 m2

No Asbestos

B0F2 - R1008 - Staff - Toilet - 6.49 m2

Ceiling Structures/Linings	Vermiculite - Composite Sample - (< 10 m2) - (X2)						
----------------------------	--	--	--	--	--	--	--

B0F2 - R1009 - Resources Space - 13.18 m2

Ceiling Structures/Linings	Vermiculite - Composite Sample - (10 - 40 m2) - (X3)							
B0F2 - R1010 - Distribution Board Cupboard - .55 m2								Note: No inspection of live electrical installation
Ceiling Structures/Linings	Flat AC Sheeting	1m2	All surfaces	Some Damage - Unsealed (3)	Medium (2)	Low Priority (2-3)	Chrysotile (white asbestos) , Amosite (brown asbestos)	
B0F2 - R1011 - General Learning Space - 55.95 m2								
Ceiling Structures/Linings	Vermiculite - Composite Sample - (40 - 70 m2) - (X5)							
B0F2 - R1012 - Staff Study - 45.39 m2								
Ceiling Structures/Linings	Vermiculite - Composite Sample - (40 - 70 m2) - (X5)							
B0F2 - R1013 - Movement - 106.82 m2								
Ceiling Structures/Linings	Vermiculite - Composite Sample - (70 - 120 m2) - (X8)							
B0F2 - R1014 - General Storeroom - 2.72 m2								
Ceiling Structures/Linings	Vermiculite - Composite Sample - (< 10 m2) - (X2)							
B0F2 - R1015 - General Learning Space - 53.02 m2								
Ceiling Structures/Linings	Vermiculite - Composite Sample - (40 - 70 m2) - (X5)							
B0F2 - R1016 - Lift - 1.42 m2								
No Asbestos								
B0F2 - R1017 - Stairs - 17.64 m2								
No Asbestos								
B0F2 - R1018 - Stairs - 17.68 m2								
No Asbestos								
B0F2 - R2001 - General Learning Space - 55.72 m2								
Ceiling Structures/Linings	Vermiculite - Composite Sample - (40 - 70 m2) - (X5)							
B0F2 - R2002 - General Learning Space - 52.37 m2								
Ceiling Structures/Linings	Vermiculite - Composite Sample - (40 - 70 m2) - (X5)							
B0F2 - R2003 - General Storeroom - 8.72 m2								
Floor Coverings Res/Textile	Vinyl Tiles							
Ceiling Structures/Linings	Flat AC Sheeting	9m2	All surfaces	Good Condition (1)	Low (1)	Low Priority (2-3)	Chrysotile (white asbestos) , Amosite (brown asbestos)	
B0F2 - R2004 - Cleaning Store - Distributed - 2.67 m2								
No Asbestos								
B0F2 - R2005 - General Learning Space - 66.79 m2								
Ceiling Structures/Linings	Vermiculite - Composite Sample - (40 - 70 m2) - (X5)							
B0F2 - R2007 - Distribution Board Cupboard - 1.01 m2								Note: No inspection of live electrical installation
Ceiling Structures/Linings	Flat AC Sheeting	2m2	All surfaces	Some Damage - Unsealed (3)	Medium (2)	Low Priority (2-3)	Chrysotile (white asbestos) , Amosite (brown asbestos)	
B0F2 - R2008 - Shared Study Space - 26.29 m2								
Ceiling Structures/Linings	Vermiculite - Composite Sample - (10 - 40 m2) - (X3)							
B0F2 - R2009 - Movement - 71.27 m2								

Ceiling Structures/Linings	Vermiculite - Composite Sample - (70 - 120 m2) - (X8)						
B0F2 - R2010 - Lift - 1.42 m2							
No Asbestos							
B0F2 - R2011 - Stairs - 17.64 m2							
Ceiling Structures/Linings	Vermiculite - Composite Sample - (10 - 40 m2) - (X3)						
Wall Linings Internal - Infill	Flat AC Sheeting	3m2	South facing, Lower portion	Good Condition (1)	Low (1)	Low Priority (2-3)	Chrysotile (white asbestos) , Amosite (brown asbestos)
B0F2 - R2012 - Stairs - 17.68 m2							
Ceiling Structures/Linings	Vermiculite - Composite Sample - (10 - 40 m2) - (X3)						
Wall Linings Internal - Infill	Flat AC Sheeting	1m2	South facing, Lower portion	Good Condition (1)	Low (1)	Low Priority (2-3)	Chrysotile (white asbestos) , Amosite (brown asbestos)
B0G1 - Multi Purpose Facilities - 2017 - Steel Framed							
Exterior							
No Asbestos							
Interior							
B0G1 - R0001 - Gymnasium - 644.07 m2							
No Asbestos							
B0G1 - R0002 - First Aid - 16.62 m2							
No Asbestos							
B0G1 - R0003 - Cleaning Supplies Store - 3.43 m2							
No Asbestos							
B0G1 - R0004 - Access Student Shower/Toilet - Type 2 - 6.33 m2							
No Asbestos							
B0G1 - R0005 - Distribution Board Cupboard - .94 m2							
No Asbestos							
B0G1 - R0006 - Change - 32.54 m2							
No Asbestos							
B0G1 - R0007 - Chair Store - 33.54 m2							
No Asbestos							
B0G1 - R0008 - General Storeroom - 33.59 m2							
No Asbestos							
B0G1 - R0009 - Change - 33.64 m2							
No Asbestos							
B0G1 - R0010 - External Movement - 179.02 m2							
No Asbestos							
B0G1 - R0011 - Tiered Learning Area - 38.27 m2							
No Asbestos							
B0G1 - R0012 - External Movement - 6.21 m2							
No Asbestos							
B0H1 - Agricultural Science - 1996 - Brick/Veneer							
Exterior							
Ceiling Voids	No Asbestos Found						
Underfloor Voids	No Asbestos Found						
Interior							
B0H1 - R0001 - Animal Space - 29.22 m2							
No Asbestos							
B0H1 - R0002 - Movement - 15.1 m2							

No Asbestos							
B0H1 - R0003 - Animal Space - 12.32 m2							
Ceiling Structures/Linings	Flat AC Sheeting						
Wall Linings Internal	Flat AC Sheeting						
B0H1 - R0004 - Class Tools Storage - 12.44 m2							
Wall Linings Internal	Flat AC Sheeting						
Ceiling Structures/Linings	Flat AC Sheeting						
B0H1 - R0005 - Animal Space - 25.9 m2							
No Asbestos							
B0L2 - Pupil Facilities - 1959 - Brick/Block							
Exterior							
Ceiling Voids	No Asbestos Found						
Underfloor Voids	Mastic						
Interior							
B0L2 - R0001 - Sport Equipment Store - 37.19 m2							
No Asbestos							
B0L2 - R0002 - Shower/Change - 25.52 m2							
Ceiling Structures/Linings	Flat AC Sheeting	26m2	All surfaces	Good Condition (1)	Low (1)	Low Priority (2-3)	Chrysotile (white asbestos)
B0L2 - R0003 - Staff Change - 9.75 m2							
Ceiling Structures/Linings	Flat AC Sheeting	10m2	All surfaces	Good Condition (1)	Low (1)	Low Priority (2-3)	Chrysotile (white asbestos)
B0L2 - R0004 - Movement - 6.4 m2							
Ceiling Structures/Linings	Flat AC Sheeting	7m2	All surfaces	Good Condition (1)	Low (1)	Low Priority (2-3)	Chrysotile (white asbestos)
B0L2 - R0005 - Distribution Board Cupboard - 1.1 m2							
						Note: No inspection of live electrical installation	
No Asbestos							
B0L2 - R0006 - Cleaning Store - Distributed - 1.1 m2							
No Asbestos							
B0L2 - R0007 - Movement - 4.74 m2							
Ceiling Structures/Linings	Flat AC Sheeting	5m2	All surfaces	Good Condition (1)	Low (1)	Low Priority (2-3)	Chrysotile (white asbestos)
B0L2 - R0008 - Toilets-Boys - 9.49 m2							
Ceiling Structures/Linings	Flat AC Sheeting	10m2	All surfaces	Good Condition (1)	Low (1)	Low Priority (2-3)	Chrysotile (white asbestos)
B0L2 - R0009 - Shower/Change - 25.59 m2							
Ceiling Structures/Linings	Flat AC Sheeting	26m2	All surfaces	Good Condition (1)	Low (1)	Low Priority (2-3)	Chrysotile (white asbestos)
B0L2 - R0010 - Movement - 37.87 m2							
Ceiling Structures/Linings	Flat AC Sheeting	38m2	All surfaces	Good Condition (1)	Low (1)	Low Priority (2-3)	Chrysotile (white asbestos)

Demountables

There are no Demountable(s) Located at this school as per the AMS records as of 09-Sep-2020