

Asbestos Register

(Hazardous Materials and Risk Assessment)

School:	Iluka Public School (2204)
Region:	North Coast AMU
State Electorate:	Clarence
Local Government Area:	Clarence Valley

Last Reviewed By:	WSP 29-AUG-2016
Last Revised By:	

Historical Fibro In Grounds Investigations/Events	Yes
Please refer to the latest site specific Asbestos Management Plans available from the Department's website (Refer to Note 2).	

2204 - Iluka Public School
Site Plan (12968)

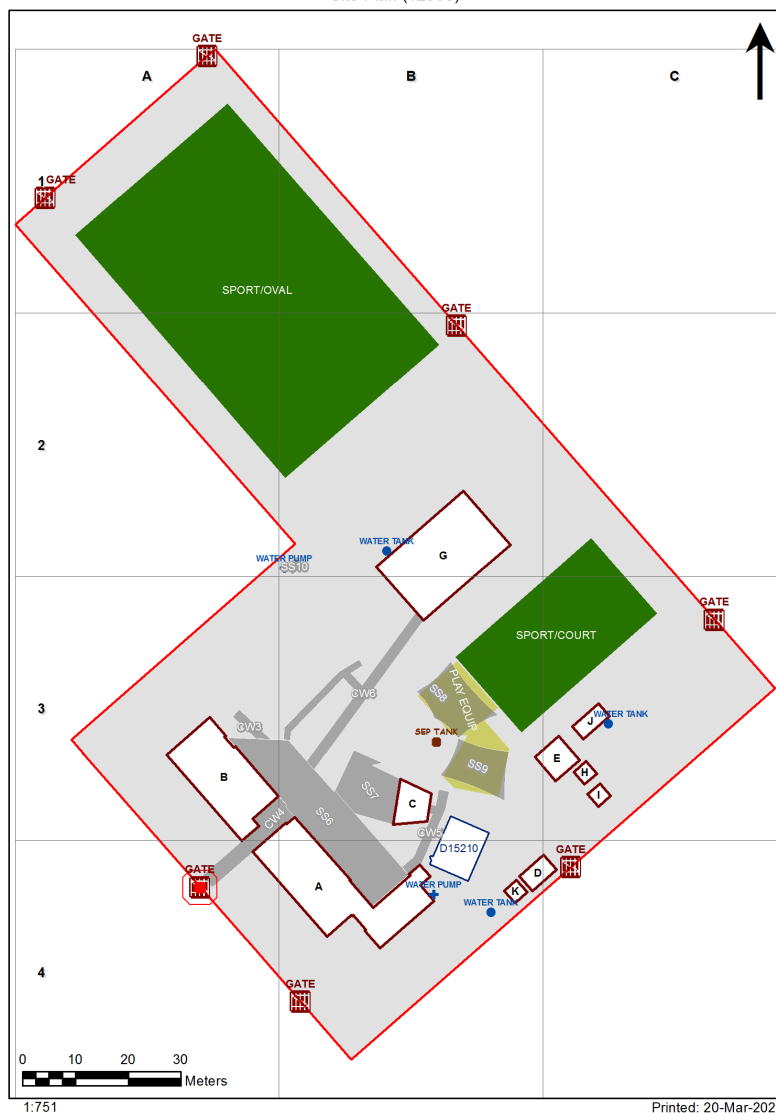

Preface to Asbestos Register

Limitations

Asbestos Registers established (first surveyed 2007/08) and maintained for the Department of Education (DoE) are limited in extent, in that:

1. All inspections and surveys of materials and finishes in DoE facilities are non-disturbance, with
2. Samples undertaken by hygienist to determine whether a sample is an Asbestos Containing Material (ACM),
3. The hygienist may apply a single sample to like materials within a space and adjoining spaces, but not normally between buildings,
4. Successive inspections have reduced any inconclusive records such as 'assumed asbestos' in difficult to access areas, by undertaking additional sampling with lifting devices.
5. In compliance with WHS Act 2011 and WHS Regulations 2017, additional inspections have been undertaken in ceiling spaces and sub-floor areas where access is possible.
 - o Where the ground floor is slab on ground, no inspection is made beneath the slab.
 - o Where fibro fragments (ACM taken for sampling) are located in ceiling spaces or sub floor voids air monitoring is normally undertaken at time of sampling, and clearance undertaken as soon as practicable.
6. No attempt has been made to identify any ACM that is hidden from view or encapsulated within
 - o Any wall cavity
 - o Sub floor area, particularly formwork for slabs in/on ground,
 - o Services (that may use ACM) such as: pipe lagging, asbestos cement pipes, flues.
7. All known ACM in Grounds (Fibro in Grounds) is made available in associated site specific asbestos management plans in DoE electronic files.
Notwithstanding information provided, ACM may be present in grounds from time to time and caution must be exercised prior to any grounds disturbance.

Use of the Asbestos Register

Prior to any disturbance works being undertaken in a building to which this asbestos register applies it will be necessary to confirm the extent of any ACM by a disturbance investigation:

- If the building was built prior to 2003
- If any ACM has been identified in the Asbestos Register for the building.

Update of Asbestos Registers

Asbestos Register Data is updated regularly by the DoE Hygienist Panel via the Online Asbestos Register Tool (Managed by Business Systems, School Infrastructure NSW). Internal users can view the latest edition of the Asbestos Register in the AMS.

Please note: The Department's external website may not contain the latest revision of the Asbestos Register.

Notes 1: Vermiculite

- During 2018/19, all vermiculite occurrences in DoE schools identified in 2007/08, were 'composite tested' in accordance with a safe work NSW agreed procedure. This required multiple testing of all vermiculite occurrences.
- During the period 2007/08 to 2018/19, some vermiculite has been over sheeted and a warning is indicated for schools where this has happened.

Note 2: DoE website link for information is here:

<https://www.schoolinfrastructure.nsw.gov.au/about-us/working-with-us/schools-asbestos-register.html>

<https://education.nsw.gov.au/about-us/strategies-and-reports/our-reports-and-reviews/schools-asbestos-register>

Note 3: Material Condition Assessment

The material condition assessment descriptors from Section 3 of the Asbestos Management Plan (AMP) is extracted below. Please read the AMP in its entirety for further information.

3.3.2.1 Material condition assessment

The OART records the material condition of identified ACM in the following format:

Rating	Description
Good condition (1)	For non-friable asbestos that is sealed and has no visible damage. This primarily related to asbestos cement (AC) sheet and vinyl tiles
Minimal damage (2)	For non-friable asbestos that has a very small amount of damage, eg hairline cracks.
Some damage / unsealed (3)	For non-friable asbestos with significant breakage or several small areas where material has been damaged, revealing loose asbestos fibres. Non-friable asbestos that is unsealed.
Poor condition (4)	For non-friable asbestos that has extensive damage. Visible asbestos debris
Friable asbestos (5)	Any occurrence of friable asbestos

Product	Material Description	Extent	Location	Material Condition	Risk Status	Remediation Priority	Result
B00A - Library/General Learning - 1970 - Brick/Veneer							
Exterior							
Underfloor Voids - Slab on Ground	No Asbestos Found						
Eaves Linings	Flat AC Sheeting	55m2	Variable positions	Minimal Damage (2)	Low (1)	Low Priority (2-3)	Chrysotile (white asbestos) , Amosite (brown asbestos)
Gable Verge Lining	Flat AC Sheeting	30m2	Variable positions	Good Condition (1)	Low (1)	Low Priority (2-3)	Chrysotile (white asbestos)
Wall Linings Internal - Infill	Flat AC Sheeting	22	Under windows	Minimal Damage (2)	Low (1)	Low Priority (2-3)	Chrysotile (white asbestos)
Plant / Equipment - Flue	Fibre Cement Pipe	1	South	Some Damage - Unsealed (3)	Low (1)	Medium Priority (4-5)	Chrysotile (white asbestos) , Amosite (brown asbestos)
Ceiling Voids	No Asbestos Found						
Interior							
B00A - R0001 - Cleaning Distributed Store - 6.63 m2							
No Asbestos							
B00A - R0002 - Toilets - Girls - 11.65 m2							
Ceiling Structures/Linings	Flat AC Sheeting	12m2	Throughout	Good Condition (1)	Low (1)	Low Priority (2-3)	Chrysotile (white asbestos) , Amosite (brown asbestos)
Partition Walls (Cubicles)	Compressed AC Sheet	10m2	Throughout	Good Condition (1)	Low (1)	Low Priority (2-3)	Chrysotile (white asbestos)
B00A - R0003 - Toilets - Girls - 2 m2							
Ceiling Structures/Linings	Flat AC Sheeting	2m2	Throughout	Good Condition (1)	Low (1)	Low Priority (2-3)	Chrysotile (white asbestos) , Amosite (brown asbestos)
Plant / Equipment - Flue	Fibre Cement Pipe	3	South	Good Condition (1)	Low (1)	Low Priority (2-3)	Chrysotile (white asbestos) , Amosite (brown asbestos)
B00A - R0004 - Toilets - Boys - 14.6 m2							
Ceiling Structures/Linings	Flat AC Sheeting	15m2	Throughout	Good Condition (1)	Low (1)	Low Priority (2-3)	Chrysotile (white asbestos) , Amosite (brown asbestos)
Partition Walls (Cubicles)	Compressed AC Sheet	5m2	Throughout	Good Condition (1)	Low (1)	Low Priority (2-3)	Chrysotile (white asbestos)
B00A - R0005 - Toilets - Boys - 1.78 m2							
Ceiling Structures/Linings	Flat AC Sheeting	2m2	Throughout	Good Condition (1)	Low (1)	Low Priority (2-3)	Chrysotile (white asbestos) , Amosite (brown asbestos)
B00A - R0006 - Movement - 5.44 m2							
Ceiling Structures/Linings	Flat AC Sheeting	6m2	Throughout	Good Condition (1)	Low (1)	Low Priority (2-3)	Chrysotile (white asbestos) , Amosite (brown asbestos)
B00A - R0008 - General Storeroom - 15.61 m2							
Ceiling Structures/Linings	Flat AC Sheeting	16m2	Throughout	Good Condition (1)	Low (1)	Low Priority (2-3)	Chrysotile (white asbestos) , Amosite (brown asbestos)
B00A - R0010 - Home Base Store - 4.69 m2							
Floor Coverings Res/Textile	Vinyl Tiles	5m2	Throughout	Good Condition (1)	Low (1)	Low Priority (2-3)	Chrysotile (white asbestos)
B00A - R0012 - Practical Activities - 1hb - 2.57 m2							
Floor Coverings Res/Textile	Vinyl Tiles	3m2	Throughout	Good Condition (1)	Low (1)	Low Priority (2-3)	Chrysotile (white asbestos)
B00A - R0014 - Library Office/Workroom - 12.63 m2							
Floor Coverings Res/Textile	Vinyl Tiles	13m2	Throughout	Good Condition (1)	Low (1)	Low Priority (2-3)	Chrysotile (white asbestos)
B00A - R0015 - Canteen - 15.26 m2							
Floor Coverings Res/Textile	Vinyl Tiles	16m2	Throughout	Good Condition (1)	Low (1)	Low Priority (2-3)	Chrysotile (white asbestos)
B00A - R0019 - Servery Covered Area - 7.82 m2							
Ceiling Structures/Linings	Flat AC Sheeting	8m2	Throughout	Good Condition (1)	Low (1)	Low Priority (2-3)	Chrysotile (white asbestos)
B00A - R0021 - Practical Activities - 17.62 m2							

Require Inspection							
B00A - R0022 - Home Base - 54.51 m2							
Require Inspection							
B00A - R0023 - Home Base - 65.02 m2							
Require Inspection							
B00A - R0024 - Withdrawal Space - 2hb - 8.71 m2							
Require Inspection							
B00A - R0025 - Personal Effects Storage - 41.72 m2							
Require Inspection							
B00B - Administration/General Learning - 1979 - Brick/Veneer							
Exterior							
Underfloor Voids - Slab on Ground	No Asbestos Found						
Eaves Linings	Flat AC Sheeting	30m2	Variable positions	Minimal Damage (2)	Low (1)	Low Priority (2-3)	Chrysotile (white asbestos)
Gable Verge Lining	Flat AC Sheeting	20m2	Variable positions	Good Condition (1)	Low (1)	Low Priority (2-3)	Chrysotile (white asbestos)
Ceiling Voids	No Asbestos Found						
Interior							
B00B - R0004 - Interview - 13.94 m2							
No Asbestos							
B00B - R0005 - Principal - 13.45 m2							
No Asbestos							
B00B - R0008 - Staff Room - 31.98 m2							
Floor Coverings Res/Textile	Vinyl Tiles	32m2	Throughout	Good Condition (1)	Low (1)	Low Priority (2-3)	Chrysotile (white asbestos)
B00B - R0012 - Staff Toilet - 3.59 m2							
No Asbestos							
B00B - R0013 - Staff Toilet - 3.59 m2							
No Asbestos							
B00B - R0014 - Movement - 5.88 m2							
No Asbestos							
B00B - R0015 - External Movement - 5.76 m2							
Ceiling Structures/Linings	Flat AC Sheeting						
B00B - R0016 - Home Base Store - M - 5.46 m2							
No Asbestos							
B00B - R0017 - Special Programs Room - 56.64 m2							
No Asbestos							
B00B - R0018 - Clerical Office/Workroom - 19.36 m2							
No Asbestos							
B00B - R0019 - Movement - 4.46 m2							
No Asbestos							
B00B - R0020 - Security Store - 11.48 m2							
No Asbestos							
B00B - R0021 - Sick Bay - 8.21 m2							
No Asbestos							
B00B - R0022 - Entry Vestibule - 12.5 m2							
No Asbestos							
B00C - Communal Facilities - 1982 - Timber							
Exterior							

Wall Cladding	Fibre Cement Casting (Monocrete)	
Ceiling Voids	No Asbestos Found	
Underfloor Voids	No Asbestos Found	
Interior		
B00C - R0004 - Covered Area - 41.87 m2		
No Asbestos		
B00D - Communal Facilities - 1970 - Timber Shed		
Exterior		
Ceiling Voids	No Asbestos Found	
Underfloor Voids	No Asbestos Found	
Interior		
B00D - R0001 - Sports Store - 20.52 m2		
No Asbestos		
B00E - Building Services - 2000 - Steel		
Exterior		
Underfloor Voids - Slab on Ground	No Asbestos Found	
Ceiling Voids	No Asbestos Found	
Interior		
B00E - R0003 - Sports Store - 31.93 m2		
Require Inspection		
B00G - Library/General Learning - 2010 - Brick/Veneer		
Exterior		
Underfloor Voids - Slab on Ground	No Asbestos Found	
Ceiling Voids	No Asbestos Found	
Interior		
B00G - R0001 - External Movement - 48.88 m2		
No Asbestos		
B00G - R0002 - Distribution Board - .99 m2		
No Asbestos		Note: No inspection of live electrical installation
B00G - R0003 - Library Office/Workroom - 17.76 m2		
No Asbestos		
B00G - R0004 - K.L.A. Store - 19.4 m2		
No Asbestos		
B00G - R0005 - Reading Area - 90.85 m2		
No Asbestos		
B00G - R0006 - Home Base - 60.58 m2		
No Asbestos		
B00G - R0007 - Home Base Store - 5.43 m2		
No Asbestos		
B00G - R0008 - Withdrawal Space - 2hb - 8.39 m2		
No Asbestos		
B00G - R0009 - Practical Activities - 1hb - 18.3 m2		
No Asbestos		
B00H - Storage - 2000 - Metal Shed		
Exterior		
Require Inspection		
Interior		

B00H - R0001 - General Storeroom - 8.43 m2
Require Inspection
B00I - Storage - 2000 - Metal Shed
Exterior
Require Inspection
Interior
B00I - R0001 - General Storeroom - 8.43 m2
Require Inspection
B00J - Storage - 1970 - Brick Shed
Exterior
Require Inspection
Interior
B00J - R0001 - General Assistant/Bulk Store - 18.86 m2
Require Inspection
B00K - Storage - 1980 - Metal Shed
Exterior
Require Inspection
Interior
B00K - R0001 - General Storeroom - 8.14 m2
Require Inspection

Demountables

OS 602 15210 - Learning Unit - Standard With P.A.A. - Placement Date : 04-JUL-2017

Note: This refurbished demountable may have asbestos present in remnant mastic in window frames.

No Asbestos Found