

Asbestos Register

(Hazardous Materials and Risk Assessment)

School:	Homebush Boys High School (8151)
Region:	South Western Sydney AMU
State Electorate:	Strathfield
Local Government Area:	Strathfield

Last Reviewed By:	Greencap 14-DEC-2017
Last Revised By:	

Historical Fibro In Grounds Investigations/Events	No
<p>No previous investigations have been recorded against the school. However, asbestos containing materials maybe present in grounds from time to time and caution must be exercised prior to any grounds disturbance.</p>	

8151 - Homebush Boys High School
Site Plan (11750)

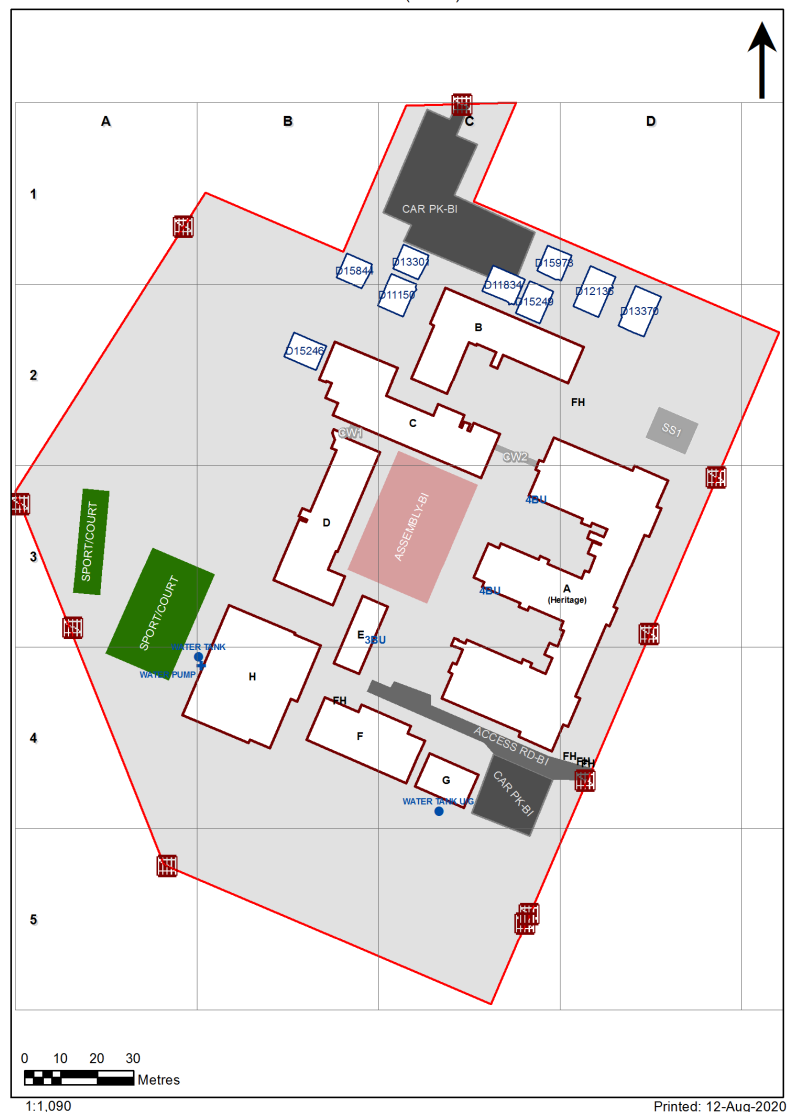

Preface to Asbestos Register

Limitations

Asbestos Registers established (first surveyed 2007/08) and maintained for the Department of Education (DoE) are limited in extent, in that:

1. All inspections and surveys of materials and finishes in DoE facilities are non-disturbance, with
2. Samples undertaken by hygienist to determine whether a sample is an Asbestos Containing Material (ACM),
3. The hygienist may apply a single sample to like materials within a space and adjoining spaces, but not normally between buildings,
4. Successive inspections have reduced any inconclusive records such as 'assumed asbestos' in difficult to access areas, by undertaking additional sampling with lifting devices.
5. In compliance with WHS Act 2011 and WHS Regulations 2017, additional inspections have been undertaken in ceiling spaces and sub-floor areas where access is possible.
 - o Where the ground floor is slab on ground, no inspection is made beneath the slab.
 - o Where fibro fragments (ACM taken for sampling) are located in ceiling spaces or sub floor voids air monitoring is normally undertaken at time of sampling, and clearance undertaken as soon as practicable.
6. No attempt has been made to identify any ACM that is hidden from view or encapsulated within
 - o Any wall cavity
 - o Sub floor area, particularly formwork for slabs in/on ground,
 - o Services (that may use ACM) such as: pipe lagging, asbestos cement pipes, flues.
7. All known ACM in Grounds (Fibro in Grounds) is made available in associated site specific asbestos management plans in DoE electronic files.
Notwithstanding information provided, ACM may be present in grounds from time to time and caution must be exercised prior to any grounds disturbance.

Use of the Asbestos Register

Prior to any disturbance works being undertaken in a building to which this asbestos register applies it will be necessary to confirm the extent of any ACM by a disturbance investigation:

- If the building was built prior to 2003
- If any ACM has been identified in the Asbestos Register for the building.

Update of Asbestos Registers

Asbestos Register Data is updated regularly by the DoE Hygienist Panel via the Online Asbestos Register Tool (Managed by Business Systems, School Infrastructure NSW). Internal users can view the latest edition of the Asbestos Register in the AMS.

Please note: The Department's external website may not contain the latest revision of the Asbestos Register.

Notes 1: Vermiculite

- During 2018/19, all vermiculite occurrences in DoE schools identified in 2007/08, were 'composite tested' in accordance with a safe work NSW agreed procedure. This required multiple testing of all vermiculite occurrences.
- During the period 2007/08 to 2018/19, some vermiculite has been over sheeted and a warning is indicated for schools where this has happened.

Note 2: DoE website link for information is here:

<https://www.schoolinfrastructure.nsw.gov.au/about-us/working-with-us/schools-asbestos-register.html>
<https://education.nsw.gov.au/about-us/strategies-and-reports/our-reports-and-reviews/schools-asbestos-register>

Note 3: Material Condition Assessment

The material condition assessment descriptors from Section 3 of the Asbestos Management Plan (AMP) is extracted below. Please read the AMP in its entirety for further information.

3.3.2.1 Material condition assessment

The OART records the material condition of identified ACM in the following format:

Rating	Description
Good condition (1)	For non-friable asbestos that is sealed and has no visible damage. This primarily related to asbestos cement (AC) sheet and vinyl tiles
Minimal damage (2)	For non-friable asbestos that has a very small amount of damage, eg hairline cracks.
Some damage / unsealed (3)	For non-friable asbestos with significant breakage or several small areas where material has been damaged, revealing loose asbestos fibres. Non-friable asbestos that is unsealed.
Poor condition (4)	For non-friable asbestos that has extensive damage. Visible asbestos debris
Friable asbestos (5)	Any occurrence of friable asbestos

Product	Material Description	Extent	Location	Material Condition	Risk Status	Remediation Priority	Result
B00A - General Learning/Various - 1935 - Brick/Block							
Exterior							
Ceiling Voids	No Asbestos Found						
Underfloor Voids	No Asbestos Found						
Interior							
B00A - R0003 - Administration - Executive - 13.24 m2							
Wall Linings Internal	Flat AC Sheeting						
B00A - R0004 - Principal Office - 21.96 m2							
Wall Linings Internal	Flat AC Sheeting						
B00A - R0005 - Movement - 15.05 m2							
Wall Linings Internal	Flat AC Sheeting						
B00A - R0006 - Duplicating Workroom - 23.06 m2							
No Asbestos							
B00A - R0007 - Administration - Clerical - 51.36 m2							
Wall Linings Internal	Flat AC Sheeting						
B00A - R0008 - Public Entry - 21.71 m2							
Wall Linings Internal	Flat AC Sheeting						
B00A - R0009 - Public Entry - 15.6 m2							
No Asbestos							
B00A - R0010 - Movement - 5.34 m2							
No Asbestos							
B00A - R0011 - Distribution Board Cupboard - 5.29 m2							
No Asbestos							Note: No inspection of live electrical installation
B00A - R0012 - Commonroom - 78.07 m2							
No Asbestos							
B00A - R0013 - General Learning Space - 52.01 m2							
No Asbestos							
B00A - R0014 - General Learning Space - 62.82 m2							
No Asbestos							
B00A - R0015 - Staff Study - 52.07 m2							
No Asbestos							
B00A - R0016 - General Learning Space - 52.08 m2							
No Asbestos							
B00A - R0017 - General Learning Space - 52.15 m2							
No Asbestos							
B00A - R0018 - General Learning Space - 51.93 m2							
No Asbestos							
B00A - R0019 - Movement - 2.18 m2							
No Asbestos							
B00A - R0020 - General Learning Space - 51.94 m2							
No Asbestos							
B00A - R0021 - General Learning Space - 51.86 m2							
No Asbestos							
B00A - R0022 - Distribution Board Cupboard - .88 m2							
No Asbestos							Note: No inspection of live electrical installation
B00A - R0023 - Cleaning Store - Distributed - 11.22 m2							

No Asbestos	
B00A - R0024 - Deputy Principal Office - 17.42 m2	
No Asbestos	
B00A - R0025 - Staff - Toilet - 6.03 m2	
No Asbestos	
B00A - R0026 - Movement - 1.99 m2	
No Asbestos	
B00A - R0027 - Multi-Purpose Space - 241.32 m2	
No Asbestos	
B00A - R0028 - Stage - 55.6 m2	
No Asbestos	
B00A - R0029 - Movement - 2.14 m2	
No Asbestos	
B00A - R0030 - Movement - 2.13 m2	
No Asbestos	
B00A - R0031 - Movement - 1.97 m2	
No Asbestos	
B00A - R0032 - Staff - Toilet - 6.02 m2	
No Asbestos	
B00A - R0033 - Deputy Principal Office - 16.87 m2	
No Asbestos	
B00A - R0034 - Distribution Board Cupboard - .65 m2	Note: No inspection of live electrical installation
No Asbestos	
B00A - R0035 - Movement - 14.79 m2	
No Asbestos	
B00A - R0036 - Movement - 2.18 m2	
No Asbestos	
B00A - R0037 - Laboratory L.S. - 81.37 m2	
No Asbestos	
B00A - R0038 - Preparation - 22.38 m2	
No Asbestos	
B00A - R0039 - Movement - 2.25 m2	
No Asbestos	
B00A - R0040 - General Learning Space - 51.86 m2	
No Asbestos	
B00A - R0041 - Preparation - 20.5 m2	
No Asbestos	
B00A - R0042 - Laboratory L.S. - 83.14 m2	
No Asbestos	
B00A - R0043 - Movement - 311.46 m2	
No Asbestos	
B00A - R0044 - Movement - 2.17 m2	
No Asbestos	
B00A - R0045 - Movement - 16.29 m2	
No Asbestos	
B00A - R0046 - External Movement - 2.58 m2	
No Asbestos	
B00A - R0047 - Lift - 1.81 m2	
No Asbestos	
B00A - R0048 - Lift - 2.5 m2	
No Asbestos	

B00A - R0049 - External Movement - 4.16 m2	
No Asbestos	
B00A - R0050 - Deputy Principal Office - 17.54 m2	
Require Inspection	
B00A - R0051 - Movement - 11.16 m2	
Require Inspection	
B00A - R0052 - Interview/Meeting - 8.63 m2	
Require Inspection	
B00A - R0053 - Interview/Meeting - 5.4 m2	
Require Inspection	
B00A - R0054 - Deputy Principal Office - 17.67 m2	
Require Inspection	
B00A - R0055 - Movement - 4.96 m2	
Require Inspection	
B00A - R0056 - Staff Study - 11.78 m2	
Require Inspection	
B00A - R0057 - Interview/Meeting - 34.13 m2	
Require Inspection	
B00A - R1001 - General Storeroom - 9.57 m2	
No Asbestos	
B00A - R1002 - Staff Study - 53.53 m2	
No Asbestos	
B00A - R1003 - General Learning Space - 64.06 m2	
No Asbestos	
B00A - R1004 - General Learning Space - 52.56 m2	
No Asbestos	
B00A - R1005 - Staff Study - 24.69 m2	
No Asbestos	
B00A - R1006 - General Learning Space - 52.77 m2	
No Asbestos	
B00A - R1007 - General Learning Space - 46.39 m2	
No Asbestos	
B00A - R1008 - General Storeroom - 4.97 m2	
No Asbestos	
B00A - R1009 - General Learning Space - 52.84 m2	
No Asbestos	
B00A - R1010 - Interview/Office - Type 1 - 23.81 m2	
No Asbestos	
B00A - R1011 - Distribution Board Cupboard - .7 m2	Note: No inspection of live electrical installation
No Asbestos	
B00A - R1012 - General Learning Space - 52.84 m2	
No Asbestos	
B00A - R1013 - Audio Visual Workroom - 58 m2	
No Asbestos	
B00A - R1014 - General Storeroom - 4.53 m2	
No Asbestos	
B00A - R1015 - Senior Study - 72.67 m2	
No Asbestos	
B00A - R1016 - Librarian - 39.92 m2	
No Asbestos	
B00A - R1017 - General Storeroom - 12.49 m2	
No Asbestos	

B00A - R1018 - Main Area - 260.92 m2	
No Asbestos	
B00A - R1019 - General Storeroom - 14.18 m2	
No Asbestos	
B00A - R1020 - Interview/Office - Type 1 - 15.94 m2	
No Asbestos	
B00A - R1021 - Staff - Toilet - 5.91 m2	
No Asbestos	
B00A - R1022 - Staff - Toilet - 5.89 m2	
No Asbestos	
B00A - R1023 - Secure Storeroom - 29.41 m2	
No Asbestos	
B00A - R1024 - Distribution Board Cupboard - .74 m2	Note: No inspection of live electrical installation
No Asbestos	
B00A - R1025 - General Learning Space - 52.82 m2	
No Asbestos	
B00A - R1026 - General Learning Space - 53.3 m2	
No Asbestos	
B00A - R1027 - General Learning Space - 52.84 m2	
No Asbestos	
B00A - R1028 - Staff Study - 21.04 m2	
No Asbestos	
B00A - R1029 - General Learning Space - 84.03 m2	
No Asbestos	
B00A - R1030 - Movement - 236.79 m2	
No Asbestos	
B00A - R9003 - Staff - Toilet - 2.46 m2	
No Asbestos	
B00A - R9004 - Movement - 2.24 m2	
No Asbestos	
B00A - R9005 - Cleaning Store - Distributed - 1.09 m2	
No Asbestos	
B00A - R9006 - Bulk Store - 5.11 m2	
No Asbestos	
B00A - R9007 - Maintenance Bulk Store - 21.86 m2	
No Asbestos	
B00A - R9008 - Staff - Toilet - 2.1 m2	
No Asbestos	
B00A - R9009 - Gymnasium - 51.45 m2	
No Asbestos	
B00A - R9010 - General Storeroom - 14.25 m2	
No Asbestos	
B00A - R9011 - Movement - 2.28 m2	
No Asbestos	
B00A - R9012 - General Storeroom - 39.06 m2	
No Asbestos	
B00A - R9013 - Maintenance Bulk Store - 27.5 m2	
No Asbestos	
B00A - R9014 - General Assistants - 14.24 m2	
No Asbestos	
B00A - R9015 - Student Canteen - 45.73 m2	

No Asbestos							
B00A - R9016 - Movement - 38.6 m2							
No Asbestos							
B00A - R9017 - External Movement - 32.31 m2							
No Asbestos							
B00B - Technological & Applied Studies - 1958 - Brick/Block							
Exterior							
Eaves Linings	Flat AC Sheeting	150m2	Throughout	Good Condition (1)	Low (1)	Low Priority (2-3)	Chrysotile (white asbestos) , Amosite (brown asbestos)
Ceiling Voids	No Asbestos Found						
Underfloor Voids	No Asbestos Found						
Interior							
B00B - R0001 - Resource/Project Store - 18.22 m2							
No Asbestos							
B00B - R0002 - Seminar/Technology Space - 31.71 m2							
No Asbestos							
B00B - R0003 - Design L.S. - 47.6 m2							
No Asbestos							
B00B - R0004 - Metal Technology Bay - 16.13 m2							
No Asbestos							
B00B - R0005 - Welding Area - 5.53 m2							
No Asbestos							
B00B - R0006 - Materials Technology L.S. - 83.47 m2							
No Asbestos							
B00B - R0007 - Materials Store - 15.41 m2							
No Asbestos							
B00B - R0008 - Food Technology L.S. - 87.41 m2							
No Asbestos							
B00B - R0009 - Store - Coolroom - 9.4 m2							
No Asbestos							
B00B - R0010 - Pantry/Preparation - 8.85 m2							
No Asbestos							
B00B - R0011 - Design L.S. - 52 m2							
No Asbestos							
B00B - R0012 - Staff Study - 11.48 m2							
No Asbestos							
B00B - R0013 - Staff Study - 8.96 m2							
No Asbestos							
B00B - R0014 - Seminar/Technology Space - 35.91 m2							
No Asbestos							
B00B - R0015 - Other-Not Used - 9.42 m2							
No Asbestos							
B00B - R0016 - Movement - 82.42 m2							
Floor Coverings Res/Textile	Vinyl Tiles						
B00B - R0017 - Lift - 2.25 m2							
No Asbestos							
B00B - R0018 - External Movement - 3.99 m2							
No Asbestos							
B00B - R1001 - Resource/Project Store - 11.72 m2							
Floor Coverings Res/Textile	Vinyl Tiles	12m2	All surfaces	Good Condition (1)	Low (1)	Low Priority (2-3)	Chrysotile (white asbestos)

B00B - R1002 - Resource/Project Store - 8.99 m2							
Floor Coverings Res/Textile	Vinyl Tiles	9m2	All surfaces	Good Condition (1)	Low (1)	Low Priority (2-3)	Chrysotile (white asbestos)
B00B - R1003 - Materials Technology L.S. - 79.42 m2							
Floor Coverings Res/Textile	Vinyl Tiles	80m2	All surfaces	Good Condition (1)	Low (1)	Low Priority (2-3)	Chrysotile (white asbestos)
B00B - R1004 - Wood Technology Bay - 18.01 m2							
Floor Coverings Res/Textile	Vinyl Tiles	18m2	All surfaces	Good Condition (1)	Low (1)	Low Priority (2-3)	Chrysotile (white asbestos)
B00B - R1005 - Plant - 7.49 m2							
Floor Coverings Res/Textile	Vinyl Tiles	8m2	All surfaces	Good Condition (1)	Low (1)	Low Priority (2-3)	Chrysotile (white asbestos)
B00B - R1006 - Materials Store - 4.31 m2							
Floor Coverings Res/Textile	Vinyl Tiles	5m2	All surfaces	Good Condition (1)	Low (1)	Low Priority (2-3)	Chrysotile (white asbestos)
B00B - R1007 - Wood Technology Bay - 17.96 m2							
Floor Coverings Res/Textile	Vinyl Tiles	18m2	All surfaces	Good Condition (1)	Low (1)	Low Priority (2-3)	Chrysotile (white asbestos)
B00B - R1008 - Materials Technology L.S. - 79.68 m2							
No Asbestos							
B00B - R1009 - Materials Store - 4.28 m2							
Floor Coverings Res/Textile	Vinyl Tiles	5m2	All surfaces	Good Condition (1)	Low (1)	Low Priority (2-3)	Chrysotile (white asbestos)
B00B - R1010 - Design L.S. - 43.57 m2							
Floor Coverings Res/Textile	Vinyl Tiles	44m2	All surfaces	Good Condition (1)	Low (1)	Low Priority (2-3)	Chrysotile (white asbestos)
B00B - R1011 - Staff Study - 33.77 m2							
No Asbestos							
B00B - R1012 - Staff - Toilet - 4.34 m2							
No Asbestos							
B00B - R1013 - General Storeroom - 9.09 m2							
No Asbestos							
B00B - R1014 - Movement - 79.1 m2							
Floor Coverings Res/Textile	Vinyl Tiles	80m2	All surfaces	Good Condition (1)	Low (1)	Low Priority (2-3)	Chrysotile (white asbestos)
B00C - Science/Art - 1967 - Brick/Block							
Exterior							
Ceiling Voids	No Asbestos Found						
Underfloor Voids	No Asbestos Found						
Interior							
B00C - R0001 - Cleaning Supplies Store - 6.87 m2							
Ceiling Structures/Linings	Vermiculite - Composite Sample - (< 10 m2) - (X2)						
B00C - R0002 - Distribution Board Cupboard - 1.44 m2						Note: No inspection of live electrical installation	
No Asbestos							
B00C - R0005 - Staff - Toilet - 5.2 m2							
Partition Walls (Cubicles)	Compressed AC Sheet						
Ceiling Structures/Linings	Flat AC Sheeting	6m2	All surfaces	Some Damage - Unsealed (3)	Low (1)	Low Priority (2-3)	Chrysotile (white asbestos)
B00C - R0006 - General Storeroom - 9.67 m2							
Ceiling Structures/Linings	Vermiculite - Composite Sample - (< 10 m2) - (X2)						
B00C - R0007 - Cleaning Store - Distributed - .58 m2							
No Asbestos							
B00C - R0008 - Staff - Toilet - 5.18 m2							

Partition Walls (Cubicles)	Compressed AC Sheet							
Ceiling Structures/Linings	Flat AC Sheeting	6m2	All surfaces	Good Condition (1)	Low (1)	Low Priority (2-3)	Chrysotile (white asbestos)	
B00C - R0009 - Laboratory L.S. - 87.02 m2								
Ceiling Structures/Linings	Vermiculite - Composite Sample - (70 - 120 m2) - (X8)							
Ceiling Structures/Linings	Vermiculite - Composite Sample - (70 - 120 m2) - (X8)							
Floor Coverings Res/Textile	Vinyl Tiles							
Floor Coverings Res/Textile	Vinyl Tiles							
B00C - R0010 - Preparation - 9.21 m2								
Ceiling Structures/Linings	Vermiculite - Composite Sample - (< 10 m2) - (X2)							
Ceiling Structures/Linings	Vermiculite - Composite Sample - (< 10 m2) - (X2)							
Floor Coverings Res/Textile	Vinyl Tiles							
Floor Coverings Res/Textile	Vinyl Tiles							
B00C - R0011 - Preparation - 27.23 m2								
Floor Coverings Res/Textile	Vinyl Tiles	28m2	All surfaces	Good Condition (1)	Low (1)	Low Priority (2-3)	Chrysotile (white asbestos)	
Floor Coverings Res/Textile	Vinyl Tiles							
B00C - R0012 - Laboratory L.S. - 86.77 m2								
Ceiling Structures/Linings	Vermiculite - Composite Sample - (70 - 120 m2) - (X8)							
Ceiling Structures/Linings	Vermiculite - Composite Sample - (70 - 120 m2) - (X8)							
Floor Coverings Res/Textile	Vinyl Tiles							
Floor Coverings Res/Textile	Vinyl Tiles							
B00C - R0013 - Seminar - 26.38 m2								
Ceiling Structures/Linings	Vermiculite - Composite Sample - (10 - 40 m2) - (X3)							
B00C - R0014 - Staff Study - 37.9 m2								
Ceiling Structures/Linings	Vermiculite - Composite Sample - (10 - 40 m2) - (X3)							
B00C - R0015 - Distribution Board Cupboard - .75 m2								
						Note: No inspection of live electrical installation		
No Asbestos								
B00C - R0016 - Staff Study - 67.26 m2								
Ceiling Structures/Linings	Vermiculite - Composite Sample - (40 - 70 m2) - (X5)							
Ceiling Structures/Linings	Vermiculite - Composite Sample - (40 - 70 m2) - (X5)							
Floor Coverings Res/Textile	Vinyl Tiles							
Floor Coverings Res/Textile	Vinyl Tiles							
B00C - R0017 - General Storeroom - 6.14 m2								
Ceiling Structures/Linings	Vermiculite - Composite Sample - (< 10 m2) - (X2)							
B00C - R0018 - Design L.S. - 51.11 m2								

Floor Coverings Res/Textile	Vinyl Tiles	
Ceiling Structures/Linings	Vermiculite - Composite Sample - (40 - 70 m2) - (X5)	
Ceiling Structures/Linings	Vermiculite - Composite Sample - (40 - 70 m2) - (X5)	
Floor Coverings Res/Textile	Vinyl Tiles	
B00C - R0019 - General Storeroom - 6.14 m2		
Ceiling Structures/Linings	Vermiculite - Composite Sample - (< 10 m2) - (X2)	
B00C - R0020 - Movement - 127.56 m2		
No Asbestos		
B00C - R0021 - Movement - 3.64 m2		
No Asbestos		
B00C - R0022 - Lift - 1.82 m2		
No Asbestos		
B00C - R0023 - Printing/Photocopying - 26.52 m2		
Require Inspection		
B00C - R1001 - Distribution Board Cupboard - 1.5 m2		Note: No inspection of live electrical installation
No Asbestos		
B00C - R1002 - General Learning Space - 51.26 m2		
Ceiling Structures/Linings	Vermiculite - Composite Sample - (40 - 70 m2) - (X5)	
B00C - R1003 - Computer Learning Space - 52.65 m2		
Ceiling Structures/Linings	Vermiculite - Composite Sample - (40 - 70 m2) - (X5)	
B00C - R1004 - Staff - Toilet - 5.23 m2		
Ceiling Structures/Linings	Vermiculite - Composite Sample - (< 10 m2) - (X2)	
Ceiling Structures/Linings	Vermiculite - Composite Sample - (< 10 m2) - (X2)	
Partition Walls (Cubicles)	Compressed AC Sheet	
Partition Walls (Cubicles)	Compressed AC Sheet	
B00C - R1005 - Staff - Toilet - 7.98 m2		
Ceiling Structures/Linings	Vermiculite - Composite Sample - (< 10 m2) - (X2)	
Ceiling Structures/Linings	Vermiculite - Composite Sample - (< 10 m2) - (X2)	
Partition Walls (Cubicles)	Compressed AC Sheet	
Partition Walls (Cubicles)	Compressed AC Sheet	
B00C - R1006 - Cleaning Store - Distributed - .71 m2		
No Asbestos		
B00C - R1007 - Staff Shower - 5.22 m2		
Ceiling Structures/Linings	Vermiculite - Composite Sample - (< 10 m2) - (X2)	
B00C - R1008 - Computer Learning Space - 52.65 m2		
Ceiling Structures/Linings	Vermiculite - Composite Sample - (40 - 70 m2) - (X5)	
B00C - R1009 - Computer Store - 25.74 m2		
Ceiling Structures/Linings	Vermiculite - Composite Sample - (10 - 40 m2) - (X3)	
B00C - R1010 - Staff Study - 51.92 m2		

Ceiling Structures/Linings	Vermiculite - Composite Sample - (40 - 70 m2) - (X5)	
B00C - R1011 - Staff Study - 26.62 m2		
Ceiling Structures/Linings	Vermiculite - Composite Sample - (10 - 40 m2) - (X3)	
B00C - R1012 - Darkroom Space - 18.66 m2		
Ceiling Structures/Linings	Vermiculite - Composite Sample - (10 - 40 m2) - (X3)	
B00C - R1013 - Staff Study - 13.74 m2		
Ceiling Structures/Linings	Vermiculite - Composite Sample - (10 - 40 m2) - (X3)	
B00C - R1014 - Cleaning Store - Distributed - 2.76 m2		
No Asbestos		
B00C - R1015 - Distribution Board Cupboard - .74 m2		Note: No inspection of live electrical installation
No Asbestos		
B00C - R1016 - Art Learning Space - 67.1 m2		
Ceiling Structures/Linings	Vermiculite - Composite Sample - (40 - 70 m2) - (X5)	
B00C - R1017 - Resources Store - 6.16 m2		
Ceiling Structures/Linings	Vermiculite - Composite Sample - (< 10 m2) - (X2)	
B00C - R1018 - Art Learning Space - 51.2 m2		
Ceiling Structures/Linings	Vermiculite - Composite Sample - (40 - 70 m2) - (X5)	
B00C - R1019 - Resources Store - 6.14 m2		
Ceiling Structures/Linings	Vermiculite - Composite Sample - (< 10 m2) - (X2)	
B00C - R1020 - Movement - 118.23 m2		
No Asbestos		
B00C - R2001 - Distribution Board Cupboard - 1.25 m2		Note: No inspection of live electrical installation
No Asbestos		
B00C - R2002 - General Learning Space - 52.65 m2		
Ceiling Structures/Linings	Vermiculite - Composite Sample - (40 - 70 m2) - (X5)	
B00C - R2003 - General Learning Space - 52.44 m2		
Ceiling Structures/Linings	Vermiculite - Composite Sample - (40 - 70 m2) - (X5)	
B00C - R2004 - Cleaning Supplies Store - 5.83 m2		
Ceiling Structures/Linings	Vermiculite - Composite Sample - (< 10 m2) - (X2)	
B00C - R2005 - Cleaning Store - Distributed - 5.73 m2		
Ceiling Structures/Linings	Vermiculite - Composite Sample - (< 10 m2) - (X2)	
B00C - R2006 - General Learning Space - 52.87 m2		
Ceiling Structures/Linings	Vermiculite - Composite Sample - (40 - 70 m2) - (X5)	
B00C - R2007 - General Storeroom - 6.21 m2		
Ceiling Structures/Linings	Vermiculite - Composite Sample - (< 10 m2) - (X2)	
B00C - R2008 - Art Learning Space - 52.51 m2		
Ceiling Structures/Linings	Vermiculite - Composite Sample - (40 - 70 m2) - (X5)	
B00C - R2009 - Resources Store - 6.2 m2		
Ceiling Structures/Linings	Vermiculite - Composite Sample - (< 10 m2) - (X2)	
B00C - R2010 - Art Learning Space - 58.8 m2		

Ceiling Structures/Linings	Vermiculite - Composite Sample - (40 - 70 m2) - (X5)							
B00C - R2011 - Resources Store - 9.77 m2								
Ceiling Structures/Linings	Vermiculite - Composite Sample - (< 10 m2) - (X2)							
B00C - R2012 - Darkroom Space - 21.87 m2								
Ceiling Structures/Linings	Vermiculite - Composite Sample - (10 - 40 m2) - (X3)							
B00C - R2013 - Resources Store - 3.24 m2								
Ceiling Structures/Linings	Vermiculite - Composite Sample - (< 10 m2) - (X2)							
B00C - R2014 - Movement - 87.58 m2								
No Asbestos								
B00D - Science/Music - 1967 - Brick/Block								
Exterior								
Ceiling Voids	No Asbestos Found							
Underfloor Voids	No Asbestos Found							
Interior								
B00D - R0001 - Main Switchroom - 6.46 m2								
No Asbestos								
B00D - R0002 - Cleaning Supplies Store - 9.35 m2								
No Asbestos								
B00D - R0003 - General Storeroom - 11.26 m2								
No Asbestos								
B00D - R0004 - Garden Store Room - 7.58 m2								
No Asbestos								
B00D - R0005 - Movement - 277.42 m2								
No Asbestos								
B00D - R0006 - Distribution Board Cupboard - .76 m2								
						Note: No inspection of live electrical installation		
Ceiling Structures/Linings	Vermiculite - Composite Sample - (< 10 m2) - (X2)							
B00D - R0007 - Movement - 4.13 m2								
Ceiling Structures/Linings	Vermiculite - Composite Sample - (< 10 m2) - (X2)							
B00D - R0008 - Sport Equipment Store - 23.15 m2								
Ceiling Structures/Linings	Vermiculite - Composite Sample - (10 - 40 m2) - (X3)							
B00D - R0009 - Shower/Change - 40.05 m2								
Ceiling Structures/Linings	Flat AC Sheeting	41m2	All surfaces	Good Condition (1)	Low (1)	Low Priority (2-3)	Chrysotile (white asbestos)	
B00D - R0010 - Shower/Change - 57.27 m2								
Ceiling Structures/Linings	Vermiculite - Composite Sample - (40 - 70 m2) - (X5)							
B00D - R0011 - Staff Shower - 4.7 m2								
Ceiling Structures/Linings	Vermiculite - Composite Sample - (< 10 m2) - (X2)							
Floor Coverings Res/Textile	Vinyl Tiles	2m2	Small section by cabinet	Good Condition (1)	Low (1)	Low Priority (2-3)	Chrysotile (white asbestos)	
B00D - R0012 - Staff Study - 25.5 m2								
Ceiling Structures/Linings	Vermiculite - Composite Sample - (10 - 40 m2) - (X3)							
B00D - R0013 - Sport Equipment Store - 23.15 m2								
Ceiling Structures/Linings	Vermiculite - Composite Sample - (10 - 40 m2) - (X3)							
B00D - R0014 - Staff - Toilet - 3.98 m2								

Ceiling Structures/Linings	Vermiculite - Composite Sample - (< 10 m2) - (X2)	
B00D - R0015 - Movement - 11.79 m2		
Ceiling Structures/Linings	Vermiculite - Composite Sample - (10 - 40 m2) - (X3)	
B00D - R0016 - Lift - 2.72 m2		
No Asbestos		
B00D - R1001 - Cleaning Store - Distributed - 6.36 m2		
Ceiling Structures/Linings	Vermiculite - Composite Sample - (< 10 m2) - (X2)	
B00D - R1002 - Chemical Store - 26.67 m2		
Ceiling Structures/Linings	Vermiculite - Composite Sample - (10 - 40 m2) - (X3)	
B00D - R1003 - Laboratory L.S. - 86.36 m2		
Ceiling Structures/Linings	Vermiculite - Composite Sample - (70 - 120 m2) - (X8)	
B00D - R1004 - Preparation - 8.83 m2		
Ceiling Structures/Linings	Vermiculite - Composite Sample - (< 10 m2) - (X2)	
B00D - R1005 - Preparation - 28.23 m2		
Ceiling Structures/Linings	Vermiculite - Composite Sample - (10 - 40 m2) - (X3)	
B00D - R1006 - Laboratory L.S. - 88.21 m2		
Ceiling Structures/Linings	Vermiculite - Composite Sample - (70 - 120 m2) - (X8)	
B00D - R1007 - Distribution Board Cupboard - .7 m2		Note: No inspection of live electrical installation
No Asbestos		
B00D - R1008 - Music Learning Space - 53.45 m2		
Ceiling Structures/Linings	Vermiculite - Composite Sample - (40 - 70 m2) - (X5)	
B00D - R1009 - Music Store - 14.67 m2		
Ceiling Structures/Linings	Vermiculite - Composite Sample - (10 - 40 m2) - (X3)	
B00D - R1010 - Music Learning Space - 54.05 m2		
Ceiling Structures/Linings	Vermiculite - Composite Sample - (40 - 70 m2) - (X5)	
B00D - R1011 - Movement - 91.83 m2		
Ceiling Structures/Linings	Vermiculite - Composite Sample - (70 - 120 m2) - (X8)	
B00E - Pupil Facilities - 1950 - Brick/Block		
Exterior		
Ceiling Voids	No Asbestos Found	
Underfloor Voids	No Asbestos Found	
Interior		
B00E - R0001 - Toilets - Boys - 17.11 m2		
Ceiling Structures/Linings	Flat AC Sheeting	
B00E - R0002 - Toilets-Boys - 98.92 m2		
Ceiling Structures/Linings	Flat AC Sheeting	
B00E - R0003 - Cleaning Store - Distributed - 1.53 m2		
Ceiling Structures/Linings	Flat AC Sheeting	
B00E - R0004 - Staff Change - 8.46 m2		
Ceiling Structures/Linings	Flat AC Sheeting	
B00E - R0005 - Staff Change - 7.52 m2		

Ceiling Structures/Linings	Flat AC Sheeting							
B00F - Physical Education - 1950 - Brick/Block								
Exterior								
Eaves Linings	Flat AC Sheeting	40m2	North facing, South facing	Good Condition (1)	Low (1)	Low Priority (2-3)	Chrysotile (white asbestos) , Amosite (brown asbestos)	
Ceiling Voids	No Asbestos Found							
Underfloor Voids	No Asbestos Found							
Interior								
B00F - R0001 - Movement - 9.41 m2								
No Asbestos								
B00F - R0002 - Gymnasium - 348.86 m2								
No Asbestos								
B00F - R0003 - Sport Equipment Store - 9.51 m2								
No Asbestos								
B00F - R0004 - Movement - 9.12 m2								
No Asbestos								
B00G - General Learning - 1950 - Timber								
Exterior								
Ceiling Voids	No Asbestos Found							
Underfloor Voids	No Asbestos Found							
Interior								
B00G - R0001 - General Learning Space - 52.44 m2								
No Asbestos								
B00G - R0002 - General Learning Space - 52.36 m2								
No Asbestos								
B00G - R0003 - Movement - 36.23 m2								
No Asbestos								
B00H - Physical Education/Staff Facilities - 2009 - Brick/Veneer								
Exterior								
Ceiling Voids	No Asbestos Found							
Underfloor Voids	No Asbestos Found							
Interior								
B00H - R0001 - Gymnasium - 620.59 m2								
No Asbestos								
B00H - R0002 - Plant - .59 m2								
No Asbestos								
B00H - R0003 - First Aid - 12.03 m2								
No Asbestos								
B00H - R0004 - Access Staff Shower/Toilet - 8.97 m2								
No Asbestos								
B00H - R0005 - Plant - .77 m2								
No Asbestos								
B00H - R0006 - Cleaning Store - Distributed - 3.08 m2								
No Asbestos								
B00H - R0007 - Change - 11.55 m2								
No Asbestos								
B00H - R0008 - Shower - 17.37 m2								
No Asbestos								
B00H - R0009 - Shower - 16.94 m2								

No Asbestos	
B00H - R0010 - Change - 11.49 m2	
No Asbestos	
B00H - R0011 - Main Switchroom - 1.13 m2	
No Asbestos	
B00H - R0012 - Large Equipment Store - 24.07 m2	
No Asbestos	
B00H - R0013 - Staff Kitchen - 8.42 m2	
No Asbestos	
B00H - R0014 - Staff Study - 24.96 m2	
No Asbestos	
B00H - R0015 - External Movement - 62.21 m2	
No Asbestos	

Demountables**OS 601 11150 - Learning Unit - Standard/Withdrawal - Placement Date : 02-AUG-2001****Exterior**

Eaves Linings	Flat AC Sheeting	11.52m2	Assumed Asbestos
Landing	Compressed AC Sheet	1.2m2	Assumed Asbestos
Step Treads	Compressed AC Sheet	1.08m2	Assumed Asbestos

Interior**R1- Entry**

End Wall Panel	Flat AC Sheeting	18m2	Assumed Asbestos
Ceiling Structures/Linings	Flat AC Sheeting	8m2	Assumed Asbestos

R2- General Learning Space

End Wall Panel	Flat AC Sheeting	18m2	Assumed Asbestos
Ceiling Structures/Linings	Flat AC Sheeting	55m2	Assumed Asbestos

R3- Store

Ceiling Structures/Linings	Flat AC Sheeting	10m2	Assumed Asbestos
----------------------------	------------------	------	------------------

OS 601 11834 - Learning Unit - Standard/Withdrawal - Placement Date : 25-JAN-2012**Exterior**

Eaves Linings	Flat AC Sheeting	11.52m2	Assumed Asbestos
Landing	Compressed AC Sheet	1.2m2	Assumed Asbestos
Step Treads	Compressed AC Sheet	1.08m2	Assumed Asbestos

Interior**R1- Entry**

End Wall Panel	Flat AC Sheeting	18m2	Assumed Asbestos
Ceiling Structures/Linings	Flat AC Sheeting	8m2	Assumed Asbestos

R2- General Learning Space

End Wall Panel	Flat AC Sheeting	18m2	Assumed Asbestos
Ceiling Structures/Linings	Flat AC Sheeting	55m2	Assumed Asbestos

R3- Store

Ceiling Structures/Linings	Flat AC Sheeting	10m2	Assumed Asbestos
----------------------------	------------------	------	------------------

OS 710 12136 - Home Science/Pantry/Laundry - Placement Date : 30-JUN-1995**Exterior**

Eaves Linings	Flat AC Sheeting	14.4m2	Assumed Asbestos
Landing	Compressed AC Sheet	1.2m2	Assumed Asbestos
Step Treads	Compressed AC Sheet	1.08m2	Assumed Asbestos

Interior**R1- Entry**

End Wall Panel	Flat AC Sheeting	18m2	Assumed Asbestos
Ceiling Structures/Linings	Flat AC Sheeting	10m2	Assumed Asbestos

R2- Food Technology L.S.

End Wall Panel	Flat AC Sheeting	18m2	Assumed Asbestos
Ceiling Structures/Linings	Flat AC Sheeting	73m2	Assumed Asbestos

R3- Laundry

Ceiling Structures/Linings	Flat AC Sheeting	8m2	Assumed Asbestos
----------------------------	------------------	-----	------------------

OS 600 13301 - Learning Unit - Small - Placement Date : 09-JUN-2005**Exterior**

Eaves Linings	Flat AC Sheeting	8.64m2	Assumed Asbestos
Landing	Compressed AC Sheet	1.2m2	Assumed Asbestos
Step Treads	Compressed AC Sheet	1.08m2	Assumed Asbestos

Interior

R1- General Learning Space			
End Wall Panel	Flat AC Sheeting	50m2	Assumed Asbestos
Ceiling Structures/Linings	Flat AC Sheeting	55m2	Assumed Asbestos
OS 710 13370 - Home Science/Pantry/Laundry - Placement Date : 25-FEB-1999			
Exterior			
Eaves Linings	Flat AC Sheeting	14.4m2	Assumed Asbestos
Landing	Compressed AC Sheet	1.2m2	Assumed Asbestos
Step Treads	Compressed AC Sheet	1.08m2	Assumed Asbestos
Interior			
R1- Entry			
End Wall Panel	Flat AC Sheeting	18m2	Assumed Asbestos
Ceiling Structures/Linings	Flat AC Sheeting	10m2	Assumed Asbestos
R2- Food Technology L.S.			
End Wall Panel	Flat AC Sheeting	18m2	Assumed Asbestos
Ceiling Structures/Linings	Flat AC Sheeting	73m2	Assumed Asbestos
R3- Laundry			
Ceiling Structures/Linings	Flat AC Sheeting	8m2	Assumed Asbestos
NS 110 15246 - Learning Unit - Single Secondary/Secure - Placement Date : 04-APR-2006			
Note: This refurbished demountable may have asbestos present in remnant mastic in window frames.			
No Asbestos Found			
NS 110 15249 - Learning Unit - Single Secondary/Secure - Placement Date : 15-JAN-2011			
No Asbestos Found			
OS 600 15844 - Learning Unit - Small - Placement Date : 19-JAN-2004			
Exterior			
Eaves Linings	Flat AC Sheeting	8.64m2	Assumed Asbestos
Landing	Compressed AC Sheet	1.2m2	Assumed Asbestos
Step Treads	Compressed AC Sheet	1.08m2	Assumed Asbestos
Interior			
R1- General Learning Space			
End Wall Panel	Flat AC Sheeting	50m2	Assumed Asbestos
Ceiling Structures/Linings	Flat AC Sheeting	55m2	Assumed Asbestos
OS 600 15973 - Learning Unit - Small - Placement Date : 08-MAR-2002			
Exterior			
Eaves Linings	Flat AC Sheeting	8.64m2	Assumed Asbestos
Landing	Compressed AC Sheet	1.2m2	Assumed Asbestos
Step Treads	Compressed AC Sheet	1.08m2	Assumed Asbestos
Interior			
R1- General Learning Space			
End Wall Panel	Flat AC Sheeting	50m2	Assumed Asbestos
Ceiling Structures/Linings	Flat AC Sheeting	55m2	Assumed Asbestos