

Asbestos Register

(Hazardous Materials and Risk Assessment)

School:	Hamilton Public School (7420)
Region:	Hunter/Central Coast AMU
State Electorate:	Newcastle
Local Government Area:	Newcastle

Last Reviewed By:	AECOM 29-APR-2016
Last Revised By:	

Historical Fibro In Grounds Investigations/Events	No
<p>No previous investigations have been recorded against the school. However, asbestos containing materials maybe present in grounds from time to time and caution must be exercised prior to any grounds disturbance.</p>	

7420 - Hamilton Public School
Site Plan (13071)

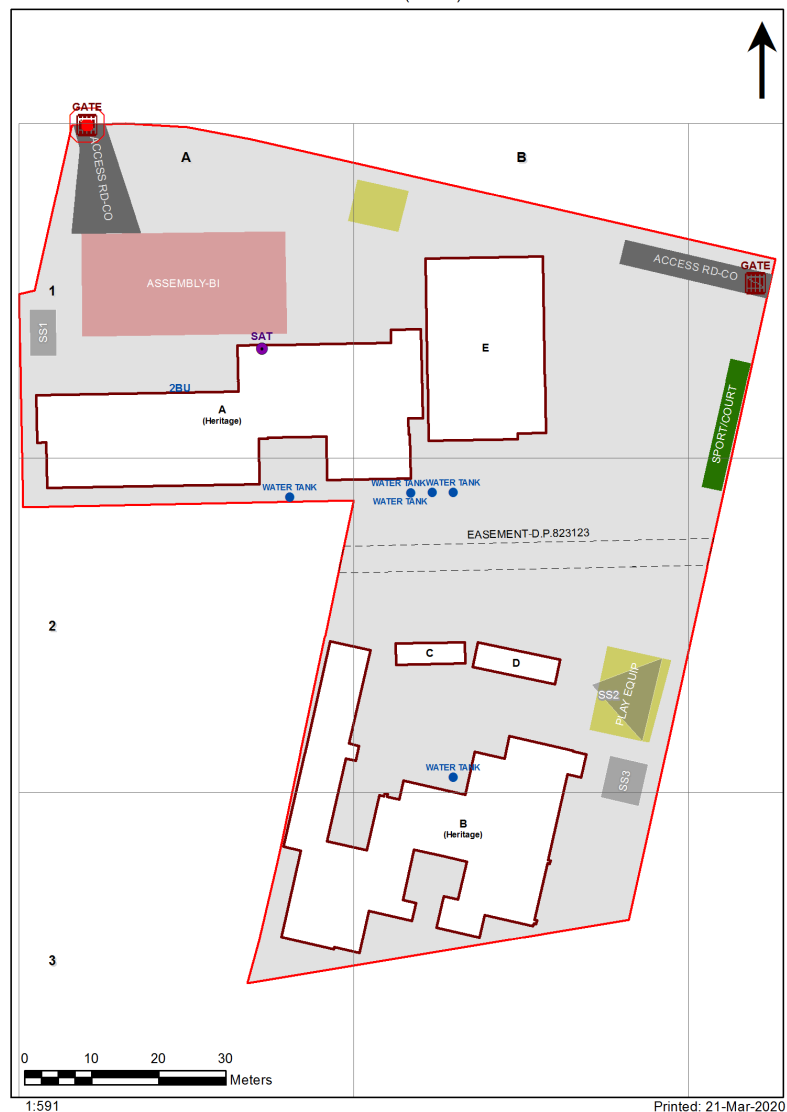

Preface to Asbestos Register

Limitations

Asbestos Registers established (first surveyed 2007/08) and maintained for the Department of Education (DoE) are limited in extent, in that:

1. All inspections and surveys of materials and finishes in DoE facilities are non-disturbance, with
2. Samples undertaken by hygienist to determine whether a sample is an Asbestos Containing Material (ACM),
3. The hygienist may apply a single sample to like materials within a space and adjoining spaces, but not normally between buildings,
4. Successive inspections have reduced any inconclusive records such as 'assumed asbestos' in difficult to access areas, by undertaking additional sampling with lifting devices.
5. In compliance with WHS Act 2011 and WHS Regulations 2017, additional inspections have been undertaken in ceiling spaces and sub-floor areas where access is possible.
 - o Where the ground floor is slab on ground, no inspection is made beneath the slab.
 - o Where fibro fragments (ACM taken for sampling) are located in ceiling spaces or sub floor voids air monitoring is normally undertaken at time of sampling, and clearance undertaken as soon as practicable.
6. No attempt has been made to identify any ACM that is hidden from view or encapsulated within
 - o Any wall cavity
 - o Sub floor area, particularly formwork for slabs in/on ground,
 - o Services (that may use ACM) such as: pipe lagging, asbestos cement pipes, flues.
7. All known ACM in Grounds (Fibro in Grounds) is made available in associated site specific asbestos management plans in DoE electronic files.
Notwithstanding information provided, ACM may be present in grounds from time to time and caution must be exercised prior to any grounds disturbance.

Use of the Asbestos Register

Prior to any disturbance works being undertaken in a building to which this asbestos register applies it will be necessary to confirm the extent of any ACM by a disturbance investigation:

- If the building was built prior to 2003
- If any ACM has been identified in the Asbestos Register for the building.

Update of Asbestos Registers

Asbestos Register Data is updated regularly by the DoE Hygienist Panel via the Online Asbestos Register Tool (Managed by Business Systems, School Infrastructure NSW). Internal users can view the latest edition of the Asbestos Register in the AMS.

Please note: The Department's external website may not contain the latest revision of the Asbestos Register.

Notes 1: Vermiculite

- During 2018/19, all vermiculite occurrences in DoE schools identified in 2007/08, were 'composite tested' in accordance with a safe work NSW agreed procedure. This required multiple testing of all vermiculite occurrences.
- During the period 2007/08 to 2018/19, some vermiculite has been over sheeted and a warning is indicated for schools where this has happened.

Note 2: DoE website link for information is here:

<https://www.schoolinfrastructure.nsw.gov.au/about-us/working-with-us/schools-asbestos-register.html>
<https://education.nsw.gov.au/about-us/strategies-and-reports/our-reports-and-reviews/schools-asbestos-register>

Note 3: Material Condition Assessment

The material condition assessment descriptors from Section 3 of the Asbestos Management Plan (AMP) is extracted below. Please read the AMP in its entirety for further information.

3.3.2.1 Material condition assessment

The OART records the material condition of identified ACM in the following format:

Rating	Description
Good condition (1)	For non-friable asbestos that is sealed and has no visible damage. This primarily related to asbestos cement (AC) sheet and vinyl tiles
Minimal damage (2)	For non-friable asbestos that has a very small amount of damage, eg hairline cracks.
Some damage / unsealed (3)	For non-friable asbestos with significant breakage or several small areas where material has been damaged, revealing loose asbestos fibres. Non-friable asbestos that is unsealed.
Poor condition (4)	For non-friable asbestos that has extensive damage. Visible asbestos debris
Friable asbestos (5)	Any occurrence of friable asbestos

Product	Material Description	Extent	Location	Material Condition	Risk Status	Remediation Priority	Result
B00A - Administration/General Learning - 1914 - Brick/Block							
Exterior							
Ceiling Voids - Raked Ceiling	Non Accessible Area						
Underfloor Voids	No Asbestos Found						
Eaves Linings	Flat AC Sheeting	25m2	North facing, South facing, Variable positions	Good Condition (1)	Low (1)	Low Priority (2-3)	Chrysotile (white asbestos)
Wall Linings Internal - Infill	Flat AC Sheeting	0.02	East of AR0008 and south of AR0009	Good Condition (1)	Low (1)	Low Priority (2-3)	Chrysotile (white asbestos), Amosite (brown asbestos)
Interior							
B00A - R0004 - Canteen - 43.18 m2							
Floor Coverings Res/Textile	Vinyl Tiles	44m2	All surfaces	Good Condition (1)	Low (1)	Low Priority (2-3)	Chrysotile (white asbestos)
B00A - R0005 - Canteen Office/Store - 4.16 m2							
Floor Coverings Res/Textile	Vinyl Tiles	5m2	All surfaces	Good Condition (1)	Low (1)	Low Priority (2-3)	Chrysotile (white asbestos)
B00A - R0006 - Staff Toilet - 3.21 m2							
Floor Coverings Res/Textile	Vinyl Tiles	4m2	All surfaces	Good Condition (1)	Low (1)	Low Priority (2-3)	Chrysotile (white asbestos)
B00A - R0008 - General Assistant/Bulk Store - 7.25 m2							
No Asbestos							
B00A - R0009 - Movement - 47.02 m2							
No Asbestos							
B00A - R0010 - Toilets - Girls - 35.55 m2							
Partition Walls (Cubides)	Compressed AC Sheet	35m2	All surfaces	Good Condition (1)	Low (1)	Low Priority (2-3)	Chrysotile (white asbestos)
B00A - R0011 - Toilets - Boys - 26.77 m2							
Partition Walls (Cubides)	Compressed AC Sheet	20m2	All surfaces	Good Condition (1)	Low (1)	Low Priority (2-3)	Chrysotile (white asbestos)
B00A - R0012 - Movement - 3.61 m2							
No Asbestos							
B00A - R0013 - Home Base Store - 9.65 m2							
Floor Coverings Res/Textile	Vinyl Tiles	10m2	All surfaces	Good Condition (1)	Low (1)	Low Priority (2-3)	Chrysotile (white asbestos)
B00A - R0014 - General Storeroom - 6.61 m2							
Floor Coverings Res/Textile	Vinyl Tiles	7m2	All surfaces	Good Condition (1)	Low (1)	Low Priority (2-3)	Chrysotile (white asbestos)
B00A - R0015 - Home Base - 52.81 m2							
No Asbestos							
B00A - R0016 - Sick Bay - 7.5 m2							
No Asbestos							
B00A - R0017 - Movement - 14.97 m2							
Floor Coverings Res/Textile	Vinyl Tiles	15m2	All surfaces	Good Condition (1)	Low (1)	Low Priority (2-3)	Chrysotile (white asbestos)
B00A - R0018 - Sports Store - 21.9 m2							
Ceiling Structures/Linings	Flat AC Sheeting	m2	All surfaces	Good Condition (1)	Low (1)	Low Priority (2-3)	Chrysotile (white asbestos), Amosite (brown asbestos)
B00A - R0019 - Movement - 8.5 m2							
Wall Linings Internal	Flat AC Sheeting	4m2	Variable positions	Good Condition (1)	Low (1)	Low Priority (2-3)	Chrysotile (white asbestos)
B00A - R0020 - Cleaning Distributed Store - 2 m2							
No Asbestos							
B00A - R0021 - Movement - 8.56 m2							
No Asbestos							

B00A - R0022 - Entry Vestibule - 11.55 m2							
No Asbestos							
B00A - R0023 - Clerical Office - 14.41 m2							
No Asbestos							
B00A - R0024 - Security Store - 47.52 m2							
Floor Coverings Res/Textile	Vinyl Tiles	48m2	All surfaces	Good Condition (1)	Low (1)	Low Priority (2-3)	Chrysotile (white asbestos)
B00A - R0025 - Movement - 55.75 m2							
No Asbestos							
B00A - R0026 - Staff Toilet - 7.48 m2							
Floor Coverings Res/Textile	Vinyl Tiles	8m2	All surfaces	Good Condition (1)	Low (1)	Low Priority (2-3)	Chrysotile (white asbestos)
B00A - R0027 - Duplicating Workroom - 17.35 m2							
No Asbestos							
B00A - R0028 - Staff Room - 48.07 m2							
Floor Coverings Res/Textile	Vinyl Tiles	10m2	East facing	Good Condition (1)	Low (1)	Low Priority (2-3)	Chrysotile (white asbestos)
B00A - R0029 - Deputy Principal - 15.91 m2							
No Asbestos							
B00A - R0030 - Reading Area - 47.59 m2							
No Asbestos							
B00A - R0031 - Reading Area - 41.39 m2							
No Asbestos							
B00A - R0032 - Library Office/Workroom - 10.84 m2							
No Asbestos							
B00A - R0033 - Principal - 15.44 m2							
No Asbestos							
B00A - R0034 - Movement - 8.56 m2							
No Asbestos							
B00A - R0035 - Movement - 8.47 m2							
No Asbestos							
B00A - R0036 - Cleaning Distributed Store - 1.99 m2							
No Asbestos							
B00A - R0037 - Servery Covered Area - 105.61 m2							
Ceiling Structures/Linings	Flat AC Sheeting						
B00A - R1001 - Movement - 81.8 m2							
No Asbestos							
B00A - R1002 - Home Base - M - 47.53 m2							
No Asbestos							
B00A - R1003 - General Storeroom - 14.94 m2							
Floor Coverings Res/Textile	Vinyl Tiles	15m2	All surfaces	Good Condition (1)	Low (1)	Low Priority (2-3)	Chrysotile (white asbestos)
B00A - R1004 - Interview - 11.33 m2							
No Asbestos							
B00A - R1005 - Home Base - 48.03 m2							
No Asbestos							
B00A - R1006 - Practical Activities - 1hb - 40.41 m2							
No Asbestos							
B00A - R1007 - Home Base - 47.45 m2							
No Asbestos							
B00A - R1008 - General Storeroom - 7.53 m2							
Floor Coverings Res/Textile	Vinyl Tiles	8m2	All surfaces	Good Condition (1)	Low (1)	Low Priority (2-3)	Chrysotile (white asbestos)

B00A - R1009 - Staff Toilet - 3.39 m2							
No Asbestos							
B00A - R1010 - Withdrawal Space - 1hb - 15.06 m2							
Floor Coverings Res/Textile	Vinyl Tiles	16m2	All surfaces	Good Condition (1)	Low (1)	Low Priority (2-3)	Chrysotile (white asbestos)
B00A - R1011 - Home Base - 52.33 m2							
No Asbestos							
B00A - R1012 - Home Base - 55.44 m2							
No Asbestos							
B00A - R1013 - Uniform Shop - 12.91 m2							
No Asbestos							
B00A - R1014 - Movement - 7.99 m2							
No Asbestos							
B00A - R1015 - Movement - 4.74 m2							
No Asbestos							
B00B - General Learning/Communal Facilities - 1872 - Brick/Block							
Exterior							
Ceiling Voids - Raked Ceiling	Non Accessible Area						
Eaves Linings	Flat AC Sheeting	60m2	Variable positions	Good Condition (1)	Low (1)	Low Priority (2-3)	Assumed Asbestos
Underfloor Voids	AC Fragments/Debris - Resinous Board	0.5	On ground, below BR0010	Poor Condition - Extensive Damage (4)	Medium (2)	Medium Priority (4-5)	Chrysotile (white asbestos)
Interior							
B00B - R0001 - Movement - 6.67 m2							
No Asbestos							
B00B - R0002 - General Storeroom - 6.47 m2							
No Asbestos							
B00B - R0003 - General Storeroom - 3.35 m2							
No Asbestos							
B00B - R0004 - Movement - 3.01 m2							
Electrical - Mounting Board	Resinous Board	1	East facing	Good Condition (1)	Low (1)	Low Priority (2-3)	Chrysotile (white asbestos)
B00B - R0005 - Movement - 105.65 m2							
Floor Coverings Res/Textile	Vinyl Tiles						
B00B - R0006 - Out Of School Hours Care Centre - 42.83 m2							
No Asbestos							
B00B - R0007 - Out Of School Hours Care Centre - 14.6 m2							
No Asbestos							
B00B - R0008 - Movement - 7.41 m2							
Floor Coverings Res/Textile	Vinyl Tiles						
B00B - R0009 - Staff Toilet - 2.73 m2							
No Asbestos							
B00B - R0010 - Home Base - 76.45 m2							
Furniture / Fixtures - Blackboard	Compressed AC Sheet	40	North facing, East facing, West facing	Good Condition (1)	Low (1)	Low Priority (2-3)	Chrysotile (white asbestos)
B00B - R0011 - Movement - 12.48 m2							
No Asbestos							
B00B - R0012 - Movement - 2.02 m2							
No Asbestos							
B00B - R0013 - Movement - 5.31 m2							

No Asbestos							
B00B - R0014 - Cleaning Distributed Store - 7.24 m2							
No Asbestos							
B00B - R0015 - Home Base - 47.88 m2							
No Asbestos							
B00B - R0016 - Home Base - 100.65 m2							
Floor Coverings Res/Textile	Vinyl Tiles						
Furniture / Fixtures - Blackboard	Compressed AC Sheet	40	North facing, South facing, East facing, West facing	Good Condition (1)	Low (1)	Low Priority (2-3)	Chrysotile (white asbestos)
B00B - R0017 - Movement - 3.95 m2							
Ceiling Structures/Linings	Flat AC Sheeting	3.95m2	Throughout	Good Condition (1)	Low (1)	Low Priority (2-3)	Chrysotile (white asbestos), Amosite (brown asbestos)
B00B - R0018 - Movement - 2.07 m2							
No Asbestos							
B00B - R0019 - No Access - 16.6 m2							
Furniture / Fixtures - Blackboard	Flat AC Sheeting	3	South	Good Condition (1)	Low (1)	Low Priority (2-3)	Chrysotile (white asbestos)
Floor Coverings Res/Textile	Vinyl Tiles	2.9m2	West	Minimal Damage (2)	Low (1)	Low Priority (2-3)	Chrysotile (white asbestos)
B00B - R0020 - Movement - 15.86 m2							
No Asbestos							
B00B - R0021 - Home Base - 57.4 m2							
Furniture / Fixtures - Blackboard	Compressed AC Sheet	12	West facing	Good Condition (1)	Low (1)	Low Priority (2-3)	Chrysotile (white asbestos)
B00B - R0022 - Practical Activities - 45.96 m2							
Furniture / Fixtures - Blackboard	Compressed AC Sheet	30	South facing, East facing, West facing	Good Condition (1)	Low (1)	Low Priority (2-3)	Chrysotile (white asbestos)
B00B - R0023 - Movement - 4.81 m2							
No Asbestos							
B00B - R0024 - Staff Toilet - 2.88 m2							
Wall Linings Internal	Flat AC Sheeting						
B00B - R0025 - General Storeroom - .67 m2							
No Asbestos							
B00B - R0026 - Movement - 6.2 m2							
Floor Coverings Res/Textile	Vinyl Tiles						
B00B - R0027 - General Storeroom - 4.38 m2							
Floor Coverings Res/Textile	Vinyl Tiles						
B00B - R0028 - Raised Platform - 26.38 m2							
No Asbestos							
B00B - R0029 - Communal Space - 103.75 m2							
No Asbestos							
B00B - R0030 - Movement - 2.98 m2							
Ceiling Structures/Linings	Flat AC Sheeting	3m2	All surfaces	Good Condition (1)	Low (1)	Low Priority (2-3)	Chrysotile (white asbestos), Amosite (brown asbestos)
B00B - R0031 - Staff Kitchen - 16.54 m2							
Floor Coverings Res/Textile	Vinyl Tiles						
B00B - R0032 - Movement - 2.95 m2							
No Asbestos							
B00B - R0033 - General Storeroom - 12.51 m2							

Floor Coverings Res/Textile	Vinyl Tiles						
B00B - R1001 - Movement - 120.04 m2							
No Asbestos							
B00B - R1002 - Home Base - 45.16 m2							
Furniture / Fixtures - Blackboard	Compressed AC Sheet	10	North facing, West facing	Good Condition (1)	Low (1)	Low Priority (2-3)	Chrysotile (white asbestos)
B00B - R1003 - Seminar/Study - 15.63 m2							
No Asbestos							
B00B - R1004 - General Storeroom - 7.65 m2							
No Asbestos							
B00B - R1005 - Staff Toilet - 2.82 m2							
Wall Linings Internal	Flat AC Sheeting						
B00B - R1006 - Home Base - 47.73 m2							
Furniture / Fixtures - Blackboard	Compressed AC Sheet	10	West facing	Good Condition (1)	Low (1)	Low Priority (2-3)	Chrysotile (white asbestos)
B00B - R1007 - Withdrawal Space - 1hb - 47.88 m2							
Furniture / Fixtures - Blackboard	Compressed AC Sheet	10	West facing	Good Condition (1)	Low (1)	Low Priority (2-3)	Chrysotile (white asbestos)
B00B - R1008 - Home Base - 51.26 m2							
Furniture / Fixtures - Blackboard	Compressed AC Sheet	13	North facing, South facing, East facing	Good Condition (1)	Low (1)	Low Priority (2-3)	Chrysotile (white asbestos)
B00C - Pupil Facilities - 1950 - Brick/Block							
Exterior							
Ceiling Voids - Flat Roof	Non Accessible Area						
Underfloor Voids - Slab on Ground	Non Accessible Area						
Eaves Linings	Flat AC Sheeting	5m2	East facing, West facing	Good Condition (1)	Low (1)	Low Priority (2-3)	Chrysotile (white asbestos)
Interior							
B00C - R0001 - Toilets - Boys - 13.4 m2							
Ceiling Structures/Linings	Flat AC Sheeting	14m2	All surfaces	Good Condition (1)	Low (1)	Low Priority (2-3)	Chrysotile (white asbestos)
B00C - R0002 - Toilets - Girls - 15.39 m2							
Ceiling Structures/Linings	Flat AC Sheeting	16m2	All surfaces	Good Condition (1)	Low (1)	Low Priority (2-3)	Chrysotile (white asbestos)
B00D - Pupil Facilities - 1950 - Timber							
Exterior							
Ceiling Voids - Flat Roof	No Asbestos Found						
Underfloor Voids - Slab on Ground	Non Accessible Area						
Interior							
B00D - R0001 - Drinking Facilities - 43.68 m2							
No Asbestos							
B00E - Communal Facilities - 2011 - Brick/Veneer							
Exterior							
Underfloor Voids	No Asbestos Found						
Ceiling Voids	No Asbestos Found						
Interior							
B00E - R0001 - Covered Outdoor Learning Area - 138.15 m2							
No Asbestos							

B00E - R0002 - Access Shower/Toilet - 6.98 m2	
No Asbestos	
B00E - R0003 - Main Switch Board - 3.25 m2	
No Asbestos	
B00E - R0004 - Communal Space - 144.64 m2	
No Asbestos	
B00E - R0005 - Cleaning Distributed Store - 3.55 m2	
No Asbestos	
B00E - R0006 - General Storeroom - 1.6 m2	
No Asbestos	
B00E - R0007 - Toilet - Lobby - 3.36 m2	
No Asbestos	
B00E - R0008 - Toilets - Boys - 5.8 m2	
No Asbestos	
B00E - R0009 - Sound Cupboard - 2.06 m2	
No Asbestos	
B00E - R0010 - Toilet - Lobby - 2.35 m2	
No Asbestos	
B00E - R0011 - Toilets - Girls - 7.36 m2	
No Asbestos	
B00E - R0012 - P.E Store - 13.02 m2	
No Asbestos	
B00E - R0013 - Communal/Performance Store - 9.13 m2	
No Asbestos	
B00E - R0014 - Hall Chair Store - 9.37 m2	
No Asbestos	
B00E - R0015 - Movement - 13.32 m2	
No Asbestos	
B00E - R0016 - Raised Platform - 62.36 m2	
No Asbestos	
B00E - R0017 - Movement - 11.26 m2	
No Asbestos	
B00E - R0018 - Movement - 5.47 m2	
No Asbestos	

Demountables

There are no Demountable(s) Located at this school as per the AMS records as of 09-Sep-2020