

# Asbestos Register

(Hazardous Materials and Risk Assessment)

School:	Haberfield Public School (2117)
Region:	Sydney AMU
State Electorate:	Summer Hill
Local Government Area:	Inner West

Last Reviewed By:	WSP 28-AUG-2015
Last Revised By:	

Historical Fibro In Grounds Investigations/Events	<b>Yes</b>
Please refer to the latest site specific Asbestos Management Plans available from the Department's website (Refer to Note 2).	

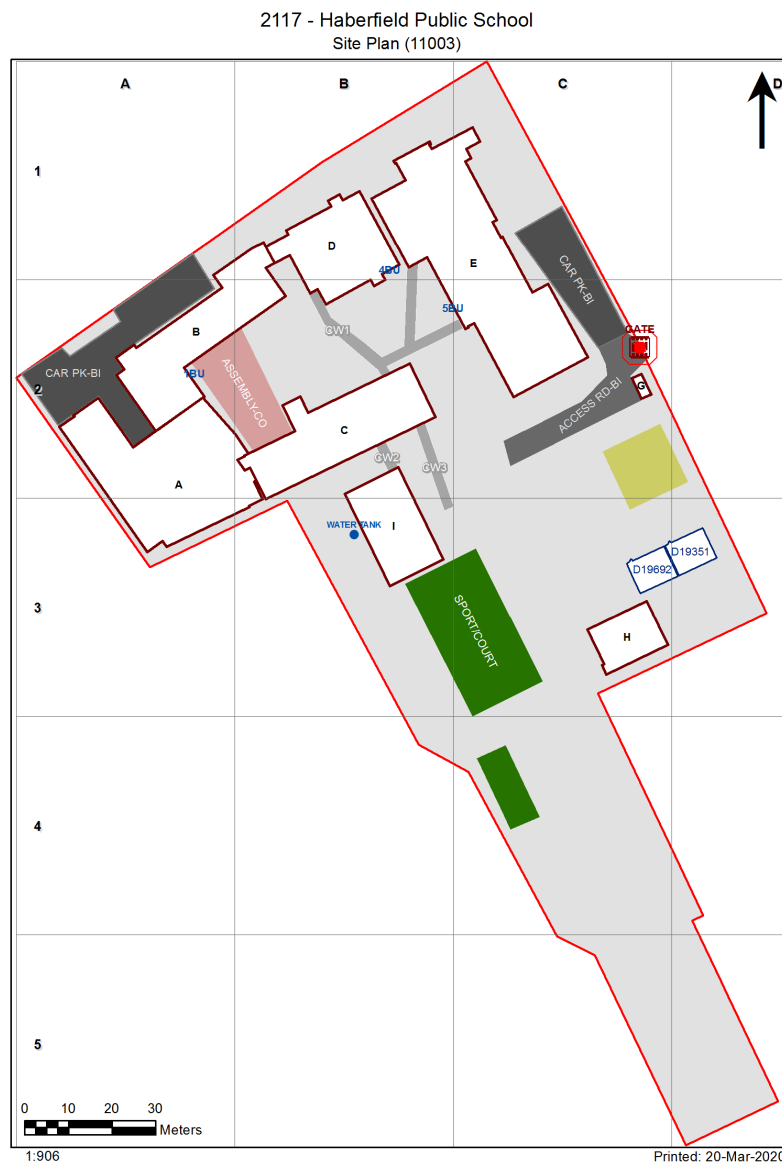

# Preface to Asbestos Register

## Limitations

Asbestos Registers established (first surveyed 2007/08) and maintained for the Department of Education (DoE) are limited in extent, in that:

1. All inspections and surveys of materials and finishes in DoE facilities are non-disturbance, with
2. Samples undertaken by hygienist to determine whether a sample is an Asbestos Containing Material (ACM),
3. The hygienist may apply a single sample to like materials within a space and adjoining spaces, but not normally between buildings,
4. Successive inspections have reduced any inconclusive records such as 'assumed asbestos' in difficult to access areas, by undertaking additional sampling with lifting devices.
5. In compliance with WHS Act 2011 and WHS Regulations 2017, additional inspections have been undertaken in ceiling spaces and sub-floor areas where access is possible.
  - o Where the ground floor is slab on ground, no inspection is made beneath the slab.
  - o Where fibro fragments (ACM taken for sampling) are located in ceiling spaces or sub floor voids air monitoring is normally undertaken at time of sampling, and clearance undertaken as soon as practicable.
6. No attempt has been made to identify any ACM that is hidden from view or encapsulated within
  - o Any wall cavity
  - o Sub floor area, particularly formwork for slabs in/on ground,
  - o Services (that may use ACM) such as: pipe lagging, asbestos cement pipes, flues.
7. All known ACM in Grounds (Fibro in Grounds) is made available in associated site specific asbestos management plans in DoE electronic files.  
Notwithstanding information provided, ACM may be present in grounds from time to time and caution must be exercised prior to any grounds disturbance.

## Use of the Asbestos Register

Prior to any disturbance works being undertaken in a building to which this asbestos register applies it will be necessary to confirm the extent of any ACM by a disturbance investigation:

- If the building was built prior to 2003
- If any ACM has been identified in the Asbestos Register for the building.

## Update of Asbestos Registers

Asbestos Register Data is updated regularly by the DoE Hygienist Panel via the Online Asbestos Register Tool (Managed by Business Systems, School Infrastructure NSW). Internal users can view the latest edition of the Asbestos Register in the AMS.

Please note: The Department's external website may not contain the latest revision of the Asbestos Register.

## Notes 1: Vermiculite

- During 2018/19, all vermiculite occurrences in DoE schools identified in 2007/08, were 'composite tested' in accordance with a safe work NSW agreed procedure. This required multiple testing of all vermiculite occurrences.
- During the period 2007/08 to 2018/19, some vermiculite has been over sheeted and a warning is indicated for schools where this has happened.

## Note 2: DoE website link for information is here:

<https://www.schoolinfrastructure.nsw.gov.au/about-us/working-with-us/schools-asbestos-register.html>  
<https://education.nsw.gov.au/about-us/strategies-and-reports/our-reports-and-reviews/schools-asbestos-register>

## Note 3: Material Condition Assessment

The material condition assessment descriptors from Section 3 of the Asbestos Management Plan (AMP) is extracted below. Please read the AMP in its entirety for further information.

### 3.3.2.1 Material condition assessment

The OART records the material condition of identified ACM in the following format:

Rating	Description
Good condition (1)	For non-friable asbestos that is sealed and has no visible damage. This primarily related to asbestos cement (AC) sheet and vinyl tiles
Minimal damage (2)	For non-friable asbestos that has a very small amount of damage, eg hairline cracks.
Some damage / unsealed (3)	For non-friable asbestos with significant breakage or several small areas where material has been damaged, revealing loose asbestos fibres. Non-friable asbestos that is unsealed.
Poor condition (4)	For non-friable asbestos that has extensive damage. Visible asbestos debris
Friable asbestos (5)	Any occurrence of friable asbestos

Product	Material Description	Extent	Location	Material Condition	Risk Status	Remediation Priority	Result
<b>B00A - Communal Facilities/Other-Community Use - 1963 - Brick/Block</b>							
<b>Exterior</b>							
Ceiling Voids	No Asbestos Found						
Underfloor Voids	No Asbestos Found						
<b>Interior</b>							
<b>B00A - R0010 - General Storeroom - 14.83 m2</b>							
No Asbestos							
<b>B00A - R0012 - Toilets - Girls - 4.5 m2</b>							
No Asbestos							
<b>B00A - R0013 - Staff Toilet - 4.52 m2</b>							
No Asbestos							
<b>B00A - R0014 - Interview - 14.58 m2</b>							
No Asbestos							
<b>B00A - R0015 - Movement - 9.52 m2</b>							
No Asbestos							
<b>B00A - R0016 - Staff Toilet - 6.96 m2</b>							
No Asbestos							
<b>B00A - R0017 - Staff Toilet - 6.88 m2</b>							
No Asbestos							
<b>B00A - R0018 - Movement - 22.3 m2</b>							
No Asbestos							
<b>B00A - R0019 - Distribution Board - .54 m2</b>							
No Asbestos						Note: No inspection of live electrical installation	
<b>B00A - R0020 - Movement - 3.69 m2</b>							
No Asbestos							
<b>B00A - R0024 - Staff Room - 23.64 m2</b>							
No Asbestos							
<b>B00A - R0026 - Staff Room - 20.21 m2</b>							
No Asbestos							
<b>B00A - R0027 - Staff Room - 17.8 m2</b>							
No Asbestos							
<b>B00A - R0028 - General Storeroom - 7.47 m2</b>							
No Asbestos							
<b>B00A - R0029 - Movement - 24.08 m2</b>							
No Asbestos							
<b>B00A - R0030 - Staff Kitchen - 10.4 m2</b>							
No Asbestos							
<b>B00A - R0031 - Sick Bay - 9.63 m2</b>							
No Asbestos							
<b>B00A - R0032 - Staff Toilet - 2.28 m2</b>							
No Asbestos							
<b>B00A - R0033 - Staff Toilet - 2.29 m2</b>							
No Asbestos							
<b>B00A - R0034 - Movement - 99.52 m2</b>							
No Asbestos							
<b>B00A - R0035 - Communal Space - 86.03 m2</b>							
No Asbestos							
<b>B00A - R0036 - Movement - 5.85 m2</b>							
No Asbestos							
<b>B00A - R0037 - Sound Cupboard - 2.61 m2</b>							

No Asbestos							
<b>B00A - R0038 - Special Programs Store - 7.8 m2</b>							
No Asbestos							
<b>B00A - R0039 - Home Base - 62.56 m2</b>							
No Asbestos							
<b>B00A - R0040 - Communal/Performance Store - 22.75 m2</b>							
No Asbestos							
<b>B00A - R0041 - Hall Chair Store - 16.86 m2</b>							
No Asbestos							
<b>B00A - R0042 - Movement - 17.43 m2</b>							
No Asbestos							
<b>B00A - R0043 - Communal Space - 171.53 m2</b>							
No Asbestos							
<b>B00A - R0044 - Raised Platform - 69.89 m2</b>							
No Asbestos							
<b>B00A - R0045 - Movement - 11.33 m2</b>							
No Asbestos							
<b>B00A - R0046 - Movement - 9.26 m2</b>							
No Asbestos							
<b>B00A - R0047 - Movement - 16.15 m2</b>							
No Asbestos							
<b>B00A - R0048 - Stairs - 10.74 m2</b>							
No Asbestos							
<b>B00A - R0049 - Movement - 7 m2</b>							
No Asbestos							
<b>B00A - R1002 - Home Base Store - 16.11 m2</b>							
No Asbestos							
<b>B00A - R1004 - Movement - 6.3 m2</b>							
No Asbestos							
<b>B00A - R1005 - Movement - 65.35 m2</b>							
No Asbestos							
<b>B00A - R1006 - Movement - 10.34 m2</b>							
No Asbestos							
<b>B00A - R1007 - Home Base - 58.81 m2</b>							
No Asbestos							
<b>B00A - R1008 - Movement - 7.8 m2</b>							
No Asbestos							
<b>B00A - R1009 - Stairs - 10.74 m2</b>							
No Asbestos							
<b>B00B - General Learning - 1915 - Brick/Block</b>							
<b>Exterior</b>							
Wall Cladding	Flat AC Sheeting	60m2	North facing, Middle portion	Mnimal Damage (2)	Low (1)	Low Priority (2-3)	Chrysotile (white asbestos) , Crocidolite (blue asbestos)
Ceiling Voids	No Asbestos Found						
Underfloor Voids	No Asbestos Found						
<b>Interior</b>							
<b>B00B - R0001 - Main Switch Board - 5.2 m2</b>							
No Asbestos							
<b>B00B - R0003 - Movement - 2 m2</b>							
No Asbestos							
<b>B00B - R0004 - Movement - 47.44 m2</b>							
No Asbestos							

<b>B00B - R0005 - Special Programs Room - 14.35 m2</b>							
No Asbestos							
<b>B00B - R0006 - Practical Activities - 44.92 m2</b>							
No Asbestos							
<b>B00B - R0007 - Withdrawal Space - 1hb - 14.24 m2</b>							
No Asbestos							
<b>B00B - R0008 - Withdrawal Space - 1hb - 30.25 m2</b>							
No Asbestos							
<b>B00B - R0009 - Home Base - 44.4 m2</b>							
No Asbestos							
<b>B00B - R0010 - Practical Activities - 1hb - 15.84 m2</b>							
No Asbestos							
<b>B00B - R0011 - Home Base - 45.3 m2</b>							
No Asbestos							
<b>B00B - R0012 - Movement - 12.31 m2</b>							
No Asbestos							
<b>B00B - R0013 - General Assistant/Bulk Store - 3.04 m2</b>							
No Asbestos							
<b>B00B - R0014 - Movement - 16.5 m2</b>							
No Asbestos							
<b>B00B - R0015 - Staff Toilet - 8.86 m2</b>							
Partition Walls (Cubicles)	Compressed AC Sheet	6m2	All surfaces	Good Condition (1)	Low (1)	Low Priority (2-3)	Chrysotile (white asbestos)
<b>B00B - R0016 - Staff Toilet - 8.11 m2</b>							
Partition Walls (Cubicles)	Compressed AC Sheet	4m2	All surfaces	Good Condition (1)	Low (1)	Low Priority (2-3)	Chrysotile (white asbestos)
<b>B00B - R0017 - Movement - 3.01 m2</b>							
No Asbestos							
<b>B00B - R0018 - Movement - 28.07 m2</b>							
Floor Coverings Res/Textile	Vinyl Tiles	0.2m2	South facing	Good Condition (1)	Low (1)	Low Priority (2-3)	Chrysotile (white asbestos)
<b>B00B - R0019 - Home Base - 47.7 m2</b>							
No Asbestos							
<b>B00B - R0020 - Home Base - 47.57 m2</b>							
No Asbestos							
<b>B00B - R0021 - Practical Activities - 1hb - 13.77 m2</b>							
No Asbestos							
<b>B00B - R0022 - Movement - 12.85 m2</b>							
Ceiling Structures/Linings	Flat AC Sheeting						
<b>B00B - R1001 - Movement - 108.33 m2</b>							
No Asbestos							
<b>B00B - R1002 - Cleaning Supplies - 5.02 m2</b>							
No Asbestos							
<b>B00B - R1003 - Staff Room Annexe - 8.48 m2</b>							
No Asbestos							
<b>B00B - R1004 - Home Base - 46.88 m2</b>							
No Asbestos							
<b>B00B - R1005 - Practical Activities - 1hb - 7.39 m2</b>							
Floor Coverings Res/Textile	Vinyl Tiles	8m2	All surfaces	Some Damage - Unsealed (3)	Low (1)	Low Priority (2-3)	Chrysotile (white asbestos)
<b>B00B - R1006 - Home Base - 45.99 m2</b>							
No Asbestos							

<b>B00B - R1007 - Withdrawal Space - 1hb - 15.01 m2</b>							
No Asbestos							
<b>B00B - R1008 - Withdrawal Space - 1hb - 30.54 m2</b>							
No Asbestos							
<b>B00B - R1009 - Withdrawal Space - 1hb - 46 m2</b>							
No Asbestos							
<b>B00B - R1010 - Home Base - 47.65 m2</b>							
No Asbestos							
<b>B00B - R1011 - Home Base - 47.41 m2</b>							
No Asbestos							
<b>B00B - R1012 - Practical Activities - 1hb - 13.69 m2</b>							
Floor Coverings Res/Textile	Vinyl Tiles	13m2	All surfaces	Minimal Damage (2)	Low (1)	Low Priority (2-3)	Chrysotile (white asbestos)
<b>B00B - R1013 - Movement - 15.24 m2</b>							
No Asbestos							
<b>B00C - Pupil Facilities/General Learning - 1977 - Brick/Block</b>							
<b>Exterior</b>							
Eaves Linings	Flat AC Sheeting	40m2	All surfaces	Good Condition (1)	Low (1)	Low Priority (2-3)	Chrysotile (white asbestos)
Ceiling Voids	No Asbestos Found						
Underfloor Voids	No Asbestos Found						
<b>Interior</b>							
<b>B00C - R0001 - Movement - 303.4 m2</b>							
Ceiling Structures/Linings	Flat AC Sheeting	200m2	Covered area adj. canteen	Good Condition (1)	Low (1)	Low Priority (2-3)	Chrysotile (white asbestos)
<b>B00C - R0002 - Canteen - 45.91 m2</b>							
Floor Coverings Res/Textile	Vinyl Tiles	46m2	North facing	Some Damage - Unsealed (3)	Low (1)	Low Priority (2-3)	Chrysotile (white asbestos)
<b>B00C - R0003 - Canteen Office/Store - 6.6 m2</b>							
Floor Coverings Res/Textile	Vinyl Tiles	7m2	North facing	Good Condition (1)	Low (1)	Low Priority (2-3)	Chrysotile (white asbestos)
<b>B00C - R0004 - Staff Toilet - 3.62 m2</b>							
Floor Coverings Res/Textile	Vinyl Tiles	2m2	North facing	Good Condition (1)	Low (1)	Low Priority (2-3)	Chrysotile (white asbestos)
<b>B00C - R0005 - Canteen Office/Store - 4.14 m2</b>							
Floor Coverings Res/Textile	Vinyl Tiles	5m2	North facing	Good Condition (1)	Low (1)	Low Priority (2-3)	Chrysotile (white asbestos)
<b>B00C - R0006 - Sports Store - 11.85 m2</b>							
No Asbestos							
<b>B00C - R0007 - Cleaning Distributed Store - 12.2 m2</b>							
No Asbestos							
<b>B00C - R0008 - General Assistant/Bulk Store - 14.93 m2</b>							
No Asbestos							
<b>B00C - R0009 - Toilets - Girls - 44.8 m2</b>							
No Asbestos							
<b>B00C - R0010 - Toilets - Boys - 36.71 m2</b>							
Partition Walls (Cubicles)	Compressed AC Sheet	10m2	All surfaces	Good Condition (1)	Low (1)	Low Priority (2-3)	Chrysotile (white asbestos)
<b>B00C - R0011 - Garden Store - 9.29 m2</b>							
No Asbestos							
<b>B00C - R0012 - Movement - 7.14 m2</b>							
No Asbestos							
<b>B00C - R0013 - Distribution Board - .62 m2</b>							
							<b>Note: No inspection of live electrical installation</b>

Ceiling Structures/Linings	Flat AC Sheeting	2m2	Ceiling & loose panel	Some Damage - Unsealed (3)	Medium (2)	Low Priority (2-3)	Chrysotile (white asbestos)
<b>B00C - R1001 - Movement - 4.38 m2</b>							
Ceiling Structures/Linings	Flat AC Sheeting	20m2	All surfaces	Good Condition (1)	Low (1)	Low Priority (2-3)	Chrysotile (white asbestos)
<b>B00C - R1002 - Home Base - 81.32 m2</b>							
No Asbestos							
<b>B00C - R1003 - Practical Activities - 1hb - 11.58 m2</b>							
Floor Coverings Res/Textile	Vinyl Tiles	12m2	All surfaces	Good Condition (1)	Low (1)	Low Priority (2-3)	Chrysotile (white asbestos)
<b>B00C - R1004 - Home Base - 80.15 m2</b>							
No Asbestos							
<b>B00C - R1005 - Practical Activities - 1hb - 11.62 m2</b>							
Floor Coverings Res/Textile	Vinyl Tiles	12m2	All surfaces	Good Condition (1)	Low (1)	Low Priority (2-3)	Chrysotile (white asbestos)
<b>B00C - R1006 - Movement - 4.04 m2</b>							
No Asbestos							
<b>B00D - Library/General Learning - 1977 - Brick/Block</b>							
<b>Exterior</b>							
Ceiling Voids	No Asbestos Found						
Underfloor Voids	No Asbestos Found						
<b>Interior</b>							
<b>B00D - R0001 - Home Base - 83.63 m2</b>							
Ceiling Structures/Linings	Vermiculite - Composite Sample - ( 70 - 120 m2) - ( X8 )						
Floor Coverings Res/Textile	Vinyl Tiles	12m2	East facing	Good Condition (1)	Low (1)	Low Priority (2-3)	Chrysotile (white asbestos)
<b>B00D - R0002 - Movement - 3.91 m2</b>							
No Asbestos							
<b>B00D - R0003 - Home Base - 83.53 m2</b>							
Ceiling Structures/Linings	Vermiculite - Composite Sample - ( 70 - 120 m2) - ( X8 )						
Floor Coverings Res/Textile	Vinyl Tiles	12m2	East facing	Good Condition (1)	Low (1)	Low Priority (2-3)	Chrysotile (white asbestos)
<b>B00D - R0004 - Movement - 3.99 m2</b>							
No Asbestos							
<b>B00D - R0005 - Home Base - 59.34 m2</b>							
Ceiling Structures/Linings	Vermiculite - Composite Sample - ( 40 - 70 m2) - ( X5 )						
<b>B00D - R0006 - Practical Activities - 1hb - 12.57 m2</b>							
Ceiling Structures/Linings	Vermiculite - Composite Sample - ( 10 - 40 m2) - ( X3 )						
Floor Coverings Res/Textile	Vinyl Tiles	13m2	All surfaces	Good Condition (1)	Low (1)	Low Priority (2-3)	Chrysotile (white asbestos)
<b>B00D - R0007 - Movement - 23.05 m2</b>							
Ceiling Structures/Linings	Vermiculite - Composite Sample - ( 10 - 40 m2) - ( X3 )						
Floor Coverings Res/Textile	Vinyl Tiles	6m2	West facing	Good Condition (1)	Low (1)	Low Priority (2-3)	Chrysotile (white asbestos)
<b>B00D - R0008 - Practical Activities - 1hb - 12.65 m2</b>							
Ceiling Structures/Linings	Vermiculite - Composite Sample - ( 10 - 40 m2) - ( X3 )						
<b>B00D - R0009 - Home Base - 58.94 m2</b>							
Ceiling Structures/Linings	Vermiculite - Composite Sample - ( 40 - 70 m2) - ( X5 )						
<b>B00D - R0010 - Movement - 26.9 m2</b>							

No Asbestos							
<b>B00D - R0012 - Stairs - 15.53 m2</b>							
No Asbestos							
<b>B00D - R1001 - Reading Area - 15.93 m2</b>							
No Asbestos							
<b>B00D - R1002 - Reading Area - 243.21 m2</b>							
No Asbestos							
<b>B00D - R1003 - Movement - 25.76 m2</b>							
No Asbestos							
<b>B00D - R1004 - Toilets - Girls - 3.69 m2</b>							
No Asbestos							
<b>B00D - R1005 - Distribution Board - 1.91 m2</b>							
							<b>Note: No inspection of live electrical installation</b>
Floor Coverings Res/Textile	Vinyl Tiles	2m2	East facing	Good Condition (1)	Low (1)	Low Priority (2-3)	Chrysotile (white asbestos)
<b>B00D - R1006 - Movement - 10.48 m2</b>							
No Asbestos							
<b>B00D - R1007 - Toilets - Boys - 3.53 m2</b>							
Partition Walls (Cubicles)	Compressed AC Sheet	2m2	All surfaces	Good Condition (1)	Low (1)	Low Priority (2-3)	Chrysotile (white asbestos)
<b>B00D - R1008 - Cleaning Distributed Store - 1.72 m2</b>							
No Asbestos							
<b>B00D - R1009 - Library Office/Workroom - 8.62 m2</b>							
No Asbestos							
<b>B00D - R1010 - Library Office/Workroom - 19.57 m2</b>							
No Asbestos							
<b>B00D - R1011 - Communications Room - 12.25 m2</b>							
No Asbestos							
<b>B00D - R1012 - K.L.A. Store - 16.12 m2</b>							
No Asbestos							
<b>B00D - R1013 - Stairs - 15.53 m2</b>							
No Asbestos							
<b>B00E - Administration/General Learning - 1977 - Brick/Block</b>							
<b>Exterior</b>							
Ceiling Voids	No Asbestos Found						
Underfloor Voids	No Asbestos Found						
<b>Interior</b>							
<b>B00E - R0001 - Craft Store - 18.64 m2</b>							
Floor Coverings Res/Textile	Vinyl Sheet						
<b>B00E - R0002 - Staff Toilet - 2.22 m2</b>							
No Asbestos							
<b>B00E - R0003 - Sick Bay - 11.13 m2</b>							
Ceiling Structures/Linings	Flat AC Sheeting	6m2	East facing	Good Condition (1)	Low (1)	Low Priority (2-3)	Chrysotile (white asbestos), Amosite (brown asbestos)
<b>B00E - R0004 - Movement - 1.49 m2</b>							
No Asbestos							
<b>B00E - R0005 - Movement - 18.2 m2</b>							
No Asbestos							
<b>B00E - R0006 - Duplicating Workroom - 39.93 m2</b>							
No Asbestos							
<b>B00E - R0007 - Staff Kitchen - 8.53 m2</b>							
No Asbestos							
<b>B00E - R0008 - Movement - 1.98 m2</b>							



No Asbestos							
<b>B00E - R0009 - Home Base - 43.39 m2</b>							
No Asbestos							
<b>B00E - R0010 - Withdrawal Space - 1hb - 25.03 m2</b>							
No Asbestos							
<b>B00E - R0011 - Practical Activities - 1hb - 18.53 m2</b>							
No Asbestos							
<b>B00E - R0012 - Practical Activities - 2hb - 106.77 m2</b>							
No Asbestos							
<b>B00E - R0013 - Home Base - 43.14 m2</b>							
No Asbestos							
<b>B00E - R0014 - Withdrawal Space - 1hb - 18.44 m2</b>							
No Asbestos							
<b>B00E - R0015 - Practical Activities - 1hb - 24.46 m2</b>							
No Asbestos							
<b>B00E - R0016 - Movement - 9.82 m2</b>							
Ceiling Structures/Linings	Flat AC Sheeting	10m2	All surfaces	Good Condition (1)	Low (1)	Low Priority (2-3)	Chrysotile (white asbestos)
<b>B00E - R0017 - Entry Vestibule - 13.64 m2</b>							
No Asbestos							
<b>B00E - R0018 - Clerical Office - 13.38 m2</b>							
Wall Linings Internal	Flat AC Sheeting	2m2	Below windows	Good Condition (1)	Low (1)	Low Priority (2-3)	Chrysotile (white asbestos)
<b>B00E - R0019 - Principal - 13.64 m2</b>							
Wall Linings Internal	Flat AC Sheeting	2m2	Below windows	Good Condition (1)	Low (1)	Low Priority (2-3)	Chrysotile (white asbestos)
<b>B00E - R0020 - Deputy Principal - 14.02 m2</b>							
Wall Linings Internal	Flat AC Sheeting	2m2	Below windows	Good Condition (1)	Low (1)	Low Priority (2-3)	Chrysotile (white asbestos)
<b>B00E - R0021 - Clerical Office/Workroom - 10.96 m2</b>							
Wall Linings Internal	Flat AC Sheeting	2m2	Below windows	Good Condition (1)	Low (1)	Low Priority (2-3)	Chrysotile (white asbestos)
<b>B00E - R0022 - Home Base - 44.04 m2</b>							
Ceiling Structures/Linings	Vermiculite - Composite Sample - (40 - 70 m2) - ( X5 )						
<b>B00E - R0023 - Practical Activities - 1hb - 27.85 m2</b>							
Ceiling Structures/Linings	Vermiculite - Composite Sample - (10 - 40 m2) - ( X3 )						
<b>B00E - R0024 - Home Base - 54 m2</b>							
Ceiling Structures/Linings	Vermiculite - Composite Sample - (40 - 70 m2) - ( X5 )						
<b>B00E - R0025 - Practical Activities - 1hb - 32.75 m2</b>							
Ceiling Structures/Linings	Vermiculite - Composite Sample - (10 - 40 m2) - ( X3 )						
Floor Coverings Res/Textile	Vinyl Tiles	33m2	All surfaces	Good Condition (1)	Low (1)	Low Priority (2-3)	Chrysotile (white asbestos)
<b>B00E - R0026 - General Storeroom - 2.72 m2</b>							
Ceiling Structures/Linings	Vermiculite - Composite Sample - (< 10 m2) - ( X2 )						
<b>B00E - R0027 - Distribution Board - .76 m2</b>							
<b>Note: No inspection of live electrical installation</b>							
No Asbestos							
<b>B00E - R0028 - Home Base - 52.14 m2</b>							
Ceiling Structures/Linings	Vermiculite - Composite Sample - (40 - 70 m2) - ( X5 )						
<b>B00E - R0029 - Practical Activities - 1hb - 21.42 m2</b>							

Ceiling Structures/Linings	Vermiculite - Composite Sample - (10 - 40 m2) - ( X3 )						
Floor Coverings Res/Textile	Vinyl Tiles	22m2	All surfaces	Good Condition (1)	Low (1)	Low Priority (2-3)	Chrysotile (white asbestos)
<b>B00E - R0030 - Movement - 26.14 m2</b>							
Ceiling Structures/Linings	Vermiculite - Composite Sample - (10 - 40 m2) - ( X3 )						
<b>B00E - R0031 - Home Base - 46.12 m2</b>							
Ceiling Structures/Linings	Vermiculite - Composite Sample - (40 - 70 m2) - ( X5 )						
<b>B00E - R0032 - Practical Activities - 1hb - 27.78 m2</b>							
Ceiling Structures/Linings	Vermiculite - Composite Sample - (10 - 40 m2) - ( X3 )						
Floor Coverings Res/Textile	Vinyl Tiles	28m2	All surfaces	Good Condition (1)	Low (1)	Low Priority (2-3)	Chrysotile (white asbestos)
<b>B00E - R0033 - Security Store - 3.17 m2</b>							
Floor Coverings Res/Textile	Vinyl Tiles	4m2	North facing	Good Condition (1)	Low (1)	Low Priority (2-3)	Chrysotile (white asbestos)
<b>B00E - R0034 - Cleaning Distributed Store - 1.67 m2</b>							
Floor Coverings Res/Textile	Vinyl Tiles	2m2	North facing	Good Condition (1)	Low (1)	Low Priority (2-3)	Chrysotile (white asbestos)
<b>B00E - R0035 - Staff Toilet - 5.05 m2</b>							
No Asbestos							
<b>B00E - R0036 - Staff Toilet - 5.05 m2</b>							
Partition Walls (Cubicles)	Compressed AC Sheet	0.5m2	All surfaces	Good Condition (1)	Low (1)	Low Priority (2-3)	Chrysotile (white asbestos)
<b>B00E - R0037 - General Storeroom - 7.57 m2</b>							
Floor Coverings Res/Textile	Vinyl Tiles	8m2	North facing	Good Condition (1)	Low (1)	Low Priority (2-3)	Chrysotile (white asbestos)
<b>B00E - R0038 - Movement - 25.51 m2</b>							
No Asbestos							
<b>B00E - R0039 - Distribution Board - .6 m2</b>							
No Asbestos							Note: No inspection of live electrical installation
<b>B00E - R0040 - Movement - 39.1 m2</b>							
No Asbestos							
<b>B00E - R0041 - Movement - 4.79 m2</b>							
Ceiling Structures/Linings	Flat AC Sheeting	5m2	All surfaces	Good Condition (1)	Low (1)	Low Priority (2-3)	Chrysotile (white asbestos)
<b>B00E - R0042 - Movement - 4.82 m2</b>							
Ceiling Structures/Linings	Flat AC Sheeting	5m2	All surfaces	Good Condition (1)	Low (1)	Low Priority (2-3)	Chrysotile (white asbestos)
<b>B00E - R0043 - Toilets - Boys - 38.6 m2</b>							
Partition Walls (Cubicles)	Compressed AC Sheet	10m2	All surfaces	Good Condition (1)	Low (1)	Low Priority (2-3)	Chrysotile (white asbestos)
<b>B00E - R0044 - Toilets - Girls - 41.14 m2</b>							
Partition Walls (Cubicles)	Compressed AC Sheet	18m2	All surfaces	Good Condition (1)	Low (1)	Low Priority (2-3)	Chrysotile (white asbestos)
<b>B00E - R0045 - Cleaning Distributed Store - 1.47 m2</b>							
No Asbestos							
<b>B00E - R0046 - Movement - 11.25 m2</b>							
Ceiling Structures/Linings	Flat AC Sheeting	12m2	All surfaces	Good Condition (1)	Low (1)	Low Priority (2-3)	Chrysotile (white asbestos)
<b>B00E - R0047 - Movement - 58.28 m2</b>							
No Asbestos							
<b>B00E - R1001 - Practical Activities - 1hb - 30.36 m2</b>							

Floor Coverings Res/Textile	Vinyl Tiles	31m2	All surfaces	Good Condition (1)	Low (1)	Low Priority (2-3)	Chrysotile (white asbestos)
<b>B00E - R1002 - Home Base - 50.17 m2</b>							
No Asbestos							
<b>B00E - R1003 - Movement - 4.33 m2</b>							
No Asbestos							
<b>B00E - R1004 - Home Base - 49.96 m2</b>							
No Asbestos							
<b>B00E - R1005 - Practical Activities - 1hb - 29.52 m2</b>							
Floor Coverings Res/Textile	Vinyl Tiles	30m2	All surfaces	Good Condition (1)	Low (1)	Low Priority (2-3)	Chrysotile (white asbestos)
<b>B00E - R1006 - General Storeroom - 3.8 m2</b>							
No Asbestos							
<b>B00E - R1007 - Home Base - 58.56 m2</b>							
No Asbestos							
<b>B00E - R1008 - Practical Activities - 1hb - 29.19 m2</b>							
Floor Coverings Res/Textile	Vinyl Tiles	30m2	All surfaces	Good Condition (1)	Low (1)	Low Priority (2-3)	Chrysotile (white asbestos)
<b>B00E - R1009 - Home Base - 45.5 m2</b>							
No Asbestos							
<b>B00E - R1010 - Practical Activities - 1hb - 29.03 m2</b>							
Floor Coverings Res/Textile	Vinyl Tiles	30m2	All surfaces	Good Condition (1)	Low (1)	Low Priority (2-3)	Chrysotile (white asbestos)
<b>B00E - R1011 - Movement - 12.26 m2</b>							
Floor Coverings Res/Textile	Vinyl Tiles	13m2	All surfaces	Good Condition (1)	Low (1)	Low Priority (2-3)	Chrysotile (white asbestos)
<b>B00G - Building Services - 2000 - Brick/Veneer</b>							
<b>Exterior</b>							
Eaves Linings	Flat AC Sheeting	3m2	West facing	Good Condition (1)	Low (1)	Low Priority (2-3)	Chrysotile (white asbestos)
Ceiling Voids	No Asbestos Found						
Underfloor Voids	No Asbestos Found						
<b>Interior</b>							
<b>B00G - R0001 - No Access - 11.72 m2</b>							
Ceiling Structures/Linings	Flat AC Sheeting	6m2	All surfaces	Good Condition (1)	Low (1)	Low Priority (2-3)	Chrysotile (white asbestos)
<b>B00H - Other-After School Care - 2004 - Timber</b>							
<b>Exterior</b>							
Ceiling Voids	No Asbestos Found						
Underfloor Voids	No Asbestos Found						
<b>Interior</b>							
<b>B00H - R0001 - Clerical Office/Workroom - 7.17 m2</b>							
Floor Coverings Res/Textile	No Asbestos Found						
<b>B00H - R0002 - Practical Activities - 11.38 m2</b>							
No Asbestos							
<b>B00H - R0003 - Out Of School Hours Care Centre - 81.89 m2</b>							
Floor Coverings Res/Textile	No Asbestos Found						
<b>B00H - R0004 - Laundry - Type 2 - 9.33 m2</b>							
No Asbestos							
<b>B00H - R0005 - Handwashing Facilities - 4.63 m2</b>							
No Asbestos							
<b>B00H - R0006 - Toilets - Boys/Girls - 1.44 m2</b>							

No Asbestos		
<b>B00H - R0007 - Toilets - Boys/Girls - 1.46 m2</b>		
No Asbestos		
<b>B00H - R0008 - Disabled Toilet - 3.21 m2</b>		
No Asbestos		
<b>B00H - R0009 - Movement - 38.84 m2</b>		
No Asbestos		
<b>B00I - General Learning - 2010 - Brick/Veneer</b>		
<b>Exterior</b>		
Ceiling Voids	No Asbestos Found	
Underfloor Voids	No Asbestos Found	
<b>Interior</b>		
<b>B00I - R0001 - Home Base - 60.76 m2</b>		
No Asbestos		
<b>B00I - R0002 - Home Base Store - 6.16 m2</b>		
No Asbestos		
<b>B00I - R0003 - Practical Activities/Movement - 1hb - 18.72 m2</b>		
No Asbestos		
<b>B00I - R0004 - Withdrawal Space - 2hb - 11.77 m2</b>		
No Asbestos		
<b>B00I - R0005 - Home Base - 60.76 m2</b>		
No Asbestos		
<b>B00I - R0006 - Home Base Store - 6.16 m2</b>		
No Asbestos		
<b>B00I - R0007 - Practical Activities/Movement - 1hb - 18.72 m2</b>		
No Asbestos		
<b>B00I - R0008 - Special Programs Room - Type 1 - 44.34 m2</b>		
No Asbestos		
<b>B00I - R0009 - Special Programs Store - 5.89 m2</b>		
No Asbestos		
<b>B00I - R0010 - External Movement - 62.42 m2</b>		
No Asbestos		

**Demountables**

**OS 602 19351 - Learning Unit - Standard With P.A.A. - Placement Date : 13-FEB-2019**

**Note: This refurbished demountable may have asbestos present in remnant mastic in window frames.**

No Asbestos Found

**OS 602 19692 - Learning Unit - Standard With P.A.A. - Placement Date : 13-FEB-2019**

**Note: This refurbished demountable may have asbestos present in remnant mastic in window frames.**

No Asbestos Found