

Asbestos Register

(Hazardous Materials and Risk Assessment)

School:	Fort Street High School (8504)
Region:	Sydney AMU
State Electorate:	Newtown
Local Government Area:	Inner West

Last Reviewed By:	Greencap 13-AUG-2014
Last Revised By:	

Historical Fibro In Grounds Investigations/Events	Yes
Please refer to the latest site specific Asbestos Management Plans available from the Department's website (Refer to Note 2).	

8504 - Fort Street High School
Site Plan (13595)

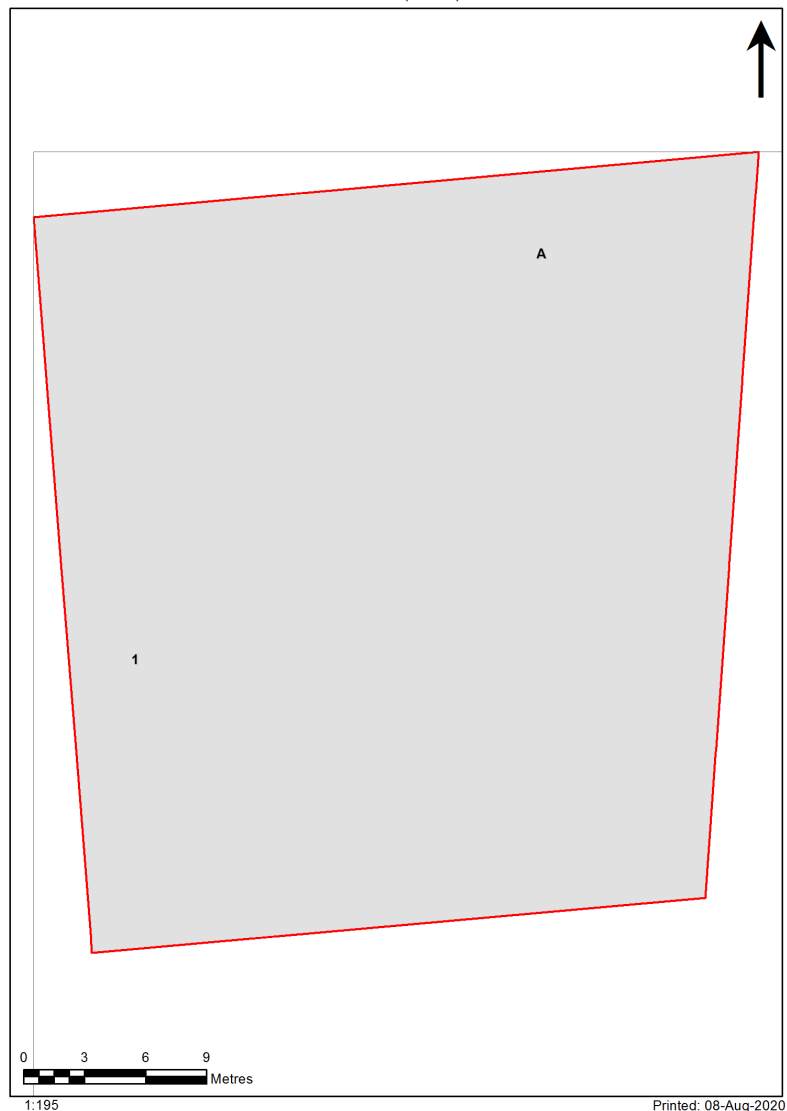

Preface to Asbestos Register

Limitations

Asbestos Registers established (first surveyed 2007/08) and maintained for the Department of Education (DoE) are limited in extent, in that:

1. All inspections and surveys of materials and finishes in DoE facilities are non-disturbance, with
2. Samples undertaken by hygienist to determine whether a sample is an Asbestos Containing Material (ACM),
3. The hygienist may apply a single sample to like materials within a space and adjoining spaces, but not normally between buildings,
4. Successive inspections have reduced any inconclusive records such as 'assumed asbestos' in difficult to access areas, by undertaking additional sampling with lifting devices.
5. In compliance with WHS Act 2011 and WHS Regulations 2017, additional inspections have been undertaken in ceiling spaces and sub-floor areas where access is possible.
 - o Where the ground floor is slab on ground, no inspection is made beneath the slab.
 - o Where fibro fragments (ACM taken for sampling) are located in ceiling spaces or sub floor voids air monitoring is normally undertaken at time of sampling, and clearance undertaken as soon as practicable.
6. No attempt has been made to identify any ACM that is hidden from view or encapsulated within
 - o Any wall cavity
 - o Sub floor area, particularly formwork for slabs in/on ground,
 - o Services (that may use ACM) such as: pipe lagging, asbestos cement pipes, flues.
7. All known ACM in Grounds (Fibro in Grounds) is made available in associated site specific asbestos management plans in DoE electronic files.
Notwithstanding information provided, ACM may be present in grounds from time to time and caution must be exercised prior to any grounds disturbance.

Use of the Asbestos Register

Prior to any disturbance works being undertaken in a building to which this asbestos register applies it will be necessary to confirm the extent of any ACM by a disturbance investigation:

- If the building was built prior to 2003
- If any ACM has been identified in the Asbestos Register for the building.

Update of Asbestos Registers

Asbestos Register Data is updated regularly by the DoE Hygienist Panel via the Online Asbestos Register Tool (Managed by Business Systems, School Infrastructure NSW). Internal users can view the latest edition of the Asbestos Register in the AMS.

Please note: The Department's external website may not contain the latest revision of the Asbestos Register.

Notes 1: Vermiculite

- During 2018/19, all vermiculite occurrences in DoE schools identified in 2007/08, were 'composite tested' in accordance with a safe work NSW agreed procedure. This required multiple testing of all vermiculite occurrences.
- During the period 2007/08 to 2018/19, some vermiculite has been over sheeted and a warning is indicated for schools where this has happened.

Note 2: DoE website link for information is here:

<https://www.schoolinfrastructure.nsw.gov.au/about-us/working-with-us/schools-asbestos-register.html>
<https://education.nsw.gov.au/about-us/strategies-and-reports/our-reports-and-reviews/schools-asbestos-register>

Note 3: Material Condition Assessment

The material condition assessment descriptors from Section 3 of the Asbestos Management Plan (AMP) is extracted below. Please read the AMP in its entirety for further information.

3.3.2.1 Material condition assessment

The OART records the material condition of identified ACM in the following format:

Rating	Description
Good condition (1)	For non-friable asbestos that is sealed and has no visible damage. This primarily related to asbestos cement (AC) sheet and vinyl tiles
Minimal damage (2)	For non-friable asbestos that has a very small amount of damage, eg hairline cracks.
Some damage / unsealed (3)	For non-friable asbestos with significant breakage or several small areas where material has been damaged, revealing loose asbestos fibres. Non-friable asbestos that is unsealed.
Poor condition (4)	For non-friable asbestos that has extensive damage. Visible asbestos debris
Friable asbestos (5)	Any occurrence of friable asbestos

Product	Material Description	Extent	Location	Material Condition	Risk Status	Remediation Priority	Result
B00A - Administration/General Learning - 1916 - Brick/Block							
Exterior							
Eaves Linings	Flat AC Sheeting	250m2	Throughout	Good Condition (1)	Low (1)	Low Priority (2-3)	Chrysotile (white asbestos)
Wall Linings Internal - Infill	Flat AC Sheeting						
Ceiling Voids	No Asbestos Found						
Underfloor Voids	No Asbestos Found						
Interior							
B00A - R0008 - Cleaning Supplies Store - 8.75 m2							
No Asbestos							
B00A - R0009 - Staff Study - 20.18 m2							
No Asbestos							
B00A - R0010 - General Learning Space - 48.24 m2							
Floor Coverings Res/Textile	Vinyl Tiles (Under Floor Covering/Carpet)	49m2	Throughout	Good Condition (1)	Low (1)	Low Priority (2-3)	Chrysotile (white asbestos)
B00A - R0011 - General Learning Space - 48.92 m2							
Floor Coverings Res/Textile	Vinyl Tiles (Under Floor Covering/Carpet)	49m2	Throughout	Good Condition (1)	Low (1)	Low Priority (2-3)	Chrysotile (white asbestos)
B00A - R0013 - Movement - 39.28 m2							
No Asbestos							
B00A - R0014 - Deputy Principal Office - 20.52 m2							
No Asbestos							
B00A - R0015 - Movement - 5.49 m2							
No Asbestos							
B00A - R0016 - Commonroom - 72.16 m2							
No Asbestos							
B00A - R0017 - Commonroom - 8.1 m2							
No Asbestos							
B00A - R0018 - Duplicating Workroom - 24.61 m2							
No Asbestos							
B00A - R0019 - Movement - 22.35 m2							
Ceiling Structures/Linings	Vermiculite - Composite Sample - (10 - 40 m2) - (X3)						
B00A - R0020 - Public Entry - 24.32 m2							
No Asbestos							
B00A - R0021 - Movement - 83.05 m2							
Ceiling Structures/Linings	Vermiculite - Composite Sample - (70 - 120 m2) - (X8)						
B00A - R0023 - Ancillary Staff - 4.23 m2							
No Asbestos							
B00A - R0025 - Staff - Toilet - 3.75 m2							
No Asbestos							
B00A - R0026 - Movement - 23.55 m2							
No Asbestos							
B00A - R0027 - Staff - Toilet - 3.38 m2							
No Asbestos							
B00A - R0029 - Public Entry - 18.12 m2							
No Asbestos							
B00A - R0031 - General Storeroom - 3.46 m2							

No Asbestos							
B00A - R0032 - Public Entry - 2.92 m2							
No Asbestos							
B00A - R0033 - Principal Office - 18.73 m2							
No Asbestos							
B00A - R0034 - General Storeroom - 5.17 m2							
No Asbestos							
B00A - R0035 - General Learning Space - 44.3 m2							
No Asbestos							
B00A - R0036 - Museum - 48.35 m2							
No Asbestos							
B00A - R0037 - General Learning Space - 45.06 m2							
No Asbestos							
B00A - R0038 - Movement - 73.46 m2							
No Asbestos							
B00A - R0039 - Movement - 12.54 m2							
No Asbestos							
B00A - R0040 - Stairs - 5.28 m2							
No Asbestos							
B00A - R0041 - General Learning Space - 39.34 m2							
No Asbestos							
B00A - R0042 - Staff Study - 19.38 m2							
No Asbestos							
B00A - R0043 - Distribution Board Cupboard - .22 m2							Note: No inspection of live electrical installation
Wall Linings Internal	Flat AC Sheeting	1m2	Throughout	Good Condition (1)	Low (1)	Low Priority (2-3)	Chrysotile (white asbestos)
B00A - R0044 - Stairs - 15.01 m2							
No Asbestos							
B00A - R0045 - Distribution Board Cupboard - .15 m2							Note: No inspection of live electrical installation
No Asbestos							
B00A - R0046 - Movement - 10.49 m2							
Ceiling Structures/Linings	Non Accessible Area	m2					
B00A - R0047 - Stairs - 4.76 m2							
No Asbestos							
B00A - R0048 - Movement - 4.39 m2							
No Asbestos							
B00A - R1001 - General Learning Space - 48.33 m2							
Floor Coverings Res/Textile	Vinyl Tiles (Under Floor Covering/Carpet)	49m2	Throughout	Good Condition (1)	Low (1)	Low Priority (2-3)	Chrysotile (white asbestos)
B00A - R1002 - General Learning Space - 45.57 m2							
No Asbestos							
B00A - R1004 - Distribution Board Cupboard - .32 m2							Note: No inspection of live electrical installation
No Asbestos							
B00A - R1005 - General Storeroom - 20.23 m2							
Floor Coverings Res/Textile	Vinyl Tiles (Under Floor Covering/Carpet)	21m2	Throughout	Good Condition (1)	Low (1)	Low Priority (2-3)	Chrysotile (white asbestos)
B00A - R1006 - General Learning Space - 50.5 m2							

Floor Coverings Res/Textile	Vinyl Tiles (Under Floor Covering/Carpet)	51m2	Throughout	Good Condition (1)	Low (1)	Low Priority (2-3)	Chrysotile (white asbestos)
B00A - R1007 - General Learning Space - 50.56 m2							
Floor Coverings Res/Textile	Vinyl Tiles (Under Floor Covering/Carpet)	51m2	Throughout	Good Condition (1)	Low (1)	Low Priority (2-3)	Chrysotile (white asbestos)
B00A - R1008 - Movement - 77.34 m2							
No Asbestos							
B00A - R1009 - Staff Study - 21.02 m2							
Floor Coverings Res/Textile	Vinyl Tiles (Under Floor Covering/Carpet)	22m2	Throughout	Good Condition (1)	Low (1)	Low Priority (2-3)	Chrysotile (white asbestos)
B00A - R1010 - Movement - 45.81 m2							
No Asbestos							
B00A - R1012 - General Learning Space - 48.43 m2							
No Asbestos							
B00A - R1013 - Staff Study - 35.62 m2							
No Asbestos							
B00A - R1014 - General Learning Space - 47.75 m2							
No Asbestos							
B00A - R1015 - Movement - 24.26 m2							
No Asbestos							
B00A - R1016 - Distribution Board Cupboard - .85 m2							
						Note: No inspection of live electrical installation	
No Asbestos							
B00A - R1017 - Movement - 88.2 m2							
Ceiling Structures/Linings	Vermiculite - Composite Sample - (70 - 120 m2) - (X8)						
B00A - R1018 - General Learning Space - 45.27 m2							
Floor Coverings Res/Textile	Vinyl Tiles (Under Floor Covering/Carpet)	46m2	Throughout	Good Condition (1)	Low (1)	Low Priority (2-3)	Chrysotile (white asbestos)
B00A - R1021 - Movement - 5.98 m2							
No Asbestos							
B00A - R1022 - General Learning Space - 45.44 m2							
Floor Coverings Res/Textile	Vinyl Tiles (Under Floor Covering/Carpet)	46m2	Throughout	Good Condition (1)	Low (1)	Low Priority (2-3)	Chrysotile (white asbestos)
B00A - R1023 - Movement - 24 m2							
No Asbestos							
B00A - R1024 - Stairs - 15.19 m2							
No Asbestos							
B00A - R1025 - Stairs - 15.14 m2							
No Asbestos							
B00A - R1026 - Stairs - 16.16 m2							
No Asbestos							
B00A - R1027 - General Learning Space - 78.4 m2							
No Asbestos							
B00A - R2001 - General Learning Space - 49.21 m2							
Floor Coverings Res/Textile	Vinyl Tiles (Under Floor Covering/Carpet)	50m2	Throughout	Good Condition (1)	Low (1)	Low Priority (2-3)	Chrysotile (white asbestos)
B00A - R2002 - General Learning Space - 45.64 m2							
Floor Coverings Res/Textile	Vinyl Tiles (Under Floor Covering/Carpet)	46m2	Throughout	Good Condition (1)	Low (1)	Low Priority (2-3)	Chrysotile (white asbestos)
B00A - R2004 - Cleaning Store - Distributed - 2.55 m2							

No Asbestos							
B00A - R2005 - Staff Study - 21.08 m2							
Floor Coverings Res/Textile	Vinyl Tiles	22m2	All surfaces	Good Condition (1)	Low (1)	Low Priority (2-3)	Chrysotile (white asbestos)
B00A - R2006 - General Learning Space - 50.95 m2							
No Asbestos							
B00A - R2007 - General Learning Space - 50.82 m2							
Floor Coverings Res/Textile	Vinyl Tiles (Under Floor Covering/Carpet)	51m2	Throughout	Good Condition (1)	Low (1)	Low Priority (2-3)	Chrysotile (white asbestos)
B00A - R2008 - Movement - 76.92 m2							
Ceiling Structures/Linings	Vermiculite - Composite Sample - (70 - 120 m2) - (X8)						
B00A - R2009 - General Storeroom - 21.74 m2							
Floor Coverings Res/Textile	Vinyl Tiles	1m2	South east corner	Good Condition (1)	Low (1)	Low Priority (2-3)	Chrysotile (white asbestos)
B00A - R2011 - Movement - 45.76 m2							
Ceiling Structures/Linings	Vermiculite - Composite Sample - (40 - 70 m2) - (X5)						
B00A - R2012 - General Learning Space - 33.76 m2							
No Asbestos							
B00A - R2013 - General Learning Space - 49.37 m2							
No Asbestos							
B00A - R2014 - Computer Learning Space - 50.53 m2							
No Asbestos							
B00A - R2015 - Movement - 24.2 m2							
No Asbestos							
B00A - R2016 - Distribution Board Cupboard - .29 m2						Note: No inspection of live electrical installation	
No Asbestos							
B00A - R2017 - Movement - 92.56 m2							
Ceiling Structures/Linings	Vermiculite - Composite Sample - (70 - 120 m2) - (X8)						
B00A - R2018 - General Learning Space - 45.7 m2							
No Asbestos							
B00A - R2020 - Movement - 5.98 m2							
No Asbestos							
B00A - R2023 - Movement - 23.96 m2							
No Asbestos							
B00A - R2025 - Distribution Board Cupboard - .32 m2						Note: No inspection of live electrical installation	
No Asbestos							
B00A - R2026 - Stairs - 15.32 m2							
No Asbestos							
B00A - R2027 - Computer Learning Space - 45.84 m2							
No Asbestos							
B00A - R2028 - General Learning Space - 80.13 m2							
No Asbestos							
B00A - R2029 - Stairs - 15.42 m2							
No Asbestos							
B00A - R2030 - Stairs - 16.16 m2							
No Asbestos							
B00A - R9001 - Art Entry/Display - 7.23 m2							
No Asbestos							
B00A - R9002 - Art Learning Space - 47.42 m2							

Ceiling Structures/Linings	Vermiculite - Composite Sample - (40 - 70 m2) - (X5)							
Floor Coverings Res/Textile	Vinyl Tiles (Under Floor Covering/Carpet)	48m2	Throughout	Good Condition (1)	Low (1)	Low Priority (2-3)	Chrysotile (white asbestos)	
B00A - R9003 - Workshop - 76.32 m2								
Floor Coverings Res/Textile	Vinyl Tiles	78m2	All surfaces	Good Condition (1)	Low (1)	Low Priority (2-3)	Chrysotile (white asbestos)	
B00A - R9004 - Resources Store - 43.29 m2								
No Asbestos								
B00A - R9005 - KIn Space - 23.6 m2								
Floor Coverings Res/Textile	Vinyl Tiles	24m2	Throughout	Good Condition (1)	Low (1)	Low Priority (2-3)	Chrysotile (white asbestos)	
B00A - R9006 - Workshop - 17.38 m2								
Floor Coverings Res/Textile	Vinyl Tiles	18m2	Throughout	Good Condition (1)	Low (1)	Low Priority (2-3)	Chrysotile (white asbestos)	
B00A - R9007 - Cleaning Store - Distributed - 3.4 m2								
No Asbestos								
B00A - R9008 - Staff - Toilet - 11.5 m2								
No Asbestos								
B00A - R9009 - Staff - Toilet - 16.48 m2								
No Asbestos								
B00A - R9011 - Computer Store - 4.47 m2								
No Asbestos								
B00A - R9012 - Stairs - 5.43 m2								
No Asbestos								
B00A - R9013 - Toilet - Lobby - 1.29 m2								
No Asbestos								
B00A - R9014 - Movement - 5.45 m2								
No Asbestos								
B00B - Various - 1925 - Brick/Block								
Exterior								
Wall Linings Internal	Flat AC Sheeting	5	South wall basement	Good Condition (1)	Low (1)	Low Priority (2-3)	Chrysotile (white asbestos)	
Eaves Linings	Flat AC Sheeting	140m2	All surfaces	Good Condition (1)	Low (1)	Low Priority (2-3)	Chrysotile (white asbestos)	
Underfloor Voids	No Asbestos Found							
Ceiling Voids	No Asbestos Found							
Interior								
B00B - M0001 - Control Room - 12.17 m2								
No Asbestos								
B00B - M0002 - Stairs - 2.07 m2								
No Asbestos								
B00B - R0001 - Stage - 10.23 m2								
No Asbestos								
B00B - R0002 - Stage - 57.98 m2								
No Asbestos								
B00B - R0003 - Stage - 13.1 m2								
No Asbestos								
B00B - R0005 - Multi-Purpose Space - 590.51 m2								

No Asbestos							
B00B - R0007 - Movement - 4.71 m2							
Ceiling Structures/Linings	Flat AC Sheeting	5m2	All surfaces	Good Condition (1)	Low (1)	Low Priority (2-3)	Chrysotile (white asbestos)
B00B - R0008 - Staff Kitchen - 7.07 m2							
Floor Coverings Res/Textile	Vinyl Tiles	8m2	All surfaces	Good Condition (1)	Low (1)	Low Priority (2-3)	Chrysotile (white asbestos)
Ceiling Structures/Linings	Flat AC Sheeting	8m2	All surfaces	Good Condition (1)	Low (1)	Low Priority (2-3)	Chrysotile (white asbestos)
B00B - R0009 - Movement - 8.23 m2							
Ceiling Structures/Linings	Flat AC Sheeting	9m2	Throughout	Good Condition (1)	Low (1)	Low Priority (2-3)	Chrysotile (white asbestos)
B00B - R0010 - External Movement - .91 m2							
Ceiling Structures/Linings	Flat AC Sheeting	1m2	All surfaces	Good Condition (1)	Low (1)	Low Priority (2-3)	Chrysotile (white asbestos)
B00B - R0011 - Movement - 1.62 m2							
No Asbestos							
B00B - R0012 - Stairs - 1.11 m2							
No Asbestos							
B00B - R0013 - Stairs - 7.53 m2							
Ceiling Structures/Linings	Flat AC Sheeting	8m2	Throughout	Good Condition (1)	Low (1)	Low Priority (2-3)	Chrysotile (white asbestos)
B00B - R0014 - Toilet - Lobby - 4.37 m2							
Ceiling Structures/Linings	Flat AC Sheeting	5m2	Throughout	Good Condition (1)	Low (1)	Low Priority (2-3)	Chrysotile (white asbestos)
B00B - R0015 - Staff - Toilet - 1.55 m2							
Ceiling Structures/Linings	Flat AC Sheeting	2m2	Throughout	Good Condition (1)	Low (1)	Low Priority (2-3)	Chrysotile (white asbestos)
B00B - R0016 - Stairs - 1.39 m2							
No Asbestos							
B00B - R0017 - Stairs - 4.16 m2							
No Asbestos							
B00B - R0018 - Stairs - 4.36 m2							
No Asbestos							
B00B - R9001 - Toilets-Boys - 7.88 m2							
Ceiling Structures/Linings	Flat AC Sheeting	8m2	All surfaces	Good Condition (1)	Low (1)	Low Priority (2-3)	Chrysotile (white asbestos)
B00B - R9002 - Performing Arts Changeroom - 48.77 m2							
Ceiling Structures/Linings	Flat AC Sheeting	49m2	All surfaces	Good Condition (1)	Low (1)	Low Priority (2-3)	Chrysotile (white asbestos)
Floor Coverings Res/Textile	Vinyl Tiles	49m2	All surfaces	Good Condition (1)	Low (1)	Low Priority (2-3)	Chrysotile (white asbestos)
B00B - R9003 - Toilets-Girls - 7.89 m2							
No Asbestos							
B00B - R9004 - Movement - 8.15 m2							
Floor Coverings Res/Textile	Vinyl Tiles	9m2	All surfaces	Good Condition (1)	Low (1)	Low Priority (2-3)	Chrysotile (white asbestos)

B00B - R9005 - General Assistants - 153.64 m2							
Wall Linings Internal	Flat AC Sheeting						
B00B - R9006 - Maintenance Bulk Store - 99.36 m2							
No Asbestos							
B00B - R9007 - Garden Store Room - 10.08 m2							
No Asbestos							
B00B - R9008 - Staff - Toilet - 6.25 m2							
No Asbestos							
B00B - R9009 - Movement - 5.76 m2							
No Asbestos							
B00B - R9010 - Movement - 10.29 m2							
Floor Coverings Res/Textile	Vinyl Tiles	11m2	Throughout	Good Condition (1)	Low (1)	Low Priority (2-3)	Chrysotile (white asbestos)
B00B - R9011 - Movement - 15.72 m2							
Floor Coverings Res/Textile	Vinyl Tiles	16m2	All surfaces	Good Condition (1)	Low (1)	Low Priority (2-3)	Chrysotile (white asbestos)
B00B - R9012 - General Storeroom - 12.29 m2							
Floor Coverings Res/Textile	Vinyl Tiles	13m2	All surfaces	Good Condition (1)	Low (1)	Low Priority (2-3)	Chrysotile (white asbestos)
B00B - R9014 - Staff Shower - 6.27 m2							
No Asbestos							
B00B - R9015 - Staff Kitchen - 23.49 m2							
Floor Coverings Res/Textile	Vinyl Tiles	24m2	All surfaces	Good Condition (1)	Low (1)	Low Priority (2-3)	Chrysotile (white asbestos)
B00B - R9016 - Commonroom - 45.25 m2							
No Asbestos							
B00B - R9017 - Cleaning Supplies Store - 24.87 m2							
Floor Coverings Res/Textile	Vinyl Tiles	25m2	All surfaces	Good Condition (1)	Low (1)	Low Priority (2-3)	Chrysotile (white asbestos)
B00B - R9018 - Toilets-Boys - 23.83 m2							
Partition Walls (Cubides)	Compressed AC Sheet	10m2	Middle portion	Good Condition (1)	Low (1)	Low Priority (2-3)	Chrysotile (white asbestos)
B00B - R9019 - Toilets-Girls - 27.17 m2							
No Asbestos							
B00B - R9020 - General Storeroom - 87.25 m2							
Floor Coverings Res/Textile	Vinyl Tiles	6m2	North west plant room	Good Condition (1)	Low (1)	Low Priority (2-3)	Chrysotile (white asbestos)
B00B - R9021 - Performing Arts Store - 13.61 m2							
No Asbestos							
B00B - R9022 - General Storeroom - 20.74 m2							
No Asbestos							
B00B - R9023 - External Movement - 3.89 m2							
No Asbestos							
B00B - R9024 - Stairs - 1.38 m2							
No Asbestos							
B00B - R9025 - Stairs - 6.54 m2							
No Asbestos							
B00B - R9026 - Stairs - 3.73 m2							
No Asbestos							

B00C - Technological & Applied Studies/General Learning - 1974 - Brick/Block

Exterior

External Wall Structure	Compressed AC Sheet	300	West facing	Minimal Damage (2)	Low (1)	Low Priority (2-3)	Chrysotile (white asbestos)
Ceiling Voids	Flat AC Sheeting						
Underfloor Voids	No Asbestos Found						

Interior

B00C - M0006 - Movement - 13.72 m2

No Asbestos

B00C - M0007 - Stairs - 6.22 m2

No Asbestos

B00C - M0008 - General Learning Space - 55.83 m2

No Asbestos

B00C - M1005 - Movement - 13.72 m2

No Asbestos

B00C - M1006 - Stairs - 6.22 m2

No Asbestos

B00C - M1007 - General Learning Space - 55.83 m2

No Asbestos

B00C - M2006 - Movement - 12.19 m2

No Asbestos

B00C - M2007 - Stairs - 3.13 m2

No Asbestos

B00C - M2008 - General Learning Space - 55.74 m2

No Asbestos

B00C - M9007 - Movement - 3.26 m2

No Asbestos

B00C - M9008 - Stairs - 3.18 m2

No Asbestos

B00C - M9009 - Stairs - 3.25 m2

No Asbestos

B00C - M9010 - Movement - 5.84 m2

No Asbestos

B00C - M9011 - General Learning Space - 52.31 m2

No Asbestos

B00C - R0001 - Movement - 8.12 m2

No Asbestos

B00C - R0003 - Materials Store - .36 m2

No Asbestos

B00C - R0004 - Plant - 16.36 m2

Ceiling Structures/Linings	Vermiculite - Composite Sample - (10 - 40 m2) - (X3)
----------------------------	---

Floor Coverings Res/Textile	Vinyl Sheet
-----------------------------	-------------

B00C - R0005 - Wood Technology L.S. - 102.93 m2

Ceiling Structures/Linings	Vermiculite - Composite Sample - (70 - 120 m2) - (X8)
----------------------------	--

B00C - R0006 - Metal Technology L.S. - 102.81 m2

Ceiling Structures/Linings	Vermiculite - Composite Sample - (70 - 120 m2) - (X8)
----------------------------	--

B00C - R0007 - Materials Store - 11.79 m2

Ceiling Structures/Linings	Vermiculite - Composite Sample - (10 - 40 m2) - (X3)
----------------------------	---

Floor Coverings Res/Textile	Vinyl Sheet							
B00C - R0008 - Welding Area - 4.72 m2								
Ceiling Structures/Linings	Vermiculite - Composite Sample - (< 10 m2) - (X2)							
B00C - R0011 - Distribution Board Cupboard - .48 m2 Note: No inspection of live electrical installation								
No Asbestos								
B00C - R0012 - Laboratory L.S. - 92.47 m2								
Plant / Equipment - Fume Cupboard	Flat AC Sheeting	2	South facing	Good Condition (1)	Low (1)	Low Priority (2-3)	Chrysotile (white asbestos)	
Plant / Equipment - Flue	Fibre Cement Pipe	3	South	Good Condition (1)	Low (1)	Low Priority (2-3)	Chrysotile (white asbestos) , Amosite (brown asbestos)	
B00C - R0015 - Laboratory L.S. - 92.75 m2								
Plant / Equipment - Fume Cupboard	Flat AC Sheeting	1	South facing	Good Condition (1)	Low (1)	Low Priority (2-3)	Chrysotile (white asbestos)	
Plant / Equipment - Flue	Fibre Cement Pipe	3	North	Good Condition (1)	Low (1)	Low Priority (2-3)	Chrysotile (white asbestos) , Amosite (brown asbestos)	
B00C - R0016 - Chemical Store - 39.62 m2								
No Asbestos								
B00C - R0019 - Apparatus Store - 26.47 m2								
No Asbestos								
B00C - R0021 - Laboratory L.S. - 92.68 m2								
Plant / Equipment - Fume Cupboard	Flat AC Sheeting	1	South facing	Good Condition (1)	Low (1)	Low Priority (2-3)	Chrysotile (white asbestos)	
Ceiling Structures/Linings	Vermiculite - Composite Sample - (70 - 120 m2) - (X8)							
B00C - R0024 - Laboratory L.S. - 92.59 m2								
Plant / Equipment - Fume Cupboard	Flat AC Sheeting	1	North facing	Good Condition (1)	Low (1)	Low Priority (2-3)	Chrysotile (white asbestos)	
Ceiling Structures/Linings	Vermiculite - Composite Sample - (70 - 120 m2) - (X8)							
B00C - R0026 - Distribution Board Cupboard - .8 m2 Note: No inspection of live electrical installation								
No Asbestos								
B00C - R0027 - Music Learning Space - 67.03 m2								
No Asbestos								
B00C - R0028 - Stairs - 3.68 m2								
No Asbestos								
B00C - R0029 - Cleaning Store - Distributed - .64 m2								
No Asbestos								
B00C - R0030 - Distribution Board Cupboard - 1.11 m2 Note: No inspection of live electrical installation								
No Asbestos								
B00C - R0031 - Stairs - 6.22 m2								
No Asbestos								
B00C - R0032 - Stairs - 18.36 m2								
No Asbestos								
B00C - R0034 - Movement - 281.83 m2								
Require Inspection								
B00C - R0035 - Preparation - 29.94 m2								
Require Inspection								
B00C - R0036 - Chemical Store - 6.94 m2								
Require Inspection								

B00C - R0037 - Movement - 17.9 m2							
Require Inspection							
B00C - R0038 - Preparation - 39.2 m2							
Require Inspection							
B00C - R1003 - Cleaning Store - Distributed - .36 m2							
No Asbestos							
B00C - R1004 - Design L.S. - 53.6 m2							
Ceiling Structures/Linings	Vermiculite - Composite Sample - (40 - 70 m2) - (X5)						
B00C - R1005 - General Storeroom - 6.07 m2							
Ceiling Structures/Linings	Vermiculite - Composite Sample - (< 10 m2) - (X2)						
B00C - R1006 - General Storeroom - 5.09 m2							
Ceiling Structures/Linings	Vermiculite - Composite Sample - (< 10 m2) - (X2)						
B00C - R1007 - Design L.S. - 53.01 m2							
Ceiling Structures/Linings	Vermiculite - Composite Sample - (40 - 70 m2) - (X5)						
B00C - R1008 - General Storeroom - 16.77 m2							
Ceiling Structures/Linings	Vermiculite - Composite Sample - (10 - 40 m2) - (X3)						
Floor Coverings Res/Textile	Vinyl Tiles	1m2	All surfaces	Good Condition (1)	Low (1)	Low Priority (2-3)	Chrysotile (white asbestos)
B00C - R1009 - Materials Store - 18.3 m2							
Ceiling Structures/Linings	Vermiculite - Composite Sample - (10 - 40 m2) - (X3)						
Floor Coverings Res/Textile	Vinyl Sheet						
B00C - R1010 - Wood Technology L.S. - 80.08 m2							
Ceiling Structures/Linings	Vermiculite - Composite Sample - (70 - 120 m2) - (X8)						
B00C - R1011 - Dust Extraction Space - 3.2 m2							
Ceiling Structures/Linings	Vermiculite - Composite Sample - (< 10 m2) - (X2)						
B00C - R1014 - Distribution Board Cupboard - .49 m2							
Note: No inspection of live electrical installation							
No Asbestos							
B00C - R1015 - Laboratory L.S. - 92.67 m2							
Furniture / Fixtures	Flat AC Sheeting	93	West facing	Good Condition (1)	Low (1)	Low Priority (2-3)	Chrysotile (white asbestos)
Ceiling Structures/Linings	Vermiculite - Composite Sample - (70 - 120 m2) - (X8)						
Plant / Equipment - Fume Cupboard	Flat AC Sheeting	1	South facing	Good Condition (1)	Low (1)	Low Priority (2-3)	Chrysotile (white asbestos)
B00C - R1016 - Preparation - 28.51 m2							
Ceiling Structures/Linings	Vermiculite - Composite Sample - (10 - 40 m2) - (X3)						
Plant / Equipment - Flue	Fibre Cement Pipe	8	Upper portion	Good Condition (1)	Low (1)	Low Priority (2-3)	Chrysotile (white asbestos) , Amosite (brown asbestos)
B00C - R1017 - General Storeroom - 9.13 m2							
Ceiling Structures/Linings	Vermiculite - Composite Sample - (10 - 40 m2) - (X3)						
B00C - R1018 - Laboratory L.S. - 91.13 m2							
Ceiling Structures/Linings	Vermiculite - Composite Sample - (70 - 120 m2) - (X8)						

Plant / Equipment - Fume Cupboard	Compressed AC Sheet	1	North	Good Condition (1)	Low (1)	Low Priority (2-3)	Chrysotile (white asbestos)
B00C - R1019 - Apparatus Store - 39.41 m2							
No Asbestos							
B00C - R1022 - Cleaning Store - Distributed - .64 m2							
No Asbestos							
B00C - R1023 - Distribution Board Cupboard - 1.15 m2						Note: No inspection of live electrical installation	
No Asbestos							
B00C - R1026 - General Learning Space - 52.43 m2							
Ceiling Structures/Linings	Vermiculite - Composite Sample - (40 - 70 m2) - (X5)						
B00C - R1027 - General Learning Space - 52.72 m2							
Ceiling Structures/Linings	Vermiculite - Composite Sample - (40 - 70 m2) - (X5)						
B00C - R1028 - General Learning Space - 52.95 m2							
Ceiling Structures/Linings	Vermiculite - Composite Sample - (40 - 70 m2) - (X5)						
B00C - R1029 - Staff Study - 17.21 m2							
Ceiling Structures/Linings	Vermiculite - Composite Sample - (10 - 40 m2) - (X3)						
B00C - R1034 - Distribution Board Cupboard - 1 m2						Note: No inspection of live electrical installation	
No Asbestos							
B00C - R1035 - Music Learning Space - 67.03 m2							
No Asbestos							
B00C - R1036 - Music Learning Space - 72.48 m2							
Ceiling Structures/Linings	Vermiculite - Composite Sample - (70 - 120 m2) - (X8)						
B00C - R1037 - Cleaning Store - Distributed - 1.42 m2							
Ceiling Structures/Linings	Vermiculite - Composite Sample - (< 10 m2) - (X2)						
B00C - R1038 - Stairs - 4.39 m2							
No Asbestos							
B00C - R1039 - Stairs - 6.22 m2							
No Asbestos							
B00C - R1040 - Stairs - 15.15 m2							
No Asbestos							
B00C - R1041 - Movement - 296.2 m2							
No Asbestos							
B00C - R1077 - General Storeroom - 13.98 m2							
No Asbestos							
B00C - R2002 - Cleaning Store - Distributed - .36 m2							
No Asbestos							
B00C - R2003 - Staff - Toilet - 5.32 m2							
Ceiling Structures/Linings	Flat AC Sheeting	6m2	All surfaces	Good Condition (1)	Low (1)	Low Priority (2-3)	Chrysotile (white asbestos)
B00C - R2004 - Staff Study - 19.92 m2							
Ceiling Structures/Linings	Vermiculite - Composite Sample - (10 - 40 m2) - (X3)						
B00C - R2005 - Kiln Space - 19.92 m2							
Ceiling Structures/Linings	Vermiculite - Composite Sample - (10 - 40 m2) - (X3)						
B00C - R2006 - Resources Store - 9.43 m2							
No Asbestos							
B00C - R2007 - Art Learning Space - 52.14 m2							

Ceiling Structures/Linings	Vermiculite - Composite Sample - (40 - 70 m2) - (X5)							
B00C - R2008 - Art Learning Space - 62.68 m2								
Ceiling Structures/Linings	Vermiculite - Composite Sample - (40 - 70 m2) - (X5)							
B00C - R2009 - Resources Store - 6.27 m2								
Ceiling Structures/Linings	Vermiculite - Composite Sample - (< 10 m2) - (X2)							
B00C - R2010 - General Storeroom - 6.27 m2								
Ceiling Structures/Linings	Vermiculite - Composite Sample - (< 10 m2) - (X2)							
B00C - R2011 - General Learning Space - 53.16 m2								
Ceiling Structures/Linings	Vermiculite - Composite Sample - (40 - 70 m2) - (X5)							
B00C - R2012 - Distribution Board Cupboard - .81 m2								
Note: No inspection of live electrical installation								
No Asbestos								
B00C - R2013 - General Learning Space - 51.63 m2								
Ceiling Structures/Linings	Vermiculite - Composite Sample - (40 - 70 m2) - (X5)							
Floor Coverings Res/Textile	Vinyl Tiles (Under Floor Covering/Carpet)							
B00C - R2015 - General Learning Space - 52.8 m2								
Ceiling Structures/Linings	Vermiculite - Composite Sample - (40 - 70 m2) - (X5)							
Floor Coverings Res/Textile	Vinyl Tiles (Under Floor Covering/Carpet)							
B00C - R2016 - Staff Study - 20.3 m2								
Ceiling Structures/Linings	Vermiculite - Composite Sample - (10 - 40 m2) - (X3)							
Floor Coverings Res/Textile	Vinyl Sheet							
B00C - R2017 - Laundry - 10.41 m2								
Ceiling Structures/Linings	Vermiculite - Composite Sample - (10 - 40 m2) - (X3)							
B00C - R2018 - Pantry - 10.41 m2								
Ceiling Structures/Linings	Vermiculite - Composite Sample - (10 - 40 m2) - (X3)							
B00C - R2019 - Food Technology L.S. - 111.09 m2								
Ceiling Structures/Linings	Vermiculite - Composite Sample - (70 - 120 m2) - (X8)							
B00C - R2020 - Distribution Board Cupboard - 1.09 m2								
Note: No inspection of live electrical installation								
Ceiling Structures/Linings	Flat AC Sheeting	2m2	Throughout	Good Condition (1)	Low (1)	Low Priority (2-3)	Chrysotile (white asbestos)	
B00C - R2021 - Cleaning Store - Distributed - 1.65 m2								
No Asbestos								
B00C - R2022 - Staff Study - 5.16 m2								
Ceiling Structures/Linings	Vermiculite - Composite Sample - (< 10 m2) - (X2)							
Floor Coverings Res/Textile	Vinyl Sheet							
B00C - R2023 - Stairs - 4.39 m2								
No Asbestos								
B00C - R2024 - Stairs - 6.22 m2								
No Asbestos								
B00C - R2025 - Movement - 195.53 m2								
No Asbestos								

B00C - R9002 - Cleaning Store - Distributed - 3.08 m2							
No Asbestos							
B00C - R9003 - Cleaning Store - Distributed - 6.64 m2							
Ceiling Structures/Linings	Non Accessible Area	m2					
B00C - R9004 - Shower/Change - 52.22 m2							
Ceiling Structures/Linings	Vermiculite - Composite Sample - (40 - 70 m2) - (X5)						
B00C - R9006 - Movement - 3.54 m2							
No Asbestos							
B00C - R9007 - Cleaning Supplies Store - 16.55 m2							
Floor Coverings Res/Textile	Vinyl Tiles	17m2	All surfaces	Good Condition (1)	Low (1)	Low Priority (2-3)	Chrysotile (white asbestos)
B00C - R9008 - General Storeroom - 4.28 m2							
Floor Coverings Res/Textile	Vinyl Tiles	5m2	All surfaces	Good Condition (1)	Low (1)	Low Priority (2-3)	Chrysotile (white asbestos)
B00C - R9011 - Toilets-Boys - 54.19 m2							
Partition Walls (Cubicles)	Compressed AC Sheet	12m2	Middle portion	Good Condition (1)	Low (1)	Low Priority (2-3)	Chrysotile (white asbestos)
Ceiling Structures/Linings	Flat AC Sheeting						
B00C - R9014 - Main Switchroom - 16.91 m2							
No Asbestos							
B00C - R9015 - General Storeroom - 16.91 m2							
Ceiling Structures/Linings	Vermiculite - Composite Sample - (10 - 40 m2) - (X3)						
B00C - R9016 - Movement - 21.56 m2							
Ceiling Structures/Linings	Vermiculite - Composite Sample - (10 - 40 m2) - (X3)						
B00C - R9017 - Cleaning Store - Distributed - 6.24 m2							
No Asbestos							
B00C - R9018 - Movement - 21.69 m2							
Ceiling Structures/Linings	Vermiculite - Composite Sample - (10 - 40 m2) - (X3)						
B00C - R9019 - Cleaning Store - Distributed - .59 m2							
No Asbestos							
B00C - R9020 - Maintenance Bulk Store - 11.19 m2							
No Asbestos							
B00C - R9021 - Toilets-Girls - 61.94 m2							
Ceiling Structures/Linings	Vermiculite - Composite Sample - (40 - 70 m2) - (X5)						
Partition Walls (Cubicles)	Compressed AC Sheet	32m2	Variable positions	Good Condition (1)	Low (1)	Low Priority (2-3)	Chrysotile (white asbestos)
B00C - R9022 - Toilets-Girls - 2.2 m2							
Ceiling Structures/Linings	Vermiculite - Composite Sample - (< 10 m2) - (X2)						
B00C - R9023 - Toilets-Girls - 2.23 m2							
Ceiling Structures/Linings	Vermiculite - Composite Sample - (< 10 m2) - (X2)						
B00C - R9024 - General Learning Space - 52.07 m2							
Ceiling Structures/Linings	Vermiculite - Composite Sample - (40 - 70 m2) - (X5)						
B00C - R9025 - General Storeroom - 9.87 m2							
No Asbestos							

B00C - R9026 - G.L.S. Store - 8.47 m2							
Ceiling Structures/Linings	Vermiculite - Composite Sample - (< 10 m2) - (X2)						
B00C - R9027 - G.L.S. Store - 7.88 m2							
Ceiling Structures/Linings	Vermiculite - Composite Sample - (< 10 m2) - (X2)						
B00C - R9028 - Movement - 10.64 m2							
No Asbestos							
B00C - R9029 - Stairs - 3.18 m2							
No Asbestos							
B00C - R9030 - Dark Room - 10.06 m2							
Ceiling Structures/Linings	Vermiculite - Composite Sample - (10 - 40 m2) - (X3)						
B00C - R9031 - General Storeroom - 2.06 m2							
No Asbestos							
B00C - R9032 - Dark Room - 2.17 m2							
Ceiling Structures/Linings	Vermiculite - Composite Sample - (< 10 m2) - (X2)						
B00C - R9033 - Garage/Carport - 19.82 m2							
Ceiling Structures/Linings	Vermiculite - Composite Sample - (10 - 40 m2) - (X3)						
B00C - R9034 - Stairs - 4.22 m2							
No Asbestos							
B00D - Physical Education/Library - 1974 - Brick/Block							
Exterior							
Ceiling Voids	No Asbestos Found						
Underfloor Voids	No Asbestos Found						
Interior							
B00D - R0001 - Pupil Entry - 106.5 m2							
No Asbestos							
B00D - R0002 - Student Canteen - 61.01 m2							
Floor Coverings Res/Textile	Vinyl Tiles	61m2	All surfaces	Good Condition (1)	Low (1)	Low Priority (2-3)	Chrysotile (white asbestos)
B00D - R0003 - Distribution Board Cupboard - 1.15 m2						Note: No inspection of live electrical installation	
No Asbestos							
B00D - R0004 - Plant Space - 16 m2							
Plant / Equipment - Flue	Fibre Cement Pipe	16	North facing	Good Condition (1)	Low (1)	Low Priority (2-3)	Chrysotile (white asbestos)
B00D - R0006 - Plant - 16 m2							
Plant / Equipment - Flue	Fibre Cement Pipe	16	North facing	Good Condition (1)	Low (1)	Low Priority (2-3)	Chrysotile (white asbestos)
Electrical - Backing Board	Resinous Board	1	South	Good Condition (1)	Low (1)	Low Priority (2-3)	Assumed Asbestos
B00D - R0007 - Movement - 3.64 m2							
No Asbestos							
B00D - R0009 - Movement - 7.97 m2							
Electrical - Backing Board	Resinous Board	1	North	Good Condition (1)	Low (1)	Low Priority (2-3)	Assumed Asbestos
B00D - R0010 - External Movement - 58.92 m2							
No Asbestos							

B00D - R0011 - External Movement - 87.61 m2							
No Asbestos							
B00D - R0012 - External Stairs - 10.45 m2							
Furniture / Fixtures	Fibre Cement Pipe	2	Upper portion	Good Condition (1)	Low (1)	Low Priority (2-3)	Chrysotile (white asbestos), Amosite (brown asbestos)
B00D - R0013 - Stairs - 4.1 m2							
No Asbestos							
B00D - R0014 - Stairs - 7.15 m2							
No Asbestos							
B00D - R0015 - Tiered Learning Area - 16.45 m2							
No Asbestos							
B00D - R0016 - Outdoor Learning Area - 109.91 m2							
Furniture / Fixtures	Fibre Cement Pipe	3	Variable positions	Good Condition (1)	Low (1)	Low Priority (2-3)	Chrysotile (white asbestos), Amosite (brown asbestos)
B00D - R0017 - Covered Area - 1.97 m2							
No Asbestos							
B00D - R1001 - Movement - 44.91 m2							
No Asbestos							
B00D - R1002 - Movement - 21.49 m2							
No Asbestos							
B00D - R1003 - Ancillary Staff - 21.5 m2							
No Asbestos							
B00D - R1007 - Distribution Board Cupboard - .25 m2						Note: No inspection of live electrical installation	
No Asbestos							
B00D - R1008 - Toilets-Boys - 3.58 m2							
No Asbestos							
B00D - R1009 - Toilets-Girls - 3.93 m2							
No Asbestos							
B00D - R1010 - General Storeroom - 4.48 m2							
Plant / Equipment - Flue	Fibre Cement Pipe	6	Upper portion	Good Condition (1)	Low (1)	Low Priority (2-3)	Chrysotile (white asbestos)
B00D - R1018 - Movement - 38.02 m2							
No Asbestos							
B00D - R1019 - Stairs - 10.23 m2							
No Asbestos							
B00D - R1020 - Main Area - 517.04 m2							
Require Inspection							
B00D - R1021 - Staff Kitchen - 6.92 m2							
Require Inspection							
B00D - R1022 - Commonroom - 38.15 m2							
Require Inspection							
B00D - R1023 - Librarian - 6.1 m2							
Require Inspection							
B00D - R1024 - Computer Learning Space - 33.24 m2							
Require Inspection							
B00D - R1025 - Interview/Meeting - 6.48 m2							
Require Inspection							
B00D - R1026 - Seminar - Type 3 - 24.02 m2							
Require Inspection							
B00D - R1027 - Seminar - Type 3 - 23.89 m2							
Require Inspection							

B00D - R1028 - Seminar - Type 3 - 24.15 m2							
Require Inspection							
B00D - R1029 - Seminar - Type 3 - 24.77 m2							
Require Inspection							
B00D - R1030 - Communication Space - 24.77 m2							
Require Inspection							
B00D - R1031 - Study Space - 96.35 m2							
Require Inspection							
B00D - R1032 - Interview/Meeting - 11.46 m2							
Require Inspection							
B00D - R1033 - Library Administration - 14.37 m2							
Require Inspection							
B00D - R1034 - Movement - 5.4 m2							
Require Inspection							
B00D - R9001 - Shower/Change - 36.13 m2							
Partition Walls (Cubicles)	Compressed AC Sheet	24m2	Middle portion	Good Condition (1)	Low (1)	Low Priority (2-3)	Chrysotile (white asbestos)
B00D - R9002 - Toilets-Girls - 13.75 m2							
Partition Walls (Cubicles)	Compressed AC Sheet	6m2	Middle portion	Good Condition (1)	Low (1)	Low Priority (2-3)	Chrysotile (white asbestos)
B00D - R9003 - Movement - 2.61 m2							
No Asbestos							
B00D - R9004 - Sport Equipment Store - 118.08 m2							
No Asbestos							
B00D - R9005 - Sport Equipment Store - 22.03 m2							
No Asbestos							
B00D - R9006 - Sport Equipment Store - 2.9 m2							
No Asbestos							
B00D - R9007 - Toilets-Boys - 15.7 m2							
Partition Walls (Cubicles)	Compressed AC Sheet	6m2	Middle portion	Good Condition (1)	Low (1)	Low Priority (2-3)	Chrysotile (white asbestos)
B00D - R9008 - Movement - 2.46 m2							
No Asbestos							
B00D - R9009 - Shower/Change - 51.93 m2							
No Asbestos							
B00D - R9010 - Distribution Board Cupboard - 1.19 m2						Note: No inspection of live electrical installation	
No Asbestos							
B00D - R9011 - Movement - 13.56 m2							
Floor Coverings Res/Textile	Vinyl Tiles	14m2	All surfaces	Good Condition (1)	Low (1)	Low Priority (2-3)	Chrysotile (white asbestos)
B00D - R9012 - Staff Shower - 5 m2							
No Asbestos							
B00D - R9013 - Staff Study - 13.22 m2							
Floor Coverings Res/Textile	Vinyl Tiles	14m2	Throughout	Minimal Damage (2)	Low (1)	Low Priority (2-3)	Chrysotile (white asbestos)
B00D - R9014 - Cleaning Supplies Store - 15.85 m2							
Floor Coverings Res/Textile	Vinyl Tiles	16m2	Throughout	Good Condition (1)	Low (1)	Low Priority (2-3)	Chrysotile (white asbestos)
Plant / Equipment - Flue	Fibre Cement Pipe	20	Variable positions	Good Condition (1)	Low (1)	Low Priority (2-3)	Chrysotile (white asbestos)

B00D - R9015 - Gymnasium - 468.53 m2							
Furniture / Fixtures	Fibre Cement Pipe	12	Upper portion	Good Condition (1)	Low (1)	Low Priority (2-3)	Chrysotile (white asbestos) , Amosite (brown asbestos)
B00D - R9016 - Sport Equipment Store - 15.17 m2							
No Asbestos							
B00D - R9017 - Movement - 6.5 m2							
Floor Coverings Res/Textile	Vinyl Tiles	7m2	All surfaces	Good Condition (1)	Low (1)	Low Priority (2-3)	Chrysotile (white asbestos)
B00D - R9018 - Staff Study - 10.79 m2							
Floor Coverings Res/Textile	Vinyl Tiles	11m2	All surfaces	Good Condition (1)	Low (1)	Low Priority (2-3)	Chrysotile (white asbestos)
B00D - R9019 - Stairs - 5.09 m2							
No Asbestos							
B00D - R9020 - Stairs - 6.17 m2							
No Asbestos							
B00D - R9021 - Tiered Learning Area - 37.17 m2							
Plant / Equipment - Boiler	Fibre Cement Pipe	22	Variable positions	Good Condition (1)	Low (1)	Low Priority (2-3)	Chrysotile (white asbestos)
B00E - Music - 1925 - Timber							
Exterior							
Underfloor Voids	No Asbestos Found						
Interior							
B00E - R0001 - Music Learning Space - 67.11 m2							
No Asbestos							
B00E - R0002 - Music Store - 6.19 m2							
No Asbestos							
B00E - R0003 - Movement - 12.02 m2							
No Asbestos							
B00F - Administration - 2003 - Brick/Veneer							
Exterior							
Ceiling Voids	No Asbestos Found						
Underfloor Voids	No Asbestos Found						
Interior							
B00F - R0001 - Public Entry - 41.7 m2							
Floor Coverings Res/Textile	No Asbestos Found						
B00F - R0002 - Interview/Office - Type 1 - 13 m2							
Floor Coverings Res/Textile	No Asbestos Found						
B00F - R0003 - Principal Office - 12.75 m2							
Floor Coverings Res/Textile	No Asbestos Found						
B00F - R0004 - Principal Office - 19.94 m2							
Floor Coverings Res/Textile	No Asbestos Found						
B00F - R0005 - Staff - Toilet - 5.44 m2							
No Asbestos							
B00F - R0006 - Deputy Principal Office - 12.48 m2							

Floor Coverings Res/Textile	No Asbestos Found	
B00F - R0007 - Administration - Clerical - 15.82 m2		
Floor Coverings Res/Textile	No Asbestos Found	
B00F - R0008 - Staff Kitchen - 13.76 m2		
No Asbestos		
B00F - R0009 - Security Store - 11.79 m2		
No Asbestos		
B00F - R0010 - Staff - Toilet - 5.99 m2		
No Asbestos		
B00F - R0011 - Disabled Toilet - 4.43 m2		
No Asbestos		
B00F - R0012 - Duplicating Workroom - 16.43 m2		
Floor Coverings Res/Textile	No Asbestos Found	
B00F - R0013 - Administration - Clerical - 47.57 m2		
Floor Coverings Res/Textile	No Asbestos Found	
B00F - R0014 - Clinic-Waiting - 12.38 m2		
Floor Coverings Res/Textile	No Asbestos Found	
B00F - R0015 - Clinic - Boys - 12.38 m2		
No Asbestos		
B00F - R0016 - Toilets - Boys - 3.04 m2		
No Asbestos		
B00F - R0017 - Toilets - Girls - 3.04 m2		
No Asbestos		
B00F - R0018 - Clinic - Girls - 11.43 m2		
No Asbestos		
B00F - R0019 - Pupil Entry - 24.56 m2		
Floor Coverings Res/Textile	No Asbestos Found	
B00F - R0020 - Leading Teacher - 12.79 m2		
Floor Coverings Res/Textile	No Asbestos Found	
B00F - R0021 - Leading Teacher - 12.83 m2		
Floor Coverings Res/Textile	No Asbestos Found	
B00F - R0022 - Movement - 17.77 m2		
Floor Coverings Res/Textile	No Asbestos Found	
B00F - R0023 - Movement - 24.92 m2		
Floor Coverings Res/Textile	No Asbestos Found	
B00F - R0024 - Movement - 37.94 m2		
Floor Coverings Res/Textile	No Asbestos Found	
B00F - R0025 - Cleaning Store - Distributed - 1.46 m2		
No Asbestos		
B00F - R0026 - Movement - 5.92 m2		
Floor Coverings Res/Textile	No Asbestos Found	
B00F - R0027 - Stairs - 20.75 m2		
No Asbestos		
B00F - R0028 - Distribution Board Cupboard - 1.57 m2		
		Note: No inspection of live electrical installation

No Asbestos		
B00F - R0029 - Plant - .64 m2		
No Asbestos		
B00F - R0030 - Lift - 2.24 m2		
No Asbestos		
B00F - R0031 - Movement - 179.85 m2		
No Asbestos		
B00F - R0032 - Movement - 15.03 m2		
No Asbestos		
B00F - R1001 - Interview/Office - Type 1 - 21.03 m2		
Floor Coverings Res/Textile	No Asbestos Found	
B00F - R1002 - Security Store - 19.91 m2		
No Asbestos		
B00F - R1003 - Staff Study - 173.69 m2		
Floor Coverings Res/Textile	No Asbestos Found	
B00F - R1004 - General Learning Space - 60.51 m2		
Floor Coverings Res/Textile	No Asbestos Found	
B00F - R1005 - General Learning Space - 58.98 m2		
Floor Coverings Res/Textile	No Asbestos Found	
B00F - R1006 - General Learning Space - 60.02 m2		
Floor Coverings Res/Textile	No Asbestos Found	
B00F - R1007 - General Learning Space - 59.79 m2		
Floor Coverings Res/Textile	No Asbestos Found	
B00F - R1008 - Staff - Toilet - 4.73 m2		
No Asbestos		
B00F - R1009 - Staff - Toilet - 4.75 m2		
No Asbestos		
B00F - R1010 - Pupil Entry - 15.54 m2		
Floor Coverings Res/Textile	No Asbestos Found	
B00F - R1011 - Movement - 8.64 m2		
Floor Coverings Res/Textile	No Asbestos Found	
B00F - R1012 - Movement - 97.95 m2		
Floor Coverings Res/Textile	No Asbestos Found	
B00F - R1013 - Stairs - 22.37 m2		
Floor Coverings Res/Textile	No Asbestos Found	
B00F - R1014 - Communications Cupboard - 2 m2		
No Asbestos		
B00F - R1015 - Distribution Board Cupboard - 1.64 m2		
		Note: No inspection of live electrical installation
No Asbestos		
B00F - R1016 - Lift - 2.24 m2		
No Asbestos		
B00F - R1017 - Plant - .73 m2		
No Asbestos		
B00F - R1018 - Movement - 15.33 m2		
No Asbestos		

B00F - R2001 - Lift - 2.24 m2		
No Asbestos		
B00F - R2002 - Movement - 6.49 m2		
No Asbestos		
B00F - R9001 - Plant - 189.48 m2		
No Asbestos		
B00F - R9002 - Main Switchroom - 5.4 m2		
No Asbestos		
B00F - R9003 - Stairs - 8.72 m2		
No Asbestos		
B00F - R9004 - Movement - 4.21 m2		
No Asbestos		
B00G - General Learning - 2003 - Brick/Veneer		
Exterior		
Ceiling Voids	No Asbestos Found	
Underfloor Voids	No Asbestos Found	
Interior		
B00G - R0001 - Stairs - 10.92 m2		
No Asbestos		
B00G - R0002 - Movement - 67.22 m2		
No Asbestos		
B00G - R0003 - Plant - 56.03 m2		
No Asbestos		
B00G - R0004 - Movement - 14.33 m2		
No Asbestos		
B00G - R1001 - Music Learning Space - 99.52 m2		
No Asbestos		
B00G - R1002 - Security Store - 23.99 m2		
No Asbestos		
B00G - R1003 - Security Store - 24.84 m2		
Floor Coverings Res/Textile	No Asbestos Found	
B00G - R1004 - Performance Workspace - 99.88 m2		
Floor Coverings Res/Textile	No Asbestos Found	
B00G - R1005 - Stairs - 17.38 m2		
No Asbestos		
B00G - R1006 - Movement - 111.91 m2		
No Asbestos		
B00G - R1007 - Movement - 13.01 m2		
No Asbestos		
B00G - R1008 - Distribution Board Cupboard - 1.91 m2		Note: No inspection of live electrical installation
No Asbestos		
B00G - R1009 - Stairs - 1.72 m2		
No Asbestos		
B00G - R2001 - Movement - 10.57 m2		
Floor Coverings Res/Textile	No Asbestos Found	
B00G - R2002 - Interview/Office - Type 1 - 19.41 m2		
Floor Coverings Res/Textile	No Asbestos Found	
B00G - R2003 - Security Store - 19.29 m2		

No Asbestos		
B00G- R2004 - Staff Kitchen - 6.22 m2		
No Asbestos		
B00G- R2005 - Staff Study - 175.88 m2		
Floor Coverings Res/Textile	No Asbestos Found	
B00G- R2006 - Staff - Toilet - 4.6 m2		
No Asbestos		
B00G- R2007 - Staff - Toilet - 4.57 m2		
No Asbestos		
B00G- R2008 - Stairs - 17.38 m2		
No Asbestos		
B00G- R2009 - Movement - 80.81 m2		
No Asbestos		
B00G- R2010 - Stairs - 16.23 m2		
No Asbestos		
B00G- R2011 - Communications Cupboard - 1.13 m2		
No Asbestos		
B00G- R2012 - Distribution Board Cupboard - 1.13 m2		Note: No inspection of live electrical installation
No Asbestos		

Demountables

There are no Demountable(s) Located at this school as per the AMS records as of 09-Sep-2020