

Asbestos Register

(Hazardous Materials and Risk Assessment)

School:	Five Islands Secondary College (8373)
Region:	Southern NSW AMU
State Electorate:	Wollongong
Local Government Area:	Wollongong

Last Reviewed By:	WSP 15-FEB-2017
Last Revised By:	

Historical Fibro In Grounds Investigations/Events	No
<p>No previous investigations have been recorded against the school. However, asbestos containing materials maybe present in grounds from time to time and caution must be exercised prior to any grounds disturbance.</p>	

8373 - Five Islands Secondary College
Site Plan (11665)

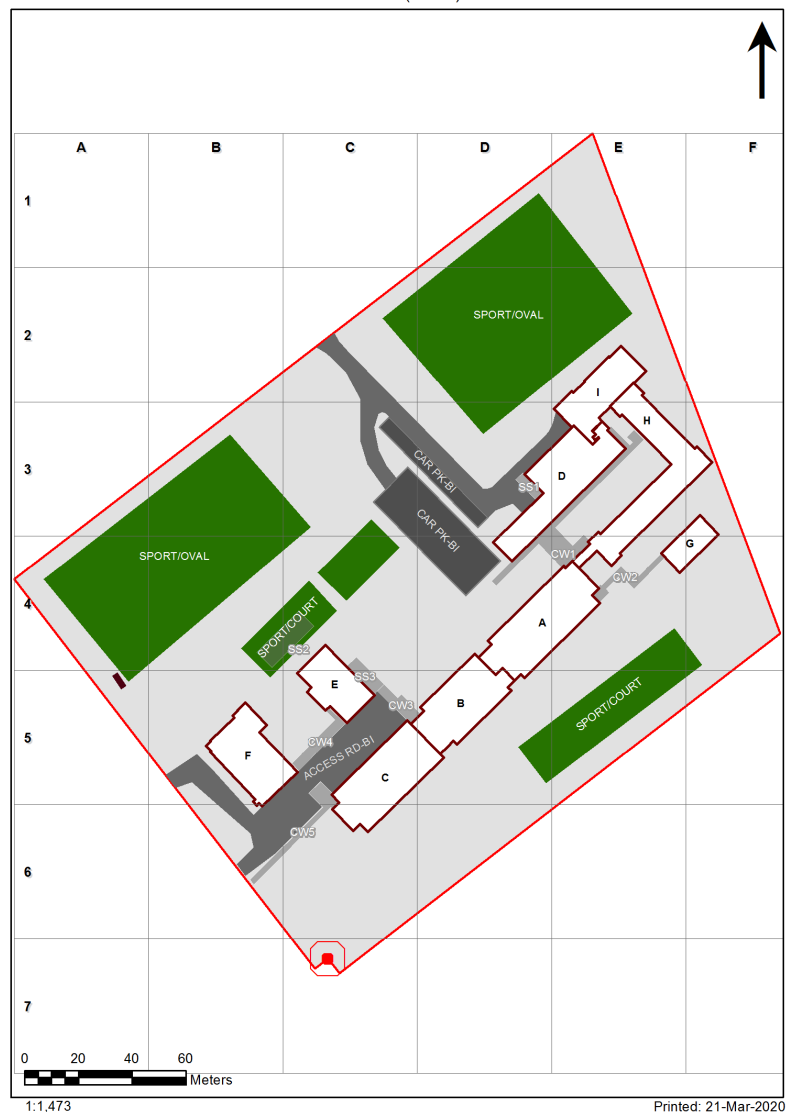

1:1.473

Printed: 21-Mar-2020

Preface to Asbestos Register

Limitations

Asbestos Registers established (first surveyed 2007/08) and maintained for the Department of Education (DoE) are limited in extent, in that:

1. All inspections and surveys of materials and finishes in DoE facilities are non-disturbance, with
2. Samples undertaken by hygienist to determine whether a sample is an Asbestos Containing Material (ACM),
3. The hygienist may apply a single sample to like materials within a space and adjoining spaces, but not normally between buildings,
4. Successive inspections have reduced any inconclusive records such as 'assumed asbestos' in difficult to access areas, by undertaking additional sampling with lifting devices.
5. In compliance with WHS Act 2011 and WHS Regulations 2017, additional inspections have been undertaken in ceiling spaces and sub-floor areas where access is possible.
 - o Where the ground floor is slab on ground, no inspection is made beneath the slab.
 - o Where fibro fragments (ACM taken for sampling) are located in ceiling spaces or sub floor voids air monitoring is normally undertaken at time of sampling, and clearance undertaken as soon as practicable.
6. No attempt has been made to identify any ACM that is hidden from view or encapsulated within
 - o Any wall cavity
 - o Sub floor area, particularly formwork for slabs in/on ground,
 - o Services (that may use ACM) such as: pipe lagging, asbestos cement pipes, flues.
7. All known ACM in Grounds (Fibro in Grounds) is made available in associated site specific asbestos management plans in DoE electronic files.
Notwithstanding information provided, ACM may be present in grounds from time to time and caution must be exercised prior to any grounds disturbance.

Use of the Asbestos Register

Prior to any disturbance works being undertaken in a building to which this asbestos register applies it will be necessary to confirm the extent of any ACM by a disturbance investigation:

- If the building was built prior to 2003
- If any ACM has been identified in the Asbestos Register for the building.

Update of Asbestos Registers

Asbestos Register Data is updated regularly by the DoE Hygienist Panel via the Online Asbestos Register Tool (Managed by Business Systems, School Infrastructure NSW). Internal users can view the latest edition of the Asbestos Register in the AMS.

Please note: The Department's external website may not contain the latest revision of the Asbestos Register.

Notes 1: Vermiculite

- During 2018/19, all vermiculite occurrences in DoE schools identified in 2007/08, were 'composite tested' in accordance with a safe work NSW agreed procedure. This required multiple testing of all vermiculite occurrences.
- During the period 2007/08 to 2018/19, some vermiculite has been over sheeted and a warning is indicated for schools where this has happened.

Note 2: DoE website link for information is here:

<https://www.schoolinfrastructure.nsw.gov.au/about-us/working-with-us/schools-asbestos-register.html>

<https://education.nsw.gov.au/about-us/strategies-and-reports/our-reports-and-reviews/schools-asbestos-register>

Note 3: Material Condition Assessment

The material condition assessment descriptors from Section 3 of the Asbestos Management Plan (AMP) is extracted below. Please read the AMP in its entirety for further information.

3.3.2.1 Material condition assessment

The OART records the material condition of identified ACM in the following format:

Rating	Description
Good condition (1)	For non-friable asbestos that is sealed and has no visible damage. This primarily related to asbestos cement (AC) sheet and vinyl tiles
Minimal damage (2)	For non-friable asbestos that has a very small amount of damage, eg hairline cracks.
Some damage / unsealed (3)	For non-friable asbestos with significant breakage or several small areas where material has been damaged, revealing loose asbestos fibres. Non-friable asbestos that is unsealed.
Poor condition (4)	For non-friable asbestos that has extensive damage. Visible asbestos debris
Friable asbestos (5)	Any occurrence of friable asbestos

Product	Material Description	Extent	Location	Material Condition	Risk Status	Remediation Priority	Result
B00A - General Learning/Various - 1960 - Concrete							
Exterior							
Underfloor Voids	No Asbestos Found						
Ceiling Voids	Compressed AC Sheet	1	Man hole cover - Library	Some Damage - Unsealed (3)	Medium (2)	Medium Priority (4-5)	Chrysotile (white asbestos) , Amosite (brown asbestos)
Interior							
B00A - R0002 - Apparatus Store - 2.84 m2							
No Asbestos							
B00A - R0011 - Main Switchroom - 3.84 m2							
Ceiling Structures/Linings	Flat AC Sheeting	4m2	Throughout	Good Condition (1)	Low (1)	Low Priority (2-3)	Chrysotile (white asbestos) , Amosite (brown asbestos)
B00A - R0012 - Movement - 3.26 m2							
Ceiling Structures/Linings	Flat AC Sheeting	4m2	Throughout	Good Condition (1)	Low (1)	Low Priority (2-3)	Chrysotile (white asbestos) , Amosite (brown asbestos)
B00A - R0013 - Distribution Board Cupboard - 3.07 m2							
						Note: No inspection of live electrical installation	
Ceiling Structures/Linings	Flat AC Sheeting	4m2	Throughout	Some Damage - Unsealed (3)	Low (1)	Low Priority (2-3)	Chrysotile (white asbestos) , Amosite (brown asbestos)
B00A - R0014 - Cleaning Supplies Store - 10.12 m2							
No Asbestos							
B00A - R0022 - Stairs - 9.52 m2							
No Asbestos							
B00A - R0023 - Stairs - 7.92 m2							
No Asbestos							
B00A - R0024 - Stairs - 9.56 m2							
No Asbestos							
B00A - R0025 - Movement - 54.92 m2							
No Asbestos							
B00A - R0026 - Laundry - 4.02 m2							
No Asbestos							
B00A - R0027 - Movement - 1.87 m2							
No Asbestos							
B00A - R0028 - Preparation - Materials - 18.53 m2							
No Asbestos							
B00A - R0029 - Kitchen - Type 1 - 103.87 m2							
No Asbestos							
B00A - R0030 - Other - 24.66 m2							
No Asbestos							
B00A - R0031 - Kitchen - Type 1 - 65.36 m2							
No Asbestos							
B00A - R0032 - Staff Study - 46.99 m2							
No Asbestos							
B00A - R0033 - Movement - 67.65 m2							
No Asbestos							
B00A - R0034 - Multi Media Store - 7.36 m2							
No Asbestos							
B00A - R0035 - Practical Activities - 76.17 m2							
No Asbestos							
B00A - R0036 - General Learning Space - 151.02 m2							
No Asbestos							
B00A - R0037 - General Learning Space - 34.63 m2							
No Asbestos							

B00A - R0038 - G.L.S. Store - 4.05 m2							
No Asbestos							
B00A - R0039 - General Learning Space - 46.66 m2							
No Asbestos							
B00A - R0040 - G.L.S. Store - 14.53 m2							
No Asbestos							
B00A - R1001 - Movement - 33.43 m2							
Ceiling Structures/Linings	Vermiculite - Composite Sample - (10 - 40 m2) - (X3)						
B00A - R1002 - Staff - Toilet - 3.97 m2							
No Asbestos							
B00A - R1003 - Staff - Toilet - 3.49 m2							
No Asbestos							
B00A - R1004 - Seminar - 13.27 m2							
Ceiling Structures/Linings	Vermiculite - Composite Sample - (10 - 40 m2) - (X3)						
B00A - R1005 - Seminar - 13.27 m2							
Ceiling Structures/Linings	Vermiculite - Composite Sample - (10 - 40 m2) - (X3)						
B00A - R1006 - General Storeroom - 13.14 m2							
Floor Coverings Res/Textile	Vinyl Tiles	14m2	Throughout	Good Condition (1)	Low (1)	Low Priority (2-3)	Chrysotile (white asbestos)
B00A - R1007 - Seminar - 12.89 m2							
Ceiling Structures/Linings	Vermiculite - Composite Sample - (10 - 40 m2) - (X3)						
B00A - R1008 - Seminar - 12.78 m2							
Ceiling Structures/Linings	Vermiculite - Composite Sample - (10 - 40 m2) - (X3)						
B00A - R1009 - Main Area - 407.27 m2							
Ceiling Structures/Linings	Vermiculite - Composite Sample - (> 250 m2) - (X25)						
B00A - R1010 - Librarian - 12.6 m2							
Ceiling Structures/Linings	Vermiculite - Composite Sample - (10 - 40 m2) - (X3)						
B00A - R1011 - Workroom - 24.6 m2							
No Asbestos							
B00A - R1012 - General Storeroom - 24.73 m2							
No Asbestos							
B00A - R1013 - Duplicating Workroom - 51.25 m2							
No Asbestos							
B00A - R1014 - Seminar - 52.78 m2							
No Asbestos							
B00A - R1015 - Movement - 25.49 m2							
Floor Coverings Res/Textile	Vinyl Tiles						
B00A - R1016 - Distribution Board Cupboard - .79 m2							
Note: No inspection of live electrical installation							
Ceiling Structures/Linings	Flat AC Sheeting	1m2	Throughout	Some Damage - Unsealed (3)	Low (1)	Low Priority (2-3)	Chrysotile (white asbestos) , Amosite (brown asbestos)
B00A - R1017 - Movement - 47.99 m2							
No Asbestos							
B00A - R1018 - Cleaning Store - Distributed - 4.38 m2							
Floor Coverings Res/Textile	Vinyl Tiles	5m2	Throughout	Good Condition (1)	Low (1)	Low Priority (2-3)	Chrysotile (white asbestos)
B00A - R1019 - Staff Study - 19.97 m2							
No Asbestos							

B00A - R1020 - Stairs - 8.06 m2							
No Asbestos							
B00A - R1021 - Stairs - 12.76 m2							
No Asbestos							
B00A - R1022 - Stairs - 13.56 m2							
No Asbestos							
B00B - General Learning/Science Learning - 1960 - Concrete							
Exterior							
Ceiling Voids - Raked Ceiling	No Asbestos Found						
Underfloor Voids	No Asbestos Found						
Interior							
B00B - R0001 - Commonroom - 75.37 m2							
No Asbestos							
B00B - R0002 - Movement - 15.76 m2							
Floor Coverings Res/Textile	Vinyl Tiles						
B00B - R0003 - Laboratory L.S. - 87.43 m2							
Plant / Equipment - Fume Cupboard	Flat AC Sheeting	1	South	Good Condition (1)	Low (1)	Low Priority (2-3)	Chrysotile (white asbestos) , Amosite (brown asbestos)
Furniture / Fixtures	Compressed AC Sheet	3	2nd bench from south corner	Good Condition (1)	Low (1)	Low Priority (2-3)	Chrysotile (white asbestos) , Amosite (brown asbestos)
B00B - R0004 - Staff Study - 28.36 m2							
Plant / Equipment - Fume Cupboard	Flat AC Sheeting	1	East	Good Condition (1)	Low (1)	Low Priority (2-3)	Chrysotile (white asbestos) , Amosite (brown asbestos)
B00B - R0005 - Staff Study - 18.62 m2							
No Asbestos							
B00B - R0006 - Distribution Board Cupboard - .67 m2							
Note: No inspection of live electrical installation							
Ceiling Structures/Linings	Flat AC Sheeting	1m2	Throughout	Good Condition (1)	Low (1)	Low Priority (2-3)	Chrysotile (white asbestos) , Amosite (brown asbestos)
B00B - R0007 - General Storeroom - 3.08 m2							
Floor Coverings Res/Textile	Vinyl Tiles						
B00B - R0008 - Movement - 108.6 m2							
Floor Coverings Res/Textile	Vinyl Tiles						
B00B - R0009 - Staff - Toilet - 10.34 m2							
No Asbestos							
B00B - R0010 - Staff Study - 13.48 m2							
No Asbestos							
B00B - R0011 - Cleaning Supplies Store - 9.89 m2							
Ceiling Structures/Linings	Flat AC Sheeting	10m2	Throughout	Good Condition (1)	Low (1)	Low Priority (2-3)	Chrysotile (white asbestos) , Amosite (brown asbestos)
B00B - R0012 - Staff - Toilet - 5.54 m2							
No Asbestos							
B00B - R0013 - Cleaning Store - Distributed - 6.25 m2							
No Asbestos							
B00B - R0014 - Tiered Learning Area - 52.15 m2							
Plant / Equipment - Fume Cupboard	Flat AC Sheeting	1	North corner	Good Condition (1)	Low (1)	Low Priority (2-3)	Chrysotile (white asbestos) , Amosite (brown asbestos)
B00B - R0015 - Preparation - 22.95 m2							
Plant / Equipment - Fume Cupboard	Flat AC Sheeting	2	North, South	Good Condition (1)	Low (1)	Low Priority (2-3)	Chrysotile (white asbestos) , Amosite (brown asbestos)
B00B - R0016 - Apparatus Store - 13.99 m2							

No Asbestos							
B00B - R0017 - Laboratory L.S. - 90.82 m2							
Plant / Equipment - Fume Cupboard	Flat AC Sheeting	1	East	Good Condition (1)	Low (1)	Low Priority (2-3)	Chrysotile (white asbestos) , Amosite (brown asbestos)
Furniture / Fixtures	Compressed AC Sheet	3	East	Good Condition (1)	Low (1)	Low Priority (2-3)	Chrysotile (white asbestos) , Amosite (brown asbestos)
B00B - R0018 - Stairs - 7.85 m2							
No Asbestos							
B00B - R0019 - Stairs - 10.01 m2							
No Asbestos							
B00B - R1002 - General Learning Space - 52.27 m2							
No Asbestos							
B00B - R1003 - General Learning Space - 51.7 m2							
No Asbestos							
B00B - R1004 - General Learning Space - 51.63 m2							
No Asbestos							
B00B - R1005 - Staff Study - 25.97 m2							
No Asbestos							
B00B - R1006 - Cleaning Store - Distributed - 1.02 m2							
Ceiling Structures/Linings	Flat AC Sheeting	2m2	Throughout	Good Condition (1)	Low (1)	Low Priority (2-3)	Chrysotile (white asbestos) , Amosite (brown asbestos)
B00B - R1007 - Distribution Board Cupboard - .82 m2						Note: No inspection of live electrical installation	
Ceiling Structures/Linings	Flat AC Sheeting	1m2	Throughout	Good Condition (1)	Low (1)	Low Priority (2-3)	Chrysotile (white asbestos) , Amosite (brown asbestos)
B00B - R1008 - Movement - 133.39 m2							
Floor Coverings Res/Textile	Vinyl Tiles						
B00B - R1009 - Cleaning Store - Distributed - 4.06 m2							
No Asbestos							
B00B - R1010 - General Learning Space - 52.57 m2							
No Asbestos							
B00B - R1011 - Staff Study - 20.87 m2							
No Asbestos							
B00B - R1012 - General Learning Space - 51.77 m2							
No Asbestos							
B00B - R1013 - General Learning Space - 65.03 m2							
No Asbestos							
B00B - R1014 - Staff Study - 19.59 m2							
No Asbestos							
B00B - R1015 - Cleaning Store - Distributed - .85 m2							
No Asbestos							
B00B - R1016 - General Storeroom - 2.99 m2							
No Asbestos							
B00B - R1017 - General Storeroom - 6.23 m2							
No Asbestos							
B00B - R1018 - Stairs - 16.68 m2							
No Asbestos							
B00B - R1019 - Stairs - 13.56 m2							
No Asbestos							
B00C - General Learning/Administration - 1960 - Concrete							
Exterior							
Ceiling Voids - Raked Ceiling	No Asbestos Found						

Underfloor Voids	AC Fragments/Debris	1	Throughout	Mnimal Damage (2)	Low (1)	Low Priority (2-3)	Chrysotile (white asbestos)
Interior							
B00C - R0001 - Movement - 36.43 m2							
No Asbestos							
B00C - R0002 - General Storeroom - 12.28 m2							
No Asbestos							
B00C - R0003 - Clinic - Girls - 15.7 m2							
No Asbestos							
B00C - R0004 - General Storeroom - 6.8 m2							
No Asbestos							
B00C - R0005 - Staff Study - 10.34 m2							
No Asbestos							
B00C - R0006 - Interview/Office - Type 1 - 10.4 m2							
No Asbestos							
B00C - R0007 - Interview/Office - Type 1 - 10.34 m2							
No Asbestos							
B00C - R0008 - Movement - 34.34 m2							
No Asbestos							
B00C - R0009 - General Storeroom - 3.35 m2							
No Asbestos							
B00C - R0010 - Distribution Board Cupboard - .43 m2							
						Note: No inspection of live electrical installation	
Ceiling Structures/Linings	Flat AC Sheeting	1m2	Throughout	Good Condition (1)	Low (1)	Low Priority (2-3)	Chrysotile (white asbestos) , Amosite (brown asbestos)
B00C - R0011 - Teachers Aides - 8.11 m2							
No Asbestos							
B00C - R0012 - Movement - 53.37 m2							
No Asbestos							
B00C - R0013 - Interview/Office - Type 1 - 17.5 m2							
No Asbestos							
B00C - R0014 - Deputy Principal Office - 17.25 m2							
No Asbestos							
B00C - R0015 - Deputy Principal Office - 17.25 m2							
No Asbestos							
B00C - R0016 - General Storeroom - 17.15 m2							
No Asbestos							
B00C - R0017 - Administration - Clerical - 25.37 m2							
No Asbestos							
B00C - R0018 - Administration - Clerical - 56.17 m2							
No Asbestos							
B00C - R0019 - Movement - 19.78 m2							
Floor Coverings Res/Textile	Vinyl Tiles						
B00C - R0020 - General Storeroom - 2.98 m2							
No Asbestos							
B00C - R0021 - Duplicating Workroom - 21.99 m2							
No Asbestos							
B00C - R0022 - Principal Office - 24.26 m2							
No Asbestos							
B00C - R0023 - General Storeroom - 4.22 m2							
No Asbestos							
B00C - R0024 - Staff - Toilet - 3.78 m2							
No Asbestos							

B00C - R0025 - Interview/Office - Type 1 - 16.85 m2							
No Asbestos							
B00C - R0026 - Careers Advisers Office - 16.89 m2							
No Asbestos							
B00C - R0027 - Cleaning Store - Distributed - 5.71 m2							
No Asbestos							
B00C - R0028 - Student Canteen - 1.96 m2							
No Asbestos							
B00C - R0029 - Staff - Toilet - 5.66 m2							
No Asbestos							
B00C - R0030 - Clinic - Boys - 7.96 m2							
No Asbestos							
B00C - R0031 - Movement - 87.88 m2							
Ceiling Structures/Linings	Flat AC Sheeting	88m2	Throughout	Good Condition (1)	Low (1)	Low Priority (2-3)	Chrysotile (white asbestos) , Amosite (brown asbestos)
B00C - R0032 - Stairs - 12.09 m2							
No Asbestos							
B00C - R1001 - General Learning Space - 52.57 m2							
No Asbestos							
B00C - R1002 - General Learning Space - 51.78 m2							
No Asbestos							
B00C - R1003 - General Learning Space - 52.13 m2							
No Asbestos							
B00C - R1004 - General Learning Space - 65.04 m2							
No Asbestos							
B00C - R1005 - General Storeroom - 7.77 m2							
No Asbestos							
B00C - R1006 - Cleaning Store - Distributed - 4.42 m2							
No Asbestos							
B00C - R1007 - Staff Study - 29.33 m2							
No Asbestos							
B00C - R1008 - General Storeroom - 7.29 m2							
Floor Coverings Res/Textile	Vinyl Tiles	8m2	Throughout	Good Condition (1)	Low (1)	Low Priority (2-3)	Chrysotile (white asbestos)
B00C - R1009 - Staff - Toilet - 8.88 m2							
No Asbestos							
B00C - R1010 - Movement - 125.62 m2							
Floor Coverings Res/Textile	Vinyl Tiles						
B00C - R1011 - Performance Workspace - 52.5 m2							
No Asbestos							
B00C - R1012 - Performing Arts Store - 6.09 m2							
No Asbestos							
B00C - R1013 - General Storeroom - 6.02 m2							
Floor Coverings Res/Textile	Vinyl Tiles						
B00C - R1014 - General Learning Space - 51.85 m2							
No Asbestos							
B00C - R1015 - Distribution Board Cupboard - 1.02 m2							
Note: No inspection of live electrical installation							
Ceiling Structures/Linings	Flat AC Sheeting	2m2	Throughout	Some Damage - Unsealed (3)	Low (1)	Low Priority (2-3)	Chrysotile (white asbestos) , Amosite (brown asbestos)
B00C - R1016 - Cleaning Store - Distributed - 1 m2							
Ceiling Structures/Linings	Flat AC Sheeting	1m2	Throughout	Some Damage - Unsealed (3)	Low (1)	Low Priority (2-3)	Chrysotile (white asbestos) , Amosite (brown asbestos)

B00C - R1017 - Staff Study - 25.25 m2							
No Asbestos							
B00C - R1018 - General Storeroom - 5.97 m2							
Floor Coverings Res/Textile	Vinyl Tiles	6m2	Throughout	Good Condition (1)	Low (1)	Low Priority (2-3)	Chrysotile (white asbestos)
B00C - R1019 - Performance Workspace - 65.03 m2							
No Asbestos							
B00C - R1020 - General Learning Space - 52.78 m2							
No Asbestos							
B00C - R1021 - Stairs - 19.92 m2							
No Asbestos							
B00D - Technological & Applied Studies - 1960 - Concrete Framed							
Exterior							
Ceiling Voids - Raked Ceiling	No Asbestos Found						
Underfloor Voids	No Asbestos Found						
Interior							
B00D - R0007 - Staff Study - 31.09 m2							
No Asbestos							
B00D - R0008 - Design L.S. - 65.87 m2							
No Asbestos							
B00D - R0009 - Pupil Entry - 4.02 m2							
No Asbestos							
B00D - R0010 - General Storeroom - 15.2 m2							
No Asbestos							
B00D - R0011 - Materials Technology L.S. - 77.22 m2							
No Asbestos							
B00D - R0021 - Materials Technology L.S. - 166.93 m2							
No Asbestos							
B00D - R0022 - Dust Extraction Space - 9.96 m2							
No Asbestos							
B00D - R0023 - Materials Store - 6.61 m2							
No Asbestos							
B00D - R0024 - Materials Store - 32.68 m2							
No Asbestos							
B00D - R0025 - Project Store - Type 1 - 29.31 m2							
No Asbestos							
B00D - R0026 - Materials Technology L.S. - 196.62 m2							
No Asbestos							
B00D - R0027 - Movement - 27.48 m2							
No Asbestos							
B00D - R0028 - Plant - .6 m2							
No Asbestos							
B00D - R0029 - Toilets-Disabled - 4.68 m2							
No Asbestos							
B00D - R0030 - Lift - 1.95 m2							
No Asbestos							
B00D - R0031 - External Movement - 18.25 m2							
No Asbestos							
B00D - R0032 - Toilets-Girls - 29.91 m2							
Require Inspection							
B00D - R0033 - Chair Storeroom - 17.73 m2							

Require Inspection							
B00D - R0034 - General Storeroom - 17.63 m2							
Require Inspection							
B00D - R0035 - Toilets-Boys - 29.73 m2							
Require Inspection							
B00D - R9001 - Sport Equipment Store - 11.91 m2							
No Asbestos							
B00D - R9002 - Sport Equipment Store - 7.37 m2							
Ceiling Structures/Linings	Flat AC Sheeting	8m2	Throughout	Good Condition (1)	Low (1)	Low Priority (2-3)	Chrysotile (white asbestos) , Amosite (brown asbestos)
B00D - R9003 - Staff - Toilet - 3.61 m2							
Ceiling Structures/Linings	Flat AC Sheeting	4m2	Throughout	Good Condition (1)	Low (1)	Low Priority (2-3)	Chrysotile (white asbestos) , Amosite (brown asbestos)
B00D - R9004 - Movement - 4.75 m2							
Ceiling Structures/Linings	Flat AC Sheeting	5m2	Throughout	Good Condition (1)	Low (1)	Low Priority (2-3)	Chrysotile (white asbestos) , Amosite (brown asbestos)
B00D - R9005 - Shower/Change - 72.63 m2							
Wall Linings Internal - Infill	Flat AC Sheeting						
B00D - R9006 - Staff Study - 6.02 m2							
Floor Coverings Res/Textile	Vinyl Tiles						
B00D - R9007 - Sport Equipment Store - 14.05 m2							
No Asbestos							
B00E - Pupil Facilities - 1960 - Concrete Framed							
Exterior							
Ceiling Voids - Raked Ceiling	No Asbestos Found						
Underfloor Voids	No Asbestos Found						
Eaves Linings	Flat AC Sheeting	40m2	Variable positions	Good Condition (1)	Low (1)	Low Priority (2-3)	Chrysotile (white asbestos) , Amosite (brown asbestos) , Crocidolite (blue asbestos)
Interior							
B00E - R0001 - Toilets-Girls - 38.72 m2							
Partition Walls (Cubicles)	Compressed AC Sheet	20m2	Variable positions	Good Condition (1)	Low (1)	Low Priority (2-3)	Chrysotile (white asbestos)
B00E - R0002 - Toilets-Disabled - 5.74 m2							
No Asbestos							
B00E - R0003 - Toilets-Boys - 29.21 m2							
Partition Walls (Cubicles)	Compressed AC Sheet	15m2	Variable positions	Good Condition (1)	Low (1)	Low Priority (2-3)	Chrysotile (white asbestos)
B00E - R0004 - Student Canteen - 236.01 m2							
No Asbestos							
B00E - R0005 - Student Canteen - 34.76 m2							
No Asbestos							
B00E - R0006 - Student Canteen - 7.04 m2							
No Asbestos							
B00E - R0007 - Staff - Toilet - 2.87 m2							
No Asbestos							
B00E - R0008 - Student Canteen - 5.09 m2							
No Asbestos							
B00E - R0009 - External Movement - 3.81 m2							
No Asbestos							
B00E - R9001 - Garden Store Room - 81.43 m2							
No Asbestos							

B00E - R9002 - Shower/Change - 82.01 m2							
Ceiling Structures/Linings	Flat AC Sheeting	82m2	Throughout	Good Condition (1)	Low (1)	Low Priority (2-3)	Chrysotile (white asbestos)
B00E - R9003 - General Storeroom - 5.86 m2							
Ceiling Structures/Linings	Flat AC Sheeting	6m2	Throughout	Good Condition (1)	Low (1)	Low Priority (2-3)	Chrysotile (white asbestos)
B00E - R9004 - Sport Equipment Store - 11.27 m2							
Ceiling Structures/Linings	Flat AC Sheeting	12m2	Throughout	Good Condition (1)	Low (1)	Low Priority (2-3)	Chrysotile (white asbestos)
B00F - Multi Purpose Facilities - 1960 - Brick/Block							
Exterior							
Ceiling Voids - Raked Ceiling	No Asbestos Found						
Eaves Linings	Flat AC Sheeting	70m2	Variable positions	Good Condition (1)	Low (1)	Low Priority (2-3)	Chrysotile (white asbestos) , Amosite (brown asbestos) , Crocidolite (blue asbestos)
Underfloor Voids	Flat AC Sheeting	50	Throughout	Mnimal Damage (2)	Low (1)	Low Priority (2-3)	Chrysotile (white asbestos)
Underfloor Voids - Stored / Debris Material	AC Fragments/Debris	50	Throughout	Mnimal Damage (2)	Low (1)	Low Priority (2-3)	Chrysotile (white asbestos)
Eaves Linings	Flat AC Sheeting						
Interior							
B00F - M0001 - General Storeroom - 12.47 m2							
No Asbestos							
B00F - M0002 - Control Room - 12.5 m2							
No Asbestos							
B00F - R0001 - Multi-Purpose Space - 411.77 m2							
No Asbestos							
B00F - R0002 - Chair Store - 12.82 m2							
No Asbestos							
B00F - R0003 - Pupil Entry - 6.62 m2							
Ceiling Structures/Linings	Flat AC Sheeting	7m2	Throughout	Good Condition (1)	Low (1)	Low Priority (2-3)	Chrysotile (white asbestos) , Amosite (brown asbestos)
B00F - R0004 - Stage - 91.44 m2							
No Asbestos							
B00F - R0005 - Movement - 20.32 m2							
No Asbestos							
B00F - R0006 - Pupil Entry - 4.47 m2							
Ceiling Structures/Linings	Flat AC Sheeting	5m2	Throughout	Good Condition (1)	Low (1)	Low Priority (2-3)	Chrysotile (white asbestos) , Amosite (brown asbestos)
B00F - R0007 - Sport Equipment Store - 9.38 m2							
No Asbestos							
B00F - R0008 - General Storeroom - 9.28 m2							
No Asbestos							
B00F - R0009 - Toilets-Boys - 5.47 m2							
No Asbestos							
B00F - R0010 - Cleaning Store - Distributed - 5 m2							
No Asbestos							
B00F - R0011 - Toilets-Girls - 7.25 m2							
No Asbestos							
B00F - R0012 - Pupil Entry - 2.6 m2							
No Asbestos							
B00F - R9001 - Chair Store - 28.01 m2							

Ceiling Structures/Linings	Flat AC Sheeting	29m2	Throughout	Good Condition (1)	Low (1)	Low Priority (2-3)	Chrysotile (white asbestos) , Amosite (brown asbestos)
B00F - R9002 - General Storeroom - 28.02 m2							
Ceiling Structures/Linings	Flat AC Sheeting	29m2	Throughout	Good Condition (1)	Low (1)	Low Priority (2-3)	Chrysotile (white asbestos) , Amosite (brown asbestos)
B00F - R9003 - General Assistants - 27.87 m2							
Ceiling Structures/Linings	Flat AC Sheeting	28m2	Throughout	Good Condition (1)	Low (1)	Low Priority (2-3)	Chrysotile (white asbestos) , Amosite (brown asbestos)
B00G - Music - 1960 - Timber							
Exterior							
Ceiling Voids - Raked Ceiling	No Asbestos Found						
Underfloor Voids	No Asbestos Found						
Eaves Linings	Flat AC Sheeting	60m2	North, South	Good Condition (1)	Low (1)	Low Priority (2-3)	Chrysotile (white asbestos) , Amosite (brown asbestos)
Interior							
B00G - R0001 - Practice/Seminar - 24.49 m2							
No Asbestos							
B00G - R0002 - Music Store - 2.51 m2							
No Asbestos							
B00G - R0003 - Music Store - 4.74 m2							
Floor Coverings Res/Textile	Vinyl Tiles						
B00G - R0004 - Cleaning Store - Distributed - 2.04 m2							
No Asbestos							
B00G - R0005 - Music Store - 14.35 m2							
Ceiling Structures/Linings	Flat AC Sheeting						
Floor Coverings Res/Textile	Vinyl Tiles						
B00G - R0006 - General Learning Space - 53.52 m2							
Wall Linings Internal - Infill	Flat AC Sheeting	2m2	South	Good Condition (1)	Low (1)	Low Priority (2-3)	Chrysotile (white asbestos) , Amosite (brown asbestos)
B00G - R0007 - Movement - 14.59 m2							
Ceiling Structures/Linings	Flat AC Sheeting						
B00G - R0008 - Movement - 17.66 m2							
Ceiling Structures/Linings	Flat AC Sheeting						
B00G - R0009 - Music Learning Space - 53.65 m2							
Wall Linings Internal - Infill	Flat AC Sheeting	2m2	South	Good Condition (1)	Low (1)	Low Priority (2-3)	Chrysotile (white asbestos) , Amosite (brown asbestos)
B00H - General Learning/Science - 1960 - Brick/Block							
Exterior							
Ceiling Voids - Raked Ceiling	No Asbestos Found						
Underfloor Voids	No Asbestos Found						
Eaves Linings	Flat AC Sheeting	180m2	Variable positions	Good Condition (1)	Low (1)	Low Priority (2-3)	Assumed Asbestos
Interior							
B00H - R0001 - Movement - 290.24 m2							
Ceiling Structures/Linings	Vermiculite - Composite Sample - (> 250 m2) - (X25)						
Floor Coverings Res/Textile	Vinyl Tiles						

Floor Coverings Res/Textile	Vinyl Tiles	93m2	North, Throughout	Good Condition (1)	Low (1)	Low Priority (2-3)	Chrysotile (white asbestos)
B00H - R0002 - Cleaning Store - Distributed - 1.39 m2							
No Asbestos							
B00H - R0003 - General Storeroom - 6.05 m2							
Floor Coverings Res/Textile	Vinyl Tiles	7m2	Throughout	Good Condition (1)	Low (1)	Low Priority (2-3)	Chrysotile (white asbestos)
Ceiling Structures/Linings	Vermiculite - Composite Sample - (< 10 m2) - (X2)						
B00H - R0004 - General Storeroom - 6.09 m2							
Floor Coverings Res/Textile	Vinyl Tiles	7m2	Throughout	Good Condition (1)	Low (1)	Low Priority (2-3)	Chrysotile (white asbestos)
Ceiling Structures/Linings	Vermiculite - Composite Sample - (< 10 m2) - (X2)						
B00H - R0005 - Art Learning Space - 51.99 m2							
Floor Coverings Res/Textile	Vinyl Tiles	52m2	Throughout	Good Condition (1)	Low (1)	Low Priority (2-3)	Chrysotile (white asbestos)
Ceiling Structures/Linings	Vermiculite - Composite Sample - (40 - 70 m2) - (X5)						
B00H - R0006 - Art Learning Space - 58.59 m2							
Floor Coverings Res/Textile	Vinyl Tiles	59m2	Throughout	Good Condition (1)	Low (1)	Low Priority (2-3)	Chrysotile (white asbestos)
Ceiling Structures/Linings	Vermiculite - Composite Sample - (40 - 70 m2) - (X5)						
B00H - R0007 - Kiln Space - 21.73 m2							
Wall Linings Internal	Flat AC Sheeting	10m2	Throughout	Good Condition (1)	Low (1)	Low Priority (2-3)	Chrysotile (white asbestos)
Ceiling Structures/Linings	Vermiculite - Composite Sample - (10 - 40 m2) - (X3)						
B00H - R0008 - Resources Store - 10.01 m2							
Ceiling Structures/Linings	Vermiculite - Composite Sample - (10 - 40 m2) - (X3)						
B00H - R0009 - Staff Study - 25.6 m2							
Floor Coverings Res/Textile	Vinyl Tiles	26m2	Throughout	Good Condition (1)	Low (1)	Low Priority (2-3)	Chrysotile (white asbestos)
Ceiling Structures/Linings	Vermiculite - Composite Sample - (10 - 40 m2) - (X3)						
B00H - R0010 - Distribution Board Cupboard - .86 m2							
Note: No inspection of live electrical installation							
No Asbestos							
B00H - R0011 - Cleaning Store - Distributed - 3.34 m2							
Floor Coverings Res/Textile	Vinyl Tiles	4m2	Throughout	Good Condition (1)	Low (1)	Low Priority (2-3)	Chrysotile (white asbestos)
Ceiling Structures/Linings	Vermiculite - Composite Sample - (< 10 m2) - (X2)						
B00H - R0012 - Staff - Toilet - 5.5 m2							
Ceiling Structures/Linings	Vermiculite - Composite Sample - (< 10 m2) - (X2)						
B00H - R0013 - Design L.S. - 60.39 m2							
Ceiling Structures/Linings	Vermiculite - Composite Sample - (40 - 70 m2) - (X5)						
Floor Coverings Res/Textile	Vinyl Tiles	61m2	Throughout	Good Condition (1)	Low (1)	Low Priority (2-3)	Chrysotile (white asbestos)
B00H - R0014 - Materials Store - 6.07 m2							
Ceiling Structures/Linings	Vermiculite - Composite Sample - (< 10 m2) - (X2)						
Floor Coverings Res/Textile	Vinyl Tiles	7m2	Throughout	Good Condition (1)	Low (1)	Low Priority (2-3)	Chrysotile (white asbestos)
B00H - R0015 - Apparatus Store - 6.07 m2							

Ceiling Structures/Linings	Vermiculite - Composite Sample - (< 10 m2) - (X2)						
B00H - R0016 - Apparatus Store - 6.26 m2							
Ceiling Structures/Linings	Vermiculite - Composite Sample - (< 10 m2) - (X2)						
B00H - R0019 - Apparatus Store - 9.75 m2							
Floor Coverings Res/Textile	Vinyl Tiles	10m2	Throughout	Good Condition (1)	Low (1)	Low Priority (2-3)	Chrysotile (white asbestos)
Ceiling Structures/Linings	Vermiculite - Composite Sample - (10 - 40 m2) - (X3)						
B00H - R0020 - Laboratory L.S. - 91.74 m2							
Plant / Equipment - Fume Cupboard	Flat AC Sheeting	1	North	Good Condition (1)	Low (1)	Low Priority (2-3)	Chrysotile (white asbestos) , Amosite (brown asbestos)
Furniture / Fixtures	Compressed AC Sheet	3	2nd bench from south corner	Good Condition (1)	Low (1)	Low Priority (2-3)	Chrysotile (white asbestos) , Amosite (brown asbestos)
B00H - R0021 - Chemical Store - 25.56 m2							
Ceiling Structures/Linings	Vermiculite - Composite Sample - (10 - 40 m2) - (X3)						
B00H - R0022 - Cleaning Store - Distributed - 1.38 m2							
No Asbestos							
B00H - R0023 - Stairs - .7 m2							
No Asbestos							
B00H - R0024 - Stairs - 10.43 m2							
No Asbestos							
B00H - R0025 - Stairs - 1.03 m2							
No Asbestos							
B00H - R0026 - General Learning Space - 39.07 m2							
Ceiling Structures/Linings	Vermiculite - Composite Sample - (40 - 70 m2) - (X5)						
B00H - R0027 - General Learning Space - 52.2 m2							
Ceiling Structures/Linings	Vermiculite - Composite Sample - (40 - 70 m2) - (X5)						
B00H - R0028 - Preparation - Science - 28.41 m2							
Require Inspection							
B00H - R1001 - Movement - 271.84 m2							
Ceiling Structures/Linings	Vermiculite - Composite Sample - (> 250 m2) - (X25)						
Floor Coverings Res/Textile	Vinyl Tiles	259m2	North, Throughout	Good Condition (1)	Low (1)	Low Priority (2-3)	Chrysotile (white asbestos)
B00H - R1002 - Cleaning Store - Distributed - 1.39 m2							
No Asbestos							
B00H - R1003 - General Learning Space - 39.1 m2							
Ceiling Structures/Linings	Vermiculite - Composite Sample - (40 - 70 m2) - (X5)						
B00H - R1004 - Senior Seminar - 12.53 m2							
Ceiling Structures/Linings	Vermiculite - Composite Sample - (10 - 40 m2) - (X3)						
B00H - R1005 - Senior Seminar - 12.7 m2							
Ceiling Structures/Linings	Vermiculite - Composite Sample - (10 - 40 m2) - (X3)						
B00H - R1006 - General Learning Space - 65.67 m2							
Ceiling Structures/Linings	Vermiculite - Composite Sample - (40 - 70 m2) - (X5)						
B00H - R1007 - Staff Study - 12.74 m2							
Ceiling Structures/Linings	Vermiculite - Composite Sample - (10 - 40 m2) - (X3)						

B00H - R1008 - Staff Study - 25.6 m2						
Ceiling Structures/Linings	Vermiculite - Composite Sample - (10 - 40 m2) - (X3)					
B00H - R1009 - Staff Study - 12.39 m2						
Ceiling Structures/Linings	Vermiculite - Composite Sample - (10 - 40 m2) - (X3)					
B00H - R1010 - Distribution Board Cupboard - .86 m2						
Note: No inspection of live electrical installation						
No Asbestos						
B00H - R1011 - Cleaning Store - Distributed - 3.5 m2						
Ceiling Structures/Linings	Vermiculite - Composite Sample - (< 10 m2) - (X2)					
Floor Coverings Res/Textile	Vinyl Tiles					
B00H - R1012 - Staff - Toilet - 5.5 m2						
Ceiling Structures/Linings	Vermiculite - Composite Sample - (< 10 m2) - (X2)					
B00H - R1013 - General Learning Space - 60.48 m2						
Ceiling Structures/Linings	Vermiculite - Composite Sample - (40 - 70 m2) - (X5)					
B00H - R1014 - General Storeroom - 6.07 m2						
Ceiling Structures/Linings	Vermiculite - Composite Sample - (< 10 m2) - (X2)					
B00H - R1015 - Staff Study - 12.74 m2						
Ceiling Structures/Linings	Vermiculite - Composite Sample - (10 - 40 m2) - (X3)					
B00H - R1016 - General Storeroom - 6.04 m2						
Ceiling Structures/Linings	Vermiculite - Composite Sample - (< 10 m2) - (X2)					
Floor Coverings Res/Textile	Vinyl Tiles	7m2	North, Throughout	Good Condition (1)	Low (1) Low Priority (2-3)	Chrysotile (white asbestos)
B00H - R1017 - General Learning Space - 52.13 m2						
Ceiling Structures/Linings	Vermiculite - Composite Sample - (40 - 70 m2) - (X5)					
B00H - R1018 - General Learning Space - 52.43 m2						
Ceiling Structures/Linings	Vermiculite - Composite Sample - (40 - 70 m2) - (X5)					
B00H - R1019 - Computer Learning Space - 52.14 m2						
Ceiling Structures/Linings	Vermiculite - Composite Sample - (40 - 70 m2) - (X5)					
B00H - R1020 - General Storeroom - 12.24 m2						
Ceiling Structures/Linings	Vermiculite - Composite Sample - (10 - 40 m2) - (X3)					
B00H - R1021 - Computer Learning Space - 51.99 m2						
Ceiling Structures/Linings	Vermiculite - Composite Sample - (40 - 70 m2) - (X5)					
B00H - R1022 - General Storeroom - 12.38 m2						
Ceiling Structures/Linings	Vermiculite - Composite Sample - (10 - 40 m2) - (X3)					
B00H - R1023 - Cleaning Store - Distributed - 1.39 m2						
No Asbestos						
B00H - R1024 - Stairs - 16.67 m2						
No Asbestos						
B00H - R1025 - Stairs - 10.06 m2						
No Asbestos						
B00H - R1026 - Stairs - 9.82 m2						
No Asbestos						
B00H - R9001 - Movement - 44.66 m2						

Ceiling Structures/Linings	Vermiculite - Composite Sample - (40 - 70 m2) - (X5)	
B00H - R9002 - Art Learning Space - 108.99 m2		
Ceiling Structures/Linings	Vermiculite - Composite Sample - (70 - 120 m2) - (X8)	
B00H - R9003 - General Storeroom - 2.51 m2		
Ceiling Structures/Linings	Vermiculite - Composite Sample - (< 10 m2) - (X2)	
B00H - R9004 - Darkroom Space - 16.03 m2		
Ceiling Structures/Linings	Vermiculite - Composite Sample - (10 - 40 m2) - (X3)	
B00H - R9005 - Movement - 3.52 m2		
Ceiling Structures/Linings	Vermiculite - Composite Sample - (< 10 m2) - (X2)	
B00H - R9006 - Darkroom Space - 16.79 m2		
Ceiling Structures/Linings	Vermiculite - Composite Sample - (10 - 40 m2) - (X3)	
B00H - R9007 - Stairs - 1.24 m2		
No Asbestos		
B00I - Technological & Applied Studies - 2011 - Brick/Veneer		
Exterior		
Underfloor Voids	No Asbestos Found	
Ceiling Voids	No Asbestos Found	
Interior		
B00I - R0001 - Store - 11.9 m2		
No Asbestos		
B00I - R0002 - Store - 2.93 m2		
No Asbestos		
B00I - R0005 - Store - 19.45 m2		
No Asbestos		
B00I - R0006 - Store - 15.88 m2		
No Asbestos		
B00I - R0007 - Plant - .59 m2		
No Asbestos		
B00I - R0008 - Welding Area - 4.36 m2		
No Asbestos		
B00I - R0009 - Welding Area - 4.29 m2		
No Asbestos		
B00I - R0010 - Welding Area - 4.29 m2		
No Asbestos		
B00I - R0011 - Welding Area - 4.29 m2		
No Asbestos		
B00I - R0012 - Welding Area - 4.29 m2		
No Asbestos		
B00I - R0013 - Welding Area - 4.29 m2		
No Asbestos		
B00I - R0014 - Materials Technology L.S. - 219.54 m2		
No Asbestos		
B00I - R0015 - Movement - 4.62 m2		
No Asbestos		
B00I - R0016 - External Movement - 155.37 m2		
No Asbestos		

Demountables

There are no Demountable(s) Located at this school as per the AMS records as of 09-Sep-2020