

Asbestos Register

(Hazardous Materials and Risk Assessment)

School:	Fernhill School (5768)
Region:	Western Sydney AMU
State Electorate:	
Local Government Area:	Penrith

Last Reviewed By:	
Last Revised By:	

Historical Fibro In Grounds Investigations/Events	No
<p>No previous investigations have been recorded against the school. However, asbestos containing materials maybe present in grounds from time to time and caution must be exercised prior to any grounds disturbance.</p>	

5768 - Fernhill School
Site Plan (13612)

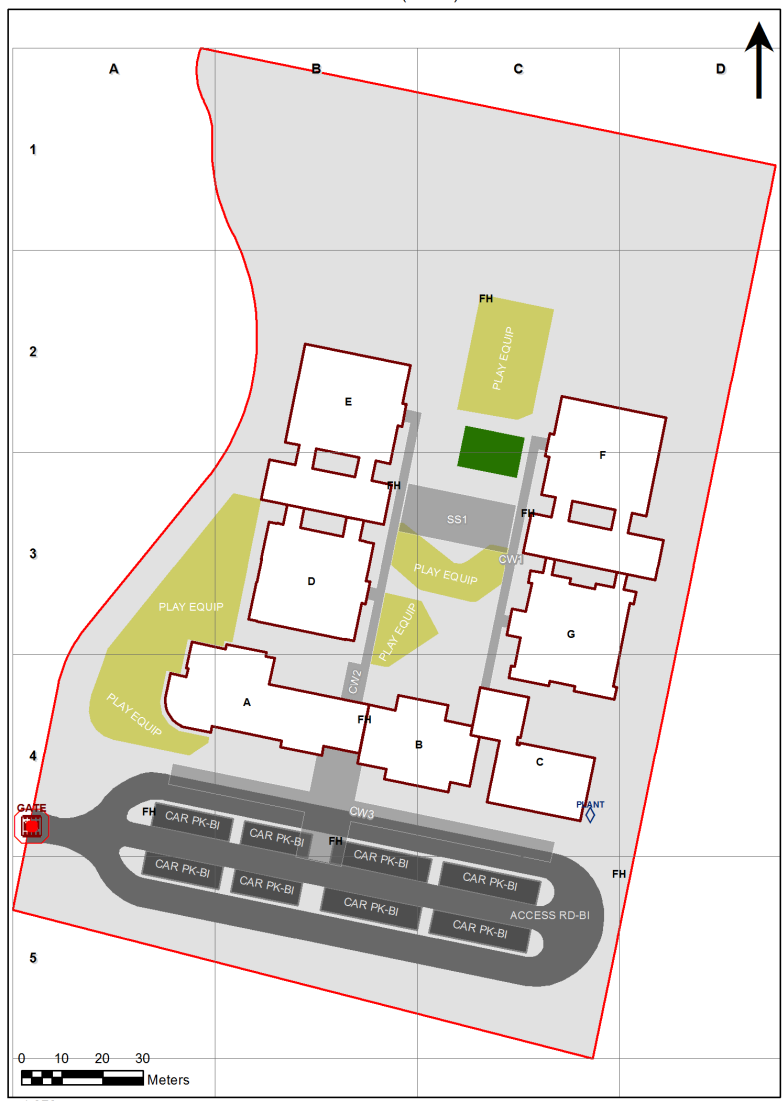

1:979

Printed: 21-Mar-2020

Preface to Asbestos Register

Limitations

Asbestos Registers established (first surveyed 2007/08) and maintained for the Department of Education (DoE) are limited in extent, in that:

1. All inspections and surveys of materials and finishes in DoE facilities are non-disturbance, with
2. Samples undertaken by hygienist to determine whether a sample is an Asbestos Containing Material (ACM),
3. The hygienist may apply a single sample to like materials within a space and adjoining spaces, but not normally between buildings,
4. Successive inspections have reduced any inconclusive records such as 'assumed asbestos' in difficult to access areas, by undertaking additional sampling with lifting devices.
5. In compliance with WHS Act 2011 and WHS Regulations 2017, additional inspections have been undertaken in ceiling spaces and sub-floor areas where access is possible.
 - o Where the ground floor is slab on ground, no inspection is made beneath the slab.
 - o Where fibro fragments (ACM taken for sampling) are located in ceiling spaces or sub floor voids air monitoring is normally undertaken at time of sampling, and clearance undertaken as soon as practicable.
6. No attempt has been made to identify any ACM that is hidden from view or encapsulated within
 - o Any wall cavity
 - o Sub floor area, particularly formwork for slabs in/on ground,
 - o Services (that may use ACM) such as: pipe lagging, asbestos cement pipes, flues.
7. All known ACM in Grounds (Fibro in Grounds) is made available in associated site specific asbestos management plans in DoE electronic files.
Notwithstanding information provided, ACM may be present in grounds from time to time and caution must be exercised prior to any grounds disturbance.

Use of the Asbestos Register

Prior to any disturbance works being undertaken in a building to which this asbestos register applies it will be necessary to confirm the extent of any ACM by a disturbance investigation:

- If the building was built prior to 2003
- If any ACM has been identified in the Asbestos Register for the building.

Update of Asbestos Registers

Asbestos Register Data is updated regularly by the DoE Hygienist Panel via the Online Asbestos Register Tool (Managed by Business Systems, School Infrastructure NSW). Internal users can view the latest edition of the Asbestos Register in the AMS.

Please note: The Department's external website may not contain the latest revision of the Asbestos Register.

Notes 1: Vermiculite

- During 2018/19, all vermiculite occurrences in DoE schools identified in 2007/08, were 'composite tested' in accordance with a safe work NSW agreed procedure. This required multiple testing of all vermiculite occurrences.
- During the period 2007/08 to 2018/19, some vermiculite has been over sheeted and a warning is indicated for schools where this has happened.

Note 2: DoE website link for information is here:

<https://www.schoolinfrastructure.nsw.gov.au/about-us/working-with-us/schools-asbestos-register.html>
<https://education.nsw.gov.au/about-us/strategies-and-reports/our-reports-and-reviews/schools-asbestos-register>

Note 3: Material Condition Assessment

The material condition assessment descriptors from Section 3 of the Asbestos Management Plan (AMP) is extracted below. Please read the AMP in its entirety for further information.

3.3.2.1 Material condition assessment

The OART records the material condition of identified ACM in the following format:

Rating	Description
Good condition (1)	For non-friable asbestos that is sealed and has no visible damage. This primarily related to asbestos cement (AC) sheet and vinyl tiles
Minimal damage (2)	For non-friable asbestos that has a very small amount of damage, eg hairline cracks.
Some damage / unsealed (3)	For non-friable asbestos with significant breakage or several small areas where material has been damaged, revealing loose asbestos fibres. Non-friable asbestos that is unsealed.
Poor condition (4)	For non-friable asbestos that has extensive damage. Visible asbestos debris
Friable asbestos (5)	Any occurrence of friable asbestos

Product	Material Description	Extent	Location	Material Condition	Risk Status	Remediation Priority	Result
B00A - Administration - 2016 - Brick/Veneer							
Exterior							
Ceiling Voids	No Asbestos Found						
Underfloor Voids	No Asbestos Found						
Underfloor Voids	No Asbestos Found						
Ceiling Voids	No Asbestos Found						
Interior							
B00A - R0001 - Entry Vestibule - 19.85 m2							
No Asbestos							
B00A - R0002 - Toilets-Unisex - 4.2 m2							
No Asbestos							
B00A - R0003 - Interview - 12.9 m2							
No Asbestos							
B00A - R0004 - Movement - 59.21 m2							
No Asbestos							
B00A - R0005 - Interview - 12.75 m2							
No Asbestos							
B00A - R0006 - Principal - 16.77 m2							
No Asbestos							
B00A - R0007 - Cleaning Distributed Store - 6.44 m2							
No Asbestos							
B00A - R0008 - Disabled Toilet - 3.86 m2							
No Asbestos							
B00A - R0009 - Disabled Toilet - 3.86 m2							
No Asbestos							
B00A - R0010 - General Storeroom - 10.28 m2							
No Asbestos							
B00A - R0011 - Security Store - 12.79 m2							
No Asbestos							
B00A - R0012 - Staff Room - 101.37 m2							
No Asbestos							
B00A - R0013 - Staff Kitchen - 10.32 m2							
No Asbestos							
B00A - R0014 - Communications Cupboard - 8.51 m2							
No Asbestos							
B00A - R0015 - Distribution Board - 4.41 m2							
No Asbestos							Note: No inspection of live electrical installation
B00A - R0016 - Special Programs Room - 55.38 m2							
No Asbestos							
B00A - R0017 - Reading Area - 91.34 m2							
No Asbestos							
B00A - R0018 - K.L.A. Store - 20.24 m2							
No Asbestos							
B00A - R0019 - Library Office/Workroom - 13.88 m2							
No Asbestos							
B00A - R0020 - Interview - 13.05 m2							
No Asbestos							
B00A - R0021 - Deputy Principal - 12.89 m2							
No Asbestos							
B00A - R0022 - Access Shower/Toilet - 6.13 m2							

No Asbestos		
B00A - R0023 - Toilets-Unisex - 2.58 m2		
No Asbestos		
B00A - R0024 - Sick Bay - 10.94 m2		
No Asbestos		
B00A - R0025 - Clerical Office - 52.85 m2		
No Asbestos		
B00A - R0026 - General Storeroom - 6.23 m2		
No Asbestos		
B00A - R0027 - Movement - 8.49 m2		
No Asbestos		
B00A - R0028 - External Movement - 79.68 m2		
No Asbestos		
B00A - R0029 - External Movement - 86.1 m2		
No Asbestos		
B00B - Special Purpose - 2016 - Brick/Veneer		
Exterior		
Ceiling Voids	No Asbestos Found	
Underfloor Voids	No Asbestos Found	
Underfloor Voids	No Asbestos Found	
Ceiling Voids	No Asbestos Found	
Interior		
B00B - R0001 - Communal Space - 116.22 m2		
No Asbestos		
B00B - R0002 - Kitchenette - 19.01 m2		
No Asbestos		
B00B - R0003 - Special Programs Room - 39.29 m2		
No Asbestos		
B00B - R0004 - Special Programs Store - 11.67 m2		
No Asbestos		
B00B - R0005 - Cleaning Supplies - 9.46 m2		
No Asbestos		
B00B - R0006 - General Storeroom - 19.29 m2		
No Asbestos		
B00B - R0007 - Garden Store - 12.75 m2		
No Asbestos		
B00B - R0008 - Sports Store - 12.21 m2		
No Asbestos		
B00B - R0009 - Access Shower/Toilet - 6.54 m2		
No Asbestos		
B00B - R0010 - Access Shower/Toilet - 6.57 m2		
No Asbestos		
B00B - R0011 - Seminar/Study - 28.75 m2		
No Asbestos		
B00B - R0012 - General Assistant/Bulk Store - 17.51 m2		
No Asbestos		
B00B - R0013 - Sports Store - 9.16 m2		
No Asbestos		
B00B - R0014 - Chair Storeroom - 7.14 m2		
No Asbestos		
B00B - R0015 - Movement - 4.54 m2		

No Asbestos		
B00B - R0016 - External Movement - 143 m2		
No Asbestos		
B00C - Special Purpose - 2016 - Brick/Block		
Exterior		
Underfloor Voids	No Asbestos Found	
Ceiling Voids	No Asbestos Found	
Ceiling Voids	No Asbestos Found	
Underfloor Voids	No Asbestos Found	
Interior		
B00C - R0001 - Movement - 4.99 m2		
No Asbestos		
B00C - R0002 - Movement - 9.98 m2		
No Asbestos		
B00C - R0003 - Movement - 98.51 m2		
No Asbestos		
B00C - R0004 - Clerical Office - 11.4 m2		
No Asbestos		
B00C - R0005 - Change - Type 2 - 13.91 m2		
No Asbestos		
B00C - R0006 - Toilet - Lobby - 5.52 m2		
No Asbestos		
B00C - R0007 - Access Shower/Toilet - 7.06 m2		
No Asbestos		
B00C - R0008 - General Storeroom - 4.08 m2		
No Asbestos		
B00C - R0009 - Shower/Change - 5.15 m2		
No Asbestos		
B00C - R0010 - Disabled Shower/Toilet - 30.26 m2		
No Asbestos		
B00C - R0011 - Plant - 43.67 m2		
No Asbestos		
B00C - R0012 - Plant - .48 m2		
No Asbestos		
B00C - R0013 - Hydrotherapy - Pool - 99.24 m2		
No Asbestos		
B00C - R0014 - External Movement - 145.04 m2		
No Asbestos		
B00D - General Learning - 2016 - Brick/Veneer		
Exterior		
Underfloor Voids	No Asbestos Found	
Ceiling Voids	No Asbestos Found	
Ceiling Voids	No Asbestos Found	
Underfloor Voids	No Asbestos Found	
Interior		
B00D - R0001 - External Movement - 45.03 m2		
No Asbestos		
B00D - R0002 - Practical Activities/Movement - 2hb - 25.48 m2		
No Asbestos		
B00D - R0003 - Practical Activities/Movement - 2hb - 41.96 m2		
No Asbestos		

B00D - R0004 - Home Base - M - 58.75 m2		
No Asbestos		
B00D - R0005 - Withdrawal - M - 12.83 m2		
No Asbestos		
B00D - R0006 - Disabled Shower/Toilet - 27.43 m2		
No Asbestos		
B00D - R0007 - Home Base Store - M - 13.55 m2		
No Asbestos		
B00D - R0008 - Laundry - P - 3.05 m2		
No Asbestos		
B00D - R0009 - Home Base - M - 59.86 m2		
No Asbestos		
B00D - R0010 - Withdrawal - M - 12.78 m2		
No Asbestos		
B00D - R0011 - External Movement - 39.01 m2		
No Asbestos		
B00D - R0012 - Home Base - M - 59.8 m2		
No Asbestos		
B00D - R0013 - Withdrawal - M - 12.75 m2		
No Asbestos		
B00D - R0014 - Disabled Shower/Toilet - 10.26 m2		
No Asbestos		
B00D - R0015 - Home Base Store - M - 16.98 m2		
No Asbestos		
B00D - R0016 - Access Shower/Toilet - 6.35 m2		
No Asbestos		
B00D - R0017 - Home Base - M - 58.97 m2		
No Asbestos		
B00D - R0018 - Disabled Shower/Toilet - 10.26 m2		
No Asbestos		
B00D - R0019 - Withdrawal - M - 12.72 m2		
No Asbestos		
B00D - R0020 - External Movement - 19.78 m2		
No Asbestos		
B00D - R0021 - External Movement - 19.7 m2		
No Asbestos		
B00D - R0022 - External Movement - 19.73 m2		
No Asbestos		
B00D - R0023 - External Movement - 19.73 m2		
No Asbestos		
B00D - R0024 - External Movement - 21.14 m2		
No Asbestos		
B00D - R0025 - External Movement - 21.21 m2		
No Asbestos		
B00E - General Learning - 2016 - Brick/Veneer		
Exterior		
Underfloor Voids	No Asbestos Found	
Ceiling Voids	No Asbestos Found	
Ceiling Voids	No Asbestos Found	
Underfloor Voids	No Asbestos Found	
Interior		

B00E - R0001 - External Movement - 45.05 m2	
No Asbestos	
B00E - R0002 - Practical Activities/Movement - 2hb - 25.48 m2	
No Asbestos	
B00E - R0003 - Practical Activities/Movement - 2hb - 41.96 m2	
No Asbestos	
B00E - R0004 - Home Base - M - 58.91 m2	
No Asbestos	
B00E - R0005 - Withdrawal - M - 12.77 m2	
No Asbestos	
B00E - R0006 - Disabled Shower/Toilet - 27.54 m2	
No Asbestos	
B00E - R0007 - Home Base Store - M - 13.53 m2	
No Asbestos	
B00E - R0008 - Laundry - P - 3.08 m2	
No Asbestos	
B00E - R0009 - Home Base - M - 59.7 m2	
No Asbestos	
B00E - R0010 - Withdrawal - M - 12.77 m2	
No Asbestos	
B00E - R0011 - External Movement - 39.19 m2	
No Asbestos	
B00E - R0012 - Home Base - M - 59.7 m2	
No Asbestos	
B00E - R0013 - Withdrawal - M - 12.78 m2	
No Asbestos	
B00E - R0014 - Disabled Shower/Toilet - 10.37 m2	
No Asbestos	
B00E - R0015 - Home Base Store - M - 16.89 m2	
No Asbestos	
B00E - R0016 - Disabled Shower/Toilet - 6.32 m2	
No Asbestos	
B00E - R0017 - Home Base - M - 58.92 m2	
No Asbestos	
B00E - R0018 - Disabled Shower/Toilet - 10.37 m2	
No Asbestos	
B00E - R0019 - Withdrawal - M - 12.78 m2	
No Asbestos	
B00E - R0020 - External Movement - 19.92 m2	
No Asbestos	
B00E - R0021 - External Movement - 19.85 m2	
No Asbestos	
B00E - R0022 - External Movement - 19.97 m2	
No Asbestos	
B00E - R0023 - External Movement - 19.97 m2	
No Asbestos	
B00E - R0024 - External Movement - 20.99 m2	
No Asbestos	
B00E - R0025 - External Movement - 21.15 m2	
No Asbestos	
B00E - R0026 - Communal Space - 309.91 m2	
No Asbestos	

B00F - General Learning - 2016 - Brick/Veneer

Exterior

Underfloor Voids	No Asbestos Found	
Ceiling Voids	No Asbestos Found	
Ceiling Voids	No Asbestos Found	
Underfloor Voids	No Asbestos Found	

Interior

B00F - R0001 - External Movement - 45.31 m2

No Asbestos

B00F - R0002 - Practical Activities/Movement - 4hb - 67.85 m2

No Asbestos

B00F - R0003 - Home Base - M - 59.8 m2

No Asbestos

B00F - R0004 - Withdrawal - M - 12.78 m2

No Asbestos

B00F - R0005 - Disabled Shower/Toilet - 10.26 m2

No Asbestos

B00F - R0006 - Home Base Store - M - 20.29 m2

No Asbestos

B00F - R0007 - Toilet - M - 3.19 m2

No Asbestos

B00F - R0008 - Home Base - M - 59.7 m2

No Asbestos

B00F - R0009 - Toilets-Unisex - 10.2 m2

No Asbestos

B00F - R0010 - Withdrawal - M - 12.78 m2

No Asbestos

B00F - R0011 - External Movement - 39.01 m2

No Asbestos

B00F - R0012 - Home Base - M - 59.73 m2

No Asbestos

B00F - R0013 - Withdrawal - M - 12.7 m2

No Asbestos

B00F - R0014 - Toilets-Unisex - 10.26 m2

No Asbestos

B00F - R0015 - Home Base Store - M - 20.21 m2

No Asbestos

B00F - R0016 - Laundry - P - 3.19 m2

No Asbestos

B00F - R0017 - Home Base - M - 59.73 m2

No Asbestos

B00F - R0018 - Toilets-Unisex - 10.22 m2

No Asbestos

B00F - R0019 - Withdrawal - M - 12.75 m2

No Asbestos

B00F - R0020 - Communal Space - 334.66 m2

No Asbestos

B00F - R0021 - External Movement - 18.92 m2

No Asbestos

B00F - R0022 - External Movement - 19.1 m2

No Asbestos

B00F - R0023 - External Movement - 18.96 m2		
No Asbestos		
B00F - R0024 - External Movement - 18.87 m2		
No Asbestos		
B00F - R0025 - External Movement - 21.14 m2		
No Asbestos		
B00F - R0026 - External Movement - 21.41 m2		
No Asbestos		
B00G - General Learning - 2016 - Brick/Veneer		
Exterior		
Underfloor Voids	No Asbestos Found	
Ceiling Voids	No Asbestos Found	
Ceiling Voids	No Asbestos Found	
Underfloor Voids	No Asbestos Found	
Interior		
B00G - R0001 - External Movement - 53.26 m2		
No Asbestos		
B00G - R0002 - Practical Activities/Movement - 4hb - 84.18 m2		
No Asbestos		
B00G - R0003 - Home Base - M - 60.76 m2		
No Asbestos		
B00G - R0004 - Withdrawal - M - 11.51 m2		
No Asbestos		
B00G - R0005 - Home Base Store - M - 24.51 m2		
No Asbestos		
B00G - R0006 - Withdrawal - M - 11.51 m2		
No Asbestos		
B00G - R0007 - Home Base - M - 61.03 m2		
No Asbestos		
B00G - R0008 - Access Shower/Toilet - 18.24 m2		
No Asbestos		
B00G - R0009 - Toilet - Lobby - 6.84 m2		
No Asbestos		
B00G - R0010 - Disabled Toilet - 3.43 m2		
No Asbestos		
B00G - R0011 - Disabled Toilet - 2.17 m2		
No Asbestos		
B00G - R0012 - Laundry - Type 2 - 2.68 m2		
No Asbestos		
B00G - R0013 - Disabled Toilet - 2.3 m2		
No Asbestos		
B00G - R0014 - Cleaning Supplies - 2.92 m2		
No Asbestos		
B00G - R0015 - Staff Toilet - 4.3 m2		
No Asbestos		
B00G - R0016 - Home Base - M - 60.76 m2		
No Asbestos		
B00G - R0017 - Withdrawal - M - 11.49 m2		
No Asbestos		
B00G - R0018 - General Storeroom - 24.47 m2		
No Asbestos		

B00G-R0019 - Withdrawal - M - 11.49 m2	
No Asbestos	
B00G-R0020 - Home Base - M - 60.76 m2	
No Asbestos	
B00G-R0021 - Outdoor Learning Area - 14.45 m2	
No Asbestos	
B00G-R0022 - External Movement - 14.38 m2	
No Asbestos	
B00G-R0023 - External Movement - 14.5 m2	
No Asbestos	
B00G-R0024 - External Movement - 13.4 m2	
No Asbestos	
B00G-R0025 - External Movement - 27.29 m2	
No Asbestos	
B00G-R0026 - External Movement - 25.39 m2	
No Asbestos	
B00G-R0027 - External Movement - 16.31 m2	
No Asbestos	
B00G-R0028 - External Movement - 16.38 m2	
No Asbestos	

Demountables

There are no Demountable(s) Located at this school as per the AMS records as of 09-Sep-2020