

Asbestos Register

(Hazardous Materials and Risk Assessment)

School:	Ferncourt Public School (5114)
Region:	Sydney AMU
State Electorate:	Summer Hill
Local Government Area:	Inner West

Last Reviewed By:	Greencap 28-SEP-2015
Last Revised By:	

Historical Fibro In Grounds Investigations/Events	Yes
Please refer to the latest site specific Asbestos Management Plans available from the Department's website (Refer to Note 2).	

5114 - Ferncourt Public School
Site Plan (10377)

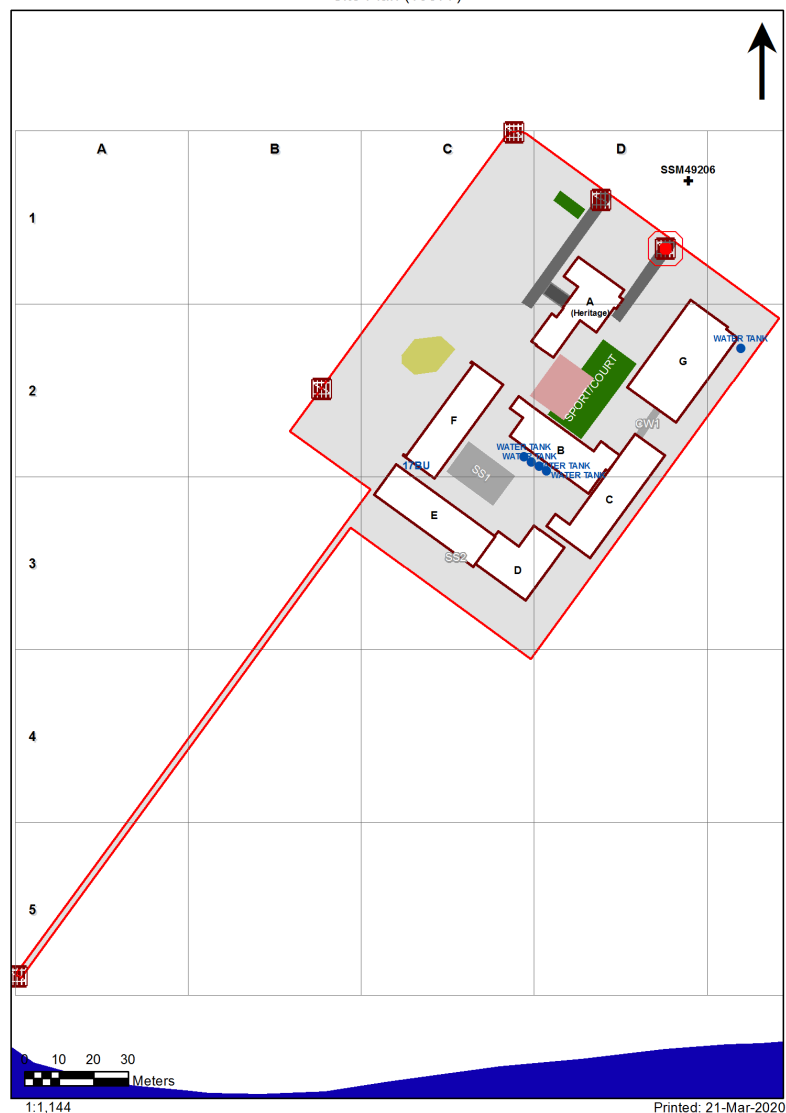

Preface to Asbestos Register

Limitations

Asbestos Registers established (first surveyed 2007/08) and maintained for the Department of Education (DoE) are limited in extent, in that:

1. All inspections and surveys of materials and finishes in DoE facilities are non-disturbance, with
2. Samples undertaken by hygienist to determine whether a sample is an Asbestos Containing Material (ACM),
3. The hygienist may apply a single sample to like materials within a space and adjoining spaces, but not normally between buildings,
4. Successive inspections have reduced any inconclusive records such as 'assumed asbestos' in difficult to access areas, by undertaking additional sampling with lifting devices.
5. In compliance with WHS Act 2011 and WHS Regulations 2017, additional inspections have been undertaken in ceiling spaces and sub-floor areas where access is possible.
 - o Where the ground floor is slab on ground, no inspection is made beneath the slab.
 - o Where fibro fragments (ACM taken for sampling) are located in ceiling spaces or sub floor voids air monitoring is normally undertaken at time of sampling, and clearance undertaken as soon as practicable.
6. No attempt has been made to identify any ACM that is hidden from view or encapsulated within
 - o Any wall cavity
 - o Sub floor area, particularly formwork for slabs in/on ground,
 - o Services (that may use ACM) such as: pipe lagging, asbestos cement pipes, flues.
7. All known ACM in Grounds (Fibro in Grounds) is made available in associated site specific asbestos management plans in DoE electronic files.
Notwithstanding information provided, ACM may be present in grounds from time to time and caution must be exercised prior to any grounds disturbance.

Use of the Asbestos Register

Prior to any disturbance works being undertaken in a building to which this asbestos register applies it will be necessary to confirm the extent of any ACM by a disturbance investigation:

- If the building was built prior to 2003
- If any ACM has been identified in the Asbestos Register for the building.

Update of Asbestos Registers

Asbestos Register Data is updated regularly by the DoE Hygienist Panel via the Online Asbestos Register Tool (Managed by Business Systems, School Infrastructure NSW). Internal users can view the latest edition of the Asbestos Register in the AMS.

Please note: The Department's external website may not contain the latest revision of the Asbestos Register.

Notes 1: Vermiculite

- During 2018/19, all vermiculite occurrences in DoE schools identified in 2007/08, were 'composite tested' in accordance with a safe work NSW agreed procedure. This required multiple testing of all vermiculite occurrences.
- During the period 2007/08 to 2018/19, some vermiculite has been over sheeted and a warning is indicated for schools where this has happened.

Note 2: DoE website link for information is here:

<https://www.schoolinfrastructure.nsw.gov.au/about-us/working-with-us/schools-asbestos-register.html>

<https://education.nsw.gov.au/about-us/strategies-and-reports/our-reports-and-reviews/schools-asbestos-register>

Note 3: Material Condition Assessment

The material condition assessment descriptors from Section 3 of the Asbestos Management Plan (AMP) is extracted below. Please read the AMP in its entirety for further information.

3.3.2.1 Material condition assessment

The OART records the material condition of identified ACM in the following format:

Rating	Description
Good condition (1)	For non-friable asbestos that is sealed and has no visible damage. This primarily related to asbestos cement (AC) sheet and vinyl tiles
Minimal damage (2)	For non-friable asbestos that has a very small amount of damage, eg hairline cracks.
Some damage / unsealed (3)	For non-friable asbestos with significant breakage or several small areas where material has been damaged, revealing loose asbestos fibres. Non-friable asbestos that is unsealed.
Poor condition (4)	For non-friable asbestos that has extensive damage. Visible asbestos debris
Friable asbestos (5)	Any occurrence of friable asbestos

Product	Material Description	Extent	Location	Material Condition	Risk Status	Remediation Priority	Result
B00A - Administration/Library - 1887 - Brick/Veneer							
Exterior							
Eaves Linings	Flat AC Sheeting	100m2	Throughout	Minimal Damage (2)	Low (1)	Low Priority (2-3)	Assumed Asbestos
Underfloor Voids	Non Accessible Area						
Ceiling Voids	Non Accessible Area						
Interior							
B00A - R0001 - Movement - 8.25 m2							
Ceiling Structures/Linings	Flat AC Sheeting	9m2	Throughout	Good Condition (1)	Low (1)	Low Priority (2-3)	Assumed Asbestos
B00A - R0002 - Clerical Office - 34.88 m2							
No Asbestos							
B00A - R0003 - Duplicating Workroom - 21.46 m2							
Floor Coverings Res/Textile	Vinyl Tiles	22m2	All surfaces	Good Condition (1)	Low (1)	Low Priority (2-3)	Chrysotile (white asbestos)
Floor Coverings Res/Textile	Vinyl Tiles - Adhesive						
B00A - R0004 - Duplicating Workroom - 14.48 m2							
Plant / Equipment - Boiler	Insulation Material	1	Suspected internal insulation	Friable Asbestos (5)	Low (1)	Low Priority (2-3)	Assumed Asbestos
Floor Coverings Res/Textile	Vinyl Tiles	15m2	All surfaces	Good Condition (1)	Low (1)	Low Priority (2-3)	Chrysotile (white asbestos)
Floor Coverings Res/Textile	Vinyl Tiles - Adhesive						
B00A - R0005 - Movement - 20.4 m2							
Ceiling Structures/Linings	Flat AC Sheeting	21m2	Throughout	Good Condition (1)	Low (1)	Low Priority (2-3)	Assumed Asbestos
B00A - R0006 - Staff Toilet - 7.76 m2							
Partition Walls (Cubicles)	Compressed AC Sheet	6m2	All surfaces	Good Condition (1)	Low (1)	Low Priority (2-3)	Chrysotile (white asbestos)
B00A - R0007 - Sick Bay - 7.92 m2							
No Asbestos							
B00A - R0008 - Canteen - 19.89 m2							
Floor Coverings Res/Textile	Vinyl Tiles	20m2	All surfaces	Good Condition (1)	Low (1)	Low Priority (2-3)	Chrysotile (white asbestos)
B00A - R0009 - Staff Toilet - 3.24 m2							
No Asbestos							
B00A - R0010 - Movement - 8.89 m2							
Floor Coverings Res/Textile	Vinyl Tiles	9m2	All surfaces	Good Condition (1)	Low (1)	Low Priority (2-3)	Chrysotile (white asbestos)
Floor Coverings Res/Textile	Vinyl Tiles - Adhesive						
B00A - R0011 - Movement - 17.06 m2							
No Asbestos							
B00A - R0012 - Movement - 8.13 m2							
Floor Coverings Res/Textile	Vinyl Tiles	9m2	All surfaces	Good Condition (1)	Low (1)	Low Priority (2-3)	Chrysotile (white asbestos)

Floor Coverings Res/Textile	Vinyl Tiles - Adhesive						
B00A - R0013 - Cleaning Distributed Store - .77 m2							
Ceiling Structures/Linings	Flat AC Sheeting	1m2	Throughout	Good Condition (1)	Low (1)	Low Priority (2-3)	Chrysotile (white asbestos), Amosite (brown asbestos)
B00A - R0014 - Movement - 16.34 m2							
Ceiling Structures/Linings	Flat AC Sheeting	16m2	Throughout	Good Condition (1)	Low (1)	Low Priority (2-3)	Assumed Asbestos
B00A - R0015 - Entry Vestibule - 17.86 m2							
No Asbestos							
B00A - R0016 - Principal - 18.48 m2							
No Asbestos							
B00A - R0017 - Movement - 4.89 m2							
Ceiling Structures/Linings	Flat AC Sheeting	5m2	Throughout	Good Condition (1)	Low (1)	Low Priority (2-3)	Assumed Asbestos
B00A - R0018 - Entry Vestibule - 6.01 m2							
No Asbestos							
B00A - R0019 - Stairs - 2.81 m2							
Require Inspection							
B00A - R0020 - Stairs - 1.54 m2							
Require Inspection							
B00A - R1003 - Library Office/Workroom - 16.56 m2							
No Asbestos							
B00A - R1004 - Distribution Board - 3.3 m2							
						Note: No inspection of live electrical installation	
Floor Coverings Res/Textile	Vinyl Tiles	4m2	All surfaces	Good Condition (1)	Low (1)	Low Priority (2-3)	Chrysotile (white asbestos)
B00A - R1005 - Reading Area - 36.81 m2							
No Asbestos							
B00A - R1007 - Movement - 7.34 m2							
Floor Coverings Res/Textile	Vinyl Tiles	8m2	All surfaces	Good Condition (1)	Low (1)	Low Priority (2-3)	Chrysotile (white asbestos)
Floor Coverings Res/Textile	Vinyl Tiles - Adhesive						
B00A - R1008 - Staff Toilet - 7.86 m2							
Partition Walls (Cubicles)	Compressed AC Sheet	8m2	All surfaces	Good Condition (1)	Low (1)	Low Priority (2-3)	Chrysotile (white asbestos)
B00A - R1009 - Staff Kitchen - 8.02 m2							
No Asbestos							
B00A - R1010 - Staff Room - 33.58 m2							
No Asbestos							
B00A - R1011 - Cleaning Distributed Store - .57 m2							
No Asbestos							
B00A - R1012 - Resource/Toy Space - 90.46 m2							
Require Inspection							
B00A - R1013 - Stairs - 3.89 m2							
Require Inspection							
B00A - R1014 - Stairs - 4.43 m2							
Require Inspection							
B00A - R1015 - Stairs - 2.96 m2							
Require Inspection							

B00B - General Learning/Pupil Facilities - 1972 - Brick/Block

Exterior

Gable Verge Lining	Flat AC Sheeting	20m2	East and West	Minimal Damage (2)	Low (1)	Low Priority (2-3)	Chrysotile (white asbestos)
Ceiling Voids	Non Accessible Area						
Underfloor Voids	Non Accessible Area						

Interior

B00B - R0001 - Cleaning Distributed Store - 9.52 m2

No Asbestos

B00B - R0002 - Drinking Facilities - 130.27 m2

Expansion Joint Resinous Membrane

B00B - R0003 - Home Base - 57.6 m2

Ceiling Structures/Linings	Vermiculite - Composite Sample - (40 - 70 m2) - (X5)						
Plant / Equipment - Thermacon Heater	Millboard	2	North and South	Friable Asbestos (5)	Low (1)	Low Priority (2-3)	Assumed Asbestos

B00B - R0004 - Home Base Store - 6.07 m2

Floor Coverings Res/Textile	Vinyl Tiles	7m2	All surfaces	Good Condition (1)	Low (1)	Low Priority (2-3)	Chrysotile (white asbestos)
Ceiling Structures/Linings	Vermiculite - Composite Sample - (< 10 m2) - (X2)						

B00B - R0005 - Personal Effects Storage - 7.46 m2

Ceiling Structures/Linings Vermiculite - Composite Sample - (< 10 m2) - (X2)

B00B - R0006 - Toilets - Girls - 36.09 m2

Partition Walls (Cubides)	Compressed AC Sheet	12m2	All surfaces	Good Condition (1)	Low (1)	Low Priority (2-3)	Chrysotile (white asbestos)
Ceiling Structures/Linings	Vermiculite - Composite Sample - (10 - 40 m2) - (X3)						

B00B - R0007 - Toilets - Boys - 35.34 m2

Ceiling Structures/Linings	Vermiculite - Composite Sample - (10 - 40 m2) - (X3)						
Partition Walls (Cubides)	Compressed AC Sheet	12m2	All surfaces	Good Condition (1)	Low (1)	Low Priority (2-3)	Chrysotile (white asbestos)

B00B - R0008 - Garden Store - 7.38 m2

Ceiling Structures/Linings Vermiculite - Composite Sample - (< 10 m2) - (X2)

B00B - R0009 - Cleaning Distributed Store - 12.41 m2

No Asbestos

B00B - R1001 - Movement - 62.1 m2

Ceiling Structures/Linings	Flat AC Sheeting	63m2	All surfaces	Good Condition (1)	Low (1)	Low Priority (2-3)	Chrysotile (white asbestos)
----------------------------	------------------	------	--------------	--------------------	---------	--------------------	-----------------------------

B00B - R1002 - Reading Area - 57.69 m2

Floor Coverings Res/Textile	Vinyl Sheet						
Floor Coverings Res/Textile	Vinyl Tiles - Adhesive						

B00B - R1003 - Home Base Store - 5.74 m2

Floor Coverings Res/Textile	Vinyl Sheet						
Floor Coverings Res/Textile	Vinyl Tiles - Adhesive						

B00B - R1004 - Distribution Board - .55 m2

Note: No inspection of live electrical installation

Electrical - Backing Board	Encapsulated Asbestos material within unit	1	South	Good Condition (1)	Low (1)	Low Priority (2-3)	Assumed Asbestos
Floor Coverings Res/Textile	Vinyl Sheet						
Floor Coverings Res/Textile	Vinyl Tiles - Adhesive						
B00B - R1005 - Personal Effects Storage - 13.68 m2							
Floor Coverings Res/Textile	Vinyl Sheet						
Floor Coverings Res/Textile	Vinyl Tiles - Adhesive						
B00B - R1006 - Home Base Store - 7.13 m2							
Floor Coverings Res/Textile	Vinyl Sheet						
Floor Coverings Res/Textile	Vinyl Tiles - Adhesive						
B00B - R1007 - Home Base - 56.44 m2							
Floor Coverings Res/Textile	Vinyl Sheet						
Floor Coverings Res/Textile	Vinyl Tiles - Adhesive						
B00B - R1008 - Home Base - 55.65 m2							
Floor Coverings Res/Textile	Vinyl Sheet						
Floor Coverings Res/Textile	Vinyl Tiles - Adhesive						
B00B - R1009 - Home Base Store - 6.78 m2							
Floor Coverings Res/Textile	Vinyl Sheet						
Floor Coverings Res/Textile	Vinyl Tiles - Adhesive						
B00B - R1010 - Personal Effects Storage - 6.57 m2							
No Asbestos							
B00C - General Learning/Other-After School Care - 1972 - Brick/Block							
Exterior							
Ceiling Voids	Non Accessible Area						
Gable Verge Lining	Flat AC Sheeting	20m2	North and South	Minimal Damage (2)	Low (1)	Low Priority (2-3)	Chrysotile (white asbestos)
Underfloor Voids	No Asbestos Found						
Interior							
B00C - R0001 - Home Base - 50.38 m2							
Ceiling Structures/Linings	Vermiculite - Composite Sample - (40 - 70 m2) - (X5)						
Floor Coverings Res/Textile	Vinyl Tiles (Under Floor Covering/Carpet)	51m2	Throughout	Good Condition (1)	Low (1)	Low Priority (2-3)	Chrysotile (white asbestos)
Floor Coverings Res/Textile	Vinyl Tiles - Adhesive						
B00C - R0002 - Practical Activities - 1hb - 19.55 m2							
Floor Coverings Res/Textile	Vinyl Tiles	20m2	All surfaces	Good Condition (1)	Low (1)	Low Priority (2-3)	Chrysotile (white asbestos)
Ceiling Structures/Linings	Vermiculite - Composite Sample - (10 - 40 m2) - (X3)						
Floor Coverings Res/Textile	Vinyl Tiles - Adhesive						
B00C - R0003 - Practical Activities - 1hb - 19.45 m2							

Ceiling Structures/Linings	Vermiculite - Composite Sample - (10 - 40 m2) - (X3)						
Floor Coverings Res/Textile	Vinyl Tiles - Adhesive						
Floor Coverings Res/Textile	Vinyl Tiles	20m2	All surfaces	Good Condition (1)	Low (1)	Low Priority (2-3)	Chrysotile (white asbestos)
B00C - R0004 - Home Base - 49.37 m2							
Floor Coverings Res/Textile	Vinyl Tiles - Adhesive						
Ceiling Structures/Linings	Vermiculite - Composite Sample - (40 - 70 m2) - (X5)						
Floor Coverings Res/Textile	Vinyl Tiles (Under Floor Covering/Carpet)	50m2	Throughout	Good Condition (1)	Low (1)	Low Priority (2-3)	Chrysotile (white asbestos)
B00C - R0005 - Home Base - 49.05 m2							
Floor Coverings Res/Textile	Vinyl Tiles - Adhesive						
Ceiling Structures/Linings	Vermiculite - Composite Sample - (40 - 70 m2) - (X5)						
Floor Coverings Res/Textile	Vinyl Tiles (Under Floor Covering/Carpet)	50m2	Throughout	Good Condition (1)	Low (1)	Low Priority (2-3)	Chrysotile (white asbestos)
B00C - R0006 - Practical Activities - 1hb - 19.61 m2							
Floor Coverings Res/Textile	Vinyl Tiles	20m2	All surfaces	Good Condition (1)	Low (1)	Low Priority (2-3)	Chrysotile (white asbestos)
Ceiling Structures/Linings	Vermiculite - Composite Sample - (10 - 40 m2) - (X3)						
Floor Coverings Res/Textile	Vinyl Tiles - Adhesive						
B00C - R0007 - Practical Activities - 1hb - 19.81 m2							
Floor Coverings Res/Textile	Vinyl Tiles	20m2	All surfaces	Good Condition (1)	Low (1)	Low Priority (2-3)	Chrysotile (white asbestos)
Ceiling Structures/Linings	Vermiculite - Composite Sample - (10 - 40 m2) - (X3)						
Floor Coverings Res/Textile	Vinyl Tiles - Adhesive						
B00C - R0008 - Home Base - 50.36 m2							
Ceiling Structures/Linings	Vermiculite - Composite Sample - (40 - 70 m2) - (X5)						
Floor Coverings Res/Textile	Vinyl Tiles (Under Floor Covering/Carpet)	51m2	Throughout	Good Condition (1)	Low (1)	Low Priority (2-3)	Chrysotile (white asbestos)
Floor Coverings Res/Textile	Vinyl Tiles - Adhesive						
B00C - R0009 - Movement - 58.68 m2							
No Asbestos							
B00C - R1001 - Home Base - 50.38 m2							
Floor Coverings Res/Textile	Vinyl Tiles - Adhesive						
Floor Coverings Res/Textile	Vinyl Tiles (Under Floor Covering/Carpet)	51m2	Throughout	Good Condition (1)	Low (1)	Low Priority (2-3)	Chrysotile (white asbestos)
B00C - R1002 - Practical Activities - 1hb - 19.52 m2							
Floor Coverings Res/Textile	Vinyl Tiles	20m2	All surfaces	Good Condition (1)	Low (1)	Low Priority (2-3)	Chrysotile (white asbestos)

Floor Coverings Res/Textile	Vinyl Tiles - Adhesive							
B00C - R1003 - Practical Activities - 1hb - 19.63 m2								
No Asbestos								
B00C - R1004 - Home Base - 49.44 m2								
Floor Coverings Res/Textile	Vinyl Tiles - Adhesive							
Floor Coverings Res/Textile	Vinyl Tiles (Under Floor Covering/Carpet)	50m2	Throughout	Good Condition (1)	Low (1)	Low Priority (2-3)	Chrysotile (white asbestos)	
B00C - R1005 - Home Base - 49.28 m2								
Floor Coverings Res/Textile	Vinyl Tiles - Adhesive							
Floor Coverings Res/Textile	Vinyl Tiles (Under Floor Covering/Carpet)	50m2	Throughout	Good Condition (1)	Low (1)	Low Priority (2-3)	Chrysotile (white asbestos)	
B00C - R1006 - Practical Activities - 1hb - 19.55 m2								
No Asbestos								
B00C - R1007 - Practical Activities - 1hb - 19.56 m2								
Floor Coverings Res/Textile	Vinyl Tiles (Under Floor Covering/Carpet)	20m2	All surfaces	Good Condition (1)	Low (1)	Low Priority (2-3)	Chrysotile (white asbestos)	
Floor Coverings Res/Textile	Vinyl Tiles - Adhesive							
B00C - R1008 - Home Base - 50.3 m2								
Floor Coverings Res/Textile	Vinyl Tiles - Adhesive							
Floor Coverings Res/Textile	Vinyl Tiles (Under Floor Covering/Carpet)	51m2	Throughout	Good Condition (1)	Low (1)	Low Priority (2-3)	Chrysotile (white asbestos)	
B00C - R1009 - Movement - 70.58 m2								
Ceiling Structures/Linings	Flat AC Sheeting							
B00C - R9001 - Out Of School Hours Care Centre - 70.33 m2								
Floor Coverings Res/Textile	Vinyl Tiles (Under Floor Covering/Carpet)	70m2	Throughout	Good Condition (1)	Low (1)	Low Priority (2-3)	Chrysotile (white asbestos)	
Ceiling Structures/Linings	Vermiculite - Composite Sample - (70 - 120 m2) - (X8)							
Floor Coverings Res/Textile	Vinyl Tiles - Adhesive							
B00C - R9002 - Movement - 16.57 m2								
No Asbestos								
B00C - R9003 - General Storeroom - 4.72 m2								
No Asbestos								
B00C - R9004 - Distribution Board - 1.92 m2								
Note: No inspection of live electrical installation								
Electrical - Backing Board	Encapsulated Asbestos material within unit	1	East	Good Condition (1)	Medium (2)	Low Priority (2-3)	Assumed Asbestos	
B00D - General Learning - 1972 - Brick/Block								
Exterior								
Ceiling Voids	Non Accessible Area							
Underfloor Voids	Non Accessible Area							
Gable Verge Lining	Flat AC Sheeting	20m2	Throughout	Minimal Damage (2)	Low (1)	Low Priority (2-3)	Chrysotile (white asbestos)	
Interior								
B00D - R0001 - Home Base - 56.5 m2								

Floor Coverings Res/Textile	Vinyl Tiles (Under Floor Covering/Carpet)	57m2	All surfaces	Good Condition (1)	Low (1)	Low Priority (2-3)	Chrysotile (white asbestos)
Floor Coverings Res/Textile	Vinyl Tiles - Adhesive	57m2	Throughout	Good Condition (1)	Low (1)	Low Priority (2-3)	Chrysotile (white asbestos)
Plant / Equipment - Thermacon Heater	Millboard	2	East and West	Friable Asbestos (5)	Low (1)	Low Priority (2-3)	Assumed Asbestos
B00D - R0002 - Home Base Store - 6.18 m2							
Floor Coverings Res/Textile	Vinyl Tiles	7m2	All surfaces	Good Condition (1)	Low (1)	Low Priority (2-3)	Chrysotile (white asbestos)
Floor Coverings Res/Textile	Vinyl Tiles - Adhesive	7m2	Throughout	Good Condition (1)	Low (1)	Low Priority (2-3)	Chrysotile (white asbestos)
B00D - R0003 - Distribution Board - .52 m2							
Note: No inspection of live electrical installation							
Floor Coverings Res/Textile	Vinyl Tiles	1m2	All surfaces	Good Condition (1)	Low (1)	Low Priority (2-3)	Chrysotile (white asbestos)
Floor Coverings Res/Textile	Vinyl Tiles - Adhesive	1m2	Throughout	Good Condition (1)	Low (1)	Low Priority (2-3)	Chrysotile (white asbestos)
Electrical - Backing Board	Encapsulated Asbestos material within unit	1	East	Good Condition (1)	Medium (2)	Low Priority (2-3)	Assumed Asbestos
B00D - R0004 - Personal Effects Storage - 13.82 m2							
Floor Coverings Res/Textile	Vinyl Tiles	14m2	All surfaces	Good Condition (1)	Low (1)	Low Priority (2-3)	Chrysotile (white asbestos)
Floor Coverings Res/Textile	Vinyl Tiles - Adhesive	14m2	Throughout	Good Condition (1)	Low (1)	Low Priority (2-3)	Chrysotile (white asbestos)
B00D - R0005 - Home Base Store - 6.75 m2							
Floor Coverings Res/Textile	Vinyl Tiles	7m2	All surfaces	Good Condition (1)	Low (1)	Low Priority (2-3)	Chrysotile (white asbestos)
Floor Coverings Res/Textile	Vinyl Tiles - Adhesive	7m2	Throughout	Good Condition (1)	Low (1)	Low Priority (2-3)	Chrysotile (white asbestos)
B00D - R0006 - Home Base - 56.82 m2							
Plant / Equipment - Thermacon Heater	Millboard	2	North and South	Friable Asbestos (5)	Low (1)	Low Priority (2-3)	Assumed Asbestos
Floor Coverings Res/Textile	Vinyl Tiles (Under Floor Covering/Carpet)	57m2	All surfaces	Good Condition (1)	Low (1)	Low Priority (2-3)	Chrysotile (white asbestos)
Floor Coverings Res/Textile	Vinyl Tiles - Adhesive	57m2	Throughout	Good Condition (1)	Low (1)	Low Priority (2-3)	Chrysotile (white asbestos)
B00D - R0007 - Movement - 119.12 m2							
No Asbestos							
B00D - R1001 - Cleaning Distributed Store - 6.76 m2							
No Asbestos							
B00D - R1002 - Craft Store - 25.66 m2							
Floor Coverings Res/Textile	Vinyl Tiles						
Floor Coverings Res/Textile	Vinyl Sheet						
Floor Coverings Res/Textile	Vinyl Tiles - Adhesive						

B00D - R1003 - Personal Effects Storage - 8.63 m2							
Floor Coverings Res/Textile	Vinyl Sheet						
Floor Coverings Res/Textile	Vinyl Tiles - Adhesive						
B00D - R1004 - Toilets - Boys/Girls - 3.33 m2							
No Asbestos							
B00D - R1005 - Home Base Store - 5.2 m2							
Floor Coverings Res/Textile	Vinyl Tiles						
Floor Coverings Res/Textile	Vinyl Tiles - Adhesive						
B00D - R1006 - Home Base - 90.7 m2							
Floor Coverings Res/Textile	Vinyl Tiles						
Plant / Equipment - Thermacon Heater	Millboard	4	North, South, East and West	Friable Asbestos (5)	Low (1)	Low Priority (2-3)	Assumed Asbestos
B00D - R1007 - Movement - 110.1 m2							
Ceiling Structures/Linings	Flat AC Sheeting	40m2	All surfaces	Good Condition (1)	Low (1)	Low Priority (2-3)	Chrysotile (white asbestos)
B00E - General Learning - 1972 - Brick/Block							
Exterior							
Eaves Linings	Flat AC Sheeting	25m2	South	Good Condition (1)	Low (1)	Low Priority (2-3)	Assumed Asbestos
Wall Cladding	Flat AC Sheeting	28m2	Panels below Windows	Good Condition (1)	Low (1)	Low Priority (2-3)	Chrysotile (white asbestos)
Ceiling Voids	Non Accessible Area						
Underfloor Voids	No Asbestos Found						
Gable Verge Lining	Insulation Material	30m2	East and West	Minimal Damage (2)	Low (1)	Low Priority (2-3)	Chrysotile (white asbestos)
Interior							
B00E - R0001 - Movement - 71.61 m2							
Wall Linings Internal	Flat AC Sheeting	12m2	Panels below Windows	Good Condition (1)	Low (1)	Low Priority (2-3)	Chrysotile (white asbestos)
Expansion Joint	Resinous Membrane						
B00E - R0002 - P.E Store - 16.05 m2							
No Asbestos							
B00E - R0003 - P.E Store - 7.15 m2							
No Asbestos							
B00E - R0004 - Personal Effects Storage - 6.57 m2							
Ceiling Structures/Linings	Vermiculite - Composite Sample - (< 10 m2) - (X2)						
Floor Coverings Res/Textile	Vinyl Sheet						
Floor Coverings Res/Textile	Vinyl Tiles - Adhesive						
B00E - R0005 - Movement - 3.12 m2							
Ceiling Structures/Linings	Vermiculite - Composite Sample - (< 10 m2) - (X2)						
Floor Coverings Res/Textile	Vinyl Tiles - Adhesive						
Floor Coverings Res/Textile	Vinyl Sheet						

B00E - R0006 - Toilets - Boys/Girls - 3.4 m2							
Ceiling Structures/Linings	Vermiculite - Composite Sample - (< 10 m2) - (X2)						
B00E - R0007 - Home Base - 100.55 m2							
Ceiling Structures/Linings	Vermiculite - Composite Sample - (70 - 120 m2) - (X8)						
Plant / Equipment - Thermacon Heater	Millboard	1	West	Friable Asbestos (5)	Low (1)	Low Priority (2-3)	Assumed Asbestos
Floor Coverings Res/Textile	Vinyl Sheet						
Floor Coverings Res/Textile	Vinyl Tiles - Adhesive						
B00E - R0008 - Home Base - 85.76 m2							
Ceiling Structures/Linings	Vermiculite - Composite Sample - (70 - 120 m2) - (X8)						
Plant / Equipment - Thermacon Heater	Millboard	3	North, East & West	Friable Asbestos (5)	Low (1)	Low Priority (2-3)	Assumed Asbestos
Floor Coverings Res/Textile	Vinyl Sheet						
Floor Coverings Res/Textile	Vinyl Tiles - Adhesive						
B00E - R0009 - Home Base Store - 4.2 m2							
Ceiling Structures/Linings	Vermiculite - Composite Sample - (< 10 m2) - (X2)						
B00E - R0010 - General Storeroom - 3.13 m2							
Ceiling Structures/Linings	Vermiculite - Composite Sample - (< 10 m2) - (X2)						
Floor Coverings Res/Textile	Vinyl Tiles - Adhesive						
Floor Coverings Res/Textile	Vinyl Sheet						
B00E - R0011 - Personal Effects Storage - 6.57 m2							
Ceiling Structures/Linings	Vermiculite - Composite Sample - (< 10 m2) - (X2)						
Floor Coverings Res/Textile	Vinyl Sheet						
Floor Coverings Res/Textile	Vinyl Tiles - Adhesive						
B00E - R0012 - P.E. Store - 16.02 m2							
No Asbestos							
B00E - R0013 - Cleaning Distributed Store - 5.8 m2							
Non Accessible							
B00E - R0014 - Distribution Board - 1.06 m2							
Note: No inspection of live electrical installation							
Electrical - Backing Board	Encapsulated Asbestos material within unit	1	South	Good Condition (1)	Medium (2)	Low Priority (2-3)	Assumed Asbestos
B00E - R1001 - Movement - 77.07 m2							
Ceiling Structures/Linings	Flat AC Sheeting	78m2	All surfaces	Good Condition (1)	Low (1)	Low Priority (2-3)	Chrysotile (white asbestos)
Wall Linings Internal	Flat AC Sheeting	12m2	Panels below Windows	Good Condition (1)	Low (1)	Low Priority (2-3)	Chrysotile (white asbestos)
Expansion Joint	Resinous Membrane						
B00E - R1002 - Movement - 7.79 m2							
No Asbestos							
B00E - R1003 - Security Store - 7.13 m2							

No Asbestos							
B00E - R1004 - Home Base - 56.88 m2							
Floor Coverings Res/Textile	Vinyl Sheet						
Floor Coverings Res/Textile	Vinyl Tiles - Adhesive						
B00E - R1005 - Home Base Store - 6.82 m2							
Floor Coverings Res/Textile	Vinyl Tiles - Adhesive						
Floor Coverings Res/Textile	Vinyl Sheet						
B00E - R1006 - Personal Effects Storage - 13.85 m2							
Floor Coverings Res/Textile	Vinyl Tiles - Adhesive						
Floor Coverings Res/Textile	Vinyl Sheet						
B00E - R1007 - Home Base Store - 6.66 m2							
Floor Coverings Res/Textile	Vinyl Tiles - Adhesive						
Floor Coverings Res/Textile	Vinyl Sheet						
B00E - R1008 - Home Base - 57.11 m2							
Floor Coverings Res/Textile	Vinyl Sheet						
Floor Coverings Res/Textile	Vinyl Tiles - Adhesive						
Plant / Equipment - Thermacon Heater	Millboard	1	West	Friable Asbestos (5)	Low (1)	Low Priority (2-3)	Assumed Asbestos
B00E - R1009 - Home Base - 57.12 m2							
Plant / Equipment - Thermacon Heater	Millboard	1	West	Friable Asbestos (5)	Low (1)	Low Priority (2-3)	Assumed Asbestos
Floor Coverings Res/Textile	Vinyl Sheet						
Floor Coverings Res/Textile	Vinyl Tiles - Adhesive						
B00E - R1010 - Home Base Store - 6.77 m2							
Floor Coverings Res/Textile	Vinyl Tiles - Adhesive						
Floor Coverings Res/Textile	Vinyl Sheet						
B00E - R1011 - Personal Effects Storage - 6.75 m2							
Floor Coverings Res/Textile	Vinyl Sheet						
Floor Coverings Res/Textile	Vinyl Tiles - Adhesive						
B00E - R1012 - Cleaning Distributed Store - 5.8 m2							
No Asbestos							
B00E - R1013 - Distribution Board - 1.06 m2							
Note: No inspection of live electrical installation							
Electrical - Backing Board	Encapsulated Asbestos material within unit	1	West	Good Condition (1)	Medium (2)	Low Priority (2-3)	Assumed Asbestos
Ceiling Structures/Linings	Flat AC Sheeting	2m2	Throughout	Good Condition (1)	Low (1)	Low Priority (2-3)	Chrysotile (white asbestos)
B00E - R1014 - Movement - 7.97 m2							
No Asbestos							
B00E - R9001 - General Storeroom - 28.01 m2							

No Asbestos							
B00E - R9002 - General Storeroom - 28.25 m2							
No Asbestos							
B00F - General Learning/Support Unit - 1966 - Brick/Veneer							
Exterior							
External Wall Structure - Awnings	Flat AC Sheeting	20	West	Good Condition (1)	Low (1)	Low Priority (2-3)	Chrysotile (white asbestos)
Underfloor Voids	Non Accessible Area						
Ceiling Voids	Non Accessible Area						
Gable Verge Lining	Flat AC Sheeting	20m2	North and South	Minimal Damage (2)	Low (1)	Low Priority (2-3)	Chrysotile (white asbestos)
Interior							
B00F - R0001 - Movement - 67.35 m2							
Wall Linings Internal	Flat AC Sheeting	10m2	Infill panels above windows	Good Condition (1)	Low (1)	Low Priority (2-3)	Chrysotile (white asbestos)
Ceiling Structures/Linings	Flat AC Sheeting	68m2	All surfaces	Good Condition (1)	Low (1)	Low Priority (2-3)	Chrysotile (white asbestos)
B00F - R0002 - Deputy Principal - 21.15 m2							
Floor Coverings Res/Textile	Vinyl Tiles (Under Floor Covering/Carpet)	22m2	Throughout	Good Condition (1)	Low (1)	Low Priority (2-3)	Chrysotile (white asbestos)
Floor Coverings Res/Textile	Vinyl Tiles - Adhesive						
Plant / Equipment - Thermacon Heater	Millboard	1	East	Friable Asbestos (5)	Low (1)	Low Priority (2-3)	Assumed Asbestos
B00F - R0003 - Interview - 18.28 m2							
Floor Coverings Res/Textile	Vinyl Tiles (Under Floor Covering/Carpet)	19m2	Throughout	Good Condition (1)	Low (1)	Low Priority (2-3)	Chrysotile (white asbestos)
Floor Coverings Res/Textile	Vinyl Tiles - Adhesive						
Plant / Equipment - Thermacon Heater	Millboard	1	South	Friable Asbestos (5)	Low (1)	Low Priority (2-3)	Assumed Asbestos
B00F - R0004 - Movement - 14.44 m2							
Floor Coverings Res/Textile	Vinyl Tiles (Under Floor Covering/Carpet)	15m2	Throughout	Good Condition (1)	Low (1)	Low Priority (2-3)	Chrysotile (white asbestos)
Floor Coverings Res/Textile	Vinyl Tiles - Adhesive						
B00F - R0005 - Distribution Board - .85 m2							
Note: No inspection of live electrical installation							
Wall Linings Internal	Flat AC Sheeting	8m2	All surfaces	Minimal Damage (2)	Low (1)	Low Priority (2-3)	Chrysotile (white asbestos)
Electrical - Backing Board	Encapsulated Asbestos material within unit	1	West	Good Condition (1)	Low (1)	Low Priority (2-3)	Assumed Asbestos
Ceiling Structures/Linings	Flat AC Sheeting	1m2	Throughout	Good Condition (1)	Low (1)	Low Priority (2-3)	Chrysotile (white asbestos)
Floor Coverings Res/Textile	Vinyl Tiles	1m2	All surfaces	Minimal Damage (2)	Low (1)	Low Priority (2-3)	Chrysotile (white asbestos)
Floor Coverings Res/Textile	Vinyl Tiles - Adhesive						
B00F - R0006 - Cleaning Distributed Store - 4.32 m2							

Floor Coverings Res/Textile	Vinyl Tiles	5m2	Throughout	Good Condition (1)	Low (1)	Low Priority (2-3)	Chrysotile (white asbestos)
Floor Coverings Res/Textile	Vinyl Tiles - Adhesive						
B00F - R0007 - Movement - 2.95 m2							
Floor Coverings Res/Textile	Vinyl Tiles - Adhesive						
Floor Coverings Res/Textile	Vinyl Tiles (Under Floor Covering/Carpet)	3m2	Throughout	Good Condition (1)	Low (1)	Low Priority (2-3)	Chrysotile (white asbestos)
B00F - R0008 - Staff Toilet - 3.31 m2							
Plant / Equipment - Incinerator	Insulation Material	1	Suspected internal insulation	Friable Asbestos (5)	Low (1)	Low Priority (2-3)	Assumed Asbestos
B00F - R0009 - General Storeroom - 7.78 m2							
Floor Coverings Res/Textile	Vinyl Tiles	8m2	Throughout	Good Condition (1)	Low (1)	Low Priority (2-3)	Chrysotile (white asbestos)
Floor Coverings Res/Textile	Vinyl Tiles - Adhesive						
B00F - R0010 - General Storeroom - .6 m2							
No Asbestos							
B00F - R0011 - Clerical Office/Workroom - 16.68 m2							
Floor Coverings Res/Textile	Vinyl Tiles (Under Floor Covering/Carpet)	17m2	Throughout	Good Condition (1)	Low (1)	Low Priority (2-3)	Chrysotile (white asbestos)
Floor Coverings Res/Textile	Vinyl Tiles - Adhesive						
Plant / Equipment - Thermocon Heater	Millboard	1	East	Friable Asbestos (5)	Low (1)	Low Priority (2-3)	Assumed Asbestos
B00F - R0012 - Personal Effects Storage - 6.51 m2							
Floor Coverings Res/Textile	Vinyl Tiles	7m2	Throughout	Good Condition (1)	Low (1)	Low Priority (2-3)	Chrysotile (white asbestos)
Floor Coverings Res/Textile	Vinyl Tiles - Adhesive						
B00F - R0013 - Home Base - 56.9 m2							
Floor Coverings Res/Textile	Vinyl Tiles (Under Floor Covering/Carpet)	57m2	Throughout	Good Condition (1)	Low (1)	Low Priority (2-3)	Chrysotile (white asbestos)
Floor Coverings Res/Textile	Vinyl Tiles - Adhesive						
Plant / Equipment - Thermocon Heater	Millboard	2	North and South	Friable Asbestos (5)	Low (1)	Low Priority (2-3)	Assumed Asbestos
B00F - R0014 - Home Base Store - 6.73 m2							
Floor Coverings Res/Textile	Vinyl Tiles	7m2	Throughout	Good Condition (1)	Low (1)	Low Priority (2-3)	Chrysotile (white asbestos)
Floor Coverings Res/Textile	Vinyl Tiles - Adhesive						
B00F - R0015 - Toilets - Girls - 42.2 m2							
Partition Walls (Cubicles)	Compressed AC Sheet	10m2	Variable positions	Good Condition (1)	Low (1)	Low Priority (2-3)	Chrysotile (white asbestos)
Ceiling Structures/Linings	Flat AC Sheeting	43m2	Throughout	Good Condition (1)	Low (1)	Low Priority (2-3)	Chrysotile (white asbestos)
B00F - R0016 - Toilets - Boys - 41.13 m2							

Partition Walls (Cubicles)	Compressed AC Sheet	10m2	Variable positions	Good Condition (1)	Low (1)	Low Priority (2-3)	Chrysotile (white asbestos)
Ceiling Structures/Linings	Flat AC Sheeting	42m2	Throughout	Good Condition (1)	Low (1)	Low Priority (2-3)	Chrysotile (white asbestos)

B00G - Pupil Facilities/Communal Facilities - 2010 - Brick/Veneer

Exterior

No Asbestos

Interior

B00G - R0001 - Communal Space - 161.34 m2

No Asbestos

B00G - R0002 - Raised Platform - 50.59 m2

No Asbestos

B00G - R0003 - Hall Chair Store - 9.25 m2

No Asbestos

B00G - R0004 - Communal/Performance Store - 9.25 m2

No Asbestos

B00G - R0005 - P.E Store - 12.19 m2

No Asbestos

B00G - R0006 - Toilet - Lobby - 2.36 m2

No Asbestos

B00G - R0007 - Toilets - Girls - 7.38 m2

No Asbestos

B00G - R0008 - Sound Cupboard - 2.05 m2

No Asbestos

B00G - R0009 - Toilets - Boys - 5.76 m2

No Asbestos

B00G - R0010 - Toilet - Lobby - 3.35 m2

No Asbestos

B00G - R0011 - Plant - 1.57 m2

No Asbestos

B00G - R0012 - Cleaning Distributed Store - 3.02 m2

No Asbestos

B00G - R0013 - Access Shower/Toilet/Change - 6.7 m2

No Asbestos

B00G - R0014 - Main Switch Board - 3.67 m2

No Asbestos

B00G - R0015 - Covered Outdoor Learning Area - 161.59 m2

No Asbestos

B00G - R0016 - Canteen - 26.54 m2

No Asbestos

B00G - R0017 - Canteen Office/Store - 9.21 m2

No Asbestos

B00G - R0018 - Plant - .3 m2

No Asbestos

B00G - R0019 - Movement - 4.86 m2

No Asbestos

B00G - R0020 - Movement - 11.2 m2

No Asbestos

B00G - R0021 - Movement - 11.59 m2

No Asbestos

Demountables

There are no Demountable(s) Located at this school as per the AMS records as of 09-Sep-2020