

Asbestos Register

(Hazardous Materials and Risk Assessment)

School:	Finley Public School (3945)
Region:	Southern NSW AMU
State Electorate:	Murray
Local Government Area:	Berrigan

Last Reviewed By:	WSP 28-FEB-2017
Last Revised By:	

Historical Fibro In Grounds Investigations/Events	No
<p>No previous investigations have been recorded against the school. However, asbestos containing materials maybe present in grounds from time to time and caution must be exercised prior to any grounds disturbance.</p>	

3945 - Finley Public School
Site Plan (12983)

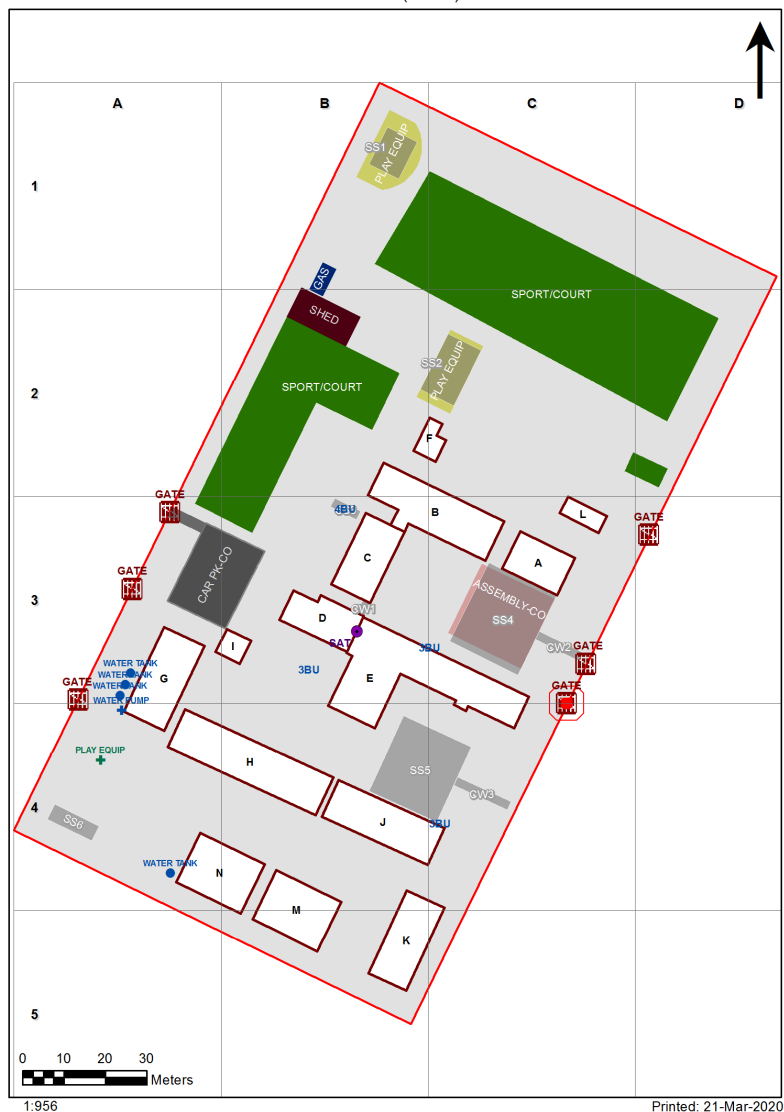

1:956

Printed: 21-Mar-2020

Preface to Asbestos Register

Limitations

Asbestos Registers established (first surveyed 2007/08) and maintained for the Department of Education (DoE) are limited in extent, in that:

1. All inspections and surveys of materials and finishes in DoE facilities are non-disturbance, with
2. Samples undertaken by hygienist to determine whether a sample is an Asbestos Containing Material (ACM),
3. The hygienist may apply a single sample to like materials within a space and adjoining spaces, but not normally between buildings,
4. Successive inspections have reduced any inconclusive records such as 'assumed asbestos' in difficult to access areas, by undertaking additional sampling with lifting devices.
5. In compliance with WHS Act 2011 and WHS Regulations 2017, additional inspections have been undertaken in ceiling spaces and sub-floor areas where access is possible.
 - o Where the ground floor is slab on ground, no inspection is made beneath the slab.
 - o Where fibro fragments (ACM taken for sampling) are located in ceiling spaces or sub floor voids air monitoring is normally undertaken at time of sampling, and clearance undertaken as soon as practicable.
6. No attempt has been made to identify any ACM that is hidden from view or encapsulated within
 - o Any wall cavity
 - o Sub floor area, particularly formwork for slabs in/on ground,
 - o Services (that may use ACM) such as: pipe lagging, asbestos cement pipes, flues.
7. All known ACM in Grounds (Fibro in Grounds) is made available in associated site specific asbestos management plans in DoE electronic files.
Notwithstanding information provided, ACM may be present in grounds from time to time and caution must be exercised prior to any grounds disturbance.

Use of the Asbestos Register

Prior to any disturbance works being undertaken in a building to which this asbestos register applies it will be necessary to confirm the extent of any ACM by a disturbance investigation:

- If the building was built prior to 2003
- If any ACM has been identified in the Asbestos Register for the building.

Update of Asbestos Registers

Asbestos Register Data is updated regularly by the DoE Hygienist Panel via the Online Asbestos Register Tool (Managed by Business Systems, School Infrastructure NSW). Internal users can view the latest edition of the Asbestos Register in the AMS.

Please note: The Department's external website may not contain the latest revision of the Asbestos Register.

Notes 1: Vermiculite

- During 2018/19, all vermiculite occurrences in DoE schools identified in 2007/08, were 'composite tested' in accordance with a safe work NSW agreed procedure. This required multiple testing of all vermiculite occurrences.
- During the period 2007/08 to 2018/19, some vermiculite has been over sheeted and a warning is indicated for schools where this has happened.

Note 2: DoE website link for information is here:

<https://www.schoolinfrastructure.nsw.gov.au/about-us/working-with-us/schools-asbestos-register.html>
<https://education.nsw.gov.au/about-us/strategies-and-reports/our-reports-and-reviews/schools-asbestos-register>

Note 3: Material Condition Assessment

The material condition assessment descriptors from Section 3 of the Asbestos Management Plan (AMP) is extracted below. Please read the AMP in its entirety for further information.

3.3.2.1 Material condition assessment

The OART records the material condition of identified ACM in the following format:

Rating	Description
Good condition (1)	For non-friable asbestos that is sealed and has no visible damage. This primarily related to asbestos cement (AC) sheet and vinyl tiles
Minimal damage (2)	For non-friable asbestos that has a very small amount of damage, eg hairline cracks.
Some damage / unsealed (3)	For non-friable asbestos with significant breakage or several small areas where material has been damaged, revealing loose asbestos fibres. Non-friable asbestos that is unsealed.
Poor condition (4)	For non-friable asbestos that has extensive damage. Visible asbestos debris
Friable asbestos (5)	Any occurrence of friable asbestos

Product	Material Description	Extent	Location	Material Condition	Risk Status	Remediation Priority	Result
B00A - General Learning - 1966 - Timber							
Exterior							
Ceiling Voids - Flat Roof	No Asbestos Found						
Underfloor Voids	No Asbestos Found						
Eaves Linings	Flat AC Sheeting	12m2	North facing, South facing	Good Condition (1)	Low (1)	Low Priority (2-3)	Chrysotile (white asbestos) , Amosite (brown asbestos)
Interior							
B00A - R0001 - Home Base - 52.34 m2							
Ceiling Structures/Linings	Flat AC Sheeting	53m2	All surfaces	Good Condition (1)	Low (1)	Low Priority (2-3)	Chrysotile (white asbestos) , Amosite (brown asbestos)
Wall Linings Internal	Flat AC Sheeting	45m2	All surfaces, Upper portion	Minimal Damage (2)	Low (1)	Low Priority (2-3)	Chrysotile (white asbestos) , Amosite (brown asbestos)
B00A - R0002 - Movement - 27.07 m2							
Ceiling Structures/Linings	Flat AC Sheeting	28m2	All surfaces	Good Condition (1)	Low (1)	Low Priority (2-3)	Chrysotile (white asbestos) , Amosite (brown asbestos)
Wall Linings Internal	Flat AC Sheeting	3m2	East facing, Upper portion	Minimal Damage (2)	Low (1)	Low Priority (2-3)	Chrysotile (white asbestos) , Amosite (brown asbestos)
B00A - R0003 - Home Base - 52.34 m2							
Wall Linings Internal	Flat AC Sheeting	45m2	All surfaces, Upper portion	Minimal Damage (2)	Low (1)	Low Priority (2-3)	Chrysotile (white asbestos) , Amosite (brown asbestos)
Ceiling Structures/Linings	Flat AC Sheeting	53m2	All surfaces	Good Condition (1)	Low (1)	Low Priority (2-3)	Chrysotile (white asbestos) , Amosite (brown asbestos)
B00A - R0004 - General Storeroom - 5.48 m2							
Ceiling Structures/Linings	Flat AC Sheeting	6m2	All surfaces	Minimal Damage (2)	Low (1)	Low Priority (2-3)	Chrysotile (white asbestos) , Amosite (brown asbestos)
Wall Linings Internal	Flat AC Sheeting	10m2	South facing, East facing, West facing	Minimal Damage (2)	Low (1)	Low Priority (2-3)	Chrysotile (white asbestos) , Amosite (brown asbestos)
B00B - General Learning - 1966 - Brick/Block							
Exterior							
Ceiling Voids - Flat Roof	No Asbestos Found						
Underfloor Voids	No Asbestos Found						
Eaves Linings	Flat AC Sheeting	15m2	North facing	Good Condition (1)	Low (1)	Low Priority (2-3)	Chrysotile (white asbestos)
Gable Ends	Non Accessible Area						
Underfloor Voids	Non Accessible Area						
Wall Linings Internal - Infill	No Asbestos Found						
Gable Verge Lining	No Asbestos Found						
Interior							
B00B - R0001 - Home Base - 73.79 m2							
No Asbestos							
B00B - R0002 - Movement - 63.27 m2							
Ceiling Structures/Linings	Flat AC Sheeting	64m2	All surfaces	Good Condition (1)	Low (1)	Low Priority (2-3)	Chrysotile (white asbestos)
B00B - R0003 - Toilets - Girls - 22.7 m2							
Ceiling Structures/Linings	Flat AC Sheeting	23m2	All surfaces	Good Condition (1)	Low (1)	Low Priority (2-3)	Chrysotile (white asbestos)
Partition Walls (Cubicles)	Compressed AC Sheet	14m2	All surfaces	Good Condition (1)	Low (1)	Low Priority (2-3)	Chrysotile (white asbestos)

B00B - R0004 - Plant - 3.81 m2							
No Asbestos							
B00B - R0005 - Toilets - Boys - 22.6 m2							
Ceiling Structures/Linings	Flat AC Sheeting	23m2	All surfaces	Good Condition (1)	Low (1)	Low Priority (2-3)	Chrysotile (white asbestos)
Partition Walls (Cubicles)	Compressed AC Sheet	7m2	All surfaces	Good Condition (1)	Low (1)	Low Priority (2-3)	Chrysotile (white asbestos)
B00B - R0008 - General Storeroom - 14.15 m2							
No Asbestos							
B00B - R0009 - Staff Room Annexe - 14.18 m2							
No Asbestos							
B00B - R0010 - Home Base - 73.79 m2							
No Asbestos							
B00B - R0011 - Access Shower/Toilet - 7.37 m2							
No Asbestos							
B00C - General Learning - 1942 - Brick/Block							
Exterior							
Ceiling Voids - Flat Roof	No Asbestos Found						
Underfloor Voids	No Asbestos Found						
Eaves Linings	Fibre Cement Casting (Monocrete)	40m2	Throughout	Good Condition (1)	Low (1)	Low Priority (2-3)	Chrysotile (white asbestos) , Amosite (brown asbestos) , Crocidolite (blue asbestos)
Gable Verge Lining	Flat AC Sheeting	10m2	North facing, South facing	Good Condition (1)	Low (1)	Low Priority (2-3)	Assumed Asbestos
Wall Linings Internal - Infill	No Asbestos Found						
Interior							
B00C - R0001 - Movement - 35 m2							
No Asbestos							
B00C - R0002 - Home Base - 56.81 m2							
No Asbestos							
B00C - R0003 - Home Base Store - 3.36 m2							
Floor Coverings Res/Textile	Vinyl Tiles						
B00C - R0004 - Home Base Store - 4.16 m2							
Floor Coverings Res/Textile	Vinyl Tiles						
B00C - R0005 - Home Base - 56.88 m2							
No Asbestos							
B00C - R0006 - Personal Effects Storage - 19.08 m2							
No Asbestos							
B00C - R0007 - Distribution Board - .59 m2							
Note: No inspection of live electrical installation							
Ceiling Structures/Linings	Flat AC Sheeting	6m2	All surfaces	Some Damage - Unsealed (3)	Low (1)	Low Priority (2-3)	Chrysotile (white asbestos) , Amosite (brown asbestos) , Crocidolite (blue asbestos)
Wall Linings Internal	Flat AC Sheeting	6m2	All surfaces	Some Damage - Unsealed (3)	Low (1)	Low Priority (2-3)	Chrysotile (white asbestos) , Amosite (brown asbestos) , Crocidolite (blue asbestos)
B00D - Pupil Facilities - 1942 - Brick/Block							
Exterior							
Ceiling Voids - Flat Roof	No Asbestos Found						
Underfloor Voids	AC Fragments/Debris	2	Throughout	Minimal Damage (2)	Low (1)	Low Priority (2-3)	Chrysotile (white asbestos)

Interior							
B00D - R0001 - Movement - 79.93 m2							
Ceiling Structures/Linings	Flat AC Sheeting	12m2	East facing	Good Condition (1)	Low (1)	Low Priority (2-3)	Assumed Asbestos
B00D - R0002 - Canteen - 26.5 m2							
Floor Coverings Res/Textile	Vinyl Tiles						
B00D - R0003 - Canteen Office/Store - 2.8 m2							
No Asbestos							
B00D - R0004 - Other-Vacant - .8 m2							
No Asbestos							
B00D - R0005 - Sports Store - 12.43 m2							
Ceiling Structures/Linings	No Asbestos Found						
B00D - R0006 - Cleaning Distributed Store - 6.74 m2							
Floor Coverings Res/Textile	Vinyl Tiles						
B00D - R0007 - Cleaning Supplies - 8.76 m2							
Ceiling Structures/Linings	No Asbestos Found						
B00D - R0008 - Staff Toilet - 3.38 m2							
Floor Coverings Res/Textile	Vinyl Tiles						
Plant / Equipment - Incinerator	No Asbestos Found						
B00D - R0009 - Canteen Office/Store - 5.32 m2							
Floor Coverings Res/Textile	Vinyl Tiles						
B00E - Administration/Library - 1966 - Brick/Block							
Exterior							
Ceiling Voids - Flat Roof	No Asbestos Found						
Underfloor Voids	No Asbestos Found						
Eaves Linings	Flat AC Sheeting	65m2	All surfaces	Good Condition (1)	Low (1)	Low Priority (2-3)	Chrysotile (white asbestos)
Gable Verge Lining	No Asbestos Found						
Interior							
B00E - R0001 - Interview - 17.13 m2							
No Asbestos							
B00E - R0002 - Principal - 18.36 m2							
No Asbestos							
B00E - R0003 - General Storeroom - 1.78 m2							
No Asbestos							
B00E - R0004 - Distribution Board - .84 m2							
No Asbestos							Note: No inspection of live electrical installation
B00E - R0005 - Sick Bay - Shower/Toilet - 5.02 m2							
Wall Linings Internal	Flat AC Sheeting						
B00E - R0006 - Sick Bay - 10.48 m2							
No Asbestos							
B00E - R0007 - Security Store - 13.79 m2							
No Asbestos							
B00E - R0008 - Deputy Principal - 12.54 m2							

No Asbestos							
B00E - R0009 - Movement - 46.48 m2							
No Asbestos							
B00E - R0011 - Reading Area - 170.02 m2							
No Asbestos							
B00E - R0012 - Movement - 12.49 m2							
Ceiling Structures/Linings	Flat AC Sheeting						
B00E - R0013 - General Storeroom - 6.96 m2							
No Asbestos							
B00E - R0014 - Special Programs Room - 34.97 m2							
No Asbestos							
B00E - R0015 - Communications Room - 12.57 m2							
No Asbestos							
B00E - R0016 - Library Office/Workroom - 24.89 m2							
No Asbestos							
B00E - R0017 - Disabled Toilet - 3.87 m2							
Wall Linings Internal	Flat AC Sheeting						
B00E - R0018 - Cleaning Distributed Store - 1.97 m2							
No Asbestos							
B00E - R0019 - Duplicating Workroom - 11.44 m2							
No Asbestos							
B00E - R0020 - Clerical Office - 23.29 m2							
No Asbestos							
B00E - R0021 - Movement - 1.42 m2							
Ceiling Structures/Linings	Flat AC Sheeting	2m2	All surfaces	Good Condition (1)	Low (1)	Low Priority (2-3)	Chrysotile (white asbestos)
B00E - R0022 - Staff Room - 49.79 m2							
No Asbestos							
B00E - R0023 - Staff Kitchen - 7.02 m2							
No Asbestos							
B00E - R0024 - Distribution Board - 2.42 m2							
						Note: No inspection of live electrical installation	
No Asbestos							
B00F - Storage - 1989 - Brick/Veneer							
Exterior							
Underfloor Voids	No Asbestos Found						
Ceiling Voids	No Asbestos Found						
Interior							
B00F - R0001 - Sports Store - 9.11 m2							
Wall Linings Internal	Flat AC Sheeting	16m2	All surfaces	Minimal Damage (2)	Low (1)	Low Priority (2-3)	Chrysotile (white asbestos)
Ceiling Structures/Linings	Flat AC Sheeting	10m2	All surfaces	Good Condition (1)	Low (1)	Low Priority (2-3)	Chrysotile (white asbestos)
B00F - R0002 - Garden Store - 13.74 m2							
No Asbestos							
B00F - R0003 - Garden Store - 9.08 m2							
Wall Linings Internal	Flat AC Sheeting	6m2	North facing	Some Damage - Unsealed (3)	Low (1)	Low Priority (2-3)	Chrysotile (white asbestos)
B00F - R0004 - No Access - 7.72 m2							
No Asbestos							

B00G - General Learning - 1989 - Brick/Block

Exterior

Underfloor Voids	No Asbestos Found						
Eaves Linings	Flat AC Sheeting	40m2	West facing	Good Condition (1)	Low (1)	Low Priority (2-3)	Chrysotile (white asbestos)
Gable Verge Lining	Flat AC Sheeting	12m2	North facing, South facing	Good Condition (1)	Low (1)	Low Priority (2-3)	Assumed Asbestos
Ceiling Voids	No Asbestos Found						
Wall Linings Internal - Infill	No Asbestos Found						

Interior

B00G - R0001 - Movement - 42.36 m2

Ceiling Structures/Linings	Flat AC Sheeting	43m2	All surfaces	Good Condition (1)	Low (1)	Low Priority (2-3)	Chrysotile (white asbestos)
----------------------------	------------------	------	--------------	--------------------	---------	--------------------	-----------------------------

B00G - R0002 - Toilets - Boys - 28.27 m2

Ceiling Structures/Linings	Flat AC Sheeting	120m2	All surfaces	Good Condition (1)	Low (1)	Low Priority (2-3)	Chrysotile (white asbestos) , Amosite (brown asbestos)
Partition Walls (Cubicles)	Compressed AC Sheet	10m2	All surfaces	Good Condition (1)	Low (1)	Low Priority (2-3)	Chrysotile (white asbestos)

B00G - R0003 - Toilets - Girls - 24.11 m2

Partition Walls (Cubicles)	Compressed AC Sheet	12m2	All surfaces	Good Condition (1)	Low (1)	Low Priority (2-3)	Chrysotile (white asbestos)
Ceiling Structures/Linings	Flat AC Sheeting	120m2	All surfaces	Good Condition (1)	Low (1)	Low Priority (2-3)	Chrysotile (white asbestos) , Amosite (brown asbestos)

B00G - R0004 - Cleaning Distributed Store - 2.12 m2

Ceiling Structures/Linings	Flat AC Sheeting	3m2	All surfaces	Good Condition (1)	Low (1)	Low Priority (2-3)	Assumed Asbestos
----------------------------	------------------	-----	--------------	--------------------	---------	--------------------	------------------

B00G - R0005 - Home Base - 73.71 m2

No Asbestos

B00G - R0006 - Withdrawal Space - 1hb - 26.86 m2

Electrical - Backing Board	No Asbestos Found						
----------------------------	-------------------	--	--	--	--	--	--

B00G - R0007 - Toilets - Boys/Girls - 2.61 m2

No Asbestos

B00G - R0008 - General Storeroom - 1.43 m2

Floor Coverings Res/Textile	Vinyl Tiles	2m2	All surfaces	Good Condition (1)	Low (1)	Low Priority (2-3)	Chrysotile (white asbestos)
-----------------------------	-------------	-----	--------------	--------------------	---------	--------------------	-----------------------------

B00G - R0009 - Staff Room Annexe - 11.12 m2

No Asbestos

B00H - General Learning - 1966 - Timber

Exterior

Ceiling Voids - Flat Roof	No Asbestos Found						
Eaves Linings	Flat AC Sheeting	50m2	All surfaces	Good Condition (1)	Low (1)	Low Priority (2-3)	Chrysotile (white asbestos) , Amosite (brown asbestos)
Underfloor Voids	Non Accessible Area						
Underfloor Voids	Non Accessible Area						
Ceiling Voids - Raked Ceiling	Non Accessible Area						

Interior

B00H - R0001 - Movement - 92.47 m2

Wall Linings Internal	Flat AC Sheeting	5m2	East facing, West facing, Upper portion	Good Condition (1)	Low (1)	Low Priority (2-3)	Chrysotile (white asbestos) , Amosite (brown asbestos)
Ceiling Structures/Linings	Flat AC Sheeting	93m2	All surfaces	Minimal Damage (2)	Low (1)	Low Priority (2-3)	Chrysotile (white asbestos) , Amosite (brown asbestos)
Electrical - Mounting Board	Resinous Board	1	South facing, West facing	Good Condition (1)	Low (1)	Low Priority (2-3)	Assumed Asbestos
Floor Coverings Res/Textile	Compressed AC Sheet						
B00H - R0002 - Withdrawal Space - 1hb - 10.98 m2							
Wall Linings Internal	Flat AC Sheeting	12m2	All surfaces, Upper portion	Good Condition (1)	Low (1)	Low Priority (2-3)	Chrysotile (white asbestos) , Amosite (brown asbestos)
Ceiling Structures/Linings	Flat AC Sheeting	11m2	All surfaces	Minimal Damage (2)	Low (1)	Low Priority (2-3)	Chrysotile (white asbestos) , Amosite (brown asbestos)
B00H - R0003 - Home Base Store - 10.72 m2							
Wall Linings Internal	Flat AC Sheeting	12m2	All surfaces, Upper portion	Good Condition (1)	Low (1)	Low Priority (2-3)	Chrysotile (white asbestos) , Amosite (brown asbestos)
Ceiling Structures/Linings	Flat AC Sheeting	11m2	All surfaces	Minimal Damage (2)	Low (1)	Low Priority (2-3)	Chrysotile (white asbestos) , Amosite (brown asbestos)
B00H - R0004 - Home Base - 53.51 m2							
Wall Linings Internal	Flat AC Sheeting	60m2	All surfaces, Upper portion	Good Condition (1)	Low (1)	Low Priority (2-3)	Chrysotile (white asbestos) , Amosite (brown asbestos)
Ceiling Structures/Linings	Flat AC Sheeting	54m2	All surfaces	Minimal Damage (2)	Low (1)	Low Priority (2-3)	Chrysotile (white asbestos) , Amosite (brown asbestos)
B00H - R0005 - Home Base - 53.51 m2							
Wall Linings Internal	Flat AC Sheeting	60m2	All surfaces, Upper portion	Good Condition (1)	Low (1)	Low Priority (2-3)	Chrysotile (white asbestos) , Amosite (brown asbestos)
Ceiling Structures/Linings	Flat AC Sheeting	54m2	All surfaces	Minimal Damage (2)	Low (1)	Low Priority (2-3)	Chrysotile (white asbestos) , Amosite (brown asbestos)
B00H - R0006 - Home Base Store - 10.83 m2							
Wall Linings Internal	Flat AC Sheeting	12m2	All surfaces, Upper portion	Good Condition (1)	Low (1)	Low Priority (2-3)	Chrysotile (white asbestos) , Amosite (brown asbestos)
Ceiling Structures/Linings	Flat AC Sheeting	11m2	All surfaces	Minimal Damage (2)	Low (1)	Low Priority (2-3)	Chrysotile (white asbestos) , Amosite (brown asbestos)
B00H - R0007 - Home Base Store - 11.13 m2							
Wall Linings Internal	Flat AC Sheeting	12m2	All surfaces, Upper portion	Good Condition (1)	Low (1)	Low Priority (2-3)	Chrysotile (white asbestos) , Amosite (brown asbestos)
Ceiling Structures/Linings	Flat AC Sheeting	12m2	All surfaces	Minimal Damage (2)	Low (1)	Low Priority (2-3)	Chrysotile (white asbestos) , Amosite (brown asbestos)
B00H - R0010 - Home Base Store - 9.88 m2							
Wall Linings Internal	Flat AC Sheeting	12m2	All surfaces, Upper portion	Good Condition (1)	Low (1)	Low Priority (2-3)	Chrysotile (white asbestos) , Amosite (brown asbestos)
Ceiling Structures/Linings	Flat AC Sheeting	10m2	All surfaces	Minimal Damage (2)	Low (1)	Low Priority (2-3)	Chrysotile (white asbestos) , Amosite (brown asbestos)
B00H - R0011 - No Access - 11.7 m2							
No Asbestos							
B00H - R0012 - Home Base - 107.48 m2							
No Asbestos							
B00I - General Learning - 1966 - Timber							
Exterior							
Ceiling Voids - Flat Roof	No Asbestos Found						
Underfloor Voids - Slab on Ground	No Asbestos Found						
Eaves Linings	Flat AC Sheeting						
Interior							
B00I - R0001 - Movement - 13.17 m2							

Ceiling Structures/Linings	Flat AC Sheeting	20m2	All surfaces	Good Condition (1)	Low (1)	Low Priority (2-3)	Chrysotile (white asbestos) , Amosite (brown asbestos)
B00I - R0002 - Withdrawal Space - 1hb - 17.74 m2							
Floor Coverings Res/Textile	Vinyl Tiles	18m2	All surfaces	Mnimal Damage (2)	Low (1)	Low Priority (2-3)	Chrysotile (white asbestos)
Ceiling Structures/Linings	Flat AC Sheeting	18m2	All surfaces	Good Condition (1)	Low (1)	Low Priority (2-3)	Assumed Asbestos
B00I - R0003 - General Storeroom - 2.03 m2							
Floor Coverings Res/Textile	Vinyl Tiles	3m2	All surfaces	Mnimal Damage (2)	Low (1)	Low Priority (2-3)	Chrysotile (white asbestos)
Ceiling Structures/Linings	Flat AC Sheeting	3m2	All surfaces	Good Condition (1)	Low (1)	Low Priority (2-3)	Assumed Asbestos
B00I - R0004 - General Storeroom - 3.4 m2							
Floor Coverings Res/Textile	Vinyl Tiles	4m2	All surfaces	Mnimal Damage (2)	Low (1)	Low Priority (2-3)	Chrysotile (white asbestos)
Ceiling Structures/Linings	Flat AC Sheeting	4m2	All surfaces	Good Condition (1)	Low (1)	Low Priority (2-3)	Assumed Asbestos
B00J - General Learning - 1966 - Brick/Veneer							
Exterior							
Ceiling Voids - Flat Roof	No Asbestos Found						
Underfloor Voids	No Asbestos Found						
Interior							
B00J - R0001 - General Storeroom - 11.27 m2							
No Asbestos							
B00J - R0002 - General Storeroom - 13.3 m2							
No Asbestos							
B00J - R0003 - Toilets - Boys/Girls - 3.29 m2							
No Asbestos							
B00J - R0004 - Home Base - 89.84 m2							
No Asbestos							
B00J - R0005 - Home Base - 43.34 m2							
No Asbestos							
B00J - R0006 - Craft Store - 17.41 m2							
No Asbestos							
B00J - R0007 - General Storeroom - 6.68 m2							
No Asbestos							
B00J - R0008 - Movement - 58.64 m2							
Wall Linings Internal	Flat AC Sheeting						
B00K - Support Unit - 1966 - Timber							
Exterior							
Ceiling Voids - Flat Roof	No Asbestos Found						
Underfloor Voids - Slab on Ground	No Asbestos Found						
Eaves Linings	Flat AC Sheeting	18m2	South facing, West facing	Good Condition (1)	Low (1)	Low Priority (2-3)	Chrysotile (white asbestos) , Amosite (brown asbestos)
Interior							
B00K - R0001 - Home Base - 52.27 m2							
Floor Coverings Res/Textile	Vinyl Tiles						
Floor Coverings Res/Textile	Compressed AC Sheet						

Wall Linings Internal	Flat AC Sheeting	60m2	All surfaces, Upper portion	Good Condition (1)	Low (1)	Low Priority (2-3)	Chrysotile (white asbestos) , Amosite (brown asbestos)
Ceiling Structures/Linings	Flat AC Sheeting	53m2	All surfaces	Minimal Damage (2)	Low (1)	Low Priority (2-3)	Chrysotile (white asbestos) , Amosite (brown asbestos)
B00K - R0002 - Home Base - M - 38.23 m2							
Wall Linings Internal	Flat AC Sheeting	40m2	All surfaces, Upper portion	Good Condition (1)	Low (1)	Low Priority (2-3)	Chrysotile (white asbestos) , Amosite (brown asbestos)
Ceiling Structures/Linings	Flat AC Sheeting	39m2	All surfaces	Minimal Damage (2)	Low (1)	Low Priority (2-3)	Chrysotile (white asbestos) , Amosite (brown asbestos)
B00K - R0003 - Practical Activities - M - 1hb - 8.85 m2							
No Asbestos							
B00K - R0004 - Sick Bay - 19.47 m2							
No Asbestos							
B00K - R0005 - General Storeroom - 6.22 m2							
No Asbestos							
B00K - R0006 - Toilet - M - 22.15 m2							
Wall Linings Internal	Flat AC Sheeting						
B00K - R0007 - Toilet - M - 2.97 m2							
Wall Linings Internal	Flat AC Sheeting						
B00K - R0008 - Laundry - P - 6.86 m2							
Wall Linings Internal	Flat AC Sheeting						
B00K - R0009 - Movement - 27.35 m2							
Wall Linings Internal	Flat AC Sheeting	5m2	North facing	Good Condition (1)	Low (1)	Low Priority (2-3)	Chrysotile (white asbestos) , Amosite (brown asbestos)
Ceiling Structures/Linings	Flat AC Sheeting	28m2	All surfaces	Minimal Damage (2)	Low (1)	Low Priority (2-3)	Chrysotile (white asbestos) , Amosite (brown asbestos)
B00K - R0010 - General Storeroom - 6.06 m2							
Wall Linings Internal	Flat AC Sheeting	16m2	All surfaces	Good Condition (1)	Low (1)	Low Priority (2-3)	Chrysotile (white asbestos) , Amosite (brown asbestos)
Ceiling Structures/Linings	Flat AC Sheeting	7m2	All surfaces	Minimal Damage (2)	Low (1)	Low Priority (2-3)	Chrysotile (white asbestos) , Amosite (brown asbestos)
B00K - R0011 - Practical Activities - M - 1hb - 13.6 m2							
Wall Linings Internal	Flat AC Sheeting	15m2	All surfaces, Upper portion	Good Condition (1)	Low (1)	Low Priority (2-3)	Chrysotile (white asbestos) , Amosite (brown asbestos)
Ceiling Structures/Linings	Flat AC Sheeting	14m2	All surfaces	Minimal Damage (2)	Low (1)	Low Priority (2-3)	Chrysotile (white asbestos) , Amosite (brown asbestos)
B00L - Building Services - 2009 - Metal Shed							
Exterior							
Underfloor Voids - Slab on Ground	No Asbestos Found						
Ceiling Voids	No Asbestos Found						
Ceiling Voids - Flat Roof	No Asbestos Found						
Interior							
B00L - R0001 - General Assistant/Bulk Store - 44.25 m2							
No Asbestos							
B00M - General Learning - 2010 - Fibre Cement Clad							
Exterior							
Underfloor Voids - Slab on Ground	No Asbestos Found						
Ceiling Voids	No Asbestos Found						

Ceiling Voids - Flat Roof	No Asbestos Found	
Interior		
B00M - R0001 - External Movement - 38.48 m2		
No Asbestos		
B00M - R0002 - Practical Activities - 1hb - 19.4 m2		
No Asbestos		
B00M - R0003 - Home Base Store - 6.02 m2		
No Asbestos		
B00M - R0004 - Home Base - 59.2 m2		
No Asbestos		
B00M - R0005 - Withdrawal Space - 2hb - 11.36 m2		
No Asbestos		
B00M - R0006 - Home Base - 59.19 m2		
No Asbestos		
B00M - R0007 - Home Base Store - 6.02 m2		
No Asbestos		
B00M - R0008 - Practical Activities - 1hb - 19.41 m2		
No Asbestos		
B00N - General Learning - 2010 - Fibre Cement Clad		
Exterior		
Underfloor Voids - Slab on Ground	No Asbestos Found	
Ceiling Voids	No Asbestos Found	
Ceiling Voids - Flat Roof	No Asbestos Found	
Interior		
B00N - R0001 - External Movement - 38.48 m2		
No Asbestos		
B00N - R0002 - Practical Activities - 1hb - 19.4 m2		
No Asbestos		
B00N - R0003 - Home Base Store - 6.02 m2		
No Asbestos		
B00N - R0004 - Home Base - 59.2 m2		
No Asbestos		
B00N - R0005 - Withdrawal Space - 2hb - 11.36 m2		
No Asbestos		
B00N - R0006 - Home Base - 59.19 m2		
No Asbestos		
B00N - R0007 - Home Base Store - 6.02 m2		
No Asbestos		
B00N - R0008 - Practical Activities - 1hb - 19.41 m2		
No Asbestos		

Demountables

There are no Demountable(s) Located at this school as per the AMS records as of 09-Sep-2020