

Michael Cassel  
Planning Secretary  
Department of Planning and Environment  
Locked Bag 5022  
Parramatta NSW 2124

Attn: Shiraz Ahmed / Rob Sherry

14 September 2022

Dear Mr Cassel

**Upgrades to Glenwood High School (SSD-23512960): Amended Plans in accordance with Condition B3**

I refer to SSD Application SSD-23512960, upgrades to Glenwood High School, approved on the 25 August 2022.

In accordance with condition B3 of the Development Consent (below), architectural drawings and landscape plans have been amended to meet the following requirements:

**Amended Plans**

- B3. Prior to commencement of construction, the architectural drawings and landscape plans referenced in Condition A2 must be amended and submitted to the Planning Secretary. The amended plans must meet the following requirements:
- (a) 25 additional on-site car parking spaces consistent with the 'Traffic Statement for Additional Parking Provision' prepared by TTW dated 17 June 2022 (submitted with the SRTs);
  - (b) include the planting of 21 additional trees using locally native tree species;
  - (c) finished levels of all internal works at the road boundary of the property must be 4% above the top of the adjacent kerb.

Condition Number	Demonstration of Compliance	Drawing(s) Reference
B3 (a)	Refer to Architectural site plans mandating condition B3(a)	DA-AR-0010_PDF_E DA-AR-0020_PDF_E DA-AR-0021_PDF_E DA-AR-0022_PDF_E DA-AR-0023_PDF_E DA-AR-0024_PDF_E DA-AR-0401_PDF_E DA-AR-0408_PDF_E

		DA-AR-2005_PDF_E DA-AR-2006_PDF_E DA-AR-2007_PDF_E DA-AR-2008_PDF_E DA-AR-A101_PDF_E DA-AR-A102_PDF_E DA-AR-N103_PDF_E DA-AR-N113_PDF_E DA-AR-N123_PDF_E DR-AR-N133_PDF_E
B3 (b)	Refer to Landscape Plan annotation mandating condition B3(b)	GHS-LS-SW-DRW-0301_04 DA-LA-0001 DA-LA-0003 DA-LA-0010
B3 (c)	Refer to Landscape Plan annotation mandating condition B3(c)	GHS-LS-SW-DRW-0301_04 GHS-LS-SW-DRW-0311_02

The amended plans have been reviewed by the Project Team and the Statutory Planning Team at School Infrastructure NSW.

The Department of Education hereby submits the above documents to the Planning Secretary for their approval.

Yours sincerely

Jeremy Stott  
**Project Director**  
**Schools Infrastructure NSW**





1 SITE PLAN - DEMO  
1 : 600 @A1

Key Plan:

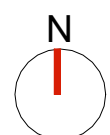
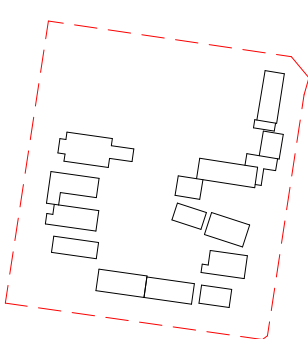

**Drawing Disclaimer:**  
Do not scale from drawings.  
Verify all dimensions on site before commencing work.  
Copying or reproduction of this drawing is strictly prohibited without the consent of PTW Architects

**Note**  
PTW takes no responsibility for external building elements. Anything connected with any design, materials selection, construction or installation of any cladding, facade or external building element must be checked by and remains the responsibility of others, including suitably qualified experts as may be required.

Rev	Amendment	By	Chk*	Date
E	SSDA SUBMISSION	FJ	DJ	22/09/12
D	SSDA SUBMISSION	FJ	DJ	21/11/10
C	DRAFT SSDA SUBMISSION	MB	DJ	21/11/01
B	DRAFT SSDA SUBMISSION	MB	DJ	21/10/25
A	DRAFT SSDA SUBMISSION	MB	DJ	21/10/01

**\*Registered Architect**  
DHJ Diane H Jones NSW Arch 4778

**Consultants**

**Client**



Education

**Architect**  
PTW Architects  
Level 11, 88 Phillip Street  
Sydney NSW 2000 Australia  
T +61 2 9232 5877  
[ptw.com.au](http://ptw.com.au)

Peddie Thorp & Walker P/L  
ABN 23 000 454 624  
trading as PTW Architects

NSW Nominated Architects  
S Parsons Architect No. 6098  
D Jones Architect No. 4778



0 36 48  
As indicated  
Project PA030471  
**GLENWOOD HIGH SCHOOL**  
FORMAN AVENUE, GLENWOOD, NSW  
2768  
Status  
SSDA SUBMISSION

Title  
SSDA  
**SITE PLAN - ROOF DEMO**  
Drawing Number  
**DA-AR-0010**

Revision  
**E**



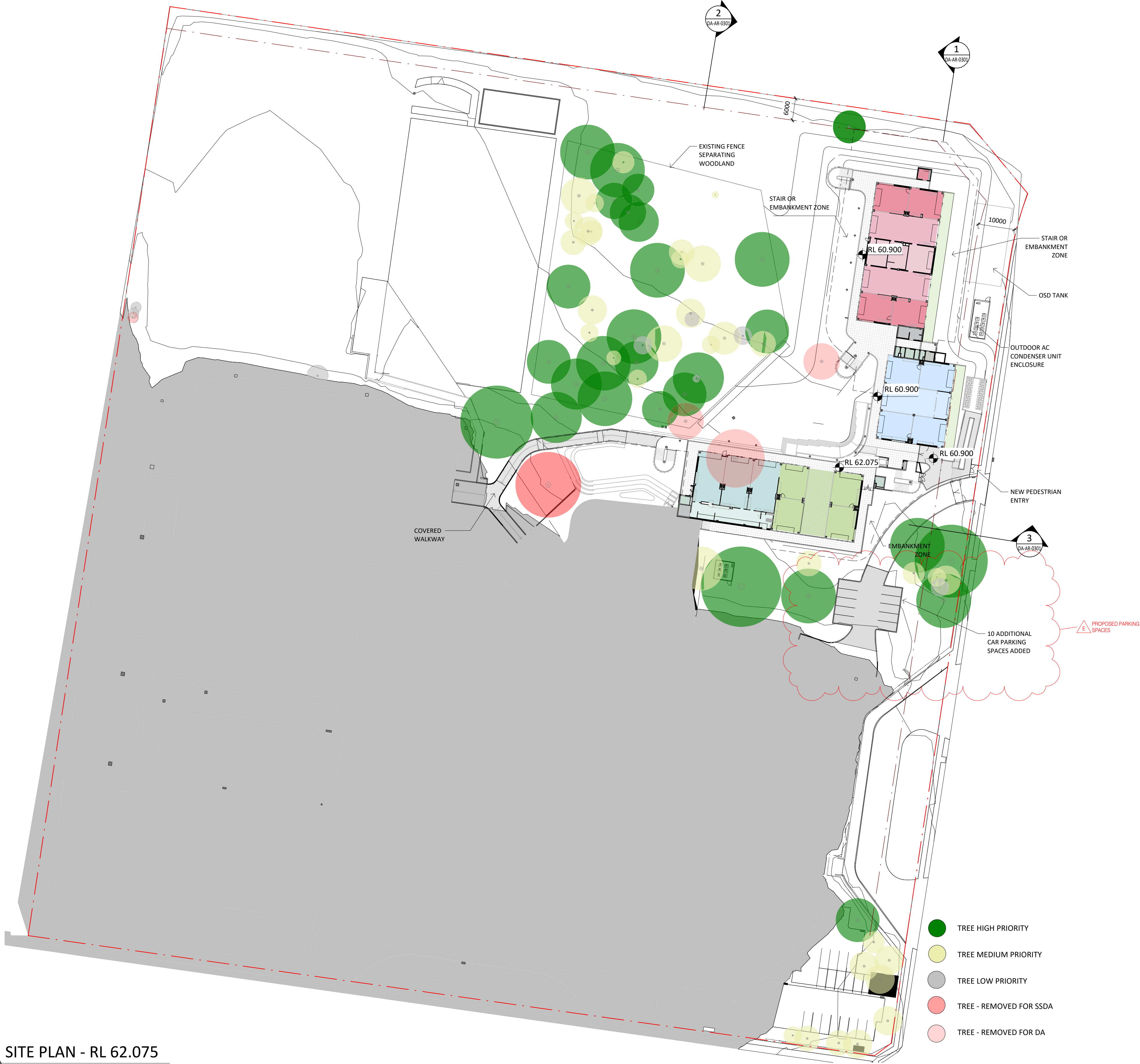

LEGEND

- ACCESSIBLE WC
- COMMS
- SCIENCE GENERAL LEARNING SPACE
- STAFF AMENITIES
- STORAGE UNIT / COMMS
- STUDENT AMENITIES
- VISUAL ARTS GENERAL LEARNING SPACE
- VISUAL ARTS WORKSHOP

- TREE HIGH PRIORITY
- TREE MEDIUM PRIORITY
- TREE LOW PRIORITY
- TREE - REMOVED FOR SSDA
- TREE - REMOVED FOR DA

1 SITE PLAN - RL 62.075  
1 : 600 @A1

Key Plan:

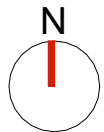
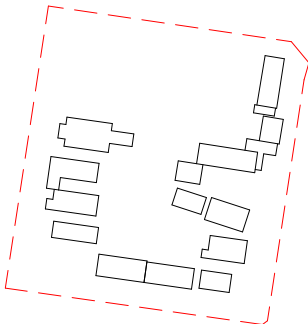

**Drawing Disclaimer:**  
Do not scale from drawings.  
Verify all dimensions on site before commencing work.  
Copying or reproduction of this drawing is strictly prohibited without the consent of PTW Architects

**Note**  
PTW takes no responsibility for external building elements. Anything connected with any design, materials selection, construction or installation of any cladding, facade or external building element must be checked by and remains the responsibility of others, including suitably qualified experts as may be required.

Rev	Amendment	By	Chk*	Date
E	SSDA SUBMISSION	FJ	DJ	22/09/12
D	SSDA SUBMISSION	FJ	DJ	21/11/10
C	DRAFT SSDA SUBMISSION	MB	DJ	21/11/01
B	DRAFT SSDA SUBMISSION	MB	DJ	21/10/25
A	DRAFT SSDA SUBMISSION	MB	DJ	21/10/01

**\*Registered Architect**  
DHJ Diane H Jones NSW Arch 4778

Consultants

Client



Education

**Architect**  
PTW Architects  
Level 11, 88 Phillip Street  
Sydney NSW 2000 Australia  
T +61 2 9232 5877  
[ptw.com.au](http://ptw.com.au)

Peddie Thorp & Walker P/L  
ABN 23 000 454 624  
trading as PTW Architects

NSW Nominated Architects  
S Parsons Architect No. 6098  
D Jones Architect No. 4778



0 36 48  
As indicated  
Project PA030471  
**GLENWOOD HIGH SCHOOL**  
FORMAN AVENUE, GLENWOOD, NSW  
2768

Status  
SSDA SUBMISSION

Title  
SSDA  
SITE PLAN - RL 62.075  
Drawing Number  
DA-AR-0020

Revision  
E





LEGEND

- NEW-ADMINISTRATION UNIT
- NEW-FOOD TECH - MATERIALS LEARNING UNIT
- NEW-GENERAL LEARNING UNIT
- NEW-SHARED LEARNING SPACE
- NEW-LIBRARY UNIT
- NEW-PERFORMING ARTS UNIT
- NEW-PERFORM ARTS WORKSHOP
- NEW-PERFORM ARTS STORE
- NEW-SCIENCE LEARNING UNIT
- NEW-SCIENCE LABORATORY
- NEW-SCIENCE STORE
- NEW - STAFF AMENITY
- NEW-STAFF UNIT
- NEW-STORAGE UNIT / COMMS
- NEW-STUDENT AMENITIES
- NEW-STAFF AMENITIES
- NEW-SUPPORT LEARNING UNIT
- NEW-WOOD/METAL - MATERIALS LEARNING UNIT
- EXIST-ADMINISTRATION
- EXIST-CANTEEN UNIT
- EXIST-CIRCULATION
- EXIST-FITNESS LEARNING UNI
- EXIST-GENERAL LEARNING UNIT
- EXIST-MOVEMENT COMPLEX
- EXIST-STORAGE UNIT / COMMS
- EXIST-STUDENT AMENITIES
- EXIST-SUPPORT LEARNING UNIT
- EXIST-WOOD/METAL - MATERIALS LEARNING UNIT

- TREE HIGH PRIORITY
- TREE MEDIUM PRIORITY
- TREE LOW PRIORITY
- TREE - REMOVED FOR SSDA
- TREE - REMOVED FOR DA

1 SITE PLAN - RL 65.975  
1 : 600 @A1

Key Plan:

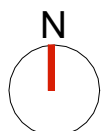
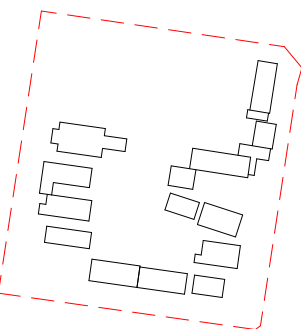

**Drawing Disclaimer:**  
Do not scale from drawings.  
Verify all dimensions on site before commencing work.  
Copying or reproduction of this drawing is strictly prohibited without the consent of PTW Architects

**Note**  
PTW takes no responsibility for external building elements. Anything connected with any design, materials selection, construction or installation of any cladding, facade or external building element must be checked by and remains the responsibility of others, including suitably qualified experts as may be required.

Rev	Amendment	By	Chk*	Date
E	SSDA SUBMISSION	FJ	DJ	22/09/12
D	SSDA SUBMISSION	FJ	DJ	21/11/10
C	DRAFT SSDA SUBMISSION	MB	DJ	21/11/01
B	DRAFT SSDA SUBMISSION	MB	DJ	21/10/25
A	DRAFT SSDA SUBMISSION	MB	DJ	21/10/01

\*Registered Architect  
DHJ Diane H Jones NSW Arch 4778

Consultants

Client



Education

Architect  
PTW Architects  
Level 11, 88 Phillip Street  
Sydney NSW 2000 Australia  
T +61 2 9232 5877  
[ptw.com.au](http://ptw.com.au)

Peddie Thorp & Walker P/L  
ABN 23 000 454 624  
trading as PTW Architects

NSW Nominated Architects  
S Parsons Architect No.6098  
D Jones Architect No.4778



0 36 48  
As indicated  
Project PA030471  
**GLENWOOD HIGH SCHOOL**  
FORMAN AVENUE, GLENWOOD, NSW  
2768  
Status  
SSDA SUBMISSION

Title  
SSDA  
SITE PLAN - RL 65.975  
Drawing Number  
DA-AR-0021

Revision  
E